

SEC. 10, T.19N., R.9E., 3rd P.M.
CHAMPAIGN COUNTY, ILLINOIS

PROPOSED \bar{C}
MAIN STREET
CURVE DATA
P.I. STA. 82+13.09
 $\Delta = 8^{\circ}07'28''$
 $D = 2^{\circ}23'14''$
 $T = 170.44'$
 $R = 2400.00'$
 $L = 340.32'$
 $E = 6.04'$
P.C. STA. 80+42.65
P.T. STA. 83+82.96

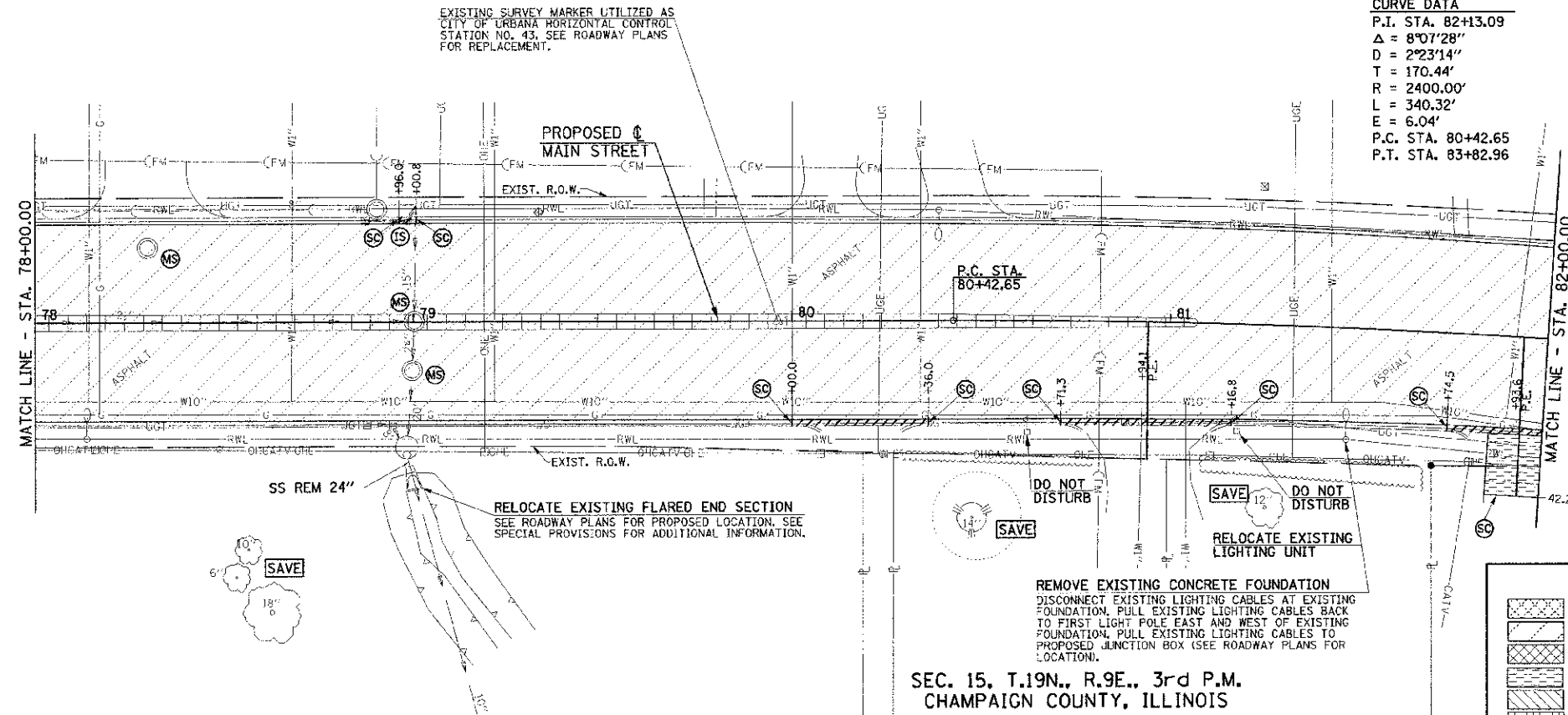
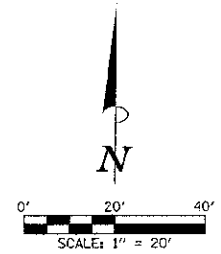

ALL TREES SHALL BE SAVED UNLESS OTHERWISE SHOWN ON THE PLANS OR DIRECTED BY THE ENGINEER.

ITEMS NOT SHOWN TO BE ADJUSTED OR REMOVED SHALL NOT BE DISTURBED UNLESS OTHERWISE DIRECTED BY THE ENGINEER.

SOME OF THE TOPOGRAPHIC INFORMATION OUTSIDE OF THE ROADWAY SHOWN ON THIS SHEET IS BASED ON AERIAL PHOTOGRAPHY AND IS APPROXIMATE.

UTILITY INFORMATION IS ONLY SHOWN IN AREAS OF PROPOSED UNDERGROUND WORK.

SEC. 15, T.19N., R.9E., 3rd P.M.
CHAMPAIGN COUNTY, ILLINOIS

SEC. 10, T.19N., R.9E., 3rd P.M.
CHAMPAIGN COUNTY, ILLINOIS

REMOVE EXISTING CONCRETE FOUNDATION
DISCONNECT EXISTING LIGHTING CABLES AT EXISTING FOUNDATION. PULL EXISTING LIGHTING CABLES BACK TO FIRST LIGHT POLE EAST AND WEST OF EXISTING FOUNDATION. PULL EXISTING LIGHTING CABLES TO PROPOSED JUNCTION BOX (SEE ROADWAY PLANS FOR LOCATION).

- LEGEND**
- PAVEMENT REMOVAL
 - HMA SURFACE REMOVAL
 - P.C.C. SIDEWALK REMOVAL
 - DRIVEWAY PAVEMENT REMOVAL
 - CONCRETE STEP REMOVAL
 - BRICK SIDEWALK REMOVAL
 - CONCRETE MEDIAN SURFACE REMOVAL
 - RETAINING WALL REMOVAL
 - COMBINATION CURB AND GUTTER REMOVAL
 - DOMESTIC METER VAULTS TO BE ADJUSTED
 - DOMESTIC WATER SERVICE BOXES TO BE ADJUSTED
 - INLET TO BE ADJUSTED
 - INLET TO BE REMOVED
 - VALVE BOXES TO BE ADJUSTED
 - MANHOLES TO BE ADJUSTED
 - VALVE BOXES TO BE ADJUSTED (SPECIAL)
 - MANHOLES TO BE ADJUSTED (SPECIAL)
 - HANDHOLE TO BE ADJUSTED
 - JUNCTION BOX TO BE ADJUSTED
 - INLETS TO BE ADJUSTED (SPECIAL)
 - INLETS TO BE ADJUSTED WITH NEW FRAME AND GRATE (SPECIAL)
 - SAW CUT

- INLET TO BE ADJUSTED
- INLET TO BE REMOVED
- VALVE BOXES TO BE ADJUSTED
- MANHOLES TO BE ADJUSTED
- VALVE BOXES TO BE ADJUSTED (SPECIAL)
- MANHOLES TO BE ADJUSTED (SPECIAL)
- HANDHOLE TO BE ADJUSTED
- JUNCTION BOX TO BE ADJUSTED
- INLETS TO BE ADJUSTED (SPECIAL)
- INLETS TO BE ADJUSTED WITH NEW FRAME AND GRATE (SPECIAL)
- SAW CUT

SEE SHEET 25 FOR REMOVAL NOTES.

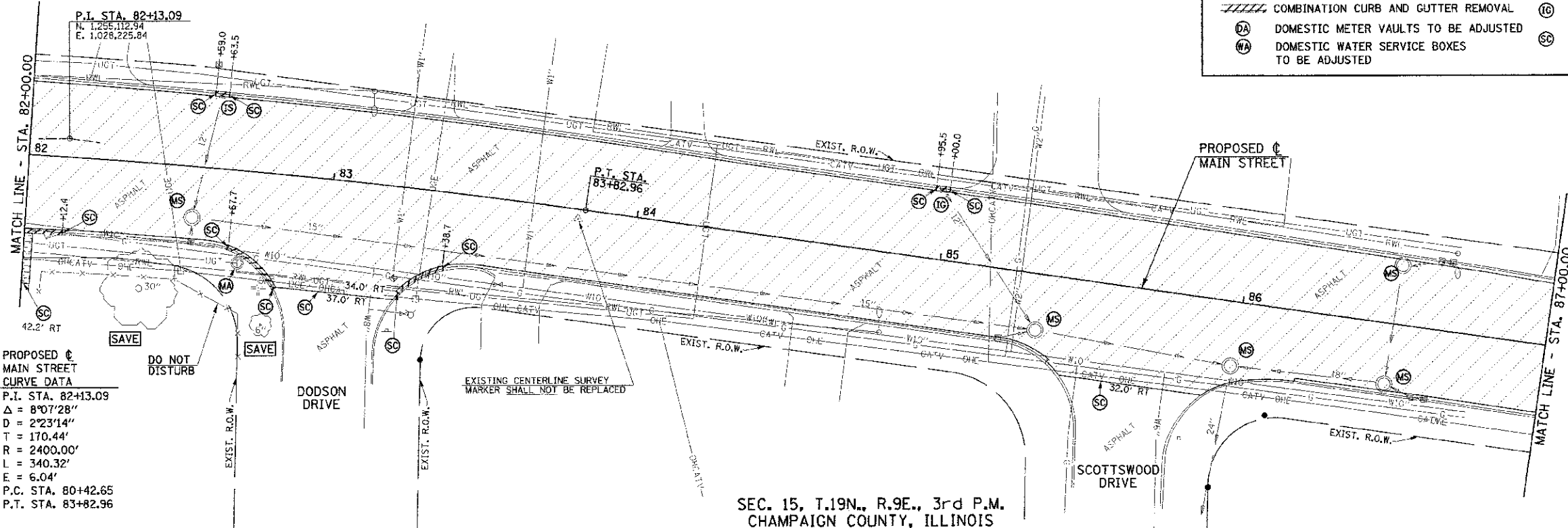

PROPOSED \bar{C}
MAIN STREET
CURVE DATA
P.I. STA. 82+13.09
 $\Delta = 8^{\circ}07'28''$
 $D = 2^{\circ}23'14''$
 $T = 170.44'$
 $R = 2400.00'$
 $L = 340.32'$
 $E = 6.04'$
P.C. STA. 80+42.65
P.T. STA. 83+82.96

SEC. 15, T.19N., R.9E., 3rd P.M.
CHAMPAIGN COUNTY, ILLINOIS

FILE NAME =
p:\U0070062_Urbana - Main Street (TEP)\Plans\sheet\08 removal.dgn
PLOT DATE =
5/3/2013 11:51:35 AM

DESIGNED - J.A.J.	REVISED -
DRAWN - D.L.M.	REVISED -
CHECKED - S.M.W.	REVISED -
DATE - 03/2013	REVISED -

STATE OF ILLINOIS
DEPARTMENT OF TRANSPORTATION

REMOVAL PLANS

SCALE: 1"=20' SHEET NO. 24 OF 75 SHEETS STA. 78+00.00 TO STA. 87+00.00

F.A.L. RTE.	SECTION	COUNTY	TOTAL SHEETS	SHEET NO.
7124	09-00483-01-RS	CHAMPAIGN	75	24
MAIN STREET		CONTRACT NO. 91480		
FED. ROAD DIST. NO.		ILLINOIS FED. AID PROJECT		