

SEC. 9, T.19N., R.9E., 3rd P.M.
CHAMPAIGN COUNTY, ILLINOIS

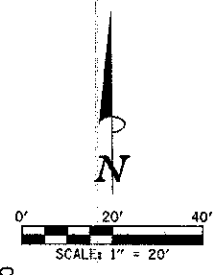

SEC. 16, T.19N., R.9E., 3rd P.M.
CHAMPAIGN COUNTY, ILLINOIS
SEC. 9, T.19N., R.9E., 3rd P.M.
CHAMPAIGN COUNTY, ILLINOIS

TYPICAL PAVEMENT MARKING AND SIGNING LEGEND	
1 4" SKIP-DASH (YELLOW)	9 12" DIAGONAL (WHITE)
2 4" SOLID (YELLOW)	10 6" CROSSWALK (WHITE)
3 12" DIAGONAL (YELLOW)	11 24" STOP BAR (WHITE)
4 4" DOUBLE (YELLOW) (NARROW)	12 8" SOLID (WHITE)*
5 4" DOUBLE (YELLOW) (WIDE)*	13 4" LANE LINE EXTENSIONS (WHITE)
6 6" DIAGONAL (YELLOW)*	14 12" CROSSWALK (WHITE)*
7 4" SKIP-DASH (WHITE)*	15 6" SOLID (WHITE)
8 4" SOLID (WHITE)	16 6" LANE LINE EXTENSIONS (WHITE)
*NOT USED	— METAL POST - TYPE B

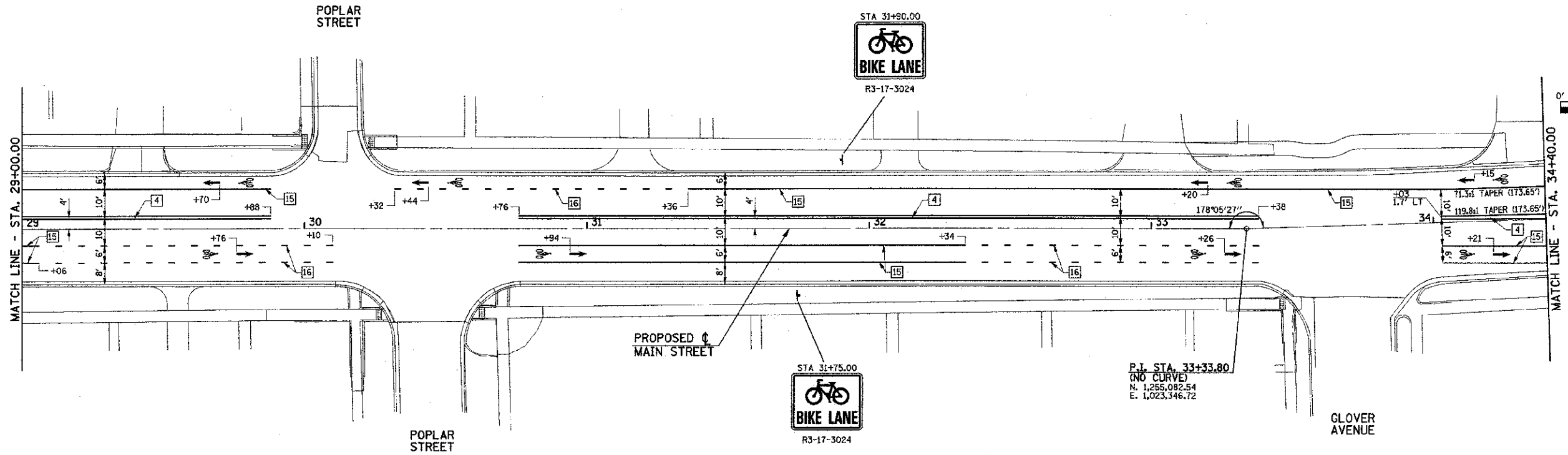
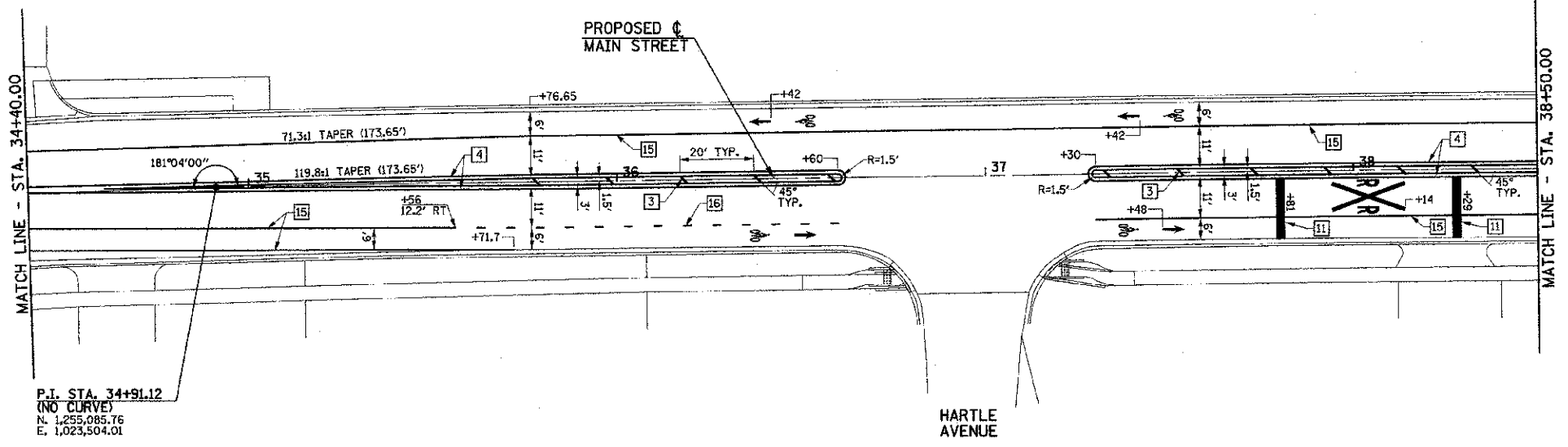

SEC. 16, T.19N., R.9E., 3rd P.M.
CHAMPAIGN COUNTY, ILLINOIS

FILE NAME = p:\0070062_Urbana - Main Street ITC\Plans\sheet\14-pvmt-marking.dgn	DESIGNED - J.A.J.	REVISED -	STATE OF ILLINOIS DEPARTMENT OF TRANSPORTATION	PAVEMENT MARKING AND SIGNING PLANS		F.A.I. RTE.	SECTION	COUNTY	TOTAL SHEETS	SHEET NO.
PLOT DATE = 3/6/2013 11:44:27 PM	DRAWN - D.L.M.	REVISED -		7124	09-00483-01-RS	CHAMPAIGN	75	49		
	CHECKED - S.M.W.	REVISED -		SCALE: 1"=20'		SHEET NO. 49 OF 75 SHEETS		STA. 29+00.00 TO STA. 38+50.00	CONTRACT NO. 91480	
	DATE - 03/2013	REVISED -		FED. ROAD DIST. NO.		ILLINOIS		FED. AID PROJECT		