

SEC. 9, T.19N., R.9E., 3rd P.M.  
CHAMPAIGN COUNTY, ILLINOIS

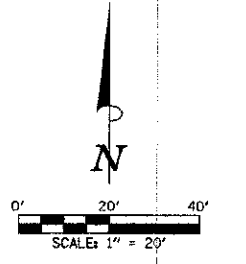

SEC. 16, T.19N., R.9E., 3rd P.M.  
CHAMPAIGN COUNTY, ILLINOIS

SEC. 9, T.19N., R.9E., 3rd P.M.  
CHAMPAIGN COUNTY, ILLINOIS

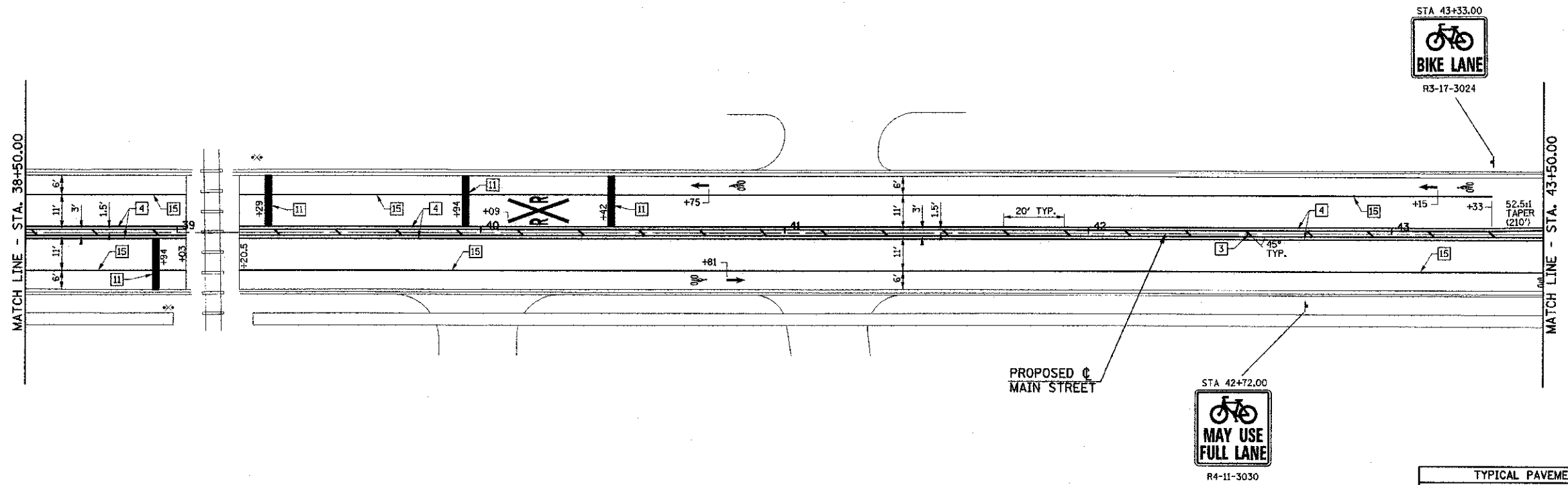
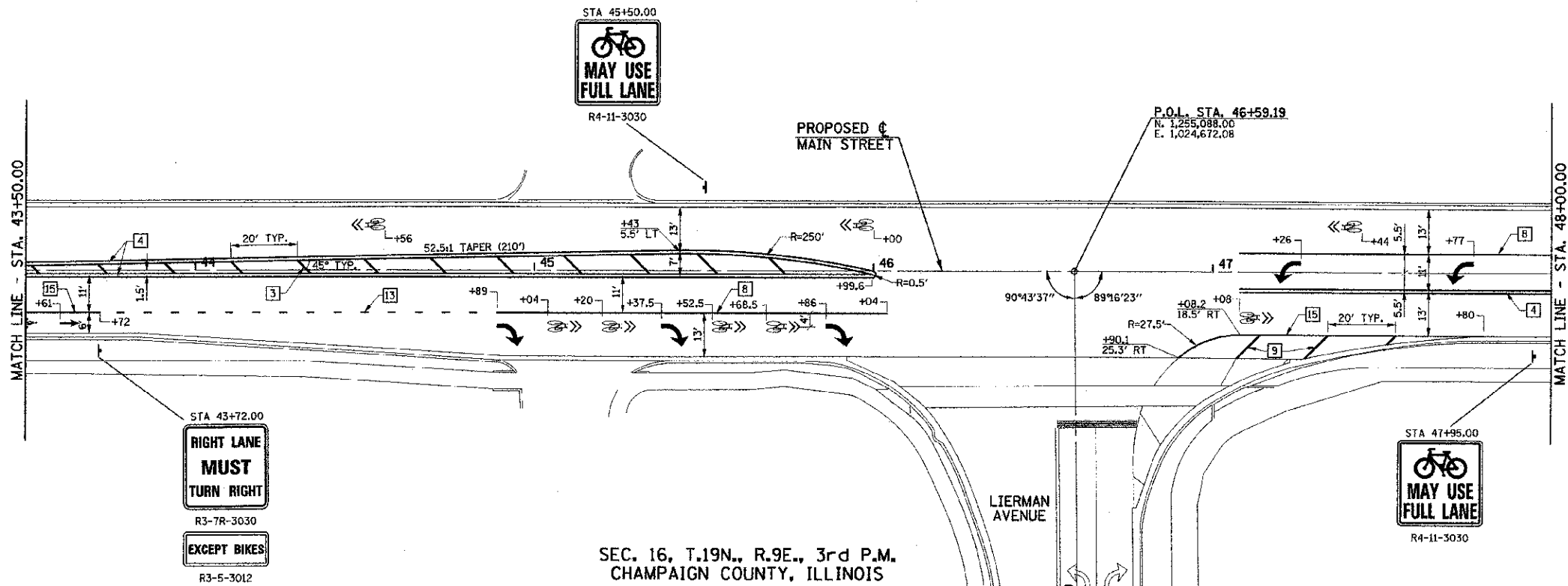

TYPICAL PAVEMENT MARKING AND SIGNING LEGEND	
1 4" SKIP-DASH (YELLOW)	9 12" DIAGONAL (WHITE)
2 4" SOLID (YELLOW)	10 6" CROSSWALK (WHITE)
3 12" DIAGONAL (YELLOW)	11 24" STOP BAR (WHITE)
4 4" DOUBLE (YELLOW) (NARROW)	12 8" SOLID (WHITE)*
5 4" DOUBLE (YELLOW) (WIDE)*	13 4" LANE LINE EXTENSIONS (WHITE)
6 6" DIAGONAL (YELLOW)*	14 12" CROSSWALK (WHITE)*
7 4" SKIP-DASH (WHITE)*	15 6" SOLID (WHITE)
8 4" SOLID (WHITE)	16 6" LANE LINE EXTENSIONS (WHITE)
*NOT USED	— METAL POST - TYPE B

FILE NAME = p:\10070062\_Urbana - Main Street\TEP\Plans\sheet\14-pvmt-marking.dgn  
PLOT DATE = 3/8/2013 11:44:28 PM

DESIGNED - J.A.J. REVISED -  
DRAWN - D.L.M. REVISED -  
CHECKED - S.M.W. REVISED -  
DATE - 03/2013 REVISED -

STATE OF ILLINOIS  
DEPARTMENT OF TRANSPORTATION

PAVEMENT MARKING AND SIGNING PLANS

SCALE: 1"=20' SHEET NO. 50 OF 75 SHEETS STA. 38+50.00 TO STA. 48+00.00

F.A.L. RTE.	SECTION	COUNTY	TOTAL SHEETS	SHEET NO.
7124	09-00483-01-RS	CHAMPAIGN	75	50
MAIN STREET		CONTRACT NO. 91480		
FED. ROAD DIST. NO.		ILLINOIS FED. AID PROJECT		