

SEC. 10, T.19N., R.9E., 3rd P.M.  
CHAMPAIGN COUNTY, ILLINOIS

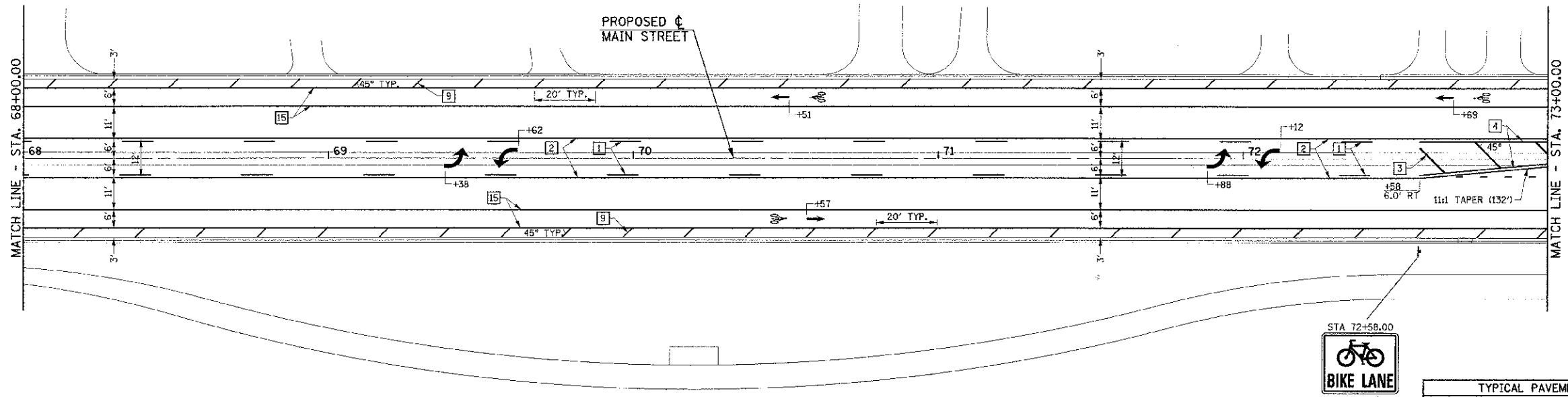

TYPICAL PAVEMENT MARKING AND SIGNING LEGEND			
1	4" SKIP-DASH (YELLOW)	9	12" DIAGONAL (WHITE)
2	4" SOLID (YELLOW)	10	6" CROSSWALK (WHITE)
3	12" DIAGONAL (YELLOW)	11	24" STOP BAR (WHITE)
4	4" DOUBLE (YELLOW) (NARROW)	12	6" SOLID (WHITE)*
5	4" DOUBLE (YELLOW) (WIDE)*	13	4" LANE LINE EXTENSIONS (WHITE)
6	6" DIAGONAL (YELLOW)*	14	12" CROSSWALK (WHITE)*
7	4" SKIP-DASH (WHITE)*	15	6" SOLID (WHITE)
8	4" SOLID (WHITE)	16	6" LANE LINE EXTENSIONS (WHITE)
*NOT USED		M METAL POST - TYPE B	

SEC. 15, T.19N., R.9E., 3rd P.M.  
CHAMPAIGN COUNTY, ILLINOIS

SEC. 10, T.19N., R.9E., 3rd P.M.  
CHAMPAIGN COUNTY, ILLINOIS

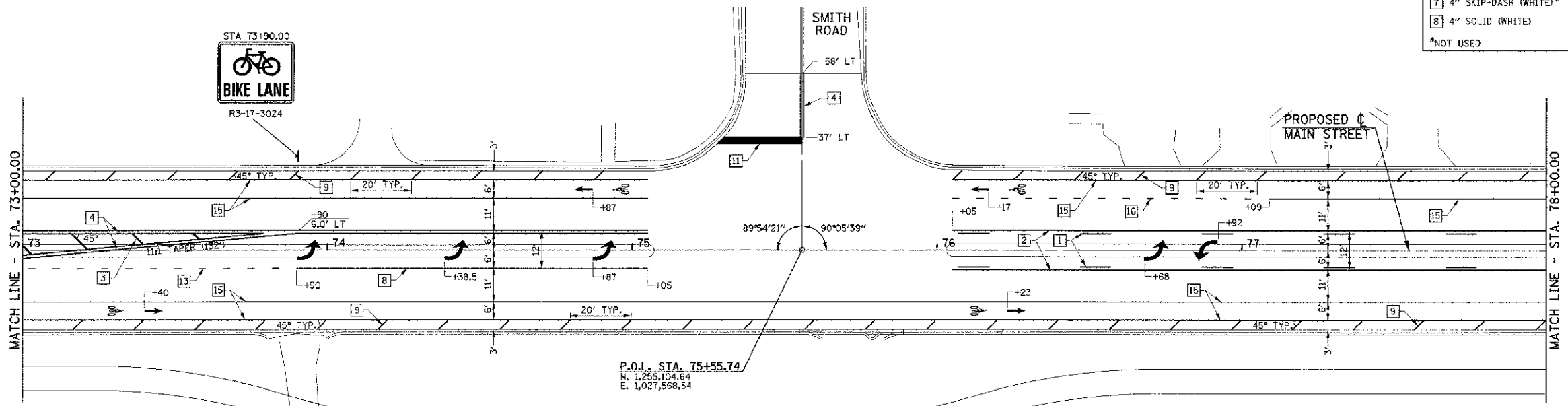

FILE NAME =  
p:\0070062\_Uroana - Main Street ITE\Plans\sheet114\pml-marking.dgn  
PLOT DATE =  
3/6/2013 11:44:28 PM

DESIGNED - J.A.J.	REVISED -
DRAWN - D.J.M.	REVISED -
CHECKED - S.M.W.	REVISED -
DATE - 03/2013	REVISED -

STATE OF ILLINOIS  
DEPARTMENT OF TRANSPORTATION

PAVEMENT MARKING AND SIGNING PLANS

SCALE: 1"=20' SHEET NO. 53 OF 75 SHEETS STA. 68+00.00 TO STA. 78+00.00

F.A.U. RTE.	SECTION	COUNTY	TOTAL SHEETS	SHEET NO.
7124	09-00483-01-RS	CHAMPAIGN	75	53
MAIN STREET		CONTRACT NO. 91480		
FED. ROAD DIST. NO.		ILLINOIS FED. AID PROJECT		