

W20-310)-36  
TO BE PLACED AT INTERSECTION  
OF REED AVE. AND LEONARD ST.

SEE SHEET 4A OF THE SPECIAL PROVISIONS  
FOR ADDITIONAL SIGNING IN THE VILLAGE  
OF JEROME.

MATCHLINE - STA. 207+00

MATCHLINE - STA. 212+00

22-070-228-021  
MCW-RD MONTVALE COMMONS LLC  
C/O SCOTT RETZLOFF

22-070-228-007  
TR. 6922 PNB  
C/O PAUL W. WANLESS

**SYMBOLS**

- IMPACT ATTENUATOR
- REMOVAL ITEMS
- TEMPORARY CONCRETE BARRIER
- TRAFFIC SIGN
- TYPE C BIDIRECTIONAL REFLECTOR
- DRUM
- FLEXIBLE DELINEATOR
- RAISED REFLECTIVE PAVEMENT MARKER
- TYPE III BARRICADE
- LIGHTS, TYPE A

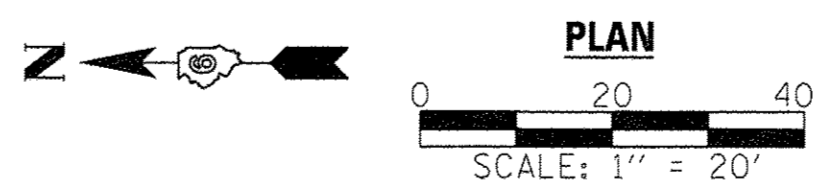

FILE NAME =	USER NAME = #USER#	DESIGNED -	REVISED -
#FILEL#		DRAWN -	REVISED -
	PLOT SCALE = #SCALE#	CHECKED -	REVISED -
	PLOT DATE = #DATE#	DATE -	REVISED -

**Allen Henderson & Associates, Inc.**  
Civil and Structural Engineers Springfield, IL.  
62703 Phone: (217)544-8033 IL Design Firm  
No. 184-001907

**STAGE CONSTRUCTION TRAFFIC DETAILS**  
**STAGE II**

SCALE: 1" = 20'    SHEET NO. 9 OF 12 SHEETS    STA.    TO STA.

F.A.U. RTE.	SECTION	COUNTY	TOTAL SHEETS	SHEET NO.
8006	10-00470-00-BR	SANGAMON	90	32
FED. ROAD DIST. NO.			ILLINOIS FED. AID PROJECT	
			CONTRACT NO. <b>93600</b>	