

ROUTE	SECTION	COUNTY	TOTAL SHEETS	SHEET NO.
T.R. 87	11-09113-00-BR	LAWRENCE	15	1
CONTRACT NO. 95693		ILLINOIS	PROJECT BROS-0101(045)	

STATE OF ILLINOIS  
DEPARTMENT OF TRANSPORTATION  
DIVISION OF HIGHWAYS  
**PLANS FOR PROPOSED  
HIGHWAY BRIDGE PROGRAM**  
SECTION 11-09113-00-BR LAWRENCE COUNTY  
PROJECT BROS-0101(045)  
JOB NO. C-97-080-12  
RUSSELL ROAD DISTRICT  
T.R. 87

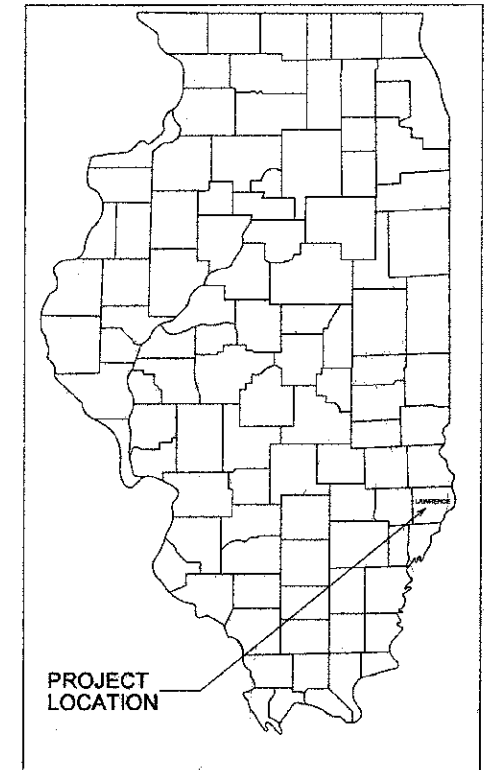

CONTRACT NO. 95693  
Joint Utility Locating Information for Excavators  
JULIE 1-800-892-0123

**INDEX OF SHEETS**

SHEET	ITEM
1	COVER SHEET
2	SUMMARY OF QUANTITIES
3	ROADWAY PLAN AND PROFILE
4	EROSION CONTROL PLAN
5	GENERAL PLAN AND ELEVATION
6	SUPERSTRUCTURE
7	SUPERSTRUCTURE DETAILS
8	STEEL RAILING, TYPE S-1
9	WEST ABUTMENT DETAILS
10	EAST ABUTMENT DETAILS
11	PILE DETAILS
12	BORING LOGS
13-15	CROSS SECTIONS

- STANDARD DRAWINGS
- STANDARD 000001-06
  - STANDARD 280001-07
  - STANDARD 515001-03
  - STANDARD 701901-02
  - STANDARD BLR 21-6
  - STANDARD BLR 22-7

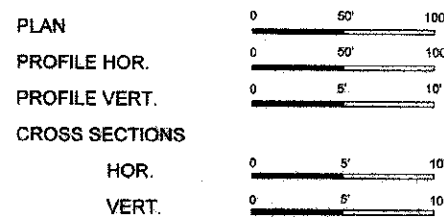

SECTION 11-09113-00-BR BEGINS STA. 1+00.00

SINGLE SPAN PRECAST PRESTRESSED CONCRETE DECK BEAM BRIDGE  
 51'-3" BK. BK. ABUTMENTS  
 STEEL H PILE / SPILLTHROUGH ABUTMENTS  
 28' DECK  
 EXISTING STRUCTURE NO. 051-3057  
 PROPOSED STRUCTURE NO. 051-3300

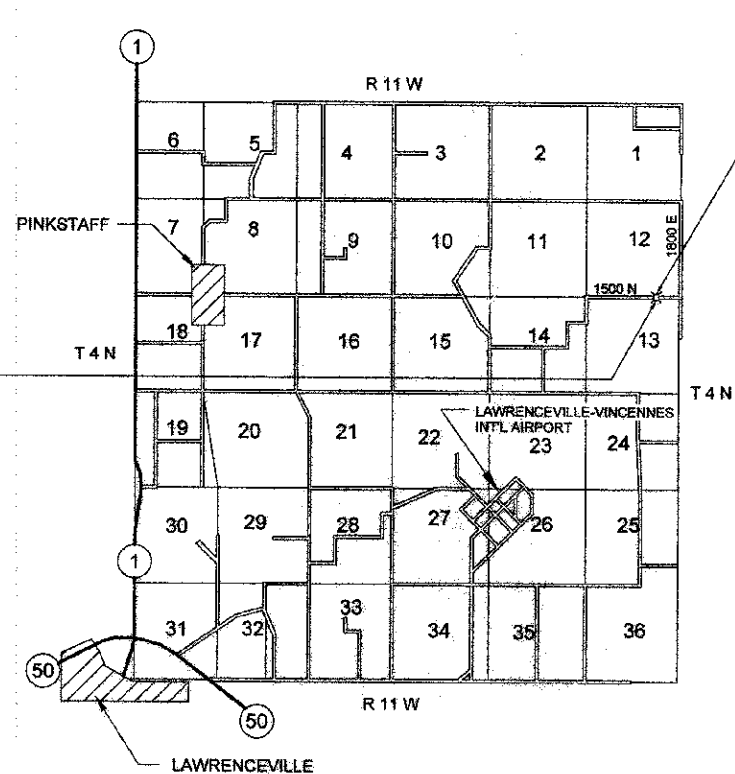

SECTION 11-09113-00-BR ENDS STA. 7+60.00

FUNCTIONAL CLASSIFICATION - RURAL LOCAL ROAD  
 ADT = 225  
 DESIGN SPEED = 30 MPH

NET LENGTH SECTION 11-09113-00-BR = 660.00 Ft. = 0.125 MI.

*Refer to Charles...*  
*11/5/12*  
*11/30/13*

**CHARLESTON ENGINEERING, INC.**  
 CONSULTING ENGINEERS  
 105 NORTH KITCHELL  
 P.O. BOX 397  
 OLNEY, ILLINOIS 62450  
 (815) 392-0738  
ILLINOIS DEPARTMENT OF PROFESSIONAL REGULATION REGISTRATION #184.003513

APPROVED 11-5 2012  
*[Signature]*  
 COUNTY ENGINEER

STATE OF ILLINOIS  
DEPARTMENT OF TRANSPORTATION

PASSED 1-7 2013  
*Maurice Kasil*  
 DISTRICT SEVEN ENGINEER OF  
 LOCAL ROADS AND STREETS

Releasing For  
 Bid Based on  
 Limited Review 1-7 2013  
*[Signature]*  
 DEPUTY DIRECTOR OF HIGHWAYS  
 REGION FOUR ENGINEER