

ROUTE	SECTION	COUNTY	TOTAL SHEETS	SHEET NO.
FAS 1722	11-00118-00-BR	RICHLAND	16	3
CONTRACT NO. 95705		ILLINOIS		

SCALES:
 1" = 50' HOR
 1" = 5' VER

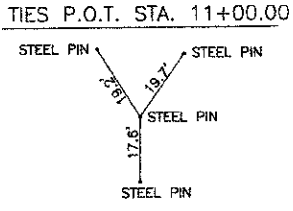
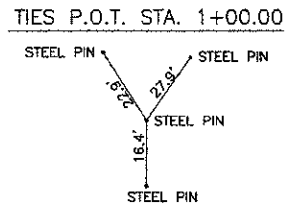

SECTION 11-00118-00-BR BEGINS STA. 2+75.00

SECTION 11-00118-00-BR ENDS STA. 10+50.00

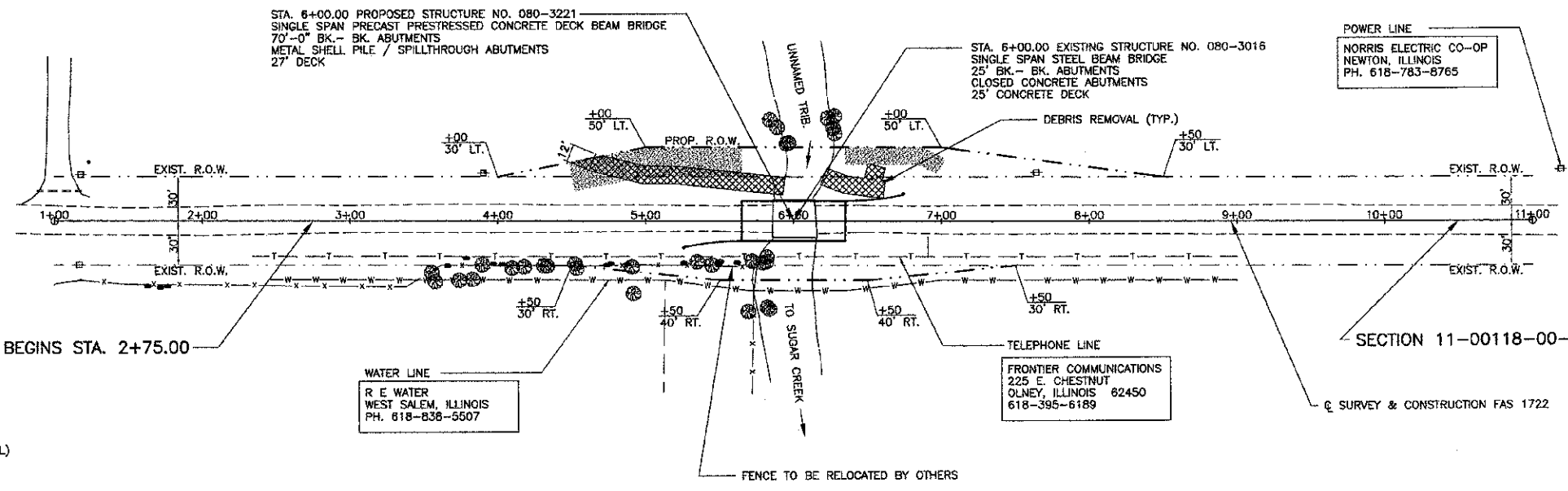
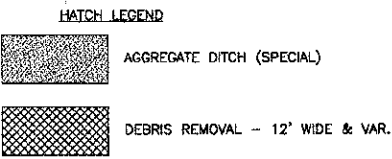

DONOVAN O'DONNELL TRUST

LYNDEN & BONITA BALDING

TRANSITION EXISTING ROADWAY TO PROPOSED ROADWAY
 STA. 2+25 TO 2+75 AND STA. 10+50 TO 11+00
 QUANTITIES FOR THE ABOVE ARE INCLUDED IN THOSE LISTED

B.M. LT. STA. 3+90
 SPIKE IN P.P.
 ELEV. 435.54

