

| * SECTION | COUNTY | TOTAL SHEETS | SHEET NO. |
|-------------------|--------|--------------|-----------|
| ** 11-00052-00-BT | SHELBY | 28 | 1 |

• PHASE 7
 •• GENERAL DACEY TRAIL

STATE OF ILLINOIS DEPARTMENT OF TRANSPORTATION PLANS FOR PROPOSED FHWA – TE CITY OF SHELBYVILLE IL SHELBY COUNTY

INDEX OF SHEETS

SEE SHEET 2 OF 28 SHEETS

LIST OF STANDARDS

SEE SHEET 2 OF 28 SHEETS

SECTION 11-00052-00-BT
 GENERAL DACEY TRAIL PHASE 7
 PROJECT NO. TE-00D7 (063)
 JOB NUMBER C-97-063-13

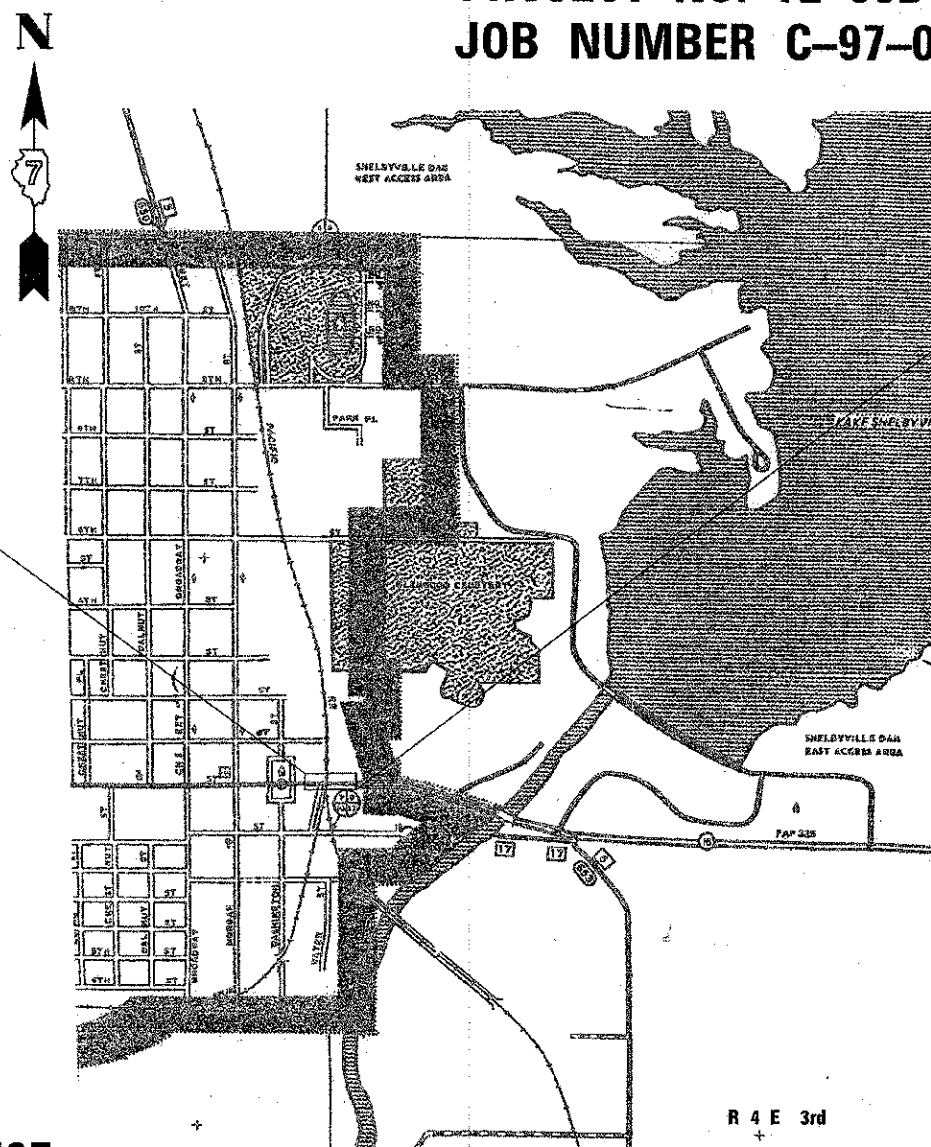
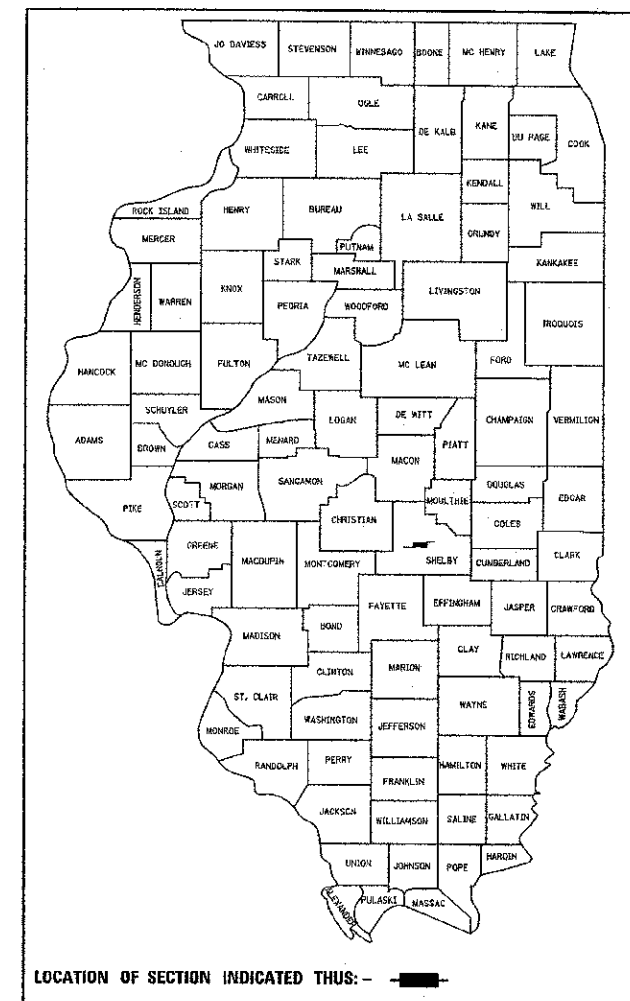

**BEGIN PROJECT
 STA 7+00**

**END PROJECT
 STA 13+50**

**PROJECT LENGTH
 650 FEET = 0.123 MILES**

**PLANS PREPARED BY:
 SHELBY ENGINEERING
 1010 E. NORTHLAND DR.
 SHELBYVILLE ILLINOIS 62565
 217-820-2278**

J.U.L.I.E.
 JOINT UTILITY LOCATION INFORMATION FOR EXCAVATION
 1-800-892-0123

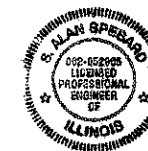

PLANS PREPARED BY:
S. Alan Spesard
S. ALAN SPESARD DATE
 LICENSED PROFESSIONAL ENGINEER OF IL
 NUMBER 062-052965
 EXPIRATION DATE 11-30-2013

CITY OF SHELBYVILLE
 APPROVED *March 28 2013*
Roy Shuff
 MAYOR, CITY OF SHELBYVILLE ILLINOIS

PASSED *4-16 2013*
Maurice K. Kroll
 DISTRICT SEVEN ENGINEER OF
 LOCAL ROAD AND STREETS

APPROVED *4-16 2013*
Roger L. Amshel
 DEPUTY DIRECTOR OF HIGHWAYS
 REGION FOUR ENGINEER

RELEASING FOR
 BID BASED ON
 LIMITED REVIEW

STATE OF ILLINOIS
 DEPARTMENT OF TRANSPORTATION

CONTRACT NUMBER 95707

R 4 E 3rd

SUMMARY OF QUANTITIES

| PAY ITEM NUMBER | DESCRIPTION | QUANTITY | UNIT |
|-----------------|---|----------|--------|
| 20200100 | EARTH EXCAVATION | 32 | CU YD |
| 20400800 | FURNISHED EXCAVATION | 37 | CU YD |
| 20800150 | TRENCH BACKFILL | 3 | CU YD |
| 25000400 | NITROGEN FERTILIZER NUTRIENT | 2 | POUND |
| 25000500 | PHOSPHORUS FERTILIZER NUTRIENT | 2 | POUND |
| 25000600 | POTASSIUM FERTILIZER NUTRIENT | 2 | POUND |
| 25200100 | SODDING | 66 | SQ YD |
| 25200200 | SUPPLEMENTAL WATERING | 6 | UNIT |
| 28000400 | PERIMETER EROSION BARRIER | 233 | FOOT |
| 28000500 | INLET AND PIPE PROTECTION | 1 | EACH |
| 42300400 | PORTLAND CEMENT CONCRETE DRIVEWAY PAVEMENT, 8 INCH | 45 | SQ YD |
| 42400200 | PORTLAND CEMENT CONCRETE SIDEWALK 5 INCH | 5340 | SQ FT |
| 42400800 | DETECTABLE WARNINGS | 60 | SQ FT |
| 44000100 | PAVEMENT REMOVAL | 335 | SQ YD |
| 44000200 | DRIVEWAY PAVEMENT REMOVAL | 68 | SQ YD |
| 44000500 | COMBINATION CURB AND GUTTER REMOVAL | 523 | FOOT |
| 44000600 | SIDEWALK REMOVAL | 3365 | SQ FT |
| 44003100 | MEDIAN REMOVAL | 160 | SQ FT |
| 550A0360 | STORM SEWERS, CLASS A, TYPE 2 15" | 6 | FOOT |
| Δ 56500300 | DOMESTIC METER VAULTS TO BE ADJUSTED | 1 | EACH |
| 60218500 | MANHOLES, TYPE A, 4'- DIAMETER, TYPE 3 FRAME AND GRATE | 1 | EACH |
| 60255800 | MANHOLES TO BE ADJUSTED WITH NEW TYPE 1 FRAME, CLOSED LID | 2 | EACH |
| 60605000 | COMBINATION CONCRETE CURB AND GUTTER, TYPE B-6.24 | 612 | FOOT |
| 60618300 | CONCRETE MEDIAN SURFACE, 4 INCH | 116 | SQ FT |
| 67100100 | MOBILIZATION | 1 | L SUM |
| 70102625 | TRAFFIC CONTROL AND PROTECTION, STANDARD 701606 | 1 | L SUM |
| 70102640 | TRAFFIC CONTROL AND PROTECTION, STANDARD 701801 | 1 | L SUM |
| 70103815 | TRAFFIC CONTROL SURVEILLANCE | 8 | CAL DA |
| Δ 78005100 | EPOXY PAVEMENT MARKING - LETTERS AND SYMBOLS | 183.6 | SQ FT |
| Δ 78005110 | EPOXY PAVEMENT MARKING - LINE 4" | 513 | FOOT |
| Δ 78005150 | EPOXY PAVEMENT MARKING - LINE 12" | 93 | FOOT |
| Δ 78005180 | EPOXY PAVEMENT MARKING - LINE 24" | 93 | FOOT |
| 78300100 | PAVEMENT MARKING REMOVAL | 525 | SQ FT |
| Z0048665 | RAILROAD PROTECTIVE LIABILITY INSURANCE | 1 | L SUM |
| X6028300 | INLETS TO BE REMOVED, SPECIAL | 1 | EACH |
| XX003219 | UNIT PAVERS | 2424 | SQ FT |
| XX008864 | INSTALL SIGN | 1 | EACH |

Δ SPECIALTY ITEMS

INDEX OF PLANS

| | |
|--|---------|
| COVER SHEET..... | 1 |
| SUMMARY OF QUANTITIES, INDEXES, LIST OF STANDARDS..... | 2 |
| GENERAL NOTES..... | 3 |
| EXISTING TYPICAL SECTIONS..... | 4 |
| PROPOSED TYPICAL SECTIONS..... | 5 - 6 |
| REMOVAL SCHEDULES..... | 7 |
| DRAINAGE SCHEDULES..... | 8 |
| EROSION CONTROL SCHEDULES..... | 9 |
| PROPOSED SURFACING SCHEDULES..... | 10 |
| UNIT PAVERS AND LOOKING FOR LINCOLN SIGN DETAILS..... | 11 |
| DRIVEWAY DETAILS..... | 12-14 |
| PAVEMENT MARKING SCHEDULES..... | 15 |
| DEMOLITION PLAN SHEETS..... | 16 - 19 |
| PROPOSED PLAN SHEETS..... | 20 - 23 |
| PROFILE SHEET..... | 24 |
| CROSS SECTION SHEETS..... | 25 - 28 |

INDEX OF STANDARDS

| STANDARD NUMBER | STANDARD NAME |
|-----------------|---|
| 000001-06 | STANDARD SYMBOLS, ABBREVIATIONS AND PATTERNS |
| 001001-02 | AREA OF REINFORCEMENT BARS |
| 280001-07 | TEMPORARY EROSION CONTROL SYSTEMS |
| 420001-07 | PAVEMENT JOINTS |
| 424001-07 | PERPENDICULAR CURB RAMPS FOR SIDEWALKS |
| 602401-03 | MANHOLE TYPE A |
| 602601-02 | PRECAST REINFORCED CONCRETE FLAT SLAB TOP |
| 602701-02 | MANHOLE STEPS |
| 604001-03 | FRAME AND LIDS TYPE 1 |
| 604006-04 | FRAME AND GRATE TYPE 3 |
| 606001-05 | CONCRETE CURB TYPE B AND COMBINATION CONCRETE CURB & GUTTER |
| 701006-04 | OFF-RD OPERATIONS, 2L 2W, 15' TO 24' FROM PAVEMENT EDGE |
| 701301-04 | LANE CLOSURE, 2L 2W SHORT TIME OPERATIONS |
| 701311-03 | LANE CLOSURE 2L 2W MOVING OPERATIONS DAY ONLY |
| 701806-08 | URBAN LANE CLOSURE, MULTILANE, 2W WITH MOUNTABLE MEDIAN |
| 701801-05 | SIDEWALK, CORNER OR CROSSWALK CLOSURE |
| 701901-02 | TRAFFIC CONTROL DEVICES |
| 780001-03 | TYPICAL PAVEMENT MARKINGS |

| | | | |
|------------------------------|------------------|----------------|----------------|
| QUANTITIES, INDEX, STANDARDS | | | |
| SCALE: N/A | APPROVED BY: SAS | DATE: 01/31/13 | DRAWN BY: CRS |
| | | | REVISED: KPP |
| 11-00052-00-BT | | | DRAWING NUMBER |

GENERAL NOTES

WHEREVER IN THE PLANS OR SPECIFICATIONS THE TERM STANDARD SPECIFICATIONS IS USED, IT SHALL BE UNDERSTOOD BY THE CONTRACTOR TO MEAN THE STANDARD SPECIFICATIONS FOR ROAD AND BRIDGE CONSTRUCTION AS PREPARED BY THE DEPARTMENT OF TRANSPORTATION OF THE STATE OF ILLINOIS AND ADOPTED JANUARY 1, 2012.

ALL ELEVATIONS SHOWN ARE ASSUMED.

WHERE SECTION, SUB-SECTION MARKERS, OR U.S. ARMY CORPS OF ENGINEER MARKERS ARE ENCOUNTERED, THE ENGINEER SHALL BE NOTIFIED BEFORE SUCH MONUMENTS ARE REMOVED. THE CONTRACTOR SHALL PROTECT AND CAREFULLY PRESERVE ALL PROPERTY MARKERS AND MONUMENTS UNTIL THE DEPARTMENT AND AUTHORIZED AGENT OR LAND SURVEYOR HAS WITNESSED OR OTHERWISE REFERENCED THEIR LOCATION.

ANY REFERENCE TO STANDARDS THROUGHOUT THE PLANS SHALL BE INTERPRETED TO BE THE LATEST STANDARDS OF THE DEPARTMENT AS SHOWN ON THE SCHEDULE OF THE STANDARD DRAWINGS ON THE COVER SHEET.

EXISTING ROAD SIGNS THAT CONFLICT WITH CONSTRUCTION OPERATIONS SHALL BE COVERED OR REMOVED AS DIRECTED BY THE ENGINEER, THIS WORK WILL NOT BE PAID FOR SEPARATELY BUT SHALL BE INCLUDED IN THE COST OF THE CONTRACT PAY ITEMS AND NO ADDITIONAL COMPENSATION WILL BE ALLOWED THE CONTRACTOR.

EXCEPT WHERE DESIGNATED OTHERWISE, THE LOCATIONS AND/OR DEPTHS OF UNDERGROUND UTILITIES SHOWN HAVE BEEN TAKEN FROM INFORMATION FURNISHED BY THE UTILITY OWNERS & MUST BE CONSIDERED APPROXIMATE. THE CONTRACTOR SHALL BE RESPONSIBLE FOR LOCATING ALL UNDERGROUND UTILITIES. CONTACT J.U.L.I.E., PHONE 800-892-0123, AND ALL UTILITY COMPANIES PRIOR TO DIGGING.

THE CONTRACTOR SHALL NOTIFY ALL UTILITY COMPANIES 48 HOURS PRIOR TO EXCAVATION OPERATIONS.

UTILITY COMPANIES MAY BE ADJUSTING THEIR FACILITIES AT THE TIME OF CONSTRUCTION OF THIS PROJECT. THE CONTRACTOR SHALL COOPERATE WITH THESE ORGANIZATIONS WHILE THEY PERFORM THEIR WORK.

GRADING SHALL BE DONE BY HAND AROUND LIGHT POLES, UTILITY POLES, SIGN POSTS, SHRUBS, TREES, OR OTHER NATURAL OR MANMADE OBJECTS WHERE SHALLOW FILLS OR CUTS ARE ADJACENT TO THESE ITEMS. IT IS THE INTENT THAT THE LIMITS OF CONSTRUCTION BE SUCH TO PRESERVE IN THE ORIGINAL STATE AS MUCH AREA OF TEMPORARY EASEMENT AS POSSIBLE. THE DECISION AS TO ITEMS TO REMAIN IN PLACE SHALL BE DIRECTED BY THE ENGINEER. THIS WORK WILL NOT BE PAID FOR SEPARATELY, AND NO ADDITIONAL COMPENSATION WILL BE ALLOWED.

UTILITIES:

THE ONLY UTILITIES KNOWN TO BE ON THIS PROJECT ARE AS FOLLOWS:

- 1. TELEPHONE CONSOLIDATED COMMUNICATIONS (**)(***)
121 SOUTH 17TH STREET
MATTOON, ILLINOIS 61938
217-234-9971
- 2. GAS AMEREN CIPS (**)(***)
711 SOUTH 9TH STREET
MATTOON, ILLINOIS 61938
- 3. POWER AMEREN CIPS (**)(***)
420N 2400 EAST ROAD
PANA, ILLINOIS 62557
- 4. WATER CITY OF SHELBYVILLE ILLINOIS (**)(***)
151 SOUTH MORGAN STREET
SHELBYVILLE, ILLINOIS 62562
- 5. SEWER CITY OF SHELBYVILLE ILLINOIS (**)(***)
151 SOUTH MORGAN STREET
SHELBYVILLE, ILLINOIS 62565

(**) J.U.L.I.E. MEMBER
 (***) POSSIBLE RELOCATION DURING CONSTRUCTION
 FOR JOINT UTILITY INFORMATION CALL, 1-800-892-0123

BENCHMARKS

BENCHMARK # 2: "M" IN MUELLER ON FIRE HYDRANT ON WEST SIDE OF SHELBY COUNTY VISITORS CENTER STA 7+23 ELEVATION 648.32

BENCHMARK # 3: TOP OF NORTH BOLT ON WEST END OF RETAINING WALL ATTACHING HAND RAIL TO WALL STA 8+33 ELEVATION 645.61

BENCHMARK # 5: TOP OF SOUTH HAND RAILING ANCHOR BOLT ON EAST END OF RETAINING WALL STA 9+66 ELEVATION 637.63

| | | |
|----------------------|------------------|----------------|
| GENERAL NOTES | | |
| SCALE: N/A | APPROVED BY: 5AS | DRAWN BY: CRS |
| DATE: 01/31/13 | | REVISED: KCP |
| 11-00052-00-BT | | DRAWING NUMBER |

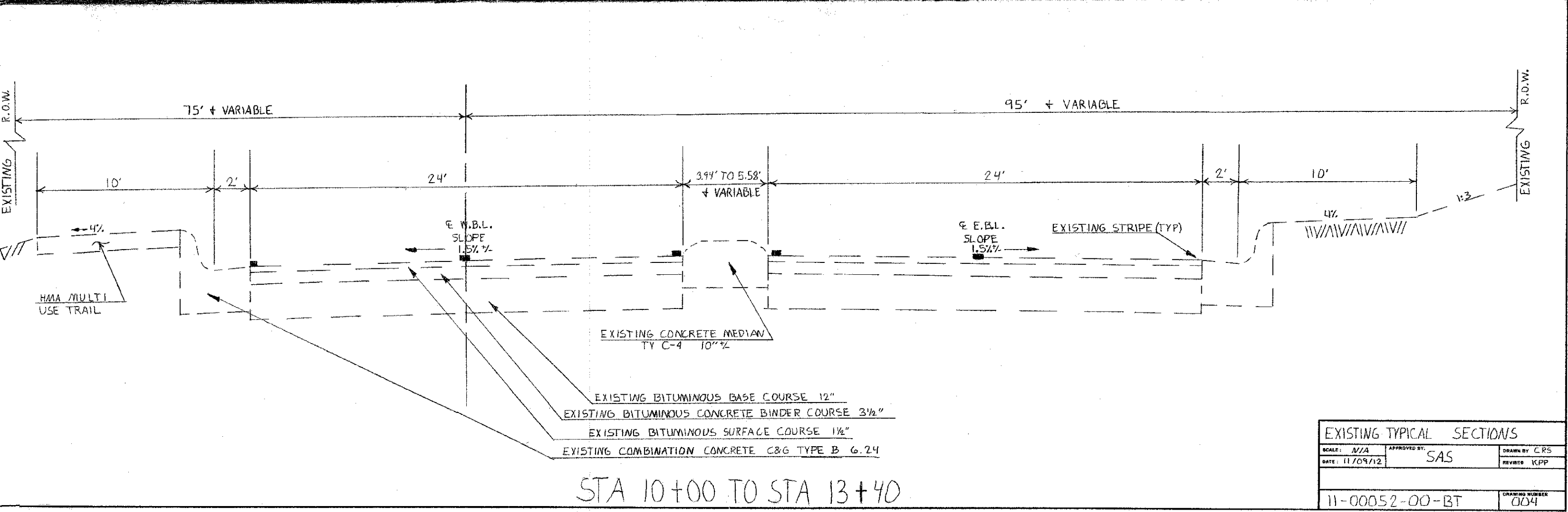
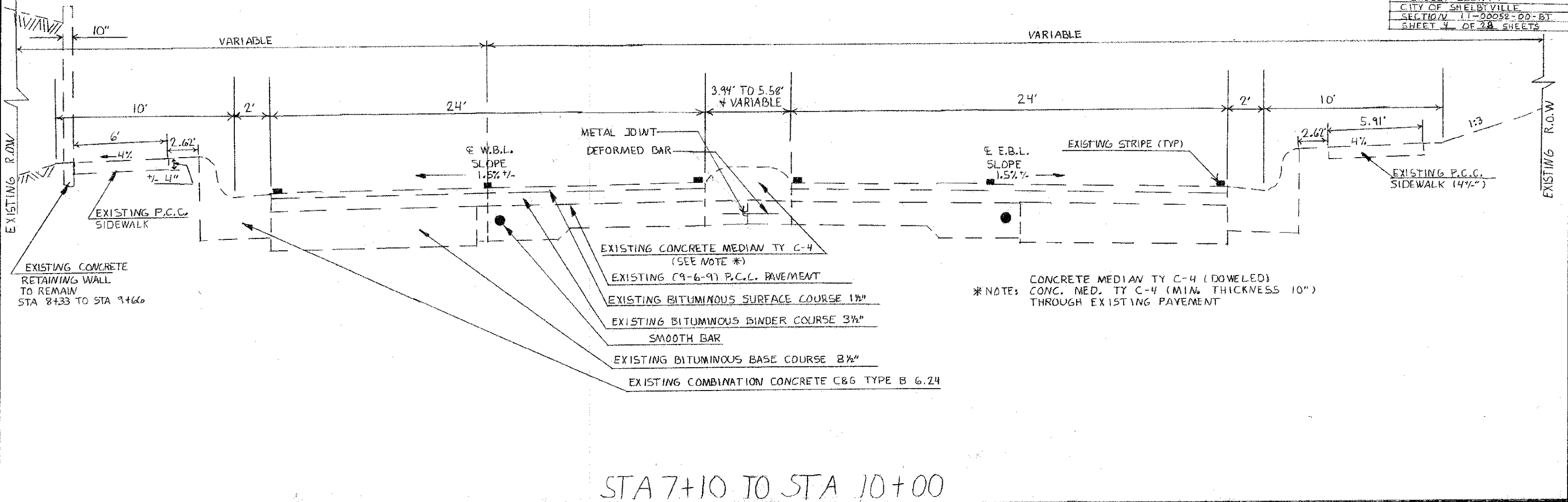

| | | | |
|---------------------------|------------------|---------------|---------------------|
| EXISTING TYPICAL SECTIONS | | | |
| SCALE: N/A | APPROVED BY: SAS | DRAWN BY: CRS | |
| DATE: 11/09/12 | | REVISED: KPP | |
| 11-00052-00-BT | | | DRAWING NUMBER: 004 |

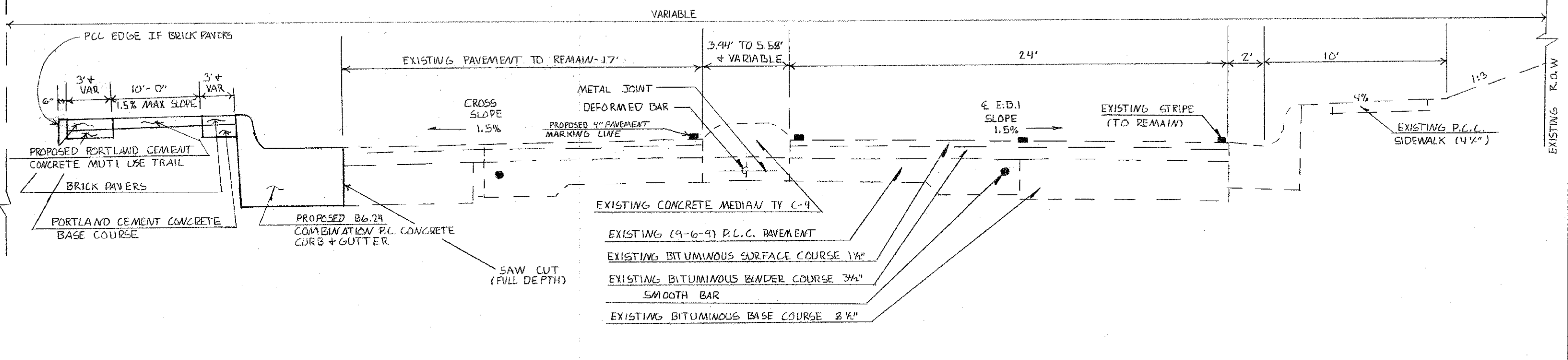

STA 7+10 TO STA 8+20

| | | |
|---------------------------|-----------------------|---------------|
| SCALE: N/A | APPROVED BY: SAS | DRAWN BY: CRS |
| DATE: 02/2/13 | | REVISED: KFP |
| PROPOSED TYPICAL SECTIONS | | |
| 11-00052-00-BT | DRAWING NUMBER P50153 | |

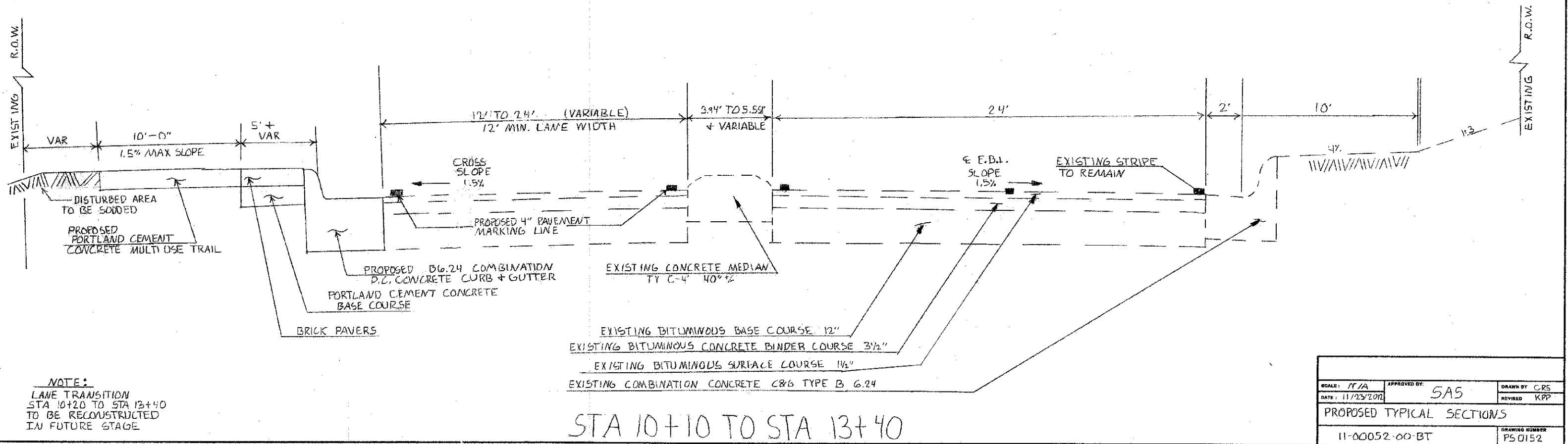
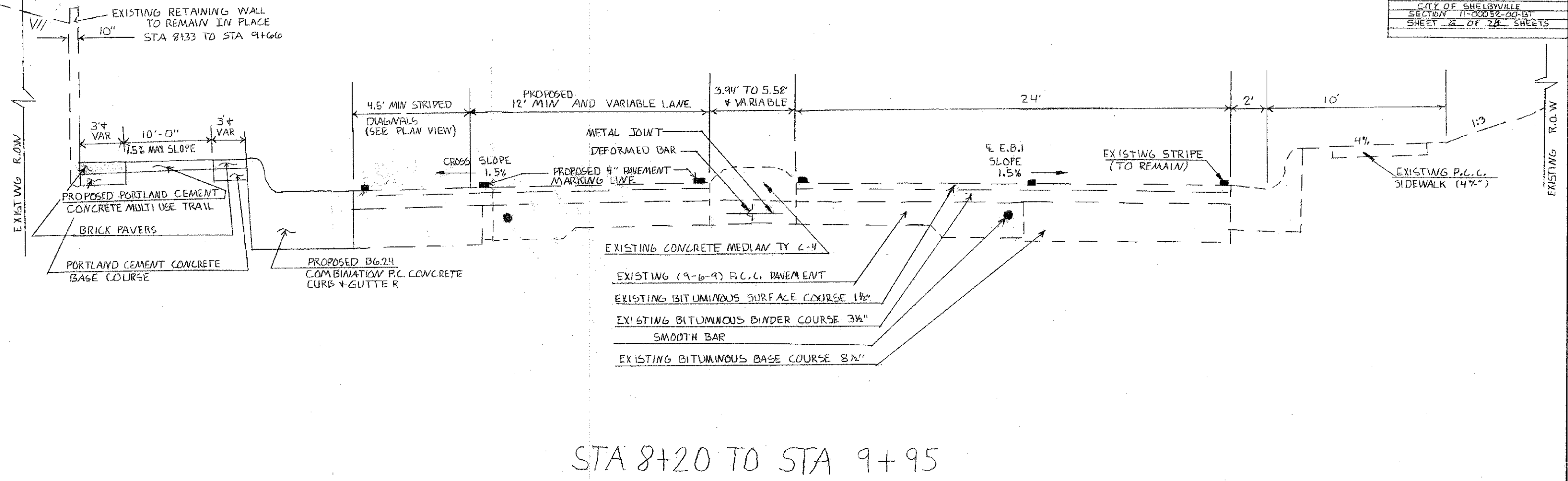

NOTE:
 LANE TRANSITION
 STA 10+20 TO STA 13+40
 TO BE RECONSTRUCTED
 IN FUTURE STAGE

| | | |
|---------------------------|------------------|------------------------|
| SCALE: N/A | APPROVED BY: SAS | DRAWN BY: CRS |
| DATE: 11/25/2011 | | REVISED: KPP |
| PROPOSED TYPICAL SECTIONS | | |
| 11-00052-00-BT | | DRAWING NUMBER: PS0152 |

COMBINATION CURB AND GUTTER REMOVAL

| STATION | STATION | LENGTH |
|---------|--------------|-----------------|
| 7+10 | 7+55 | 65 FOOT |
| 7+80 | 8+00 | 35 FOOT |
| 8+20 | 9+00 | 95 FOOT |
| 9+00 | 9+96 | 96 FOOT |
| 10+10 | 13+40 | 232 FOOT |
| | | |
| | TOTAL | 523 FOOT |

DRIVEWAY PAVEMENT REMOVAL

| TYPE | STATION | WIDTH | LENGTH | QUANTITY |
|-------|-----------|-------|--------------|-------------------|
| C.E. | STA 7+67 | 22' | 11' | 22 SQ. YD. |
| ALLEY | STA 8+10 | 17' | 10' | 19 SQ. YD. |
| P.E. | STA 12+53 | 22' | 11' | 27 SQ. YD. |
| | | | | |
| | | | TOTAL | 68 SQ. YD. |

MEDIAN REMOVAL

| STATION | STATION | WIDTH | AREA |
|---------|---------|--------------|--------------------|
| 7+80 | 8+00 | 8' | 160 SQ. FT. |
| | | | |
| | | TOTAL | 160 SQ. FT. |

PAVEMENT REMOVAL

| STATION | STATION | WIDTH | AREA |
|---------|---------|--------------|--------------------|
| 7+10 | 8+00 | 8 | 80 SQ. YD. |
| 8+00 | 9+00 | 7.5' | 73 SQ. YD. |
| 9+00 | 9+67 | 6.5' | 48 SQ. YD. |
| 9+67 | 9+86 | 8.5 | 18 SQ. YD. |
| 10+10 | 11+50 | 7' TO 12' | 43 SQ. YD. |
| 11+50 | 13+40 | 0' TO 7' | 73 SQ. YD. |
| | | | |
| | | TOTAL | 335 SQ. YD. |

SIDEWALK REMOVAL

| STATION | STATION | WIDTH | AREA |
|---------|---------|--------------|---------------------|
| 7+20 | 7+55 | 5 | 175 SQ. FT. |
| 8+20 | 9+00 | 5' | 400 SQ. FT. |
| 9+00 | 9+86 | 5' | 430 SQ. FT. |
| 10+10 | 10+20 | 6' | 60 SQ. FT. |
| 10+20 | 12+43 | 10' | 2230 SQ. FT. |
| 12+63 | 12+70 | 10' | 70 SQ. FT. |
| | | | |
| | | TOTAL | 3365 SQ. FT. |

REMOVAL SCHEDULES

| | | |
|----------------|------------------|----------------|
| SCALE: N/A | APPROVED BY: SAS | DRAWN BY: CRZ |
| DATE: 01/3/13 | | REVISED: KFP |
| 11-00052-00-BT | | DRAWING NUMBER |

INLETS TO BE REMOVED SPECIAL

| LOCATION | QUANTITY |
|--------------|-----------------|
| STA 9+58 | 1.0 EACH |
| <hr/> | |
| TOTAL | 1.0 EACH |

MANHOLES TO BE ADJUSTED WITH A NEW TYPE 1 FRAME, CLOSED LID

| LOCATION | QUANTITY |
|--------------|-----------------|
| STA 7+27 | 1.0 EACH |
| STA 9+58 | 1.0 EACH |
| <hr/> | |
| TOTAL | 2.0 EACH |

DOMESTIC METER VAULTS TO BE ADJUSTED

| LOCATION | QUANTITY |
|--------------|-----------------|
| STA 7+75 | 1.0 EACH |
| <hr/> | |
| TOTAL | 1.0 EACH |

TRENCH BACKFILL

| LOCATION | QUANTITY |
|--------------|------------------|
| STA 9+58 | 3.0 CUD |
| <hr/> | |
| TOTAL | 3.0 CU YD |

MANHOLES, TYPE A 4' DIAMETER, TYPE 3 FRAME AND GRATE

| LOCATION | QUANTITY |
|--------------|-----------------|
| STA 9+58 | 1.0 EACH |
| <hr/> | |
| TOTAL | 1.0 EACH |

STORM SEWERS, CLASS A TYPE 2 15"

| LOCATION | QUANTITY |
|--------------|-----------------|
| STA 9+58 | 6.0 FOOT |
| <hr/> | |
| TOTAL | 6.0 FOOT |

Earthwork Schedule

| Station to Station | Location | Earth Excavation | Earth Excavation (Adjusted for Shrinkage) | Embankment | Earth Balance-Waste(+) or Shortage(-) |
|--------------------|---------------|------------------|---|------------|---------------------------------------|
| 7+10 to 10+00 | West Approach | 15 | 0 | 16 | (-) 16 |
| 10+10 to 13+40 | East Approach | 17 | 0 | 21 | (-) 21 |
| Total: | | 32 | 0 * | 37 | (-)37 ** |

Notes: All quantities are in cubic yards.

No Earth Excavation used in Furnished Excavation. *

Furnished Excavation Required. **

| | | |
|------------------|------------------|----------------|
| DRAINAGE | | |
| SCALE: N/A | APPROVED BY: SAS | DRAWN BY: CRS |
| DATE: 01/3/13 | | REVISED: KPP |
| SCHEDULES | | |
| 11-00052-00-BT | | DRAWING NUMBER |

INLET AND PIPE PROTECTION

| LOCATION | QUANTITY |
|--------------|-----------------|
| STA 9+58 | 1.0 EACH |
| ----- | |
| TOTAL | 1.0 EACH |

SODDING

| LOCATION | WIDTH | QUANTITY |
|------------------------|------------|-------------------|
| STA 10+10 TO STA 11+70 | 0 TO 7 FT. | 66 SQ. YD. |
| ----- | | ----- |
| TOTAL | | 66 SQ. YD. |

PERIMETER EROSION BARRIER

| LOCATION | QUANTITY |
|-----------------------|-----------------|
| STA10+10 TO STA 12+43 | 233 FOOT |
| ----- | |
| TOTAL | 233 FOOT |

PERIMETER EROSION BARRIER

PERIMETER EROSION BARRIER SHALL BE PLACED AT LOCATIONS AS DIRECTED BY THE ENGINEER.

THE QUANTITY IN THE PLANS IS ESTIMATED TO ESTABLISH A CONTRACT UNIT PRICE. FINAL PAYMENT WILL BE MADE BASED UPON THE AMOUNT ORDERED AND INSTALLED.

| | | |
|------------------------|------------------|----------------|
| EROSION CONTROL | | |
| SCALE: N/A | APPROVED BY: SAG | DRAWN BY: CRS |
| DATE: 01/31/12 | | REVISED: KPP |
| SCHEDULES | | |
| 11-00052-00-BT | | DRAWING NUMBER |

CONCRETE MEDIAN SURFACE 4"

| STATION | STATION | WIDTH | AREA |
|---------|---------|-------|-------------|
| 12+63 | 13+40 | 10' | 116 SQ. FT. |
| | | ----- | ----- |
| | | TOTAL | 116 SQ. FT. |

PORTLAND CEMENT CONCRETE SIDEWALK 5 INCH

| STATION | STATION | WIDTH | AREA |
|---------|---------|-------|--------------|
| 7+10 | 7+55 | 10' | 450 SQ. FT. |
| 7+57 | 7+78 | 10' | 210 SQ. FT. |
| 7+80 | 8+00 | 10' | 200 SQ. FT. |
| 8+02 | 8+19 | 10' | 170 SQ. FT. |
| 8+21 | 9+66 | 10' | 1450 SQ. FT. |
| 9+66 | 9+92 | 10' | 260 SQ. FT. |
| 10+10 | 12+43 | 10' | 2330 SQ. FT. |
| 12+43 | 12+63 | 10' | 200 SQ. FT. |
| 12+63 | 12+70 | 10' | 70 SQ. FT. |
| | | ----- | ----- |
| | | TOTAL | 5340 SQ. FT. |

COMBINATION CONCRETE CURB AND GUTTER TYPE B 6.24

| STATION | STATION | LENGTH | |
|---------|---------|----------|----------|
| 7+10 | 7+57 | 84 FOOT | |
| 7+78 | 8+02 | 46 FOOT | |
| 8+19 | 9+00 | 60 FOOT | |
| 9+00 | 9+92 | 92 FOOT | |
| 10+10 | 13+40 | 330 FOOT | |
| | | ----- | |
| | | TOTAL | 612 FOOT |

DETECTABLE WARNINGS

| STATION | STATION | WIDTH | AREA |
|---------|---------|-------|------------|
| 7+10 | 7+12 | 10' | 20 SQ. FT. |
| 9+90 | 9+92 | 10' | 20 SQ. FT. |
| 10+10 | 10+12 | 10' | 20 SQ. FT. |
| | | ----- | ----- |
| | | TOTAL | 60 SQ. FT. |

| | | |
|--------------------|---------------------|------------------|
| PROPOSED SURFACING | | |
| SCALE: N/A | APPROVED BY: SAB | DRAWN BY: CRS |
| DATE: 01/27/13 | | REVISED: KPP |
| SCHEDULES | | |
| 11-00052-00-BT | | DRAWING NUMBER |

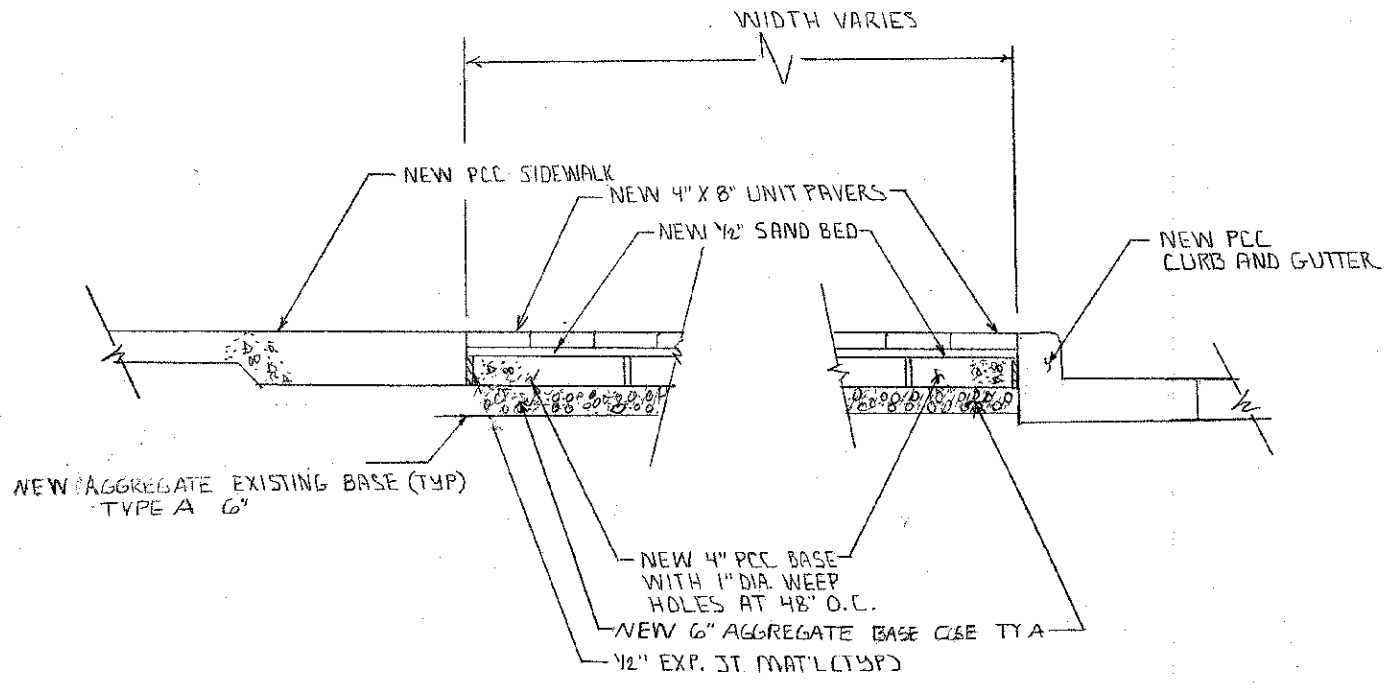

TYPICAL UNIT PAVER DETAIL
 NO SCALE

NOTES:
 SEE SPECIAL PROVISIONS
 SIGN TO BE SUPPLIED TO JOBSITE BY OTHERS
 CLASS SI CONCRETE TO BE USED THROUGH OUT

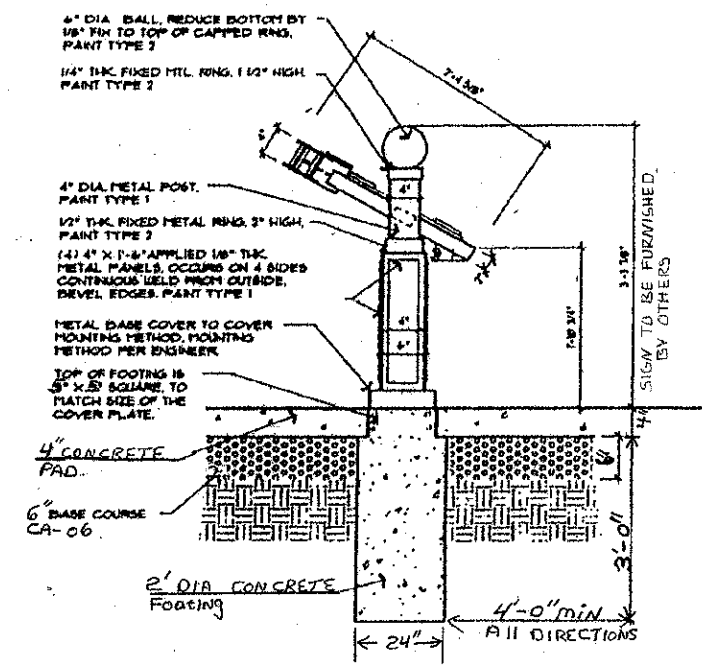

Side Elevation

LOOKING FOR LINCOLN SIGN
 STA 7+98 LEFT

UNIT PAVERS

| STATION | STATION | LOCATION | WIDTH | AREA |
|---------|---------|--------------|----------|--------------|
| 7+10 | 7+55 | LT. OF TRAIL | 3' | 117 SQ. FT. |
| 7+20 | 7+55 | RT. OF TRAIL | 6' | 210 SQ. FT. |
| 7+80 | 8+02 | LT. OF TRAIL | 3' | 64 SQ. FT. |
| 7+80 | 8+00 | RT. OF TRAIL | 6' | 120 SQ. FT. |
| 8+21 | 9+66 | LT. OF TRAIL | 3' | 432 SQ. FT. |
| 8+21 | 9+66 | RT. OF TRAIL | 3' | 435 SQ. FT. |
| 9+66 | 9+82 | RT. OF TRAIL | 4' | 64 SQ. FT. |
| 9+82 | 9+92 | RT. OF TRAIL | 5' | 50 SQ. FT. |
| 10+10 | 12+43 | RT. OF TRAIL | 3' TO 5' | 932 SQ. FT. |
| | | ----- | ----- | ----- |
| | | | TOTAL | 2424 SQ. FT. |

| | | |
|--------------------------|------------------|----------------|
| UNIT PAVERS | | |
| SCALE: N/A | APPROVED BY: SAS | DRAWN BY: CRS |
| DATE: 01/31/13 | | REVISED: KPP |
| LOOKING FOR LINCOLN SIGN | | |
| 11-00052-00-BT | | DRAWING NUMBER |

DETAIL OF P.C. CONCRETE DRIVEWAYS

PORTLAND CEMENT CONCRETE DRIVEWAY PAVEMENT 8 INCH

| TYPE | STATION | QUANTITY |
|-------|-----------|------------|
| C.E. | STA 7+67 | 21 SQ. YD. |
| ALLEY | STA 8+10 | 17 SQ. YD. |
| P.E. | STA 12+53 | 7 SQ. YD. |
| TOTAL | | 45 SQ. YD. |

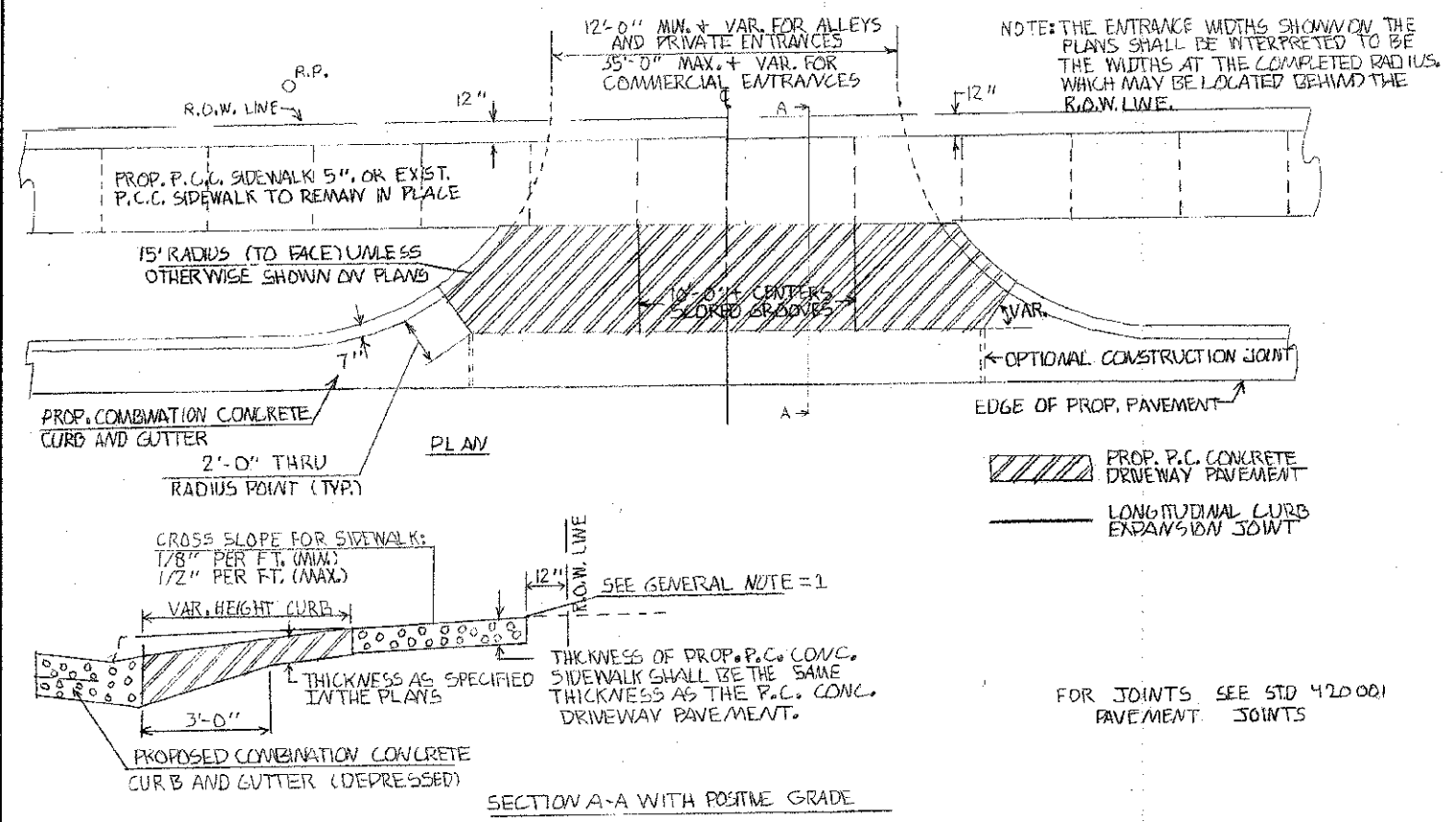

| | | |
|------------------|------------------|----------------|
| DRIVEWAY DETAILS | | |
| SCALE: N/A | APPROVED BY: SAS | DRAWN BY: CRS |
| DATE: 12/7/12 | | REVISED |
| 11-00052-00-BT | | DRAWING NUMBER |

FINAL SURVEY
DATE: _____ BY: _____
SURVEYED: _____ PLOTTED: _____
NOTE BOOK NO. _____ AREAS CHECKED: _____
AREAS CHECKED: _____

ORIGINAL SURVEY
DATE: _____ BY: _____
SURVEYED: _____ PLOTTED: _____
NOTE BOOK NO. _____ AREAS CHECKED: _____
AREAS CHECKED: _____

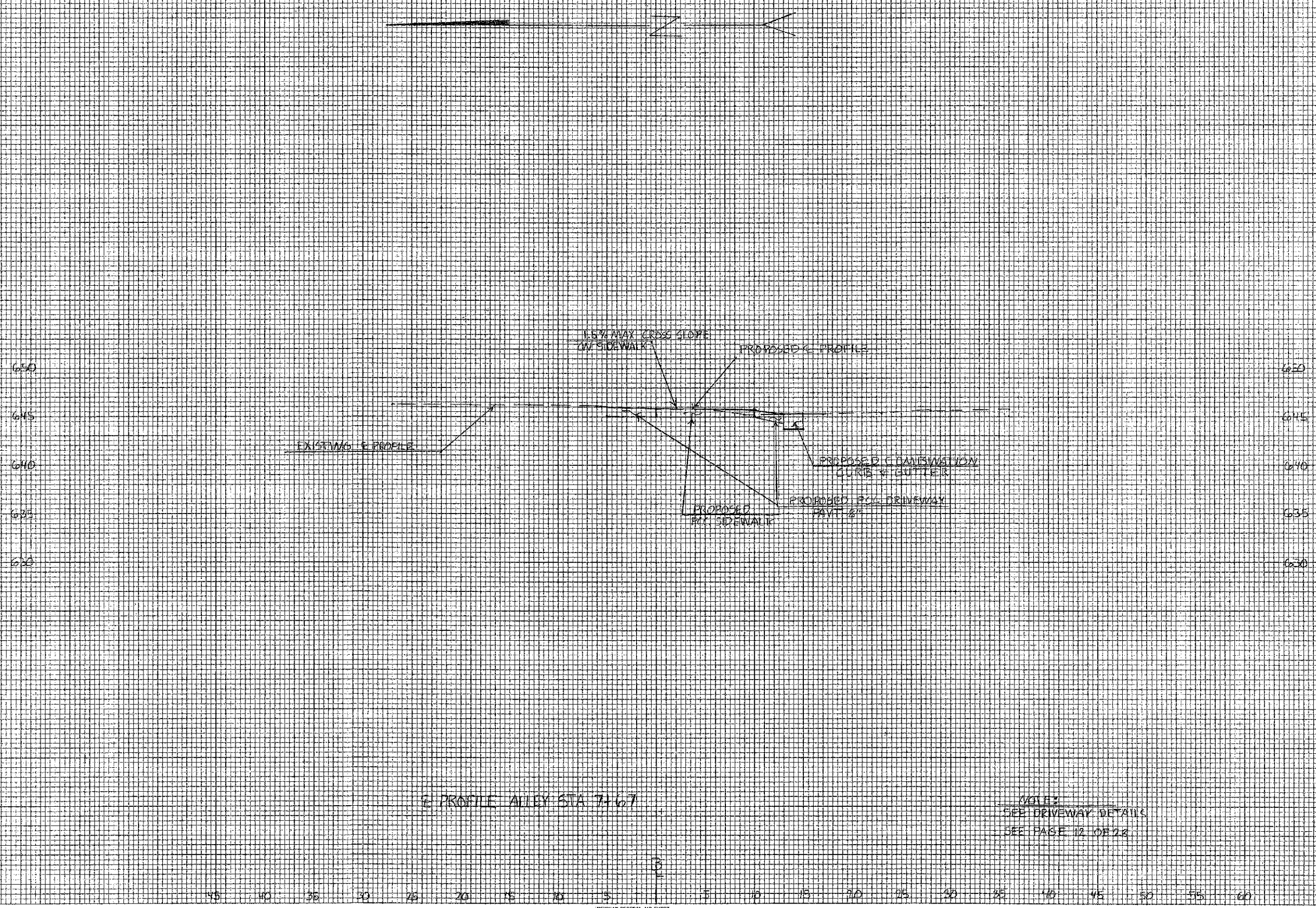

G. PROFILE ALLEY STA 7+67

NOTE:
SEE DRIVEWAY DETAILS
SEE PAGE 12 OF 28

| | |
|-----------|-------------|
| DATE | 11/11/11 |
| PROJECT | WOODS COURT |
| DESIGNER | DAVID BECK |
| CHECKER | DAVID BECK |
| IN CHARGE | DAVID BECK |
| SCALE | AS SHOWN |

| | |
|-----------|-------------|
| DATE | 11/11/11 |
| PROJECT | WOODS COURT |
| DESIGNER | DAVID BECK |
| CHECKER | DAVID BECK |
| IN CHARGE | DAVID BECK |
| SCALE | AS SHOWN |

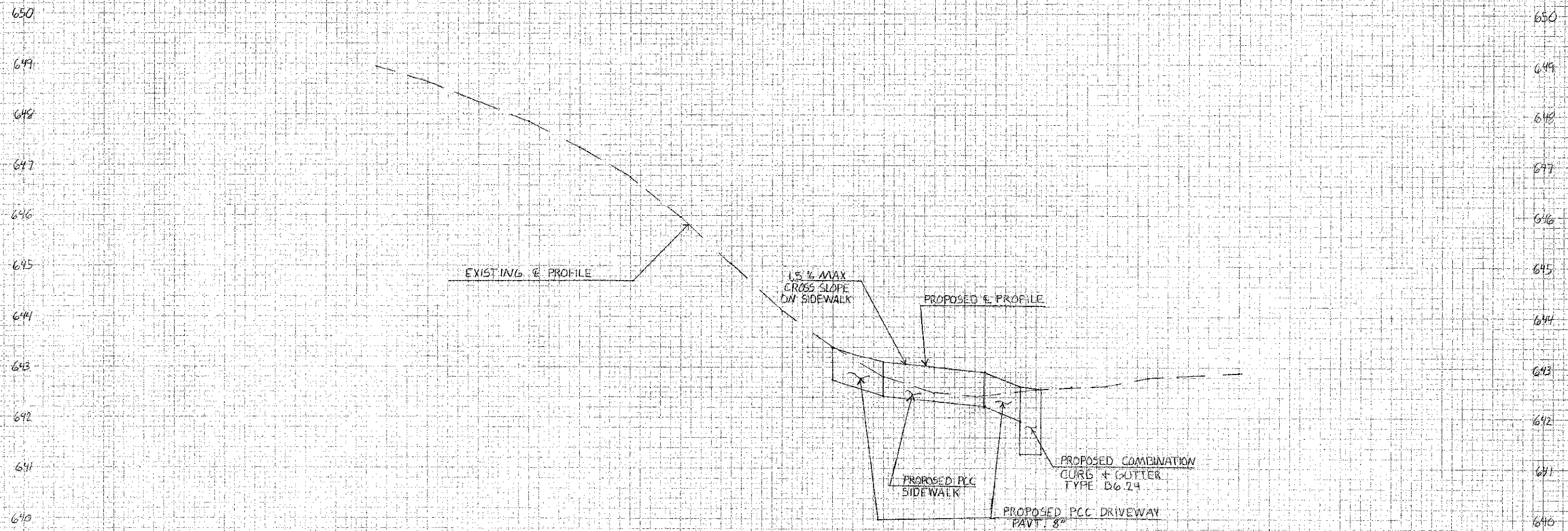

E PROFILE ALLEY STA 8+10

NOTE:
SEE DRIVEWAY DETAILS
SEE PAGE 12 OF 28

50 45 40 35 30 25 20 15 10 5 0 5 10 15 20 25 30 35

PAVEMENT MARKING REMOVAL

| LOCATION | ITEM | AREA |
|------------------------|---------------|---------------|
| STA. 7+50 | RIGHT ARROW | 15.6 SQ. FT. |
| STA. 7+80 | RIGHT ARROW | 15.6 SQ. FT. |
| STA 7+15 TO STA. 8+00 | 4" SOLID LINE | 28.1 SQ. FT. |
| STA 8+00 TO STA 9+00 | 4" SKIP DASH | 6.7 SQ. FT. |
| STA 9+00 TO STA 10+00 | 4' SKIP DASH | 6.7 SQ. FT. |
| STA 8+00 TO STA 10+00 | 12" DIAGONALS | 156.1 SQ. FT. |
| STA 10+24 | 24" STOP BAR | 48.0 SQ. FT. |
| STA 12+86 | 24" STOP BAR | 48.0 SQ. FT. |
| STA 13+16 | 4 - R'S | 14.4 SQ. FT. |
| STA 13+16 | 2 - X'S | 108.0 SQ. FT. |
| STA 13+40 | 24" STOP BAR | 48.0 SQ. FT. |
| SAT 10+10 TO STA 13+40 | 4" SKIP DASH | 29.8 SQ. FT. |
| | TOTAL | 525.0 SQ. FT. |

EPOXY PAVEMENT MARKING LINE 4 "

| LOCATION | COLOR | TYPE | LENGTH |
|------------------------|-------|-----------|----------|
| STA 8+19 TO STA 9+92 | WHITE | EDGE LINE | 173 FOOT |
| STA 10+10 TO STA 13+50 | WHITE | EDGE LINE | 340 FOOT |
| | | TOTAL | 513 FOOT |

EPOXY PAVEMENT MARKING LINE 12 "

| LOCATION | COLOR | TYPE | LENGTH |
|----------------------|-------|-----------|---------|
| STA 8+19 TO STA 9+82 | WHITE | DIAGONALS | 93 FOOT |
| | | TOTAL | 93 FOOT |

EPOXY PAVEMENT MARKING - LETTERS AND SYMBOLS

| LOCATION | ITEM | LOCATION | AREA |
|-----------|---------|----------|---------------|
| STA 9+78 | 2 - R'S | TRAIL | 7.2 SQ. FT. |
| STA 9+78 | X | TRAIL | 54.0 SQ.FT. |
| STA 10+60 | 2 - R'S | TRAIL | 7.2 SQ. FT. |
| STA 10+60 | X | TRAIL | 54.0 SQ.FT. |
| STA 12+15 | 2 - R'S | ROADWAY | 7.2 SQ. FT. |
| STA 12+15 | X | ROADWAY | 54.0 SQ.FT. |
| | | TOTAL | 183.6 SQ. FT. |

EPOXY PAVEMENT MARKING LINE 24 "

| LOCATION | ITEM | LOCATION | LENGTH |
|------------|----------|----------|---------|
| STA 9+66 | STOP BAR | TRAIL | 10 FOOT |
| STA. 9+89 | STOP BAR | TRAIL | 10 FOOT |
| STA 10+18 | STOP BAR | TRAIL | 10 FOOT |
| STA 10+18 | STOP BAR | ROADWAY | 12 FOOT |
| STA 11+00 | STOP BAR | TRAIL | 10 FOOT |
| STA 11 +90 | STOP BAR | ROADWAY | 19 FOOT |
| STA 12+40 | STOP BAR | ROADWAY | 22 FOOT |
| | | TOTAL | 93 FOOT |

| | | |
|--------------------------|------------------|----------------|
| PAVEMENT MARKINGS | | |
| SCALE: N/A | APPROVED BY: SAS | DRAWN BY: C.DS |
| DATE: 01/13/13 | | REVISED: KPP |
| SCHEDULES | | |
| 11-00052-00-BT | | DRAWING NUMBER |

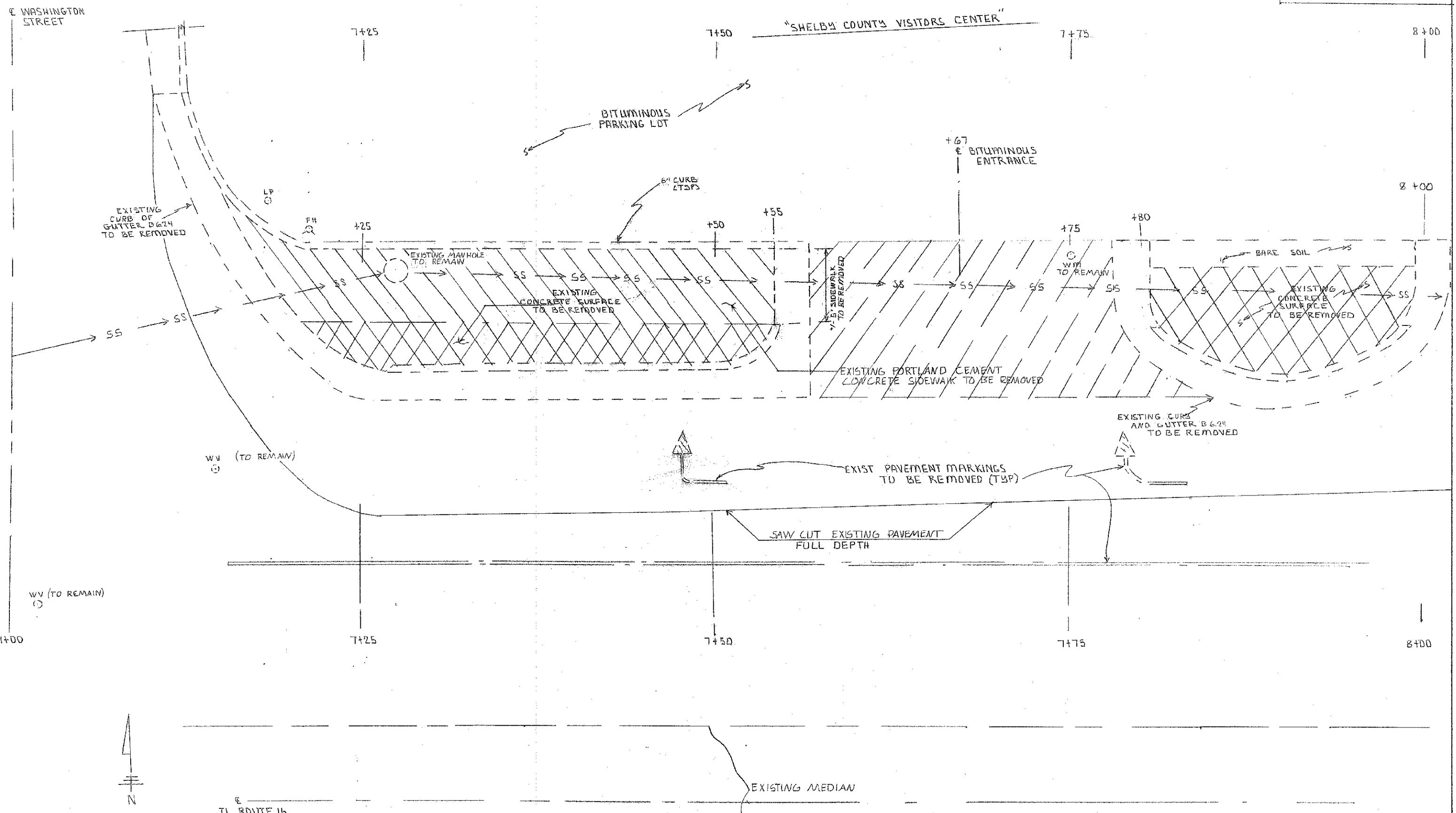

LEGEND

| | |
|--|---------------------------------|
| | EXISTING SIDEWALK TO BE REMOVED |
| | DRIVEWAY PAVEMENT TO BE REMOVED |
| | CONCRETE SURFACE TO BE REMOVED |

STA 7+00 TO STA 8+00

| | | | |
|------------------------|------------------|---------------|---------------|
| DEMOLITION PLAN | | | |
| SCALE: 1/4" = 1'-0" | APPROVED BY: SAS | DRAWN BY: CRS | REVISION: KPP |
| STA 7+00 TO STA 8+00 | | | |
| 11-00052-00-BT | | | 0001 |

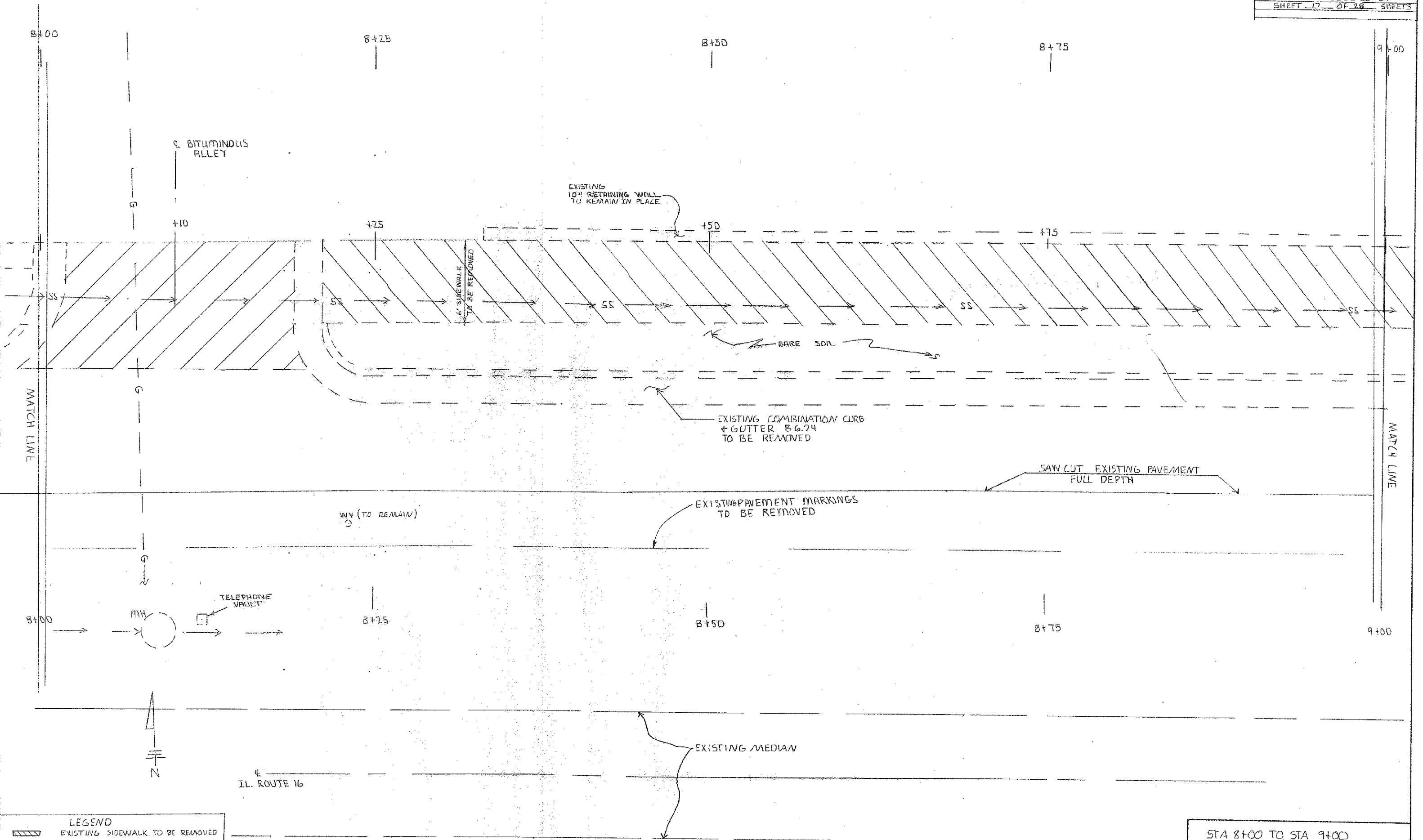

LEGEND

| | |
|--|---------------------------------|
| | EXISTING SIDEWALK TO BE REMOVED |
| | DRIVEWAY PAVEMENT TO BE REMOVED |

| | | | |
|----------------------|------------------|------------------|----------------------|
| STA 8+00 TO STA 9+00 | | | |
| SCALE: 1" = 3' | APPROVED BY: SAS | DRAWN BY: C.P.S. | DATE: 11-20-12 |
| DEMOLITION PLAN | | REVISION: KPP | DRAWING NUMBER: D002 |
| 11-00052-00-BT | | | |

9+00 9+25 9+50 9+75 10+00

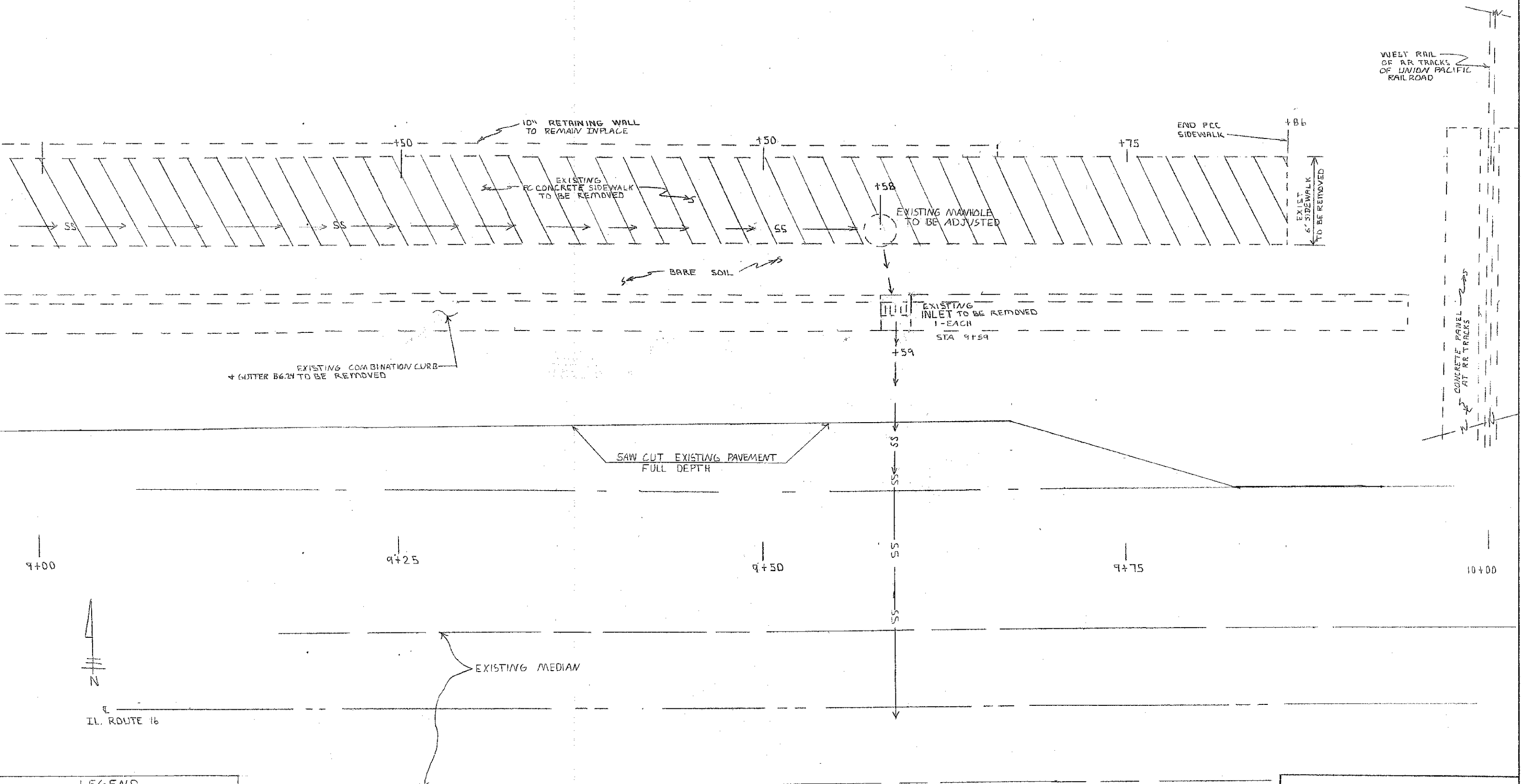

LEGEND
 EXISTING SIDEWALK TO BE REMOVED

STA 9+00 TO STA 10+00
 SCALE: 1" = 30'
 DATE: 11-20-12
 APPROVED BY: SAS
 DRAWN BY: CRS
 REVISION: KFP
DEMOLITION PLAN
 DRAWING NUMBER: 11-00052-00-BT
 0003

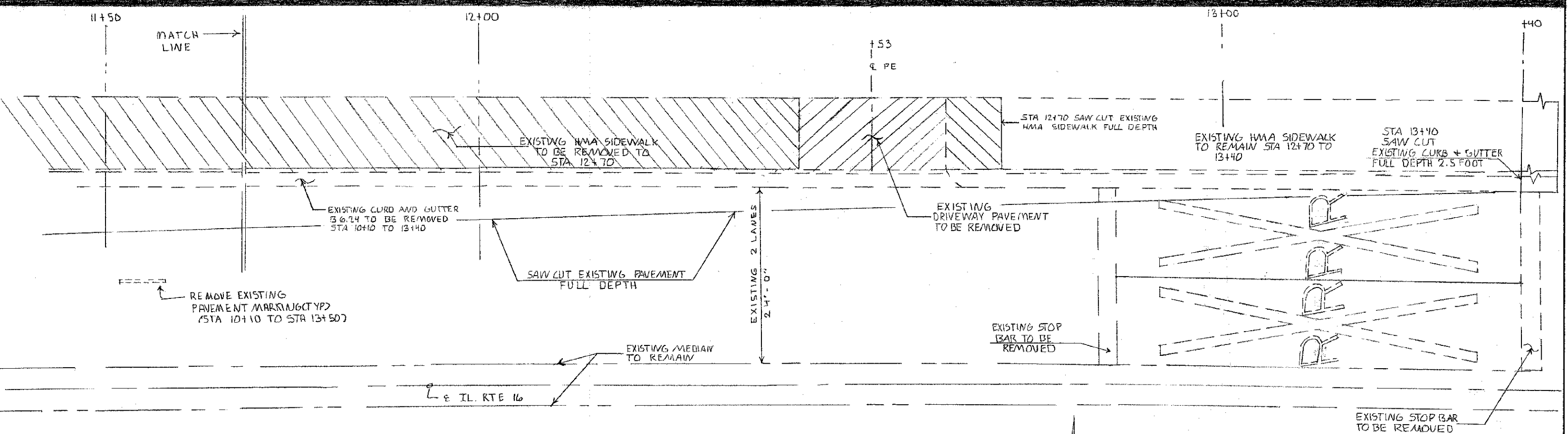
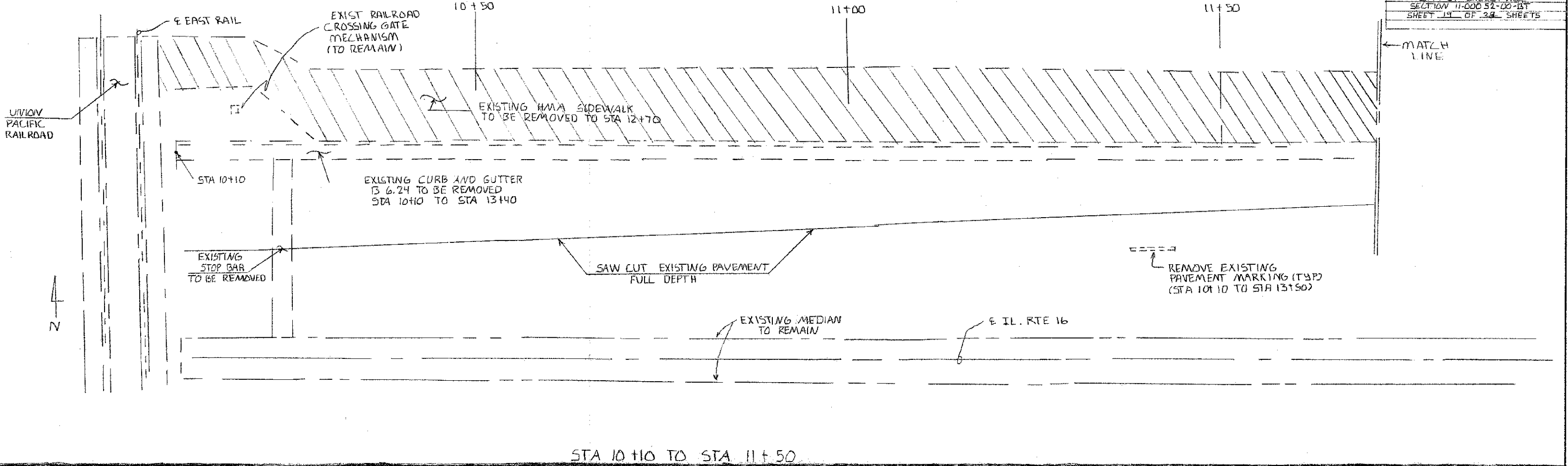

LEGEND

| | |
|--|---------------------------------|
| | EXISTING SIDEWALK TO BE REMOVED |
| | DRIVEWAY PAVEMENT TO BE REMOVED |

LANE TRANSITION PLAN
 DESIGN SPEED LIMIT = 40 MPH
 POSTED SPEED LIMIT = 35 MPH
 SCALE 1" = 6'

NOTE:
 EXISTING RR SYMBOLS
 TO BE REMOVED

| | | |
|---|------------------|------------------|
| LANE TRANSITION STA 10+10 TO STA 13+40 | | |
| SCALE: 1"=6' | APPROVED BY: SAS | DRAWN BY: C.R.S. |
| DATE: 11-06-12 | | REVISED: K.P.P. |
| DEMOLITION PLAN | | |
| 11-00052-00-BT | | DRAWING NUMBER |

STA 11+50 TO STA 13+50

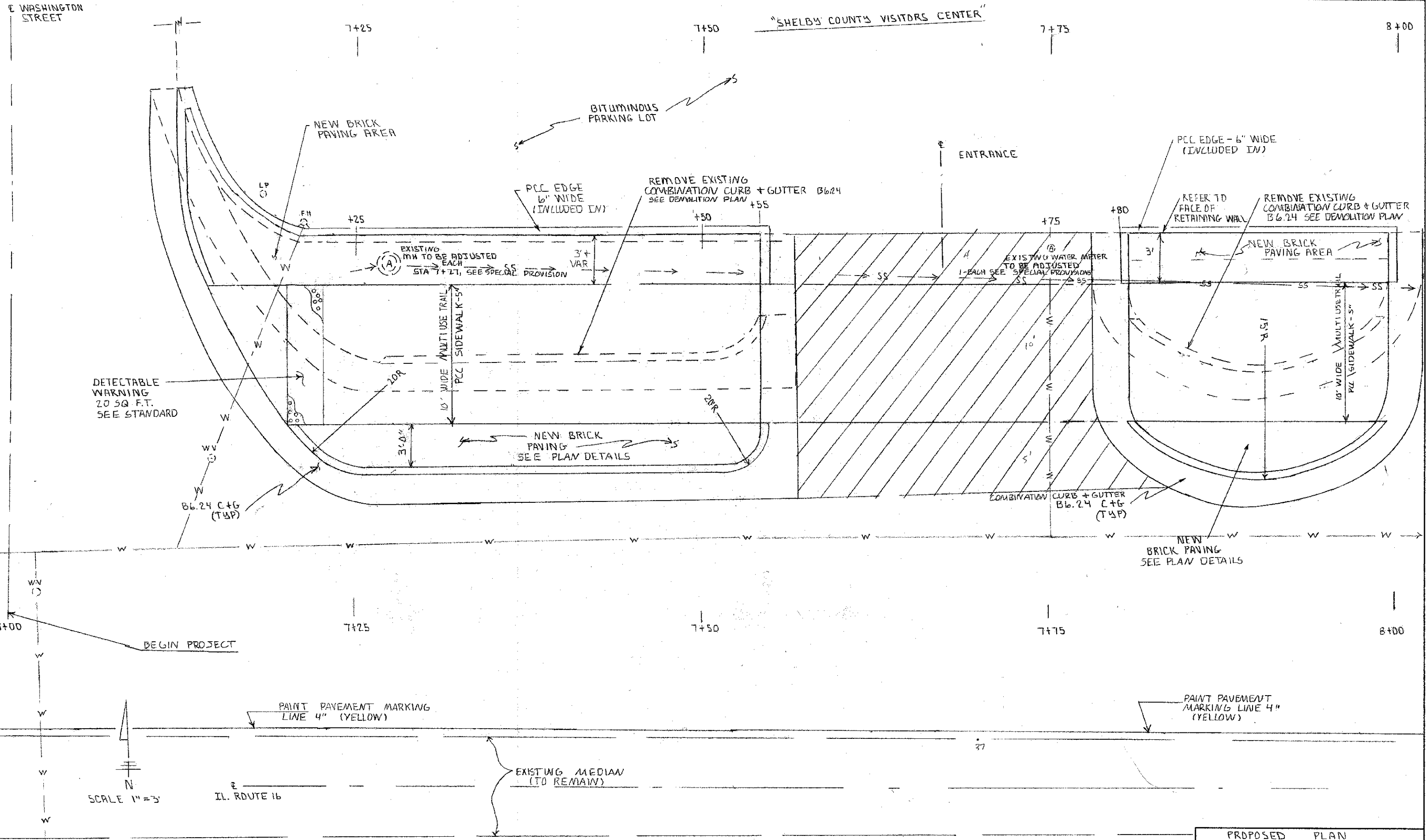

E WASHINGTON STREET

"SHELBY COUNTY VISITORS CENTER"

ENTRANCE

BITUMINOUS PARKING LOT

NEW BRICK PAVING AREA

PCC EDGE - 6" WIDE (INCLUDED INV)

REMOVE EXISTING COMBINATION CURB + GUTTER B6.24 SEE DEMOLITION PLAN

REFER TO FACE OF RETAINING WALL

REMOVE EXISTING COMBINATION CURB + GUTTER B6.24 SEE DEMOLITION PLAN

NEW BRICK PAVING AREA

EXISTING MH TO BE ADJUSTED TO BE ADJUSTED EACH STA 7+21, SEE SPECIAL PROVISION

EXISTING WATER METER TO BE ADJUSTED 1-EACH SEE SPECIAL PROVISIONS

DETECTABLE WARNING 20 SQ. F.T. SEE STANDARD

NEW BRICK PAVING SEE PLAN DETAILS

NEW BRICK PAVING SEE PLAN DETAILS

BEGIN PROJECT

PAINT PAVEMENT MARKING LINE 4" (YELLOW)

PAINT PAVEMENT MARKING LINE 4" (YELLOW)

EXISTING MEDIAN (TO REMAIN)

SCALE 1"=3'

IL. ROUTE 16



7+00
7+25
7+50
7+75
8+00

7+25

7+50

7+75

8+00

+25

+50

+55

+75

+80

7+25

7+50

7+75

8+00

"MIKES TAVERN"

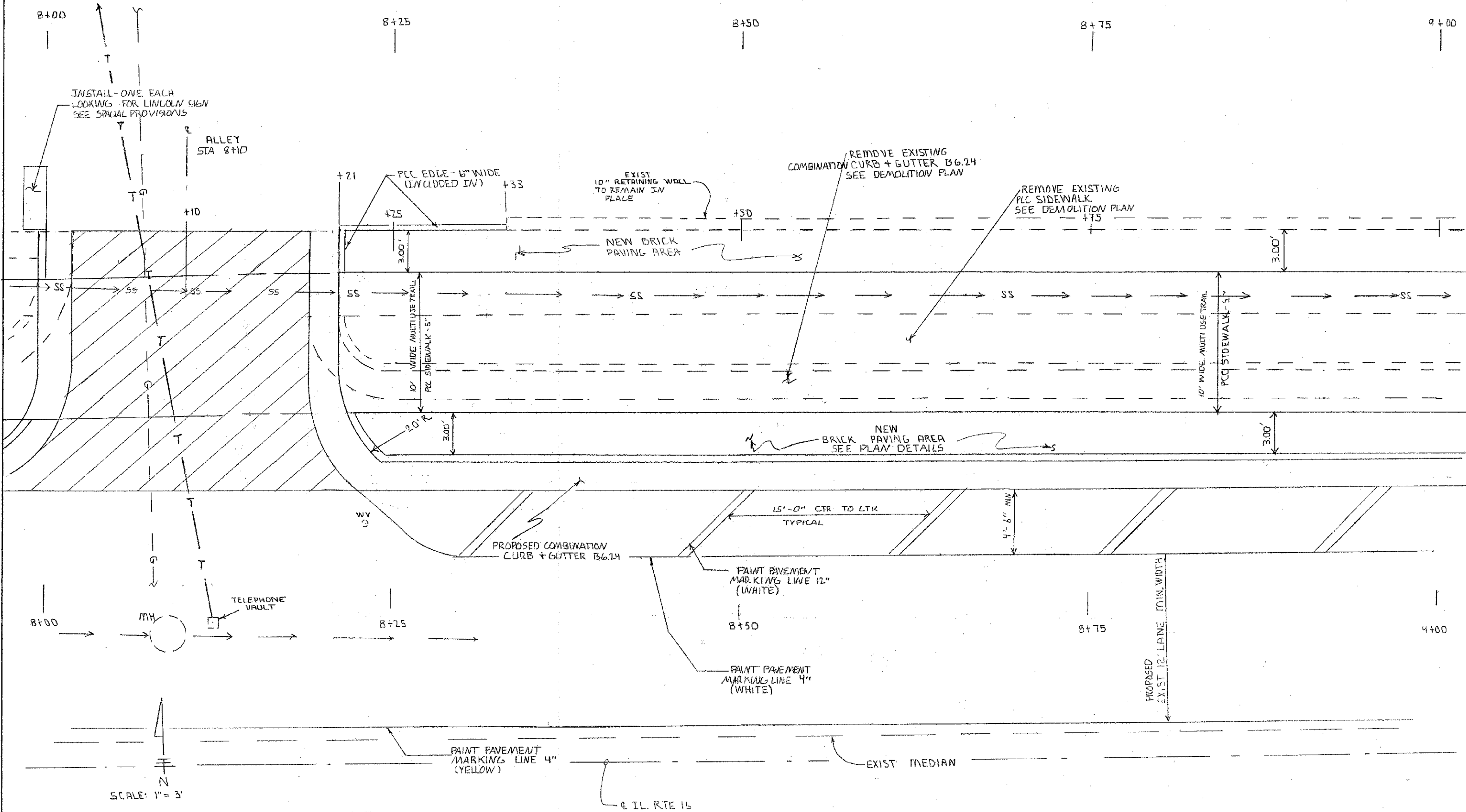

| | | | |
|----------------------|-----------------|--------------|---------------------|
| STA 8+00 TO STA 9+00 | | | |
| SCALE 1 INCH = 3 FT. | APPROVED BY SAS | DRAWN BY CJS | REVISOR KPP |
| DATE 11-24-2002 | PROPOSED PLAN | | DRAWING NUMBER P002 |
| 11-00052-00-BT | | | |

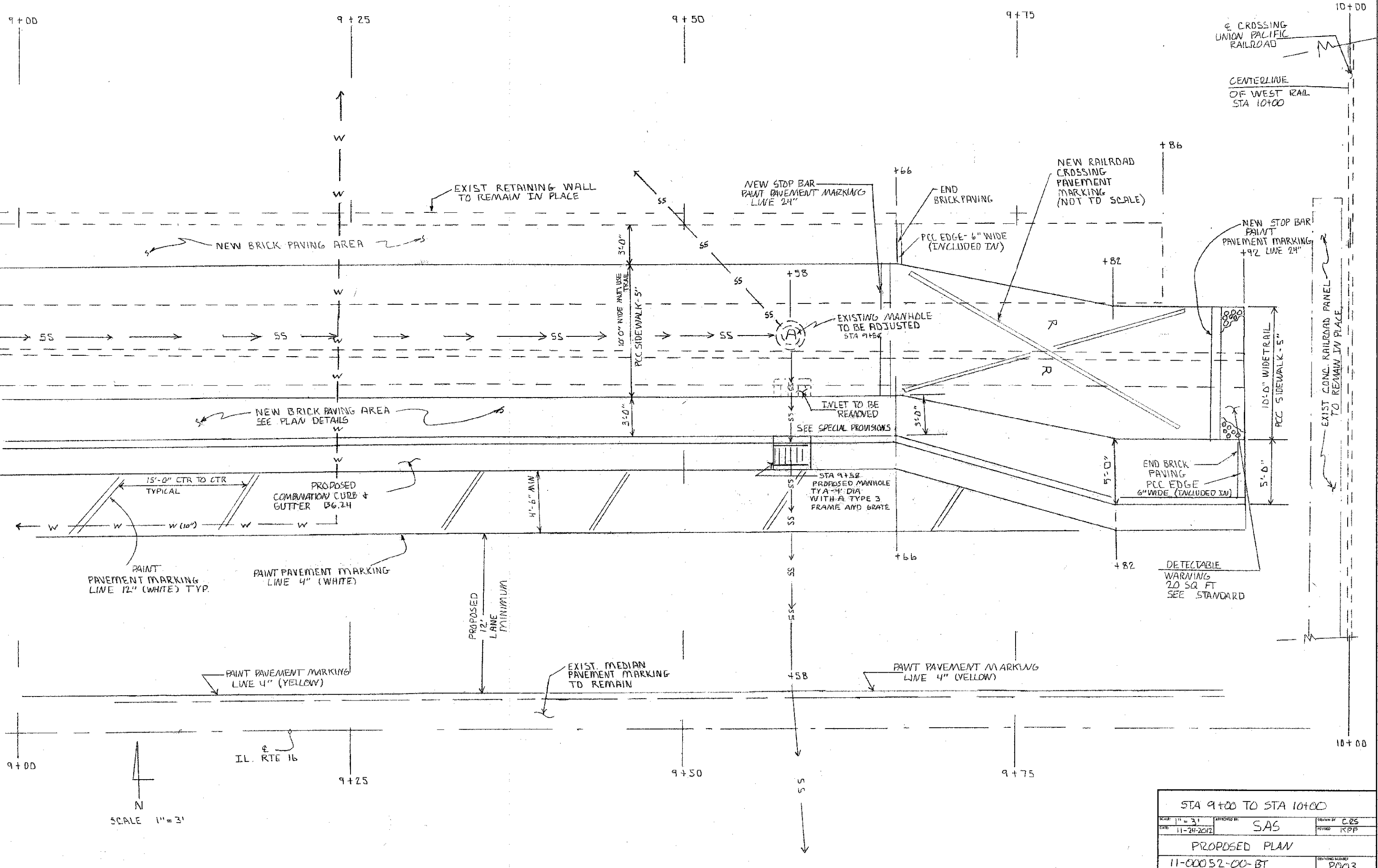

| | | | |
|-----------------------|------------------|---------------|----------------------|
| STA 9+00 TO STA 10+00 | | | |
| SCALE: 1" = 3' | APPROVED BY: SAS | DRAWN BY: CBS | REVISED: RPP |
| DATE: 11-29-2012 | PROPOSED PLAN | | DRAWING NUMBER: P003 |
| 11-00052-00-BT | | | |

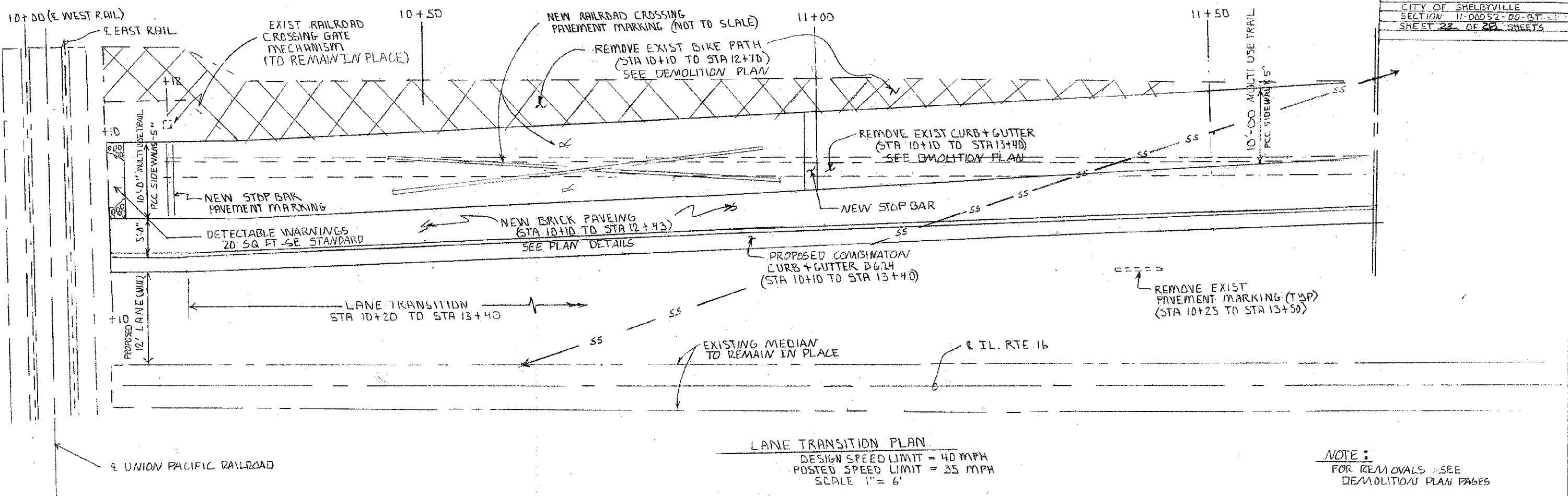

LANE TRANSITION PLAN
 DESIGN SPEED LIMIT = 40 MPH
 POSTED SPEED LIMIT = 35 MPH
 SCALE 1" = 6'

NOTE:
 FOR REMOVALS SEE
 DEMOLITION PLAN PAGES

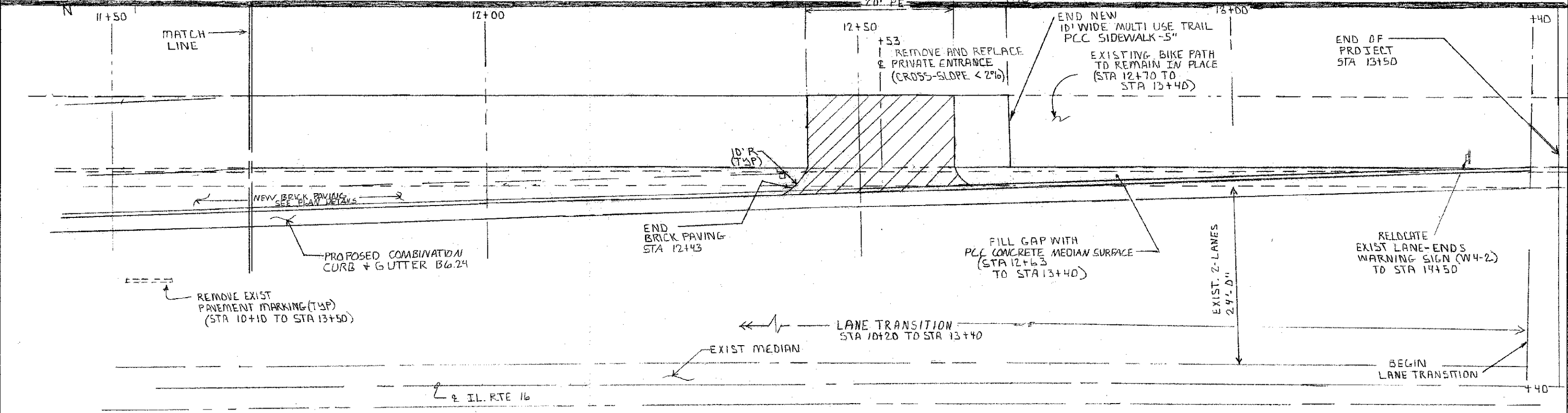

LEGEND

- PORTLAND CEMENT CONCRETE DRIVEWAY PAVEMENT 6"
- EXISTING PATH TO BE REMOVED AND AREA SOGDED

LANE TRANSITION PLAN
 DESIGN SPEED LIMIT = 40 MPH
 POSTED SPEED LIMIT = 35 MPH
 SCALE 1" = 6'

NOTE:
 FOR REMOVALS SEE
 DEMOLITION PLAN PAGES

| | | | |
|---|------------------|---------------|----------------------|
| LANE TRANSITION STA 10+10 TO STA 13+40 | | | |
| SCALE: 1" = 6' | APPROVED BY: SAS | DRAWN BY: CRS | |
| DATE: 11-24-2020 | | REVIEWED: | |
| PROPOSED PLAN | | | |
| 11-00052-00-13T | | | DRAWING NUMBER: 0004 |

CENTERLINE TRAIL PROFILE SHEET

CONTRACT #95707

| |
|-------------------------|
| SHELBY COUNTY |
| CITY OF GHELBYVILLE |
| SECTION 11-00052-00-13T |
| SHEET 24 OF 28 SHEETS |

NOTE:
E PROFILE OF TRAIL
TO PARALLEL ROADWAY GRADE

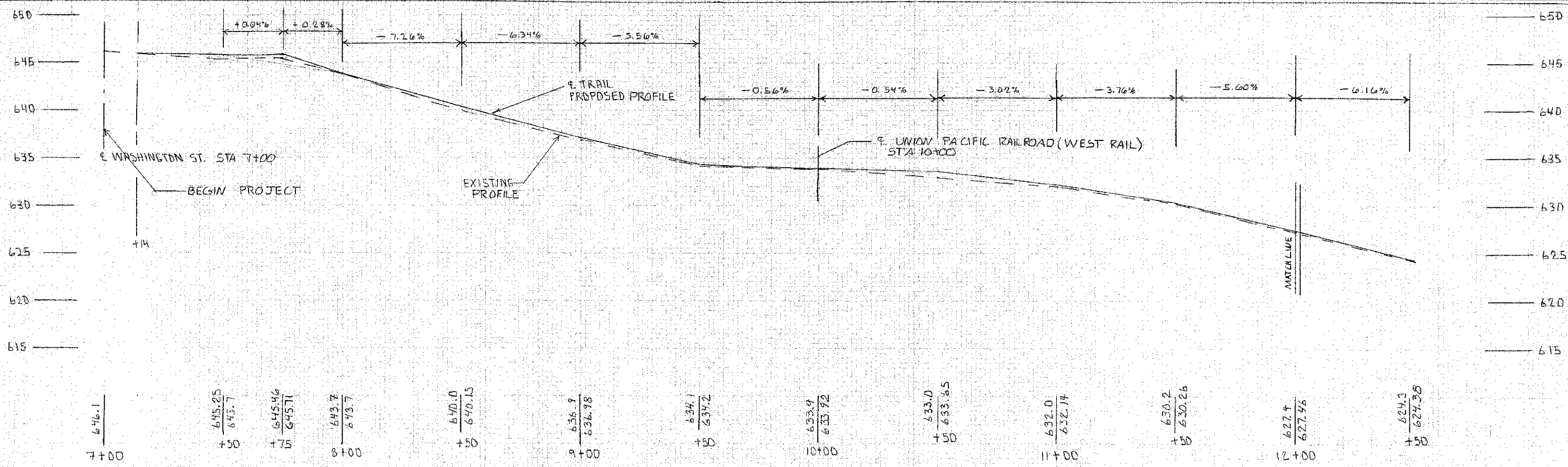
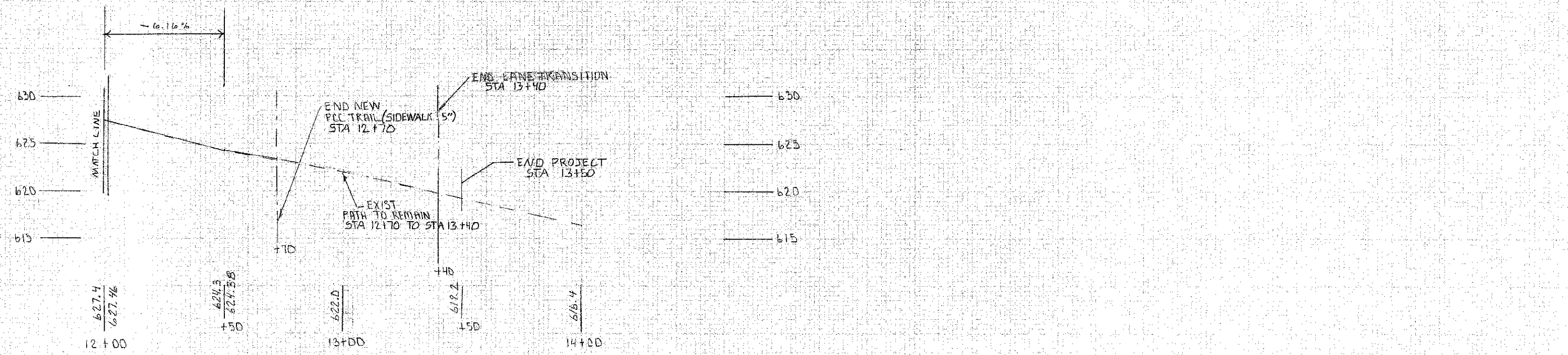

SCALE:
VERTICAL 1" = 5'
HORIZONTAL 1" = 20'

DATE: 11/15/11
 DRAWN BY: [illegible]
 CHECKED BY: [illegible]
 APPROVED BY: [illegible]

DATE: 11/15/11
 DRAWN BY: [illegible]
 CHECKED BY: [illegible]
 APPROVED BY: [illegible]

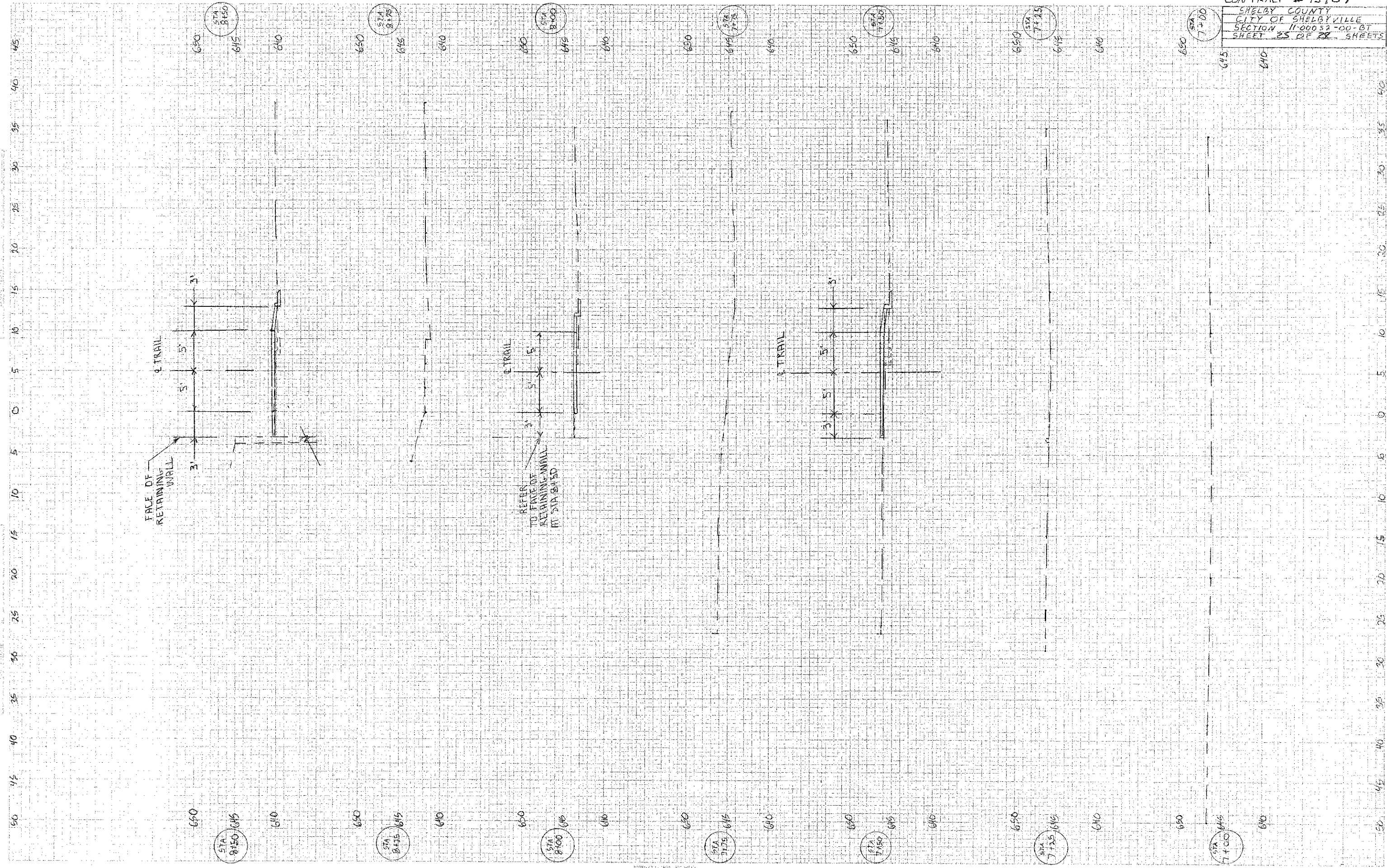

PROPOSED
EXISTING
RAILROAD CROSSING SURFACE

PROPOSED
EXISTING
RAILROAD CROSSING SURFACE

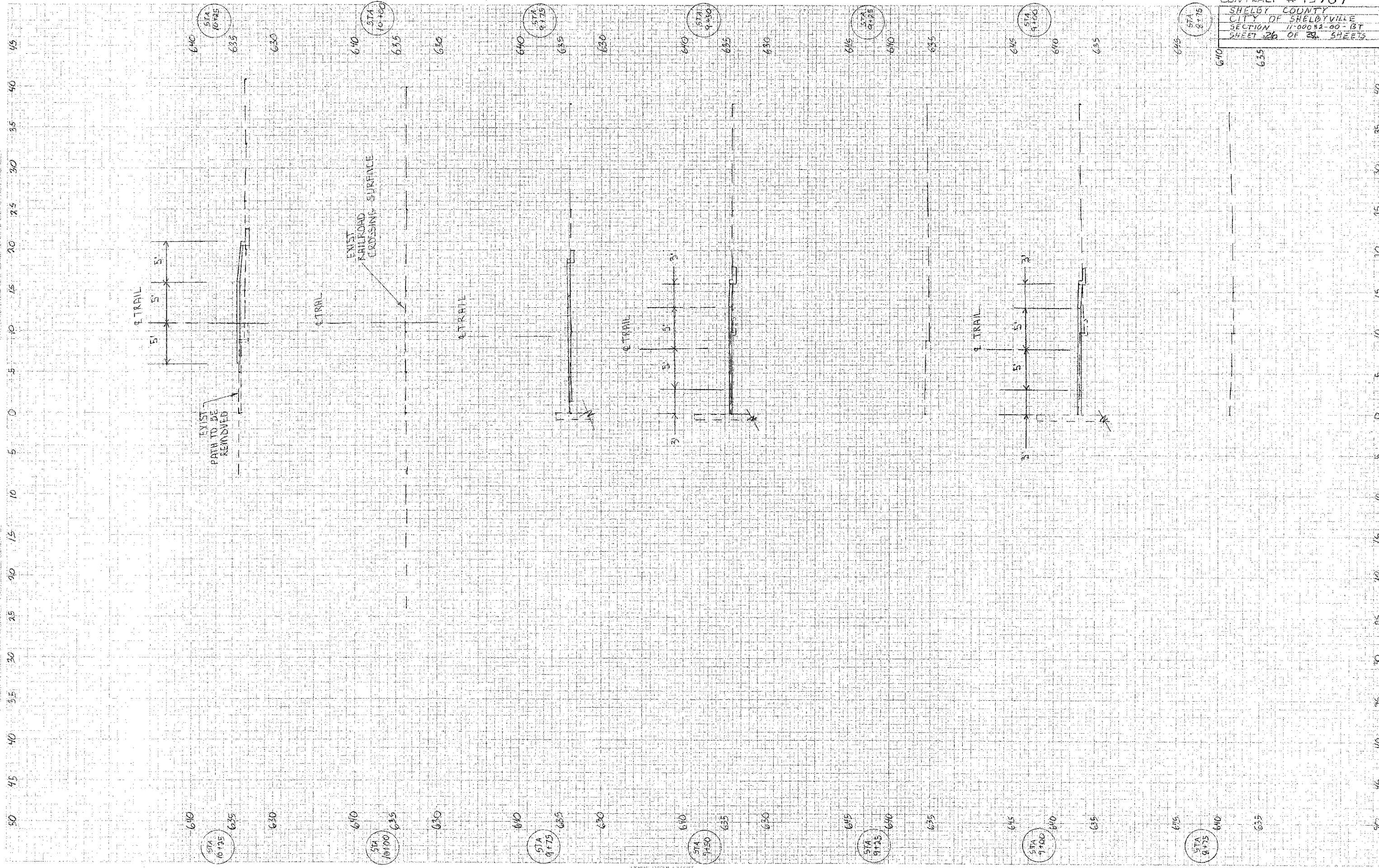

DATE: 11/11/00
 DRAWN BY: [illegible]
 CHECKED BY: [illegible]

DATE: 11/11/00
 DRAWN BY: [illegible]
 CHECKED BY: [illegible]

