

ROUTE	SECTION	COUNTY	TOTAL SHEETS	SHEET NO.
TR 239	06-06117-00-BR	SALINE	14	14
PROJECT NO. BROS-165(30)			CONTRACT NO. 89488	

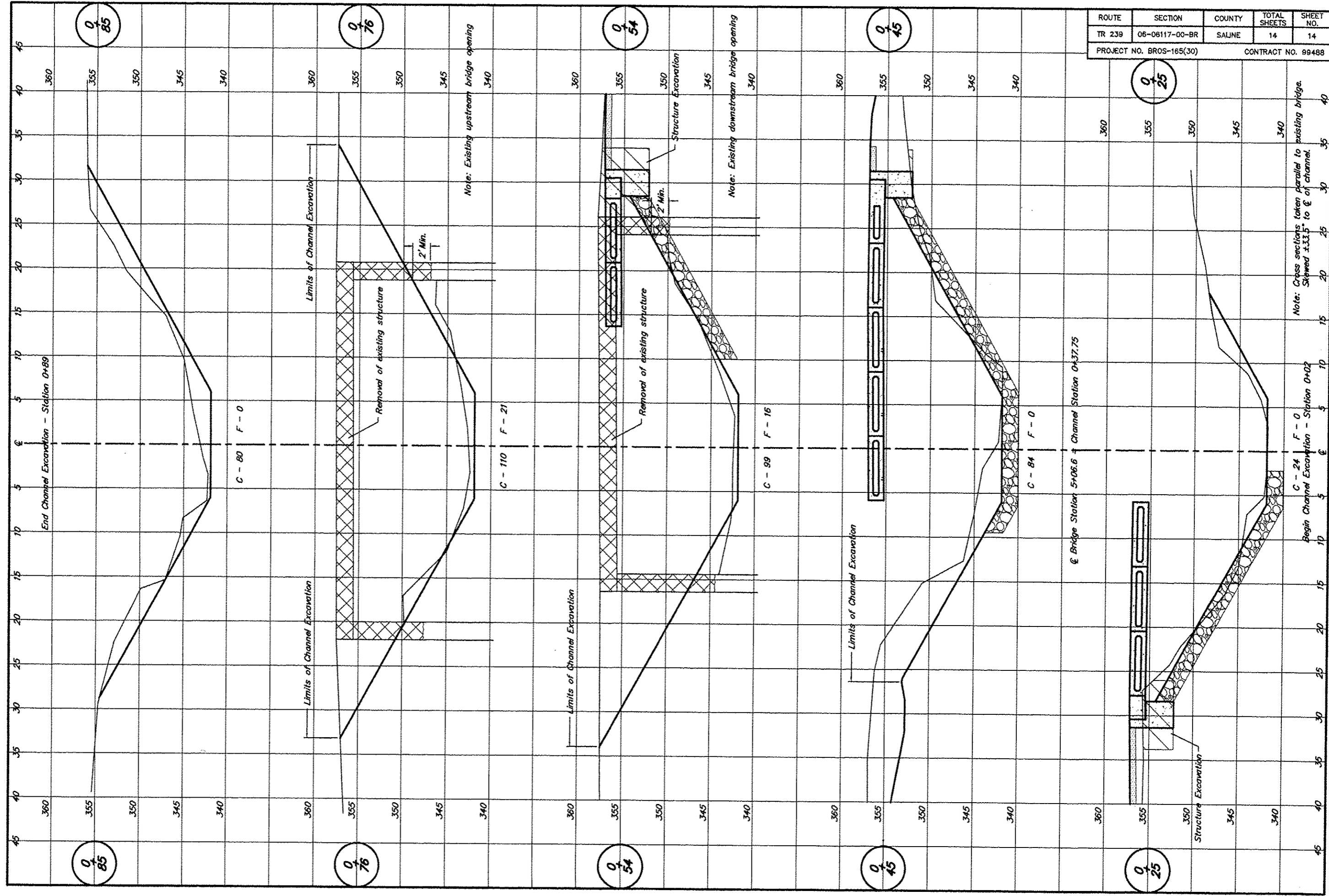

Note: Cross sections taken parallel to existing bridge. Skewed ±33.5° to C of channel.

Begin Channel Excavation - Station D+02

End Channel Excavation - Station D+89

Structure Excavation

Removal of existing structure

Limits of Channel Excavation

Note: Existing upstream bridge opening

Note: Existing downstream bridge opening

C - 80 F - 0

C - 110 F - 21

C - 99 F - 16

C - 84 F - 0

Channel Station 0+37.75

Bridge Station 5+06.6

Stationing: 45, 40, 35, 30, 25, 20, 15, 10, 5

Elevation: 360, 355, 350, 345, 340

Section Markers: 0/85, 0/76, 0/54, 0/45, 0/25