

BY	DATE
FINAL SURVEY	SURVEYED
NOTE BOOK	PLOTTED
	REPLATE
	AREAS OBTAINED

BY	DATE
ORIGINAL SURVEY	SURVEYED
NOTE BOOK	PLOTTED
	REPLATE
	AREAS OBTAINED

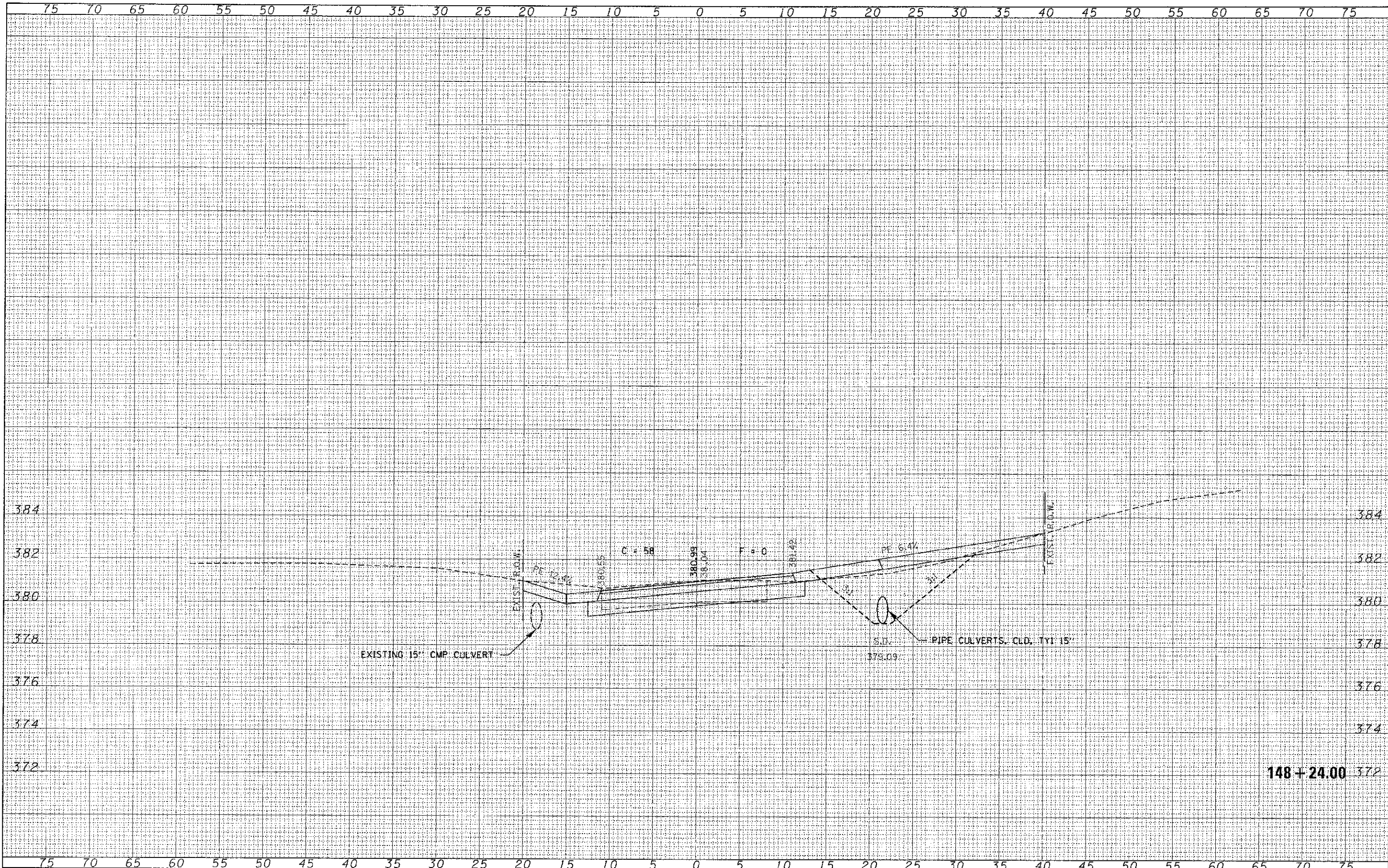

148+24.00 372

FILE NAME * 120127-shr-smw.dgn	USER NAME *	DESIGNED - J.W.F.	REVISED -	<p align="center">STATE OF ILLINOIS JACKSON COUNTY HIGHWAY DEPARTMENT</p> <p align="center">STATION CROSS SECTIONS DILLINGER ROAD</p> <p>SCALE: V5H2 SHEET NO. OF SHEETS STA. 148+24.00 TO STA. 148+24.00</p>	C.H.	SECTION	COUNTY	TOTAL SHEETS	SHEET NO.
HAMPTON, LENZINI AND RENWICK, INC.		DRAWN - L.G.C.	REVISED -		11	06-00145-00-BR	JACKSON	54	13
ILLINOIS PROFESSIONAL ENGINEERS		CHECKED - S.W.M.	REVISED -		CARSONDALE ROAD DISTRICT				CONTRACT NO. 99509
ILLINOIS PROFESSIONAL ENGINEERS		DATE - 04/04/13	REVISED -		ILLINOIS FED. AID PROJECT				