

MAR 11, 2013 12:00 PM HARR01115  
 pw:\sps-svr306\hanson\Documents\Projects\12A0069\12A0069D\CAD\Airport\Sheet\C-161-JNT

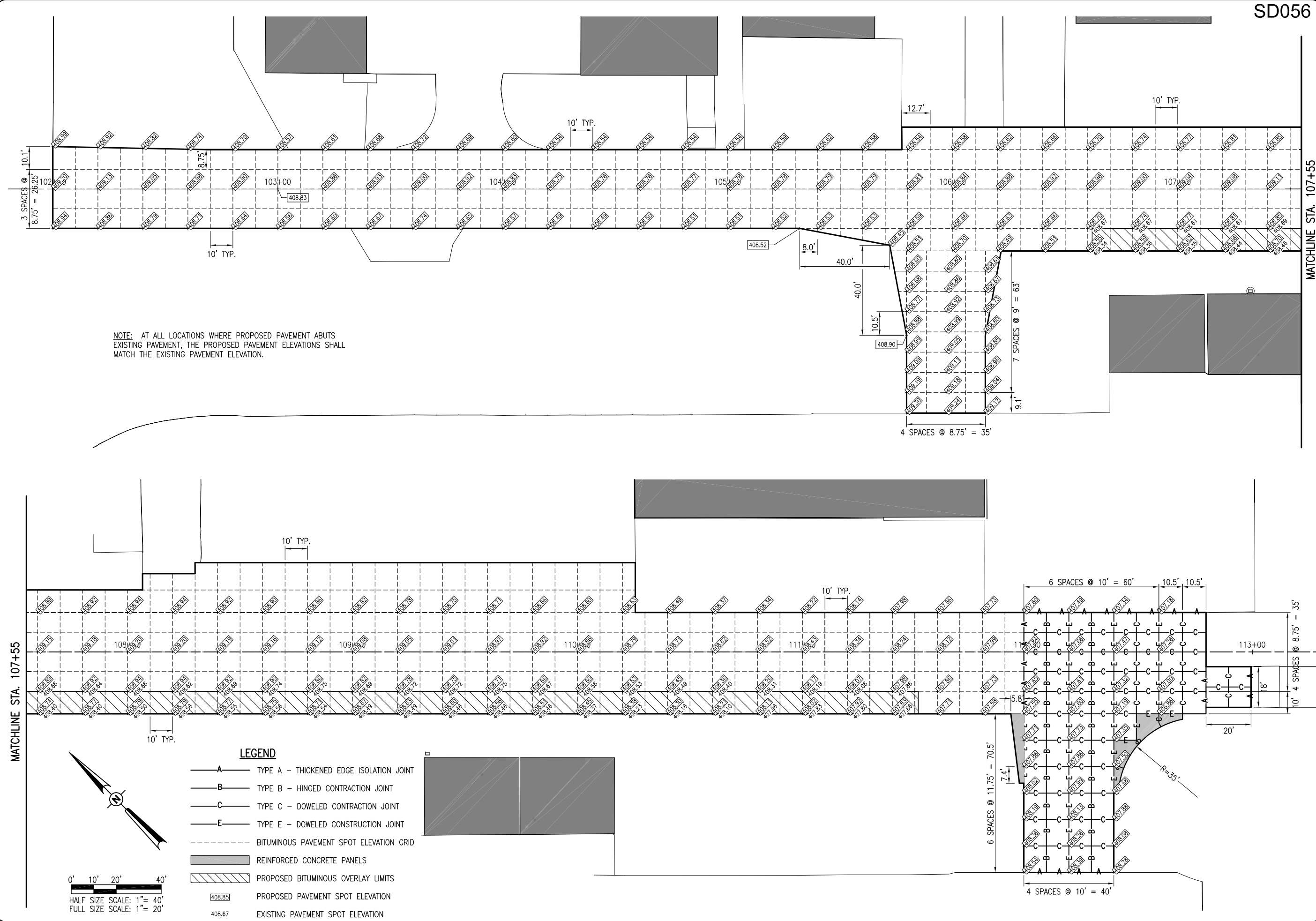

SD056

MATCHLINE STA. 107+55

DATE	REVISION

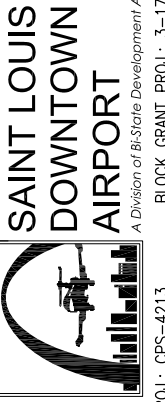

**SAINT LOUIS DOWNTOWN AIRPORT**  
 A Division of Bi-State Development Agency  
 BLOCK GRANT PROJ.: 3-17-0039-B30  
 IL PROJ.: CPS-4213

Hanson Project No.	12A0069
Filename	C-161-JNT.dwg
Scale	1" = 30'
Date	03/08/13
LAYOUT	JRH 01/30/13
DRAWN	JRH 02/01/13
REVIEWED	BSS 03/08/13



**HANSON**  
 Hanson Professional Services Inc. 2013  
 1525 South Main Street  
 Springfield, Illinois 62703-2886

RECONSTRUCT TAXILANE  
 IN NORTHWEST QUADRANT

PROPOSED JOINTING PLAN  
 AND SPOT ELEVATION PLAN