

CONSTRUCTION PLANS FOR

SPARTA COMMUNITY AIRPORT

HUNTER FIELD

SPARTA, ILLINOIS

ILLINOIS PROJECT SAR - 4224

S.B.G. PROJECT 3-17-0094-B11

EXTEND PARALLEL TAXIWAY TO RUNWAY 18 THRESHOLD

Sheet List Table	
Sheet Number	Sheet Title
01	COVER SHEET
02	SITE PLAN
03	CONSTRUCTION ACTIVITY PLAN INDEX
04	CONSTRUCTION ACTIVITY PLAN 1
05	CONSTRUCTION ACTIVITY PLAN 2
06	CONSTRUCTION ACTIVITY PLAN 3
07	CONSTRUCTION SAFETY PHASING PLAN NOTES
08	EXISTING CONDITIONS AND REMOVALS
09	PROPOSED IMPROVEMENTS
10	TAXIWAY A PLAN & PROFILE SHEET STA. 35+00 TO STA. 50+00
11	TYPICAL SECTIONS
12	ELECTRICAL LAYOUT AND LIGHTING PLAN 1
13	ELECTRICAL LAYOUT AND LIGHTING PLAN 2
14	ELECTRICAL DETAILS 1
15	ELECTRICAL DETAILS 2
16	ELECTRICAL DETAILS 3
17	DRAINAGE DETAILS
18	INLET DETAILS
19	PAVEMENT MARKING PLAN
20	EROSION CONTROL AND INDEX TO CROSS SECTIONS
21	EROSION CONTROL DETAILS 1
22	EROSION CONTROL DETAILS 2
23	BORROW SITE PLAN AND PROFILE
24	TAXIWAY A CROSS SECTIONS SHEET 1
25	TAXIWAY A CROSS SECTIONS SHEET 2
26	TAXIWAY A CROSS SECTIONS SHEET 3
27	BORROW PIT CROSS SECTIONS SHEET 1
28	BORROW PIT CROSS SECTION SHEET 2

SUMMARY OF QUANTITIES			
ITEM NO.	Description	UNIT	QUANTITY
AR108158	1/C #8 5 KV UG CABLE IN UD	LF	3,975.0
AR110102	DUCT MARKER - IN PAVEMENT	EA	2.0
AR110504	4-WAY CONCRETE ENCASED DUCT	LF	45.0
AR125415	MIL-BASE MOUNTED	EA	33.0
AR125444	TAXI GUIDANCE SIGN, 4 CHARACTER	EA	2.0
AR125445	TAXI GUIDANCE SIGN, 5 CHARACTER	EA	2.0
AR125447	TAXI GUIDANCE SIGN, 7 CHARACTER	EA	2.0
AR125565	SPLICE CAN	EA	1.0
AR125610	REILS	PAIR	1.0
AR125901	REMOVE STAKE MOUNTED LIGHT	EA	3.0
AR125904	REMOVE TAXI GUIDANCE SIGN	EA	4.0
AR125907	REMOVE REILS	PAIR	1.0
AR150510	ENGINEER'S FIELD OFFICE	LS	1.0
AR150520	MOBILIZATION	LS	1.0
AR151450	CLEARING AND GRUBBING	AC	0.3
AR152410	UNCLASSIFIED EXCAVATION	CY	7,000.0
AR156510	SILT FENCE	LF	650.0
AR156514	STRAW WATTLE	LF	270.0
AR156520	INLET PROTECTION	EA	1.0
AR156530	TEMPORARY SEEDING	AC	3.5
AR801248	TIED CONCRETE BLOCK MAT	SF	1,600.0
AR208540	OVERSIZED AGGREGATE	TON	1,800.0
AR209600	GEOTEXTILE FABRIC	SY	3,250.0
AR209606	CRUSHED AGG. BASE COURSE - 6"	SY	3,150.0
AR401610	BITUMINOUS SURFACE COURSE	TON	325.0
AR401655	BUTT JOINT CONSTRUCTION	SY	234.0
AR401921	REMOVE PAVEMENT	SY	785.0
AR403610	BITUMINOUS BASE COURSE	TON	455.0
AR602510	BITUMINOUS PRIME COAT	GAL	1,600.0
AR603510	BITUMINOUS TACK COAT	GAL	850.0
AR620520	PAVEMENT MARKING-WATERBORNE	SF	3,000.0
AR620525	PAVEMENT MARKING-BLACK BORDER	SF	1,960.0
AR620900	PAVEMENT MARKING REMOVAL	SF	1,210.0
AR625511	SEAL COAT	SY	2,250.0
AR701530	30" RCP, CLASS IV	LF	192.0
AR701900	REMOVE PIPE	LF	140.0
AR751410	INLET	EA	1.0
AR752430	PRECAST REINFORCED CONC. FES 30"	EA	1.0
AR752900	REMOVE END SECTION	EA	1.0
AR901510	SEEDING	AC	3.5
AR908510	MULCHING	AC	3.5
AR908520	EXCELSIOR BLANKET	SY	500.0
AR908525	KNITTED STRAW MAT	SY	2,050.0

MARCH 1, 2013

811 Know what's below. Call before you dig. **J.U.L.I.E. JOINT UTILITY LOCATING INFORMATION FOR EXCAVATORS** www.illinois1call.com

THE LOCATION, SIZE AND TYPE OF MATERIAL OF EXISTING UNDERGROUND UTILITIES INDICATED ON THE PLANS IS NOT REPRESENTED AS BEING ACCURATE, SUFFICIENT OR COMPLETE. IT SHALL BE THE CONTRACTOR'S RESPONSIBILITY TO DETERMINE ACTUAL LOCATIONS OF ALL SUCH FACILITIES, INCLUDING SERVICE CONNECTIONS TO UNDERGROUND UTILITIES. PRIOR TO CONSTRUCTION, THE CONTRACTOR SHALL NOTIFY UTILITY COMPANIES OF HIS OPERATIONAL PLANS, OBTAIN FROM RESPECTIVE UTILITY COMPANIES DETAILED INFORMATION AND ASSISTANCE RELATIVE TO THE LOCATION OF THEIR FACILITIES AND THE WORKING SCHEDULE OF THE COMPANIES FOR REMOVAL OR ADJUSTMENT WHERE REQUIRED. IN THE EVENT AN UNEXPECTED UTILITY INTERFERENCE IS ENCOUNTERED DURING CONSTRUCTION, THE CONTRACTOR SHALL IMMEDIATELY NOTIFY THE UTILITY COMPANY OF JURISDICTION AND THE ONE-CALL NOTICE SYSTEM. THE ENGINEER SHALL ALSO BE IMMEDIATELY NOTIFIED. ANY SUCH UTILITY OR SERVICES SHALL BE RESTORED TO SERVICE AT ONCE AND PAID FOR BY THE CONTRACTOR AT NO ADDITIONAL COST TO THE CONTRACT.

CALL J.U.L.I.E. FOR UTILITY INFORMATION AT 811.

DESIGN INFORMATION

GEOMETRIC CRITERIA
 AIRPLANE DESIGN GROUP II
 TAXIWAY DESIGN GROUP II

PAVEMENT DESIGN CRITERIA
 AIRCRAFT SINGLE WHEEL GEAR
 DEPARTURE WEIGHT = 12,500 LBS.
 100 ANNUAL DEPARTURES

MAXIMUM ALLOWABLE EQUIPMENT HEIGHT = 25'

RADIO CONTROL FREQUENCY 123.075

CALL J.U.L.I.E. BEFORE EXCAVATING
 1-800-892-0123

TOWNSHIP: T4S
 RANGE: R5W
 SECTION: 30
 COUNTY: RANDOLPH
 CIVIL TOWNSHIP: COULTERVILLE

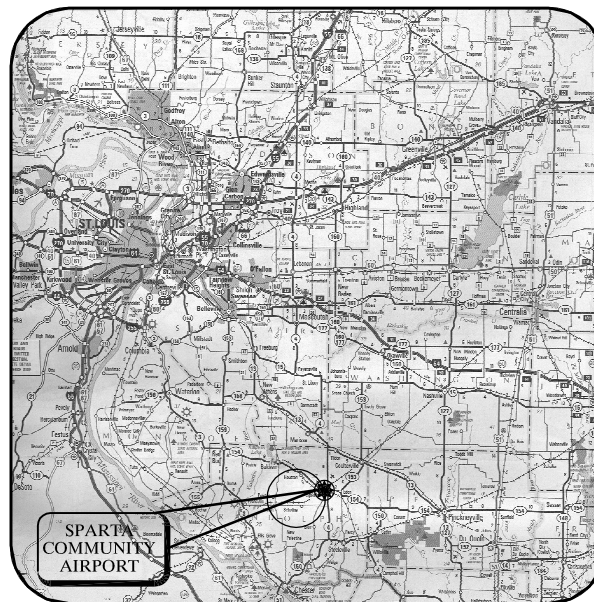

LOCATION MAP

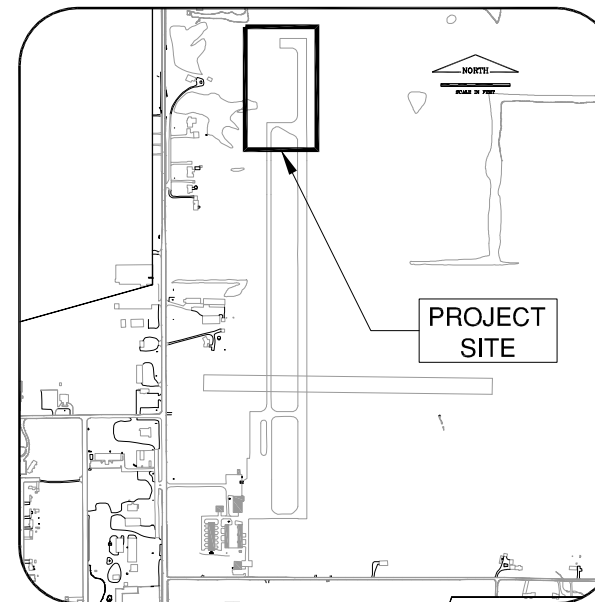

SITE PLAN

Exp. 11/30/2013

CHRISTOPHER B. GRATH
 062-056232
 LICENSED PROFESSIONAL ENGINEER OF ILLINOIS

Christopher B. Grath
 3/18/2013

**SPARTA COMMUNITY AIRPORT
 SPARTA, ILLINOIS**

APPROVED *Christopher B. Grath*

DATE 3/13/13 2013

CMT
CRAWFORD MURPHY & TILLY, INC.
 CONSULTING ENGINEERS

■ SPRINGFIELD, IL ■ AURORA, IL ■ ST. LOUIS, MO

SUBMITTED BY *Christopher B. Grath*

DATE: 3/18/2013

CMT JOB NUMBER 12412-01-00

SP023

REVISIONS		
NUMBER	BY	DATE

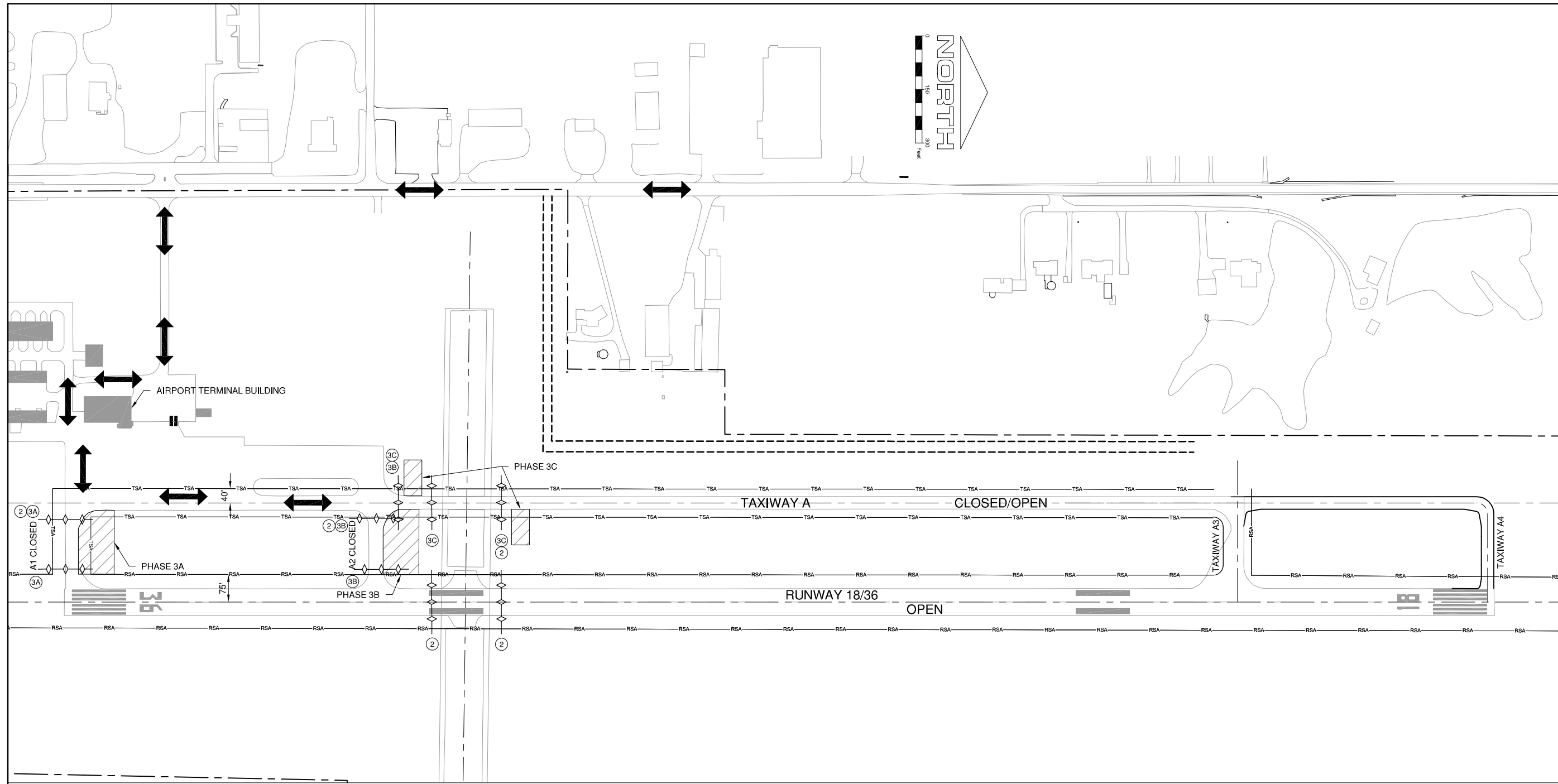
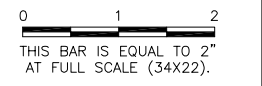

**SPARTA COMMUNITY AIRPORT
 HUNTER FIELD
 SPARTA, ILLINOIS**

**TAXIWAY EXTENSION
 CONSTRUCTION ACTIVITY PLAN 3**

PHASE 3 NOTES:

1. PHASE 3 SHALL CONSIST OF ELECTRICAL IMPROVEMENTS, INCLUDING REMOVING EXISTING SIGNS & REPLACING THEM WITH NEW SIGNS & ASSOCIATED CABLING.
2. WORK WITHIN THESE PHASES WILL BE OUTSIDE THE RUNWAY SAFETY AREA BUT WITHIN THE TAXIWAY SAFETY AREA.
3. WORK WITHIN THE SUB PHASED 3A, 3B, 3C SHALL NOT BE CONSTRUCTED CONCURRENTLY. THE AIRPORT SHALL REQUIRE OPEN ACCESS TO RUNWAY 18/36 AT ALL TIMES.
4. CONTRACTOR SHALL ACCESS THE SITE THRU THE PAVEMENTS NEAR THE AIRPORT BUILDINGS.
5. CONTRACTOR SHALL HAVE SUFFICIENT MEANS ON SITE TO CLEAN THE PAVEMENTS DURING THIS PHASE.

LEGEND

	WORK AREA
	CONTRACTOR'S ACCESS
	CONTRACTOR'S HAUL ROUTE
	PROPERTY LINE
	CONSTRUCTION SET BACK STAKES
	BARRICADES

© Copyright CMT, Inc.

CMT
 CRAWFORD, MURPHY & TILLY, INC.
 CONSULTING ENGINEERS
 License No. 184-000613



DESIGN BY:	CBG
DRAWN BY:	CMT
CHECKED BY:	CET
APPROVED BY:	CET
DATE:	MARCH 1, 2013
JOB No:	1241201

IL. PROJ. NO. SAR-4224
 SBG NO. 3-17-0094-B11