

SUMMARY OF QUANTITIES			URBAN TOTAL QUANTITIES	CONSTRUCTION TYPE CODE				
CODE NO	ITEM	UNIT		90% FED 10% STATE 0004 ROADWAY	90% FED 5% STATE 5% DUPAGE COUNTY 0021 SIGNALS	100% VILLAGE OF BARTLETT 0021 EVP	80% FED 20% VILLAGE OF BARTLETT 0021 PATH	
40600985	PORTLAND CEMENT CONCRETE SURFACE REMOVAL - BUTT JOINT	SO YD	859	859				
40603335	HOT-MIX ASPHALT SURFACE COURSE, MIX "D", N50	TON	284	42		242		
40603565	POLYMERIZED HOT-MIX ASPHALT SURFACE COURSE, MIX "E", N70	TON	751	751				
42000511	PORTLAND CEMENT CONCRETE PAVEMENT 10 1/2" (JOINTED)	SO YD	2551	2551				
42001300	PROTECTIVE COAT	SO YD	5099	5073		26		
42300600	PORTLAND CEMENT CONCRETE DRIVEWAY PAVEMENT, 10 INCH	SO YD	138	138				
42400200	PORTLAND CEMENT CONCRETE SIDEWALK 5 INCH	SO FT	307	76		231		
* 42400800	DETECTABLE WARNINGS	SO FT	290	16		274		
44000100	PAVEMENT REMOVAL	SO YD	4784	4784				
44000200	DRIVEWAY PAVEMENT REMOVAL	SO YD	594	594				
44000500	COMBINATION CURB AND GUTTER REMOVAL	FOOT	8237	8237				
44000600	SIDEWALK REMOVAL	SO FT	75	75				
44003100	MEDIAN REMOVAL	SO FT	28331	28331				

SUMMARY OF QUANTITIES			URBAN TOTAL QUANTITIES	CONSTRUCTION TYPE CODE				
CODE NO	ITEM	UNIT		90% FED 10% STATE 0004 ROADWAY	90% FED 5% STATE 5% DUPAGE COUNTY 0021 SIGNALS	100% VILLAGE OF BARTLETT 0021 EVP	80% FED 20% VILLAGE OF BARTLETT 0021 PATH	
44004250	PAVED SHOULDER REMOVAL	SO YD	545	545				
44200966	CLASS B PATCHES, TYPE I, 10 INCH	SO YD	5	5				
44200970	CLASS B PATCHES, TYPE II, 10 INCH	SO YD	103	103				
44200978	CLASS B PATCHES, TYPE I, 11 INCH	SO YD	30	30				
44200982	CLASS B PATCHES, TYPE II, 11 INCH	SO YD	227	227				
44201299	DOWEL BARS 1 1/2"	EACH	907	907				
44201765	CLASS D PATCHES, TYPE II, 10 INCH	SO YD	342	342				
44201769	CLASS D PATCHES, TYPE III, 10 INCH	SO YD	452	452				
44201771	CLASS D PATCHES, TYPE IV, 10 INCH	SO YD	76	76				
50100100	REMOVAL OF EXISTING STRUCTURES	EACH	2	2				
50105220	PIPE CULVERT REMOVAL	FOOT	128	128				
50500505	STUD SHEAR CONNECTORS	EACH	235	235				
50800205	REINFORCEMENT BARS, EPOXY COATED	POUND	5900	5900				
52200100	FURNISHING SOLDIER PILES (HP SECTION)	FOOT	1290	1290				
52200150	DRIVING SOLDIER PILES	FOOT	1290	1290				
* SPECIALTY ITEMS								

FILE NAME =	USER NAME = ka1orm	DESIGNED	REVISED
pw\planroom.dot,illinois.gov\PIDOT\Documents\IDOT Offices\District 1\Projects\P105044\Drawings\Design\P105014-sht-500.dgn		REVISION	REVISION
PLOT SCALE = 100.0000' / 1in.	CHECKED	REVISION	REVISION
PLOT DATE = 3/21/2019	DATE	REVISION	REVISION

STATE OF ILLINOIS
DEPARTMENT OF TRANSPORTATION

IL 59 AT ARMY TRAIL ROAD
SUMMARY OF QUANTITIES

SCALE: SHEET NO. OF SHEETS STA. TO STA.

F.A.P. RTE.	SECTION	COUNTY	TOTAL SHEETS	SHEET NO.
338	110TS-N	DUPAGE	133	4
CONTRACT NO. 62F19				
FED. ROAD DIST. NO. 1 ILLINOIS FED. AID PROJECT				

SUMMARY OF QUANTITIES			URBAN TOTAL QUANTITIES	CONSTRUCTION TYPE CODE				
CODE NO	ITEM	UNIT		90% FED 10% STATE 0004 ROADWAY	90% FED 5% STATE 5% DUPAGE COUNTY 0021 SIGNALS	100% VILLAGE OF BARTLETT 0021 EVP	80% FED 20% VILLAGE OF BARTLETT 0021 PATH	
60201330	CATCH BASINS, TYPE A, 4'-DIAMETER, TYPE 23 FRAME AND GRATE	EACH	3	3				
60201340	CATCH BASINS, TYPE A, 4" DIAMETER, TYPE 24 FRAME AND GRATE	EACH	7	7				
60207605	CATCH BASINS, TYPE C, TYPE 8 GRATE	EACH	1	1				
60221100	MANHOLES, TYPE A, 5'-DIAMETER, TYPE 1 FRAME, CLOSED LID	EACH	10	10				
60223800	MANHOLES, TYPE A, 6'-DIAMETER, TYPE 1 FRAME, CLOSED LID	EACH	1	1				
60237460	INLETS, TYPE A, TYPE 23 FRAME AND GRATE	EACH	6	6				
60237470	INLETS, TYPE A, TYPE 24 FRAME AND GRATE	EACH	6	6				
60250200	CATCH BASINS TO BE ADJUSTED	EACH	3	3				
60251740	CATCH BASINS TO BE ADJUSTED WITH NEW TYPE 24 FRAME AND GRATE	EACH	1	1				
60500040	REMOVING MANHOLES	EACH	10	10				
60500050	REMOVING CATCH BASINS	EACH	1	1				
60500060	REMOVING INLETS	EACH	39	39				
60300105	FRAMES AND GRATES TO BE ADJUSTED	EACH	4	4				
60500070	REMOVING MANHOLES TO MAINTAIN FLOW	EACH	1	1				
60300305	FRAMES AND LIDS TO BE ADJUSTED	EACH	1	4				
60500105	FILLING MANHOLES	EACH	3	3				
60603800	COMBINATION CONCRETE CURB AND GUTTER, TYPE B-6.12	FOOT	299	299				
60605000	COMBINATION CONCRETE CURB AND GUTTER, TYPE B-6.24	FOOT	4122.5	4122.5				
60608300	COMBINATION CONCRETE CURB AND GUTTER, TYPE M-2.12	FOOT	4088.9	4088.9				

SUMMARY OF QUANTITIES			URBAN TOTAL QUANTITIES	CONSTRUCTION TYPE CODE				
CODE NO	ITEM	UNIT		90% FED 10% STATE 0004 ROADWAY	90% FED 5% STATE 5% DUPAGE COUNTY 0021 SIGNALS	100% VILLAGE OF BARTLETT 0021 EVP	80% FED 20% VILLAGE OF BARTLETT 0021 PATH	
60618320	CONCRETE MEDIAN SURFACE, 6 INCH	SO FT	1749	1749				
60626300	STABILIZED MEDIAN SURFACE	SO YD	4062	4062				
* 63000001	STEEL PLATE BEAM GUARDRAIL, TYPE A, 6 FOOT POSTS	FOOT	337.5	337.5				
* 63100045	TRAFFIC BARRIER TERMINAL, TYPE 2	EACH	1	1				
* 63100167	TRAFFIC BARRIER TERMINAL, TYPE 1 (SPECIAL) TANGENT	EACH	2	2				
63200310	GUARDRAIL REMOVAL	FOOT	439	439				
* 66900200	NON-SPECIAL WASTE DISPOSAL	CU YD	4740	4740				
* 66900530	SOIL DISPOSAL ANALYSIS	EACH	5	5				
* 66901001	REGULATED SUBSTANCES PRE-CONSTRUCTION PLAN	LSUM	1	1				
* 66901002	ON-SITE MONITORING OF REGULATED SUBSTANCES	CAL DA	11	11				
* 66901003	REGULATED SUBSTANCES FINAL CONSTRUCTION REPORT	LSUM	1	1				
67000400	ENGINEER'S FIELD OFFICE, TYPE A	CAL MO	18	18				
67100100	MOBILIZATION	L SUM	1	1				
* SPECIALTY ITEMS								

FILE NAME =	USER NAME = ka1orm	DESIGNED	REVISED
p:\planning\dot\illinois.gov\PIDOT\Documents\IDOT Offices\District 1\Projects\P105044\Drawings\Design\P105014-sht-500.dgn		CHECKED	REVISED
	PLOT SCALE = 100.0000' / 1in.	DATE	REVISED
	PLOT DATE = 3/21/2019		

STATE OF ILLINOIS
DEPARTMENT OF TRANSPORTATION

IL 59 AT ARMY TRAIL ROAD
SUMMARY OF QUANTITIES

SCALE: SHEET NO. OF SHEETS STA. TO STA.

F.A.P. RTE.	SECTION	COUNTY	TOTAL SHEETS	SHEET NO.
338	110TS-N	DUPAGE	133	6
CONTRACT NO. 62F19				
FED. ROAD DIST. NO. 1 ILLINOIS FED. AID PROJECT				

SUMMARY OF QUANTITIES			URBAN TOTAL QUANTITIES	CONSTRUCTION TYPE CODE			
CODE NO	ITEM	UNIT		90% FED 10% STATE 0004 ROADWAY	90% FED 5% STATE 5% DUPAGE COUNTY 0021 SIGNALS	100% VILLAGE OF BARTLETT 0021 EVP	80% FED 20% VILLAGE OF BARTLETT 0021 PATH
X8710024	FIBER OPTIC CABLE IN CONDUIT, NO. 62.5/125, MM12F SM24F	FOOT	6136	6136			
Z0013798	CONSTRUCTION LAYOUT	L SUM	1	1			
Z0030850	TEMPORARY INFORMATION SIGNING	SO FT	102.8	102.8			
Z0033056	OPTIMIZE TRAFFIC SIGNAL SYSTEM	EACH	1	1			
Z0046304	PIPE UNDERDRAINS FOR STRUCTURES 4"	FOOT	415	415			
Z0062456	TEMPORARY PAVEMENT	SO YD	3326	3326			
Z0073510	TEMPORARY TRAFFIC SIGNAL TIMING	EACH	1	1			
X1700088	PRECAST NOISE WALL PANEL REMOVAL, MODIFICATION, & RE-INSTALLATION	L SUM	2	2			
Z0076600	TRAINEES	HOUR	1000	1000			
Z0076604	TRAINEES TRAINING PROGRAM GRADUATE	HOUR	1000	1000			
	PRECAST NOISE WALL PANEL REMOVAL, MODIFICATION, & REINSTALLATION, LOCATION 1	L SUM	1	1			
	PRECAST NOISE WALL PANEL REMOVAL, MODIFICATION, & REINSTALLATION, LOCATION 2	L SUM	1	1			

SUMMARY OF QUANTITIES			URBAN TOTAL QUANTITIES	CONSTRUCTION TYPE CODE			
CODE NO	ITEM	UNIT		90% FED 10% STATE 0004 ROADWAY	90% FED 5% STATE 5% DUPAGE COUNTY 0021 SIGNALS	100% VILLAGE OF BARTLETT 0021 EVP	80% FED 20% VILLAGE OF BARTLETT 0021 PATH
SPECIALTY ITEMS							

FILE NAME =	USER NAME = kaorm	DESIGNED	REVISED
p:\planning\dot.illinois.gov\PI0504\Drawings\Design\PI0504-shr-500.dgn		REVISED	REVISED
PLOT SCALE = 100.0000' / 1in.	CHECKED	REVISED	REVISED
PLOT DATE = 3/21/2019	DATE	REVISED	REVISED

STATE OF ILLINOIS
DEPARTMENT OF TRANSPORTATION

IL 59 AT ARMY TRAIL ROAD
SUMMARY OF QUANTITIES

SCALE: SHEET NO. OF SHEETS STA. TO STA.

F.A. RTE.	SECTION	COUNTY	TOTAL SHEETS	SHEET NO.
338	110TS-N	DUPAGE	133	11
CONTRACT NO. 62F19				
FED. ROAD DIST. NO. 1 ILLINOIS FED. AID PROJECT				

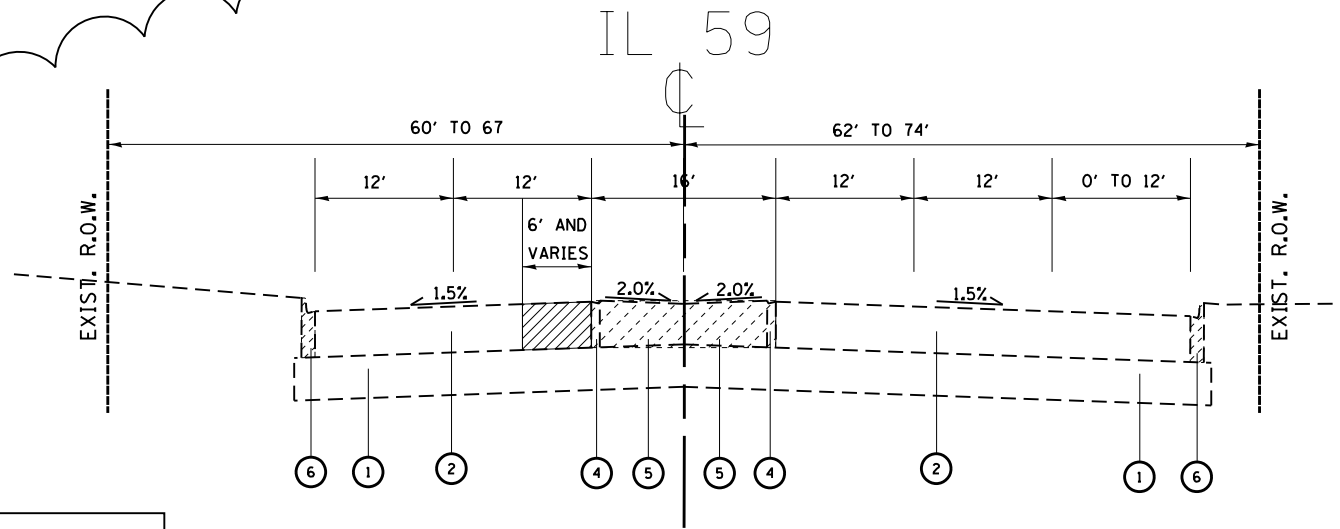

IL 59 (SUTTON ROAD)
EXISTING TYPICAL SECTION
STA. 490+00 TO STA. 494+36

LEGEND:

- MEDIAN REMOVAL
M2.12 CURB AND GUTTER REMOVAL
B6.24 CURB AND GUTTER REMOVAL
- PAVEMENT REMOVAL

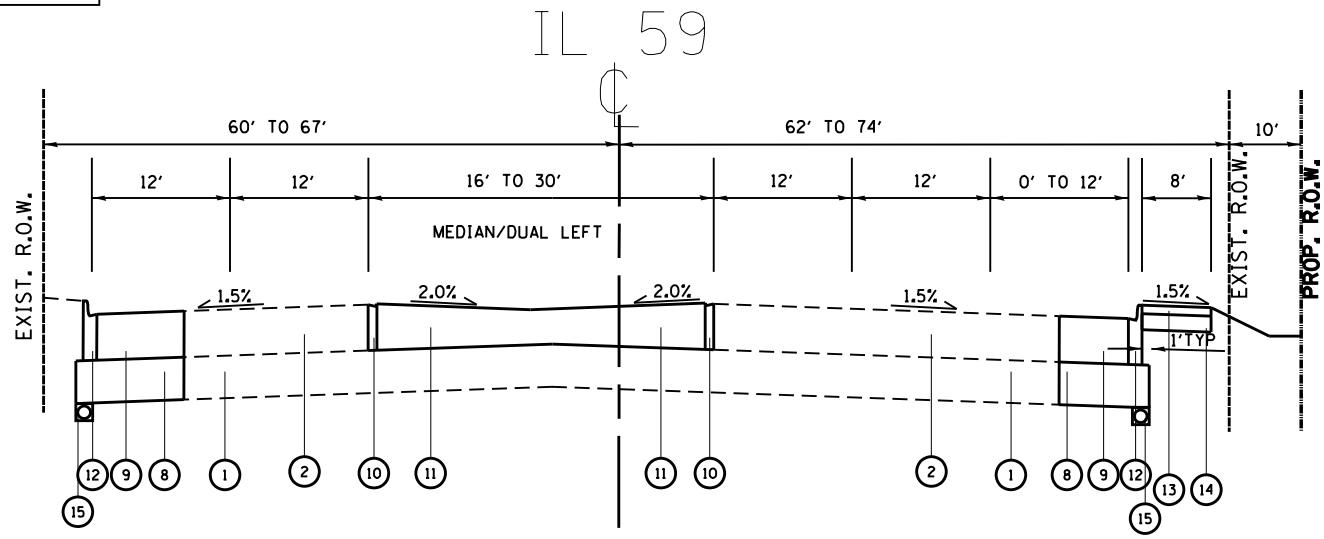

IL 59 (SUTTON ROAD)
PROPOSED TYPICAL SECTION
STA. 490+00 TO STA. 494+36

EXISTING CONDITIONS:

- ① EXISTING AGGREGATE SUBGRADE, 12"
- ② EXISTING PCC PAVEMENT (JOINTED), 10 1/2"
- ③ EXISTING PCC PAVEMENT (JOINTED), 10"
- ④ EXISTING M-2.12 CURB AND GUTTER
- ⑤ MOUNTABLE MEDIAN/LEFT TURN LANE
- ⑥ EXISTING B-6.24 CURB AND GUTTER
- ⑦ EXISTING HMA SHOULDER, 10"

PROPOSED CONDITIONS:

- ⑧ PROPOSED AGGREGATE SUBGRADE IMPROVEMENT, 12"
- ⑨ PROPOSED PCC PAVEMENT (JOINTED), 10 1/2"
- ⑨A PROPOSED HOT MIX ASPHALT SURFACE REMOVAL (VARIABLE DEPTH)
- ⑩ PROPOSED COMBINATION CONCRETE CURB AND GUTTER, TYPE M-2.12
- ⑪ PROPOSED STABILIZED MEDIAN SURFACE
- ⑫ PROPOSED COMBINATION CONCRETE CURB AND GUTTER, TYPE B-6.24
- ⑬ PROPOSED HMA BIKE PATH, HMA SURFACE COURSE, MIX "D" N50, 2"
- ⑭ PROPOSED AGGREGATE BASE COURSE, TYPE B, 6"
- ⑮ PIPE UNDERDRAINS, TYPE 2, 4"
- ⑯ PROPOSED HMA BASE COURSE, 7 1/2"
- ⑰ PROPOSED POLYMERIZED LEVELING BINDER (MM), IL-4.75, N50, 3/4"
- ⑱ PROPOSED POLYMERIZED HMA SURFACE COURSE, MIX "E", N70, 1 3/4"

HOT-MIX ASPHALT MIXTURE REQUIREMENTS			
ITEM	MIXTURE TYPE	AIR VOIDS @ Ndes	QUALITY MANAGEMENT PROGRAM (OMP)
PAVEMENT WIDENING (ARMY TRAIL RD.)	POLYMERIZED HMA SURFACE COURSE, MIX "E", N70, 1 3/4", (IL-9.5 mm)	4% @ 70 GYR.	QC/OA
	POLYMERIZED LEVELING BINDER (MM), IL-4.75, N50; 3/4"	3.5% @ 50 GYR.	QC/OA
	HMA BASE COURSE, 7 1/2" (HMA BINDER IL-19)	4% @ 90 GYR	QC/OA
PAVEMENT RESURFACING (ARMY TRAIL RD.)	POLYMERIZED HMA SURFACE COURSE, MIX "E", N70, 1 3/4", (IL-9.5 mm)	4% @ 70 GYR.	QC/OA
	POLYMERIZED LEVELING BINDER (MM), IL-4.75, N50; 3/4"	3.5% @ 50 GYR.	QC/OA
SHARED USE PATH/ DRIVEWAYS	HMA SURFACE COURSE, MIX "D", N50, 2" (IL-9.5 MM)	4% @ 50 GYR	QC/OA
DRIVEWAYS	HMA BASE COURSE (HMA BINDER IL-19 MM); PE-6"; CE-8"	4% @ 50 GYR	QC/OA
TEMPORARY PAVEMENT	HMA BINDER COURSE, IL 19.0, N70, 8"	4% @ 70 GYR	QC/OA
	HMA SURFACE COURSE, MIX "D", N70, 2" (IL-9.5 MM)	4% @ 70 GYR	QC/OA
STABILIZED MEDIAN SURFACE	HMA BINDER COURSE, IL 19.0, N70, 8 1/2"	4% @ 70 GYR	QC/OA
	HMA SURFACE COURSE, MIX "D", N70, 2" (IL-9.5 MM)	4% @ 70 GYR	QC/OA
PATCHING	CLASS D PATCHES (HMA BINDER IL-19 mm)	4% @ 70 GYR	QC/OA

OMP DESIGNATION: QUALITY CONTROL/QUALITY ASSURANCE (QC/OA); QUALITY CONTROL FOR PERFORMANCE (QCP); PAY FOR PERFORMANCE (PFP)

NOTES:

NOTE 1: THE UNIT WEIGHT USED TO CALCULATE ALL HMA SURFACE QUANTITIES IS 112 LBS/SQ YD/IN.

QUALITY MANAGEMENT PROGRAM (OMP) IDENTIFIES THE PARTICULAR QUALITY CONTROL SPECIFICATION THAT APPLIES TO THE HMA MIXTURE.

NOTE 2: THE "AC TYPE" FOR POLYMERIZED HMA MIXES SHALL BE "SBS/SBR PG 76-22" AND FOR NON POLYMERIZED HMA THE "AC TYPE" SHALL BE "PG 64-22" UNLESS MODIFIED BY DISTRICT ONE SPECIAL PROVISIONS

PC CONCRETE TEMPORARY PAVEMENT SHALL CONSIST OF CLASS PV CONCRETE MEETING THE REQUIREMENTS OF ART. 1020 OF THE STANDARD SPECIFICATIONS. TEMPORARY PCC PAVEMENT DOES NOT REQUIRE DOWEL BARS.

FOR USE OF RECYCLED MATERIALS SEE DISTRICT ONE SPECIAL PROVISIONS.

TEMPORARY PAVEMENT IS 10" THICK FOR BOTH HMA AND PCC

FILE NAME =	USER NAME = kalorm	DESIGNED -	REVISED -
pw:\planroom.dot.illinois.gov\PIDOT\Documents\IDOT Offices\District 1\Projects\P105014\Design\PI105014-sht-typical.dgn		DRAWN	REVISOR - RK - 05/31/2019
PLOT SCALE = 100.0000' / in.	CHECKED -	REVISOR -	REVISOR -
Default	DATE -	REVISOR -	REVISOR -

STATE OF ILLINOIS
DEPARTMENT OF TRANSPORTATION

ILLINOIS ROUTE 59 (SUTTON ROAD) AT ARMY TRAIL ROAD
EXISTING AND PROPOSED TYPICAL SECTIONS
SCALE: NONE SHEET 1 OF 1 SHEETS STA. TO STA.

F.A.P. RTE.	SECTION	COUNTY	TOTAL SHEETS	SHEET NO.
338	110TS-N		133	12
CONTRACT NO. 62F19			ILLINOIS FED. AID PROJECT	

IL 59

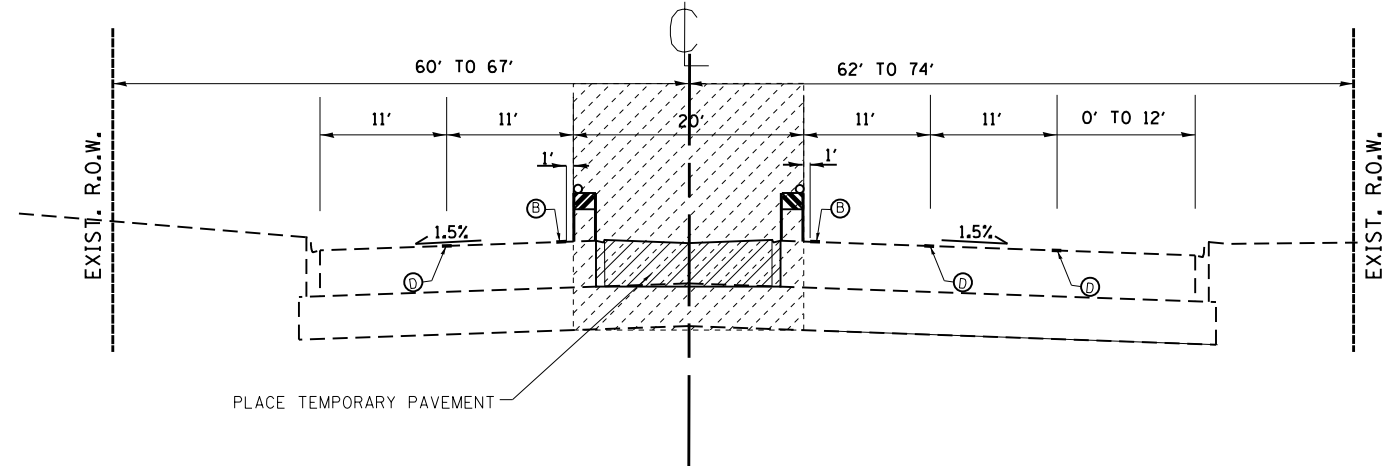

IL 59 (SUTTON ROAD)
PRE-STAGE
 STA. 487+50 TO STA. 494+36

PRE-STAGE: MEDIAN REMOVAL

- REMOVE EXISTING MEDIAN ALONG IL 59
- PLACE TEMPORARY HMA OR PCC PAVEMENT
- PROVIDE TWO 11 FT. TRAVEL LANES AND A TURN LANE IN EACH DIRECTION
- PLACE TYPE I BARRICADES (NARROW) TO PROTECT TRAFFIC FROM THE CONSTRUCTION ZONE

IL 59

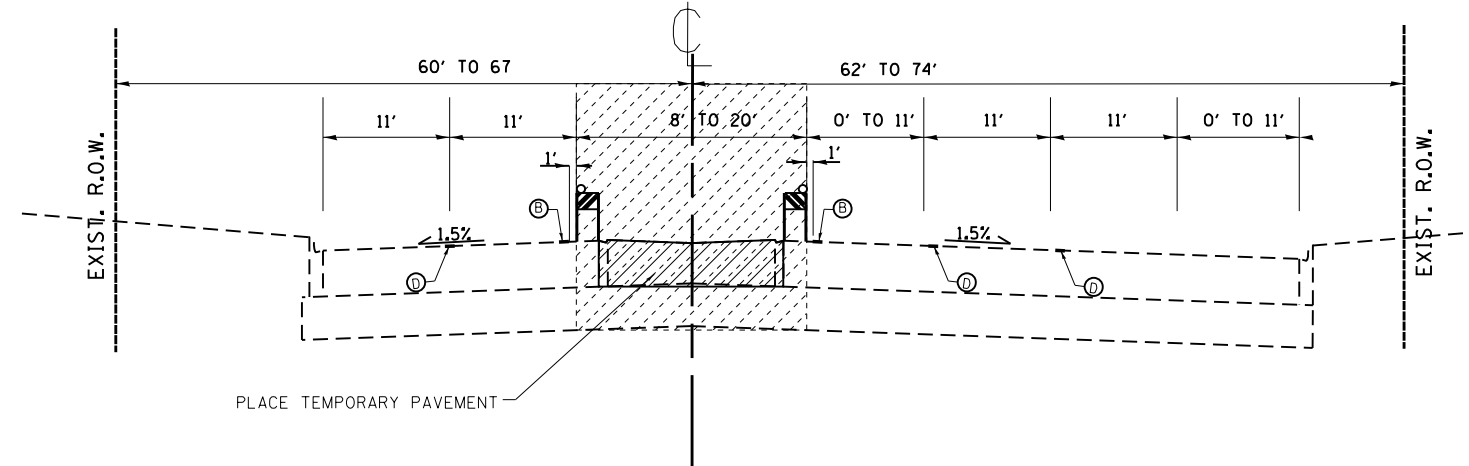

IL 59 (SUTTON ROAD)
PRE-STAGE
 STA. 494+36 TO STA. 500+00

IL 59

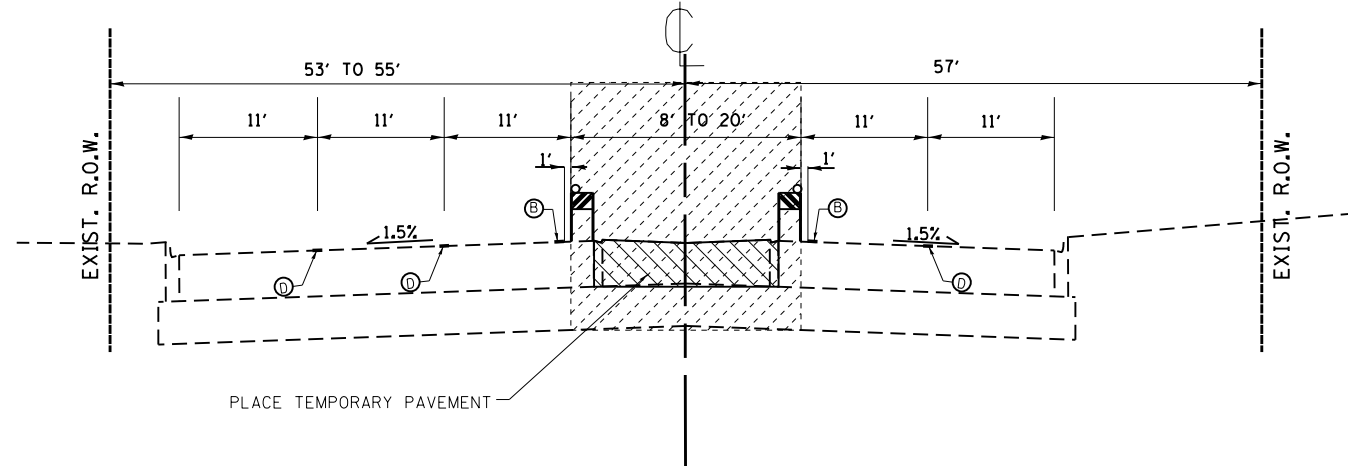

IL 59 (SUTTON ROAD)
PRE-STAGE
 STA. 500+00 TO STA. 505+97

IL 59

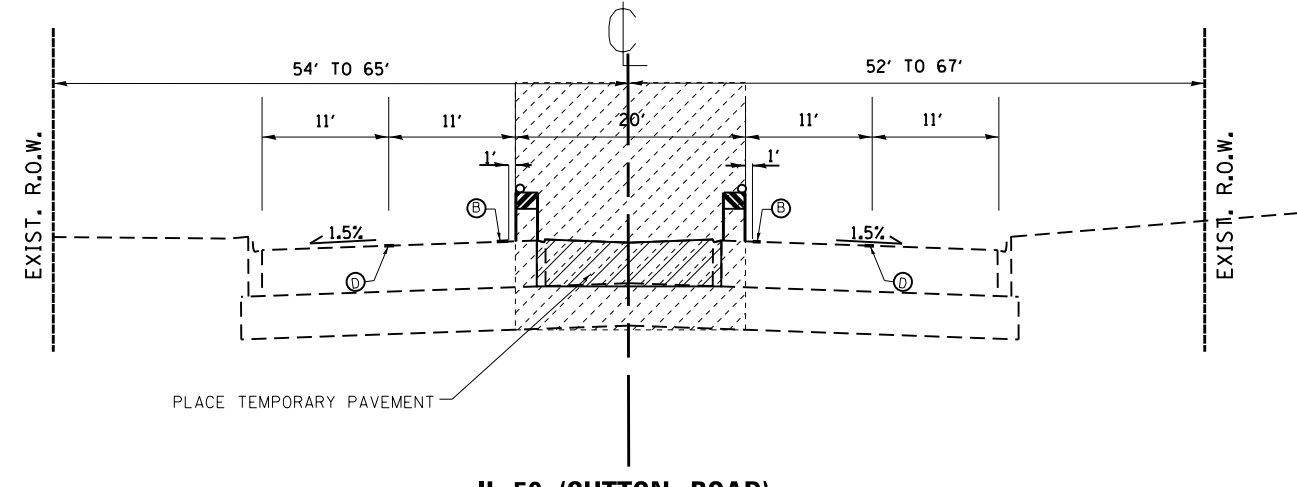



IL 59 (SUTTON ROAD)
PRE-STAGE
 STA. 505+97 TO STA. 511+00

LEGEND:

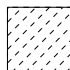
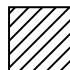
- (A) TEMPORARY PAVEMENT MARKING, TYPE IV 6" SOLID WHITE EDGE LINE/WHITE LANE LINE
- (B) TEMPORARY PAVEMENT MARKING, TYPE IV 4" SOLID YELLOW EDGE LINE
- (C) TEMPORARY PAVEMENT MARKING, TYPE IV 4" SOLID DOUBLE YELLOW @ 11" C-C
- (D) TEMPORARY PAVEMENT MARKING, TYPE IV 4" SKIP DASH WHITE LANE LINE 10' LINE, 30' SKIP
- (E) TEMPORARY PAVEMENT MARKING, TYPE IV 4" SOLID WHITE EDGE LINE

 WORK ZONE
  MEDIAN REMOVAL

 TEMPORARY CONCRETE BARRIER

 DRUMS OR TY II BARRICADE AT 50 FT SPACING DEVICES IN TAPER (20 FT C-C) DEVICES IN CURVES & RADII (25 FT C-C)

NOTES:

TRAFFIC ALONG IL 59 AND ARMY TRAIL RD. SHALL BE MAINTAINED DURING THE WIDENING AND RESURFACING OPERATIONS BY STAGING THE CONSTRUCTION.

IMPACT ATTENUATORS UTILIZED IN WINTER MONTHS MUST NOT BE AFFECTED BY WINTER TEMPS

FILE NAME =	USER NAME = kalorm	DESIGNED -	REVISED -  RK - 05/31/2019
pw:\planroom.dot.illinois.gov\PIDOT\Documents\IDOT Offices\District 1\Projects\PI05014\Design\PI05014-sht-typical.dgn		DRAWN -	REVISED -
Default	PLOT SCALE = 100.0000' / 1in.	CHECKED -	REVISED -
	PLOT DATE = 5/24/2019	DATE -	REVISED -

STATE OF ILLINOIS
DEPARTMENT OF TRANSPORTATION

ILLINOIS ROUTE 59 (SUTTON ROAD) AT ARMY TRAIL ROAD
PRE-STAGE TYPICAL SECTIONS

SCALE: NONE SHEET 1 OF 1 SHEETS STA. TO STA.

F.A.P. RTE.	SECTION	COUNTY	TOTAL SHEETS	SHEET NO.
338	110TS-N		133	23
			CONTRACT NO. 62F19	
ILLINOIS FED. AID PROJECT				

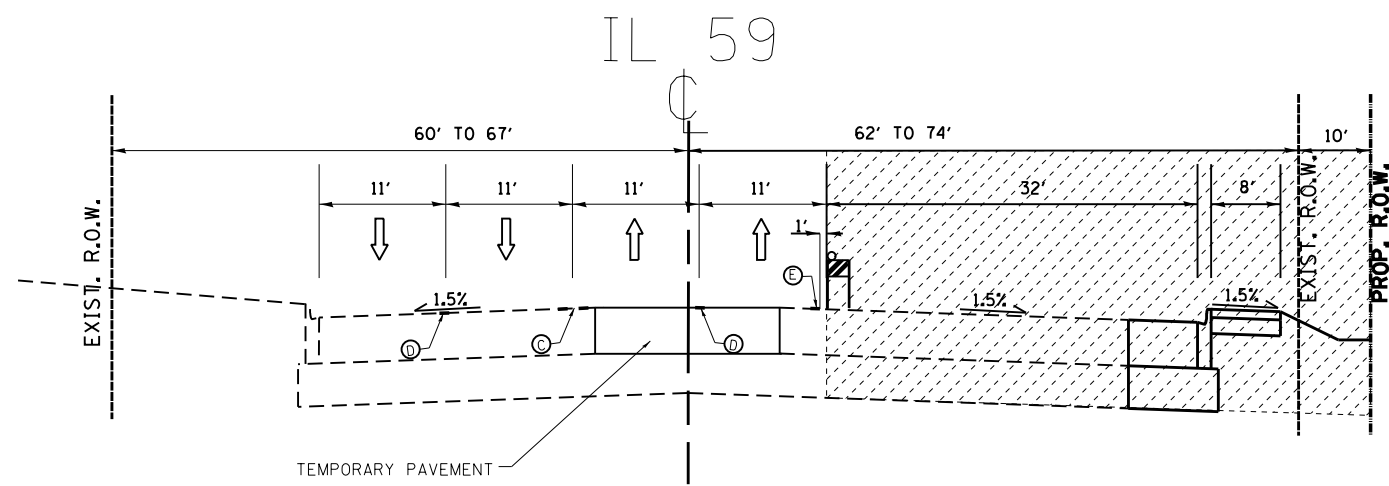

IL 59 (SUTTON ROAD)
STAGE 1
 STA. 487+50 TO STA. 494+36

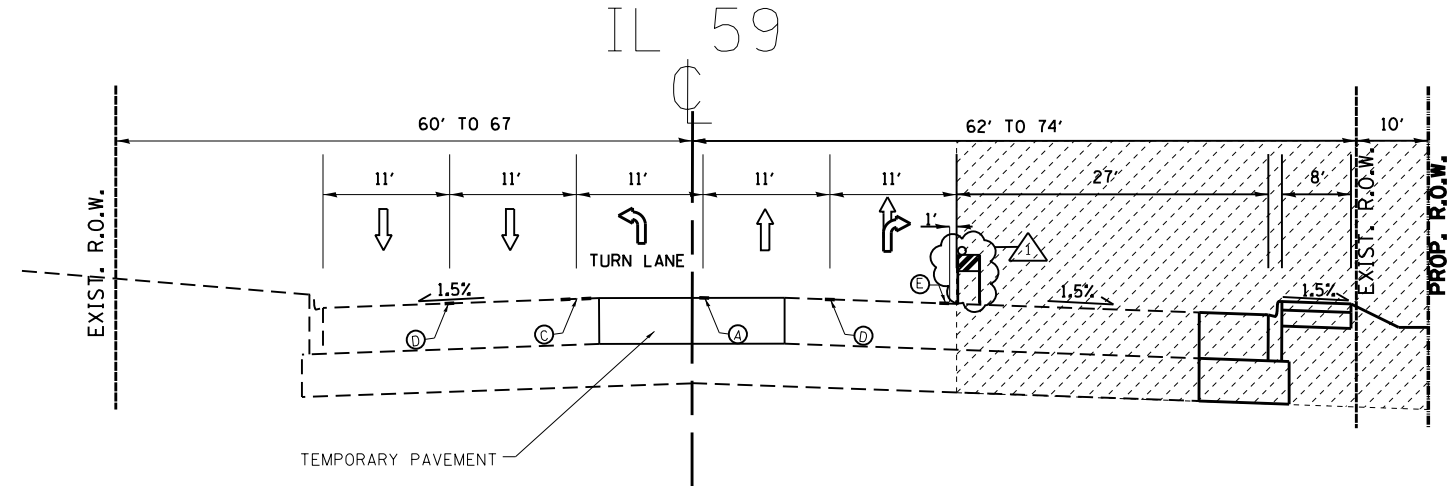

IL 59 (SUTTON ROAD)
STAGE 1
 STA. 494+36 TO STA. 500+00

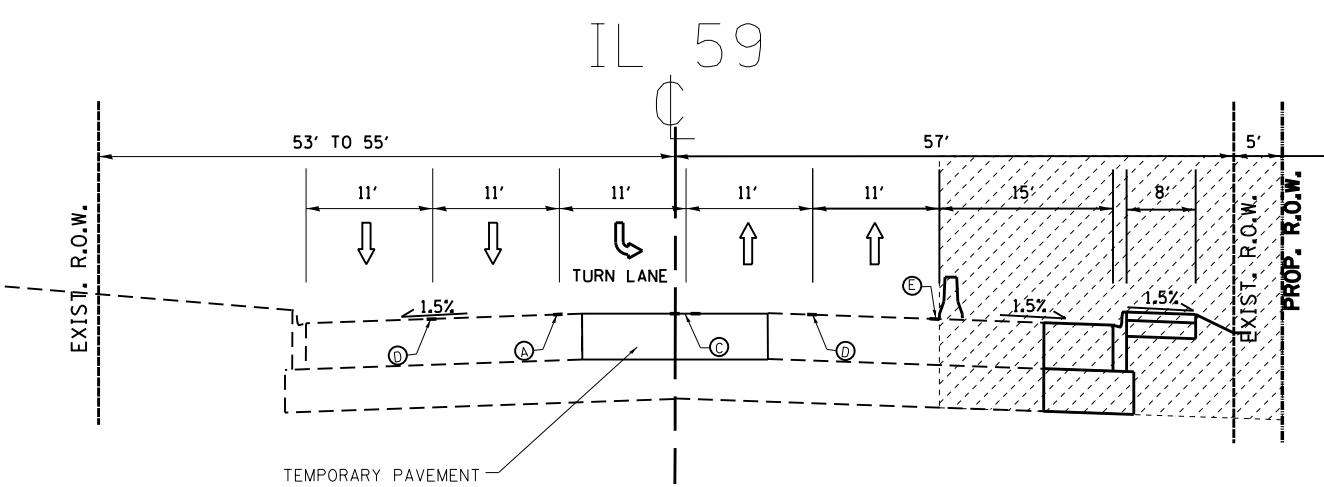

IL 59 (SUTTON ROAD)
STAGE 1
 STA. 500+00 TO STA. 505+97

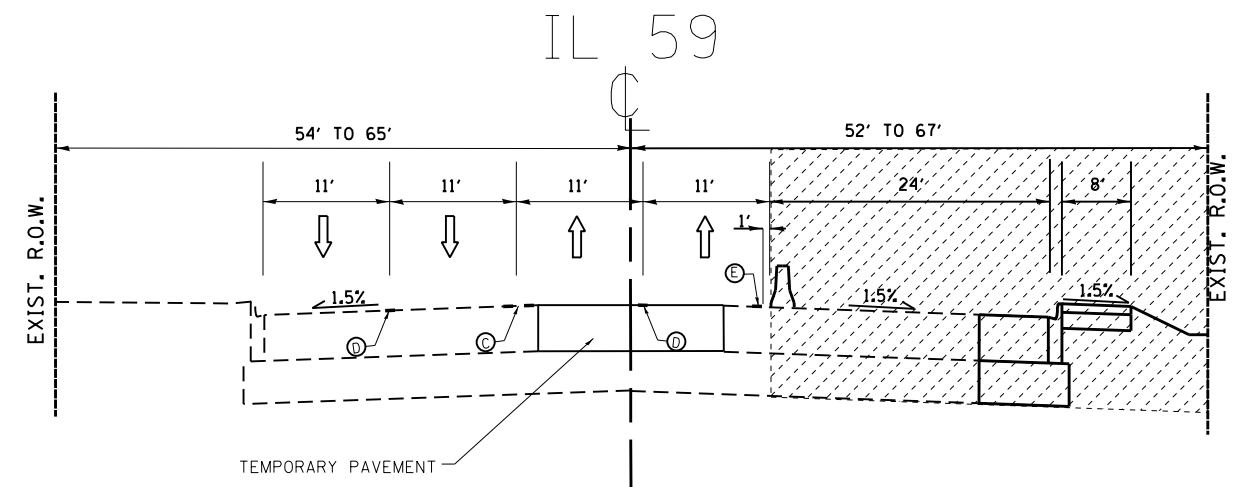

IL 59 (SUTTON ROAD)
STAGE 1
 STA. 505+97 TO STA. 511+00

LEGEND:

- (A) TEMPORARY PAVEMENT MARKING, TYPE IV 6" SOLID WHITE EDGE LINE/WHITE LANE LINE
- (B) TEMPORARY PAVEMENT MARKING, TYPE IV 4" SOLID YELLOW EDGE LINE
- (C) TEMPORARY PAVEMENT MARKING, TYPE IV 4" SOLID DOUBLE YELLOW @ 11" C-C
- (D) TEMPORARY PAVEMENT MARKING, TYPE IV 4" SKIP DASH WHITE LANE LINE 10' LINE, 30' SKIP
- (E) TEMPORARY PAVEMENT MARKING, TYPE IV 4" SOLID WHITE EDGE LINE

WORK ZONE MEDIAN REMOVAL

TEMPORARY CONCRETE BARRIER

DRUMS OR TY II BARRICADE AT 50 FT SPACING DEVICES IN TAPER (20 FT C-C) DEVICES IN CURVES & RADII (25 FT C-C)

STAGE 1 (EAST SIDE CONSTRUCTION):

- PROVIDE TWO 11 FT. TRAVEL LANES AND A TURN LANE IN EACH DIRECTION
- PLACE TEMPORARY CONCRETE BARRIER, DRUMS, OR TYPE II BARRICADE TO PROTECT TRAFFIC FROM THE CONSTRUCTION ZONE
- WESTBOUND TRAFFIC WILL BE REDUCED TO ONE LANE TO CONSTRUCT RIGHT TURN LANE
- CONSTRUCT BIKE PATH, TRAFFIC SIGNAL, CURB AND GUTTER, AND NEW PAVEMENT

NOTES:

TRAFFIC ALONG IL 59 AND ARMY TRAIL RD. SHALL BE MAINTAINED DURING THE WIDENING AND RESURFACING OPERATIONS BY STAGING THE CONSTRUCTION.

IMPACT ATTENUATORS UTILIZED IN WINTER MONTHS MUST NOT BE AFFECTED BY WINTER TEMPS

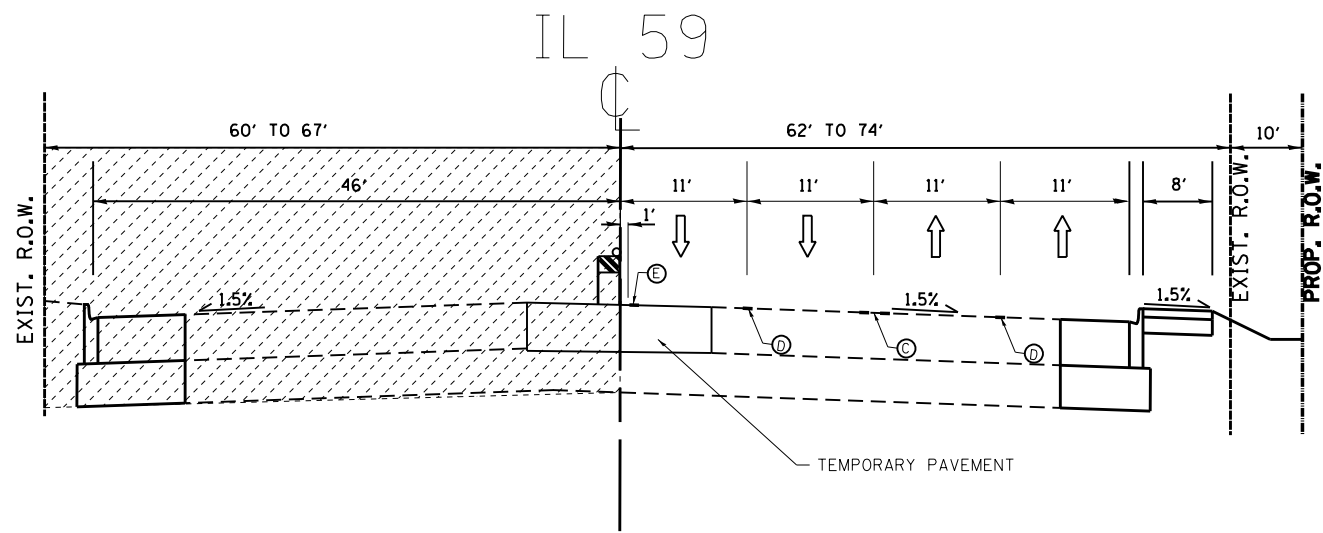

IL 59 (SUTTON ROAD)
STAGE 2
 STA. 487+50 TO STA. 494+36

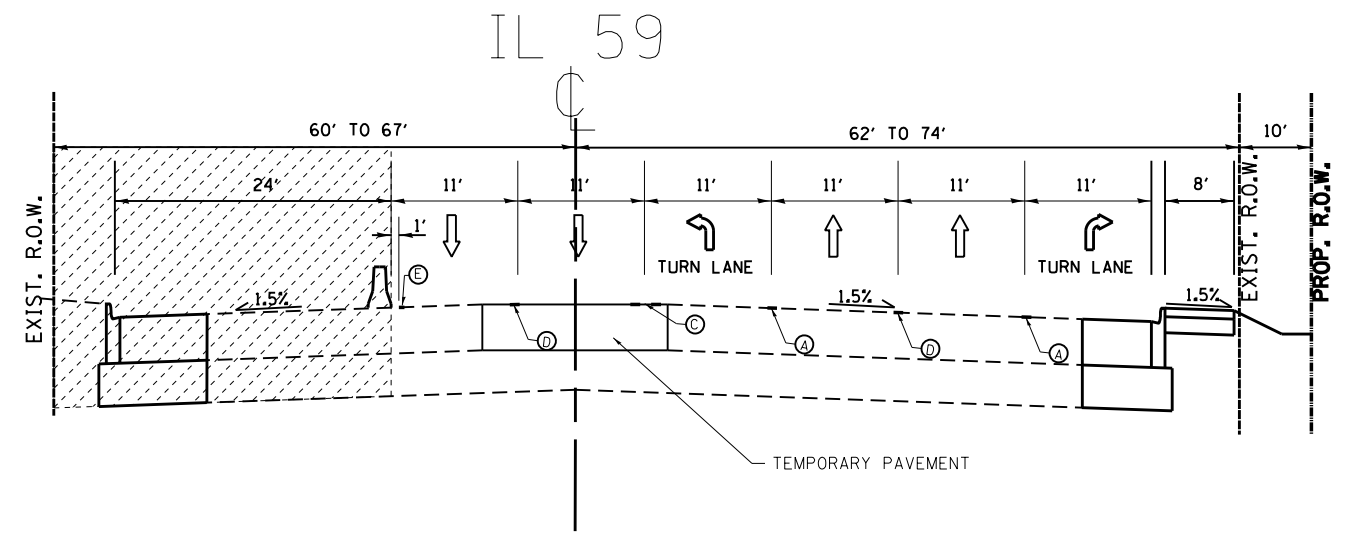

IL 59 (SUTTON ROAD)
STAGE 2
 STA. 494+36 TO STA. 500+00

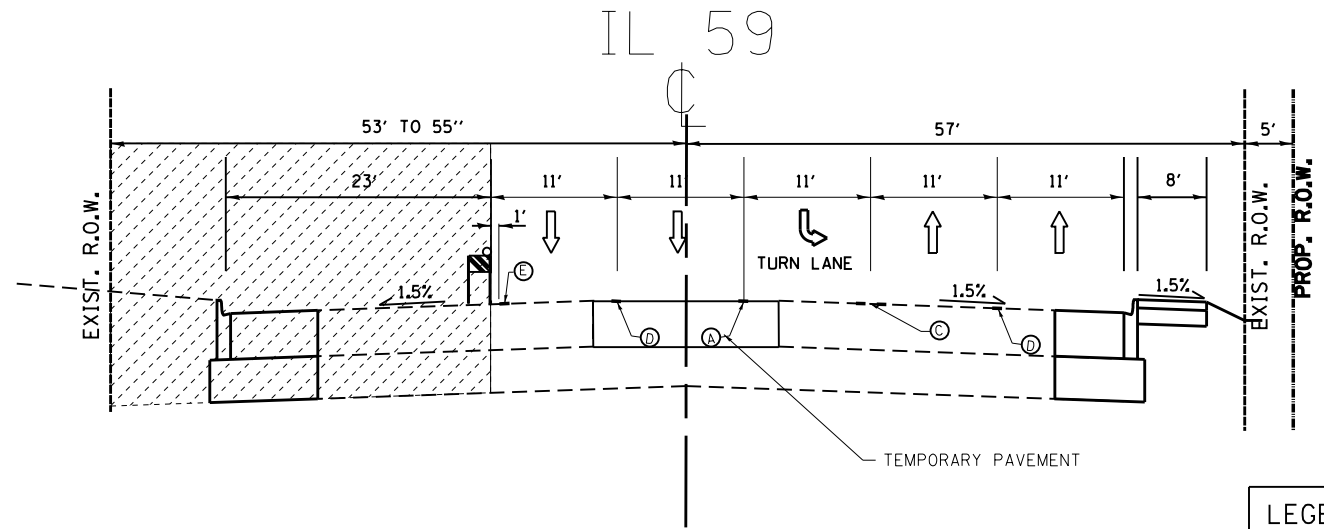

IL 59 (SUTTON ROAD)
STAGE 2
 STA. 500+00 TO STA. 505+97

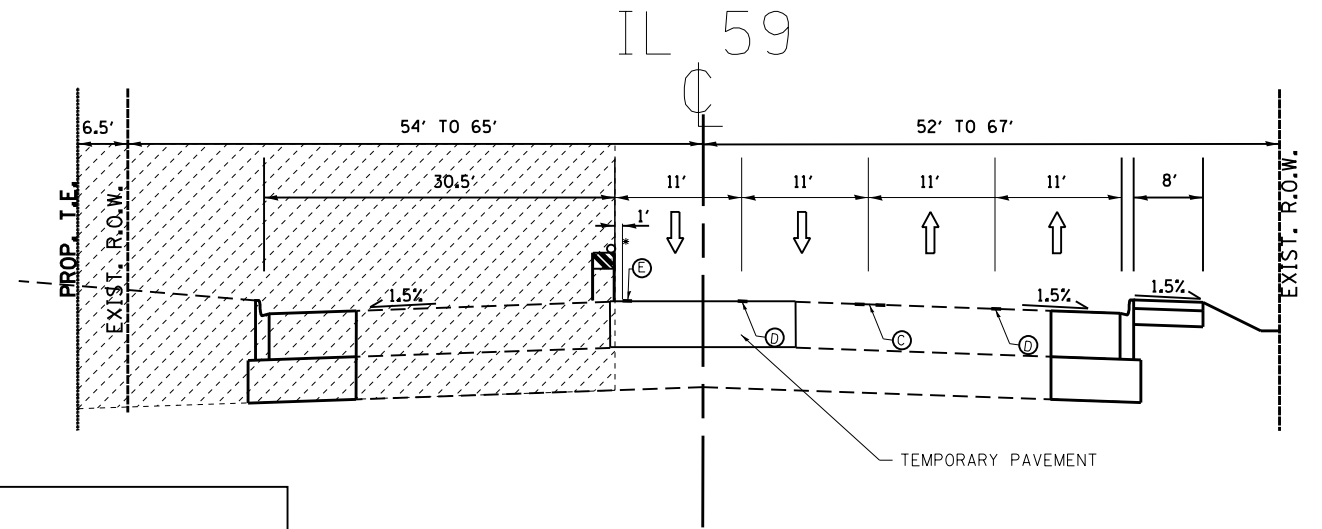

IL 59 (SUTTON ROAD)
STAGE 2
 STA. 505+97 TO STA. 511+00

LEGEND:

- Ⓐ TEMPORARY PAVEMENT MARKING, TYPE IV 6" SOLID WHITE EDGE LINE/WHITE LANE LINE
- Ⓑ TEMPORARY PAVEMENT MARKING, TYPE IV 4" SOLID YELLOW EDGE LINE
- Ⓒ TEMPORARY PAVEMENT MARKING, TYPE IV 4" SOLID DOUBLE YELLOW @ 11" C-C
- Ⓓ TEMPORARY PAVEMENT MARKING, TYPE IV 4" SKIP DASH WHITE LANE LINE 10' LINE, 30' SKIP
- Ⓔ TEMPORARY PAVEMENT MARKING, TYPE IV 4" SOLID WHITE EDGE LINE
- WORK ZONE
- MEDIAN REMOVAL
- TEMPORARY CONCRETE BARRIER
- DRUMS OR TY II BARRICADE AT 50 FT SPACING DEVICES IN TAPER (20 FT C-C) DEVICES IN CURVES & RADII (25 FT C-C)

STAGE 2 (WEST SIDE CONSTRUCTION):

- SHIFT TRAFFIC TO EAST SIDE OF IL 59
- SHIFT NORTHBOUND TRAFFIC TO UTILIZE PART OF THE EXISTING SOUTHBOUND LANE
- PROVIDE TWO 11 FT LANES AND A TURN LANE IN EACH DIRECTION
- PLACE TEMPORARY CONCRETE BARRIER, DRUMS, OR TYPE II BARRICADE TO PROTECT TRAFFIC FROM THE CONSTRUCTION ZONE
- CONSTRUCT TRAFFIC SIGNAL, CURB AND GUTTER, AND NEW PAVEMENT

* NOTE: VARIES BETWEEN DRUMS AND TEMPORARY CONCRETE BARRIER. SEE PLAN SHEET FOR MORE DETAILS

NOTES:

TRAFFIC ALONG IL 59 AND ARMY TRAIL RD. SHALL BE MAINTAINED DURING THE WIDENING AND RESURFACING OPERATIONS BY STAGING THE CONSTRUCTION.

IMPACT ATTENUATORS UTILIZED IN WINTER MONTHS MUST NOT BE AFFECTED BY WINTER TEMPS

IL 59

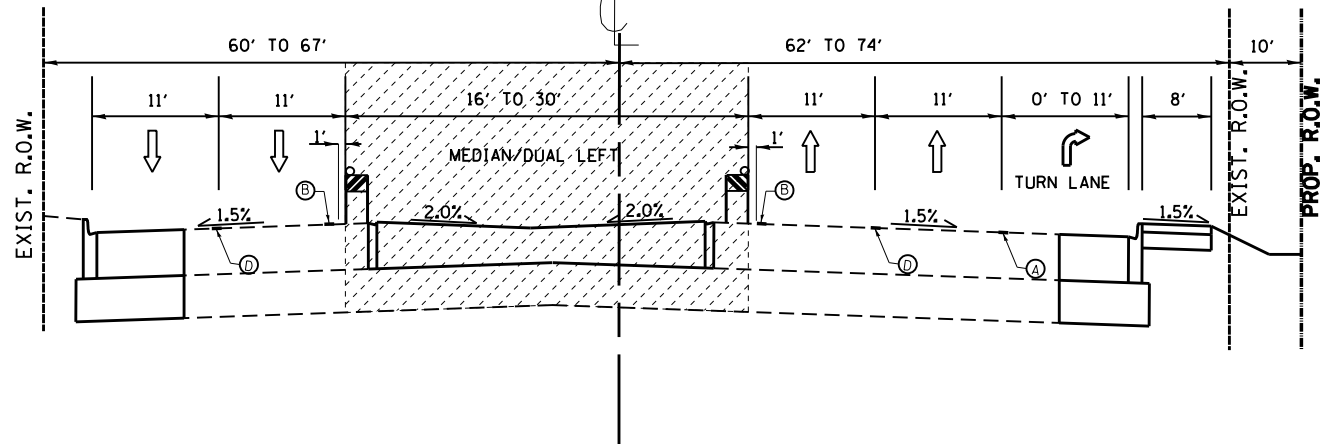

IL 59 (SUTTON ROAD)
STAGE 3
 STA. 487+50 TO STA. 494+36

IL 59

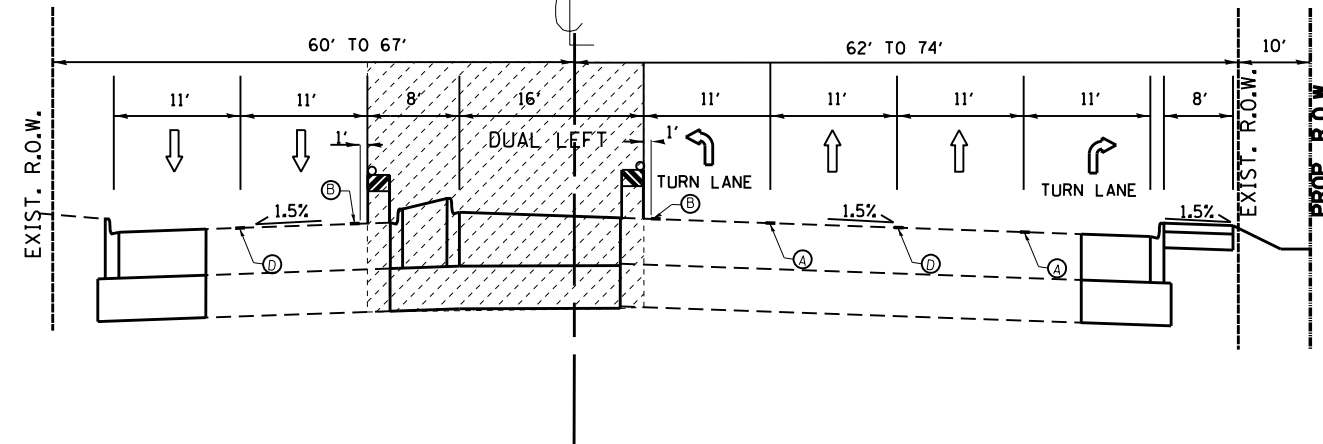

IL 59 (SUTTON ROAD)
STAGE 3
 STA. 494+36 TO STA. 500+00

IL 59

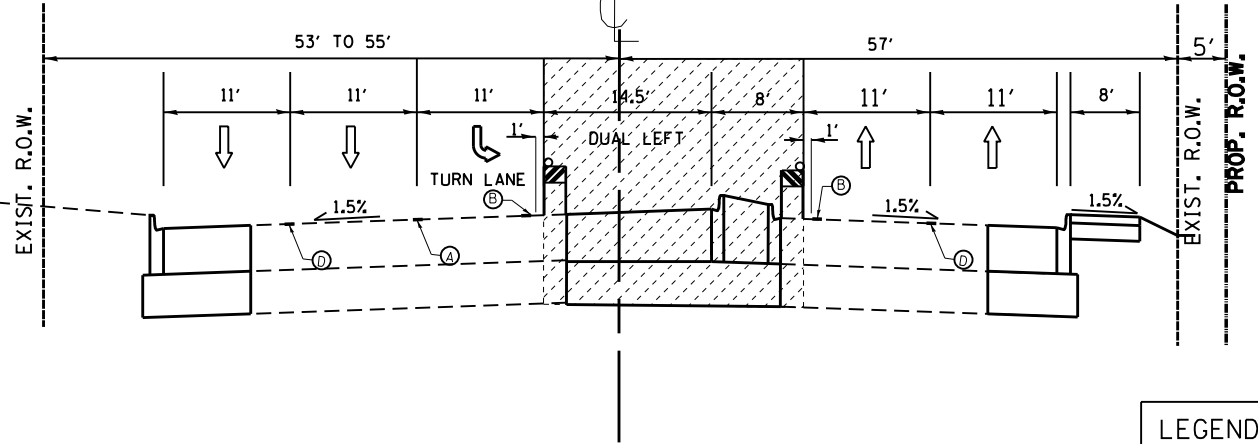

IL 59 (SUTTON ROAD)
STAGE 3
 STA. 500+00 TO STA. 505+97

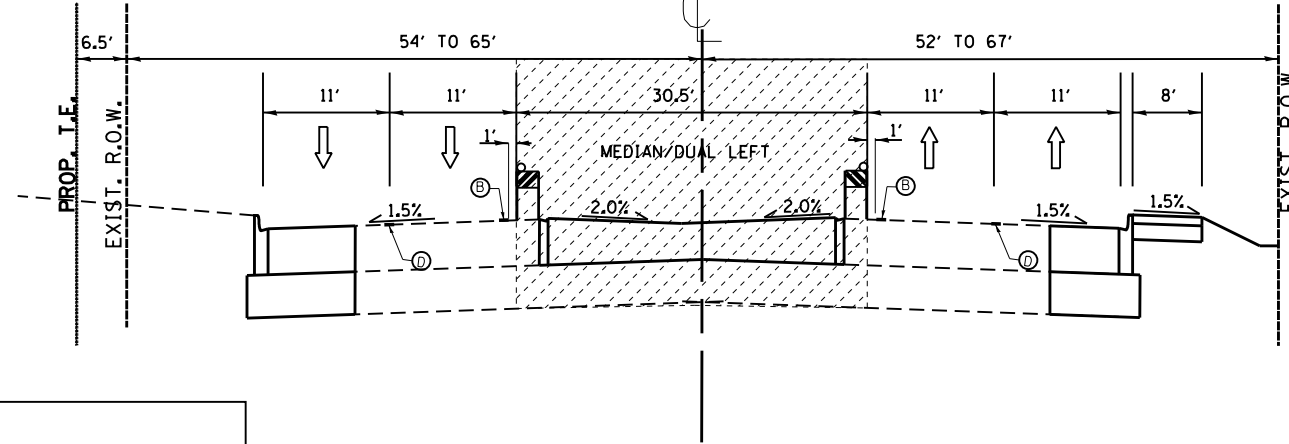

IL 59





IL 59 (SUTTON ROAD)
STAGE 3
 STA. 505+97 TO STA. 511+00

LEGEND:

- (A) TEMPORARY PAVEMENT MARKING, TYPE IV
6" SOLID WHITE EDGE LINE/WHITE LANE LINE
- (B) TEMPORARY PAVEMENT MARKING, TYPE IV
4" SOLID YELLOW EDGE LINE
- (C) TEMPORARY PAVEMENT MARKING, TYPE IV
4" SOLID DOUBLE YELLOW @ 11" C-C
- (D) TEMPORARY PAVEMENT MARKING, TYPE IV
4" SKIP DASH WHITE LANE LINE
10' LINE, 30' SKIP
- (E) TEMPORARY PAVEMENT MARKING, TYPE IV
4" SOLID WHITE EDGE LINE

 WORK ZONE
  MEDIAN REMOVAL

 TEMPORARY CONCRETE BARRIER

 DRUMS OR TY II BARRICADE AT 50 FT SPACING
 DEVICES IN TAPER (20 FT C-C)
 DEVICES IN CURVES & RADII (25 FT C-C)

**STAGE 3
 (MEDIAN AND TURN LANE CONSTRUCTION):**

- SHIFT SOUTHBOUND TRAFFIC TO THE WEST SIDE OF IL 59
- NORTHBOUND TRAFFIC WILL REMAIN ON THE EAST SIDE OF IL 59
- PROVIDE TWO 11 FT LANES AND A TURN LANE IN EACH DIRECTION
- PLACE DRUMS, OR TYPE II BARRICADE TO PROTECT TRAFFIC FROM THE CONSTRUCTION ZONE
- REMOVE TEMPORARY PAVEMENT
- CONSTRUCT MEDIAN AND DUAL LEFT TURN LANES

NOTES:

TRAFFIC ALONG IL 59 AND ARMY TRAIL RD. SHALL BE MAINTAINED DURING THE WIDENING AND RESURFACING OPERATIONS BY STAGING THE CONSTRUCTION.

IMPACT ATTENUATORS UTILIZED IN WINTER MONTHS MUST NOT BE AFFECTED BY WINTER TEMPS

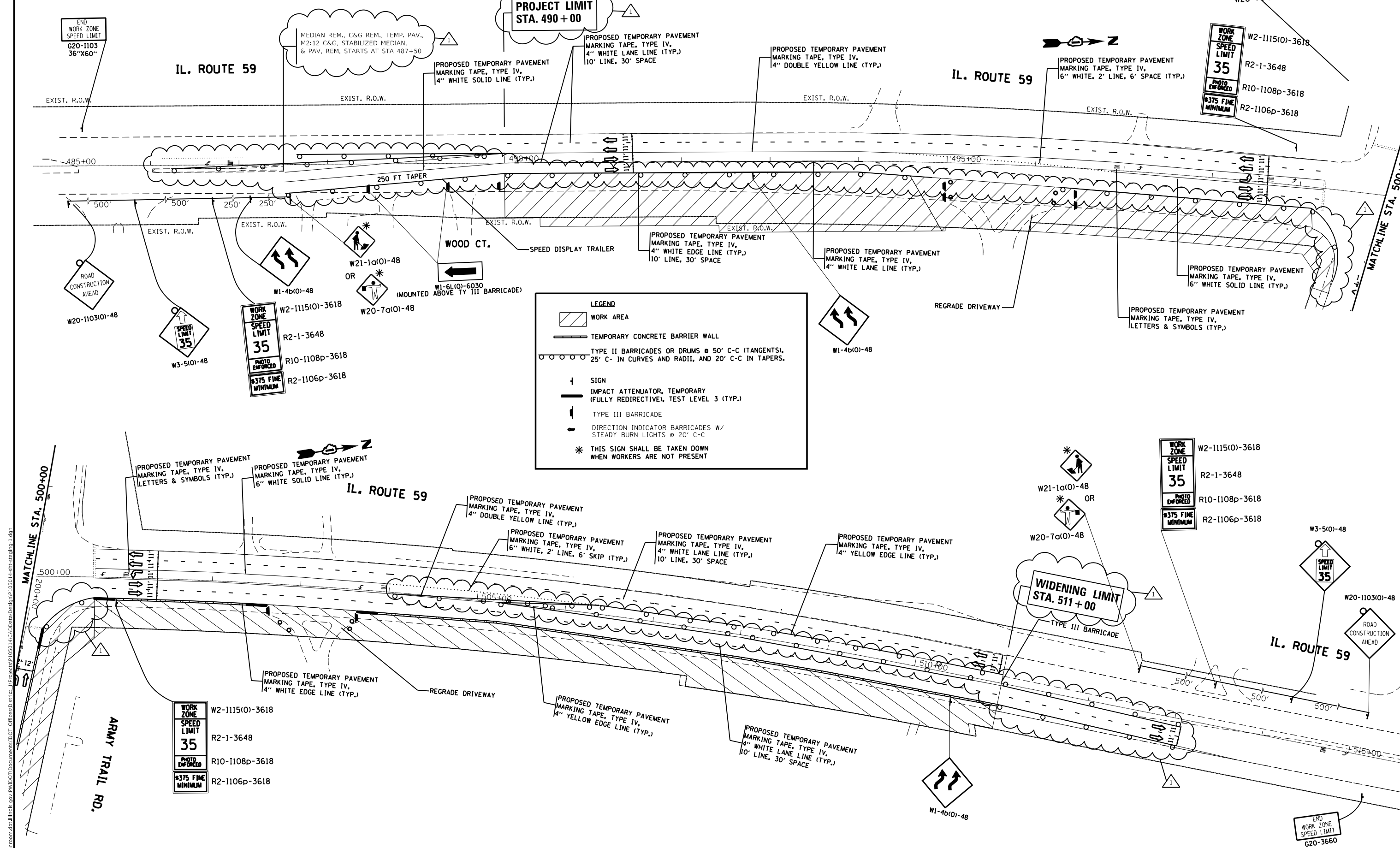

LEGEND

- WORK AREA
- TEMPORARY CONCRETE BARRIER WALL
- TYPE II BARRICADES OR DRUMS @ 50' C-C (TANGENTS), 25' C-C IN CURVES AND RADII, AND 20' C-C IN TAPERS.
- SIGN
- IMPACT ATTENUATOR, TEMPORARY (FULLY REDIRECTIVE), TEST LEVEL 3 (TYP.)
- TYPE III BARRICADE
- DIRECTION INDICATOR BARRICADES W/ STEADY BURN LIGHTS @ 20' C-C
- * THIS SIGN SHALL BE TAKEN DOWN WHEN WORKERS ARE NOT PRESENT

USER NAME = kalorm	DESIGNED -	REVISED - RK - 05/31/2019
	DRAWN -	REVISED -
PLOT SCALE = 100,0000' / in.	CHECKED -	REVISED -
PLOT DATE = 5/24/2019	DATE -	REVISED -

**STATE OF ILLINOIS
DEPARTMENT OF TRANSPORTATION**

IL ROUTE 59 AT ARMY TRAIL ROAD	
STAGE I CONSTRUCTION	
SCALE:	SHEET OF SHEETS STA. TO STA.

F.A.P. RTE. 338	SECTION 110TS-N	COUNTY DUPAGE	TOTAL SHEETS 133	SHEET NO. 29
ILLINOIS FED. AID PROJECT			CONTRACT NO. 62F19	

MODEL: Default
 FILE: \\s:\p\pub\barroom.dwg
 PLOT DATE: 5/24/2019 10:50:14 AM
 PLOT SCALE: 100,0000' / in.
 PLOT SIZE: 11x17
 PLOT ORIENT: Landscape
 PLOT RANGE: All
 PLOT PENS: 1
 PLOT PENNAMES: 1
 PLOT PENNUMS: 1
 PLOT PENWIDTHS: 1
 PLOT PENWEIGHTS: 1
 PLOT PENWEIGHTS2: 1
 PLOT PENWEIGHTS3: 1
 PLOT PENWEIGHTS4: 1
 PLOT PENWEIGHTS5: 1
 PLOT PENWEIGHTS6: 1
 PLOT PENWEIGHTS7: 1
 PLOT PENWEIGHTS8: 1
 PLOT PENWEIGHTS9: 1
 PLOT PENWEIGHTS10: 1
 PLOT PENWEIGHTS11: 1
 PLOT PENWEIGHTS12: 1
 PLOT PENWEIGHTS13: 1
 PLOT PENWEIGHTS14: 1
 PLOT PENWEIGHTS15: 1
 PLOT PENWEIGHTS16: 1
 PLOT PENWEIGHTS17: 1
 PLOT PENWEIGHTS18: 1
 PLOT PENWEIGHTS19: 1
 PLOT PENWEIGHTS20: 1
 PLOT PENWEIGHTS21: 1
 PLOT PENWEIGHTS22: 1
 PLOT PENWEIGHTS23: 1
 PLOT PENWEIGHTS24: 1
 PLOT PENWEIGHTS25: 1
 PLOT PENWEIGHTS26: 1
 PLOT PENWEIGHTS27: 1
 PLOT PENWEIGHTS28: 1
 PLOT PENWEIGHTS29: 1
 PLOT PENWEIGHTS30: 1
 PLOT PENWEIGHTS31: 1
 PLOT PENWEIGHTS32: 1
 PLOT PENWEIGHTS33: 1
 PLOT PENWEIGHTS34: 1
 PLOT PENWEIGHTS35: 1
 PLOT PENWEIGHTS36: 1
 PLOT PENWEIGHTS37: 1
 PLOT PENWEIGHTS38: 1
 PLOT PENWEIGHTS39: 1
 PLOT PENWEIGHTS40: 1
 PLOT PENWEIGHTS41: 1
 PLOT PENWEIGHTS42: 1
 PLOT PENWEIGHTS43: 1
 PLOT PENWEIGHTS44: 1
 PLOT PENWEIGHTS45: 1
 PLOT PENWEIGHTS46: 1
 PLOT PENWEIGHTS47: 1
 PLOT PENWEIGHTS48: 1
 PLOT PENWEIGHTS49: 1
 PLOT PENWEIGHTS50: 1
 PLOT PENWEIGHTS51: 1
 PLOT PENWEIGHTS52: 1
 PLOT PENWEIGHTS53: 1
 PLOT PENWEIGHTS54: 1
 PLOT PENWEIGHTS55: 1
 PLOT PENWEIGHTS56: 1
 PLOT PENWEIGHTS57: 1
 PLOT PENWEIGHTS58: 1
 PLOT PENWEIGHTS59: 1
 PLOT PENWEIGHTS60: 1
 PLOT PENWEIGHTS61: 1
 PLOT PENWEIGHTS62: 1
 PLOT PENWEIGHTS63: 1
 PLOT PENWEIGHTS64: 1
 PLOT PENWEIGHTS65: 1
 PLOT PENWEIGHTS66: 1
 PLOT PENWEIGHTS67: 1
 PLOT PENWEIGHTS68: 1
 PLOT PENWEIGHTS69: 1
 PLOT PENWEIGHTS70: 1
 PLOT PENWEIGHTS71: 1
 PLOT PENWEIGHTS72: 1
 PLOT PENWEIGHTS73: 1
 PLOT PENWEIGHTS74: 1
 PLOT PENWEIGHTS75: 1
 PLOT PENWEIGHTS76: 1
 PLOT PENWEIGHTS77: 1
 PLOT PENWEIGHTS78: 1
 PLOT PENWEIGHTS79: 1
 PLOT PENWEIGHTS80: 1
 PLOT PENWEIGHTS81: 1
 PLOT PENWEIGHTS82: 1
 PLOT PENWEIGHTS83: 1
 PLOT PENWEIGHTS84: 1
 PLOT PENWEIGHTS85: 1
 PLOT PENWEIGHTS86: 1
 PLOT PENWEIGHTS87: 1
 PLOT PENWEIGHTS88: 1
 PLOT PENWEIGHTS89: 1
 PLOT PENWEIGHTS90: 1
 PLOT PENWEIGHTS91: 1
 PLOT PENWEIGHTS92: 1
 PLOT PENWEIGHTS93: 1
 PLOT PENWEIGHTS94: 1
 PLOT PENWEIGHTS95: 1
 PLOT PENWEIGHTS96: 1
 PLOT PENWEIGHTS97: 1
 PLOT PENWEIGHTS98: 1
 PLOT PENWEIGHTS99: 1
 PLOT PENWEIGHTS100: 1

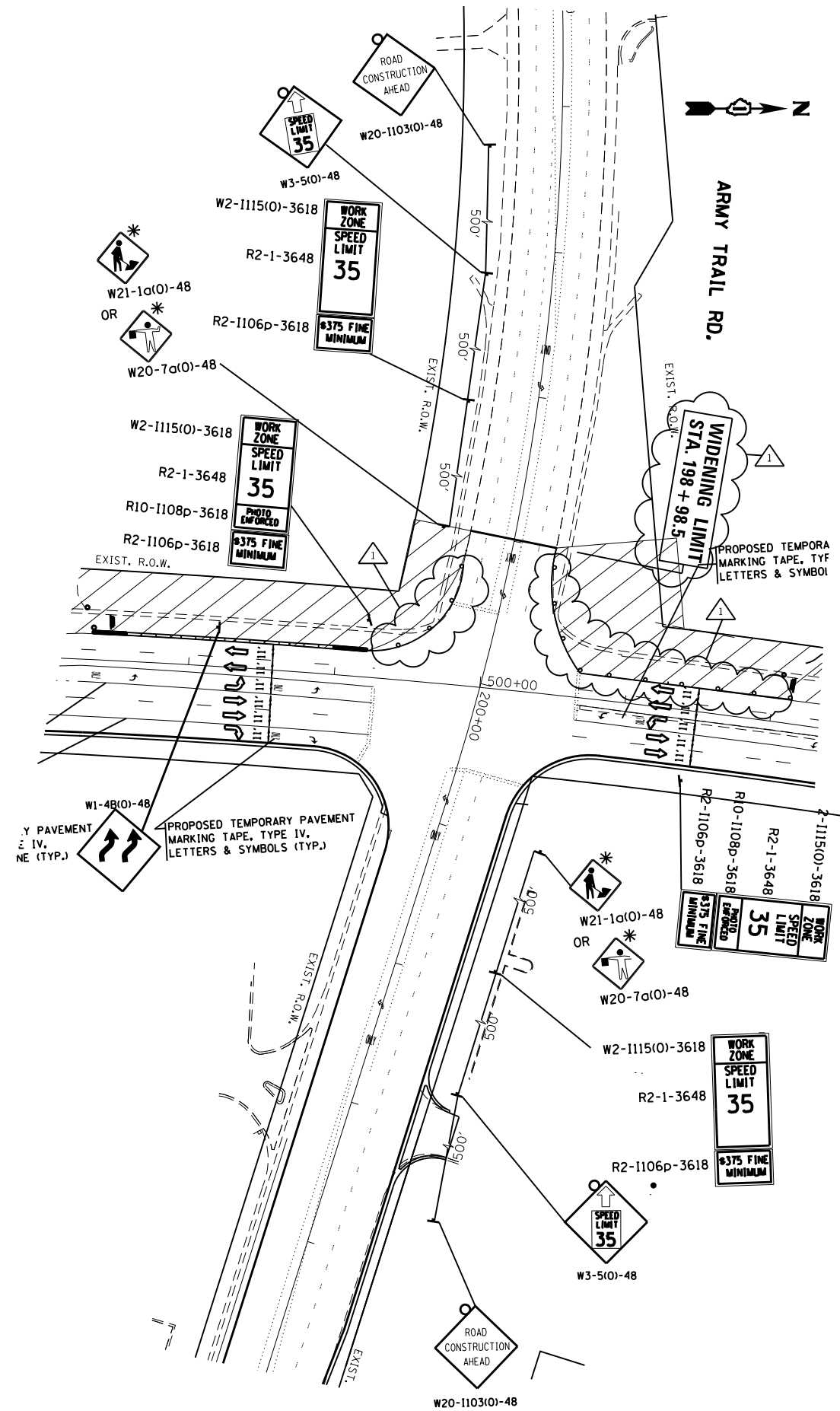

LEGEND	
	WORK AREA
	TEMPORARY CONCRETE BARRIER WALL
	TYPE II BARRICADES OR DRUMS @ 50' C-C (TANGENTS), 25' C-C IN CURVES AND RADII, AND 20' C-C IN TAPERS.
	SIGN
	IMPACT ATTENUATOR, TEMPORARY (FULLY REDIRECTIVE), TEST LEVEL 3 (TYP.)
	TYPE III BARRICADE
	DIRECTION INDICATOR BARRICADES W/ STEADY BURN LIGHTS @ 20' C-C
*	THIS SIGN SHALL BE TAKEN DOWN WHEN WORKERS ARE NOT PRESENT

MODEL: Default
 FILE: \\blm\c:\pub\blm\room\dat\illinois\p00\WIDDOT\Documents\DOT_Offices\Illinet\1\Project\10501\ACAD\DATA\Drawings\105014-act-22-19-2.dgn

USER NAME = kalorm	DESIGNED -	REVISED - RK - 05/31/2019
PLOT SCALE = 100,0000' / in.	DRAWN -	REVISED -
PLOT DATE = 5/24/2019	CHECKED -	REVISED -
	DATE -	REVISED -

**STATE OF ILLINOIS
 DEPARTMENT OF TRANSPORTATION**

**IL ROUTE 59 AT ARMY TRAIL ROAD
 STAGE II CONSTRUCTION**

SCALE: SHEET OF SHEETS STA. TO STA.

F.A.P. RTE.	SECTION	COUNTY	TOTAL SHEETS	SHEET NO.
338	110TS-N	DUPAGE	133	32
			CONTRACT NO. 62F19	
ILLINOIS FED. AID PROJECT				

MODEL: Default
 FILE: 338.ctb
 PLOT DATE: 5/24/2019
 PLOT SCALE: = 100.0000' / in.
 USER NAME: = kalorm

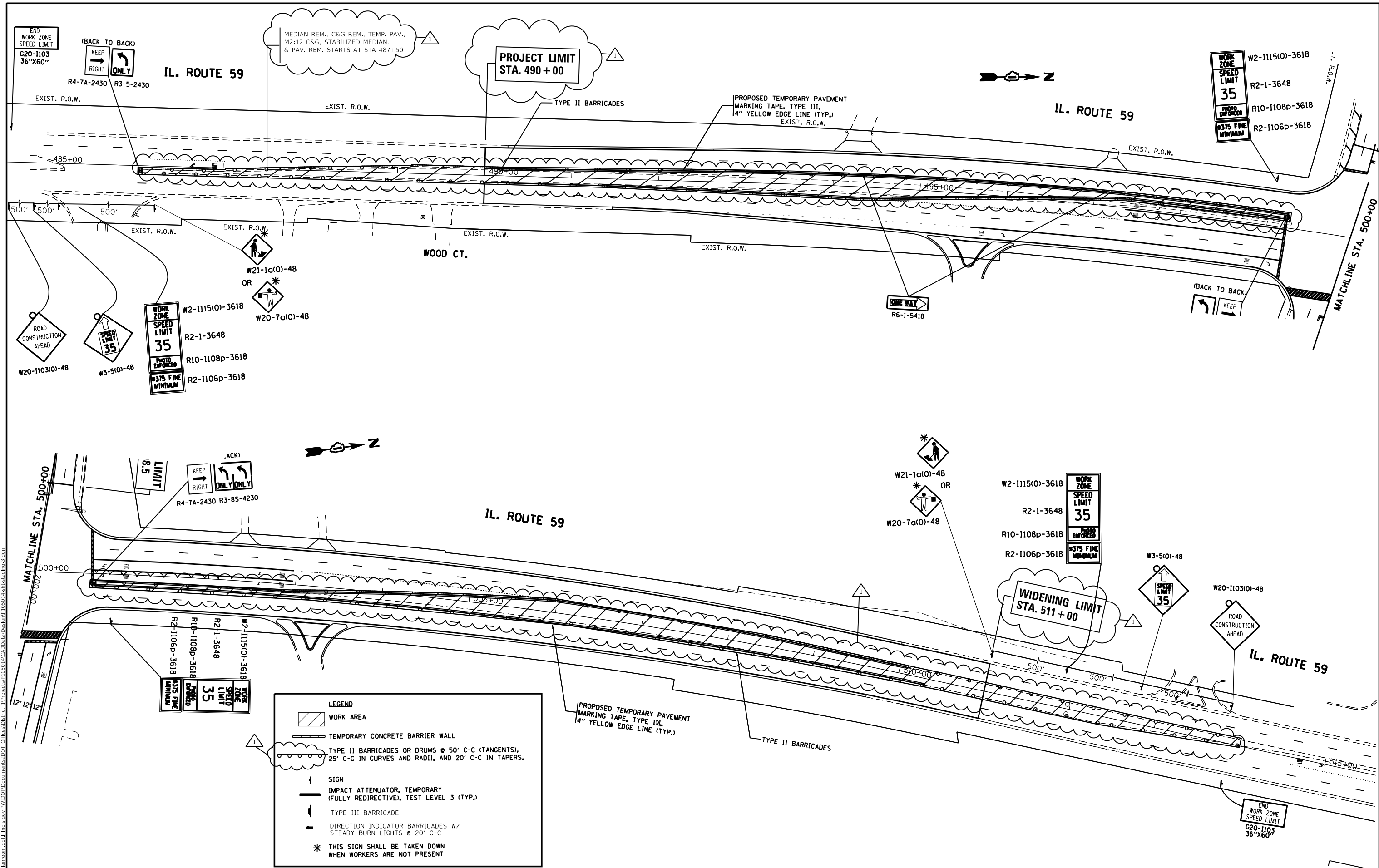

LEGEND	
	WORK AREA
	TEMPORARY CONCRETE BARRIER WALL
	TYPE II BARRICADES OR DRUMS @ 50' C-C (TANGENTS), 25' C-C IN CURVES AND RADII, AND 20' C-C IN TAPERS.
	SIGN
	IMPACT ATTENUATOR, TEMPORARY (FULLY REDIRECTIVE), TEST LEVEL 3 (TYP.)
	TYPE III BARRICADE
	DIRECTION INDICATOR BARRICADES W/ STEADY BURN LIGHTS @ 20' C-C
	* THIS SIGN SHALL BE TAKEN DOWN WHEN WORKERS ARE NOT PRESENT

DESIGNED -	REVISOR -	DATE -
DRAWN -	REVISOR -	DATE -
CHECKED -	REVISOR -	DATE -
DATE -	REVISOR -	DATE -

**STATE OF ILLINOIS
 DEPARTMENT OF TRANSPORTATION**

SCALE:		SHEET	OF	SHEETS	STA.	TO	STA.
--------	--	-------	----	--------	------	----	------

**IL ROUTE 59 AT ARMY TRAIL ROAD
 STAGE III CONSTRUCTION**

F.A.P. RTE.	SECTION	COUNTY	TOTAL SHEETS	SHEET NO.
338	110TS-N	DUPAGE	133	33
CONTRACT NO. 62F19				
ILLINOIS FED. AID PROJECT				

GENERAL NOTES:

- All structural steel shall be in accordance with AASHTO M270 Grade 50, unless otherwise noted.
- All H-Piles and structural steel shall be shop painted in accordance with Article 506 of the Standard Specifications utilizing the Organic Zinc-Rich/Epoxy/Urethane paint system. The final finish coat shall match Munsell Glossy 2.5YR Reddish Brown.
- No field welding is permitted except as specified in the contract documents.
- Reinforcement bars designated (E) shall be epoxy coated.
- Plan dimensions and details relative to existing plans are subject to nominal construction variations. The Contractor shall field verify existing dimensions and details affecting new construction and make necessary approved adjustments prior to construction or ordering of materials. Such variations shall not be cause for additional compensation for a change in scope of the work, however, the Contractor will be paid for the quantity actually furnished at the unit price bid for the work.
- Concrete sealer shall be applied to all exposed surfaces of the wall and shall extend 1'-0" minimum below finished grade.
- Chamfers on vertical surfaces shall be continued a minimum of 1'-0" below finished ground level.
- The Contractor is responsible for the design and performance of the lagging using no less than a 3" nominal rough-sawn thickness and timber with an allowable bending stress of 1000 psi.
- The Contractor shall verify the dimensions of the existing noise wall panels prior to construction and notify the engineer of any discrepancies.

INDEX OF SHEETS

- General Plan and Elevation
- General Notes, Bill of Materials and Index of Sheets
- Enlarged Elevation
- Typical Wall Section and Details
- Soldier Pile Information and CIP Bill of Materials
- Soil Boring Logs

MINIMUM BAR LAPS

#5 Bars - 3'-8"

TOTAL BILL OF MATERIALS

CODE NO.	ITEM	UNIT	TOTAL QUANTITY
20900110	POROUS GRANULAR BACKFILL	CU YD	95
50100100	REMOVAL OF EXISTING STRUCTURES	EA	1
50500505	STUD SHEAR CONNECTORS	EA	146
50800205	REINFORCEMENT BARS, EPOXY COATED	POUND	3590
52200100	FURNISHING SOLDIER PILES (HP SECTION)	FT	807
52200150	DRIVING SOLDIER PILES	FT	807
52200250	UNTREATED TIMBER LAGGING	SQ FT	897
52200900	CONCRETE STRUCTURES (RETAINING WALL)	CU YD	33.3
58700300	CONCRETE SEALER	SQ FT	642
59100100	GEOCOMPOSITE WALL DRAIN	SQ YD	67
Z0046304	PIPE UNDERDRAINS FOR STRUCTURES, 4"	FT	256
	PRECAST NOISE WALL PANEL REMOVAL, MODIFICATION, & REINSTALLATION, LOCATION 1	L. SUM	1

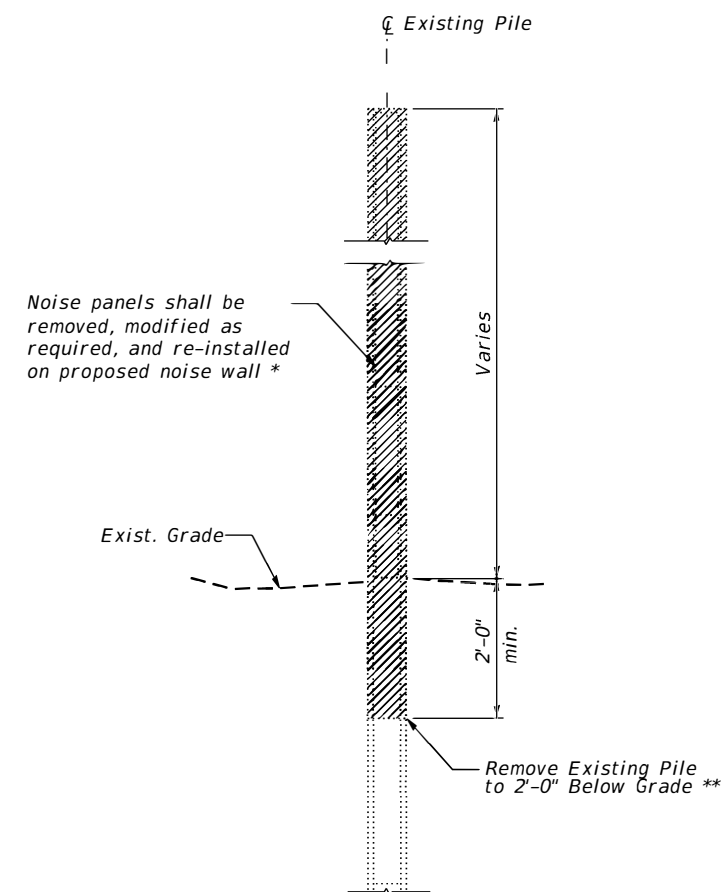

REMOVAL OF EXISTING WALL

1 * Cost of this work shall be included in the pay item "Precast Noise Wall Panel Removal, Modification, & Reinstallation, Location 1."

** Cost of this work shall be included in the pay item "Removal of Existing Structures."

FILE NAME =	USER NAME =	DESIGNED - LY	REVISED - ADDENDUM	STATE OF ILLINOIS DEPARTMENT OF TRANSPORTATION	GENERAL NOTES, BILL OF MATERIALS & INDEX OF SHEETS STRUCTURE NO. 022-2998	F.A.P. RTE. =	SECTION	COUNTY	TOTAL SHEETS	SHEET NO.	
COLLINS ENGINEERS	123 N. Rocker Dr. Suite 900 Chicago, IL 60606 Tel: (312) 704-9300 Fax: (312) 704-9320 www.collinseng.com	CHECKED - JMS	REVISED -			338	110TS-N	DuPAGE	133	89	
PLOT SCALE =	DRAWN - DR	REVISED -				CONTRACT NO. 62F19					
PLOT DATE =	CHECKED - JMS	REVISED -				SHEET NO. S2 OF S6 SHEETS					

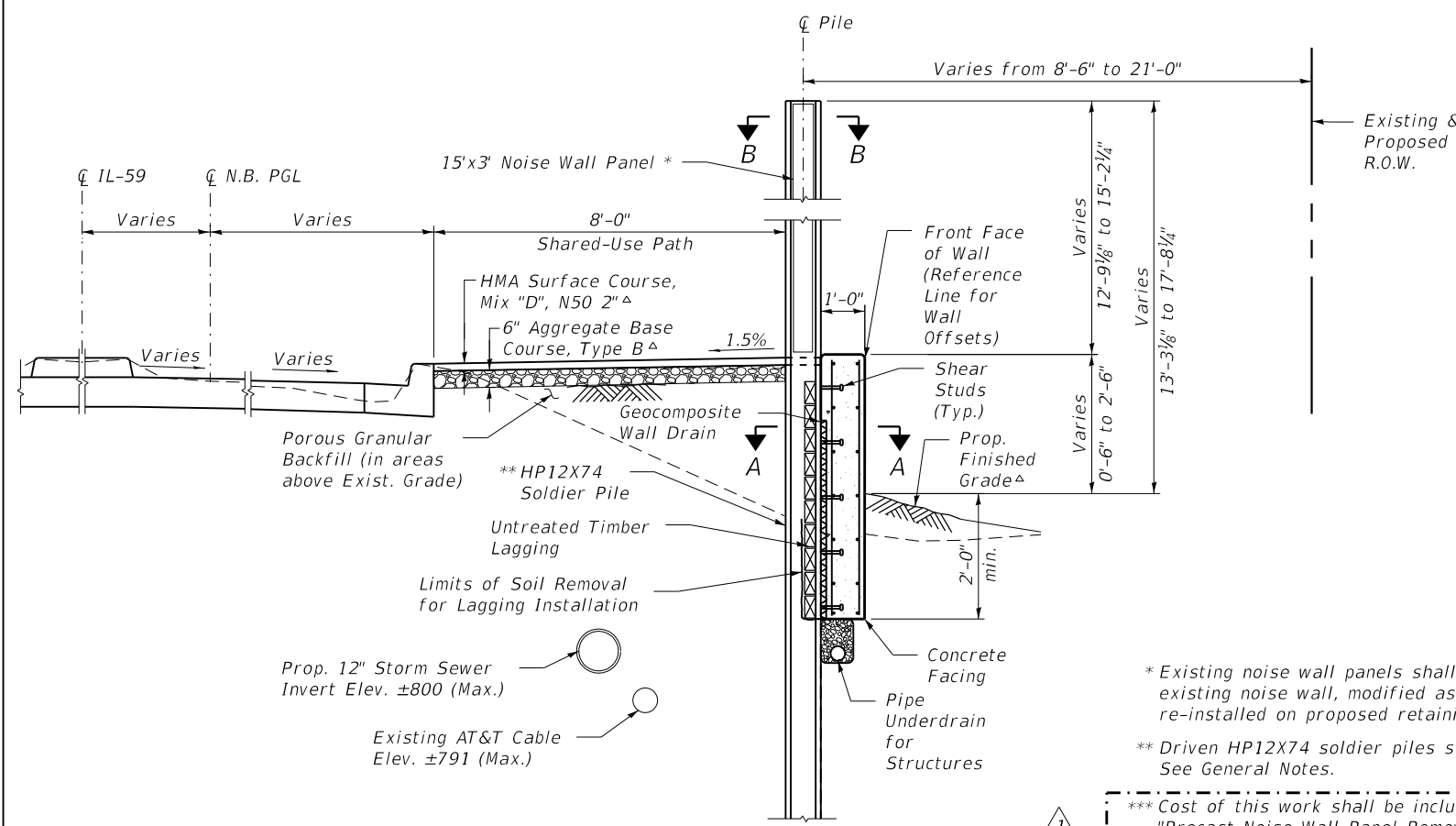

TYPICAL CROSS SECTION

* Existing noise wall panels shall be removed from existing noise wall, modified as required, and re-installed on proposed retaining/noise wall.
 ** Driven HP12X74 soldier piles shall be painted. See General Notes.
 *** Cost of this work shall be included in the pay item "Precast Noise Wall Panel Removal, Modification, & Reinstallation, Location 1."
 ^ See Civil Drawings.

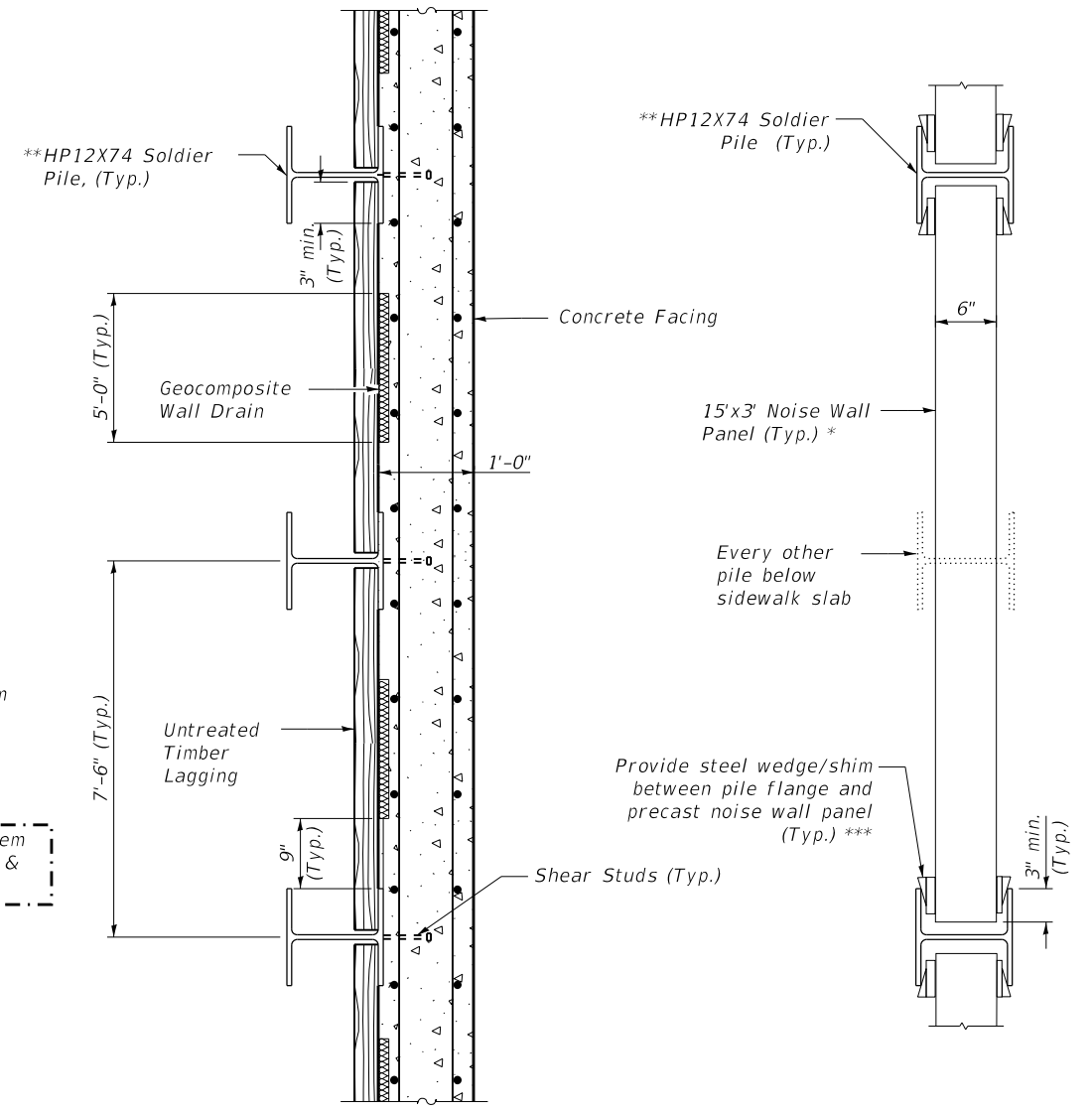

SECTION A-A

SECTION B-B

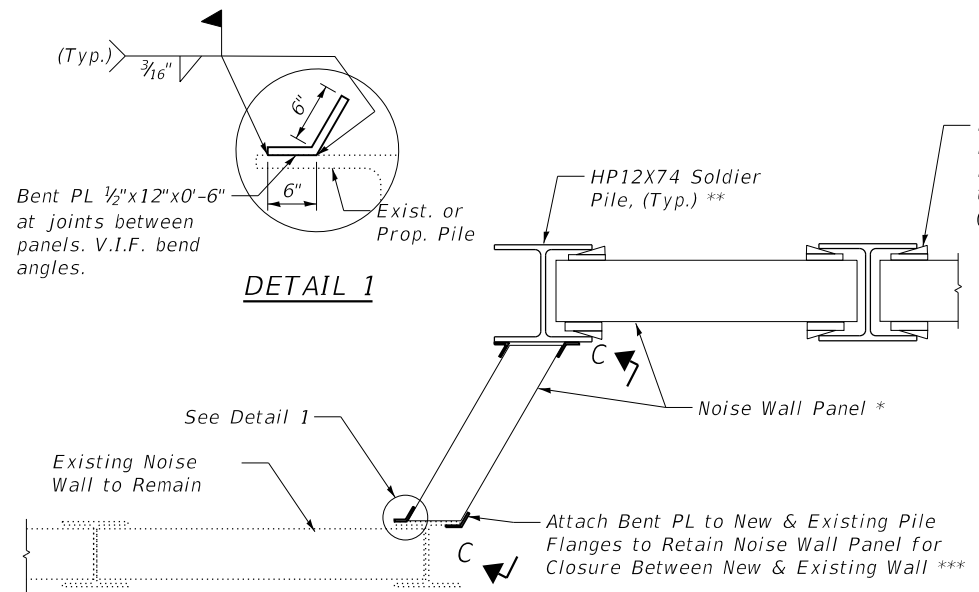

DETAIL 1

Provide steel wedge/shim between pile flange and noise wall panel. Wedge tight as necessary. *** (Typ.)

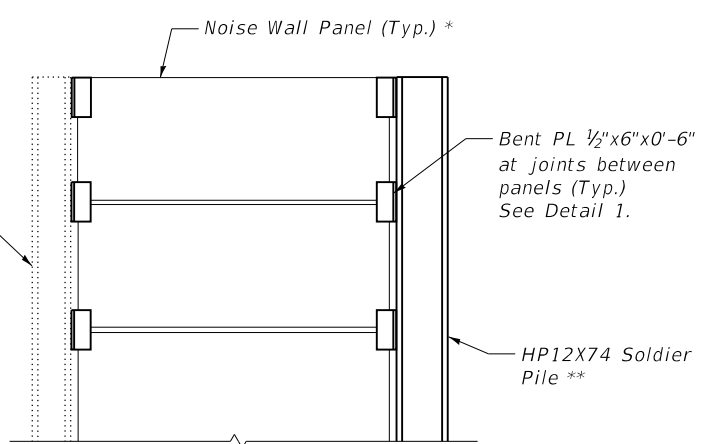

SECTION C-C

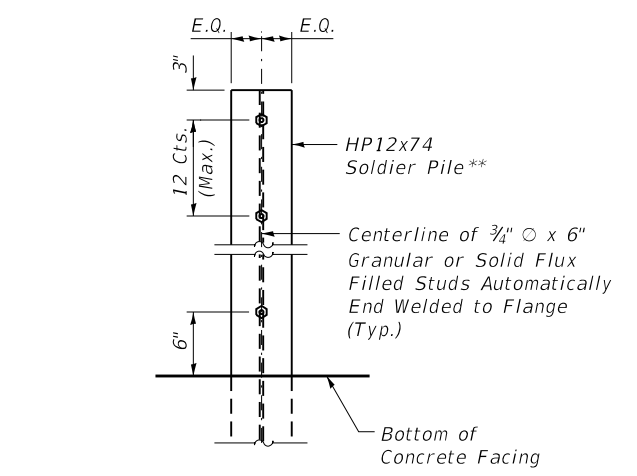

STUD SHEAR CONNECTOR LAYOUT

FILE NAME =
 COLLINS ENGINEERS
 123 N. Wacker Dr.
 Suite 900
 Chicago, IL 60606
 Tel: (312) 704-9300
 Fax: (312) 704-9320
 www.collinseng.com
 ILLINOIS PROFESSIONAL DESIGN FIRM LICENSE NO. 184-000993

USER NAME =	DESIGNED - LY	REVISED -	ADDENDUM
PLOT SCALE =	CHECKED - JMS	REVISED -	
PLOT DATE =	DRAWN - DR	REVISED -	
	CHECKED - JMS	REVISED -	

STATE OF ILLINOIS
 DEPARTMENT OF TRANSPORTATION

TYPICAL SECTIONS AND DETAILS
 STRUCTURE NO. 022-2998

SHEET NO. S4 OF S6 SHEETS

F.A.P. RTE.	SECTION	COUNTY	TOTAL SHEETS	SHEET NO.
338	110TS-N	DuPAGE	133	91
			CONTRACT NO. 62F19	
ILLINOIS FED. AID PROJECT				

GENERAL NOTES:

1. All structural steel shall be in accordance with AASHTO M270 Grade 50, unless otherwise noted.
2. All H-Piles and structural steel shall be shop painted in accordance with Article 506 of the Standard Specifications utilizing the Organic Zinc-Rich/Epoxy/Urethane paint system. The final finish coat shall match Munsell Glossy 2.5YR Reddish Brown.
3. No field welding is permitted except as specified in the contract documents.
4. Reinforcement bars designated (E) shall be epoxy coated.
5. Plan dimensions and details relative to existing plans are subject to nominal construction variations. The Contractor shall field verify existing dimensions and details affecting new construction and make necessary approved adjustments prior to construction or ordering of materials. Such variations shall not be cause for additional compensation for a change in scope of the work, however, the Contractor will be paid for the quantity actually furnished at the unit price bid for the work.
6. Concrete sealer shall be applied to all exposed surfaces of the wall and shall extend 1'-0" minimum below finished grade.
7. Chamfers on vertical surfaces shall be continued a minimum of 1'-0" below finished ground level.
8. The Contractor is responsible for the design and performance of the lagging using no less than a 3" nominal rough-sawn thickness and timber with an allowable bending stress of 1000 psi.
9. The Contractor shall verify the dimensions of the existing noise wall panels prior to construction and notify the engineer of any discrepancies.

INDEX OF SHEETS

1. General Plan and Elevation
2. General Notes, Bill of Materials and Index of Sheets
3. Enlarged Elevation
4. Typical Wall Section and Details
5. Soldier Pile Information and CIP Bill of Materials
6. Soil Boring Logs

MINIMUM BAR LAPS

#5 Bars - 3'-8"

TOTAL BILL OF MATERIALS

CODE NO.	ITEM	UNIT	TOTAL QUANTITY
20900110	POROUS GRANULAR BACKFILL	CU YD	47
50100100	REMOVAL OF EXISTING STRUCTURES	EA	1
50500505	STUD SHEAR CONNECTORS	EA	89
50800205	REINFORCEMENT BARS, EPOXY COATED	POUND	2310
52200100	FURNISHING SOLDIER PILES (HP SECTION)	FT	483
52200150	DRIVING SOLDIER PILES	FT	483
52200250	UNTREATED TIMBER LAGGING	SQ FT	537
52200900	CONCRETE STRUCTURES (RETAINING WALL)	CU YD	19.9
58700300	CONCRETE SEALER	SQ FT	378
59100100	GEOCOMPOSITE WALL DRAIN	SQ YD	40
Z0046304	PIPE UNDERDRAINS FOR STRUCTURES, 4"	FT	159
	PRECAST NOISE WALL PANEL REMOVAL, MODIFICATION, & REINSTALLATION, LOCATION 2	L. SUM	1

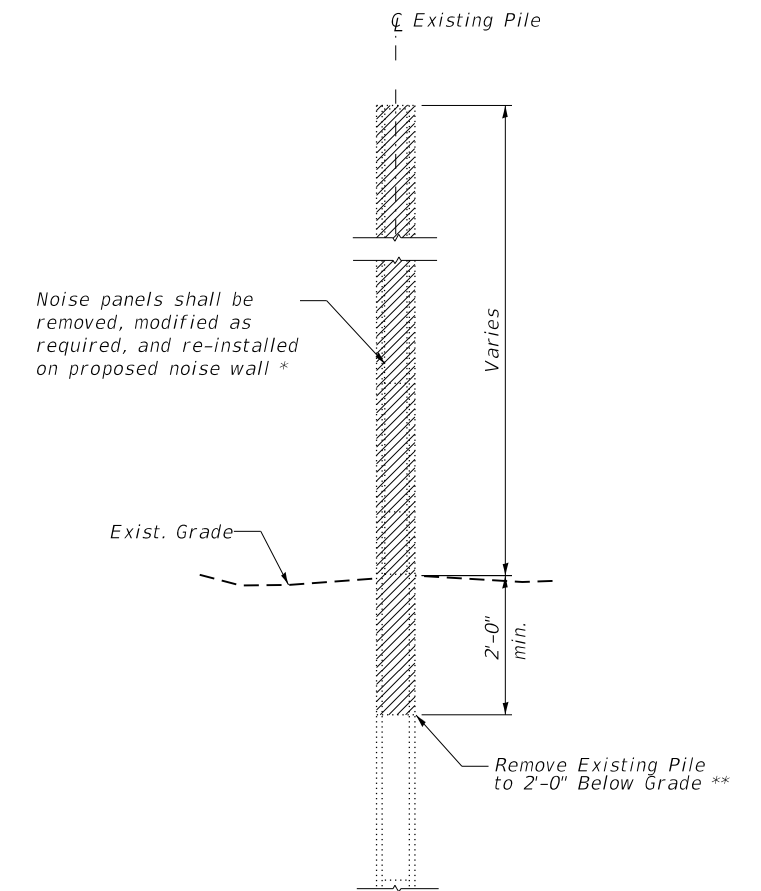

REMOVAL OF EXISTING WALL



* Cost of this work shall be included in the pay item "Precast Noise Wall Panel Removal, Modification, & Reinstallation, Location 2."

** Cost of this work shall be included in the pay item "Removal of Existing Structures."

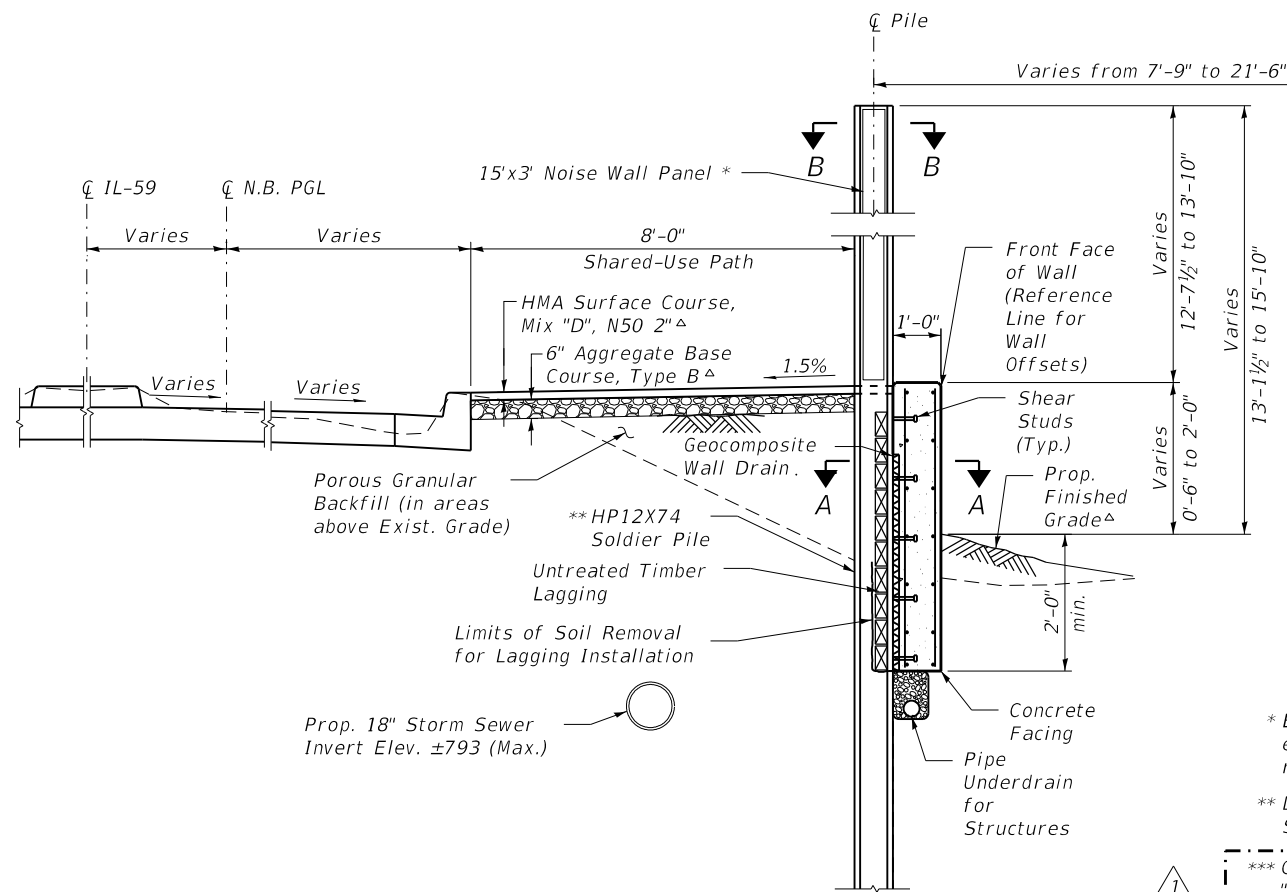

TYPICAL CROSS SECTION

* Existing noise wall panels shall be removed from existing noise wall, modified as required, and re-installed on proposed retaining/noise wall.
 ** Driven HP12X74 soldier piles shall be painted. See General Notes.
 *** Cost of this work shall be included in the pay item "Precast Noise Wall Panel Removal, Modification, & Reinstallation, Location 2."
 △ See Civil Drawings.

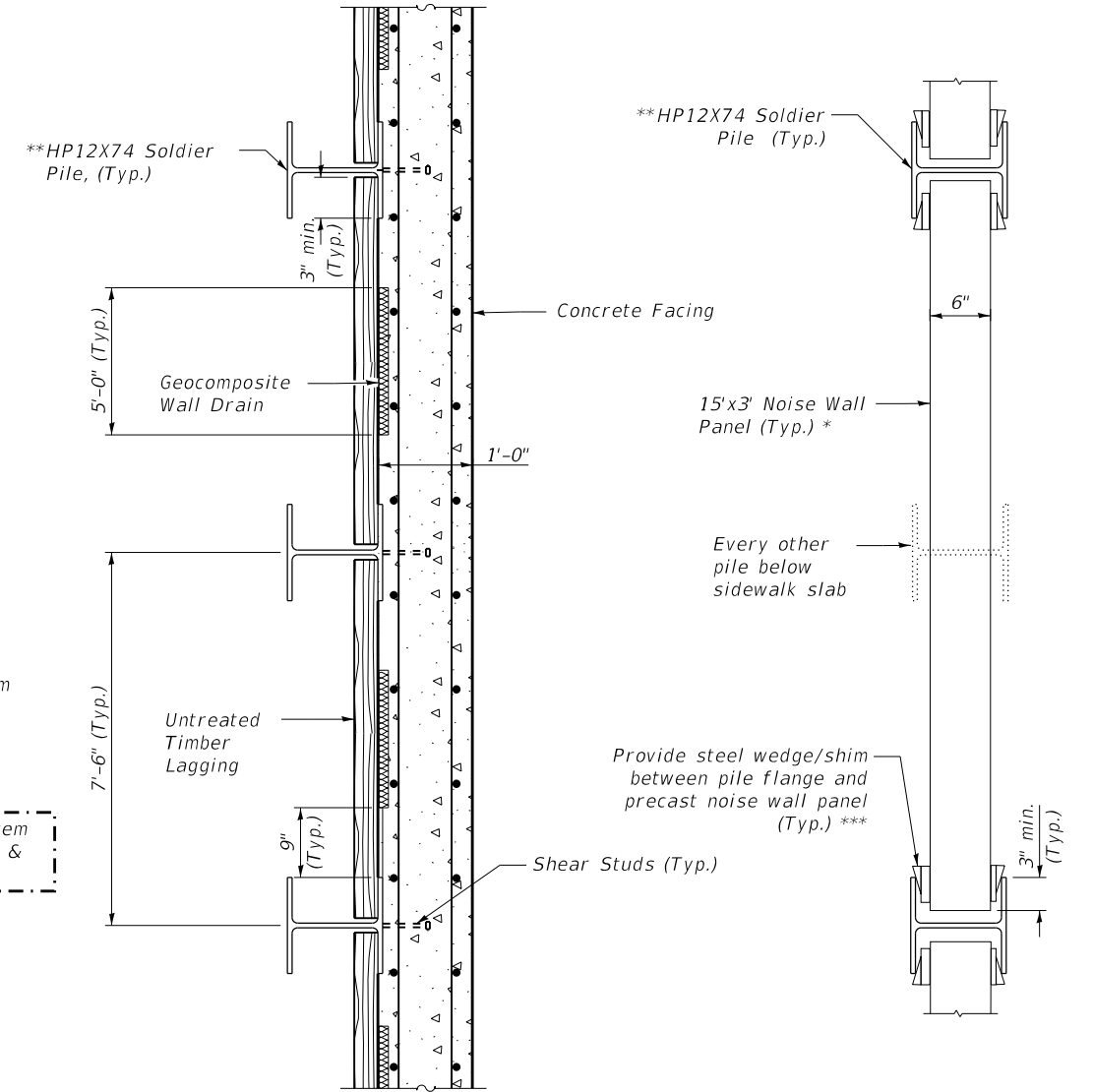

SECTION A-A

SECTION B-B

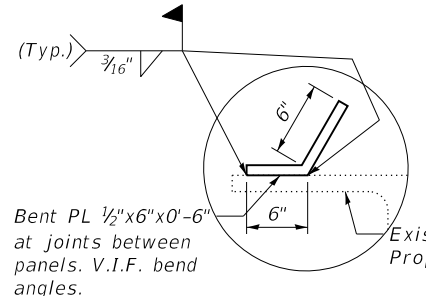

DETAIL 1

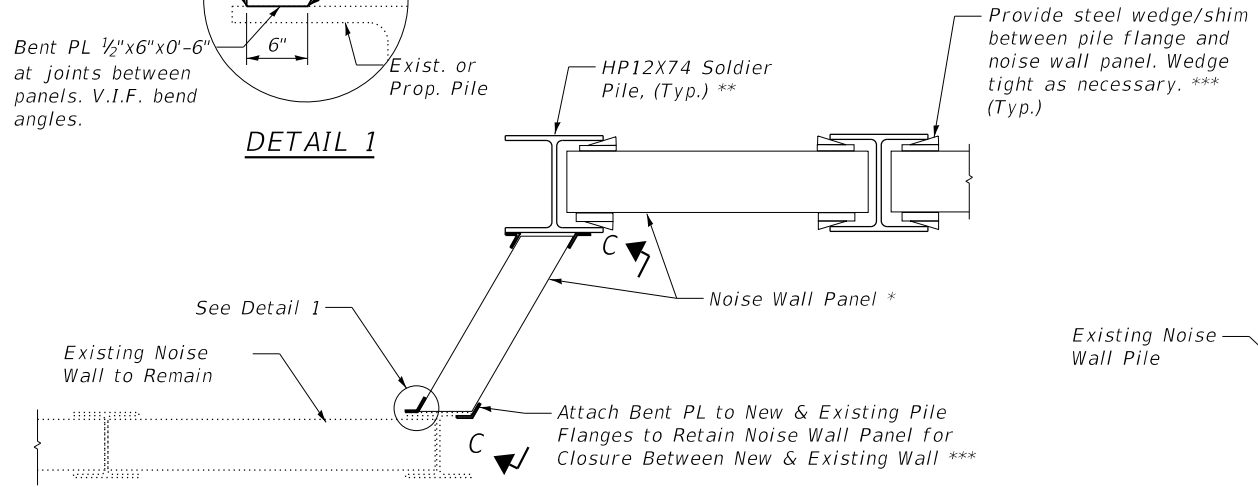

TYPICAL CONNECTION TO EXISTING NOISE WALL

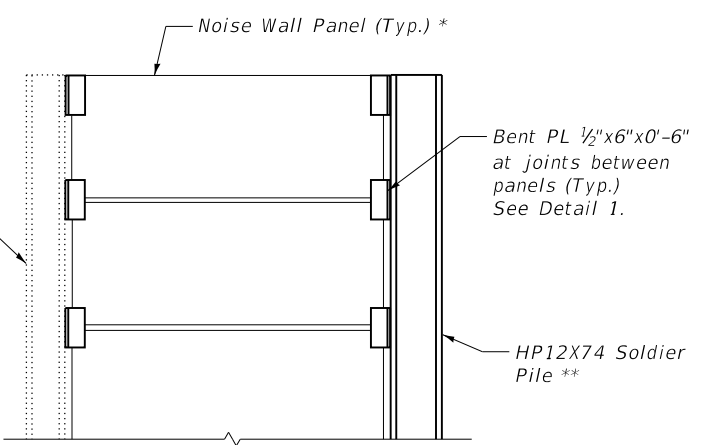

SECTION C-C

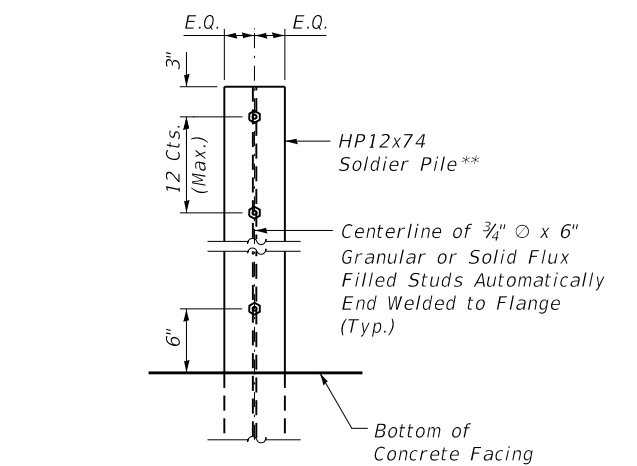

STUD SHEAR CONNECTOR LAYOUT

FILE NAME = COLLINS ENGINEERS 123 N. Rocker Dr. Suite 900 Chicago, IL 60606 Tel: (312) 704-9300 Fax: (312) 704-9320 www.collinseng.com ILLINOIS PROFESSIONAL DESIGN FIRM LICENSE NO. 184-000993	USER NAME =	DESIGNED - LY CHECKED - JMS	REVISED - ADDENDUM REVISED - REVISED - REVISED -	STATE OF ILLINOIS DEPARTMENT OF TRANSPORTATION	TYPICAL SECTIONS AND DETAILS STRUCTURE NO. 022-2999	F.A.P. RTE. = 338	SECTION = 110TS-N	COUNTY = DuPAGE	TOTAL SHEETS = 133	SHEET NO. = 97
	PLOT SCALE =	DRAWN - DR CHECKED - JMS	REVISED - REVISED -			SHEET NO. S4 OF S6 SHEETS	CONTRACT NO. 62F19	ILLINOIS FED. AID PROJECT		