

STATE OF ILLINOIS
DEPARTMENT OF TRANSPORTATION

F.A.P. RTE.	SECTION	COUNTY	TOTAL SHEETS	SHEET NO.
567	D3 IL 38 PP 2020-2	DeKalb	8	1
ILLINOIS			CONTRACT NO. 66J99	

INDEX OF SHEETS

1. COVER SHEET
2. GENERAL NOTES
3. SUMMARY OF QUANTITIES
4. TYPICAL SECTIONS
5. SCHEDULES
- 6-7. CLASS B PATCHING DETAILS
8. DETAILS

STANDARDS

- 701001-02 OFF-ROAD OPERATIONS 2L, 2W, MORE THAN 15' (4.5 m) AWAY
- 701006-05 OFF-ROAD OPERATIONS 2L, 2W, 15' (4.5 m) TO 24" (600 mm) FROM PAVEMENT EDGE
- 701336-07 LANE CLOSURE, 2L, 2W, WORK AREAS IN SERIES, FOR SPEEDS ≥ 45 MPH
- 701502-09 URBAN LANE CLOSURE, 2L, 2W, WITH BIDIRECTIONAL LEFT TURN LANE
- 701901-08 TRAFFIC CONTROL DEVICES

PROPOSED HIGHWAY PLANS

FAP ROUTE 567 (IL 38)
SECTION D3 IL 38 PP 2020-2
PROJECT
PAVEMENT PATCHING
DEKALB COUNTY

C-93-084-19

BEGIN IMPROVEMENT
INTERSECTION OF IL 38
AND PEACE RD.
LOG MILE 0.00

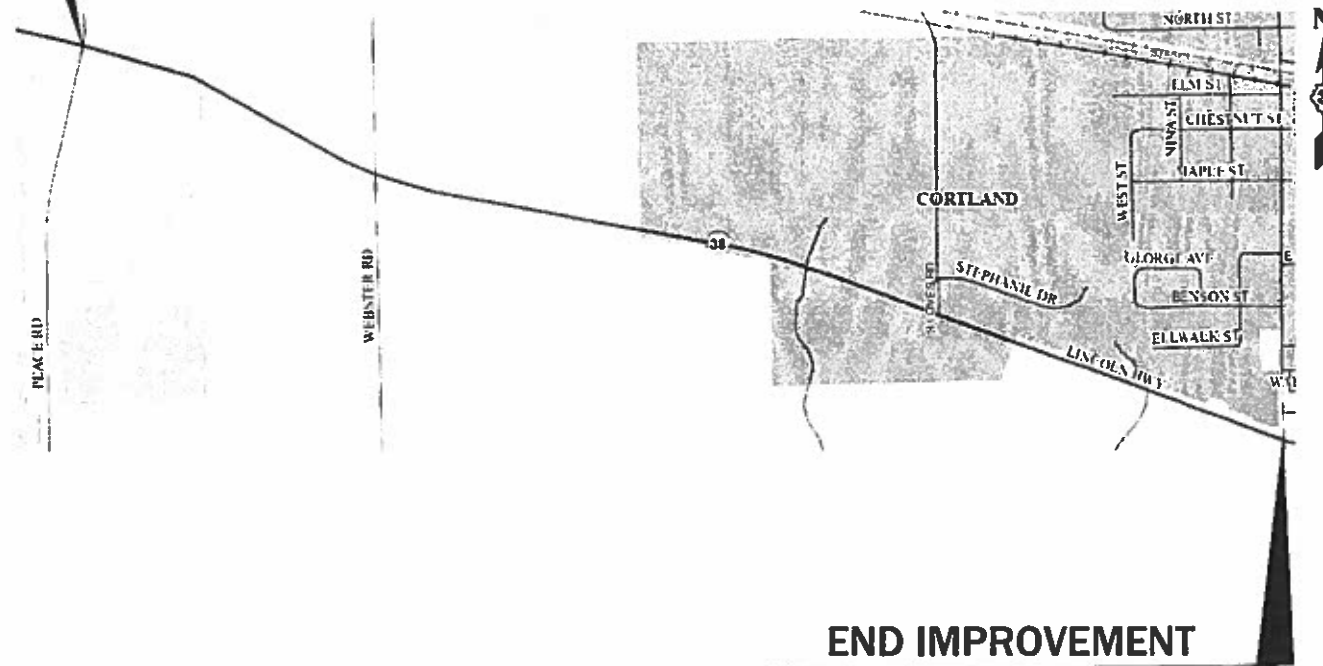

END IMPROVEMENT
INTERSECTION OF IL 38
AND SOMONAUK RD.
LOG MILE 2.00

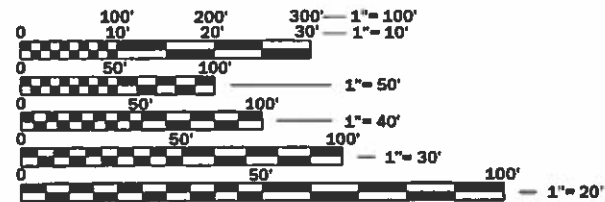

FULL SIZE PLANS HAVE BEEN PREPARED USING STANDARD ENGINEERING SCALES. REDUCED SIZED PLANS WILL NOT CONFORM TO STANDARD SCALES. IN MAKING MEASUREMENTS ON REDUCED PLANS, THE ABOVE SCALES MAY BE USED.

J.U.L.I.E.
JOINT UTILITY LOCATION INFORMATION FOR EXCAVATION
1-800-892-0123
OR 811

PROJECT ENGINEER JOE KANNEL P.E.
UNIT CHIEF RON WOODSHANK
DISTRICT 3 NO. (815) 434-6131
CONTRACT NO. 66J99

GROSS LENGTH = 10560 FT. = 2.00 MILE
NET LENGTH = 10560 FT. = 2.00 MILE

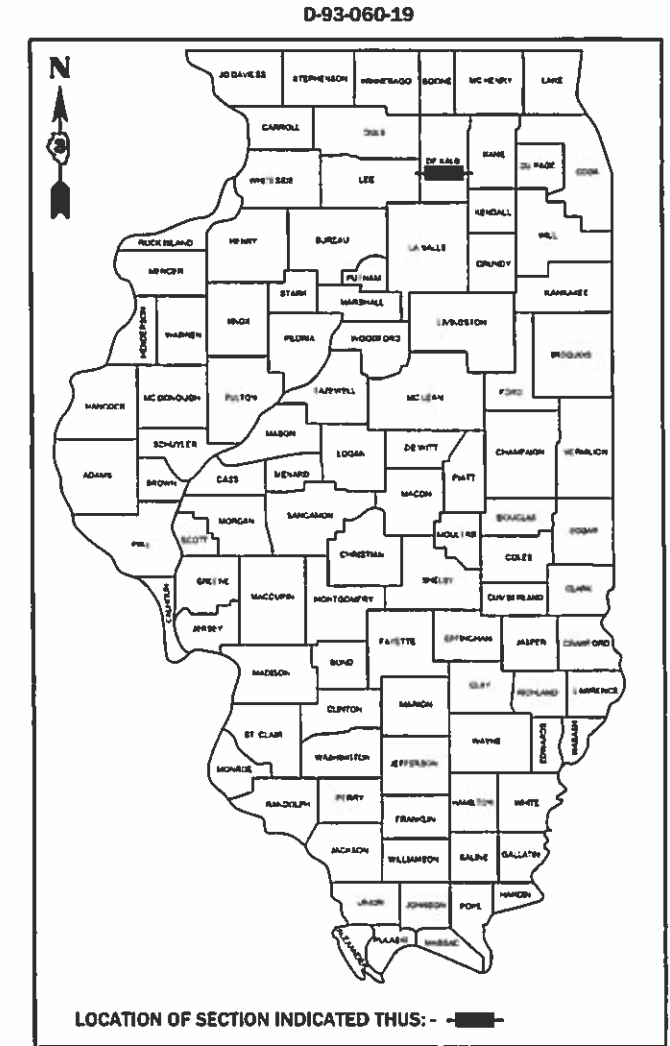

FUNCTIONAL CLASSIFICATION
URBAN
MAJOR COLLECTOR
F.A.I. ROUTE 39 (I-39)
2017 ADT = 9050
P.V. 92% S.U. 3.3% M.U. 4.7%

STATE OF ILLINOIS
DEPARTMENT OF TRANSPORTATION

SUBMITTED 3-28 2019
March
REGIONAL ENGINEER

May 10 2019
Paul J. Kannel
ENGINEER OF DESIGN AND ENVIRONMENT

May 19 2019
Paul J. Kannel
DIRECTOR OF HIGHWAYS PROJECT IMPLEMENTATION

PRINTED BY THE AUTHORITY
OF THE STATE OF ILLINOIS

GENERAL NOTES

FOR STABILIZATION, ALL TYPE III BARRICADES WILL REQUIRE A MINIMUM OF FOUR SAND BAGS PER BARRICADE.

ALL EXCAVATED MATERIAL, WHICH INCLUDES DIGGING OR GRADING OF ANY SOIL OR FILL MATERIAL, WITH THE EXCEPTION OF AGGREGATE FILLS, MUST BE INCORPORATED WITHIN THE IDOT RIGHT OF WAY DUE TO ENVIRONMENTAL DOCUMENTATION REQUIREMENTS.

ANY REFERENCE TO A STANDARD IN THESE PLANS SHALL BE INTERPRETED TO MEAN THE EDITION AS INDICATED BY THE SUBNUMBER SHOWN IN THE LIST OF STANDARDS OR THE COPY INCLUDED IN THESE PLANS.

THE CONTRACTOR SHALL CONTACT JULIE AT LEAST 48 HOURS PRIOR TO EXCAVATION TO DETERMINE WHICH UTILITIES ARE IN THE AREA.

THE EXISTING CONCRETE PAVEMENT AROUND THE DETECTOR LOOPS SHALL BE AVOIDED UNLESS THE ENGINEER DETERMINES THAT PAVEMENT PATCHING IS REQUIRED. IF PATCHING FALLS WITHIN THE DETECTOR LOOP AREA, CONTACT TRAFFIC SIGNAL SECTION AT 815-434-8506.

COMMITMENTS

STATE OF ILLINOIS
DEPARTMENT OF TRANSPORTATION
DISTRICT THREE
AS BUILT INFORMATION

SUPERVISING CONSTRUCTION FIELD ENGINEER

RESIDENT ENGINEER / TECHNICIAN

START & END DATES
OF CONSTRUCTION:

INSPECTORS:

STATE OF ILLINOIS
DEPARTMENT OF TRANSPORTATION
DISTRICT THREE

PREPARED BY: *Don Beaulieu*
DISTRICT STUDIES & PLANS ENGINEER

DATE: 3-25-19

EXAMINED BY: *LJS*
DISTRICT CONSTRUCTION ENGINEER

Michael Asha
DISTRICT MATERIALS ENGINEER

Tom Hoagel
DISTRICT OPERATIONS ENGINEER

FILE NAME =	pw:\planroom.dot\illinois.gov\FWIDOT\Documents\IDOT	USER NAME = MARINIEJ	DESIGNED - EVAN MARINI	REVISED -
	Office\District 3\Projects\D366J99\CADData\66J99-cover.dgn		DRAWN - EVAN MARINI	REVISED -
			CHECKED - RON WOODSHANK	REVISED -
			DATE - 1/22/2019	REVISED -

STATE OF ILLINOIS
DEPARTMENT OF TRANSPORTATION

GENERAL NOTES

SCALE: SHEET 1 OF 1 SHEETS STA. TO STA.

F.A.P. RTE.	SECTION	COUNTY	TOTAL SHEETS	SHEET NO.
567	D3 IL 38 PP 2020-2	DEKALB	8	2
CONTRACT NO. 66J99				
ILLINOIS FED. AID PROJECT				

CODE NO.	ITEM	UNIT	TOTAL QUANTITY	CONSTR. CODE
				CONTRACT MAINTENANCE
				100% STATE ROADWAY
				0006 URBAN
4200060	WELDED WIRE REINFORCEMENT	SQ YD	220	220
44201007	CLASS B PATCHES, TYPE II, 13 INCH	SQ YD	450	450
44201011	CLASS B PATCHES, TYPE III, 13 INCH	SQ YD	20	20
44201013	CLASS B PATCHES, TYPE IV, 13 INCH	SQ YD	200	200
44201299	DOWEL BARS 1 1/2"	EACH	1200	1200
44213200	SAW CUTS	FOOT	3214	3214
44213204	TIE BARS 3/4"	EACH	75	75
67100100	MOBILIZATION	L SUM	1	1
X7010216	TRAFFIC CONTROL AND PROTECTION, (SPECIAL)	L SUM	1	1
Z0017099	DOWEL BAR ASSEMBLY	EACH	15	15
Z0030850	TEMPORARY INFORMATION SIGNING	SQ FT	42	42

FILE NAME =	pw2\planroom\d01\illinois.gov\PWIDOT\Documents\DOT	USER NAME = MARINIEJ	DESIGNED - EVAN MARINI	REVISED -
	Office\District 3\Projects\D366J99\CADData\66J99-cover.dgn		DRAWN - EVAN MARINI	REVISED -
			CHECKED - RON WOODSHANK	REVISED -
Default			DATE - 1/22/2019	REVISED -

**STATE OF ILLINOIS
DEPARTMENT OF TRANSPORTATION**

SUMMARY OF QUANTITIES

SCALE: SHEET 1 OF 1 SHEETS STA. TO STA.

F.A.P. RTE.	SECTION	COUNTY	TOTAL SHEETS	SHEET NO.
567	D3 IL 38 PP 2020-2	DEKALB	8	3
CONTRACT NO. 66J99				
ILLINOIS FED. AID PROJECT				

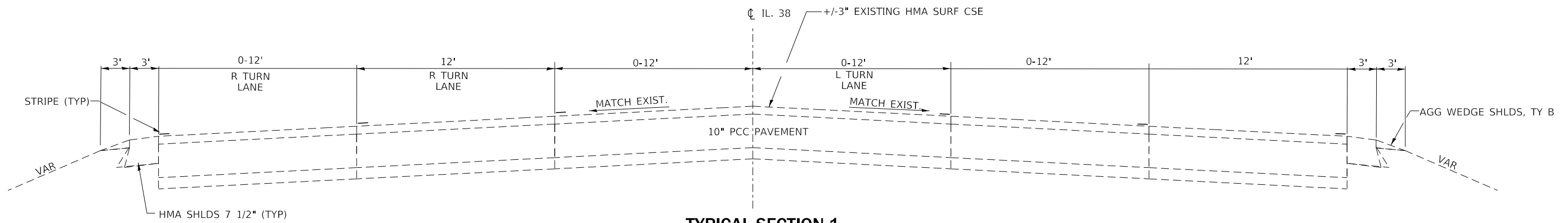

TYPICAL SECTION 1

LM 0.00 TO LM 0.24

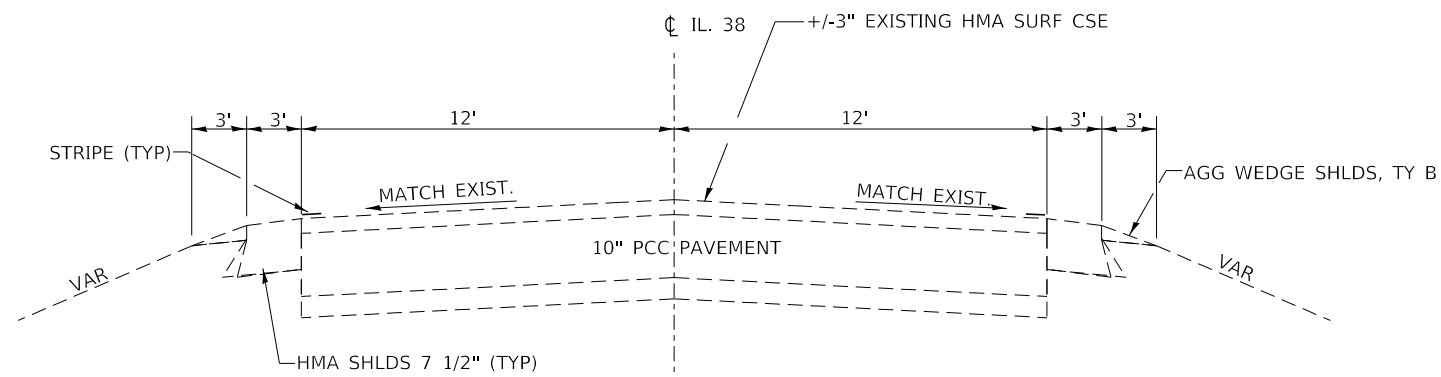

TYPICAL SECTION 2

LM 0.24 TO LM 1.12
LM 1.46 TO LM 1.70

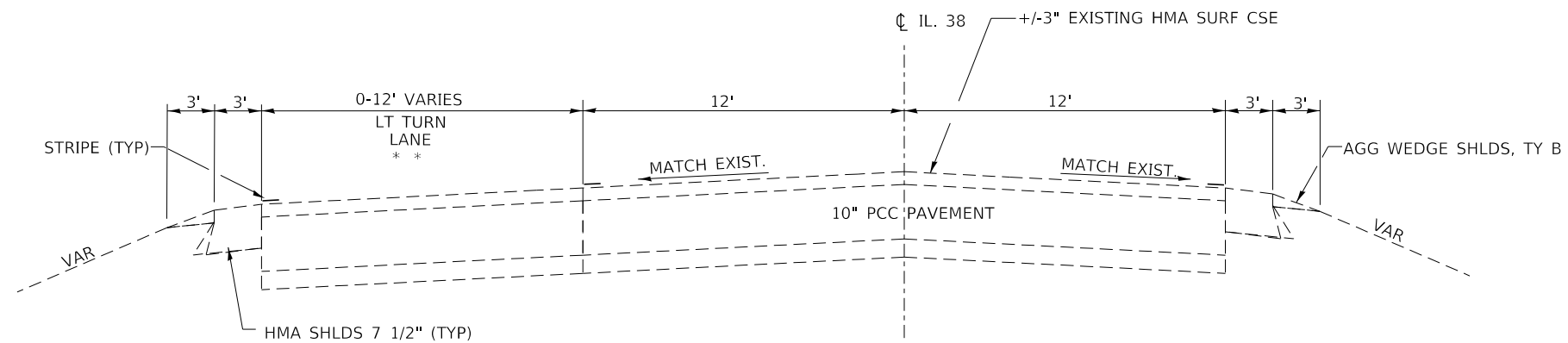

TYPICAL SECTION 3

LM 1.12 TO LM 1.46
LM 1.70 TO LM 2.00

FILE NAME pw2\planroom\dot\il\hols.gov\FWIDOT\Documents\IDOT	USER NAME - MARINIEJ	DESIGNED - EVAN MARINI	REVISED -	STATE OF ILLINOIS DEPARTMENT OF TRANSPORTATION	TYPICAL SECTION			F.A.P. RTE.	SECTION	COUNTY	TOTAL SHEETS	SHEET NO.
	PLOT SCALE - 3,9407 / mm	CHECKED - RON WOODSHANK	REVISED -					567	D3 IL 38 PP 2020-2	DEKALB	8	4
	PLOT DATE - 3/20/2019	DATE - 1/22/2019	REVISED -		SCALE: SHEET 1 OF 1 SHEETS STA. TO STA.			CONTRACT NO. 66J99				
								ILLINOIS FED. AID PROJECT				

PATCHING SCHEDULE

EAST BOUND LANE

LOCATION	PATCH LENGTH	CLASS B			DOWEL BARS 1 1/2"	SAW CUTS	WELDED WIRE REINF.	TIE BARS 3/4"
		TYPE II 13"	TYPE III 13"	TYPE IV 13"				
LOG MILE	(FT)	SQ YD	SQ YD	SQ YD	EACH	FOOT	SQ YD	EACH
0.20	6	8			20	48		
0.20	6	8			20	48		
0.20	90			120	20	216	120	45
0.30	6	8			20	48		
0.30	10	13			20	56		
0.30	6	8			20	48		
0.60	6	8			20	48		
0.60	6	8			20	48		
0.70	6	8			20	48		
0.90	6	8			20	48		
0.90	6	8			20	48		
0.90	8	11			20	52		
0.90	6	8			20	48		
1.00	6	8			20	48		
1.10	10	13			20	56		
1.10	6	8			20	48		
1.30	6	8			20	48		
1.50	6	8			20	48		
1.60	6	8			20	48		
1.60	6	8			20	48		
1.70	6	6			20	48		
1.70	6	8			20	48		
TOTALS		179		120	440	1244	120	45

PATCHING SCHEDULE

WEST BOUND LANE

LOCATION	PATCH LENGTH	CLASS B			DOWEL BARS 1 1/2"	SAW CUTS	WELDED WIRE REINF.	TIE BARS 3/4"
		TYPE II 13"	TYPE III 13"	TYPE IV 13"				
LOG MILE	(FT)	SQ YD	SQ YD	SQ YD	EACH	FOOT	SQ YD	EACH
0.90	6	8			20	48		
0.90	6	8			20	48		
0.80	6	8			20	48		
0.80	6	8			20	48		
0.70	6	8			20	48		
0.70	6	8			20	48		
0.70	6	8			20	48		
0.60	6	8			20	48		
0.60	6	8			20	48		
0.60	6	8			20	48		
0.60	6	8			20	48		
0.60	8	11			20	52		
0.60	6	8			20	48		
0.50	10	13			20	56		
0.50	6	8			20	48		
0.40	15		20		20	66	20	
0.40	20			27	20	76	27	10
0.40	40			53	20	116	53	20
0.30	6	8			20	48		
0.20	6	8			20	48		
TOTALS		144	20	80	400	1086	100	30

PATCHING SCHEDULE

WEST BOUND LANE

LOCATION	PATCH LENGTH	CLASS B			DOWEL BARS 1 1/2"	SAW CUTS	WELDED WIRE REINF.	TIE BARS 3/4"
		TYPE II 13"	TYPE III 13"	TYPE IV 13"				
LOG MILE	(FT)	SQ YD	SQ YD	SQ YD	EACH	FOOT	SQ YD	EACH
1.90	6	8			20	48		
1.70	6	8			20	48		
1.60	6	8			20	48		
1.60	6	8			20	48		
1.60	6	8			20	48		
1.50	6	8			20	48		
1.40	6	8			20	48		
1.40	6	8			20	48		
1.30	10	13			20	56		
1.30	10	13			20	56		
1.30	6	8			20	48		
1.20	6	8			20	48		
1.20	6	8			20	48		
1.10	6	8			20	48		
1.10	6	8			20	48		
1.10	8	11			20	52		
1.00	6	8			20	48		
1.00	6	8			20	48		
TOTALS		157			360	884		

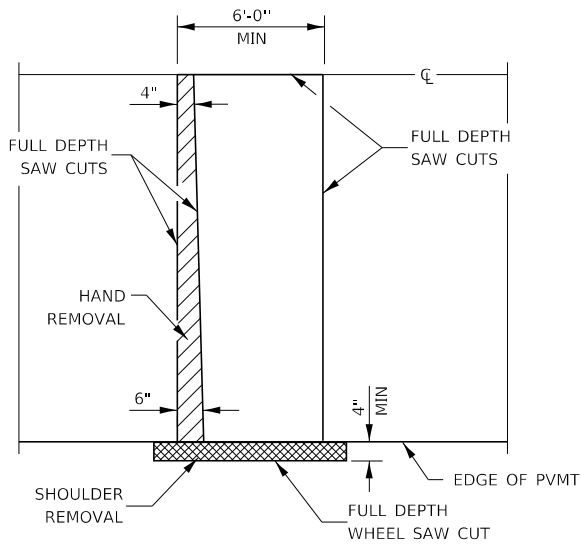

PAVEMENT SAWING DETAIL

(HMA SHOULDER)

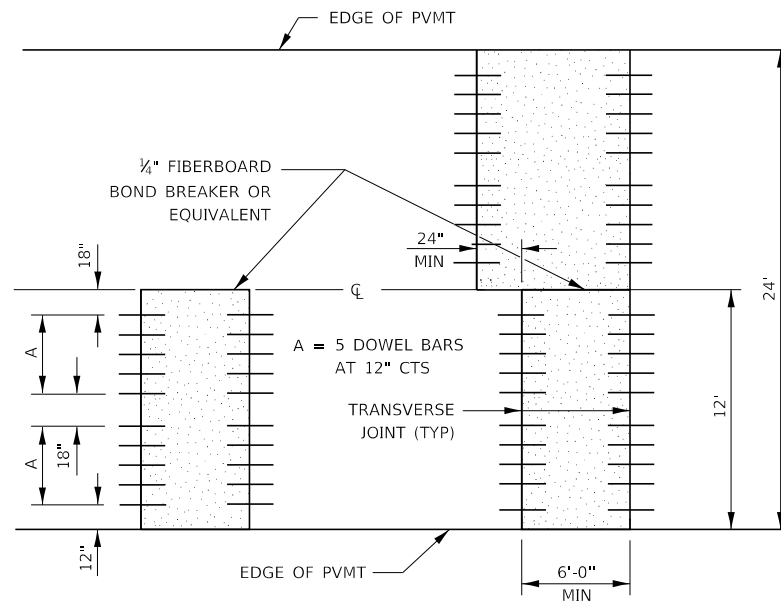

12' WIDE LANES

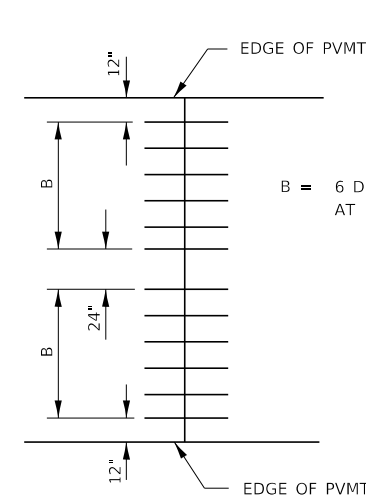

14' WIDE RAMP

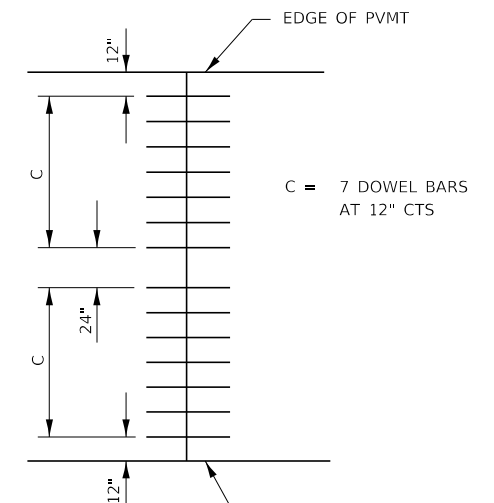

16' WIDE RAMP

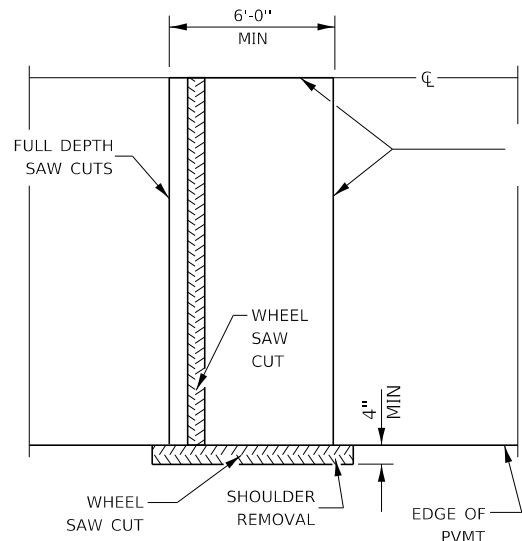

ALTERNATE SAWING DETAIL

(HMA SHOULDER)

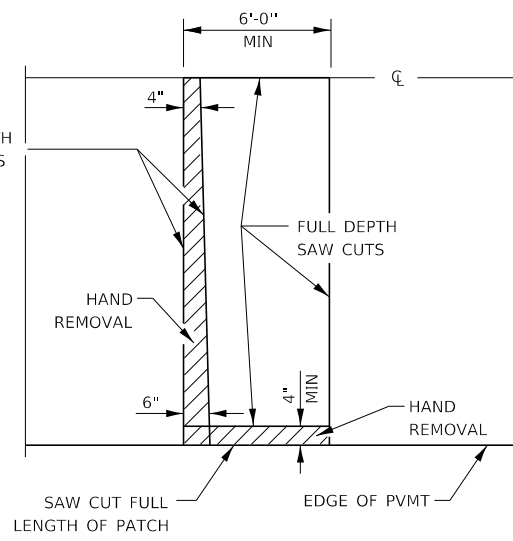

PAVEMENT SAWING DETAIL

(PCC SHOULDER)

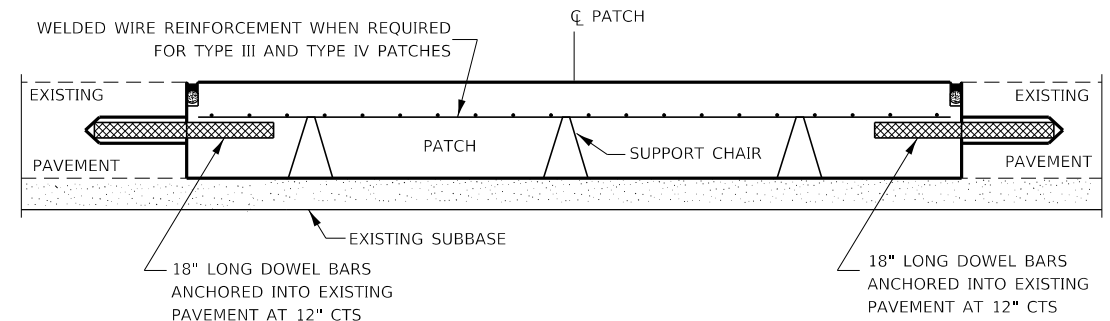

PATCHING WITHOUT HMA OVERLAY

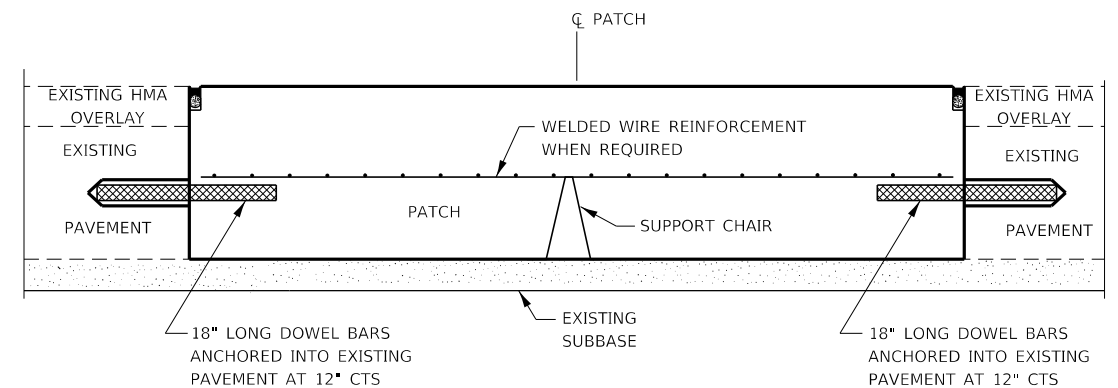

PATCHING WITH HMA OVERLAY

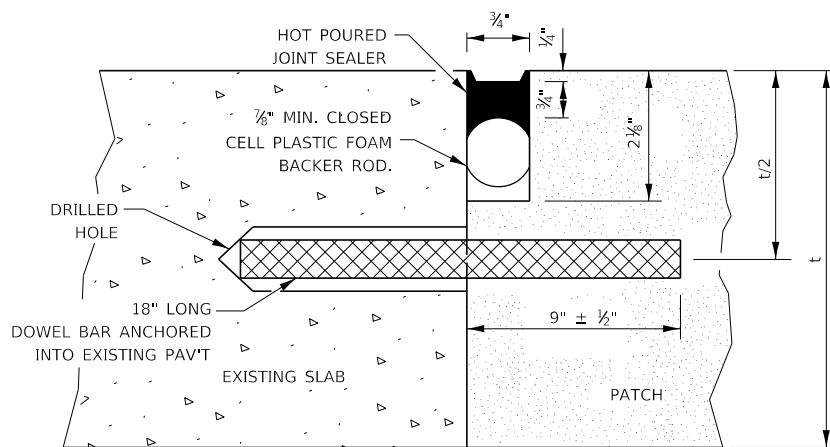

TRANSVERSE JOINT

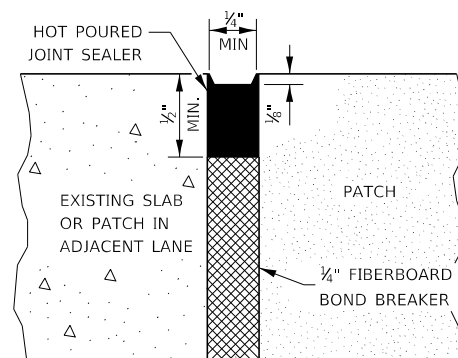

CENTERLINE JOINT

DOWEL BAR TABLE		
PAVEMENT THICKNESS	DOWEL BAR DIAMETER	HOLE DIAMETER
8" OR GREATER	1 1/2"	1 5/8"
7" THRU 7.99"	1 1/4"	1 3/8"
LESS THAN 7"	1"	1 1/8"

GENERAL NOTES

THE TRANSVERSE JOINTS FOR CLASS B PATCHES SHALL ALIGN WITH JOINTS OR CRACKS IN THE ADJACENT LANE WHENEVER POSSIBLE.

SEE STANDARD 420701 FOR DETAILS OF PAVEMENT WELDED WIRE REINFORCEMENT.

MODEL: Default
FILE NAME: \\pav\lanroom\mod\illinois\pav\WIDOT\Documents\WIDOT - Offices\District 3\Projects\D36699\CADD\Drawings\66199-cover.dgn

USER NAME = MARINEJ	DESIGNED - EVAN MARINI	REVISED -
PLOT SCALE = 3,9476' / mm	DRAWN - EVAN MARINI	REVISED -
PLOT DATE = 3/20/2019	CHECKED - RON WOODSHANK	REVISED -
	DATE - 1/22/2019	REVISED -

**STATE OF ILLINOIS
DEPARTMENT OF TRANSPORTATION**

CLASS B PATCHING DETAILS

SCALE: SHEET 1 OF 2 SHEETS STA. TO STA.

F.A.P. RTE.	SECTION	COUNTY	TOTAL SHEETS	SHEET NO.
567	D3 IL 38 PP 2020-2	DEKALB	8	6
CONTRACT NO. 66199			ILLINOIS FED. AID PROJECT	

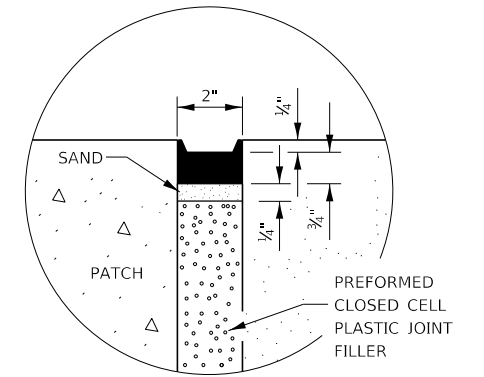
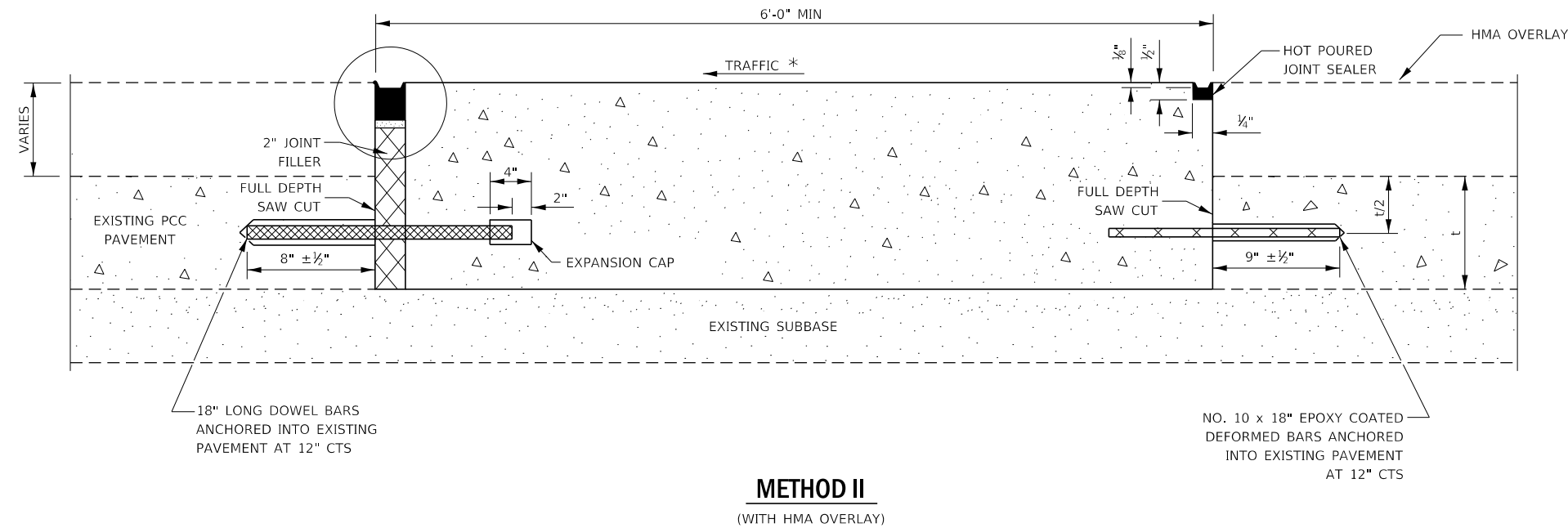
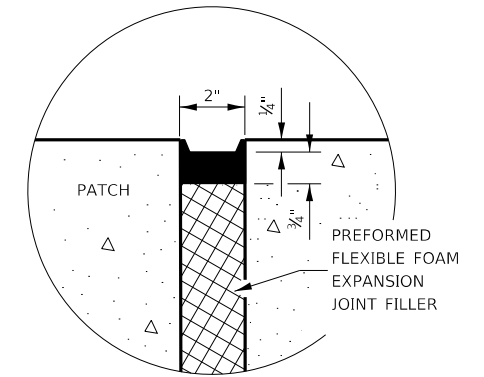
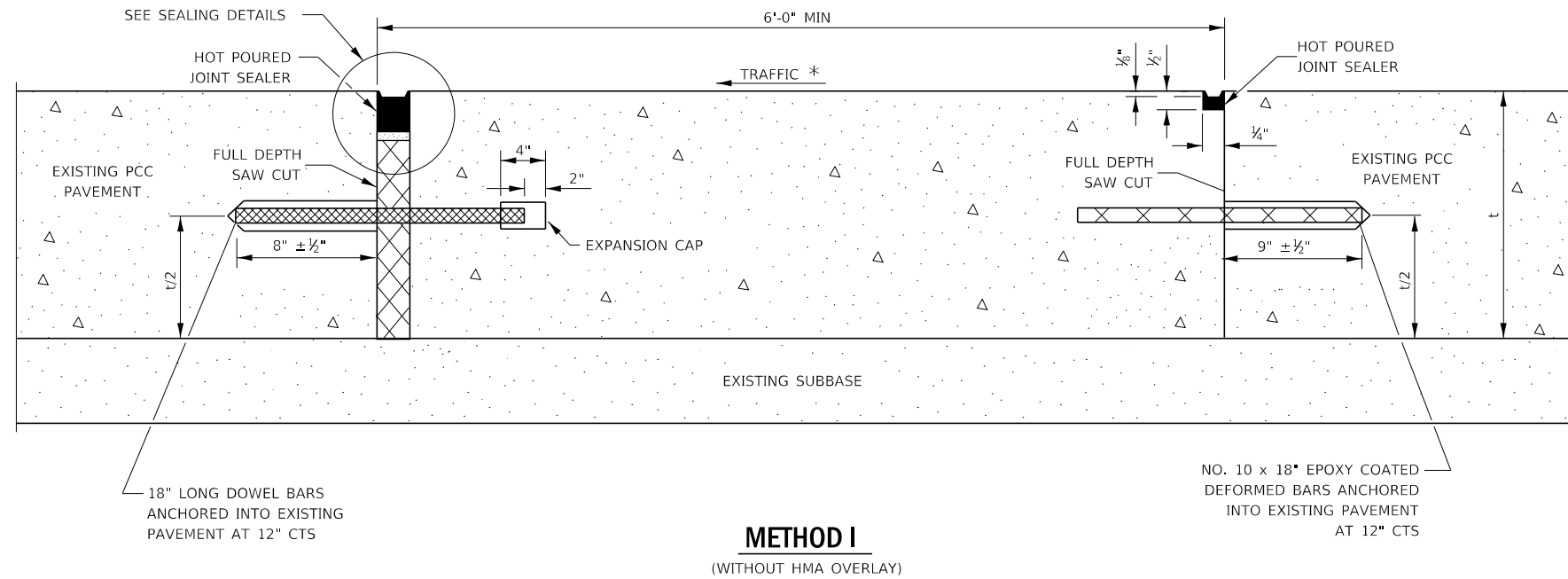

NOTE

* WHEN RE-ESTABLISHING A TRANSVERSE EXPANSION JOINT ON A TWO-WAY ROAD, REVERSE THE ORIENTATION OF THE DOWEL BARS WITH RESPECT TO TRAFFIC FOR ONE OF THE PATCHES SUCH THAT THE JOINT WILL BE CONTINUOUS ACROSS BOTH LANES.

MODEL: Default
FILE NAME: p:\2019\planroom\dot\illinois\dot\11\11\DOT\Documents\DOT - Offices\Director - 31\Projects\366\99\Cadd\366\99\cover.dgn

USER NAME = MARINEJ	DESIGNED - EVAN MARINI	REVISED -
PLOT SCALE = 3,9476 ' / mm	DRAWN - EVAN MARINI	REVISED -
PLOT DATE = 3/20/2019	CHECKED - RON WOODSHANK	REVISED -
	DATE - 1/22/2019	REVISED -

STATE OF ILLINOIS
DEPARTMENT OF TRANSPORTATION

CLASS B PATCHING DETAILS

SCALE: SHEET 2 OF 2 SHEETS STA. TO STA.

F.A.P RTE.	SECTION	COUNTY	TOTAL SHEETS	SHEET NO.
567	D3 IL 38 PP 2020-2	DEKALB	8	7
CONTRACT NO. 66J99				
ILLINOIS FED. AID PROJECT				

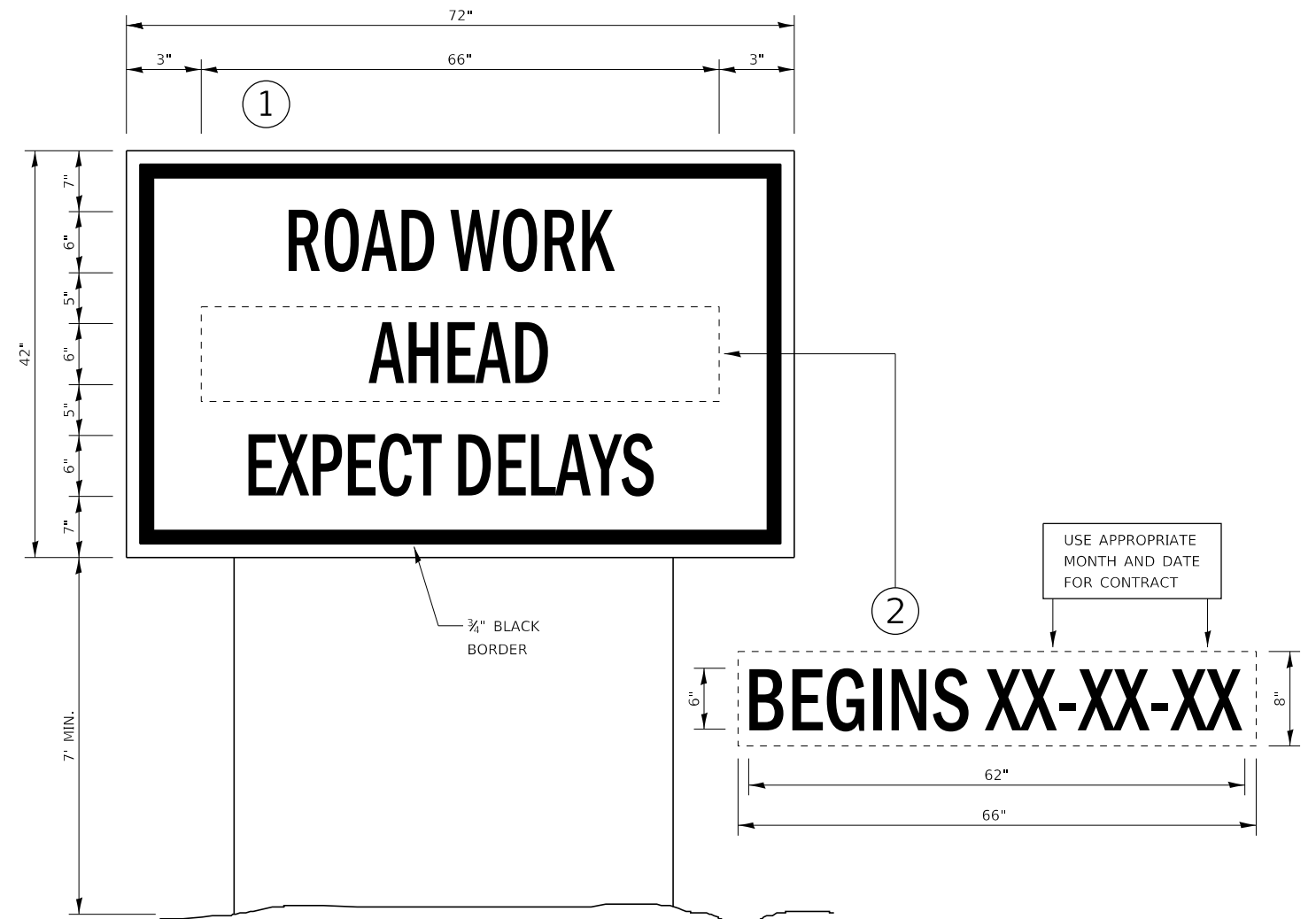

TEMPORARY INFORMATION SIGNING

NOTES:

1. USE 6" D BLACK LETTERING ON FLUORESCENT ORANGE BACKGROUND.
2. ERECT SIGNS AT LOCATIONS IN ADVANCE OF THE "ROAD CONSTRUCTION AHEAD" SIGNS AS DIRECTED BY THE ENGINEER.
3. ERECT SIGN ① WITH INSTALLED PANEL ② A MINIMUM OF ONE WEEK PRIOR TO THE START OF THE LANE CLOSURE.
4. REMOVE PANEL ② ON THAT DATE.
5. SEE SPECIAL PROVISION "TEMPORARY INFORMATION SIGNING" FOR ADDITIONAL INFORMATION.
6. WILL BE PAID FOR PER SQ FT AS "TEMPORARY INFORMATION SIGNING". EACH SIGN = 21 SQ FT AND THE DATE PANEL ② WILL NOT BE MEASURED SEPARATELY FOR PAYMENT.

FILE NAME =	USER NAME = MARINEJ	DESIGNED - EVAN MARINI	REVISED -	STATE OF ILLINOIS DEPARTMENT OF TRANSPORTATION	DETAILS	F.A.P RTE.	SECTION	COUNTY	TOTAL SHEETS	SHEET NO.	
pw2\planroom\dott\hols.gov\PWIDOT\Documents\IDOT	offices\District 3\Projects\ID366J99\CADData\66J99-cover.dgn	DRAWN - EVAN MARINI	REVISED -			567	D3 IL 38 PP 2020-2	DEKALB	8	8	
Default	PLOT SCALE = 3/476 / mm	CHECKED - RON WOODSHANK	REVISED -			CONTRACT NO. 66J99					
	PLOT DATE = 3/20/2019	DATE - 1/22/2019	REVISED -			ILLINOIS FED. AID PROJECT					