

STATE OF ILLINOIS  
DEPARTMENT OF TRANSPORTATION

F.A.P. RTE.	SECTION	COUNTY	TOTAL SHEETS	SHEET NO.
71	D3 IL 54 PP 2020-5	FORD	10	1
		ILLINOIS	CONTRACT NO. 66K03	

**INDEX OF SHEETS**

1. COVER SHEET
2. GENERAL NOTES
3. SUMMARY OF QUANTITIES
4. TYPICAL SECTIONS
- 5-7. SCHEDULES
- 8-9. CLASS B PATCHING DETAILS
10. DETAILS

**STANDARDS**

- 701001-02 OFF-ROAD OPERATIONS 2L, 2W, MORE THAN 15' (4.5 m) AWAY  
701006-05 OFF-ROAD OPERATIONS 2L, 2W, 15' (4.5 m) TO 24" (600 mm) FROM PAVEMENT EDGE  
701336-07 LANE CLOSURE, 2L, 2W, WORK AREAS IN SERIES, FOR SPEEDS ≥ 45 MPH  
701501-06 URBAN LANE CLOSURE, 2L, 2W, UNDIVIDED  
701901-08 TRAFFIC CONTROL DEVICES

**PROPOSED  
HIGHWAY PLANS**

**FAP ROUTE 71 (IL 54)  
SECTION D3 IL 54 PP 2020-5  
PROJECT  
PAVEMENT PATCHING  
FORD COUNTY**

C-93-087-19

**END IMPROVEMENT**  
INTERSECTION OF IL 54  
AND E. MAIN ST.  
IN MELVIN  
LOG MILE 16.96

**BEGIN IMPROVEMENT**  
±130' E OF CHURCH ST.  
IN GIBSON CITY  
LOG MILE 6.11



**FUNCTIONAL CLASSIFICATION**  
RURAL  
MAJOR COLLECTOR  
F.A.P. ROUTE 71 (IL 54)  
2017 ADT = 1500  
P.V. 82% S.U. 8.67% M.U. 9.33%

STATE OF ILLINOIS  
DEPARTMENT OF TRANSPORTATION

SUBMITTED 3-28 2019  
*[Signature]*  
REGIONAL ENGINEER  
May 19 2019  
*[Signature]*  
ENGINEER OF DESIGN AND ENVIRONMENT  
May 19 2019  
*[Signature]*  
DIRECTOR OF HIGHWAYS PROJECT IMPLEMENTATION

**PRINTED BY THE AUTHORITY  
OF THE STATE OF ILLINOIS**

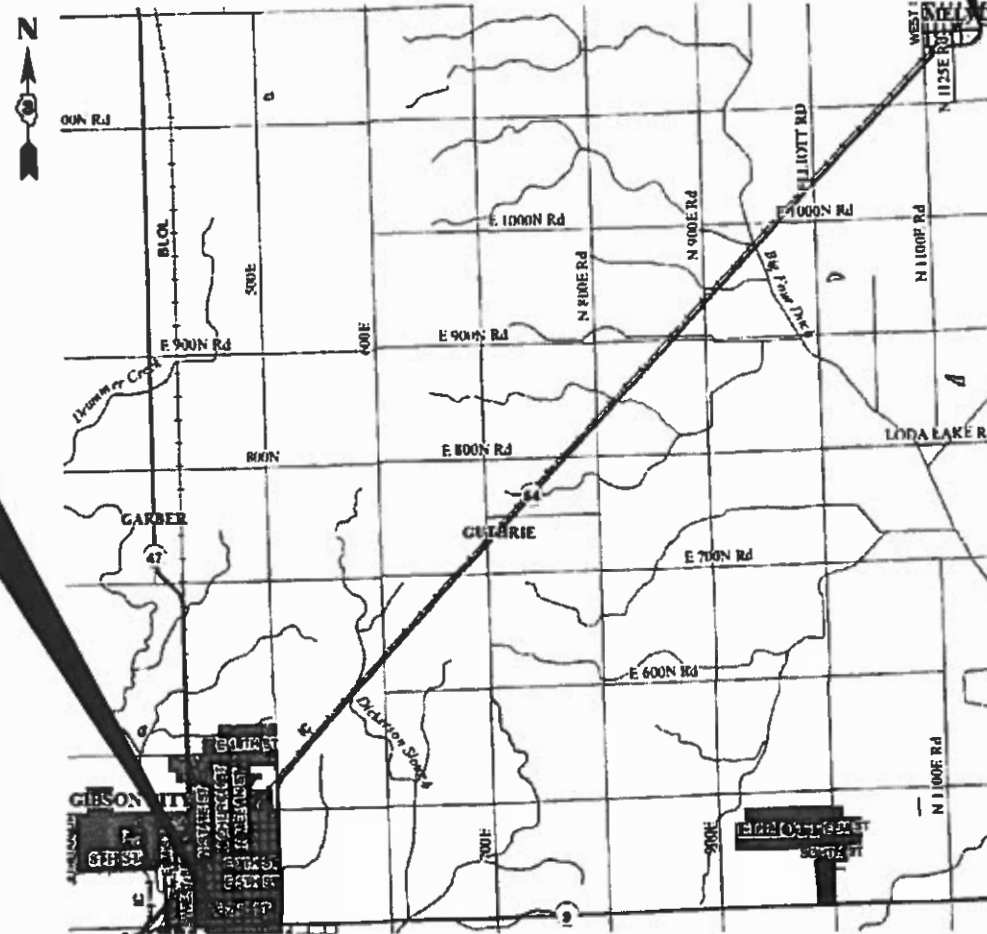

GROSS LENGTH = 57288 FT. = 10.85 MILE  
NET LENGTH = 57288 FT. = 10.85 MILE

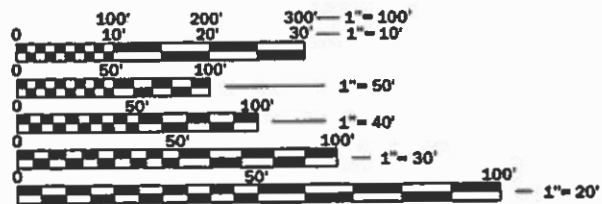

FULL SIZE PLANS HAVE BEEN PREPARED USING STANDARD ENGINEERING SCALES. REDUCED SIZED PLANS WILL NOT CONFORM TO STANDARD SCALES. IN MAKING MEASUREMENTS ON REDUCED PLANS, THE ABOVE SCALES MAY BE USED.

J.U.L.I.E.  
JOINT UTILITY LOCATION INFORMATION FOR EXCAVATION  
1-800-892-0123  
OR 811

**PROJECT ENGINEER JOE KANNEL P.E.**  
**UNIT CHIEF RON WOODSHANK**  
DISTRICT 3 NO. (815) 434-6131  
CONTRACT NO. 66K03

**GENERAL NOTES**

FOR STABILIZATION, ALL TYPE III BARRICADES WILL REQUIRE A MINIMUM OF FOUR SAND BAGS PER BARRICADE.

ALL EXCAVATED MATERIAL, WHICH INCLUDES DIGGING OR GRADING OF ANY SOIL OR FILL MATERIAL, WITH THE EXCEPTION OF AGGREGATE FILLS, MUST BE INCORPORATED WITHIN THE IDOT RIGHT OF WAY DUE TO ENVIRONMENTAL DOCUMENTATION REQUIREMENTS.

ANY REFERENCE TO A STANDARD IN THESE PLANS SHALL BE INTERPRETED TO MEAN THE EDITION AS INDICATED BY THE SUBNUMBER SHOWN IN THE LIST OF STANDARDS OR THE COPY INCLUDED IN THESE PLANS.

THE CONTRACTOR SHALL CONTACT JULIE AT LEAST 48 HOURS PRIOR TO EXCAVATION TO DETERMINE WHICH UTILITIES ARE IN THE AREA.

THE EXISTING CONCRETE PAVEMENT AROUND THE DETECTOR LOOPS SHALL BE AVOIDED UNLESS THE ENGINEER DETERMINES THAT PAVEMENT PATCHING IS REQUIRED. IF PATCHING FALLS WITHIN THE DETECTOR LOOP AREA, CONTACT TRAFFIC SIGNAL SECTION AT 815-434-8506.

**COMMITMENTS**

STATE OF ILLINOIS  
DEPARTMENT OF TRANSPORTATION  
DISTRICT THREE  
AS BUILT INFORMATION

\_\_\_\_\_  
SUPERVISING CONSTRUCTION FIELD ENGINEER

\_\_\_\_\_  
RESIDENT ENGINEER / TECHNICIAN

START & END DATES  
OF CONSTRUCTION:

INSPECTORS:

STATE OF ILLINOIS  
DEPARTMENT OF TRANSPORTATION  
DISTRICT THREE

PREPARED BY: *[Signature]*  
DISTRICT STUDIES & PLANS ENGINEER

DATE: 3-28-19

EXAMINED BY: *[Signature]*  
DISTRICT CONSTRUCTION ENGINEER

*[Signature]*  
DISTRICT MATERIALS ENGINEER

*[Signature]*  
DISTRICT OPERATIONS ENGINEER

FILE NAME =	USER NAME = MARINIEJ	DESIGNED - EVAN MARINI	REVISED -
pw:\planroom.dot\illinois.gov\FWIDOT\Documents\IDOT	offices\District 3\Projects\66K03\CADData\66K03-cover.dgn	DRAWN - EVAN MARINI	REVISED -
Default	PLOT SCALE = 3.9373 / mm	CHECKED - RON WOODSHANK	REVISED -
	PLOT DATE = 3/26/2019	DATE - 1/22/2019	REVISED -

STATE OF ILLINOIS  
DEPARTMENT OF TRANSPORTATION

**GENERAL NOTES**

SCALE: SHEET 1 OF 1 SHEETS STA. TO STA.

F.A.P. RTE.	SECTION	COUNTY	TOTAL SHEETS	SHEET NO.
71	D3 IL 54 PP 2020-5	FORD	10	2
CONTRACT NO. 66K03				
ILLINOIS FED. AID PROJECT				

CODE NO.	ITEM	UNIT	TOTAL QUANTITY	CONSTR. CODE	
				CONTRACT MAINTENANCE	
				100% STATE	
				ROADWAY	
				0006	
				RURAL	
4200060	WELDED WIRE REINFORCEMENT	SQ YD	283		283
44201102	CLASS B PATCHES, TYPE II, 20 INCH	SQ YD	1676		1676
44201104	CLASS B PATCHES, TYPE III, 20 INCH	SQ YD	212		212
44201106	CLASS B PATCHES, TYPE IV, 20 INCH	SQ YD	94		94
44201299	DOWEL BARS 1 1/2"	EACH	3320		3320
44213200	SAW CUTS	FOOT	8672		8672
44213204	TIE BARS 3/4"	EACH	32		32
67100100	MOBILIZATION	L SUM	1		1
X7010216	TRAFFIC CONTROL AND PROTECTION, (SPECIAL)	L SUM	1		1
Z0017099	DOWEL BAR ASSEMBLY	EACH	8		8
Z0030850	TEMPORARY INFORMATION SIGNING	SQ FT	42		42

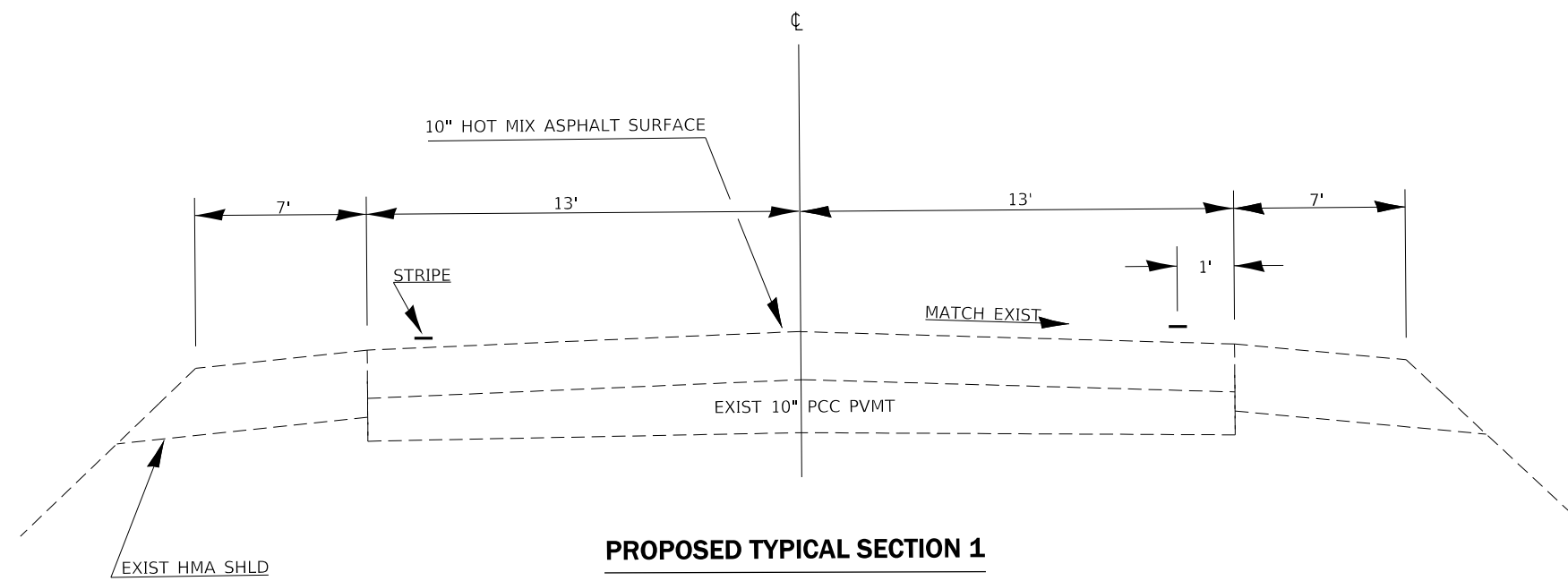

FILE NAME	USER NAME	DESIGNED	REVISED
pwt\planroom\dot\illinois.gov\2PW\DOT\Documents\DOT	MARINIEJ	EVAN MARINI	-
Files\District 3\Projects\ID366K03\CADData\66K03-cover.dgn		EVAN MARINI	-
		RON WOODSHANK	-
		1/22/2019	-

**STATE OF ILLINOIS  
DEPARTMENT OF TRANSPORTATION**

**TYPICAL SECTION**

SCALE: SHEET 1 OF 1 SHEETS STA. TO STA.

F.A.P. RTE.	SECTION	COUNTY	TOTAL SHEETS	SHEET NO.
71	D3 IL 54 PP 2020-5	FORD	10	4
CONTRACT NO. 66K03				
ILLINOIS FED. AID PROJECT				

PATCHING SCHEDULE

EASTBOUND LANE						
LOCATION	PATCH LENGTH	CLASS B		DOWEL BARS 1 1/2"	SAW CUTS	WELDED WIRE REINF.
		TYPE II 20"	TYPE III 20"			
LOG MILE	(FT)	SQ YD	SQ YD	EACH	FOOT	SQ YD
6.30	10	14		20	56	
6.40	8	12		20	52	
6.80	6	9		20	48	
6.90	8	12		20	52	
7.00	6	9		20	48	
7.20	8	12		20	52	
7.40	8	12		20	52	
7.50	6	9		20	48	
7.60	6	9		20	48	
7.70	6	9		20	48	
7.80	10	14		20	56	
7.90	6	9		20	48	
7.90	8	12		20	52	
8.00	6	9		20	48	
8.20	6	9		20	48	
8.30	8	12		20	52	
8.30	15		22	20	66	22
8.40	8	12		20	52	
8.60	6	9		20	48	
8.80	8	12		20	52	
8.90	6	9		20	48	
9.00	8	12		20	52	
9.10	8	12		20	52	
9.20	6	9		20	48	
9.30	6	9		20	48	
9.40	8	12		20	52	
9.50	6	9		20	48	
9.60	6	9		20	48	
9.80	8	12		20	52	
9.90	10	14		20	56	
10.00	6	9		20	48	
TOTALS		321	22	620	1578	22

PATCHING SCHEDULE

EASTBOUND LANE						
LOCATION	PATCH LENGTH	CLASS B		DOWEL BARS 1 1/2"	SAW CUTS	WELDED WIRE REINF.
		TYPE II 20"	TYPE III 20"			
LOG MILE	(FT)	SQ YD	SQ YD	EACH	FOOT	SQ YD
10.10	10	14		20	56	
10.20	6	9		20	48	
10.20	10	14		20	56	
10.30	6	9		20	48	
10.40	6	9		20	48	
10.40	8	12		20	52	
10.60	8	12		20	52	
10.60	10	14		20	56	
10.70	6	9		20	48	
10.90	8	12		20	52	
11.30	10	14		20	56	
11.40	8	12		20	52	
11.50	6	9		20	48	
11.60	6	9		20	48	
11.70	10	14		20	56	
11.80	6	9		20	48	
12.10	8	12		20	52	
12.10	10	14		20	56	
12.40	12		17	20	60	17
12.40	10	14		20	56	
12.60	8	12		20	52	
12.80	8	12		20	52	
12.80	12		17	20	60	17
13.00	6	9		20	48	
13.20	10	14		20	56	
13.30	10	14		20	56	
13.40	6	9		20	48	
13.50	6	9		20	48	
13.50	6	9		20	48	
13.80	6	9		20	48	
14.20	10	14		20	56	
TOTALS		332	34	620	1620	34

PATCHING SCHEDULE

EASTBOUND LANE						
LOCATION	PATCH LENGTH	CLASS B		DOWEL BARS 1 1/2"	SAW CUTS	WELDED WIRE REINF.
		TYPE II 20"	TYPE III 20"			
LOG MILE	(FT)	SQ YD	SQ YD	EACH	FOOT	SQ YD
14.30	6	9		20	48	
14.40	6	9		20	48	
14.50	6	9		20	48	
14.60	10	14		20	56	
14.60	6	9		20	48	
14.70	8	12		20	52	
14.90	6	9		20	48	
15.00	8	12		20	52	
15.10	6	9		20	48	
15.30	8	12		20	52	
15.40	6	9		20	48	
15.50	6	9		20	48	
15.50	8	12		20	52	
15.60	8	12		20	52	
15.70	6	9		20	48	
15.80	6	9		20	48	
15.80	8	12		20	52	
15.90	6	9		20	48	
15.70	6	9		20	48	
16.00	8	12		20	52	
16.10	8	12		20	52	
16.10	8	12		20	52	
16.20	10	14		20	56	
16.20	6	9		20	48	
16.30	10	14		20	56	
16.50	8	12		20	52	
16.70	6	9		20	48	
16.90	8	12		20	52	
17.00	6	9		20	48	
17.00	6	9		20	48	
17.10	8	12		20	52	
17.20	6	9		20	48	
<b>TOTALS</b>		<b>339</b>		<b>640</b>	<b>1608</b>	

PATCHING SCHEDULE

WESTBOUND LANE								
LOCATION	PATCH LENGTH	CLASS B			DOWEL BARS 1 1/2"	SAW CUTS	WELDED WIRE REINF.	TIE BARS 3/4"
		TYPE II	TYPE III	TYPE IV				
		20"	20"	20"				
LOG MILE	(FT)	SQ YD	SQ YD	SQ YD	EACH	FOOT	SQ YD	EACH
17.2	15		22		20	66	22	
17.0	6	9			20	48		
16.9	8	12			20	52		
16.6	6	9			20	48		
16.5	6	9			20	48		
16.4	10	14			20	56		
16.0	6	9			20	48		
15.9	15		22		20	66	22	
15.8	8	12			20	52		
15.6	10	14			20	56		
15.5	20			29	20	76	29	10
15.4	10	14			20	56		
15.3	6	9			20	48		
15.1	6	9			20	48		
15.1	6	9			20	48		
14.9	8	12			20	52		
14.8	6	9			20	48		
14.6	8	12			20	52		
14.5	6	9			20	48		
14.2	8	12			20	52		
14.1	6	9			20	48		
14.0	8	12			20	52		
13.9	10	14			20	56		
13.8	15		22		20	66	22	
13.7	20			29	20	76	29	10
13.5	12		17		20	60	17	
13.3	10	14			20	56		
13.1	8	12			20	52		
13.1	15		22		20	66	22	
13.0	8	12			20	52		
12.9	25			36	20	86	36	12
12.8	10	14			20	56		
12.7	8	12			20	52		
12.6	12		17		20	60	17	
12.0	10	14			20	56		
<b>TOTALS</b>		<b>296</b>	<b>122</b>	<b>94</b>	<b>700</b>	<b>1962</b>	<b>216</b>	<b>32</b>

PATCHING SCHEDULE

WESTBOUND LANE								
LOCATION	PATCH LENGTH	CLASS B			DOWEL BARS 1 1/2"	SAW CUTS	WELDED WIRE REINF.	TIE BARS 3/4"
		TYPE II	TYPE III	TYPE IV				
		20"	20"	20"				
LOG MILE	(FT)	SQ YD	SQ YD	SQ YD	EACH	FOOT	SQ YD	EACH
11.9	8	12			20	52		
11.8	6	9			20	48		
11.7	8	12			20	52		
11.6	12		17		20	60	17	
11.5	8	12			20	52		
11.3	8	12			20	52		
11.1	6	9			20	48		
10.9	6	9			20	48		
10.8	8	12			20	52		
10.6	10	14			20	56		
10.5	10	14			20	56		
10.4	6	9			20	48		
10.3	8	12			20	52		
10.2	8	12			20	52		
10.1	8	12			20	52		
10.0	8	12			20	52		
9.8	6	9			20	48		
9.5	8	12			20	52		
9.3	10	14			20	56		
9.2	12		17		20	60	17	
9.1	6	9			20	48		
9.0	6	9			20	48		
8.7	8	12			20	52		
8.6	8	12			20	52		
8.4	6	9			20	48		
8.2	6	9			20	48		
8.1	8	12			20	52		
7.9	6	9			20	48		
7.7	6	9			20	48		
7.6	8	12			20	52		
7.5	6	9			20	48		
7.3	6	9			20	48		
7.1	8	12			20	52		
7.0	8	12			20	52		
6.9	10	14			20	56		
6.6	6	9			20	48		
6.9	10	14			20	56		
<b>TOTALS</b>		<b>388</b>	<b>34</b>		<b>740</b>	<b>1904</b>	<b>34</b>	

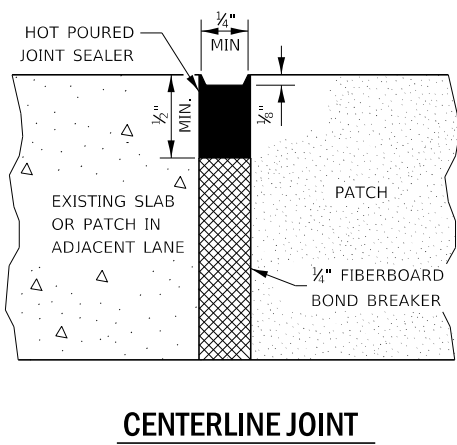
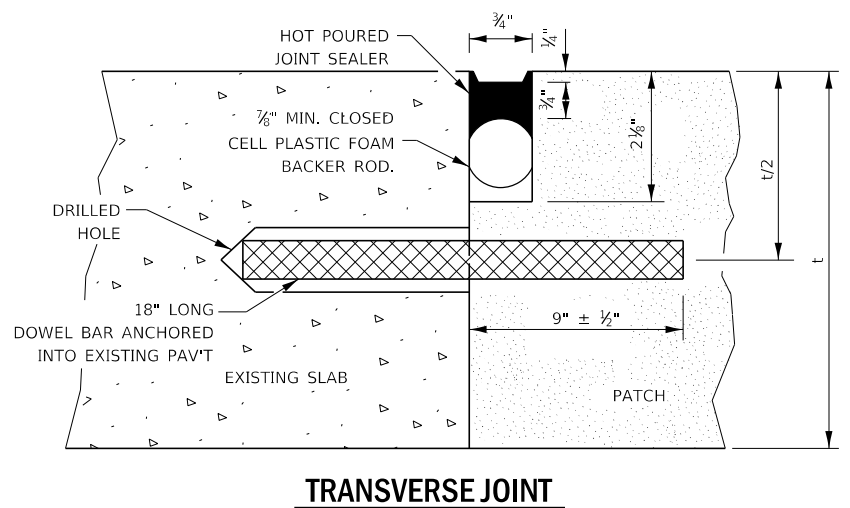
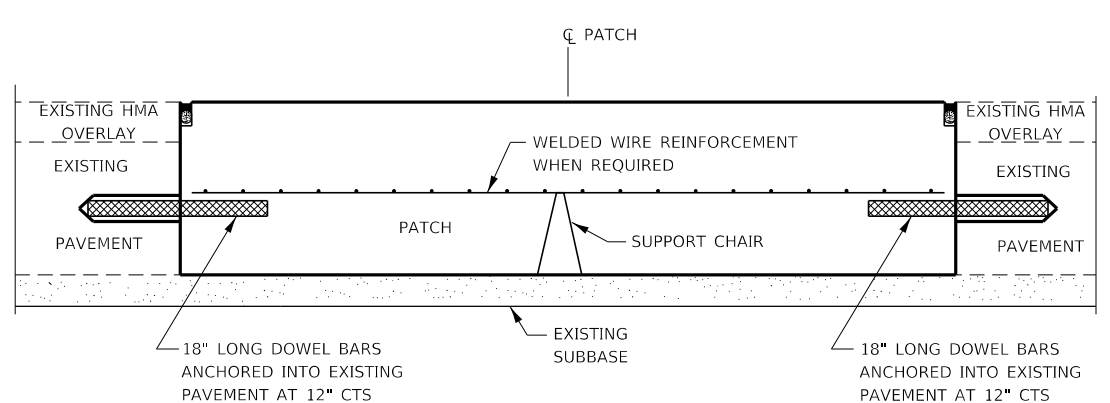
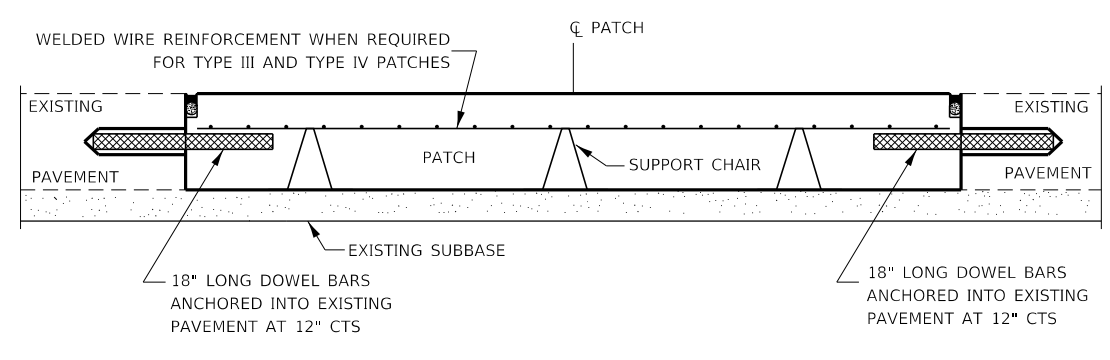
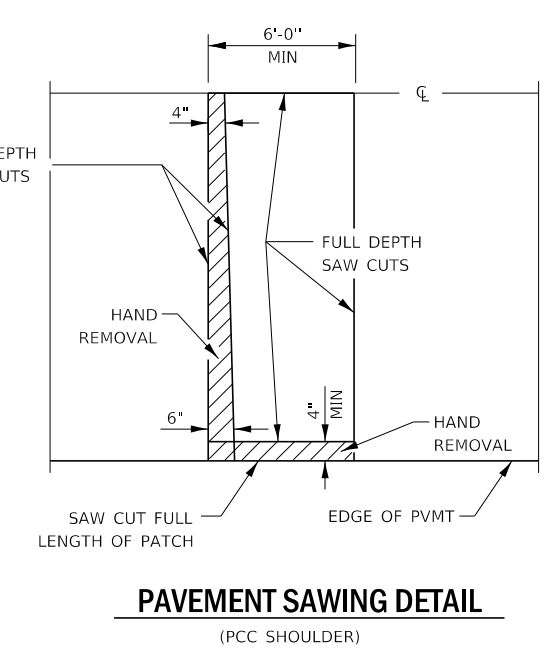
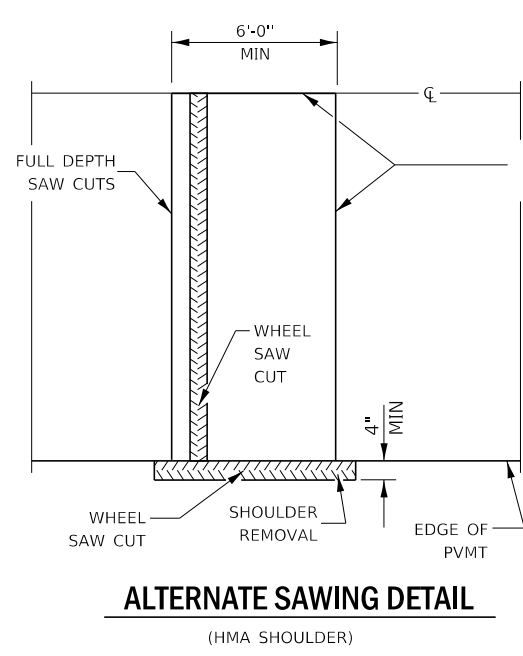
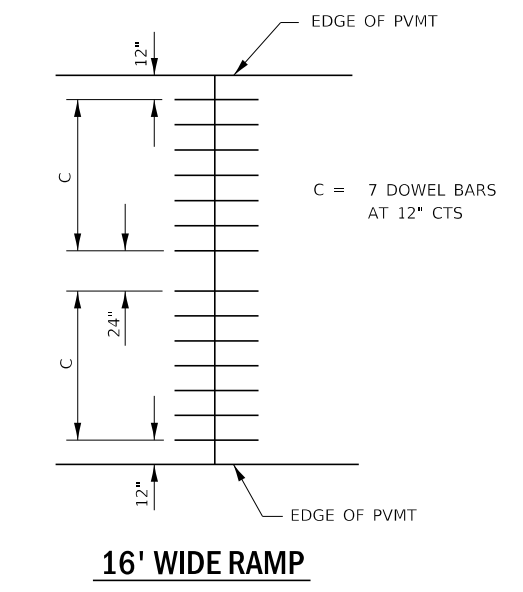
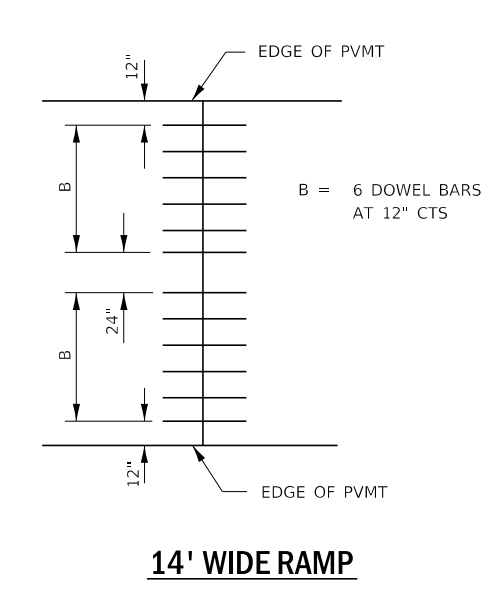
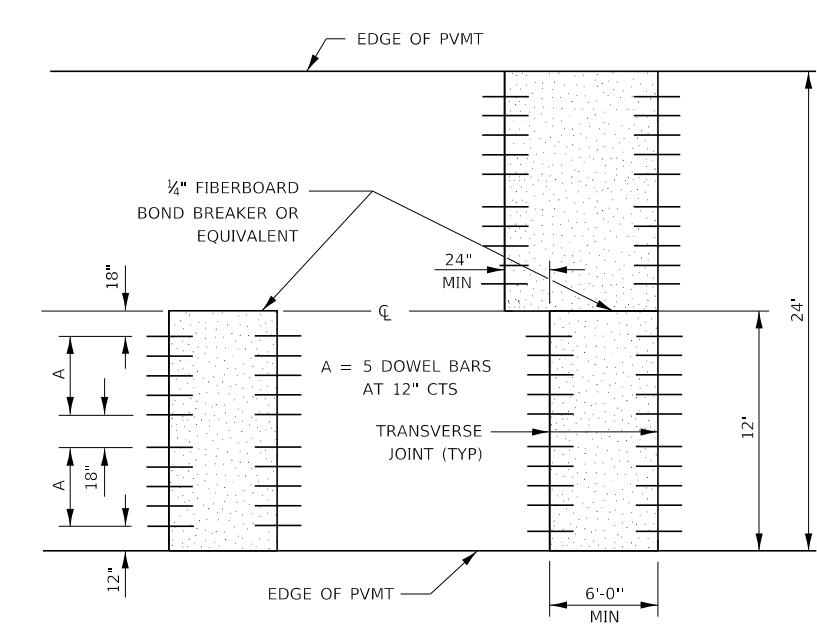
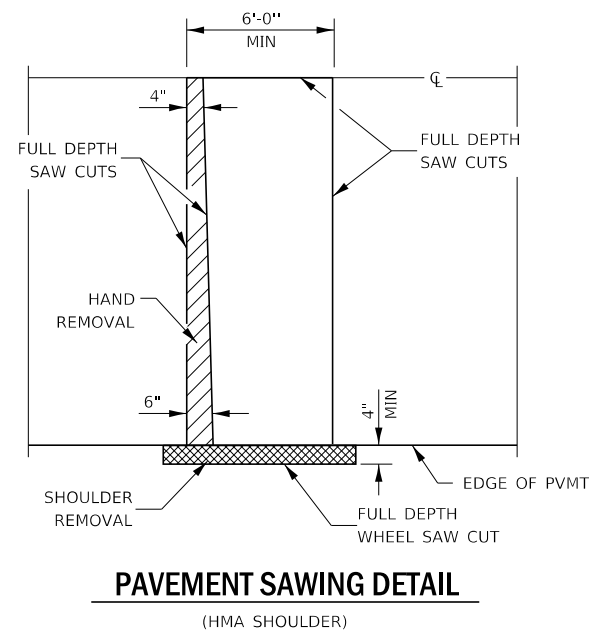

DOWEL BAR TABLE

PAVEMENT THICKNESS	DOWEL BAR DIAMETER	HOLE DIAMETER
8" OR GREATER	1 1/2"	1 3/8"
7" THRU 7.99"	1 1/4"	1 3/8"
LESS THAN 7"	1"	1 1/8"

**GENERAL NOTES**

THE TRANSVERSE JOINTS FOR CLASS B PATCHES SHALL ALIGN WITH JOINTS OR CRACKS IN THE ADJACENT LANE WHENEVER POSSIBLE.

SEE STANDARD 420701 FOR DETAILS OF PAVEMENT WELDED WIRE REINFORCEMENT.

MODEL: Default  
 FILE NAME: P:\Projects\66K03\DOT Documents\DOT Office\Bldg\3\Projects\66K03\CAD\Detail\66K03-cover.dgn

USER NAME = MARINEJ	DESIGNED - EVAN MARINI	REVISED -
PLOT SCALE = 3.9463' / mm	DRAWN - EVAN MARINI	REVISED -
PLOT DATE = 3/26/2019	CHECKED - RON WOODSHANK	REVISED -
	DATE - 1/22/2019	REVISED -

STATE OF ILLINOIS  
DEPARTMENT OF TRANSPORTATION

**CLASS B PATCHING DETAILS**

SCALE: SHEET 1 OF 2 SHEETS STA. TO STA.

F.A.P RTE.	SECTION	COUNTY	TOTAL SHEETS	SHEET NO.
71	D3 IL 54 PP 2020-5	FORD	10	8
CONTRACT NO. 66K03				
ILLINOIS FED. AID PROJECT				



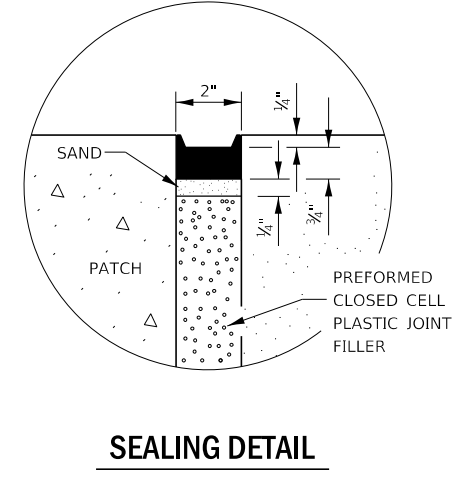
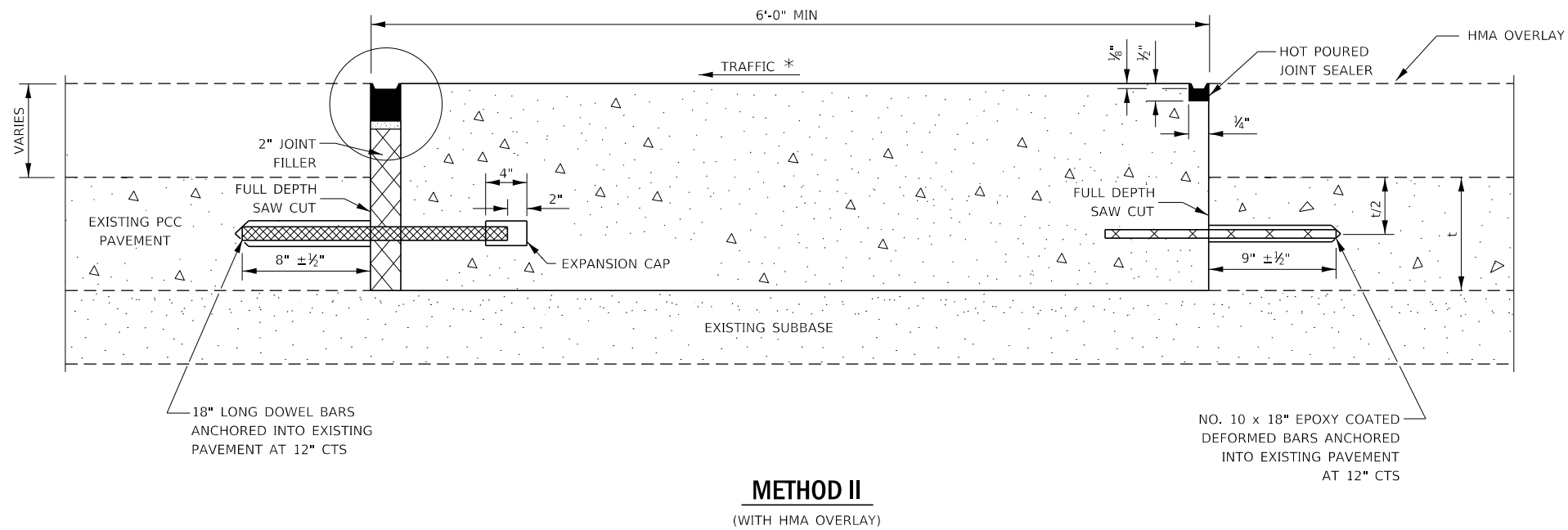
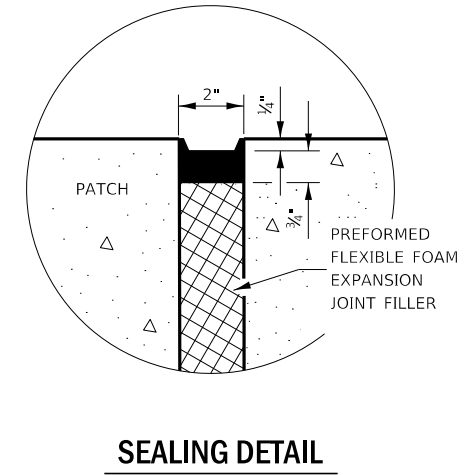
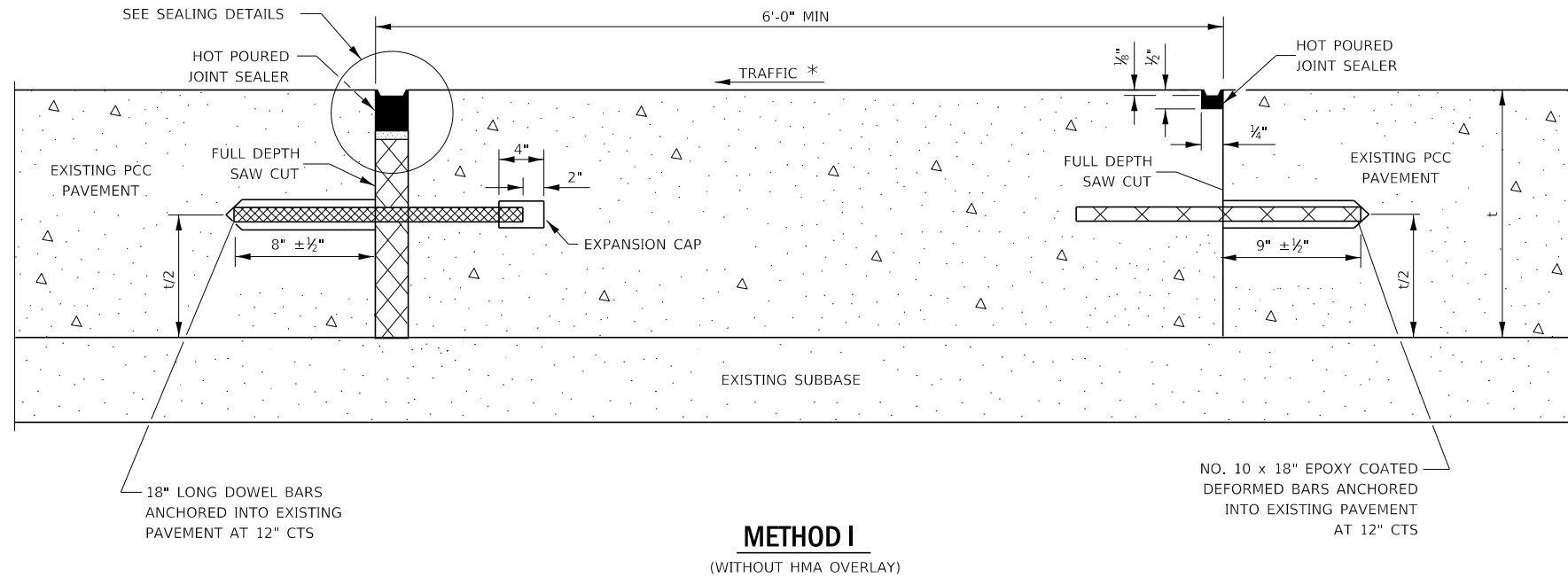

NOTE

\* WHEN RE-ESTABLISHING A TRANSVERSE EXPANSION JOINT ON A TWO-WAY ROAD, REVERSE THE ORIENTATION OF THE DOWEL BARS WITH RESPECT TO TRAFFIC FOR ONE OF THE PATCHES SUCH THAT THE JOINT WILL BE CONTINUOUS ACROSS BOTH LANES.

MODEL: Default  
FILE NAME: p:\w\banosm\del\illinois\gov\p\DOT\Documents\DOT - Offices\District 3\Projects\0366K03\CAD\Detail\66K03-cover.dgn

USER NAME = MARINEJ	DESIGNED - EVAN MARINI	REVISED -
PLOT SCALE = 3,9463' / mm	DRAWN - EVAN MARINI	REVISED -
PLOT DATE = 3/26/2019	CHECKED - RON WOODSHANK	REVISED -
	DATE - 1/22/2019	REVISED -

STATE OF ILLINOIS  
DEPARTMENT OF TRANSPORTATION

CLASS B PATCHING DETAILS

SCALE: SHEET 2 OF 2 SHEETS STA. TO STA.

F.A.P. RTE.	SECTION	COUNTY	TOTAL SHEETS	SHEET NO.
71	D3 IL 54 PP 2020-5	FORD	10	9
CONTRACT NO. 66K03			ILLINOIS FED. AID PROJECT	

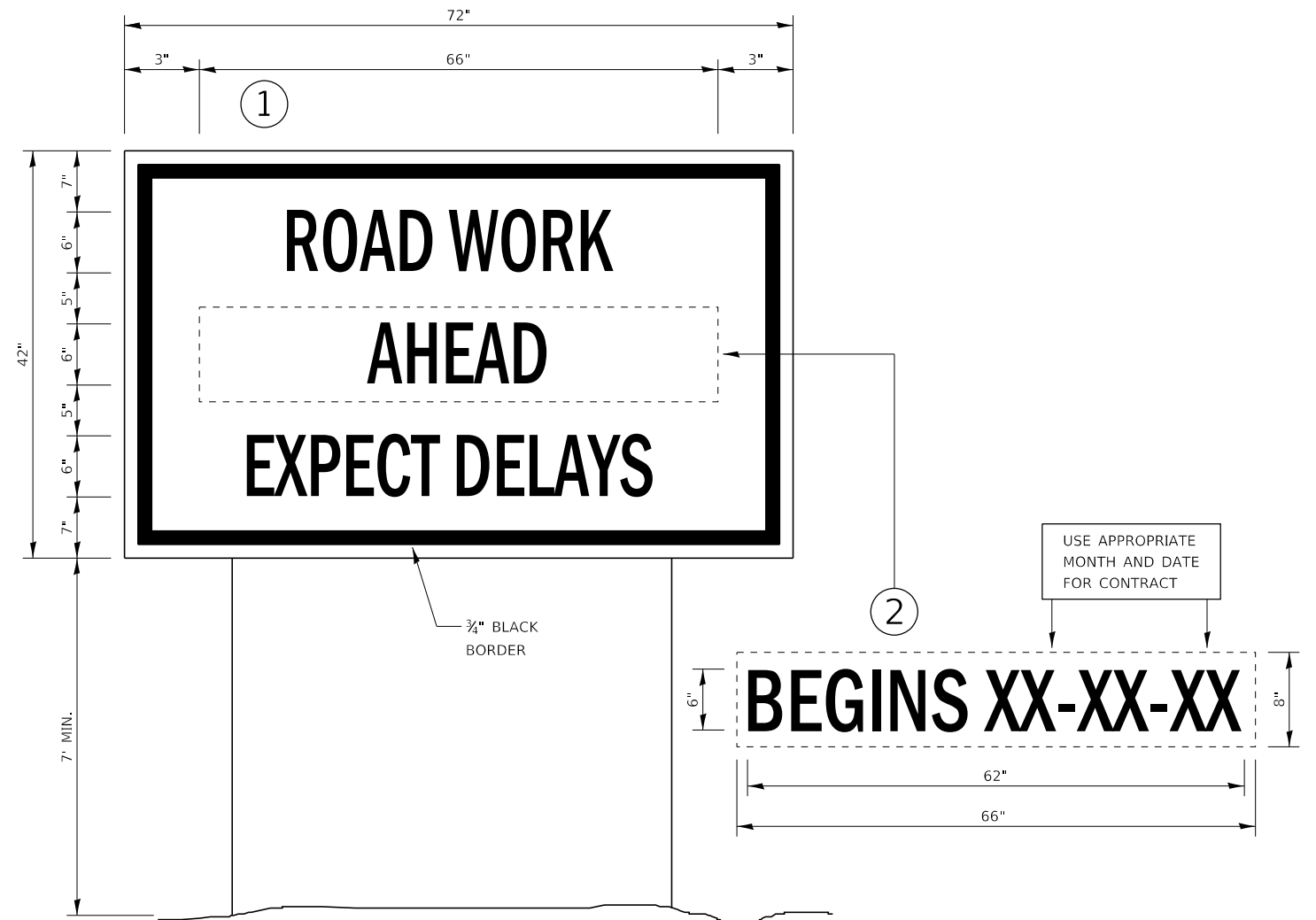

## TEMPORARY INFORMATION SIGNING

### NOTES:

1. USE 6" D BLACK LETTERING ON FLUORESCENT ORANGE BACKGROUND.
2. ERECT SIGNS AT LOCATIONS IN ADVANCE OF THE "ROAD CONSTRUCTION AHEAD" SIGNS AS DIRECTED BY THE ENGINEER.
3. ERECT SIGN ① WITH INSTALLED PANEL ② A MINIMUM OF ONE WEEK PRIOR TO THE START OF THE LANE CLOSURE.
4. REMOVE PANEL ② ON THAT DATE.
5. SEE SPECIAL PROVISION "TEMPORARY INFORMATION SIGNING" FOR ADDITIONAL INFORMATION.
6. WILL BE PAID FOR PER SQ FT AS "TEMPORARY INFORMATION SIGNING". EACH SIGN = 21 SQ FT AND THE DATE PANEL ② WILL NOT BE MEASURED SEPARATELY FOR PAYMENT.

FILE NAME -	USER NAME - MARINIEJ	DESIGNED - EVAN MARINI	REVISED -	<b>STATE OF ILLINOIS DEPARTMENT OF TRANSPORTATION</b>	<b>DETAILS</b>	F.A.P RTE.	SECTION	COUNTY	TOTAL SHEETS	SHEET NO.		
pwc:\planroom\dot\illinois.gov\FW\DOT\Documents\DOT\Files\Dist\ct 3\Projects\0366K03\CADData\66K03-cover.dgn						DRAWN - EVAN MARINI	REVISED -	71	D3 IL 54 PP 2020-5	FORD	10	10
PLOT SCALE = 3,9429 / mm						CHECKED - RON WOODSHANK	REVISED -	CONTRACT NO. 66K03				
Default						PLOT DATE - 3/11/2019	DATE - 1/22/2019	SCALE:	SHEET 1	OF 1	SHEETS	STA. TO STA.