

SUMMARY OF QUANTITIES
CONSTRUCTION TYPE CODE: 0010

S.P.	PAY ITEM NO.	DESCRIPTION	UNIT	QUANTITY
*	20101000	TEMPORARY FENCE	FOOT	105
*	20200100	EARTH EXCAVATION	C.Y.	1050
	20201200	REMOVAL AND DISPOSAL OF UNSUITABLE MATERIAL	C.Y.	193
	20400800	FURNISHED EXCAVATION	C.Y.	115
	20700220	POROUS GRANULAR EMBANKMENT	C.Y.	110
*	25000110	SEEDING, CLASS 1A	ACRE	0.2
*	25000400	NITROGEN FERTILIZER NUTRIENT	LBS	25
*	25000500	PHOSPHORUS FERTILIZER NUTRIENT	LBS	25
*	25000600	POTASSIUM FERTILIZER NUTRIENT	LBS	25
	25100630	EROSION CONTROL BLANKET	S.Y.	948
	28000250	TEMPORARY EROSION CONTROL SEEDING	LBS	20
	28000400	PERIMETER EROSION BARRIER	FT.	474
	28000500	INLET AND PIPE PROTECTION	EA.	1
	28100107	STONE RIPRAP, CLASS A4	S.Y.	50
	28200200	FILTER FABRIC	S.Y.	50
	31101000	SUBBASE GRANULAR MATERIAL, TYPE B	TON	690
	35102400	AGGREGATE BASE COURSE, TYPE B 12"	S.Y.	1315
	40300200	BITUMINOUS MATERIALS (PRIME COAT)	TON	1.33
	40300400	BITUMINOUS MATERIALS (COVER AND SEAL COATS)	TON	2.4
	40300600	SEAL COAT AGGREGATE	TON	20
	50100100	REMOVAL OF EXISTING STRUCTURES	EACH	1
	50800105	REINFORCEMENT BARS	LBS	18750
	51500100	NAME PLATES	EACH	1
	54003000	CONCRETE BOX CULVERTS	C.Y.	87.7
	542C1063	PIPE CULVERTS, CLASS C, TYPE 2, 18"	FOOT	37
	54213453	END SECTIONS, 18"	EACH	2
	5422C048	PIPE CULVERTS, CLASS C, TYPE 2, 48" (TEMPORARY)	FOOT	126
△	* 56100500	WATER MAIN 4"	FOOT	146
△	56109416	DUCTILE IRON WATER MAIN FITTINGS 4" 45.00 DEGREE BEND	EACH	8
	50000100	MEMBRANE WATERPROOFING	S.F.	855
△	63000005	STEEL PLATE BEAM GUARDRAIL, TYPE B	FOOT	225
△	63000030	STRONG POST GUARDRAIL ATTACHED TO CULVERT	FOOT	48
	63100041	TRAFFIC BARRIER TERMINAL, TYPE 1B	EACH	2
△	63100045	TRAFFIC BARRIER TERMINAL, TYPE 2	EACH	2
	67100100	MOBILIZATION	L.S.	1
	LR631020	TRAFFIC BARRIER TERMINAL, TYPE 1	EACH	2
△	* XX006253	SANITARY MANHOLE, 4'-DIAMETER	EACH	4
△	* XX007263	GATE VALVE AND BOX 4"	EACH	2
	X0326806	WASHOUT BASIN	L.S.	1
	X090064	MEMBRANE WATERPROOFING SYSTEM FOR BURIED STRUCTURES	S.Y.	95
	* X2010400	STUMP REMOVAL ONLY	UNIT	108
△	* X2200020	FENCE REMOVAL AND REINSTALLATION	FOOT	150
△	* X5610654	WATER MAIN TO BE ABANDONED, 4"	FOOT	136
△	* X5630704	CONNECTION TO EXISTING WATER MAIN 4"	EACH	2
	* X7010216	TRAFFIC CONTROL AND PROTECTION SPECIAL	L.S.	1
	* Z0054500	ROCK FILL	TON	336
△	* Z0056900	SANITARY SEWER, 8"	FOOT	116
△	* Z0067200	STEEL CASINGS 10"	FOOT	50
△	* Z0067500	STEEL CASINGS 16"	FOOT	50

△ SPECIALTY ITEMS

FEHR GRAHAM
ENGINEERING & ENVIRONMENTAL
ILLINOIS DESIGN FIRM NO. 184-003525

ILLINOIS
IOWA
WISCONSIN

OWNER/DEVELOPER:
VILLAGE OF WINSLOW
501 SCHOOL STREET
WINSLOW, IL 61089

PROJECT AND LOCATION:
SCHOOL ST CULVERT
IMPROVEMENTS
WINSLOW, IL

DRAWN BY: M.S.
APPROVED BY: P.E.
DATE: 02/25/19
SCALE: AS NOTED

REVISIONS		
REV. NO.	DESCRIPTION	DATE
1	ADDENDUM 1	5/30/19

DRAWING:
SUMMARY OF QUANTITIES

SET TYPE:
C:\C30\1616-326A\Plan\16-326A_Plan.dwg SUMMARY

JOB NUMBER:
16-326A

SHEET NUMBER:
2 of 22

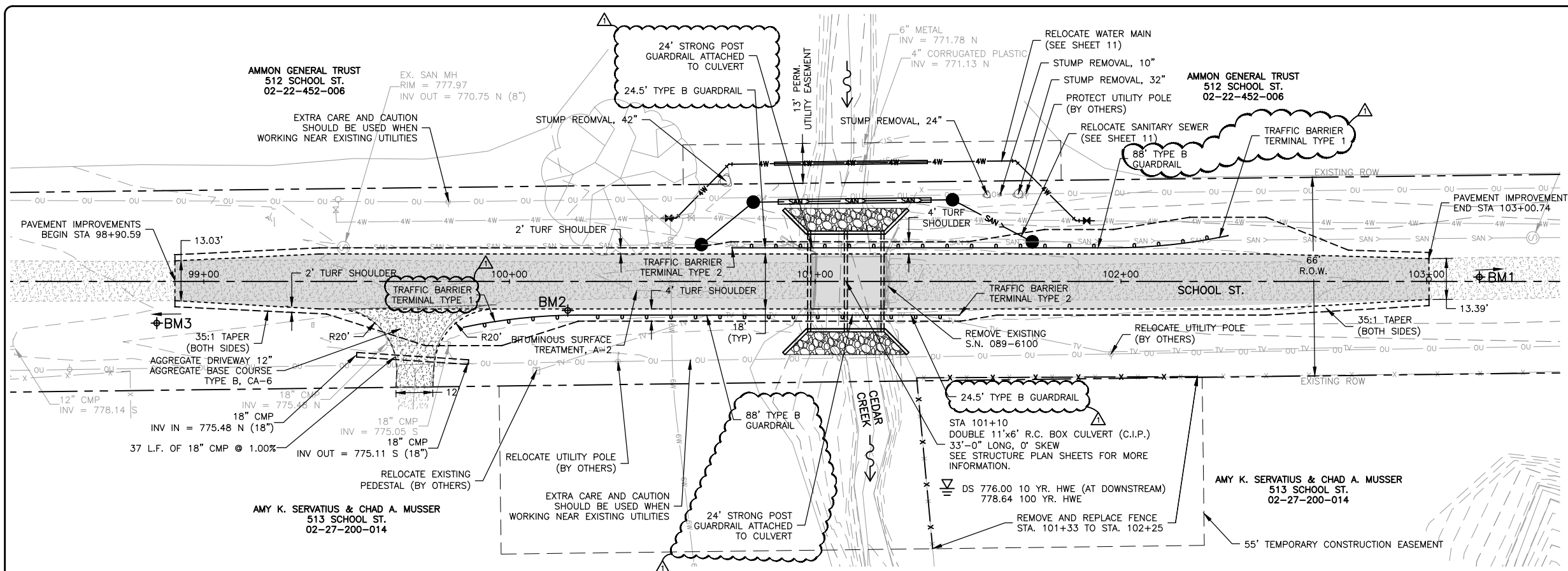

NOTES:

EXISTING BRIDGE TO BE REMOVED AND REPLACED WITH A NEW REINFORCED CONCRETE BOX CULVERT. SEE STRUCTURE PLAN SHEETS FOR MORE INFORMATION ABOUT THE PROPOSED STRUCTURE.

SEE PROPOSED TYPICAL SECTION SHEETS FOR GRAVEL SURFACE INFORMATION.

PROPOSED RECONSTRUCTION WILL REMOVE AND REPLACE THE EXISTING ROADWAY WITHIN THE IMPROVEMENT LIMITS. CHANNEL DISTURBANCE WILL BE LIMITED TO THAT REQUIRED TO REMOVE THE EXISTING CULVERT, TO CONSTRUCT THE NEW STRUCTURE AND TO TRANSITION FROM THE NEW STRUCTURE TO THE NATURAL CHANNEL.

CONTRACTOR TO COORDINATE WITH UTILITY COMPANIES (COST INCIDENTAL TO CONTRACT)

EXISTING STRUCTURE: No. 089-6100
SINGLE SPAN STEEL I-BEAM BRIDGE STRUCTURE ON CLOSED CONCRETE ABUTMENTS.

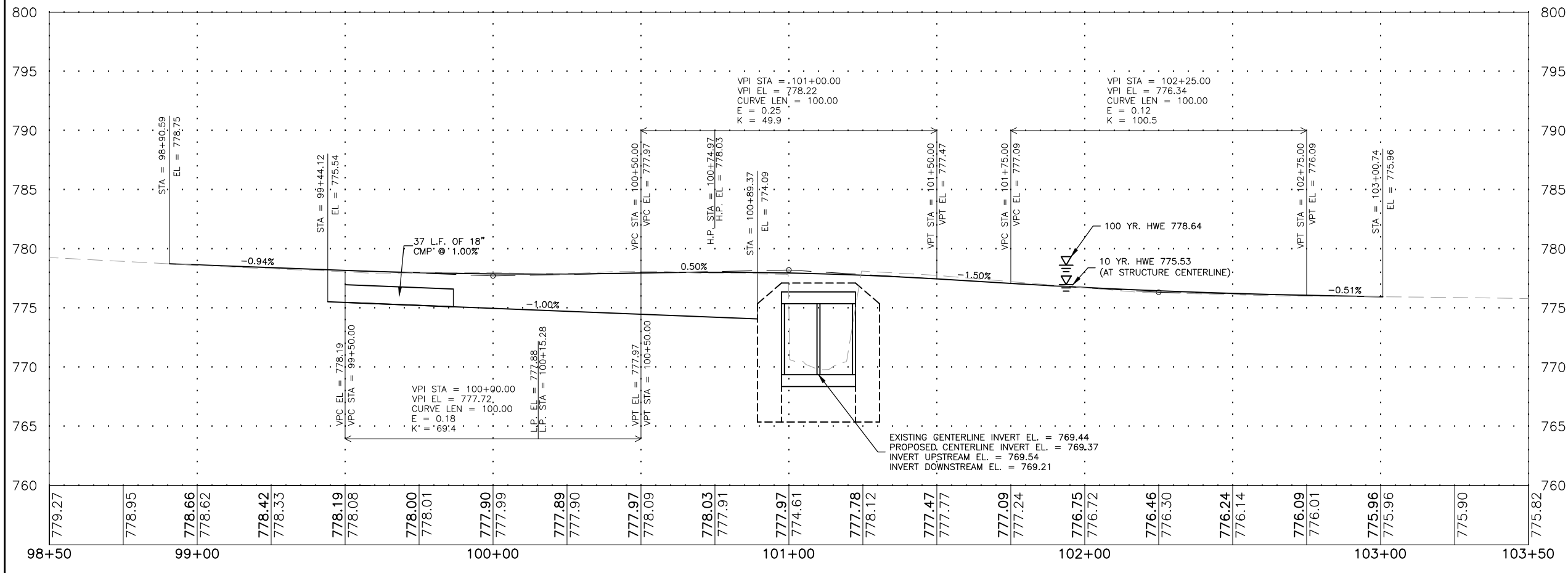
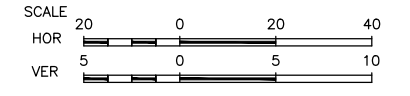

GEOMETRY CHECKED USING AUTODESK VEHICLE TRACKING SOFTWARE 2015. DESIGN VEHICLE USED WAS SCHOOL BUS-40.

BM1

DATUM INFORMATION	
VERTICAL CONTROL:	NAVD 88
HORIZONTAL CONTROL:	NAD 83 IL STATE PLANE WEST
BENCHMARK INFORMATION	
BM1 = CONTROL POINT REBAR (CPRB3)	N 2120975.04, E 2397206.15, ELEV 776.00
BM2 = CONTROL POINT REBAR (CPRB4)	N 2120376.16, E 2397193.13, ELEV 777.74
BM3 = CONTROL POINT REBAR (CPRB5)	N 2119917.77, E 2397166.84, ELEV 786.96

FEHR GRAHAM
ENGINEERING & ENVIRONMENTAL
ILLINOIS DESIGN FIRM NO. 184-003525

ILLINOIS
IOWA
WISCONSIN

OWNER/DEVELOPER:
VILLAGE OF WINSLOW
501 SCHOOL STREET
WINSLOW, IL 61089

PROJECT AND LOCATION:
SCHOOL ST CULVERT IMPROVEMENTS
WINSLOW, IL

DRAWN BY: M.S.
APPROVED BY: P.E.
DATE: 02/25/19
SCALE: AS NOTED

REVISIONS		
REV. NO.	DESCRIPTION	DATE
1	ADDENDUM 1	5/30/19

DRAWING:
SCHOOL STREET PLAN AND PROFILE
STA. 99+00 TO 103+00

SET TYPE:
G:\30\1616-326A\16-326A Design.dwg, P&P

JOB NUMBER:
16-326A

SHEET NUMBER:
9 of 22

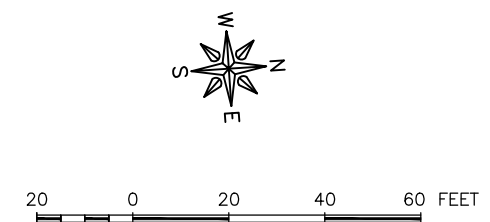
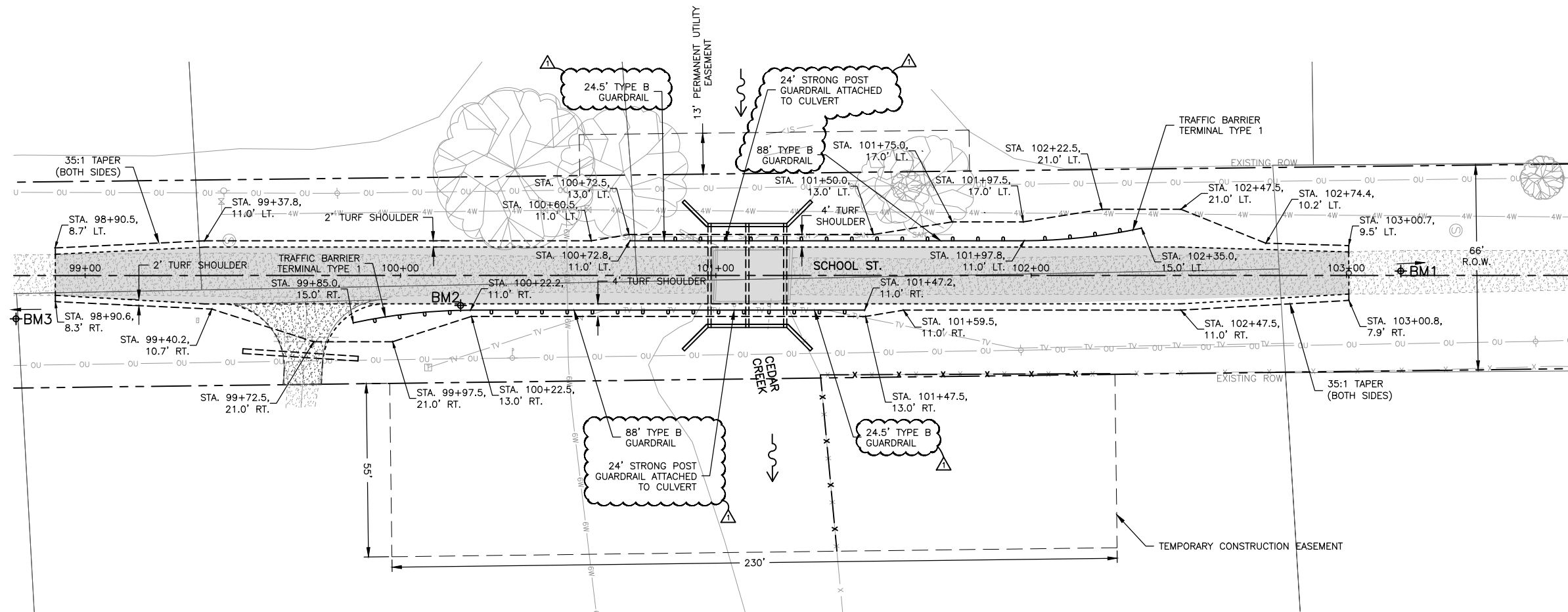

BM1

DATUM INFORMATION	
VERTICAL CONTROL:	NAVD 88
HORIZONTAL CONTROL:	NAD 83 IL STATE PLANE WEST
BENCHMARK INFORMATION	
BM1 = CONTROL POINT REBAR (CPRB3)	N 2120975.04, E 2397206.15, ELEV 776.00
BM2 = CONTROL POINT REBAR (CPRB4)	N 2120376.16, E 2397193.13, ELEV 777.74
BM3 = CONTROL POINT REBAR (CPRB5)	N 2119917.77, E 2397166.84, ELEV 786.96

FEHR GRAHAM
ENGINEERING & ENVIRONMENTAL
ILLINOIS DESIGN FIRM NO. 184-003525

ILLINOIS
IOWA
WISCONSIN

OWNER/DEVELOPER:
VILLAGE OF WINSLOW
501 SCHOOL STREET
WINSLOW, IL 61089

PROJECT AND LOCATION:
SCHOOL ST CULVERT
IMPROVEMENTS
WINSLOW, IL

DRAWN BY: M.S.
APPROVED BY: P.E.
DATE: 02/25/19
SCALE: AS NOTED

REVISIONS		
REV. NO.	DESCRIPTION	DATE
1	ADDENDUM 1	5/30/19

DRAWING:
SHOULDER AND GUARDRAIL DETAIL
SET TYPE:
G:\CD\16\16-326A\Plans\16-326A_Plan.dwg, GUARDRAIL

JOB NUMBER:
16-326A
SHEET NUMBER:
12 of 22