

ROAD CLASSIFICATION: MAJOR COLLECTOR
DESIGN SPEED: 50 M.P.H.

06-14-2019 LETTING ITEM 228

STATE OF ILLINOIS

DEPARTMENT OF TRANSPORTATION

DIVISION OF HIGHWAYS

PLANS FOR PROPOSED ROADWAY IMPROVEMENTS

FAS 1874 REND CITY ROAD

Franklin County, Illinois

Section 08-00170-00-RS

Project 2DA2(122)

Job C-99-526-09

ROUTE	SECTION	COUNTY	SHEET NO.
FAS 1874	08-00170-00-RS	FRANKLIN	1 OF 7
			CONTRACT 99622

ADT:
(2019) = 1350
(2039) = 1890
PC = 1663
SU = 132
MU = 95
DHV₂₀ = 189

SHEET NO.	TITLE
1	COVER SHEET AND SUMMARY OF QUANTITIES
2	MISCELLANEOUS DETAILS AND TYPICAL SECTIONS
3	MISCELLANEOUS DETAILS
4-7	PLAN

STANDARDS

701006-05
701301-04
701306-04
701311-03
701901-08
780001-05
BLR 24-2

SUMMARY OF QUANTITIES			
CODE NO.	PAY ITEM	UNIT	TOTAL
40200800	AGGREGATE SURFACE COURSE, TYPE B	TON	72
40600275	BITUMINOUS MATERIALS (PRIME COAT)	POUND	1,624
40600982	HOT-MIX ASPHALT SURFACE REMOVAL	SQ YD	863
	-BUTT JOINT		
40603085	HOT-MIX ASPHALT BINDER COURSE, IL 19.0, N70	TON	4,950
40603315	HOT-MIX ASPHALT SURFACE COURSE, MIX "C", N70	TON	3,880
44300100	AREA REFLECTIVE CRACK CONTROL	SQ YD	38,621
48100100	AGGREGATE SHOULDERS, TYPE A	TON	2,555
67100100	MOBILIZATION	L SUM	1
70300100	SHORT-TERM PAVEMENT MARKING	FOOT	3,062
Δ7800110	PAINT PAVEMENT MARKING - LINE 4"	FOOT	38,214
X4401198	HOT MIX ASPHALT SURFACE REMOVAL	SQ YD	3,016
Δ	SPECIALTY ITEM VARIABLE DEPTH		

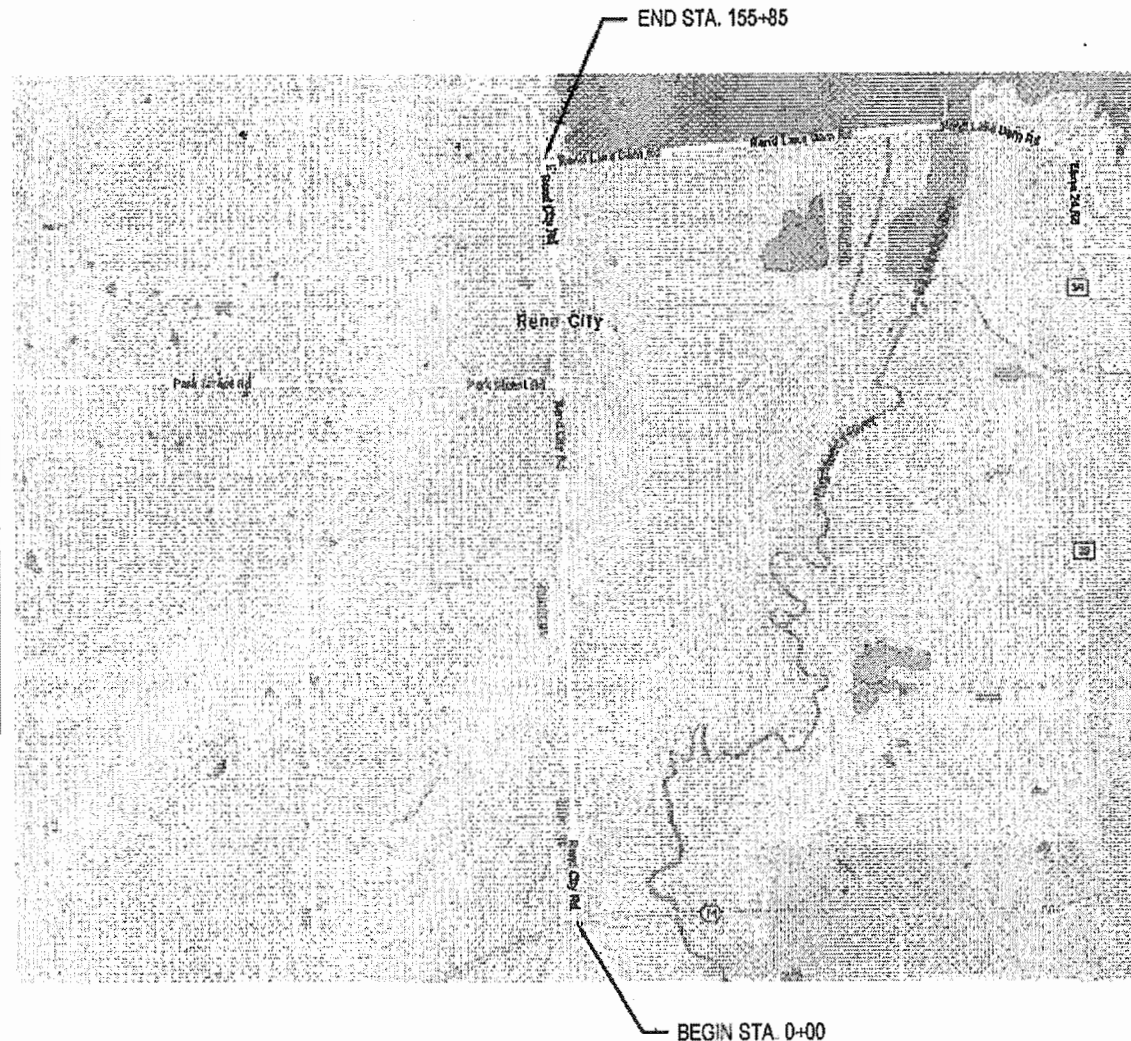

LOCATION MAP
NET LENGTH = 2.95 miles (15585 Feet)



STATE OF ILLINOIS	
DEPARTMENT OF TRANSPORTATION	
APPROVED	2/28/2019 <i>[Signature]</i>
FRANKLIN COUNTY HIGHWAY ENGINEER	
PASSED	APRIL 09, 2019 <i>[Signature]</i>
DISTRICT ENGINEER OF LOCAL ROADS & STREETS	
RELEASING FOR BID	
BASED ON LIMITED	APRIL 09, 2019
REVIEW	<i>[Signature]</i>
DEPUTY DIRECTOR OF HIGHWAYS, REGION 5 ENGINEER	

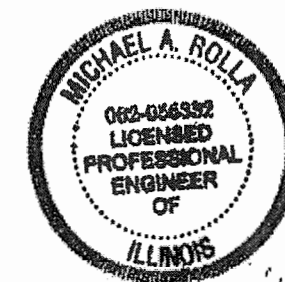

[Signature]
MICHAEL A. ROLLA
ILLINOIS REGISTERED PROFESSIONAL ENGINEER
#062-056332
LIC. EXPIRES 11/30/2019

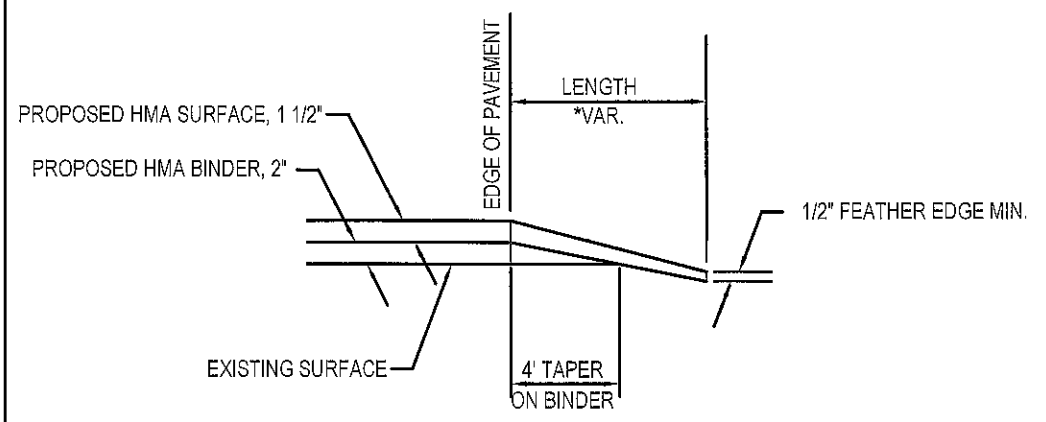
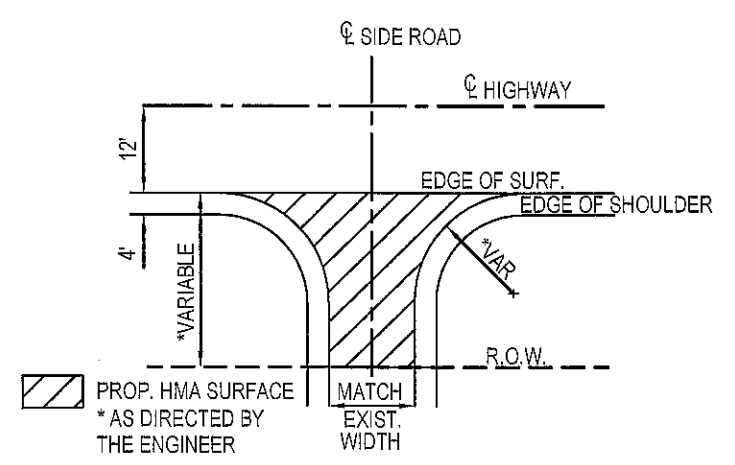

SIDEROAD DETAILS

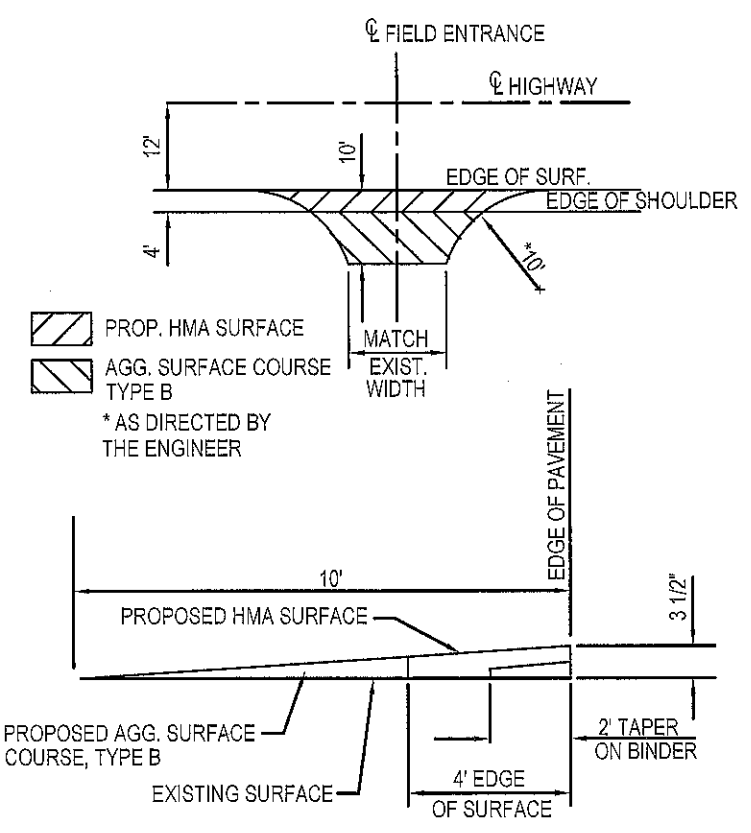

FIELD ENTRANCE DETAILS

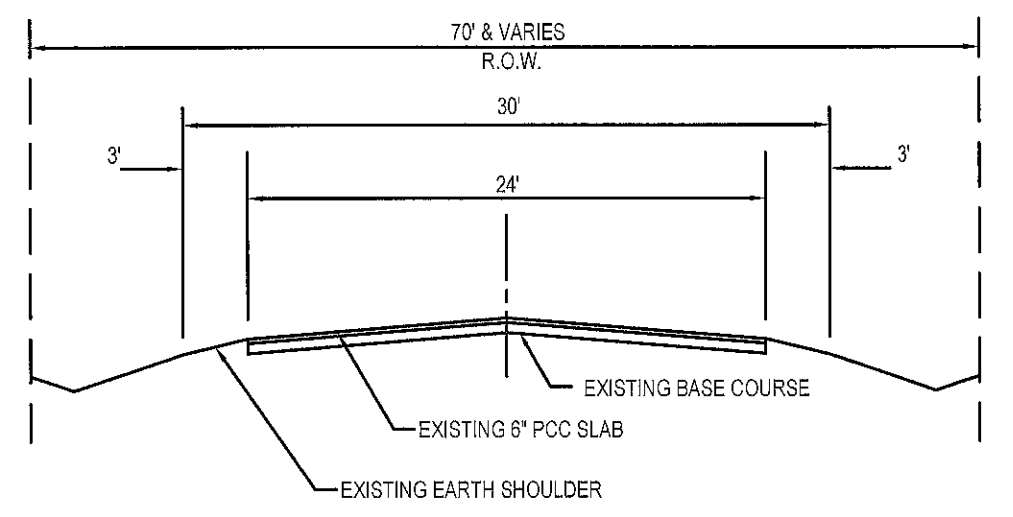

TYPICAL EXISTING SECTION

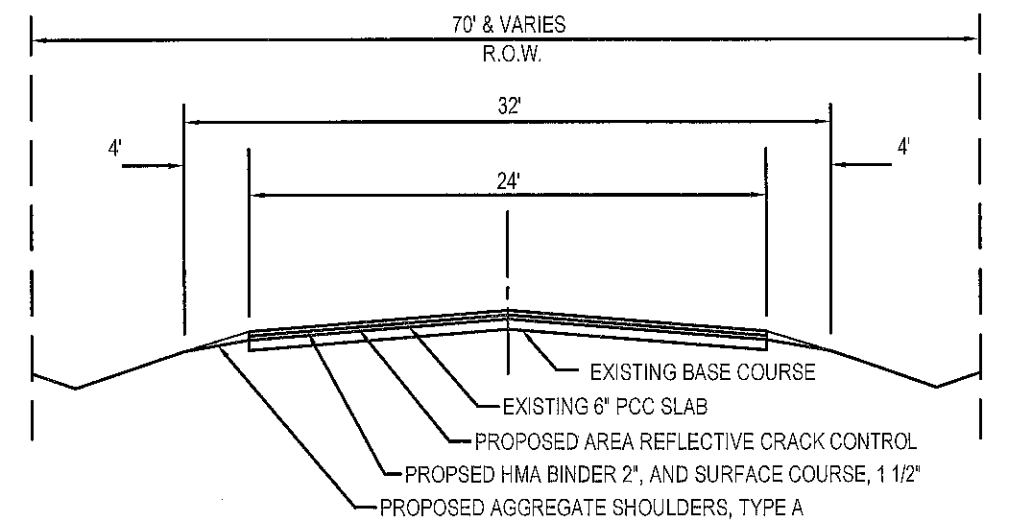

TYPICAL PROPOSED SECTION

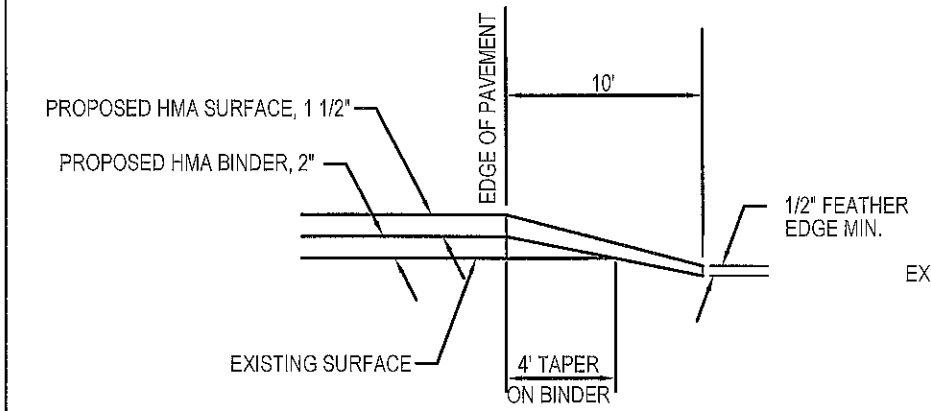
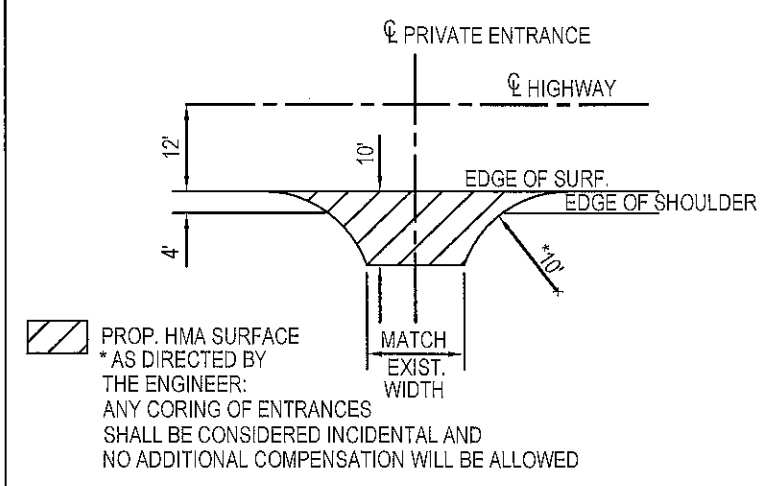

PRIVATE AND COMMERCIAL ENTRANCE DETAILS

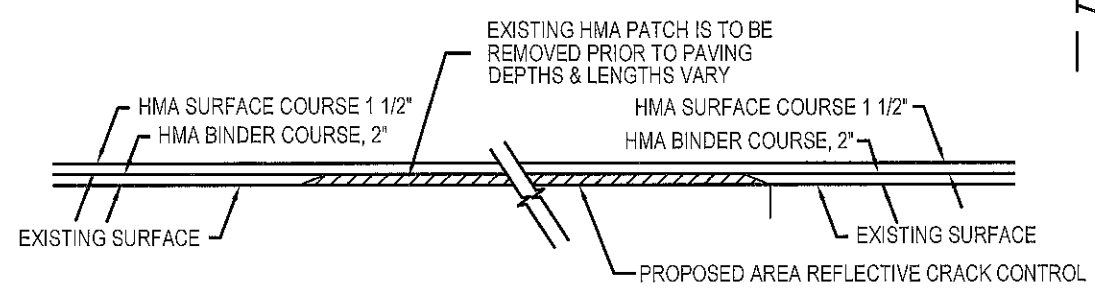

HMA REMOVAL-VARIABLE DEPTH

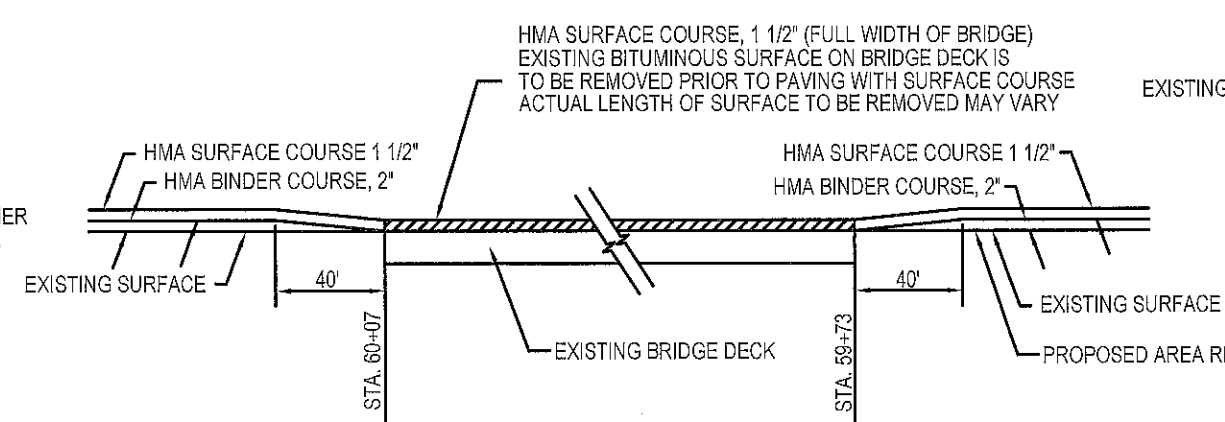

SURFACING AT BRIDGE

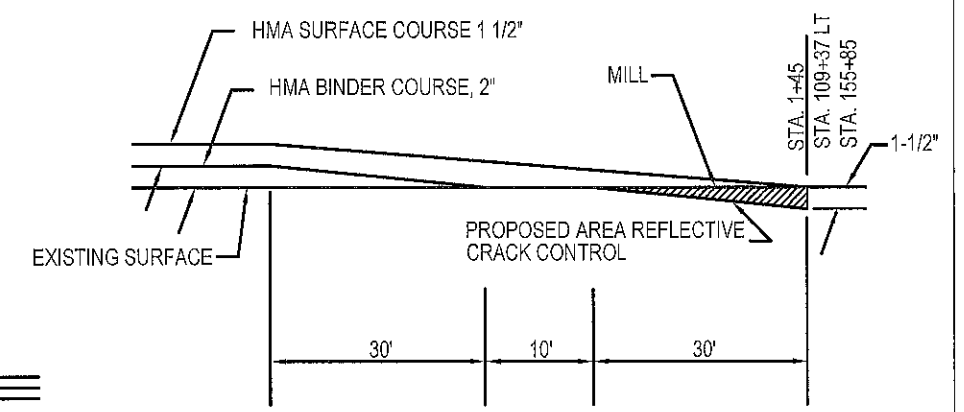

BUTT JOINT

MISCELLANEOUS DETAILS & TYPICAL SECTIONS

FIELD ENTRANCE QUANTITIES		
ENTRANCES	AGGREGATE SURFACE COURSE TYPE B, TON	HOT MIX ASPHALT SURFACE COURSE, MIX "C", N70, TON
ONE (1) ENTRANCE	3	2
TOTAL = 24 ENTRANCES	72	48

MAILBOX TURNOUT QUANTITIES		
TURNOUT	BITUMINOUS MATERIALS (PRIME COAT) GALLON	HOT MIX ASPHALT SURFACE COURSE, MIX "C", N70, TON
ONE (1) TURNOUT	4	2
TOTAL = 7 TURNOUTS	28	14

PRIVATE ENTRANCE QUANTITIES		
ENTRANCES	BITUMINOUS MATERIALS (PRIME COAT) GALLON	HOT MIX ASPHALT SURFACE COURSE, MIX "C", N70, TON
ONE (1) ENTRANCE	7	2
TOTAL = 12 ENTRANCES	84	24

COMMERCIAL ENTRANCE QUANTITIES		
ENTRANCES	BITUMINOUS MATERIALS (PRIME COAT) GALLON	HOT MIX ASPHALT SURFACE COURSE, MIX "C", N70, TON
ONE (1) ENTRANCE	14	5
TOTAL = 2 ENTRANCES	28	10

SIDEROAD QUANTITIES		
ENTRANCES	BITUMINOUS MATERIALS (PRIME COAT) GALLON	HOT MIX ASPHALT SURFACE COURSE, MIX "C", N70, TON
STA. 28+96 LT	0	7
STA. 109+37 LT	55	10
STA. 109+37 RT	0	7
STA. 122+67 RT	0	5
TOTAL = 2 ENTRANCES	55	29

MILLING SCHEDULE		
LOCATION	TYPE	COLD MILLING
STA. 1+45 TO 1+75	BUTT JOINT	80 SQ YD
STA. 36+87 TO 38+27	VARIABLE DEPTH	373 SQ YD
STA. 57+70 TO 61+78	VARIABLE DEPTH	1088 SQ YD
STA. 67+13 TO 69+53	VARIABLE DEPTH	640 SQ YD
STA. 70+53 TO 72+14	VARIABLE DEPTH	429 SQ YD
STA. 74+12 TO 75+94	VARIABLE DEPTH	486 SQ YD
STA. 109+37 LT	BUTT JOINT	183 SQ YD
STA. 153+60 TO 155+85	BUTT JOINT	600 SQ YD
TOTAL		3879 SQ YD

SCHEDULE OF PAVEMENT MARKING LINE, 4"								
NORTHBOUND LANE				SOUTHBOUND LANE				
STATION	NO PASSING (YELLOW SOLID)	PASSING (YELLOW DASHED)		STATION	NO PASSING (YELLOW SOLID)	PASSING (YELLOW DASHED)	STATION	EDGE LINE (WHITE SOLID)
0+00 TO 123+92		3098		123+92 TO 128+44		113	0+00 TO 155+85	30878
123+92 TO 128+44	452			128+44 TO 131+20	276			
128+44 TO 131+20	276			131+20 TO 138+20	700			
131+20 TO 138+20		175		141+32 TO 151+16		24.6		
138+20 TO 141+32		78		151+16 TO 155+85	469			
141+32 TO 151+16	984							
151+16 TO 155+85	469							
TOTALS	2181	3351			1445	359		30878

MISCELLANEOUS DETAILS

SCALE 1" = 200'

ROUTE	SECTION	COUNTY	SHEET NO.
FAS 1874	08-00170-00-RS	FRANKLIN	4 OF 7
CONTRACT 99622			

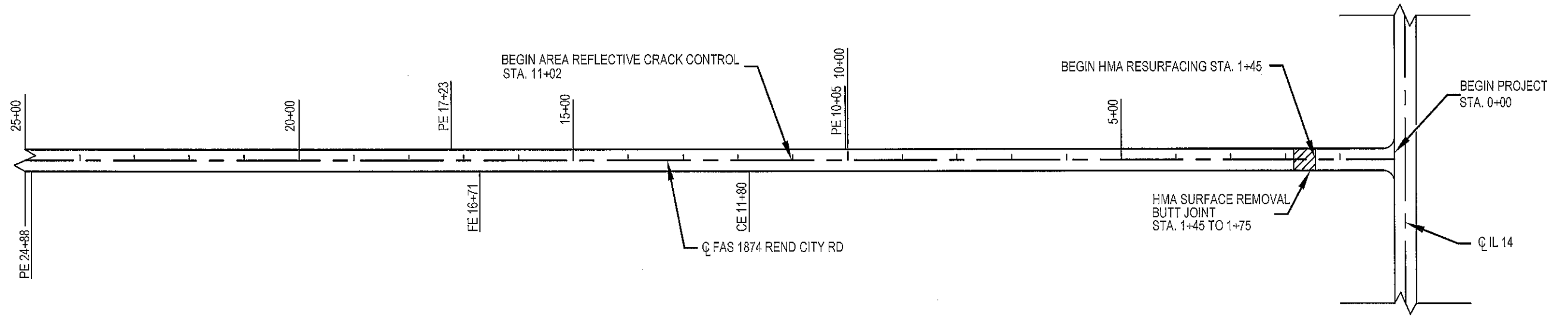

SCALE 1" = 200'

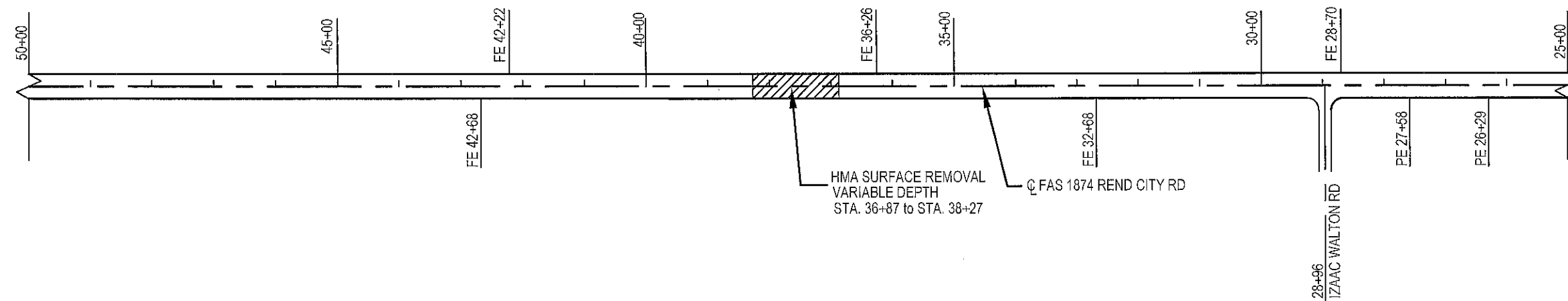

PLAN
STATION 0+00 TO 50+00

SCALE 1" = 200'

ROUTE	SECTION	COUNTY	SHEET NO.
FAS 1874	08-00170-00-RS	FRANKLIN	5 OF 7
CONTRACT 99622			

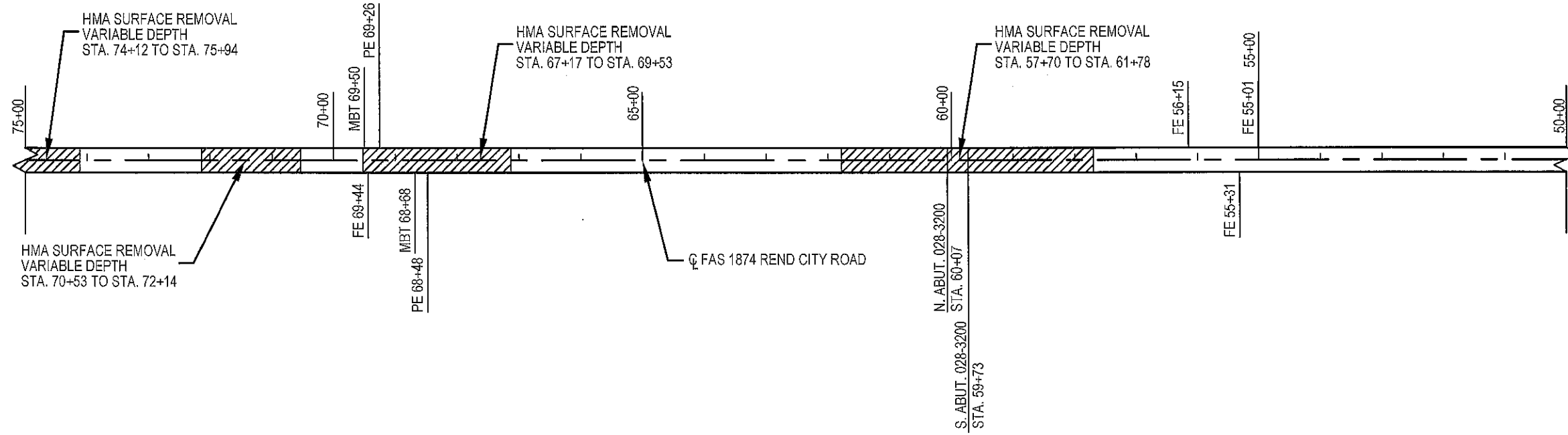

SCALE 1" = 200'

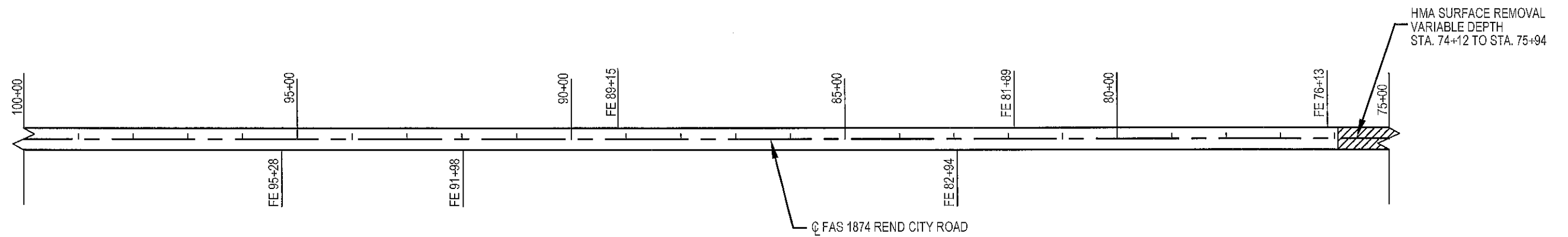

PLAN
STATION 50+00 TO 100+00

SCALE 1" = 200'

ROUTE	SECTION	COUNTY	SHEET NO.
FAS 1874	08-00170-00-RS	FRANKLIN	6 OF 7
CONTRACT 99622			

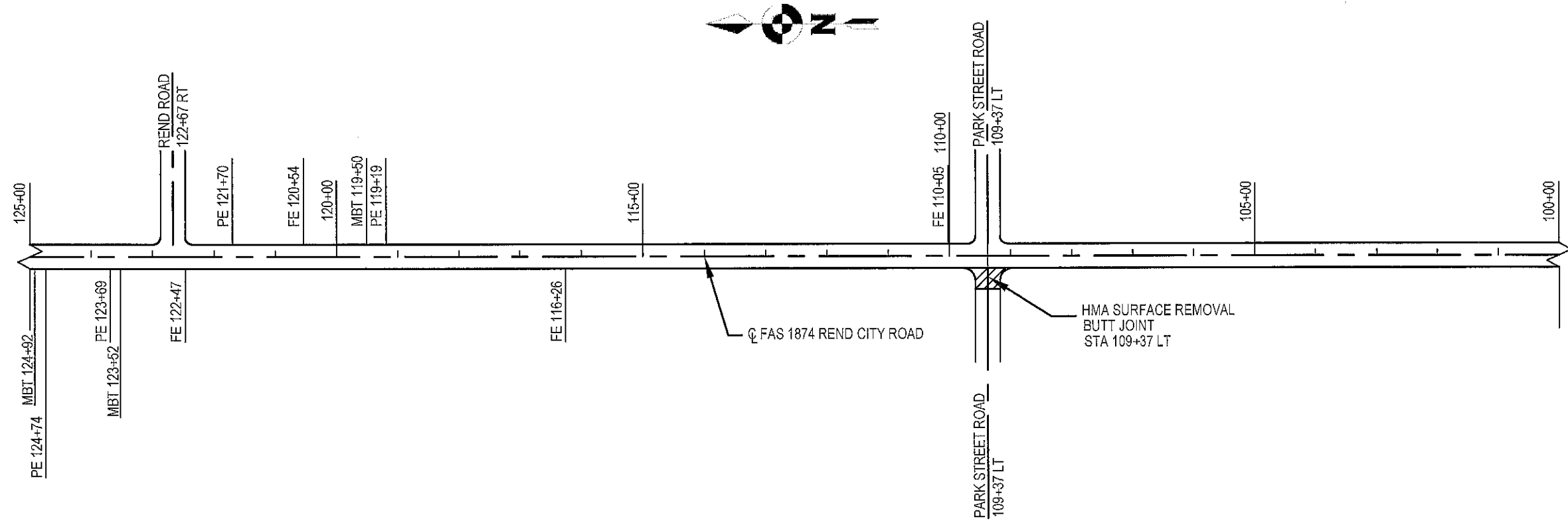

SCALE 1" = 200'

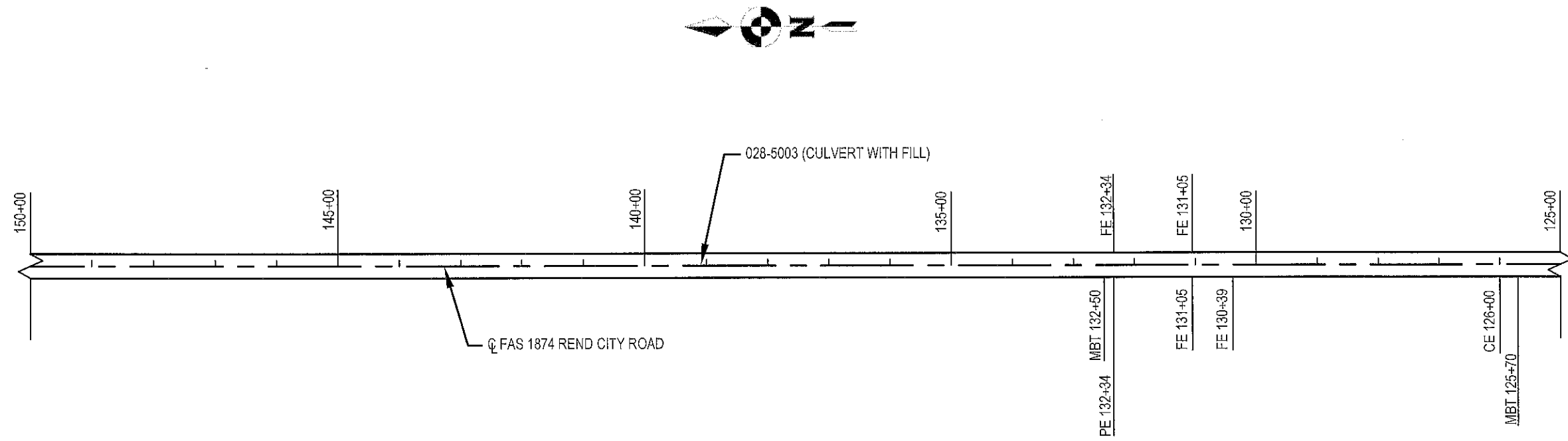

PLAN
STATION 100+00 TO 150+00

SCALE 1" = 200'

ROUTE	SECTION	COUNTY	SHEET NO.
FAS 1874	08-00170-00-RS	FRANKLIN	7 OF 7
CONTRACT 99622			

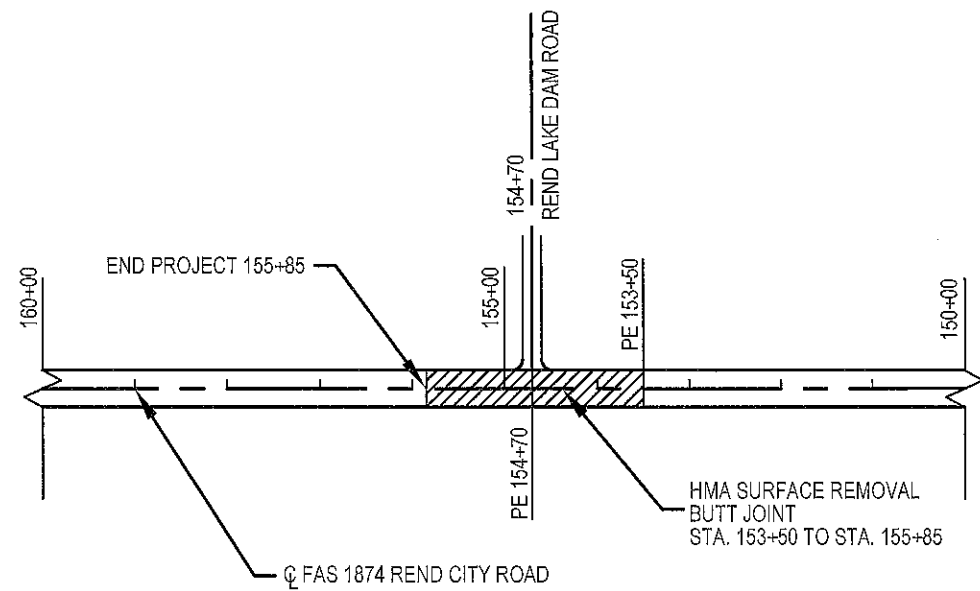

PLAN
STATION 150+00 TO 160+00