

INDEX OF SHEETS

SHEET NO.

- 1 TITLE PAGE
- 2 GENERAL PLAN
- 3 SUMMARY OF QUANTITIES
- 4-8 NORTHWEST EXPRESSWAY ALIGNMENT AND TIES
- 9-15 NORTHWEST EXPRESSWAY TIES TO CROSS STREET
- 16-17 NORTHWEST EXPRESSWAY TYPICAL SECTIONS
- 18 RESURFACING OF W. BRYN MAWR AVE. TYPICAL ROADWAY SECTION
- 19 TYPICAL PAVEMENT SECTIONS AND DETAILS
- 20-26 NORTHWEST EXPRESSWAY EXISTING TOPOGRAPHY AND UTILITIES
- 27-34 NORTHWEST EXPRESSWAY PLAN AND PROFILE
- 35-38 NORTHWEST EXPRESSWAY PROFILES, RAMPS 1B THROUGH 25
- 39-41 NORTHWEST EXPRESSWAY PROFILE, FRONTAGE ROADS
- 42 RESURFACING OF W. BRYN MAWR AVE. PROF. LE.
- 43-49 NORTHWEST EXPRESSWAY CURBING, JOINTING, FENCING AND RIGHT OF WAY
- 50-56 NORTHWEST EXPRESSWAY GRADING
- 57-63 NORTHWEST EXPRESSWAY LANDSCAPING AND SHOULDER TREATMENT
- 64 NORTHWEST EXPRESSWAY CONTOUR PLAN AT N. NATOMA AVE. GRADE SEPARATION
- 65 NORTHWEST EXPRESSWAY CONTOUR PLAN AT N. NAGLE AVE. GRADE SEPARATION
- 66 NORTHWEST EXPRESSWAY CONTOUR PLAN AT AUSTIN AVE. PEDESTRIAN WALKWAY
- 67 NORTHWEST EXPRESSWAY CONTOUR PLAN AT W. FOSTER AVE. GRADE SEPARATION
- 68-115 NORTHWEST EXPRESSWAY CROSS SECTIONS
- 116 PCC DRIVEWAY PAVEMENT DETAILS OF PORTLAND CEMENT CONCRETE SIDEWALK CONSTRUCTION DETAIL OF ALLEY RETURN STANDARD DESIGN FOR PAVEMENT FABRIC TYPE A AND TYPE B
- 117 DETAILS OF STANCHION BARRIER
- 117-A DETAILS OF PEDESTRIAN BARRIER AT LIGHT STD.
- 118 ALTERNATE DESIGNS FOR LONGITUDINAL METAL JOINT VEHICULAR BARRIER DOUBLE CABLE ROAD GUARD
- 119 DETAIL OF SURVEY MONUMENT
- 120 DETAILS OF CURB AND GUTTER ABUTTING EXISTING PAVEMENT FEDERAL AID PROJECT MARKER
- 121 DETAILS OF CONSTRUCTION OF PARKWAYS
- 121A LOCATION OF STOCKPILED TOPSOIL
- 121B SUPERELEVATION TRANSITION
- 122 R.O.W. MARKER STANDARD SECTION MARKER STANDARD DESIGN FOR STEEL PLATE BEAM GUARD RAIL
- 123 CRUSHED STONE SHOULDER AND COMBINATION CONCRETE C AND G, TYPE 34
- 124 RAMP NOSING DETAILS
- 125 FIELD OFFICE LABORATORY
- 126-132 NORTHWEST EXPRESSWAY DRAINAGE
- 133 TYPE A2 CATCH BASIN DETAIL OF STORM SEWER CONN. TO SEWER TYPE A MANHOLE
- 134 DETAIL OF TYPE A INLET C AND G, FRAME AND GRATE TYPE 34 STANDARD SYMBOLS FIELD JOINT FOR CONN. OF LATERAL TO TRUNK SEWER OR MAIN COLLECTOR
- 135 C AND G FRAME AND GRATE TYPE 32 CAST IRON GRATE TYPE 37 PIPE UNDERDRAIN FOR TYPE 34 C B G C AND G FRAME AND GRATE TYPE #31
- 136 FOUNDATION REMOVAL AND PLUGGING EXISTING DRAINS AND SEWERS TRENCH BACKFILL AND PAVEMENT REPLACEMENT - ENTIRE DETAILS OF STANDARD FRAMES AND GRATES
- 137 DETAILS OF PAVEMENT CONSTRUCTION ADJACENT TO TYPE 5 FRAME DETAILS OF CURB AND GUTTER AND PAVEMENT CONSTRUCTION ADJACENT TO CASTING
- 138 DETAIL OF LATERAL SEWER CONN. FOR USE WITH 5'-9" X 6'-4" SEMI-ELLIPT. AND 72" CIRCULAR PIPE DETAIL OF LATERAL SEWER CONN. FOR USE WITH 6'-6" AND 7'-3" SEMI-ELLIPT. AND 84" CIRCULAR PIPE
- 139-171 NORTHWEST EXPRESSWAY RETAINING WALLS

STATE OF ILLINOIS
COUNTY OF COOK
DEPARTMENT OF HIGHWAYS

PLANS FOR PROPOSED
FEDERAL AID HIGHWAY

SCALES

PLAN	1 INCH	80 FT
PROFILE PLAN	1 INCH	50 FT
CROSS SECTIONS	1 INCH	5 FT
CROSS SECTIONS	1 INCH	5 FT VERT
CROSS SECTIONS	1 INCH	10 FT HOR

FEDERAL AID ROUTE 173 PROJECT BU. 265 (35)

NORTHWEST EXPRESSWAY

GRADING & PAVING

S.A.R. 267 SECTION 267-1214-15D

NET LENGTH TO BE IMPROVED 7750.00 FT. = 1.468 MILES

PLANS APPROVED
BY STATE DIVISION OF HIGHWAYS
NOV. 20, 1958

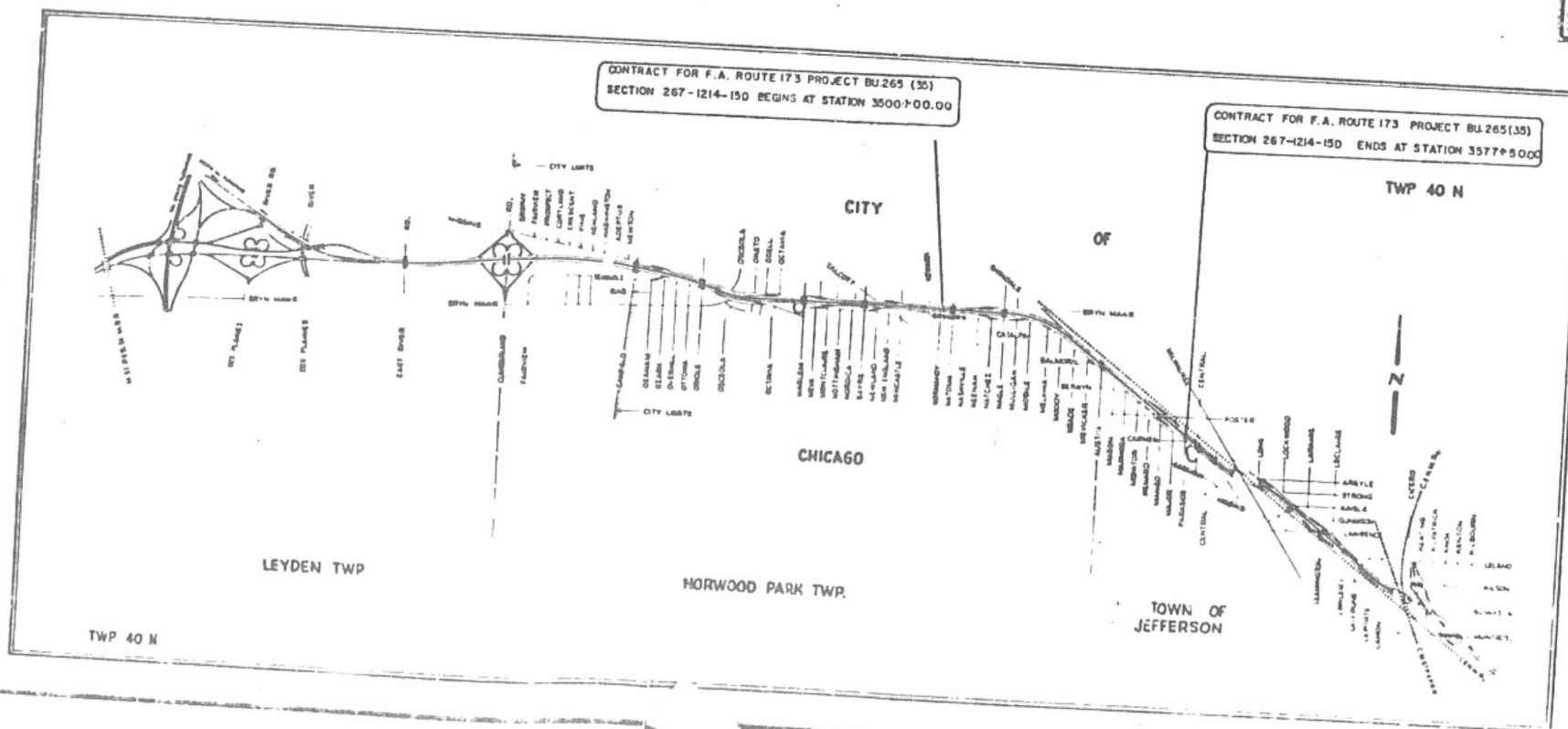
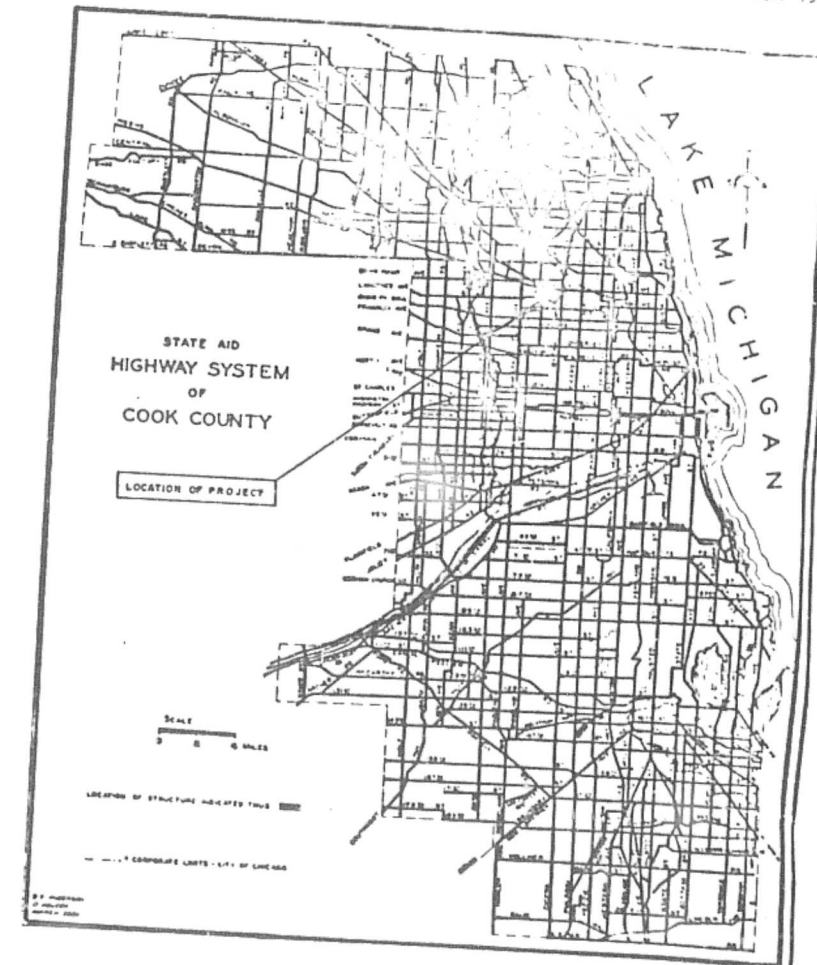

COUNTY OF COOK
DEPARTMENT OF HIGHWAYS

APPROVED: *October 17, 1958*
Richard A. Blalock

APPROVED: *October 17, 1958*
Alfred J. Stark
CHIEF ENGINEER

APPROVED: *October 17, 1958*
James J. Blalock
SUPERINTENDENT

STATE OF ILLINOIS
DEPARTMENT OF PUBLIC WORKS AND BUILDINGS
DIVISION OF HIGHWAYS

APPROVED: _____
CHIEF ENGINEER

APPROVED: _____
DIRECTOR

DEPARTMENT OF COMMERCE
BUREAU OF _____

State Aid	Fiscal	Sheet	Total
Route No.	Year	No.	Sheets
267	1958	2	171

SECTION 267-1214-15D

PROJECT BU-265(35) SECTION 267-1214-15D
 BEGINS AT STATION 3500+00

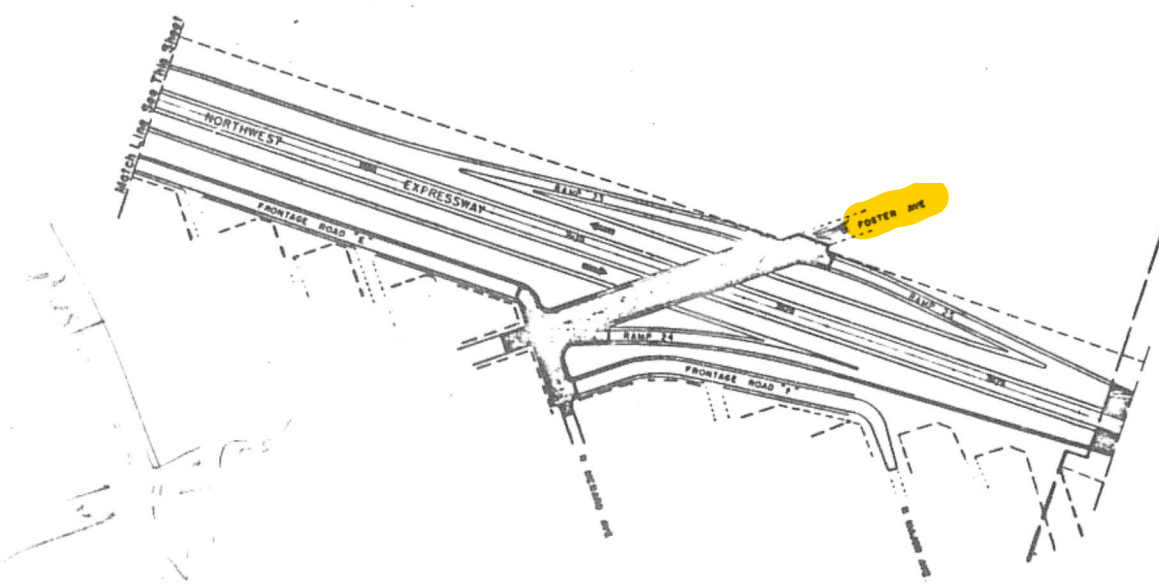
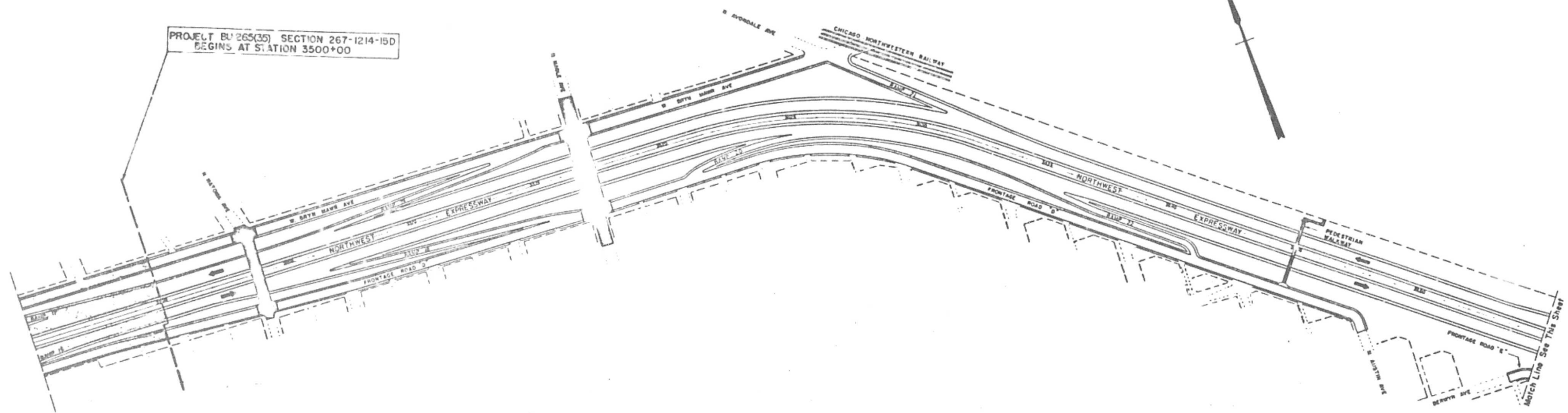

PROJECT BU-265(35) SECTION 267-1214-15D
 ENDS AT STATION 3577+5000

LEGEND
 Area Indicated Thus  Not Included in Contract

PLAN
 Scale 1" = 200'

COUNTY OF OYK DEPARTMENT OF HIGHWAYS	
DANIEL RYAN PRESIDENT	WILLIAM J. MORTIMER COMMISSIONER
NORTHWEST EXPRESSWAY GENERAL PLAN	
COMPUTED	APPROVED <i>[Signature]</i>
DRAWN <i>[Signature]</i>	<i>[Signature]</i>
CHECKED <i>[Signature]</i>	<i>[Signature]</i>
EAT, SHOFFER & THOMPSON, INC. ENGINEERS	

Q1-2
1386

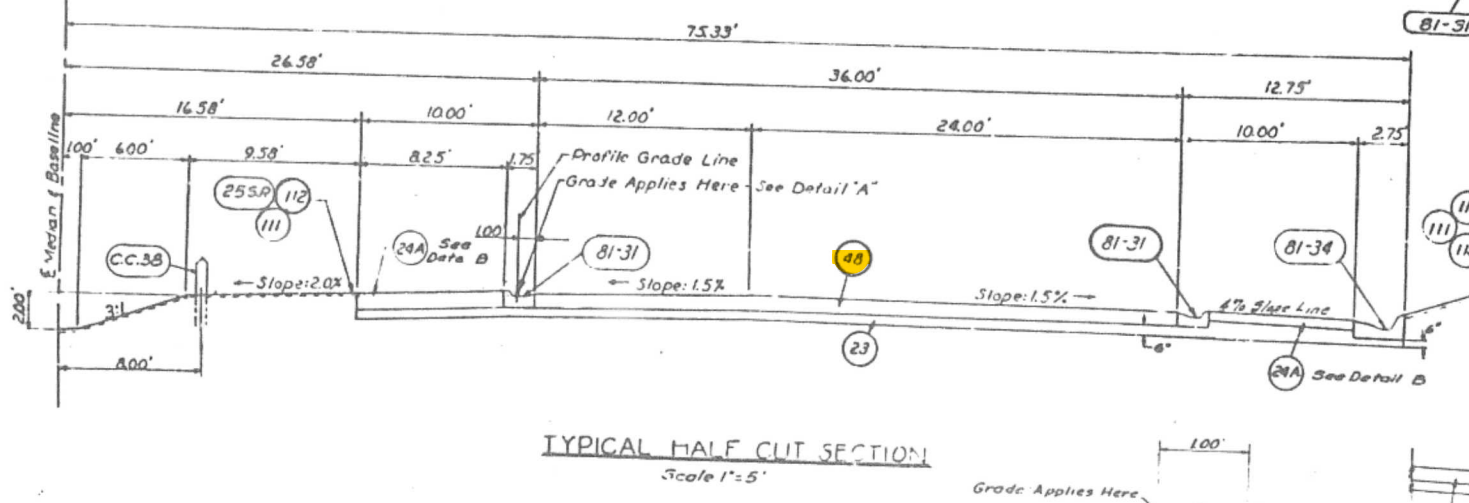
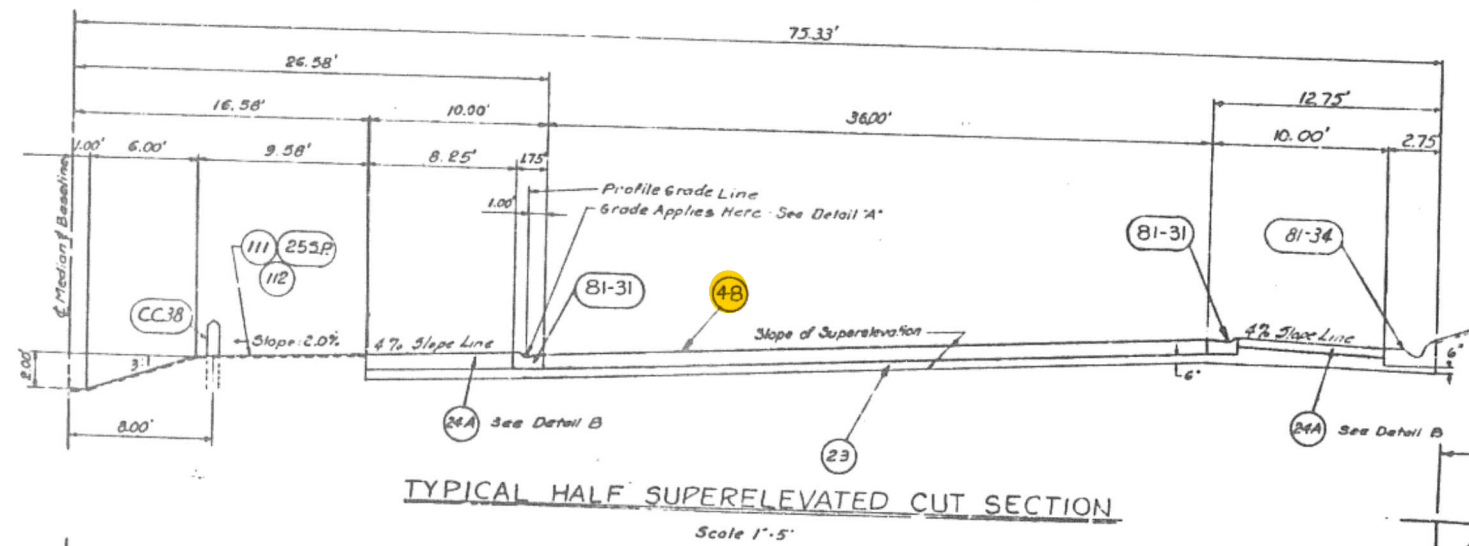
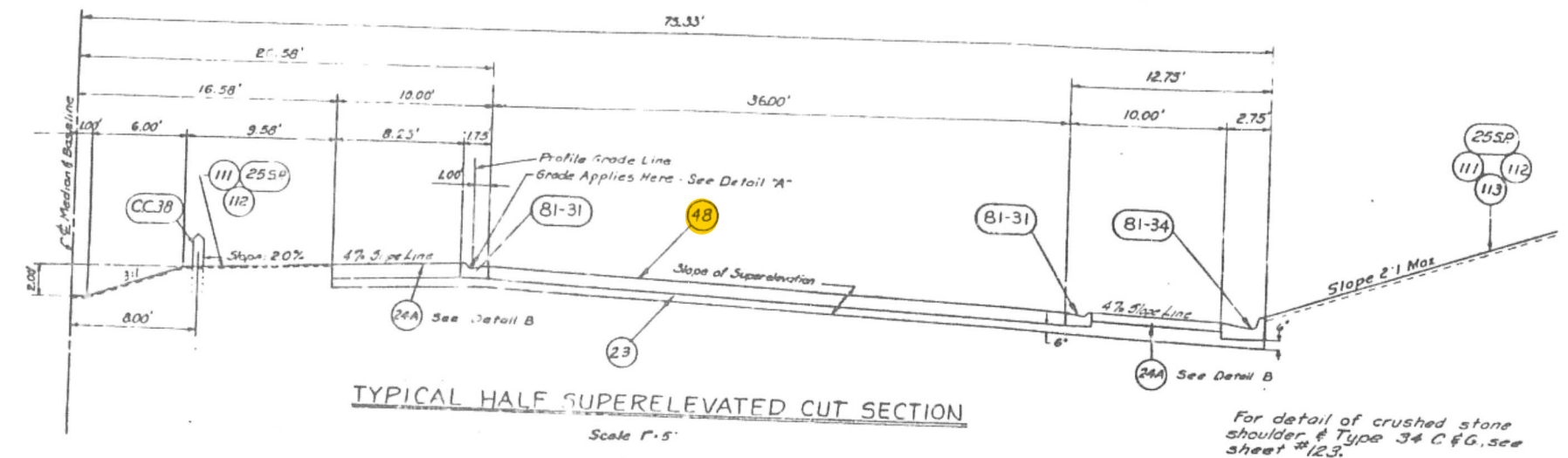

Width Indicated on Plans
 Note: The contractor shall construct the stabilized shoulders with the lighting cables and other underground utilities have been installed.

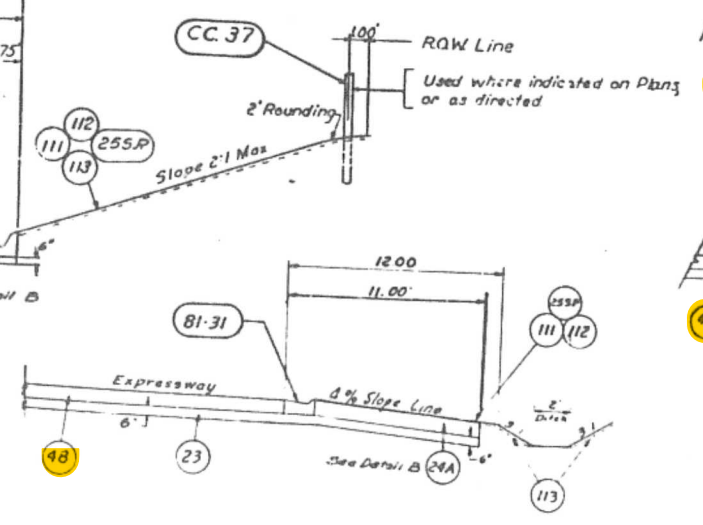
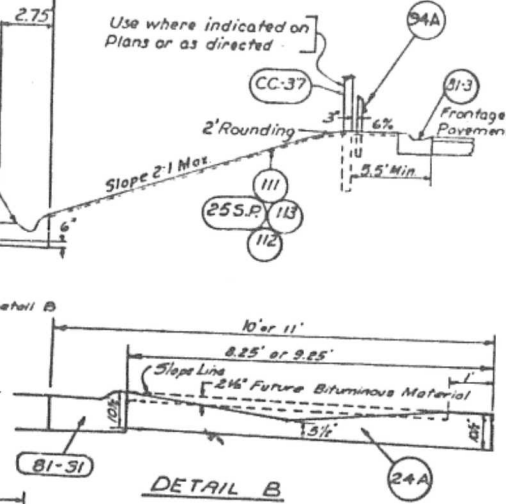
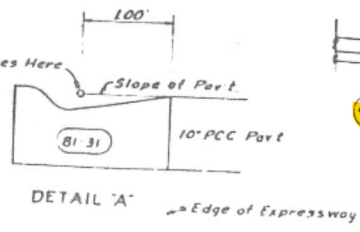

- LEGEND:**
- Specification Reference
- CC-16 Portland Cement Concrete Pavement (10' Colored Red) - Pavement Fabric
 - CC-37 Pedestrian Barrier (Type I)
 - CC-38 Double Cable Road Guard.
 - 23 Sub-Base - Granular Material, Type A.
 - 24A Crushed Stone Shoulders
 - 255.P Topsoil from Stockpile.
 - 48 Portland Cement Concrete Pavement (10') - Pavement Fabric
 - 81-31 Combination Concrete Curb & Gutter, Type 31.
 - 81-32 Combination Concrete Curb & Gutter, Type 32.
 - 81-34 Combination Concrete Curb & Gutter, Type 34
 - 111 Temporary Seeding - Fertilize - Nutrients
 - 112 Mulch
 - 113 Sodding and Fertilizer Nutrients (No 255P required)
 - 5P Ground Cover Area (Use 200 Gals emulsified Asphalt per Acre)
 - 94A Steel Plate Beam Guard Rail (where shown on plans)

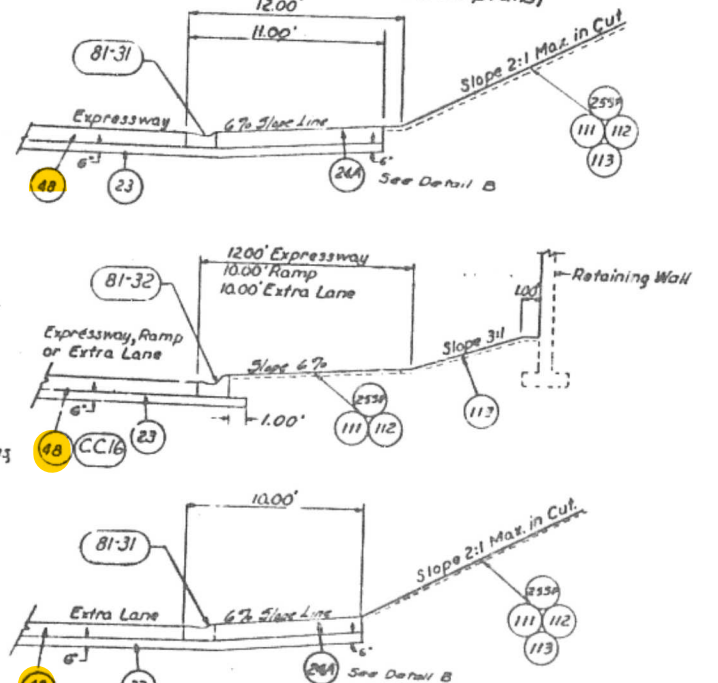

DESIGN CLASSIFICATION
 2756 T60
 NOTE For Reinforcement & Joint Details See Sheet No 19

COUNTY OF COOK DEPARTMENT OF HIGHWAYS	
DANIEL RYAN PRESIDENT	WILLIAM J. MONTHELY COMMISSIONER
NORTHWEST EXPRESSWAY TYPICAL ROADWAY SECTIONS PART 1	
COMPUTED DARYL W. WILSON	APPROVED Oct 13, 1958 W. J. MONTHELY

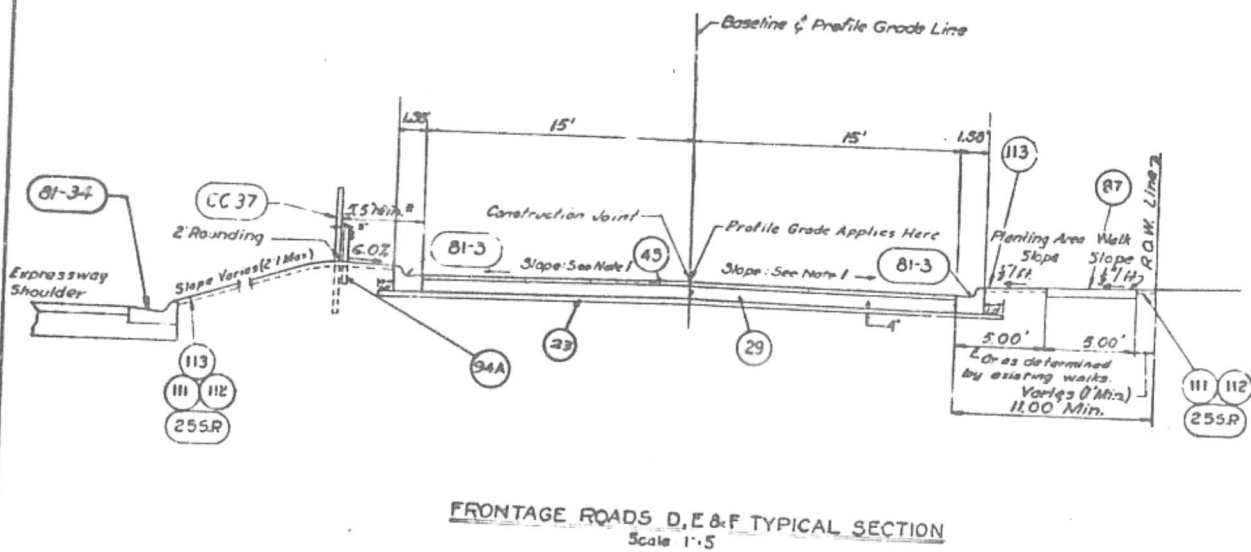
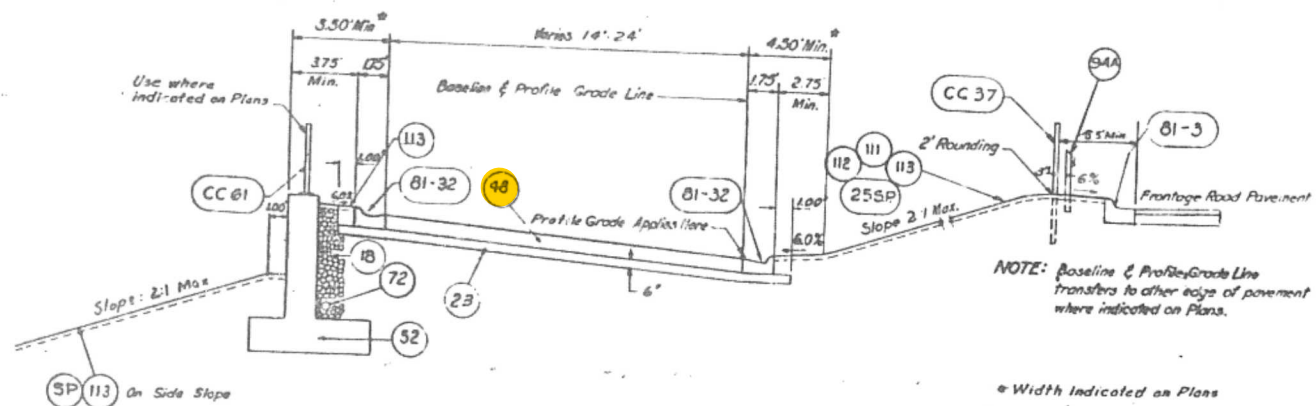
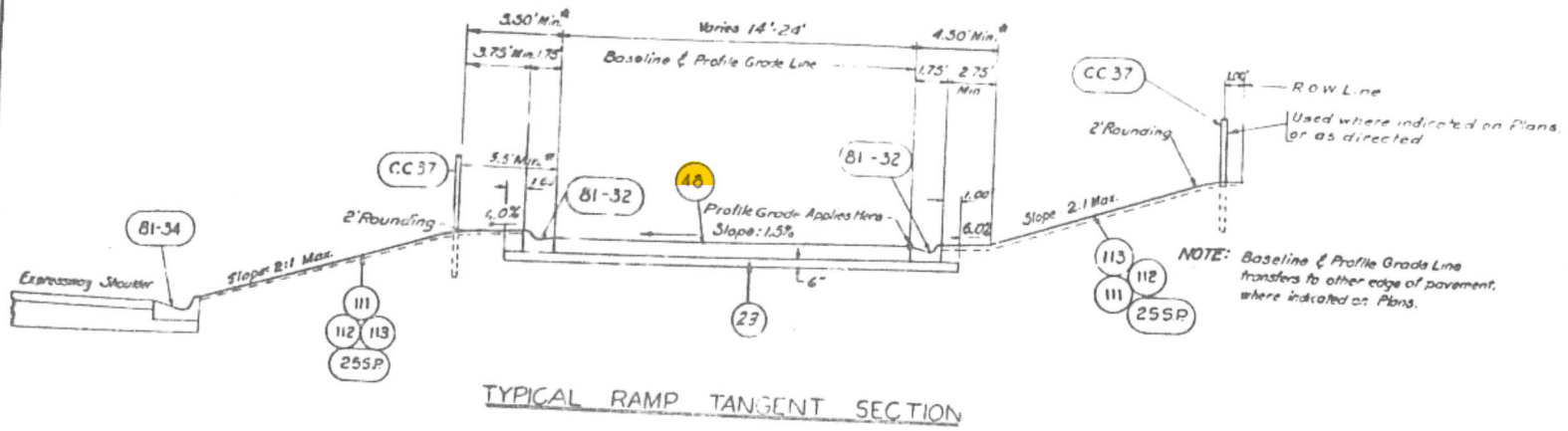

- LEGEND**
- Specification Reference
- (18) Porous Granular Embankment
 - (23) Sub-Base-Granular Material, Type A
 - (255P) Topsoil from Stockpile
 - (29) Portland Cement Concrete Base Course (9')
 - (45) 1/2" Bituminous Concrete Binder Course - 1" Bituminous Concrete Surface Course, Fine Dense-Graded Aggregate Type, Subclass I-II
 - (48) Portland Cement Concrete Pavement (10')-Pavement fabric
 - (52) Class X Concrete
 - (72) Perforated Corrugated Metal Pipe Underdrains
 - (81-3) Combination Concrete Curb & Gutter, Type 3
 - (81-32) Combination Concrete Curb & Gutter, Type 32
 - (81-34) Combination Concrete Curb & Gutter, Type 34
 - (87) Portland Cement Concrete Sidewalk (5')
 - (111) Temporary Seeding - Fertilizer Nutrients
 - (112) Mulch
 - (113) Seeding and Fertilizer Nutrients (No 25 SP required)
 - (CC 37) Pedestrian Barrier (Type I)
 - (CC 61) Pedestrian Barrier (Type II, III-a, or III-b)
 - (SP) Ground Cover Area (Use 200 coats emulsified Asphalt per Acre)
 - (94A) Steel Plate Beam Guard Rail (Where shown on plans)

- Notes:**
1. Cross slopes of frontage roads varies from 1% Min to 4% Maximum, with pavement edges warped for drainage.
 2. Edge of Pavement gradient is at 0.5% minimum.
 3. Curb reveal on expressway side of new frontage roads varies from 5" to 8". Curb reveal on sidewalk side of new frontage roads varies from 4" to 8".
 4. For finished roadway, top of curb and sidewalk grades, see Grading Plans.
 5. For Reinforcement & Joint Details see Sheet No. 19.

COUNTY OF COOK
DEPARTMENT OF HIGHWAYS

DANIEL RYAN
PRESIDENT

WILLIAM J. MURPHY
COMMISSIONER

NORTHWEST EXPRESSWAY

TYPICAL ROADWAY SECTIONS PART 2

COMPUTED BY: [Signature]

DRAWN BY: [Signature]

CHECKED BY: [Signature]

DATE: 10/1/58

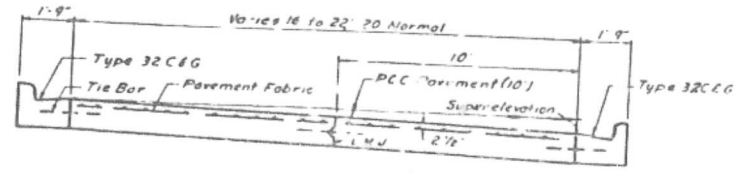

CROSS SECTION

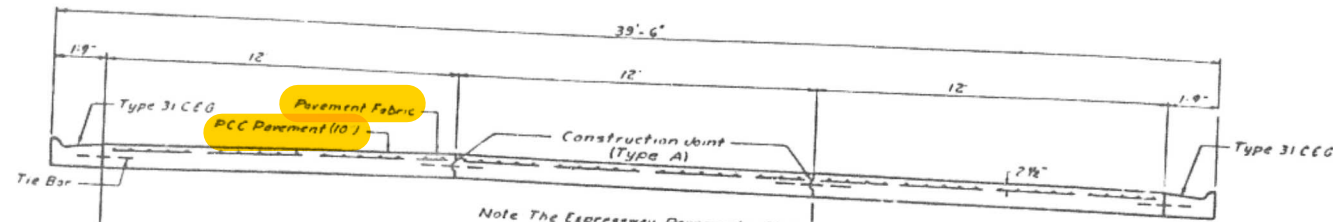

CROSS SECTION

Note: The Expressway Pavements Shall be Constructed in Separate 12 Foot Lanes

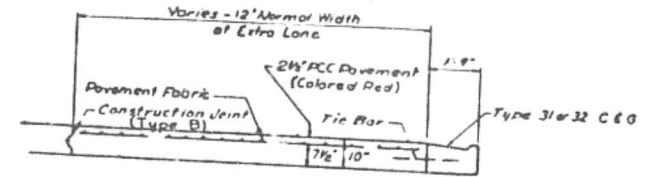

CROSS SECTION

Note: This Item of Work Shall be Constructed and Paid for in Conformance with the Special Provisions for Portland Cement Concrete Pavement (10' Colored Red)

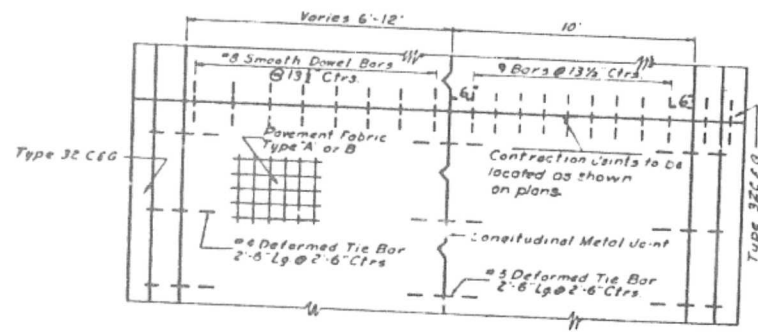

PLAN RAMP

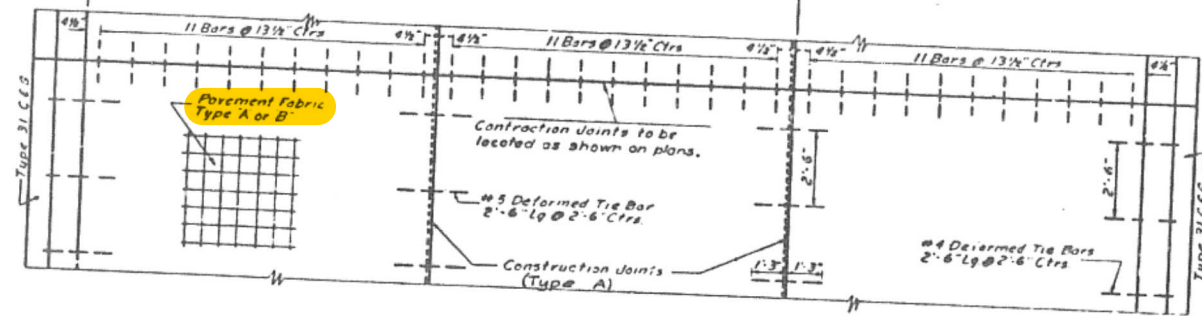

PLAN NORTHWEST EXPRESSWAY

NOTE: Not More Than Three Lanes Shall be Tied Together With Tie Bars.

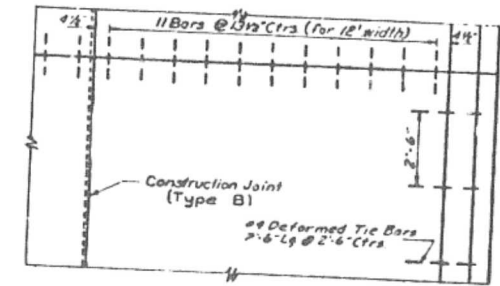

PLAN EXTRA LANE OR RAMP TAPER

Sawed Joint See Special Provisions for Portland Cement Concrete Pavement

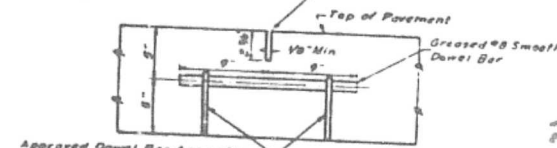

SAWED CONTRACTION JOINT

Sawed joint to be filled flush with sealer, Hot-Applied Type for joints in concrete, SS-S-104, or with cold-applied, Ready mixed concrete joint sealing compound, as specified in the "Special Provisions for Portland Cement Concrete Pavement with Sawed Contraction Joints."

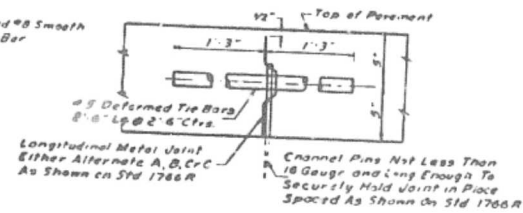

LONGITUDINAL METAL JOINT

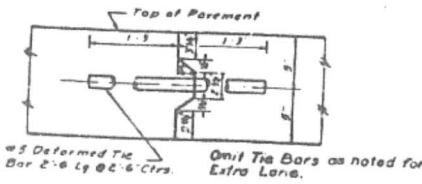

CONSTRUCTION JOINT, TYPE A (Type B, omit tie Bar)

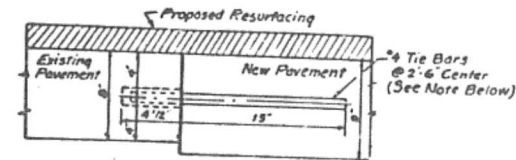

ANCHOR TIE DETAIL FOR REPLACING PAVEMENT IN W. HIGGINS AVE. AND W. BRYN MAWR AVE.

NOTE: THE 6# TIE BARS SHALL BE MADE FROM BILLET-STEEL REINFORCEMENT BARS, STRUCTURAL GRADE MEETING THE REQUIREMENTS OF THE SPECIFICATIONS, CONCRETE REINFORCEMENT BARS. THE HOLES FOR THE TIE BARS SHALL BE DRILLED WITH 7/8" DIAMETER STAR DRILL OR 1 5/16" DIAMETER AIR OR ELECTRIC HAMMER. THE TIE BARS SHALL BE INSTALLED IN ACCORDANCE WITH THE MANUFACTURER'S RECOMMENDATION AND SHALL BE EQUAL TO OR SIMILAR TO THOSE MANUFACTURED BY THE AMERICAN EXPANSION BOLT & MFG. COMPANY OF CHICAGO, ILL. THE COST OF FURNISHING AND INSTALLING TIE BARS AND CONSTRUCTING THE JOINT SHALL BE INCLUDED IN THE CONTRACT UNIT PRICE PER SQ. YD. FOR PCC BASE (9' UNREINFORCED).

COUNTY OF COOK DEPARTMENT OF HIGHWAYS	
DANIEL RYAN PRESIDENT	W. LANE / MORTIMER SUPERVISOR
NORTHWEST EXPRESSWAY TYPICAL PAVEMENT SECTIONS AND DETAILS	
DESIGNED BY	APPROVED BY
DRAWN BY	CHECKED BY
EAT, SPOTFORD & ENGINEERS, INC. 1402 N. LAKE ST. CHICAGO, ILL.	

STANDARD DESIGN FOR PAVEMENT FABRIC

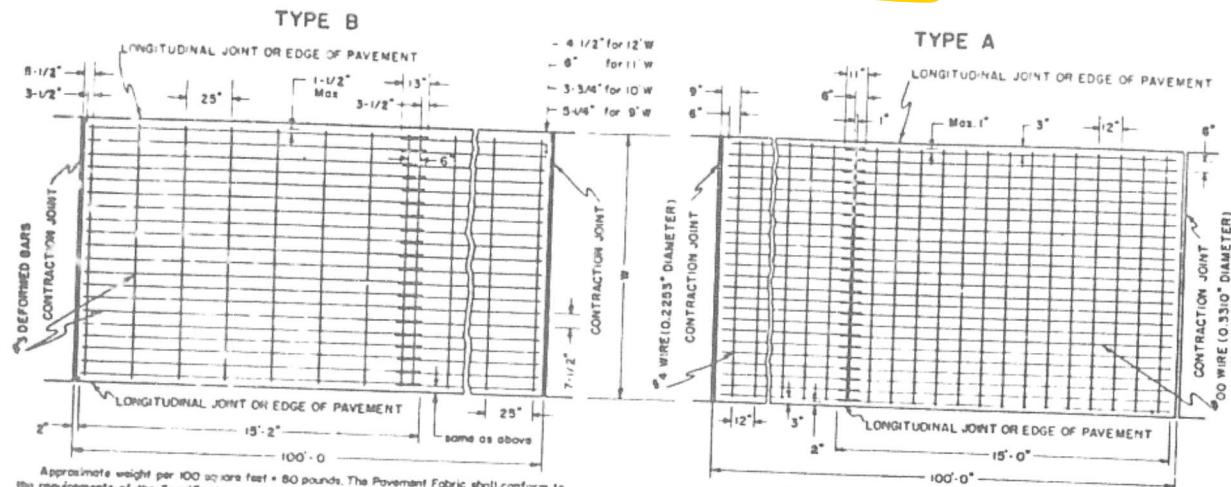

NOTE:
Pavement Fabric which is lapped transversely shall have a maximum lap of six (6) inches.

Specification References: Articles 48.12, 48.17, 48.35, 48.36, 124.8.

COUNTY OF COOK DEPARTMENT OF HIGHWAYS STANDARD DESIGN FOR PAVEMENT FABRIC TYPE "A" AND TYPE "B"

STATE STANDARD COMPUTED 2/12	STATE AID ROUTE NO.	FISCAL YEAR	SHEET NO.	TOTAL SHEETS
DRAWN BY FIEDLER	SECTION			
CHECKED F. KASBE				

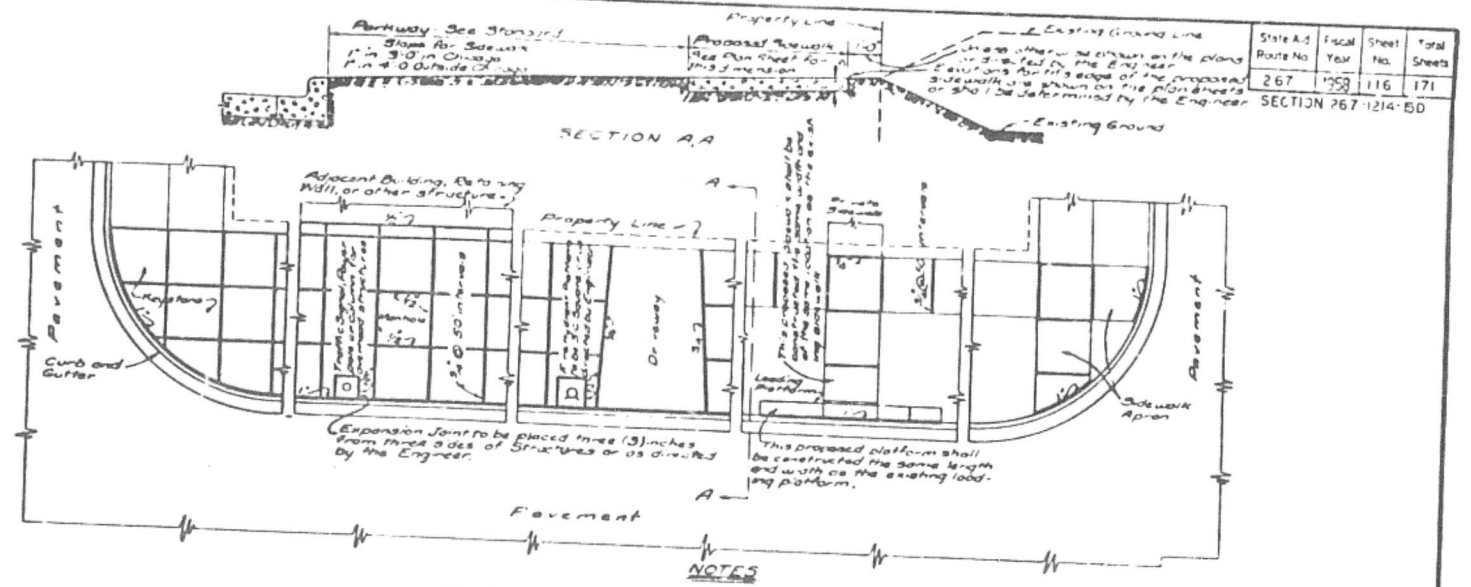

NOTES

The following one (1) inch Bituminous Preformed Fibre Joint Filler will be paid for at the contract unit price per square foot for Longitudinal Curb Expansion Joint:

1. Between the back of the curb and sidewalk
2. Between the back of the curb and all structures one (1) inch or less from the back of curb.

The cost of the following 3/8 inch and one half (1/2) inch expansion joints shall be included in the contract unit price per square foot for Portland Cement Concrete Sidewalk:

1. The 3/8 inch and the one half (1/2) inch joints in the sidewalk proper.
2. The 3/8 inch joint between public and private walks and drives adjoining building walls.
3. The one half (1/2) inch joints between the sidewalk and structures which extend through the sidewalk such as Light Standards, Trolley and Power Poles, Columns of Overhanging Structures, Manholes, etc.

The sidewalk shall be paid for at the Contract unit price per square foot for P.C.C. Sidewalk.

Note: All Preformed Expansion Joint Fillers shall conform to the requirements of the Specifications for Bituminous Preformed Fibre Joint Filler.

STATE STANDARD COMPUTED 2/12	STATE AID ROUTE NO.	FISCAL YEAR	SHEET NO.	TOTAL SHEETS
DRAWN BY FIEDLER	SECTION			
CHECKED F. KASBE				

DETAILS OF PORTLAND CEMENT CONCRETE SIDEWALK CONSTRUCTION

COUNTY OF COOK
DEPARTMENT OF HIGHWAYS

Approved by: *August 1905*

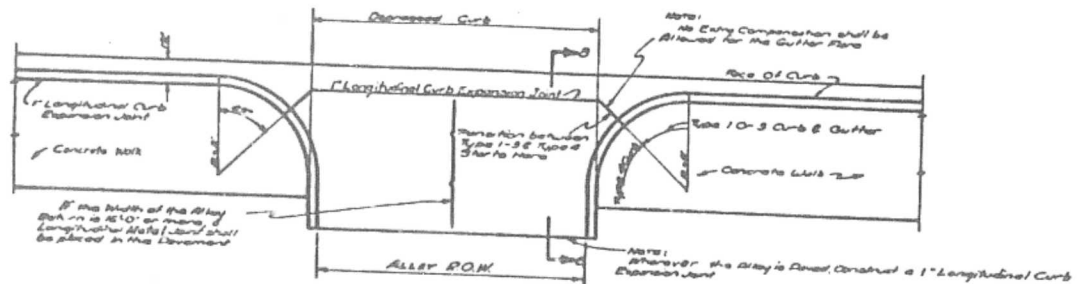

SECTION B-B

NOTE: Type A Curb is to be included in the lineal length of the particular type of curb or curb and gutter called for on the plans.

STATE STANDARD COMPUTED 2/12	STATE AID ROUTE NO.	FISCAL YEAR	SHEET NO.	TOTAL SHEETS
DRAWN BY FIEDLER	SECTION			
CHECKED F. KASBE				

DETAIL OF ALLEY RETURN

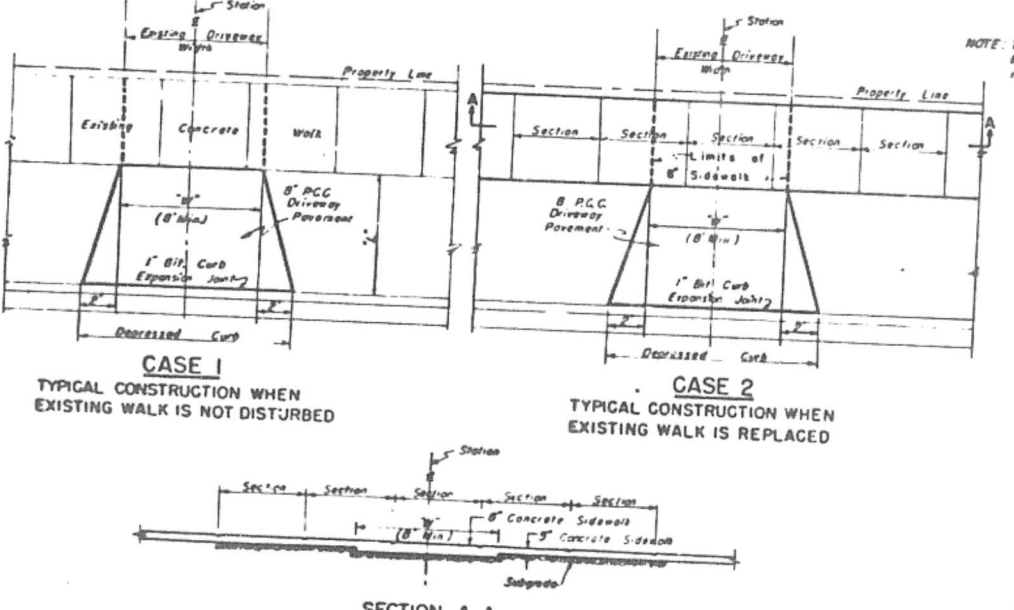

NOTE: The normal sidewalk sections shall be retained across the eight (8) inch thickness.

STATION	W	SUMMARY OF DRIVEWAY PAVT.	
		P.C.C. DRIVEWAY PAVEMENT 50 YDS	P.C.C. SIDEWALK 50 FT

BASIS OF PAYMENT

CASE 1 AND 2

The driveway pavement shall be paid for at the contract unit price per square yard for P.C.C. DRIVEWAY PAVEMENT, measured in place.

The one (1) inch bituminous expansion joint shall be paid for at the contract unit price per square foot for LONGITUDINAL CURB EXPANSION JOINT, measured in place.

CASE 2 P.C.C. SIDEWALK

The proposed eight (8) inch sidewalk shall be constructed in conjunction with the regular five (5) inch sidewalk as called for on the plans and in accordance with this standard.

The work as outlined above and performed in accordance with the Standard and Supplemental Specifications shall be paid for at the contract unit price per square foot for P.C.C. SIDEWALK (5") or P.C.C. SIDEWALK (8") measured in place.

STATE STANDARD COMPUTED 2/12	STATE AID ROUTE NO.	FISCAL YEAR	SHEET NO.	TOTAL SHEETS
DRAWN BY FIEDLER	SECTION			
CHECKED F. KASBE				

P.C.C. DRIVEWAY PAVEMENT

Approved by: *August 1905*