

STATE OF ILLINOIS
DEPARTMENT OF TRANSPORTATION

PROPOSED
HIGHWAY PLANS

ROUTE FAP 742 (IL 2)
SECTION (38VB-1)DR & PP
INLET REPAIR & PATCHING
OGLE COUNTY

F.A.P. RTE.	SECTION	COUNTY	TOTAL SHEETS	SHEET NO.
742	(38VB-1) DR & PP	OGLE	4	1
		ILLINOIS	CONTRACT NO. 64T26	

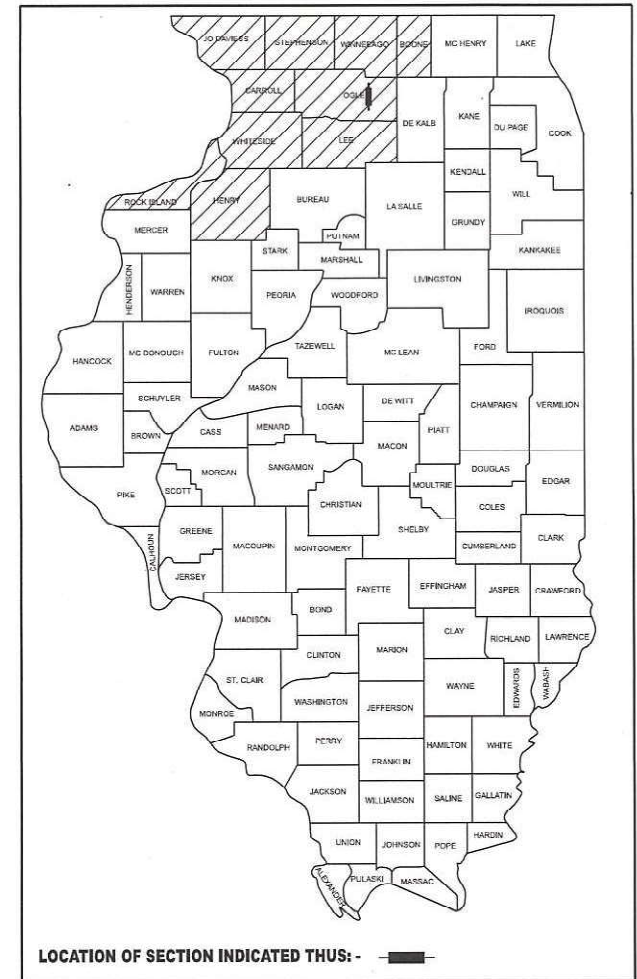

C-92-072-24

PROJECT LOCATION
SN 071-0097

TOWNSHIP SECTIONS (9, 10)

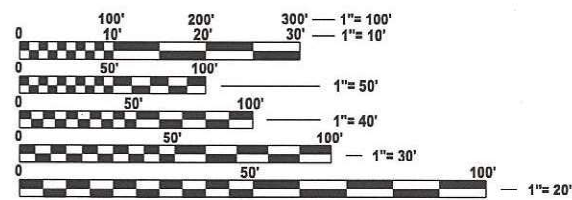

FULL SIZE PLANS HAVE BEEN PREPARED USING STANDARD ENGINEERING SCALES. REDUCED SIZED PLANS WILL NOT CONFORM TO STANDARD SCALES. IN MAKING MEASUREMENTS ON REDUCED PLANS, THE ABOVE SCALES MAY BE USED.

J.U.L.I.E.
JOINT UTILITY LOCATION INFORMATION FOR EXCAVATION
1-800-892-0123
OR 811

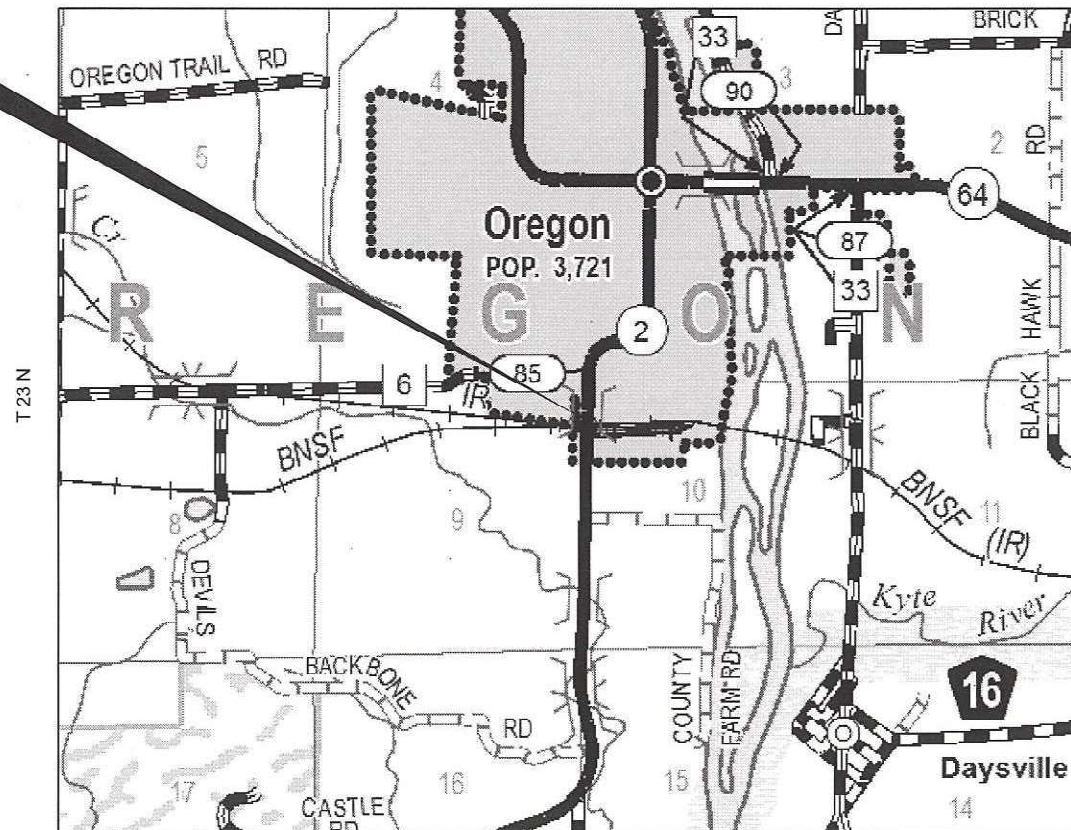

STATE OF ILLINOIS
DEPARTMENT OF TRANSPORTATION

SUBMITTED March 13, 2024
Justin Mason
REGIONAL ENGINEER

May 10, 2024 [Signature]
ENGINEER OF DESIGN AND ENVIRONMENT

May 10, 2024 [Signature]
DIRECTOR OF HIGHWAYS PROJECT IMPLEMENTATION

PRINTED BY THE AUTHORITY
OF THE STATE OF ILLINOIS

INDEX OF SHEETS

- 1 COVER SHEET
- 2 INDEX OF SHEETS, STANDARDS, GENERAL NOTES
- 3 SUMMARY OF QUANTITIES/ SCHEDULE OF QUANTITIES
- 4 DETAILS

HIGHWAY STANDARDS

- 420001-10 PAVEMENT JOINTS
- 420401-13 PAVEMENT CONNECTOR (PCC) FOR BRIDGE APPROACH SLAB
- 610001-09 SHOULDER INLET WITH CURB
- 701006-05 OFF-ROAD OPERATIONS, 2L, 2W, 15' TO 24" FROM PAVEMENT EDGE
- 701316-13 LANE CLOSURE, 2L, 2W, BRIDGE REPAIR FOR SPEEDS > 45 MPH
- 701901-09 TRAFFIC CONTROL DEVICES

GENERAL NOTES

CURB REMOVAL AND REPLACEMENT RELATED TO THE TYPE F INLET SHOULD BE INCLUDED IN THE COST OF STANDARD 610001 (SHOULDER INLET WITH CURB). ALL OTHER LOCATIONS, EXISTING CURB IS INTENDED TO REMAIN IN PLACE.

CONCRETE AND REINFORCEMENT REMOVAL AND REPLACEMENT IN THE SHOULDER RELATED TO THE TYPE F INLET SHOULD BE INCLUDED IN THE COST OF STANDARD 610001 (SHOULDER INLET WITH CURB)

THE COST TO REMOVE A PORTION OF THE TRAFFIC BARRIER TERMINAL, TYPE 6 TO BE INCLUDED WITH THE COST OF 'REMOVE AND REERECT STEEL PLATE BEAM GUARDRAIL'.

PREFORMED JOINT SEAL INSTALLATION TO FOLLOW THE APPLICABLE SECTIONS OF ARTICLE 520 (BRIDGE EXPANSION JOINTS). JOINT SHALL NOT BE CUT AND IS INTENDED TO BE PLACED CONTINUOUSLY AT EACH LOCATION.

SEE DETAIL SHEET, CONTRACTOR SHALL NOT DAMAGE THE APPROACH FOOTING. NOTE THAT 20" PATCH IS REGARDING THE PAVEMENT ADJACENT TO THE SHOULDER INLET AND THE THICKENED PORTION IS ONLY APPROXIMATELY HALF OF THE PATCH LENGTH. CONTRACTOR TO INCLUDE A 10 MIL. POLYETHYLENE BOND BREAKER ON APPROACH FOOTING BEFORE PLACING CONCRETE, COST INCLUDED WITH THE COST OF THE PATCH.

MODEL: D:_SMT INDEX
 FILE NAME: I:\projects\2024\6426-IL-2 Bridge Inlet replacement and patching\CD\Drawings\Contract Maintenance\FY 2024\6426-IL-2 Bridge Inlet replacement and patching\CD\Drawings\6426-02-Index Sheet

USER NAME = Nicholas,Vock	DESIGNED -	REVISED -	STATE OF ILLINOIS DEPARTMENT OF TRANSPORTATION	INDEX OF SHEETS & HIGHWAY STANDARDS	F.A.P. RTE.	SECTION	COUNTY	TOTAL SHEETS	SHEET NO.	
PLOT SCALE = \$SCALE\$	DRAWN -	REVISED -			742	(38VB-1) DR & PP	OGLE	4	2	
PLOT DATE = 3/15/2024	CHECKED -	REVISED -			CONTRACT NO. 64T26					
	DATE -	REVISED -			SCALE:	SHEET	OF	SHEETS	STA.	TO STA.

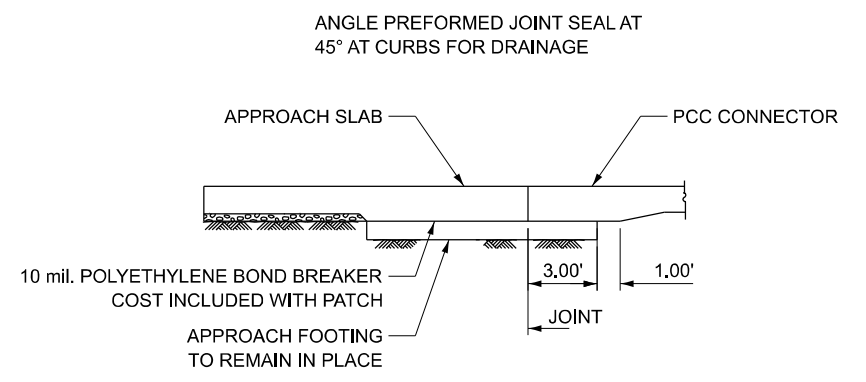
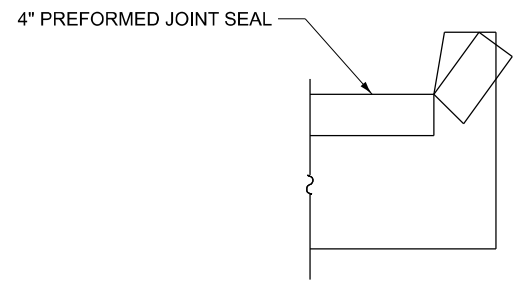
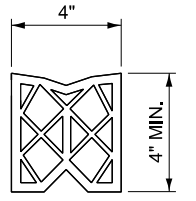
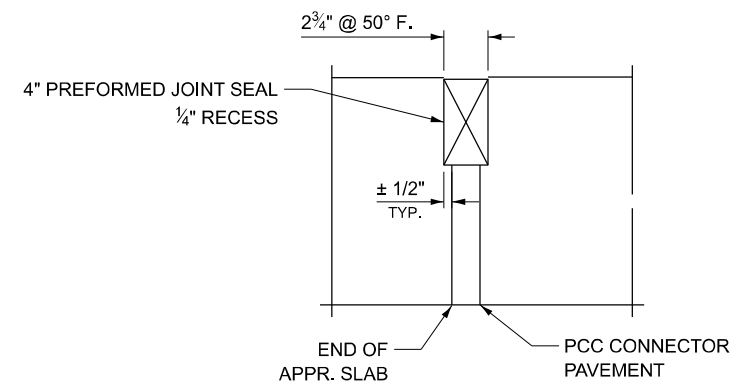
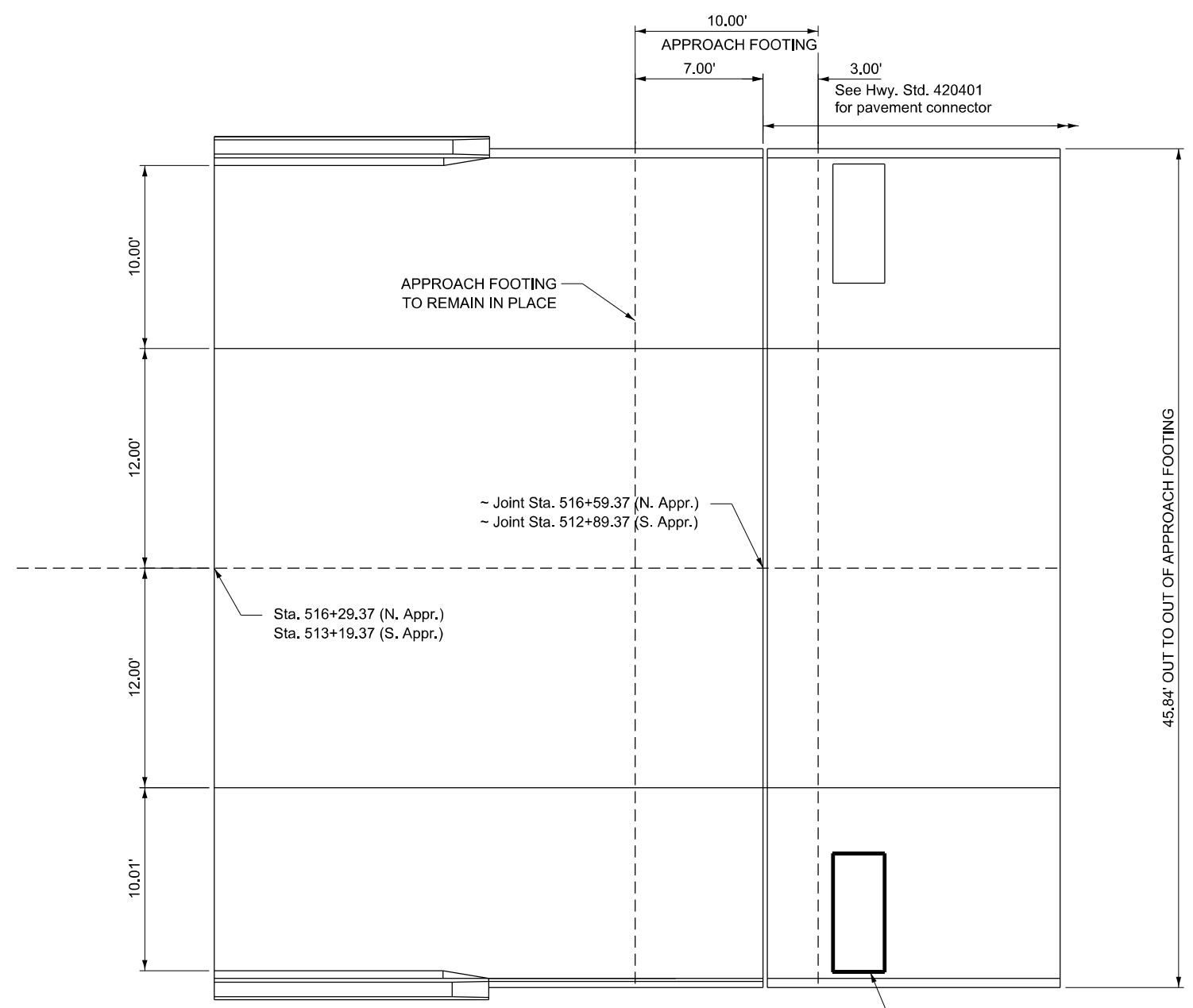
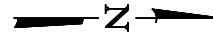

Sta. 516+64 PROPOSED TYPE F INLET BOX,
HWY. STD 610001, TYP.

GUARDRAIL NOT SHOWN FOR CLARITY
CURB REMOVAL AND REPLACE TO BE INCLUDED IN COST FOR INLET TYPE F
MATCH SAW CUT OF EXISTING PATCH

MODEL: 64T26 - Detail sheet 5
 FILE NAME: I:\projects\2024\64T26 - E. 2 Bridge Inlet replacement and patching\CD\Drawings\64T26-04-Detail

USER NAME = Nicholas,Vock	DESIGNED -	REVISED -
	DRAWN -	REVISED -
PLOT SCALE = \$SCALE\$	CHECKED -	REVISED -
PLOT DATE = 3/15/2024	DATE -	REVISED -

**STATE OF ILLINOIS
DEPARTMENT OF TRANSPORTATION**

JOINT DETAILS

SCALE: SHEET OF SHEETS STA. TO STA.

F.A.P. RTE.	SECTION	COUNTY	TOTAL SHEETS	SHEET NO.
742	(38VB-1) DR & PP	OGLE	4	4
CONTRACT NO. 64T26				
		ILLINOIS	FED. AID PROJECT	