

SPL'TY ITEM	CODE NO.	ITEM	UNIT	TOTAL QUANTITY	CONSTRUCTION CODE		
					RURAL NHPP FUNDS	RURAL NHPP FUNDS	RURAL NHPP FUNDS
					90% FED / 10% STATE	90% FED / 10% STATE	90% FED / 10% STATE
					0004 RURAL I	0013 RURAL II	0013 RURAL III
	X7010216	TRAFFIC CONTROL AND PROTECTION, (SPECIAL)	L SUM	1	1		
*	X8101100	UNDERGROUND CONDUIT, MULTI-DUCT, 7-16MM MICRODUCTS	FOOT	1,050	1,050		
	Z0001002	GUARDRAIL AGGREGATE EROSION CONTROL	TON	529	529		
	Z0004552	APPROACH SLAB REMOVAL	SQ YD	459	459		
	Z0012754	STRUCTURAL REPAIR OF CONCRETE (DEPTH EQUAL TO OR LESS THAN 5 INCHES)	SQ FT	8		4	4
	Z0012755	STRUCTURAL REPAIR OF CONCRETE (DEPTH GREATER THAN 5 INCHES)	SQ FT	12		6	6
	Z0013798	CONSTRUCTION LAYOUT	L SUM	1	1		
	Z0018004	DRAINAGE SCUPPERS, DS-12	EACH	16		8	8
	Z0029090	DIAMOND GRINDING (BRIDGE SECTION)	SQ YD	3,744		1,819	1,925
*	Z0033052	COMMUNICATIONS VAULT	EACH	2	2		
	Z0034105	MATERIAL TRANSFER DEVICE	TON	1,745	1,745		
	Z0040530	PIPE UNDERDRAIN REMOVAL	FOOT	42	42		



LEGEND
 I = ROADWAY & NON-STRUCTURAL ITEMS
 II = WB BRIDGE - STRUCTURE NUMBER 048-0051
 III = EB BRIDGE - STRUCTURE NUMBER 048-0052

* THIS ITEM IS PAID FOR AS 100% STATE FUNDS.

MODEL: 20 SHEET 1
 FILE NAME: C:\PWA\WORK\EXP-RW\BENTLEY.COM\EXP-RW\01\001\43\BID\68E35-SHT-500-10.DGN



USER NAME = SWANSONAL	DESIGNED - D. Hansen	REVISED -
	DRAWN - V. Parra	REVISED -
PLOT SCALE = 0.16666633' / IN.	CHECKED - K. Antonson	REVISED -
PLOT DATE = 3/20/2024	DATE - 3/20/2024	REVISED -

**STATE OF ILLINOIS
DEPARTMENT OF TRANSPORTATION**

SUMMARY OF QUANTITIES

SCALE: SHEET OF SHEETS STA. TO STA.

F.A.I. RTE.	SECTION	COUNTY	TOTAL SHEETS	SHEET NO.
74	(48-29B)BR	KNOX	166	12
CONTRACT NO. 68E35				
ILLINOIS FED. AID PROJECT				

78003151 TERMINAL MARKER - DIRECT APPLIED TOTAL 166 FOOT

LINE TYPE	COLOR	SUBTOTALS
SOLID	WHITE	3.4
SOLID	WHITE	6.8
SOLID	WHITE	10.0
SOLID	WHITE	12.7
SOLID	WHITE	15.4
SOLID	WHITE	17.7
SOLID	WHITE	20.6
SOLID	WHITE	23.5
SOLID	WHITE	26.3
SOLID	WHITE	29.9

78100100 RAISED REFLECTIVE PAVEMENT MARKER TOTAL 121 EACH

LINE TYPE	COLOR	STA FROM	STA TO	SUBTOTALS
4" DASH	WHITE	1054+85.00	1087+62.10	41
4" DASH	WHITE	1055+59.81	1083+73.37	36
SOLID	WHITE	1079+89.22	1083+70.00	10
SOLID	WHITE	3+73.13	7+10.40	9
SOLID	WHITE	33+94.60	37+57.07	10
SOLID	WHITE	1083+92.68	1087+60.70	10
SOLID	WHITE	0+19.13	1+02.00	5

X4400196 HOT-MIX ASPHALT SURFACE REMOVAL (SPECIAL) TOTAL 415 SQ YD

ROADWAY	FROM STA	TO STA	SUBTOTALS
EB I-74	1055+69.81	1065+82.55	112.5
EB I-74	1071+99.46	1083+63.36	129.3
WB I-74	1071+99.30	1087+62.10	173.6

X4404400 PAVEMENT REMOVAL (SPECIAL) TOTAL 591 SQ YD

ROADWAY	FROM STA	TO STA	SUBTOTALS
WB I-74	1071+14.88	1071+89.30	198.9
EB I-74	1065+92.55	1066+64.57	190.8
EB I-74	1071+14.84	1071+89.46	201.4

Z0001002 GUARDRAIL AGGREGATE EROSION CONTROL TOTAL 529 TON

ROADWAY	FROM STA	TO STA	SUBTOTALS
WB I-74	1065+70.00	1066+64.79	33.7
WB I-74	1071+14.71	1074+46.18	117.9
WB I-74	1071+14.71	1074+50.09	119.2
EB I-74	1063+38.70	1066+64.79	115.9
EB I-74	1063+40.40	1066+64.79	115.3
EB I-74	1071+14.71	1071+89.11	26.5



Z0034105 MATERIAL TRANSFER DEVICE TOTAL 1745 TON

PAY ITEM	SUBTOTALS
POLYMERIZED HOT-MIX ASPHALT SURFACE COURSE, STONE MATRIX ASPHALT, 12.5, MIX "E", N80	1481
HOT-MIX ASPHALT SHOULDERS, 2"	264.4

X4201410 BRIDGE APPROACH PAVEMENT CONNECTOR (SPECIAL) TOTAL 330 SQ YD

ROADWAY	FROM STA	TO STA	SUBTOTALS
EB I-74	1066+05.13	1066+44.79	105.8
EB I-74	1071+34.71	1071+76.79	112.2
WB I-74	1071+34.71	1071+76.63	111.8

#4002299 DOUBLE EXPANSION JOINT 4" TOTAL 101 SQ YD

ROADWAY	FROM STA	TO STA	SUBTOTALS
EB I-74	1065+92.23	1066+04.90	33.8
EB I-74	1071+76.79	1071+89.46	33.8
WB I-74	1071+76.63	1071+89.30	33.8

#4002300 DOUBLE REINFORCED CONCRETE SLAB TOTAL 96.3 CU YD

ROADWAY	FROM STA	TO STA	SUBTOTALS
EB I-74	1066+44.79	1066+64.79	24.1
EB I-74	1071+14.71	1071+34.71	24.1
WB I-74	1066+44.79	1066+64.79	24.1
WB I-74	1071+14.71	1071+34.71	24.1

30300112 AGGREGATE SUBGRADE IMPROVEMENT 12" TOTAL 9909 SQ YD

Starting STA	Ending STA	Length (FT)	SUBTOTALS
1055+28.73	1059+75.11	446.38	546
1060+96.29	1065+11.52	415.23	508
1059+75.11	1060+96.26	121.15	942
1079+41.59	1083+73.00	431.41	1726
1072+86.12	1076+04.11	317.99	601
1076+04.11	1078+15.00	210.89	890
1078+15.00	1079+41.59	126.59	155
1078+15.00	1079+41.59	126.59	155
1071+15.50	1078+15.15	699.65	466
1073+14.76	1076+08.81	294.05	555
1076+08.81	1077+26.17	117.36	183
1076+08.81	1077+26.17	117.36	183
1077+26.17	1085+65.00	838.83	1305
1077+26.17	1085+65.00	838.83	1305
1071+14.50	1077+00.00	585.50	390

40604050 HOT-MIX ASPHALT SURFACE COURSE, IL-9.5, MIX "C", N50 TOTAL 206 TON

Starting STA	Ending STA	SUBTOTALS
EAST CROSSOVER		
1072+86.15	1079+41.59	49
1078+15.15	1082+32.78	31
1073+14.76	1079+92.90	51
1076+08.81	1081+91.79	44
WEST CROSSOVER		
1056+99.05	1063+21.71	15
1056+99.05	1063+41.09	16

MODEL: 20 SHEET 14 FILE NAME: C:\P\WORK\EXP\W.BENTLEY.COM\EXP\W01\001\43\B\0468E35-SHT-SCHEDULE-04.DGN



USER NAME = PARRAV	DESIGNED - D. Hansen	REVISED - 5/22/2024
PLOT SCALE = 0.16666633' / IN.	DRAWN - V. Parra	REVISED -
PLOT DATE = 5/21/2024	CHECKED - K. Antonson	REVISED -
	DATE - 3/26/2024	REVISED -

STATE OF ILLINOIS
DEPARTMENT OF TRANSPORTATION

SCHEDULE OF QUANTITIES			
I-74			
SCALE:	SHEET	OF SHEETS	STA. TO STA.

F.A.I. RTE.	SECTION	COUNTY	TOTAL SHEETS	SHEET NO.
74	(48-29B)BR	KNOX	166	19
CONTRACT NO. 68E35				
ILLINOIS FED. AID PROJECT				

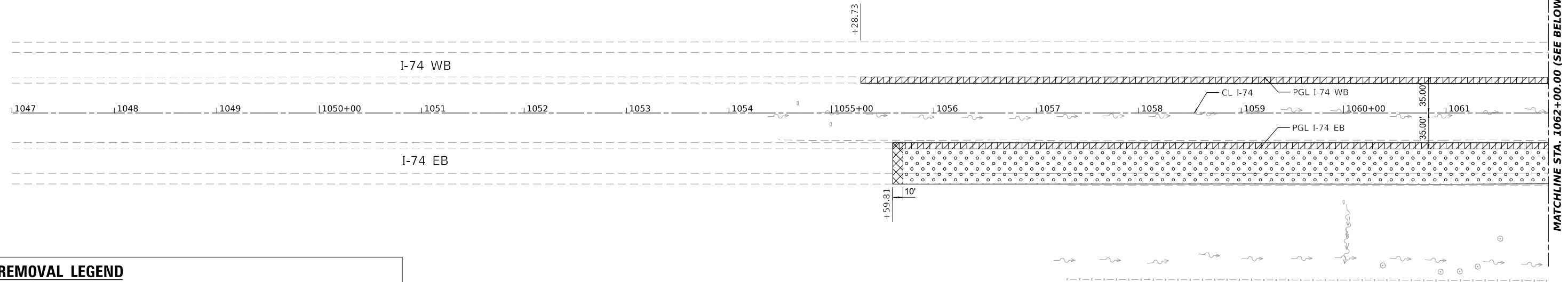
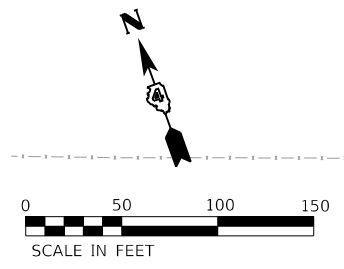

REMOVAL LEGEND

	PAVEMENT REMOVAL		HOT-MIX ASPHALT SURFACE REMOVAL, 2"
	PAVEMENT REMOVAL (SPECIAL)		PAVED SHOULDER REMOVAL
	HOT-MIX ASPHALT SURFACE REMOVAL - BUTT JOINT		APPROACH SLAB REMOVAL (SEE NOTE)

NOTE
 THE COST OF APPROACH SLAB REMOVAL IS INCLUDED IN THE CONTRACT UNIT PRICE FOR "REMOVAL OF EXISTING SUPERSTRUCTURES." SEE STRUCTURAL PLANS.

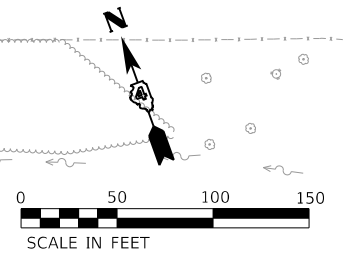
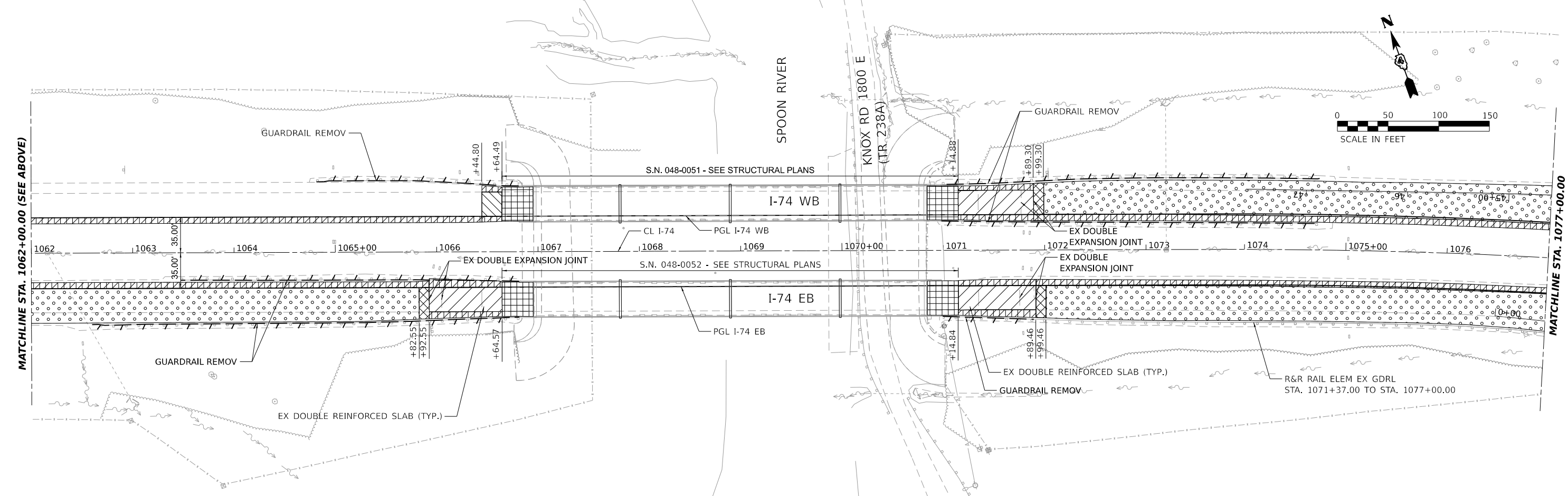

MODEL: I-74 REM PLAN - I-74 REMOVAL
 FILE NAME: C:\P\WORK\EXR\BENTLEY\COM\EXP\RW\01\1001\43\B\68E35-SHT-REM-02.DGN

	USER NAME = PARRAV	DESIGNED - D. Hansen	REVISED - 5/22/2024
	PLOT SCALE = 0.16666633' / IN.	DRAWN - V. Parra	REVISED -
	PLOT DATE = 5/21/2024	CHECKED - K. Antonson	REVISED -
		DATE - 3/25/2024	REVISED -

**STATE OF ILLINOIS
 DEPARTMENT OF TRANSPORTATION**

EXISTING CONDITIONS AND REMOVAL PLANS
I-74

SCALE: 1"=50' SHEET OF SHEETS STA. 1047+00.00 TO STA. 1077+00.00

F.A.I. RTE.	SECTION	COUNTY	TOTAL SHEETS	SHEET NO.
74	(48-29B)BR	KNOX	166	26
CONTRACT NO. 68E35				
ILLINOIS FED. AID PROJECT				

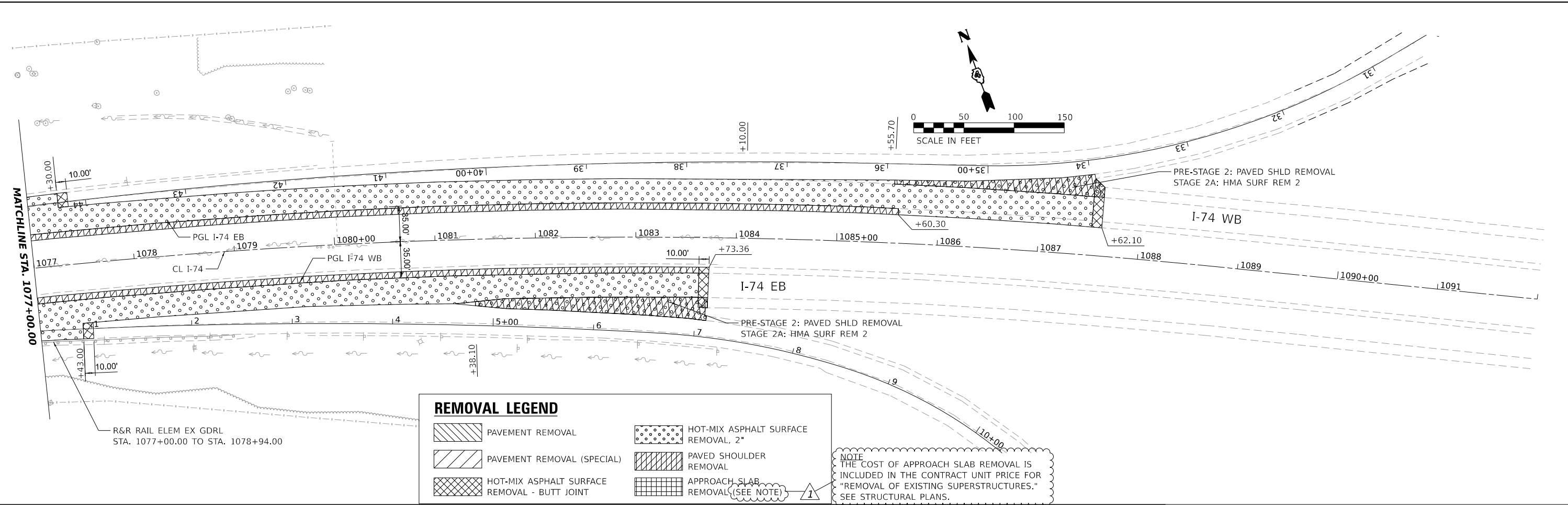

REMOVAL LEGEND

	PAVEMENT REMOVAL		HOT-MIX ASPHALT SURFACE REMOVAL, 2"
	PAVEMENT REMOVAL (SPECIAL)		PAVED SHOULDER REMOVAL
	HOT-MIX ASPHALT SURFACE REMOVAL - BUTT JOINT		APPROACH SLAB REMOVAL (SEE NOTE)

NOTE
 THE COST OF APPROACH SLAB REMOVAL IS INCLUDED IN THE CONTRACT UNIT PRICE FOR "REMOVAL OF EXISTING SUPERSTRUCTURES." SEE STRUCTURAL PLANS.

MODEL: I-74 REM PLAN - I-74 REMOVAL-24 (SHEET)
 FILE NAME: C:\PW\WORK\EXP\BENTLEY\COM\EXP\I-74\I-74 REMOVAL-24\I-74 REMOVAL-24.DGN



USER NAME = PARRAV	DESIGNED - D. Hansen	REVISED - 1/5/22/2024
PLOT SCALE = 0.16666633' / IN.	DRAWN - V. Parra	REVISED -
PLOT DATE = 5/21/2024	CHECKED - K. Antonson	REVISED -
	DATE - 3/25/2024	REVISED -

**STATE OF ILLINOIS
 DEPARTMENT OF TRANSPORTATION**

**EXISTING CONDITIONS AND REMOVAL PLANS
 I-74**

SCALE: 1"=50' SHEET OF SHEETS STA. 1077+00.00 TO STA. 1107+00.00

F.A.I. RTE.	SECTION	COUNTY	TOTAL SHEETS	SHEET NO.
74	(48-29B)BR	KNOX	166	27
CONTRACT NO. 68E35				
		ILLINOIS	FED. AID PROJECT	