

STATE OF ILLINOIS
DEPARTMENT OF TRANSPORTATION

F.A.P. RTE.	SECTION	COUNTY	TOTAL SHEETS	SHEET NO.
322	D5 CM PATCHING 2024-5	DEWITT	7	1
		ILLINOIS	CONTRACT NO. 70H09	

FOR INDEX OF SHEETS, SEE SHEET NO. 2
FOR SUMMARY OF QUANTITIES, SEE SHEET NO. 3

TRAFFIC DATA

FAP 322 (US 51)
LEG "A"

2023 ADT =	10,300
P.U. %	87.4
S.U. %	3.4
M.U. %	9.2

TRAFFIC DATA LOCATIONS
LEG "A" is US 51 from N. First St in Wapella to US 51 Bus North in Clinton

FUNCTIONAL CLASSIFICATION
US 51: Freeway and Expressway

TOWNSHIP
CLINTONIA

PROPOSED HIGHWAY PLANS

FAP ROUTE 322 (US 51) SECTION D5 CM PATCHING 2024-5 PROJECT PATCHING DEWITT COUNTY

C-95-031-24
N FIRST ST IN WAPELLA TO US 51 BUS N OF CLINTON

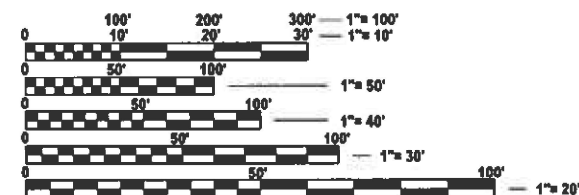
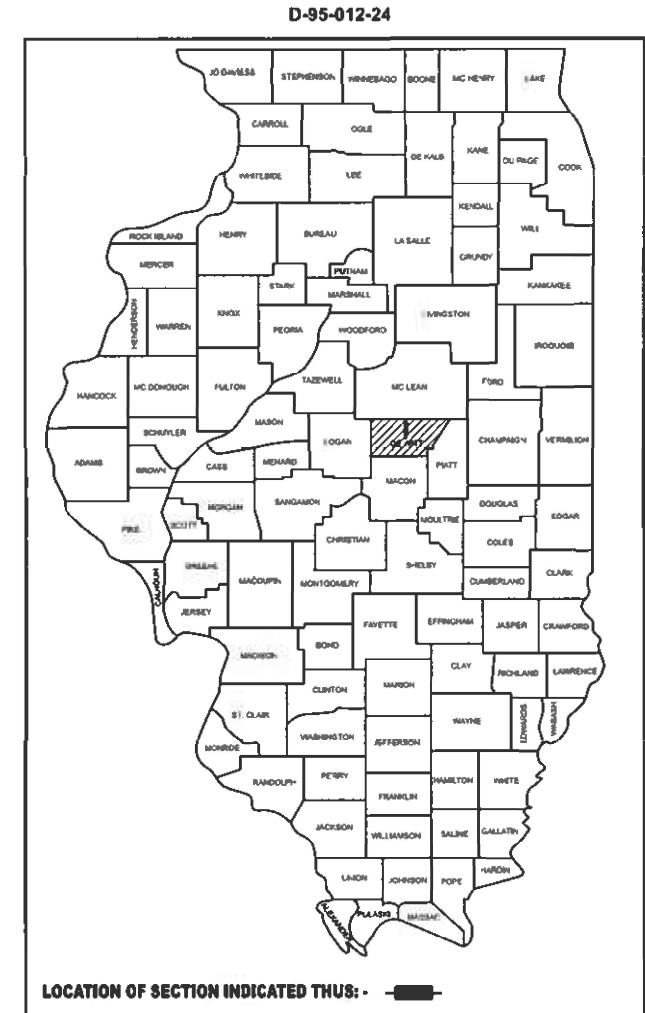

FULL SIZE PLANS HAVE BEEN PREPARED USING STANDARD ENGINEERING SCALES. REDUCED SIZED PLANS WILL NOT CONFORM TO STANDARD SCALES. IN MAKING MEASUREMENTS ON REDUCED PLANS, THE ABOVE SCALES MAY BE USED.

J.U.L.I.E.
JOINT UTILITY LOCATION INFORMATION FOR EXCAVATION
1-800-892-0123
OR 811

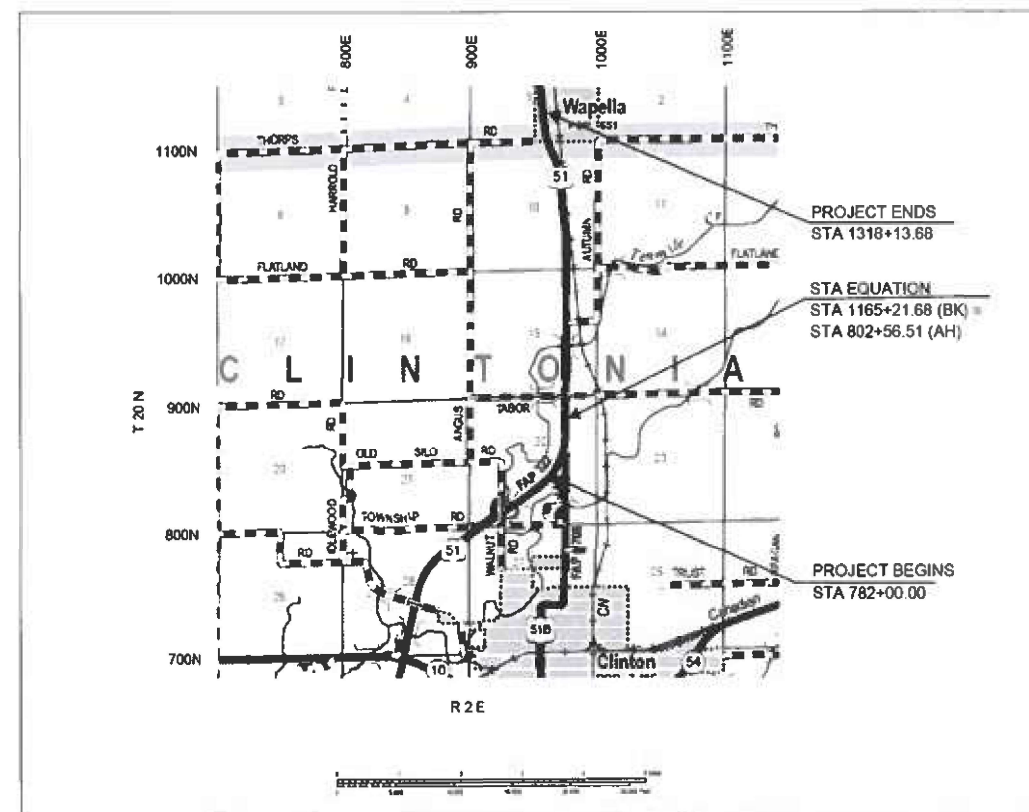

PROJECT ENGINEER: JASON STULTS
DESIGNER: JEANNIE BLAND
PHONE: (217)465-4181
CONTRACT NO. 70H09

GROSS LENGTH = 17,348.51 FT. = 3.29 MILES
NET LENGTH = 17,348.51 FT. = 3.29 MILES

STATE OF ILLINOIS
DEPARTMENT OF TRANSPORTATION

SUBMITTED 12/26 20 2023
Kensila Barnett swin
REGIONAL ENGINEER

May 10, 2024 *SEA ERS*
ENGINEER OF DESIGN AND ENVIRONMENT

May 10, 2024 *Stephen McSwain*
DIRECTOR OF HIGHWAYS PROJECT IMPLEMENTATION

**PRINTED BY THE AUTHORITY
OF THE STATE OF ILLINOIS**

INDEX OF SHEETS

SHEET NO.	DESCRIPTION
1	COVERSHEET
2	INDEX OF SHEETS
2	HIGHWAY STANDARDS
2	GENERAL NOTES
2	COMMITMENTS
3	SUMMARY OF QUANTITIES
4	TYPICAL CROSS SECTIONS
5	SCHEDULE OF QUANTITIES
6-7	DETAIL FOR CLASS A PATCHING (SPL)

LIST OF HIGHWAY STANDARDS

STANDARD NO.	DESCRIPTION
00001-08	STANDARDS SYMBOLS, ABBREVIATIONS, & PATTERNS
001001-02	AREAS OF REINFORCEMENT
001006	DECIMAL OF AN INCH AND OF A FOOT
701101-05	OFF-ROAD OPERATIONS, MULTILANE, 15' TO 24" FROM PAVEMENT EDGE
701106-02	OFF-ROAD OPERATIONS, MULTILANE, MORE THAN 15' AWAY
701422-10	LANE CLOSURE, MULTILANE, FOR SPEEDS >= 45 MPH TO 55 MPH
701901-09	TRAFFIC CONTROL DEVICES

GENERAL NOTES

G.N.-100A
 ELECTRONIC FILES AND/OR ELECTRONIC SURVEY INFORMATION INCLUDING CADD FILES WILL NOT BE AVAILABLE TO THE CONTRACTOR.

COMMITMENTS

THERE ARE NO COMMITMENTS FOR THIS CONTRACT

MODEL: Gen Notes (Sheet)
 FILE NAME: c:\pwwork\pierson\052070570109_Sht-Gen Notes.dgn

USER NAME = Bridgette Pierson	DESIGNED -	REVISED -
	DRAWN -	REVISED -
PLOT SCALE = 0.10000007/in.	CHECKED -	REVISED -
PLOT DATE = 12/12/2023	DATE -	REVISED -

STATE OF ILLINOIS
 DEPARTMENT OF TRANSPORTATION

INDEX OF SHEETS, LIST OF HIGHWAY STANDARDS,
 GENERAL NOTES & COMMITMENTS

SCALE: NONE | SHEET 1 OF 1 SHEETS | STA. TOSTA.

FAP RTE.	SECTION	COUNTY	TOTAL SHEETS	SHEET NO.
322	05 CM PATCHING 2024-5	VERMILION	7	2
			CONTRACT NO. 70H09	

LOCATION OF WORK: FAP 322 (US 51)
 FREEWAY AND EXPRESSWAY

URBAN
 STA. 1318+13.68 -
 STA. 1162+21.68 (BK)
 STA. 802+56.51 (AH) -
 STA. 770+00.00
 DEWITT

FUNDING BREAKOUT: 100% STATE
 CONSTRUCTION TYPE CODE: 0006

CODE NO.	ITEM	UNIT	TOTAL QUANTITY	ROADWAY QUANTITY
44213000	PATCH REINFORCEMENT	SQ YD	2,766.0	2,766.0
44213200	SAW CUTS	FOOT	8,734.0	8,734.0
44213204	TIE BARS 3/4"	EACH	3,040.0	3,040.0
67100100	MORII IZATION	L SUM	1.0	1.0
70100320	TRAFFIC CONTROL AND PROTECTION, STANDARD 701422	L SUM	1.0	1.0
70103815	TRAFFIC CONTROL SURVEILLANCE	CAL DAY	9.0	9.0
70107025	CHANGEABLE MESSAGE SIGN	CAL DAY	3.0	3.0
X4420545	CLASS A PATCHES, TYPE II, 9" SPECIAL	SQ YD	130.0	130.0
X4420547	CLASS A PATCHES, TYPE III, 9" SPECIAL	SQ YD	193.0	193.0
X4420549	CLASS A PATCHES, TYPE IV, 9" SPECIAL	SQ YD	2,444.0	2,444.0
Z0013798	CONSTRUCTION LAYOUT	L SUM	1.0	1.0
* DENOTES SPECIALTY ITEM				

MODEL: SOQ (Sheet)
 FILE NAME: c:\p\work\p\piersonb\093207\0570109_Sht-SOQ.dgn

USER NAME = Bridgette.Pierson	DESIGNED -	REVISED -
PLOT SCALE = 0.1666667 / in.	DRAWN -	REVISED -
PLOT DATE = 2/22/2024	CHECKED -	REVISED -
	DATE -	REVISED -

**STATE OF ILLINOIS
 DEPARTMENT OF TRANSPORTATION**

SUMMARY OF QUANTITIES			
SCALE: NONE	SHEET 1	OF 1 SHEETS	STA. TO STA.

F.A.P. RTE. 322	SECTION D5 CM PATCHING 2024-5	COUNTY VERMILION	TOTAL SHEETS 7	SHEET NO. 3
ILLINOIS FED.AID PROJECT			CONTRACT NO. 70H09	

① TYPICAL CROSS SECTION

SOUTHBOUND LANES ONLY
 STATION 770+00.00 TO STATION 802+56.51 BK (STA. EQ.)
 1165+21.68 AH (STA. EQU.) TO STATION 1281+03.77

STATION EQUATION
 802+56.61 BK = 1165+21.68 AH

NOTE:
 LIME MODIFIED SUB-GRADE, 12"
 STA. 1235+20.00 TO 1244+62.56
 STA. 1251+32.18 TO 1273+73.85

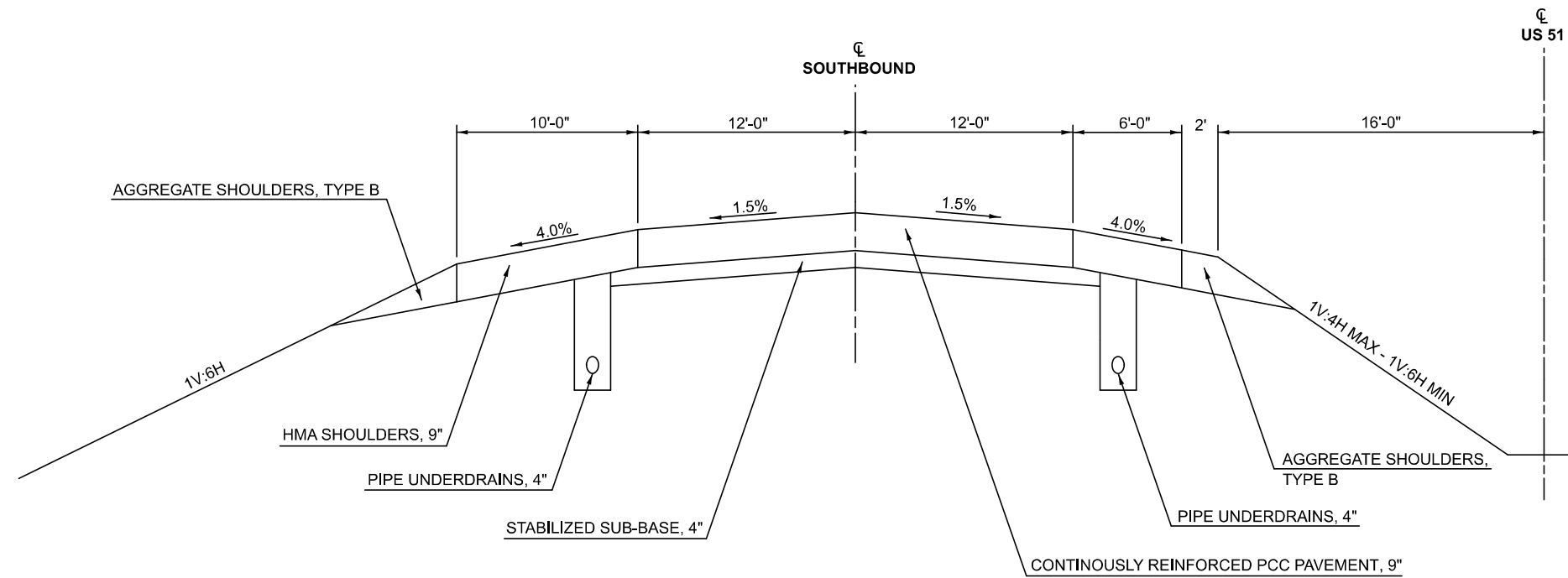

② TYPICAL CROSS SECTION

SOUTHBOUND LANES ONLY
 STATION 1281+03.77 TO STATION 1318+13.69

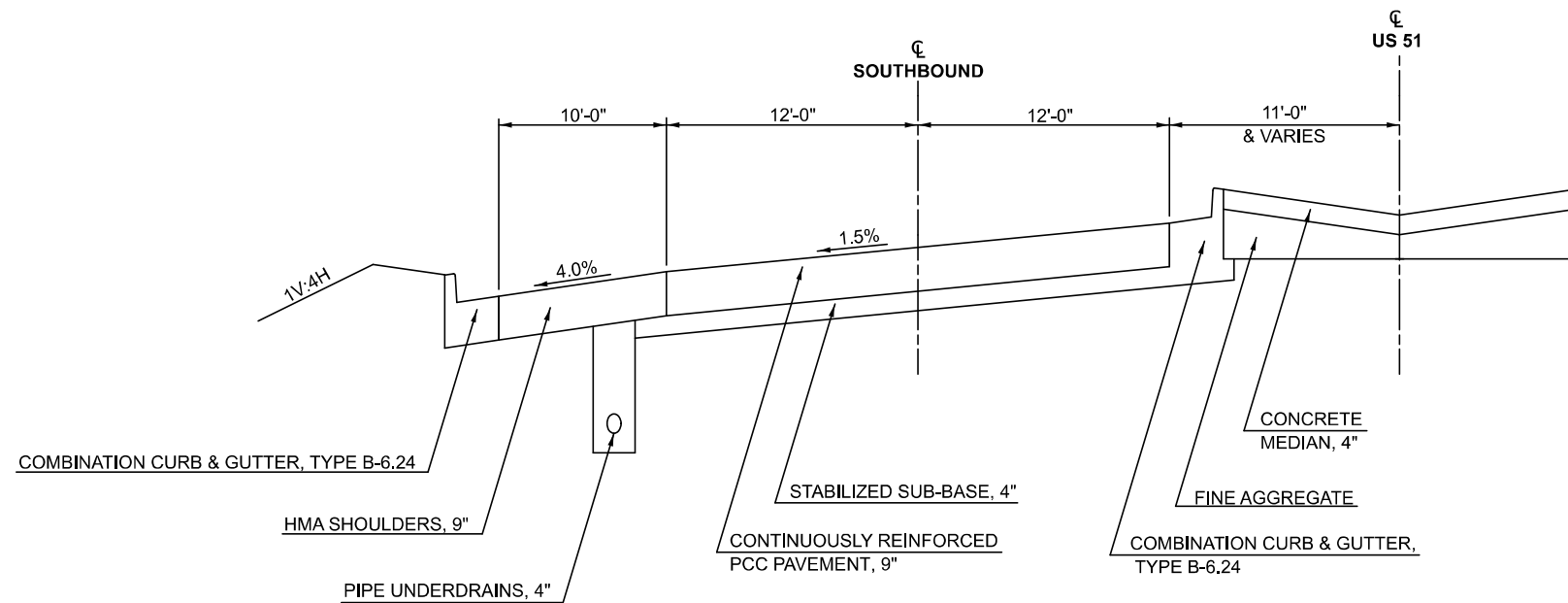

MODEL: Typical1_2 (Sheet)
 FILE NAME: c:\p\work\paw\td\pierson\09032077\0570109_Sht-Typicals.dgn

USER NAME = Bridgette.Pierson	DESIGNED - BBB	REVISED - RV1
	DRAWN - CCC	REVISED - RV2
PLOT SCALE = 0.1666667 / in.	CHECKED - AAA	REVISED - RV3
PLOT DATE = 2/16/2024	DATE - XX/XX/XX	REVISED - RV4

**STATE OF ILLINOIS
 DEPARTMENT OF TRANSPORTATION**

**TYPICAL CROSS SECTIONS
 FAP 322 (US 51)**

SCALE: NONE SHEET 1 OF 1 SHEETS STA. TO STA.

F.A.P. RTE.	SECTION	COUNTY	TOTAL SHEETS	SHEET NO.
322	D5 CM PATCHING 2024-5	DEWITT	7	4
CONTRACT NO. 70H09				
ILLINOIS		FED. AID PROJECT		

URBAN
US 51 BYPASS
DEWITT COUNTY

STATION	DIRECTION	LANE	LENGTH FT	WIDTH FT	AREA SQYD	CLASS A PATCHES, TYPE II, 9 INCH SPECIAL (SQ YD)	CLASS A PATCHES, TYPE III, 9 INCH SPECIAL (SQ YD)	CLASS A PATCHES, TYPE IV, 9 INCH SPECIAL (SQ YD)	PATCH REINFORCEMENT (SQ YD)	SAW CUTS (FT)	TIE BARS 3/4" (Longitudinal) (EACH)	TIE BARS 3/4" (Transverse) (EACH)
						X4420545	X4420547	X4420549	44213000	44213200	44213204	44213204
794+66	SB	DL	115.00	6.00	76.67			76.67	76.67	242.00	76.00	10.00
1279+20	SB	DL	525.00	6.00	350.00			350.00	350.00	1,062.00	350.00	10.00
1282+00	SB	DL	82.00	6.00	54.67			54.70	54.70	176.00	54.00	10.00
1283+25	SB	DL	36.00	6.00	24.00		24.00		24.00	84.00	24.00	10.00
1284+85	SB	DL	89.00	6.00	59.33			59.30	59.30	190.00	60.00	10.00
1296+60	SB	DL	120.00	6.00	80.00			80.00	80.00	252.00	80.00	10.00
1311+91	SB	DL	25.00	6.00	16.67		16.67		16.67	62.00	16.00	10.00
SOUTHBOUND DRIVING LANE SUBTOTALS						0.0	40.7	620.7	661.3	2068.0	660.0	70.0
1279+20	SB	PL	586.00	6.00	390.67			390.70	390.70	1,184.00	390.00	10.00
1288+10	SB	PL	259.00	6.00	172.67			172.70	172.70	530.00	172.00	10.00
1296+20	SB	PL	20.00	6.00	13.33	13.30			13.30	52.00	14.00	10.00
1298+15	SB	PL	129.00	6.00	86.00			86.00	86.00	270.00	86.00	10.00
SOUTHBOUND PASSING LANE SUBTOTALS						13.3	0.0	649.4	662.7	2036.0	662.0	40.0
SUBTOTALS						13.3	40.7	1,270.1	1,324.0	4,104.0	1,322.0	110.0
TOTALS USE:						13.0	41.0	1,270.0	1,324.0	4,104.0	1,432.0	

MODEL: Schedules [Sheet]
FILE NAME: c:\p\work\wv\del\pierson\br\093207\057\0109_Sht-Schedule.dgn

USER NAME = Bridgette, Pierson	DESIGNED - BBB	REVISED - RV1
	DRAWN - CCC	REVISED - RV2
PLOT SCALE = 0.16666667 / in.	CHECKED - AAA	REVISED - RV3
PLOT DATE = 2/16/2024	DATE - XX/XX/XX	REVISED - RV4

STATE OF ILLINOIS
DEPARTMENT OF TRANSPORTATION

PATCHING SCHEDULE

SCALE: NONE SHEET 1 OF 1 SHEETS STA. TO STA.

F.A.P. RTE.	SECTION	COUNTY	TOTAL SHEETS	SHEET NO.
322	D5 CM PATCHING 2024-5	DEWITT	7	5
CONTRACT NO. 70H09				
ILLINOIS FED. AID PROJECT				

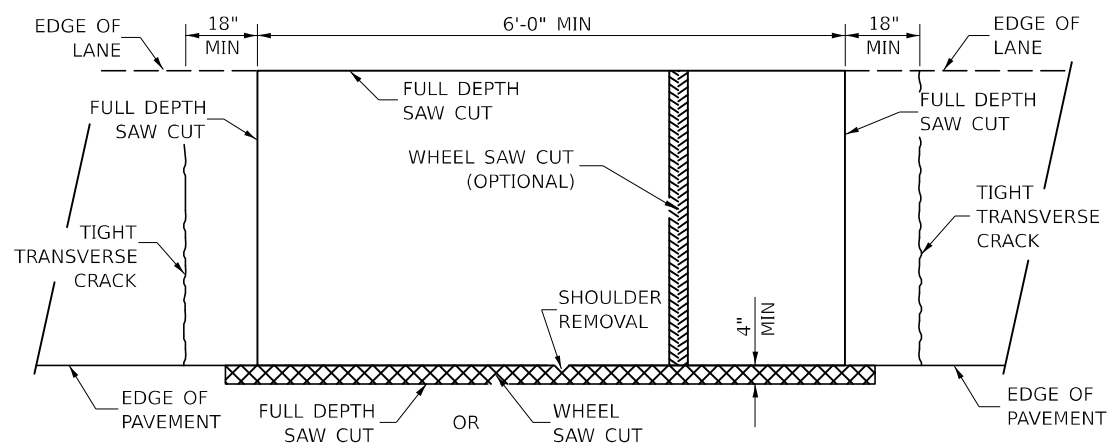

**PAVEMENT SAWING DETAIL
(HMA SHOULDER)**

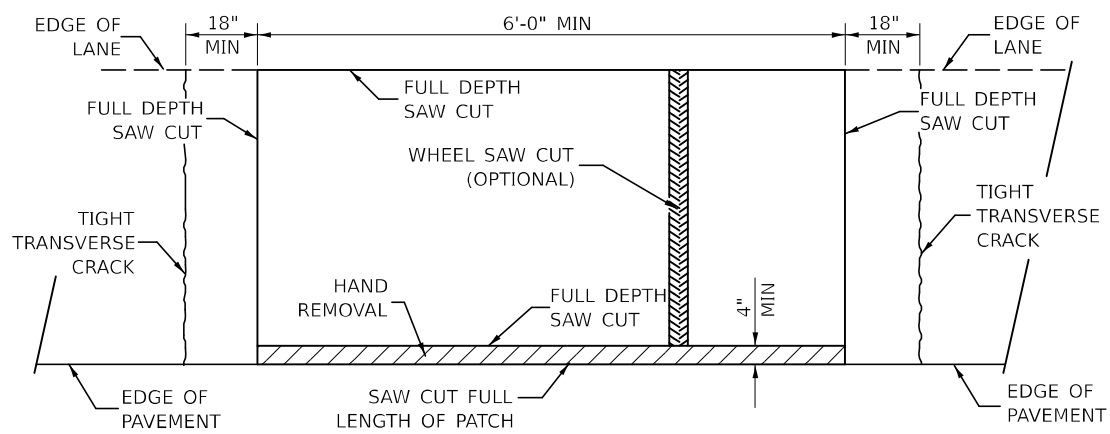

**PAVEMENT SAWING DETAIL
(PCC SHOULDER)**

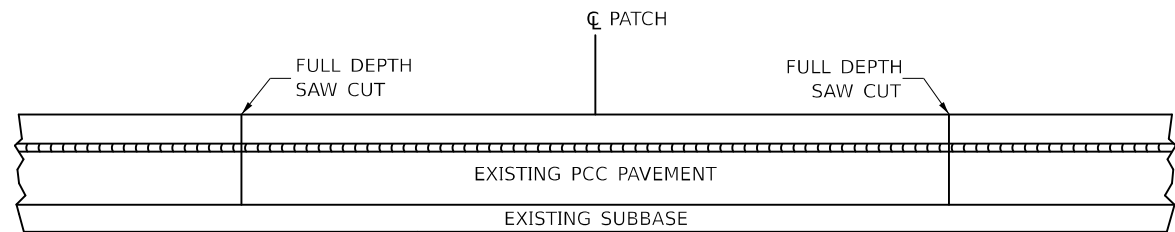

EXISTING PAVEMENT WITHOUT HMA SURFACE

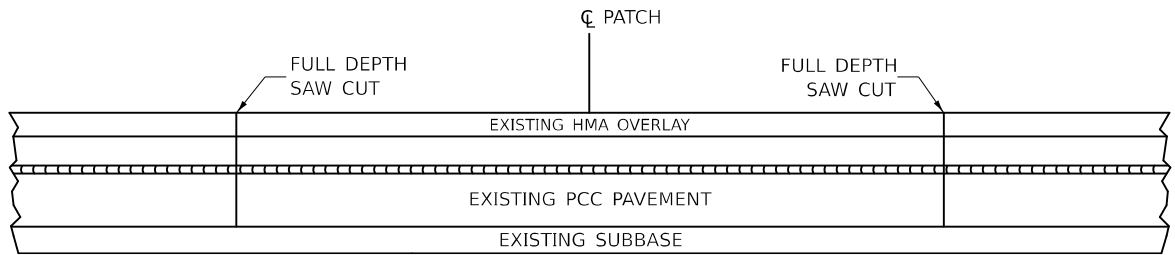

EXISTING PAVEMENT WITH HMA SURFACE

**PAVEMENT SAWING DETAIL FOR CLASS A PATCHING
(CRC PAVEMENT)**

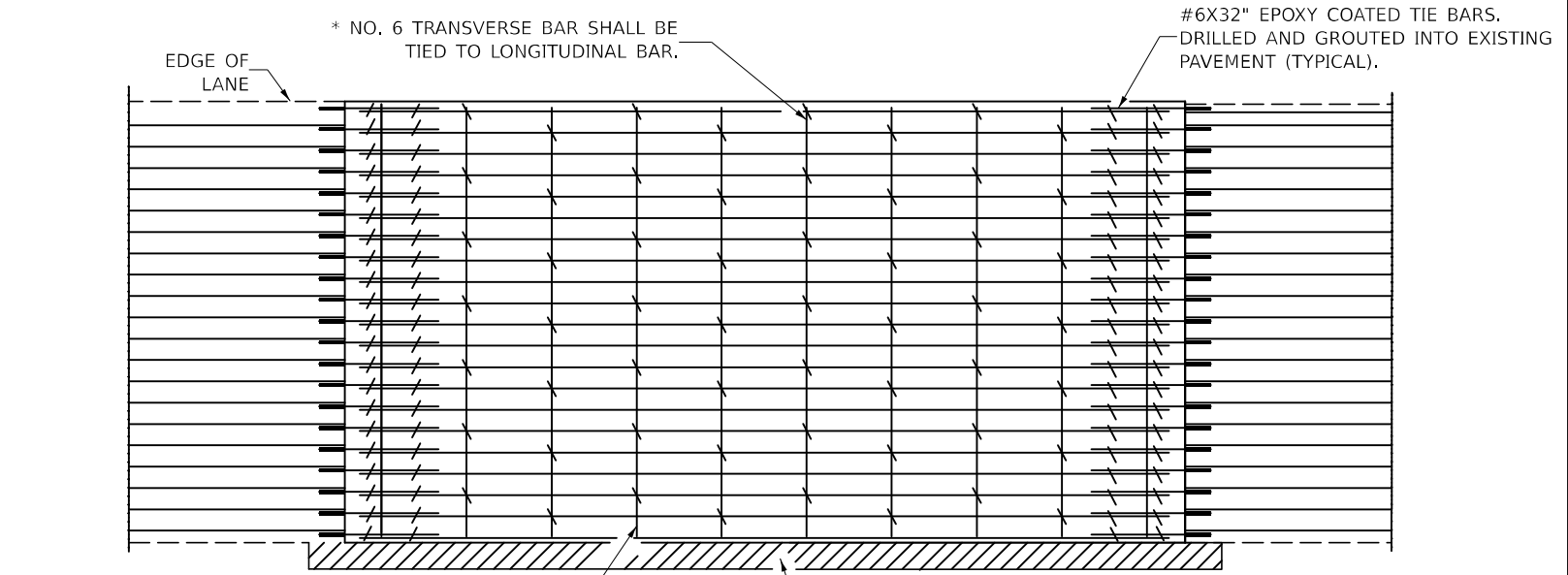

PAVEMENT REINFORCEMENT DETAIL

TRANSVERSE REBAR SHALL EXTEND TO OUTER LONGITUDINAL REBAR WHILE PROVIDING A MINIMUM 3" CLEARANCE FROM EXISTING PAVEMENT EDGE

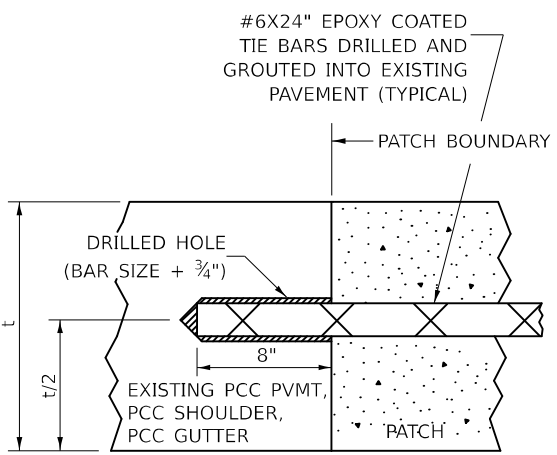

LONGITUDINAL CONSTRUCTION JOINT

PATCHES MORE THAN 20' IN LENGTH SHALL BE TIED TO ADJACENT PAVEMENT, PCC SHOULDERS OR PCC CURB AND GUTTER WITH #6x24" EPOXY COATED TIE BARS AT 36" CENTERS.

NOTES:

EXISTING LONGITUDINAL REINFORCEMENT SPACING; ±6 1/2".

SPACING OF NEW LONGITUDINAL REINFORCEMENT AND NEW LONGITUDINAL TIE BARS SHALL MATCH SPACING OF EXISTING REINFORCEMENT AND SHALL BE TIED TOGETHER WITH A MINIMUM OF TWO TIES PER BAR.

SUPPORT CHAIRS SHALL BE REQUIRED WHENEVER PATCH LENGTH EXCEEDS 6'-0"

* EVERY THIRD INTERSECTION MUST BE TIED. WHEN THE MINIMUM CLEARANCE CANNOT BE OBTAINED WITH THE TRANSVERSE REBAR ON TOP, THEN THE TRANSVERSE REBAR SHALL BE TIED TO THE BOTTOM OF THE LONGITUDINAL REBAR.

** VARIABLES WHERE S AND S ARE 2 1/2" MIN. AND 12" MAX.

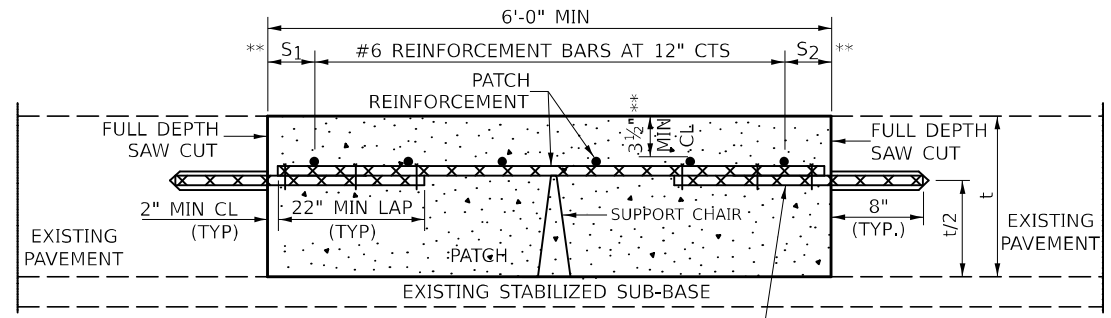

WITHOUT HMA OVERLAY

#6X32" EPOXY COATED TIE BARS DRILLED AND GROUTED INTO EXISTING PAVEMENT (TYPICAL)

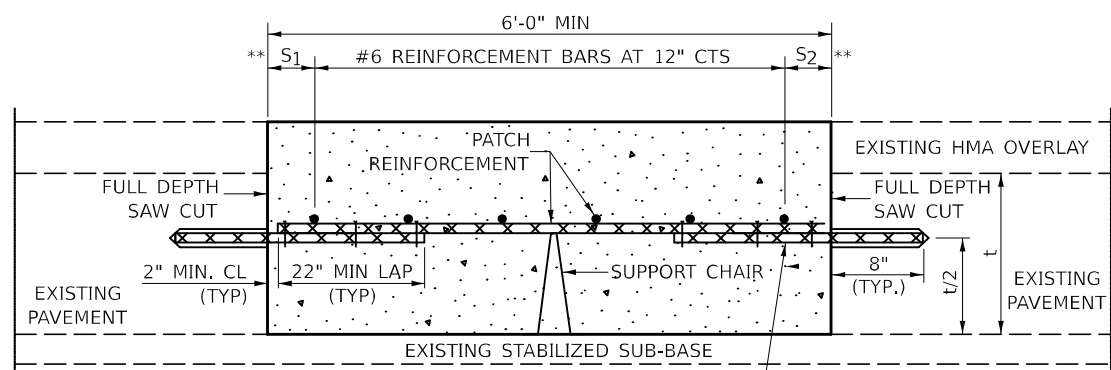

WITH HMA OVERLAY

#6X32" EPOXY COATED TIE BARS DRILLED AND GROUTED INTO EXISTING PAVEMENT (TYPICAL)

**PATCHING DETAIL FOR CLASS A PATCHING
(CRC PAVEMENT)**

Note: All dimensions are in INCHES (millimeters) unless otherwise shown.

MODEL: SHT_PLAN
FILE NAME: C:\Bentley\CONNECT1011\Organization\Chivil\DOT_Standards\Civil\DOT_Sheets.dwg

USER NAME = Eric.Thomas	DESIGNED - JWS	REVISED - 12/2023 - JWS
PLOT SCALE = 0.16666600' / in.	CHECKED -	REVISED -
PLOT DATE = 12/7/2022	DATE - 01/2021	REVISED -

**STATE OF ILLINOIS
DEPARTMENT OF TRANSPORTATION**

CLASS A PATCHING (SPECIAL)

SCALE: NONE SHEET 1 OF 2 SHEETS STA. TO STA.

DISTRICT 5 DETAIL NO. 44200AAA					
F.A.P. RTE.	SECTION	COUNTY	TOTAL SHEETS	SHEET NO.	
322	D5 CM PATCHING 2024-5	VERMILION	7	6	
CONTRACT NO. 70H09					
ILLINOIS FED. AID PROJECT					

CLASS A PATCHING (SPECIAL)

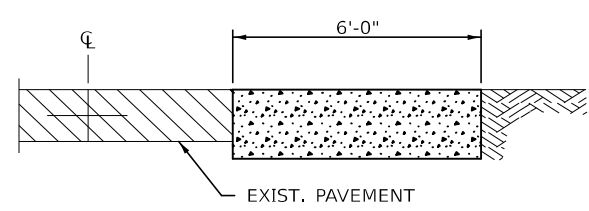
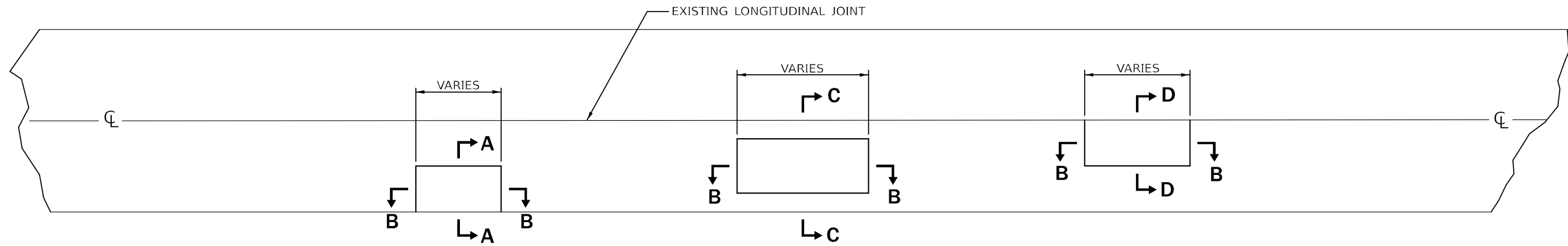

SECTION A-A

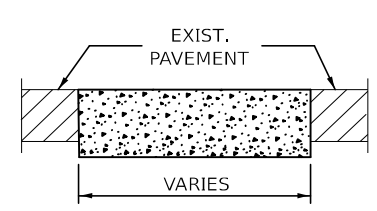

SECTION B-B

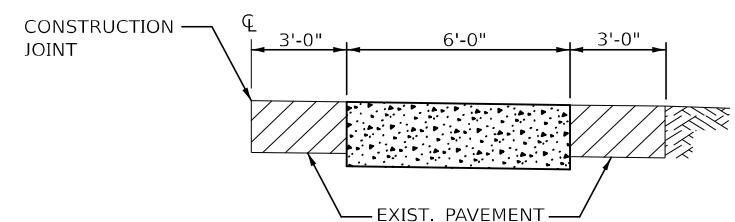

SECTION C-C

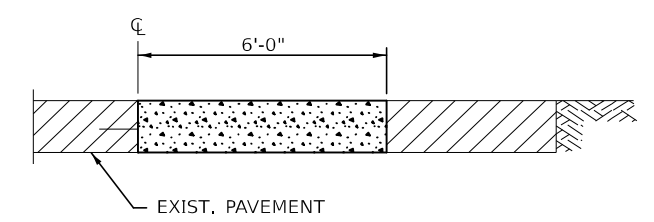

SECTION D-D

NOTE:
LONGITUDINAL JOINTS SHALL BE AS DETAILED ON STANDARD 420001, EXCEPT
TIE BARS ARE NOT REQUIRED FOR PATCHES 20'-0" (6.0 m) OR LESS IN LENGTH.

All dimensions are in INCHES (millimeters)
unless otherwise shown.

MODEL: Class A Patching Sheet 2 (Sheet)
FILE NAME: c:\p\work\pav\pav\piersonbr\03207\0570107_Sht-Detail_44200AAA.dgn

USER NAME = Bridgette.Pierson	DESIGNED -	REVISED -
	DRAWN -	REVISED -
PLOT SCALE = 0.16666667 / in.	CHECKED -	REVISED -
PLOT DATE = 12/20/2023	DATE -	REVISED -

**STATE OF ILLINOIS
DEPARTMENT OF TRANSPORTATION**

CLASS A PATCHING (SPECIAL)

SCALE: NONE SHEET 2 OF 2 SHEETS STA. TO STA.

F.A.P. RTE.	SECTION	COUNTY	TOTAL SHEETS	SHEET NO.
322	D5 CM PATCHING 2024-5	VERMILION	7	7
CONTRACT NO. 70H09				
ILLINOIS FED. AID PROJECT				