

- INDEX OF SHEETS**  
 1. COVER SHEET  
 2. SUMMARY OF QUANTITIES SHEET  
 3. SCHEDULE OF QUANTITIES SHEET  
 4. PLAN SHEET  
 5. DETAILS

**HIGHWAY STANDARDS:**

- 000001-08  
 664001-02  
 701001-02  
 701006-05  
 701201-05  
 701301-04  
 701901-09  
 BLR21-9  
 001006

**STATE OF ILLINOIS**  
**DEPARTMENT OF TRANSPORTATION**

**PROPOSED**  
**HIGHWAY PLANS**

**FAU ROUTE 8006 (CHATHAM RD.)**  
**SECTION D6 MG-PRKG-FNC 2024**  
**NEW OPERATIONS YARD**  
**PARKING LOT & FENCING**  
**SANGAMON COUNTY**

C-96-034-24

R5W

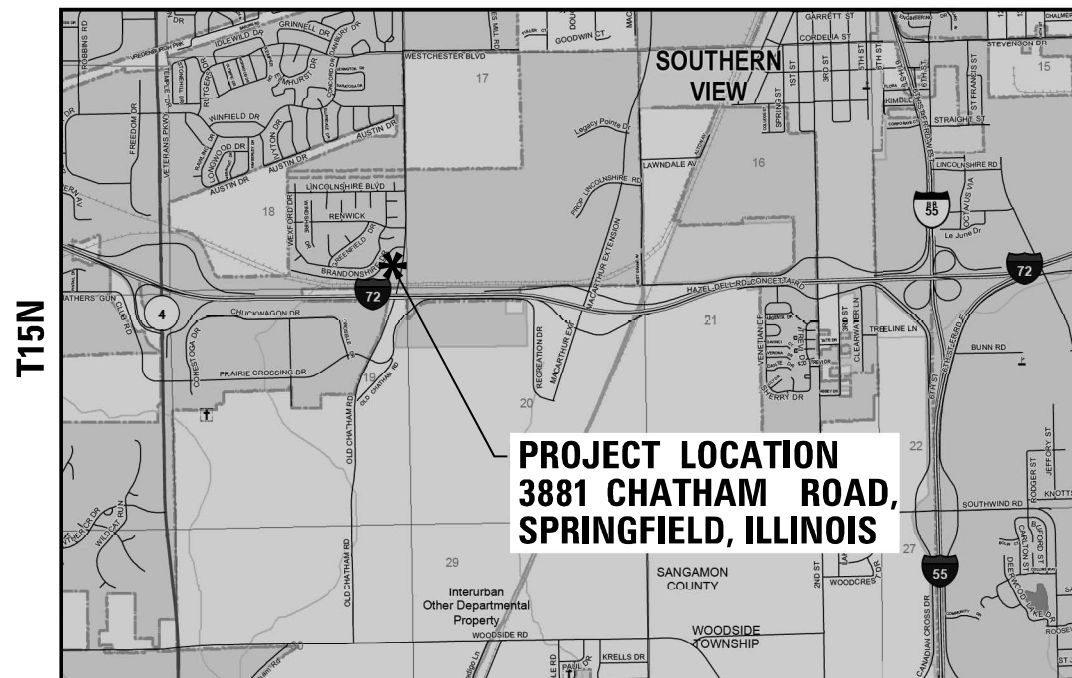

**PROJECT LOCATION**  
**3881 CHATHAM ROAD,**  
**SPRINGFIELD, ILLINOIS**



GROSS LENGTH = 911.0 FT. = 0.17 MILE  
 NET LENGTH = 911.0 FT. = 0.17 MILE

F.A.U. RTE.	SECTION	COUNTY	TOTAL SHEETS	SHEET NO.
8006	D6 MG-PRKG-FNC 2024	SANGAMON	5	1
		ILLINOIS	CONTRACT NO. 72730	

D-96-019-24

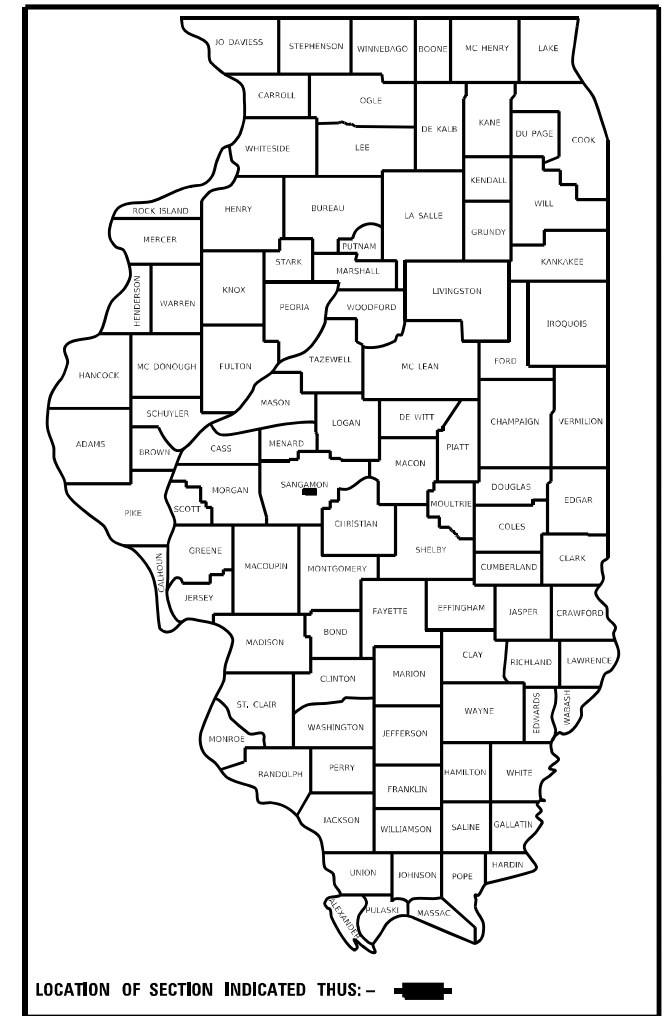

LOCATION OF SECTION INDICATED THIS: - [black rectangle]

**CHATHAM ROAD**  
 ADT 8600 (2022)  
 45 MPH

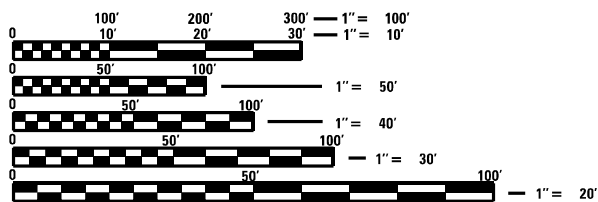

FULL SIZE PLANS HAVE BEEN PREPARED USING STANDARD ENGINEERING SCALES, REDUCED SIZED PLANS WILL NOT CONFORM TO STANDARD SCALES. IN MAKING MEASUREMENTS ON REDUCED PLANS, THE ABOVE SCALES MAY BE USED.

J.U.L.I.E.  
 JOINT UTILITY LOCATION INFORMATION FOR EXCAVATORS  
 1-800-892-0123  
 OR 811

**PROJECT ENGINEER: BRANDON DUDLEY 217-785-9290**  
**PROJECT MANAGER: FRANK SHIMKUS 217-685-5567**

**CONTRACT NO. 72730**

STATE OF ILLINOIS  
 DEPARTMENT OF TRANSPORTATION

SUBMITTED March 26 2024

*[Signature]*  
 REGIONAL ENGINEER

May 10, 2024  
*[Signature]*  
 ENGINEER OF DESIGN AND ENVIRONMENT

May 10, 2024  
*[Signature]*  
 DIRECTOR OF HIGHWAYS PROJECT IMPLEMENTATION

**PRINTED BY THE AUTHORITY**  
**OF THE STATE OF ILLINOIS**

				6-01165-9963
				100% STATE
CODE NO.	ITEM	UNIT	TOTAL QUANTITY	ROADWAY
				0005 URBAN
35800200	AGGREGATE BASE REPAIR	TON	100	100
40600290	BITUMINOUS MATERIALS (TACK COAT)	POUND	2090	2090
40600982	HOT-MIX ASPHALT SURFACE REMOVAL - BUTT JOINT	SQ YD	336	336
40603080	HOT-MIX ASPHALT BINDER COURSE, IL-19.0, N50	TON	1301	1301
40604050	HOT-MIX ASPHALT SURFACE COURSE, IL-9.5, MIX "C", N50	TON	781	781
48101200	AGGREGATE SHOULDERS, TYPE B	TON	75	75
66404800	CHAIN LINK GATES, 8' X 5' SINGLE	EACH	2	2
67100100	MOBILIZATION	L SUM	1	1
70100450	TRAFFIC CONTROL AND PROTECTION, STANDARD 701201	L SUM	1	1
X3580302	PREPARATION OF BASE (SPECIAL)	SQ YD	2391	2391
X6640308 *	CHAIN LINK GATES (SPECIAL)	EACH	2	2
X6640570 *	CHAIN LINK FENCE, 8' (SPECIAL)	FOOT	1420	1420
Ø Z0076604	TRAINEES TRAINING PROGRAM GRADUATE	HOUR	500	500
X7011800 *	TRAFFIC CONTROL AND PROTECTION, STANDARD BLR 21	L SUM	1	1

\* SEE SPECIAL PROVISIONS

Ø 0042

**GENERAL NOTES**

1. ALL PARKING LOT PAVEMENT SHALL SLOPE AWAY FROM EXISTING STRUCTURES
2. ALL REFERANCES TO THE STANDARDS THROUGHOUT THE PLANS SHALL BE INTERPRETED TO BE THE EDITION, AS INDICATED BY THE SUB-NUMBER, LISTED ON THE COVER SHEET, OR THE COPY OF THE STANDARD INCLUDED IN THESE PLANS.

APPLICATION RATES	
GRANULAR MATERIAL	1.9 TONS/CU YD
HOT-MIX ASPHALT	112 LBS/ SQ YD/IN
BITUMINOUS MATERIAL (TACK COAT)	.025 LBS/SQ FT

**STATE OF ILLINOIS  
DEPARTMENT OF TRANSPORTATION  
DIVISION OF HIGHWAYS  
DISTRICT 6**

---

EXAMINED March, 15 20 24  
  
**ENGINEER OF OPERATIONS**

---

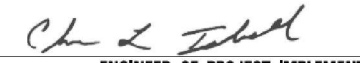
EXAMINED March, 15 20 24  
  
**ENGINEER OF PROJECT IMPLEMENTATION**

---

EXAMINED March, 14 20 24  
  
**ENGINEER OF PROGRAM DEVELOPMENT**

REV. - MS

MODEL: Default  
FILE NAME: SubAddressBridgePlans\_CAD\72730 - bridge crew para for improvements\Sh-500.dgn

USER NAME = Default	DESIGNED -	REVISED -	<b>STATE OF ILLINOIS DEPARTMENT OF TRANSPORTATION</b>	<b>SUMMARY OF QUANTITIES</b>			F.A.U. RTE.	SECTION	COUNTY	TOTAL SHEETS	SHEET NO.
PLOT SCALE = 40,0000 * / in.	DRAWN -	REVISED -					8006	D6 MG-PRKG-FNC 2024	SANGAMON	5	2
PLOT DATE = 3/25/2024	CHECKED -	REVISED -		SCALE: SHEET OF SHEETS STA. TO STA.			CONTRACT NO. 72730				
	DATE -	REVISED -					ILLINOIS FED. AID PROJECT				

HOT-MIX ASPHALT										
					HMA BINDER CSE	HMA SURFACE CSE	BIT MAT (TACK COAT)	HMA BUTT-JOINT	PREPARATION OF BASE (SPECIAL)	AGGREGATE BASE REPAIR
					IL 19.0, N50 2.5"	IL 9.5, MIX "C", N50 1.5"		REM		
STATION		LENGTH	WIDTH	SQYD	TON	TON	POUNDS	SQYD	SQYD	TON
BANYAN DRIVE										
38+00.00	TO	46+35.72	835.72	16	1485.72	208.00	124.80	334.29	1485.72	100.00
46+35.72	TO	47+07.42	71.70	36	286.80	40.15	24.09	64.53	286.80	
47+07.42	TO	47+11.54	4.12	105.7	48.39	6.77	4.06	10.89	48.39	
	TO		0.00							
SUB TOTAL =					254.93	152.96	409.71	335.19	1820.91	100.00
ENTRANCE										
39+00.00	TO	41+09.00	209.00	4	92.89	13.00	7.80	20.90	92.89	
41+66.00	TO	43+62.00	196.00	4	87.11	12.20	7.32	19.60	87.11	
SUB TOTAL =					25.20	15.12	40.50	0.00	180.00	0.00
PARKING LOT										
AREA FLOODED IN CADD					7288.05	1020.33	612.20	1639.81	390	
SUB TOTAL =					1020.33	612.20	1639.81	0.00	390.00	0.00
<b>TOTAL =</b>					<b>1300.5</b>	<b>780.3</b>	<b>2090.0</b>	<b>335.2</b>	<b>2390.9</b>	<b>100.0</b>

AGGREGATE SHOULDERS				
				AGGREGATE SHOULDERS, TYPE B 4"
STATION		LENGTH	WIDTH	TON
BANYAN DRIVE LEFT				
38+00.00	TO	46+75.00	875.00	2
BANYAN DRIVE RIGHT				
38+00.00	TO	39+14.00	114.00	2
40+93.00		41+81.00	88.00	2
43+53.00	TO	46+75.00	322.00	2
AGGREGATE UNDER FENCE				1420.00
<b>TOTAL =</b>				<b>74.9</b>

FENCE				
		CHAIN LINK FENCE, 8' (SPECIAL)	CHAIN LINK GATES (SPECIAL)	CHAIN LINK GATES 8'X5' SINGLE
STATION		LENGTH FOOT	EACH	EACH
PERIMETER FENCE				
39+78.70	TO	40+18.70	40.00	1.00
42+53.30	TO	42+93.30	40.00	1.00
41+85.00				1.00
43+30.00				1.00
<b>TOTAL =</b>		<b>1419.1</b>	<b>2.0</b>	<b>2.0</b>

MIX DESIGNS	
HMA SURFACE	HMA BINDER
PG 64-22	PG 64-22
4.0% @ N50	4.0% @ N50
IL-9.5	IL-19.0
MIX "C"	N/A
QC/QA	QC/QA

**NOTES:**  
 QUANTITIES FOR AGGREGATE BASE REPAIR AND AND PREPARATION OF BASE ARE ASSUMED QUANTITIES AND TO BE USED AT THE DISCRETION OF THE ENGINEER.

PREPARATION OF BASE QUANTITY IN PARKING LOT AREA IS TO REMOVE A 10' WIDE RAMP OF AGGREGATE AT THE EDGE OF THE EXISTING CONCRETE.

MODEL: Default  
 FILE NAME: SubAddressBridgePlans\_CAD:72730 - bridge crew.rvt  
 Plot Improvements: Sh-Schedule.dgn

USER NAME = Default	DESIGNED -	REVISED -	<b>STATE OF ILLINOIS DEPARTMENT OF TRANSPORTATION</b>	<b>SCHEDULE OF QUANTITIES</b>			F.A.U. RTE.	SECTION	COUNTY	TOTAL SHEETS	SHEET NO.
PLOT SCALE = 40,0000 * / in.	DRAWN -	REVISED -					8006	D6 MG-PRKG-FNC 2024	SANGAMON	5	3
PLOT DATE = 3/25/2024	CHECKED -	REVISED -		SCALE: SHEET OF SHEETS STA. TO STA.			CONTRACT NO. 72730				
	DATE -	REVISED -					ILLINOIS FED. AID PROJECT				

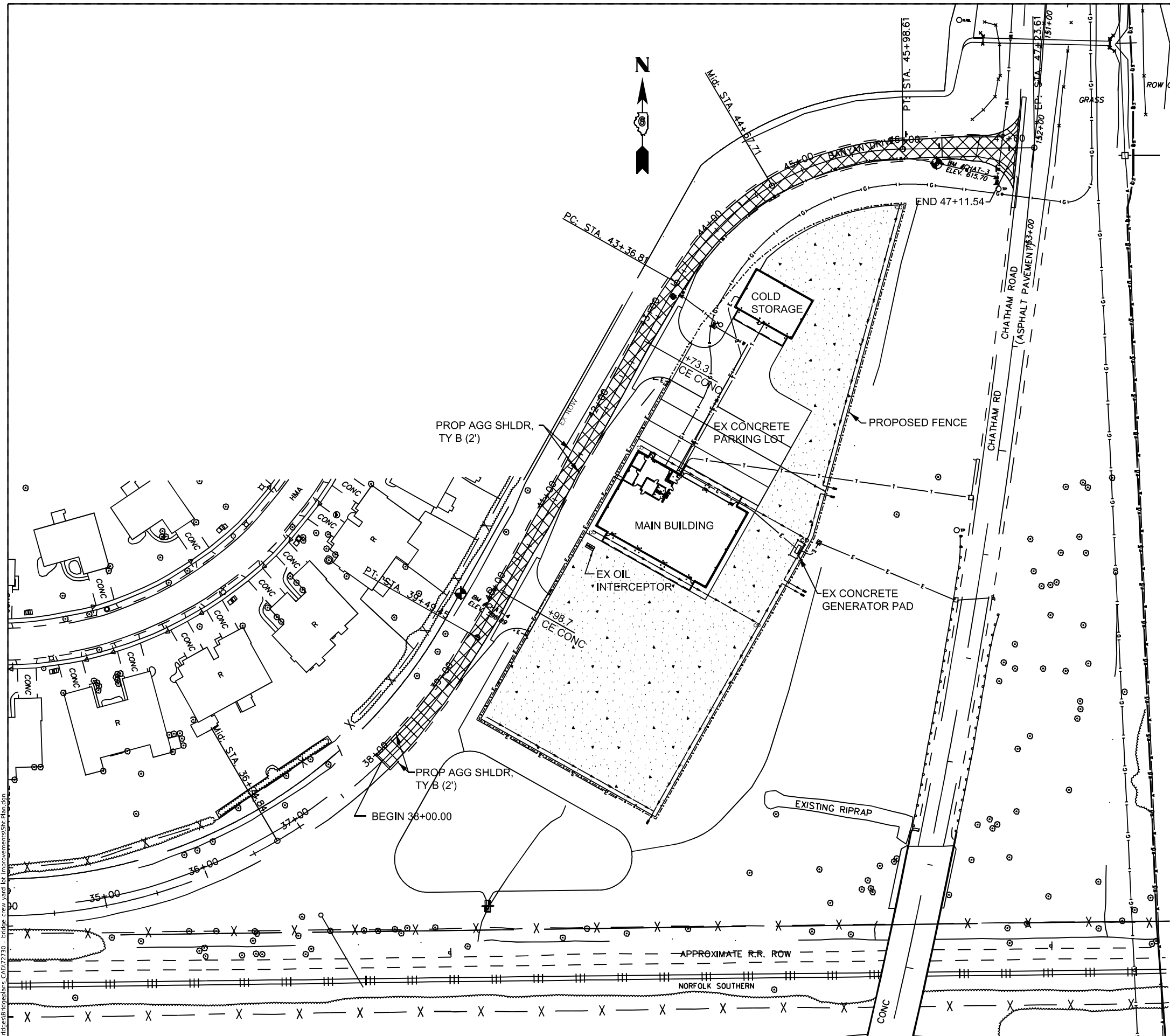

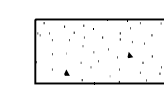
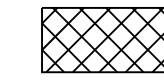
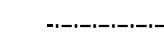
- 
 PROPOSED PARKING LOT PAVEMENT:  
 HOT-MIX ASPHALT SURFACE COURSE, IL-9.5, MIX "C", N50 - 1.5"  
 HOT-MIX ASPHALT BINDER COURSE, IL-19.0, N50 - 2.5"
- 
 PROPOSED ROADWAY PAVEMENT:  
 HOT-MIX ASPHALT SURFACE COURSE, IL-9.5, MIX "C", N50 - 1.5"  
 HOT-MIX ASPHALT BINDER COURSE, IL-19.0, N50 - 2.5"
- 
 PROPOSED CHAIN LINK FENCE, 8' (SPECIAL)

NOTES:  
 NO ADDITIONAL COMPENSATION  
 WILL BE ALLOWED FOR PAVING  
 AROUND EXISTING OIL INTERCEPTOR  
 OR GENERATOR PAD.  
 SEE DETAILS FOR TYPICAL SECTIONS

MODEL: Mechl  
 FILE NAME: S:\Bids\Bids\plan\cadd\72730 - bridge crew\pav\pav\improvements\Shc-dna.dgn

USER NAME = Default	DESIGNED -	REVISED -
	DRAWN -	REVISED -
PLOT SCALE = 98.425 / in.	CHECKED -	REVISED -
PLOT DATE = 3/25/2024	DATE -	REVISED -

**STATE OF ILLINOIS**  
**DEPARTMENT OF TRANSPORTATION**

SCALE:		PLAN SHEET	
		SHEET OF SHEETS	STA. TO STA.

F.A.U. RTE.	SECTION	COUNTY	TOTAL SHEETS	SHEET NO.
8006	D6 MG-PRKG-FNC 2024	SANGAMON	5	4
CONTRACT NO. 72730			ILLINOIS FED. AID PROJECT	

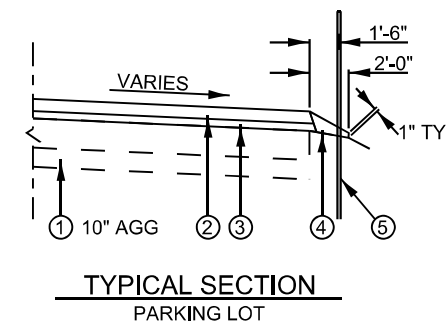
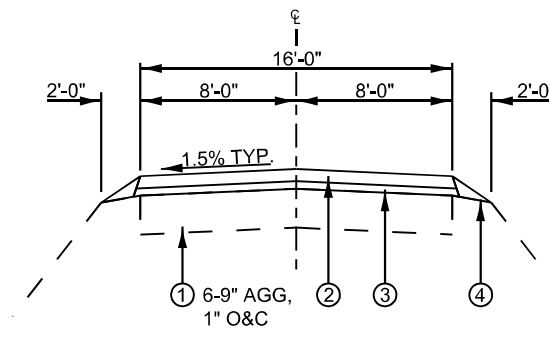
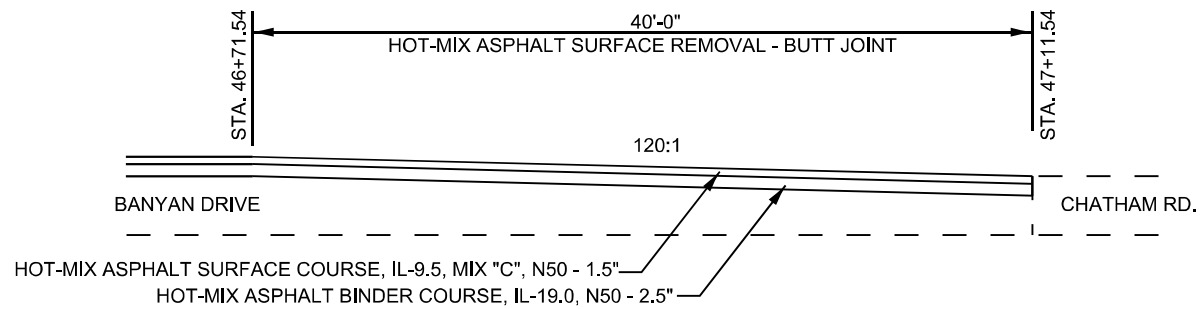
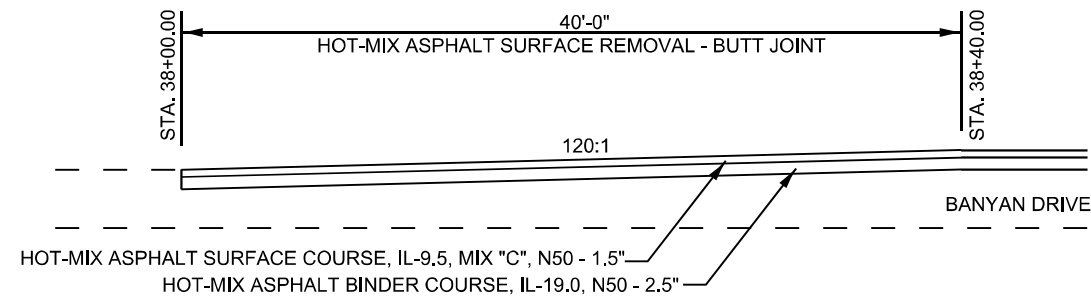
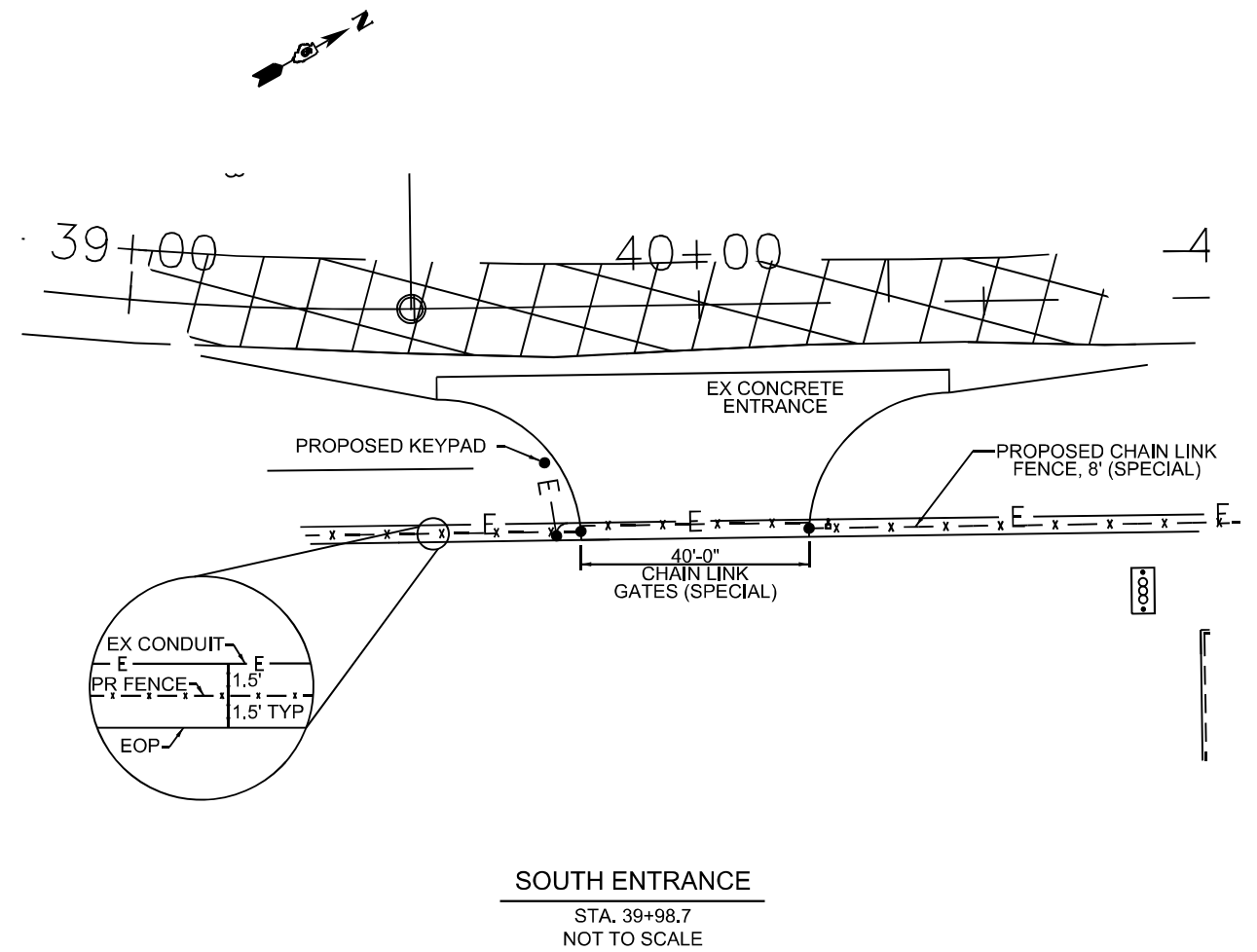
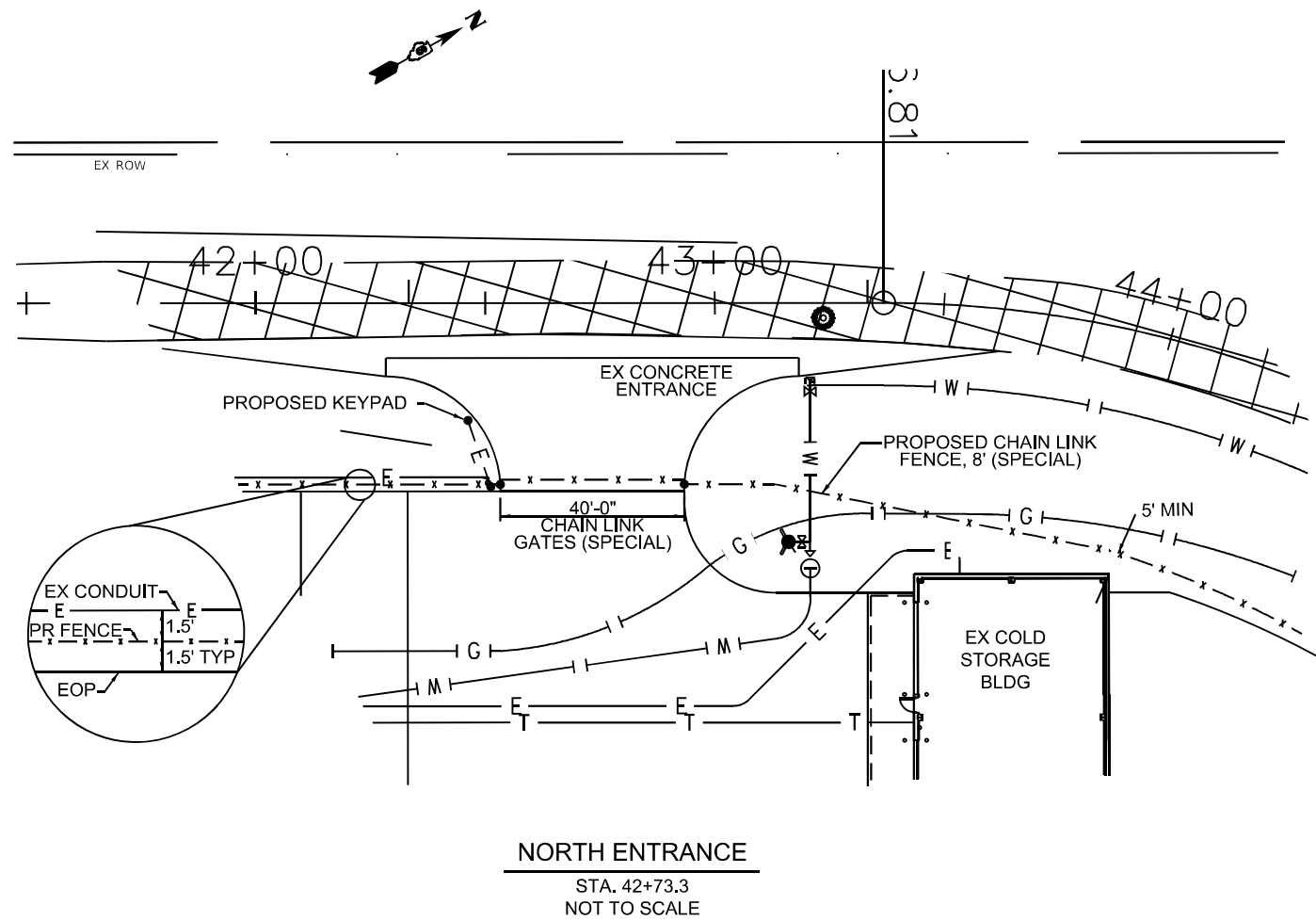

1. EXISTING PAVEMENT
2. HOT-MIX ASPHALT SURFACE COURSE, IL-9.5, MIX "C", N50 - 1.5"
3. HOT-MIX ASPHALT BINDER COURSE, IL-19.0, N50 - 2.5"
4. AGGREGATE SHOULDERS, TYPE B
5. CHAIN LINK FENCE, 8' (SPECIAL)

MODEL: Mechl  
FILE NAME: S:\Bids\Bridges\plans\_CAD\72730 - bridge crew\p2d\improvements\Shc-4ba.dgn

USER NAME = Default	DESIGNED -	REVISED -
	DRAWN -	REVISED -
PLOT SCALE = 98.425 / in.	CHECKED -	REVISED -
PLOT DATE = 2/14/2024	DATE -	REVISED -

**STATE OF ILLINOIS  
DEPARTMENT OF TRANSPORTATION**

**DETAIL SHEET**

SCALE: SHEET OF SHEETS STA. TO STA.

F.A.U. RTE.	SECTION	COUNTY	TOTAL SHEETS	SHEET NO.
8006	D6 MG-PRKG-FNC 2024	SANGAMON	5	5
ILLINOIS FED. AID PROJECT			CONTRACT NO. 72730	