

STATE OF ILLINOIS  
DEPARTMENT OF TRANSPORTATION

F.A.P. RTE.	SECTION	COUNTY	TOTAL SHEETS	SHEET NO.
562	(116B-1)BDR	MORGAN	6	1
		ILLINOIS	CONTRACT NO. 72911	

FOR INDEX OF SHEETS, SEE SHEET NO. 2

# PROPOSED CONTRACT MAINTENANCE

FAP ROUTE 562 (IL 100)  
SECTION (116B-1)BDR  
PROJECT (STATE)  
BRIDGE DECK REPAIRS  
MORGAN COUNTY

C-96-045-24

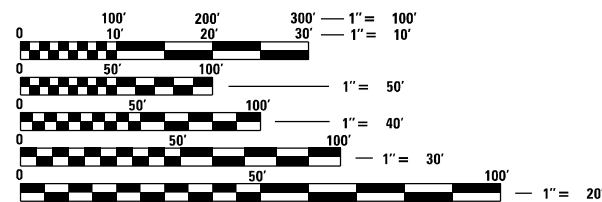
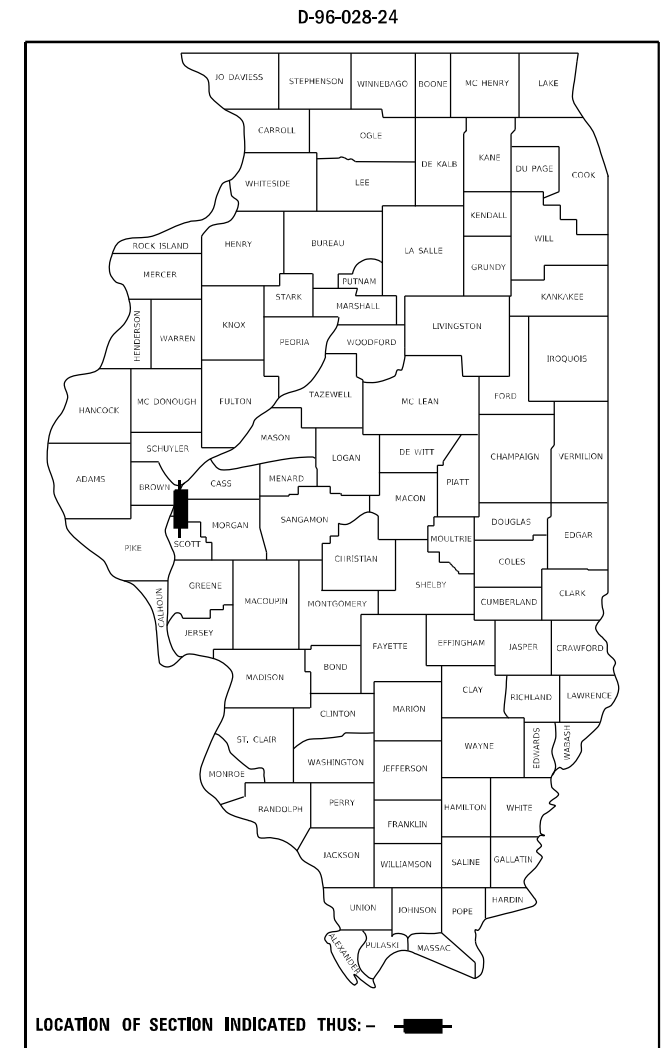

FULL SIZE PLANS HAVE BEEN PREPARED USING STANDARD ENGINEERING SCALES, REDUCED SIZED PLANS WILL NOT CONFORM TO STANDARD SCALES. IN MAKING MEASUREMENTS ON REDUCED PLANS, THE ABOVE SCALES MAY BE USED.

J.U.L.I.E.  
JOINT UTILITY LOCATION INFORMATION FOR EXCAVATORS  
1-800-892-0123  
OR 811

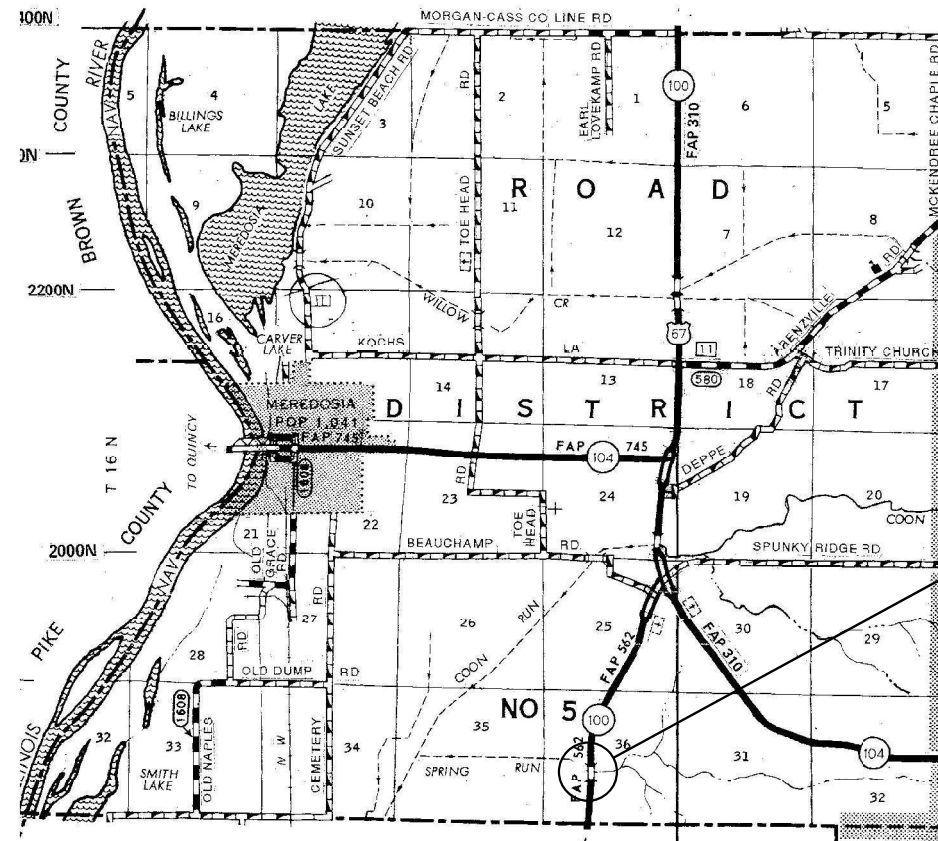

PROJECT LOCATION  
SN 069-0062  
IL 100 EB OVER SPRING RUN  
1.7 MI S US 67

BRIDGE MAINTENANCE ENGINEER: BRANDON DUDLEY - (217) 785-9290

GROSS LENGTH = 136 FT. = 0.03 MILE  
NET LENGTH = 136 FT. = 0.03 MILE

CONTRACT NO. 72911

STATE OF ILLINOIS  
DEPARTMENT OF TRANSPORTATION

SUBMITTED March 26, 2024

*[Signature]*  
REGIONAL ENGINEER

May 10, 2024  
*[Signature]*  
ENGINEER OF DESIGN AND ENVIRONMENT

May 10, 2024  
*[Signature]*  
DIRECTOR OF HIGHWAYS PROJECT IMPLEMENTATION

PRINTED BY THE AUTHORITY  
OF THE STATE OF ILLINOIS

INDEX OF SHEETS

- 1 COVER SHEET
- 2 INDEX, STANDARDS, SIGNATURES, & GENERAL NOTES
- 3 SUMMARY OF QUANTITIES
- 4 STAGING PLAN
- 5-6 BRIDGE PLANS

STANDARDS

- 000001-08
- 001001-02
- 001006
- 701001-02
- 701006-05
- 701301-04
- 701316-13
- 701901-09

GENERAL NOTES:

AREAS OF DECK REPAIRS SHOWN ARE ESTIMATED. THE ENGINEER SHALL SHOW ACTUAL LOCATIONS ON AS-BUILT PLANS.

FULL DEPTH PATCHES SHALL BE COVERED WITH STEEL PLATES WHEN WORKERS ARE NOT PRESENT.

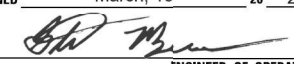
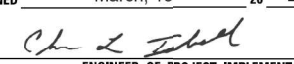
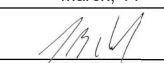
<b>STATE OF ILLINOIS DEPARTMENT OF TRANSPORTATION DIVISION OF HIGHWAYS DISTRICT 6</b>	
EXAMINED	March, 15 20 24
 ENGINEER OF OPERATIONS	
EXAMINED	March, 15 20 24
 ENGINEER OF PROJECT IMPLEMENTATION	
EXAMINED	March, 14 20 24
 ENGINEER OF PROGRAM DEVELOPMENT	

MODEL: Default  
FILE NAME: S:\Roads\Bridges\Bridges\CAD\72911 - 069002 - Patching\abnsheet.dgn

	USER NAME = Brandon.Dudley	DESIGNED -	REVISED -	<b>STATE OF ILLINOIS DEPARTMENT OF TRANSPORTATION</b>	<b>INDEX OF SHEETS, STANDARDS, GENERAL NOTES, &amp; SIGNATURES</b>	SCALE:	SHEET OF SHEETS	STA. TO STA.	F.A.P. RTE.	SECTION	COUNTY	TOTAL SHEETS	SHEET NO.		
		DRAWN -	REVISED -								562	(116B-1)BDR	MORGAN	6	2
	PLOT SCALE = 100,0000 ' / in.	CHECKED -	REVISED -												
	PLOT DATE = 3/19/2024	DATE -	REVISED -												
												CONTRACT NO. 72911			
												ILLINOIS FED. AID PROJECT			

0-02178-6030  
 SN 069-0062  
 100% STATE

CODE NO.	ITEM	UNIT	TOTAL QUANTITY	BRIDGE/RURAL
				0047 MORGAN
50300300	PROTECTIVE COAT	SQ YD	57	57
67100100	MOBILIZATION	L SUM	1	1
70100100	TRAFFIC CONTROL AND PROTECTION, STANDARD 701316	EACH	1	1
70106500	TEMPORARY BRIDGE TRAFFIC SIGNALS	EACH	1	1
70106700	TEMPORARY RUMBLE STRIPS	EACH	6	6
70107025	CHANGEABLE MESSAGE SIGNS	CAL DAY	80	80
X7200201	WIDTH RESTRICTION SIGNING	L SUM	1	1
Z0001800	APPROACH SLAB REPAIR (PARTIAL DEPTH)	SQ YD	18	18
Z0016002	DECK SLAB REPAIR (FULL DEPTH, TYPE II)	SQ YD	5	5
Z0016200	DECK SLAB REPAIR (PARTIAL)	SQ YD	34	34
Z0032500	JOINT SEALING (PATCHES)	FOOT	700	700

MODEL Path: \\s:\address\Bridges\Bridges\CAD\72911 - 0690062 - Patching\Bridgesheet.dgn  
 FILE NAME: \\s:\address\Bridges\Bridges\CAD\72911 - 0690062 - Patching\Bridgesheet.dgn

USER NAME = Brandon.Dudley	DESIGNED -	REVISED -
PLOT SCALE = 100,0000' / in.	DRAWN -	REVISED -
PLOT DATE = 3/19/2024	CHECKED -	REVISED -
	DATE -	REVISED -

**STATE OF ILLINOIS**  
**DEPARTMENT OF TRANSPORTATION**

SUMMARY OF QUANTITIES			
SCALE:	SHEET	OF	SHEETS

F.A.P. RTE.	SECTION	COUNTY	TOTAL SHEETS	SHEET NO.
562	(116B-1)BDR	MORGAN	6	3
CONTRACT NO. 72911				
ILLINOIS FED. AID PROJECT				

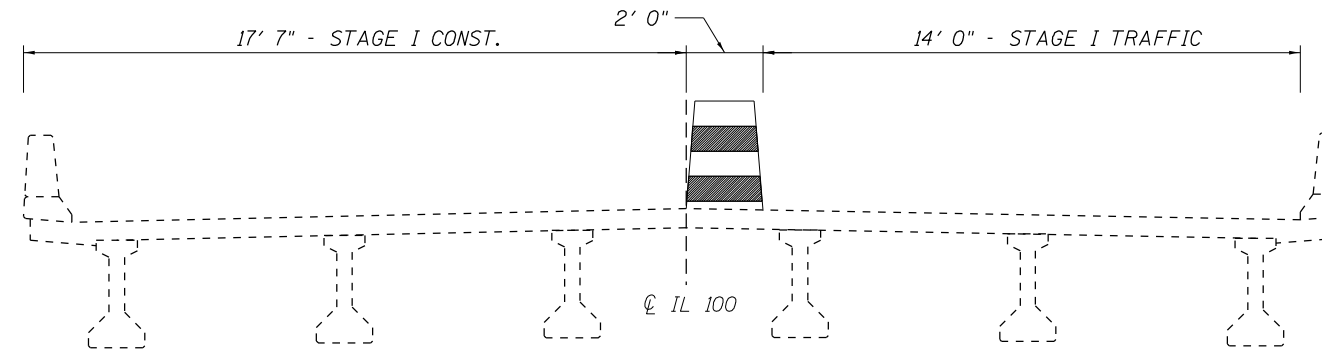

**STAGE I TRAFFIC - LOOKING SOUTH**

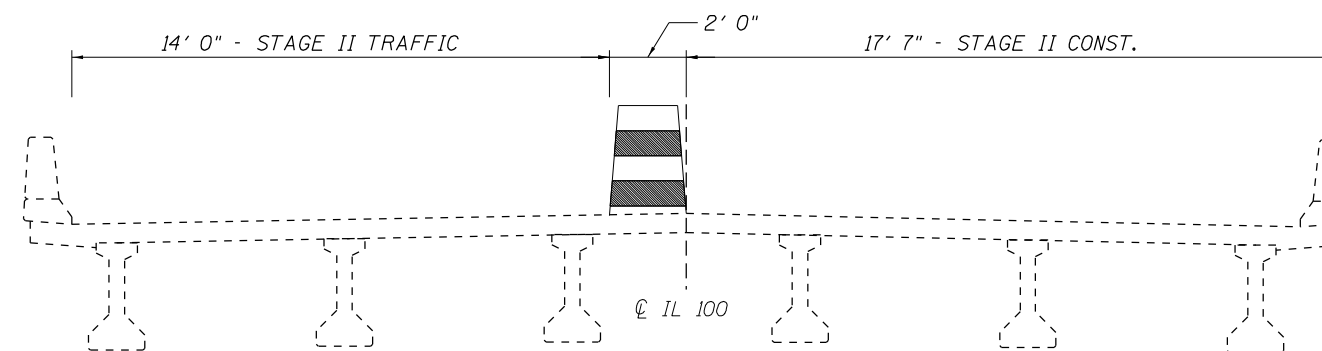

**STAGE II TRAFFIC - LOOKING SOUTH**

MODEL: Default  
 FILE NAME: S:\Bids\Bids\Bids\Bids\CAD\72911 - 06900E2\_batching\batchsheet.dgn

USER NAME = Brandon.Dudley	DESIGNED -	REVISED -
	DRAWN -	REVISED -
PLOT SCALE = 100,0000' / in.	CHECKED -	REVISED -
PLOT DATE = 3/19/2024	DATE -	REVISED -

**STATE OF ILLINOIS**  
**DEPARTMENT OF TRANSPORTATION**

TRAFFIC STAGING PLAN			
SCALE:	SHEET	OF	SHEETS
	STA.		TO STA.

F.A.P. RTE.	SECTION	COUNTY	TOTAL SHEETS	SHEET NO.
562	(116B-1)BDR	MORGAN	6	4
CONTRACT NO. 72911			ILLINOIS FED. AID PROJECT	

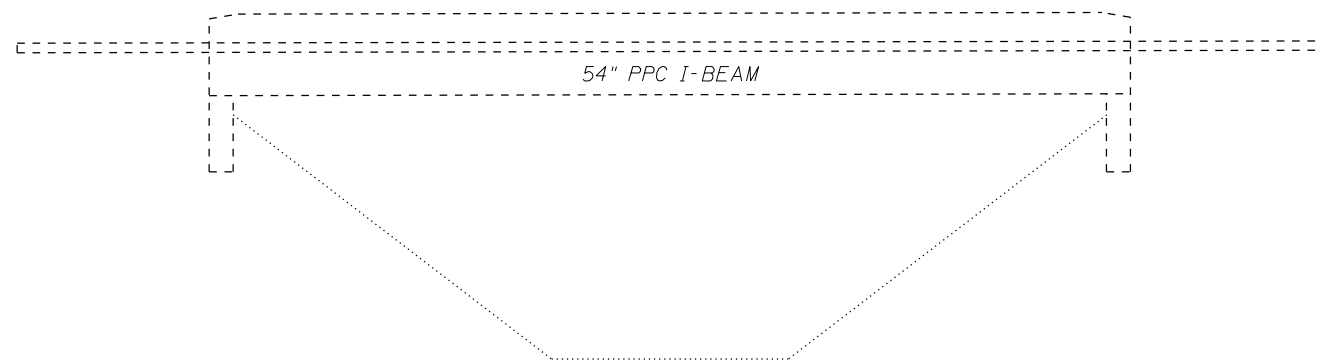

**ELEVATION**

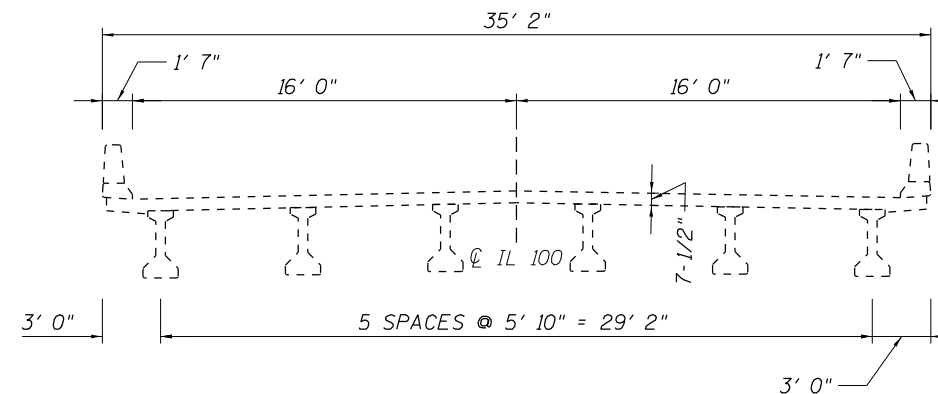

**CROSS SECTION**

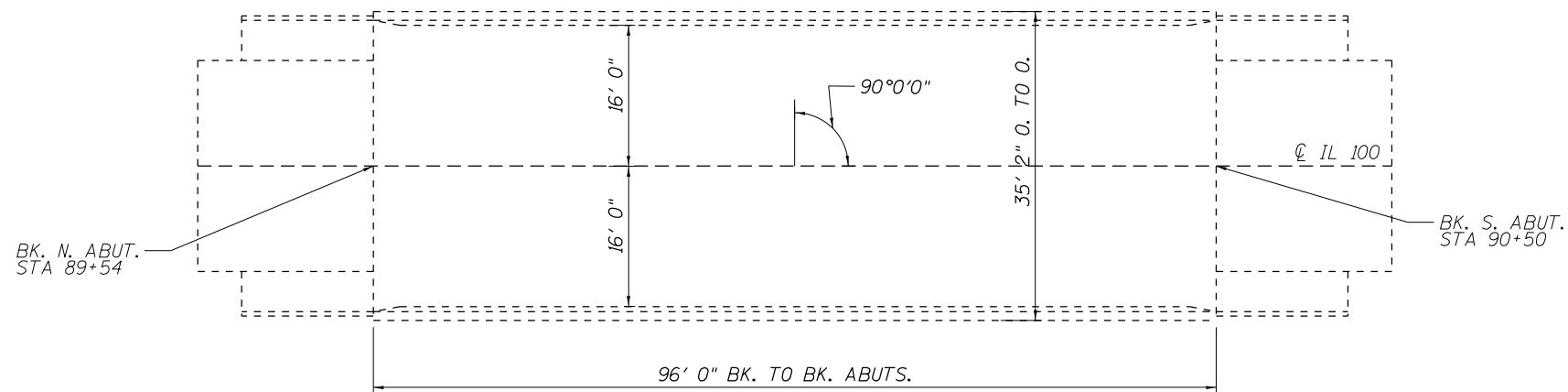

**PLAN**

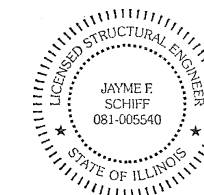

EXPIRES 11-30-2024

*Jayme F. Schiff*

**STRUCTURE GENERAL NOTES:**

PRIOR TO POURING THE NEW CONCRETE PATCHES, ALL HEAVY OR LOOSE MILL SCALE AND OTHER LOOSE OR POTENTIALLY DETRIMENTAL FOREIGN MATERIAL SHALL BE REMOVED FROM THE SURFACES IN CONTACT WITH CONCRETE. TIGHTLY ADHERED PAINT MAY REMAIN UNLESS OTHERWISE NOTED. REMOVAL SHALL BE ACCOMPLISHED BY METHODS THAT WILL NOT DAMAGE THE STEEL AND THE COST WILL BE INCLUDED IN CONCRETE REMOVAL.

PLAN DIMENSIONS AND DETAILS RELATIVE TO THE EXISTING STRUCTURE HAVE BEEN TAKEN FROM EXISTING PLANS ARE SUBJECT TO NOMINAL CONSTRUCTION VARIATIONS. THE CONTRACTOR SHALL FIELD VERIFY EXISTING DIMENSIONS AND DETAILS AFFECTING NEW CONSTRUCTION AND MAKE NECESSARY APPROVED ADJUSTMENTS PRIOR TO CONSTRUCTION OR ORDERING OF MATERIALS. SUCH VARIATIONS SHALL NOT BE CAUSE FOR ADDITIONAL COMPENSATION FOR A CHANGE IN THE SCOPE OF WORK, HOWEVER, THE CONTRACTOR WILL BE PAID FOR THE QUANTITY ACTUALLY FURNISHED AT THE UNIT PRICE BID FOR THE WORK.

EXISTING REINFORCEMENT BARS EXTENDING INTO THE REMOVAL AREA SHALL BE CLEANED, STRAIGHTENED, AND INCORPORATED INTO THE NEW CONSTRUCTION. ANY REINFORCEMENT BARS THAT ARE DAMAGED DURING CONCRETE REMOVAL SHALL BE REPLACED WITH AN APPROVED BAR SPLICER OR ANCHORAGE SYSTEM. COST INCLUDED WITH CONCRETE REMOVAL.

PROTECTIVE COAT SHALL BE APPLIED TO NEW CONCRETE ONLY.

**TOTAL BILL OF MATERIAL (SN 069-0062)**

ITEM	UNIT	QUANTITY
Deck Slab Repair (Partial)	Sq. Yd.	34
Approach Slab Repair (Partial Depth)	Sq. Yd.	18
Deck Slab Repair (Full Depth, Type II)	Sq. Yd.	5*
Joint Sealing (Patches)	Foot	700
Protective Coat	Sq. Yd.	57

\* estimated quantity

MODEL: D:\p\h\... FILE NAME: S:\Addresses\Bridges\bars\_CAD\72911\_0690062\_patch\brnarcheck.dgn

USER NAME = Brandon.Dudley	DESIGNED - BRANDON DUDLEY	REVISED -
	DRAWN - BRANDON DUDLEY	REVISED -
PLOT SCALE = 100,0000' / in.	CHECKED -	REVISED -
PLOT DATE = 3/26/2024	DATE - 1/8/2024	REVISED -

**STATE OF ILLINOIS  
DEPARTMENT OF TRANSPORTATION**

**BRIDGE PLAN & ELEVATION  
SN 069-0062**

SCALE: SHEET 1 OF 2 SHEETS STA. TO STA.

F.A.P. RTE.	SECTION	COUNTY	TOTAL SHEETS	SHEET NO.
562	(116B-1)BDR	MORGAN	6	5
			CONTRACT NO. 72911	
ILLINOIS FED. AID PROJECT				

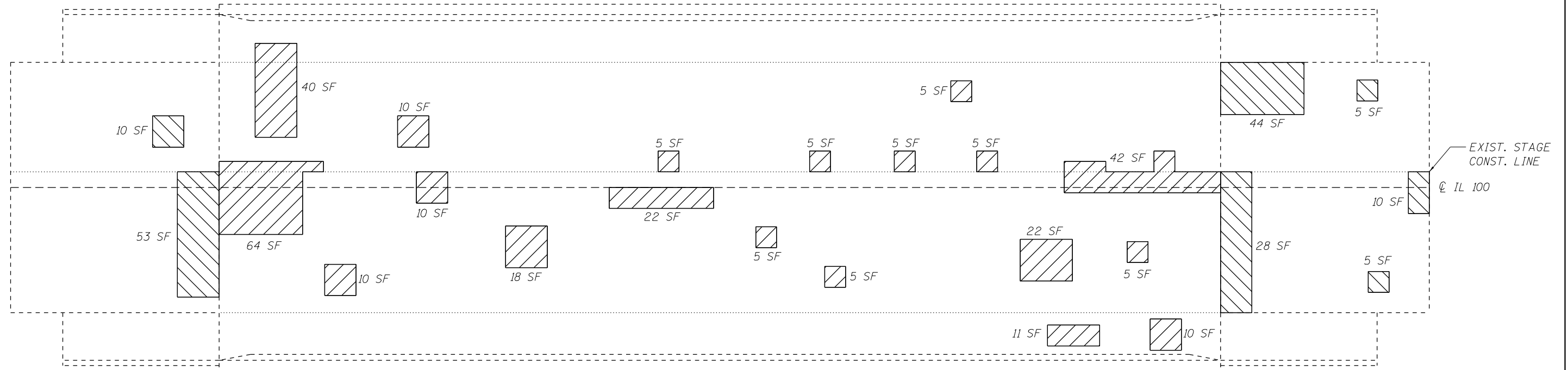

**PLAN**

**PATCHING BILL OF MATERIAL**

ITEM	UNIT	QUANTITY
Deck Slab Repair (Partial)	Sq. Yd.	34
Approach Slab Repair (Partial Depth)	Sq. Yd.	18
Deck Slab Repair (Full Depth, Type II) *	Sq. Yd.	5*
Joint Sealing (Patches)	Foot	700

\* No FD patches anticipated, nominal quantity included

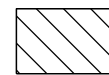

APPROACH SLAB REPAIR (PARTIAL DEPTH)



DECK SLAB REPAIR (PARTIAL)

**NOTES:**

IDENTIFIED PATCHING LOCATIONS ARE ESTIMATED FROM A DECK SURVEY PERFORMED ON 11/1/2022. THE PATCHING SURVEY IS INCLUDED FOR INFORMATION ONLY. THE ENGINEER SHALL LAY OUT ACTUAL PATCH LOCATIONS IN THE FIELD.

THE ENGINEER SHALL SHOW ACTUAL LOCATIONS OF DECK REPAIRS ON AS-BUILT PLANS.

IF FULL DEPTH PATCHES ARE DISCOVERED, THEY SHALL BE COVERED WITH STEEL PLATES DURING NON-WORK HOURS.

JOINT SEALING (PATCHES) SHALL BE APPLIED IN LOCATIONS AS DIRECTED IN THE SPECIAL PROVISIONS, ALONG THE ENTIRE LENGTH OF ANY EXISTING STAGE CONSTRUCTION LINES, AND ALONG THE CONSTRUCTION JOINTS BETWEEN THE ABUTMENT AND APPROACHES.

MODEL: Default  
FILE NAME: S:\Addresses\Bridges\BDR\_CAD\72911 - 069062 Patching\plan sheet.dgn

USER NAME = Brandon.Dudley	DESIGNED -	REVISED -
PLOT SCALE = 100,0000' / in.	DRAWN -	REVISED -
PLOT DATE = 3/19/2024	CHECKED -	REVISED -
	DATE -	REVISED -

**STATE OF ILLINOIS  
DEPARTMENT OF TRANSPORTATION**

**BRIDGE PLAN & ELEVATION  
SN 069-0062**

SCALE: SHEET 2 OF 2 SHEETS STA. TO STA.

F.A.P. RTE.	SECTION	COUNTY	TOTAL SHEETS	SHEET NO.
562	(116B-1)BDR	MORGAN	6	6
ILLINOIS FED. AID PROJECT			CONTRACT NO. 72911	