

STATE OF ILLINOIS
DEPARTMENT OF TRANSPORTATION

| F.A. RTE. | SECTION | COUNTY | TOTAL SHEETS | SHEET NO. |
|-----------|--------------------|------------|--------------|--------------------|
| FAP828 | (108,109,110) RS-4 | CUMBERLAND | 27 | 1 |
| | | ILLINOIS | | CONTRACT NO. 74C42 |

FOR INDEX OF SHEETS, SEE SHEET NO. 2

ADT 3063 (2023)

STATION EQUATION
0+00 BK = 6+08 AH
215+45.68 BK = 215+50 AH

PROPOSED HIGHWAY PLANS

FAP ROUTE 828 (ILL 121)
SECTION (108, 109, 110) RS-4
PROJECT STP-D72V(574)
SMART OVERLAY
CUMBERLAND COUNTY

D-97-085-23

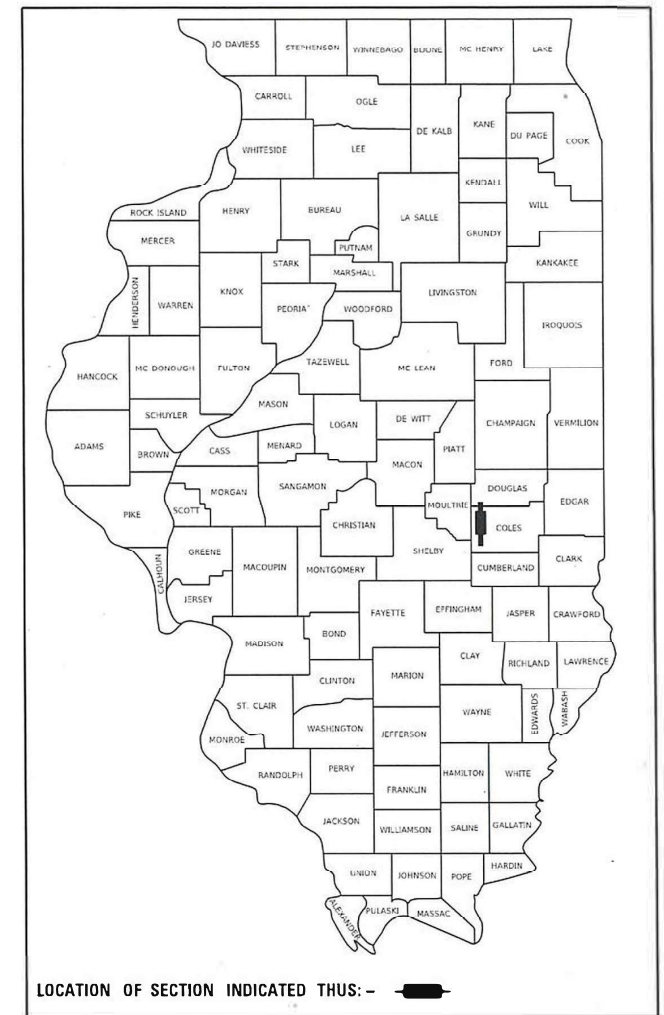

RAILROAD OMISSION
STA 6+08 TO STA 6+20

BRIDGE OMISSION
STA 154+89 TO STA 155+95

BRIDGE OMISSION
STA 231+47 TO STA 233+93

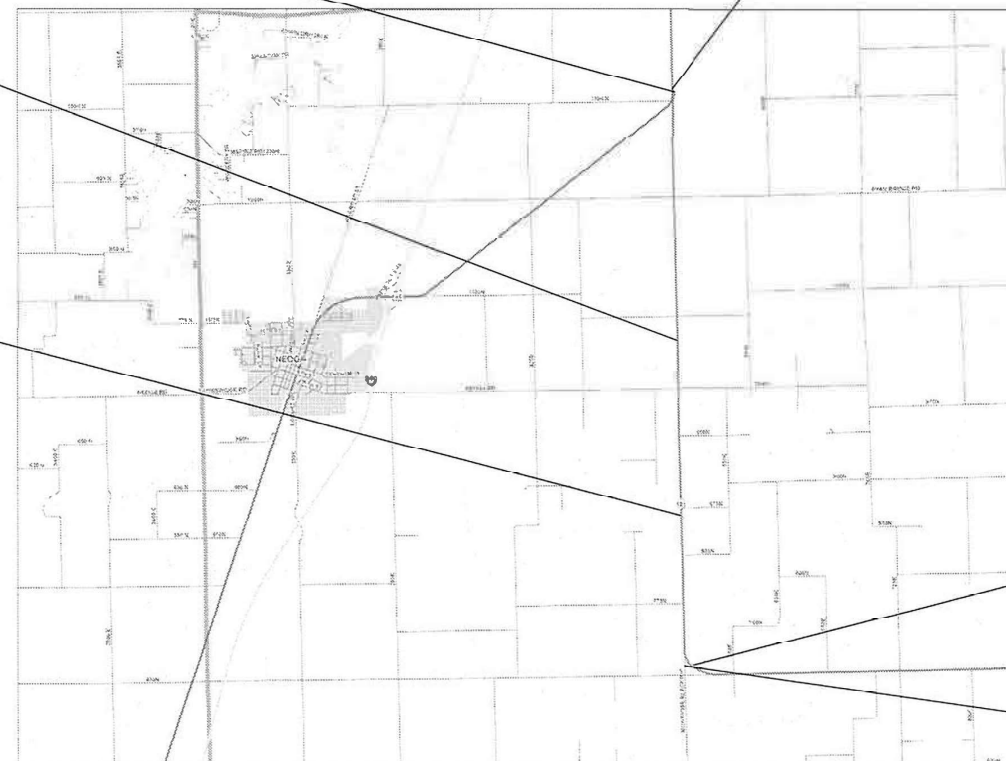

C-97-116-23

PROJECT BEGINS
STA 7+94

PROJECT ENDS
STA 313+00
(ILL 121)

PROJECT ENDS
STA 105+00
(SOUTH LEG)

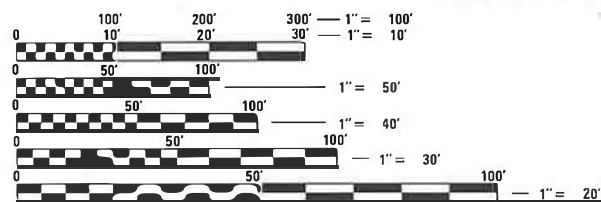

FULL SIZE PLANS HAVE BEEN PREPARED USING STANDARD ENGINEERING SCALES. REDUCED SIZED PLANS WILL NOT CONFORM TO STANDARD SCALES. IN MAKING MEASUREMENTS ON REDUCED PLANS, THE ABOVE SCALES MAY BE USED.

J.U.L.I.E.
JOINT UTILITY LOCATION INFORMATION FOR EXCAVATORS
1-800-892-0123
OR 811

PROJECT ENGINEER- BRIAN LEWIS
PROJECT MANAGER- JACKIE WILLENBURG

CONTRACT NO. 74C42

GROSS LENGTH = 31099.2 FT. = 5.89 MILE
NET LENGTH = 30747.2 FT. = 5.82 MILE

STATE OF ILLINOIS
DEPARTMENT OF TRANSPORTATION

SUBMITTED March 21 2024
Jeffrey P. Myrals REGIONAL ENGINEER
May 10, 2024 [Signature]
ENGINEER OF DESIGN AND ENVIRONMENT
May 10, 2024 [Signature]
DIRECTOR OF HIGHWAYS PROJECT IMPLEMENTATION

PRINTED BY THE AUTHORITY
OF THE STATE OF ILLINOIS

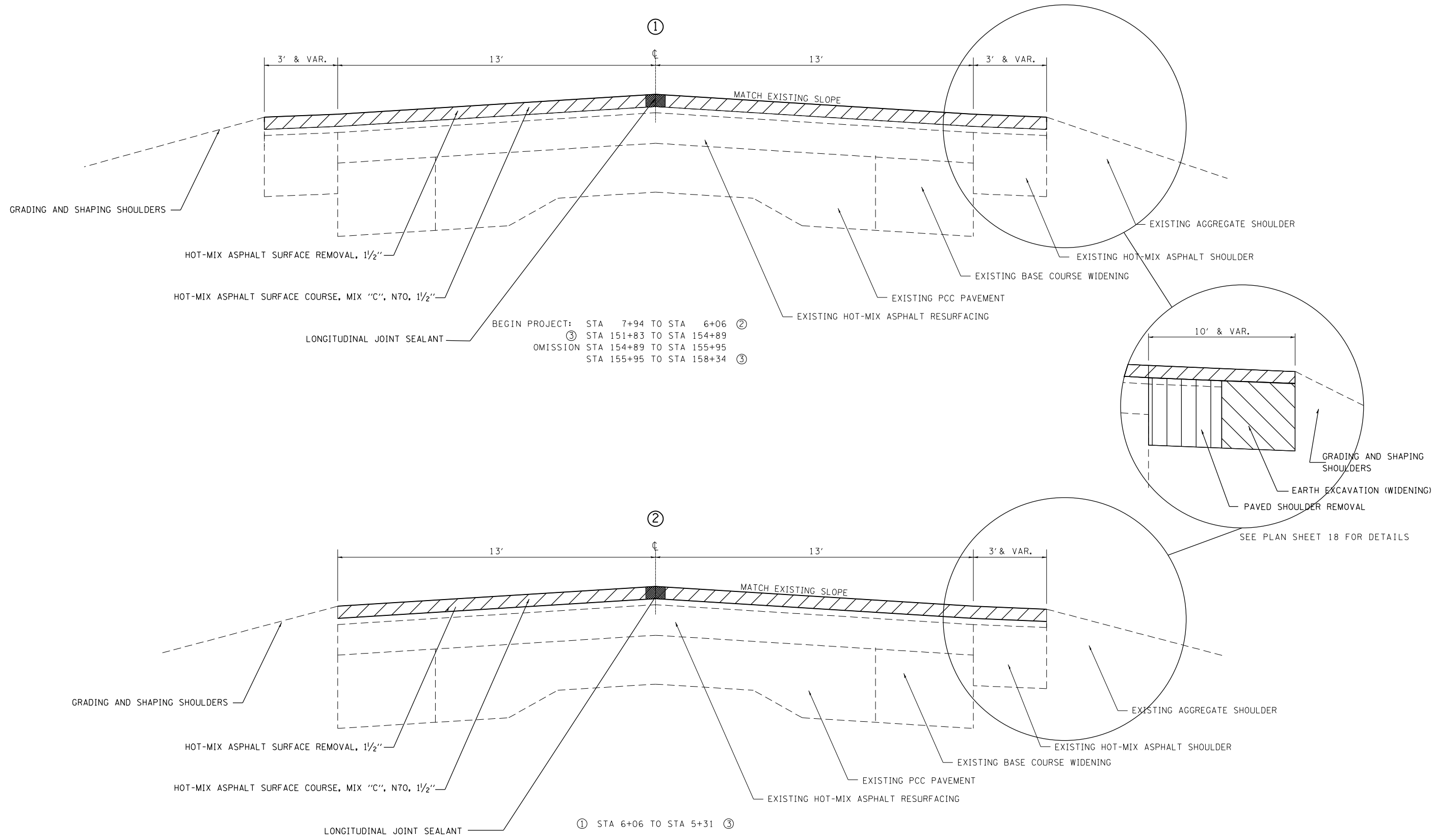

NOTE: NOT TO SCALE

MODEL: Default
 FILE: \\blmfc-pw\uldr-pw\bead\p\com\PIV\DOT\Documents\DOT\Office\Dir\dr_7\Project\74C42\CADD\Drawings\74C42-shr-tp\18-18.dwg

| | | |
|------------------------------|------------|-----------|
| USER NAME = jessica.hille | DESIGNED - | REVISED - |
| | DRAWN - | REVISED - |
| PLOT SCALE = 100,0000' / in. | CHECKED - | REVISED - |
| PLOT DATE = 3/21/2024 | DATE - | REVISED - |

**STATE OF ILLINOIS
DEPARTMENT OF TRANSPORTATION**

| | | | | |
|------------------------|-------|----|--------|--------------|
| TYPICAL SECTION | | | | |
| SCALE: | SHEET | OF | SHEETS | STA. TO STA. |

| | | | | |
|--------------------|-------------------|------------|------------------|-----------|
| F.A.P. RTE. | SECTION | COUNTY | TOTAL SHEETS | SHEET NO. |
| 828 | (108,109,110)RS-4 | CUMBERLAND | 27 | 5 |
| CONTRACT NO. 74C42 | | | | |
| | | ILLINOIS | FED. AID PROJECT | |

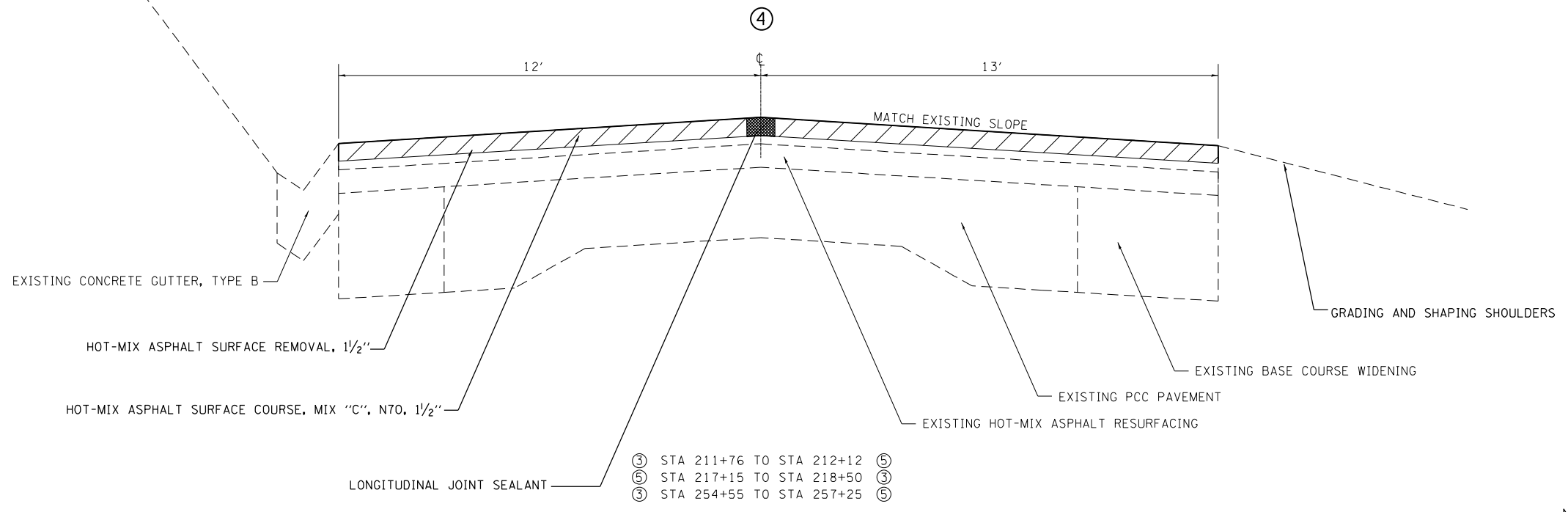
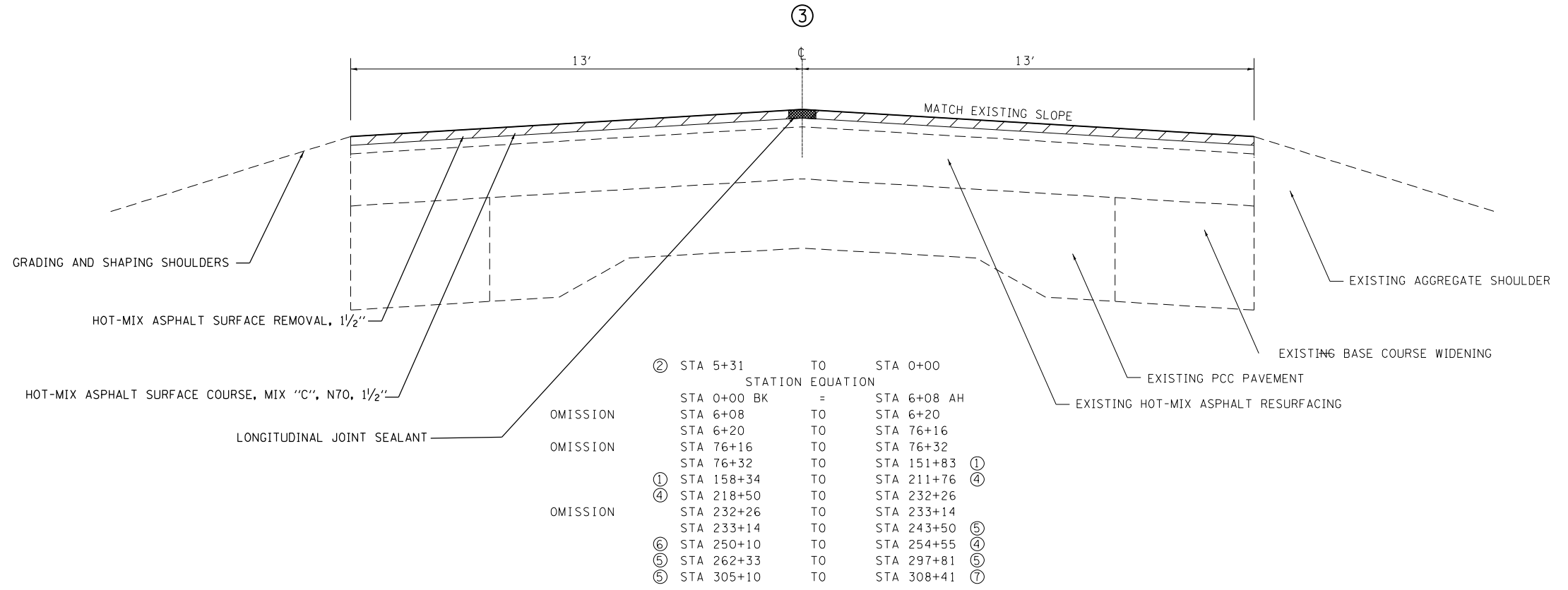

NOTE: NOT TO SCALE

MODEL: Default
FILE: h:\m\c... \subect-aw-bead-fay.com\PIV\DOT\Documents\DOT Office\Director_7\Project\74C42\CADDData\CAD\Sheet\74C42-shr-jpic1-k.dgn

| | | |
|------------------------------|------------|-----------|
| USER NAME = jessica.hille | DESIGNED - | REVISED - |
| | DRAWN - | REVISED - |
| PLOT SCALE = 100,0000' / in. | CHECKED - | REVISED - |
| PLOT DATE = 3/21/2024 | DATE - | REVISED - |

**STATE OF ILLINOIS
DEPARTMENT OF TRANSPORTATION**

TYPICAL SECTION

SCALE: SHEET OF SHEETS STA. TO STA.

| F.A.P. RTE. | SECTION | COUNTY | TOTAL SHEETS | SHEET NO. |
|---------------------------|-------------------|------------|--------------|-----------|
| 828 | (108,109,110)RS-4 | CUMBERLAND | 27 | 6 |
| CONTRACT NO. 74C42 | | | | |
| ILLINOIS FED. AID PROJECT | | | | |

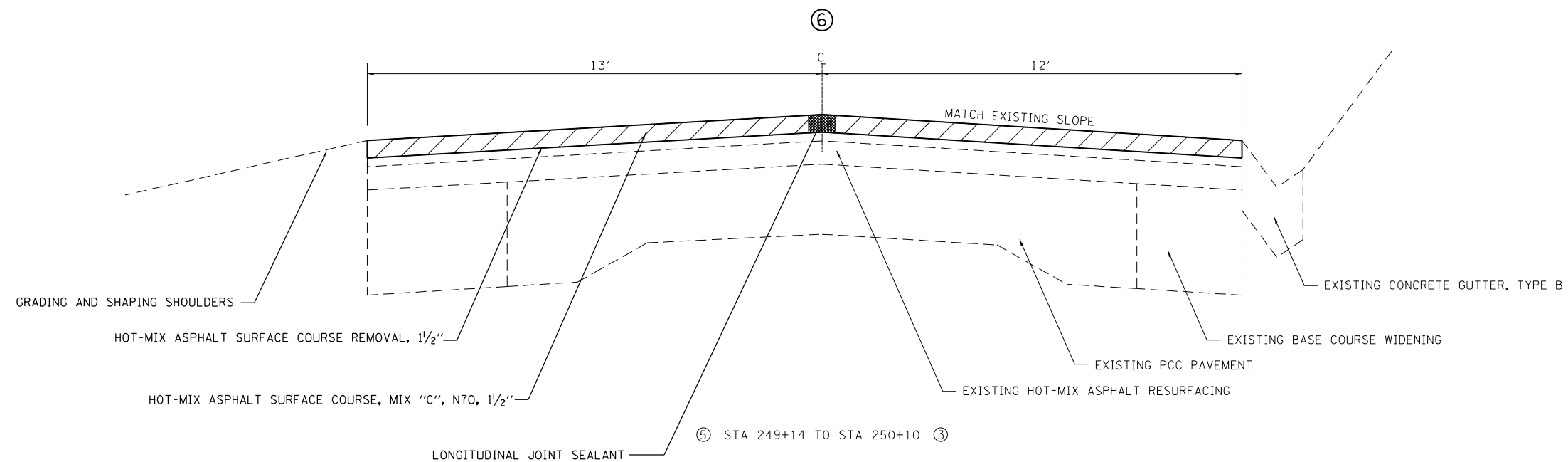
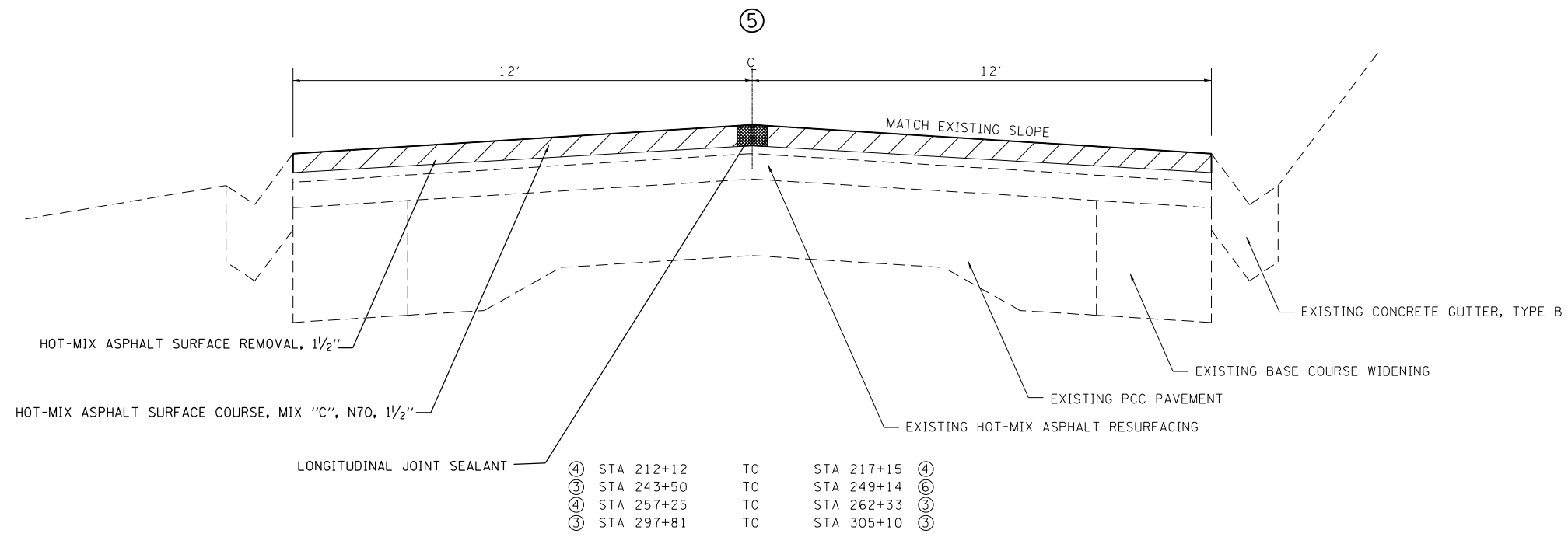

NOTE: NOT TO SCALE

MODEL: Default
 FILE: \\malfp-pls\ultra-cw-beadley.com\FW\DOT\Documents\DOT Office\District 7\Projects\7AC13\CADDData\CAD\Sheet\74C42-shr-typrict.kxdm

| | | |
|------------------------------|------------|-----------|
| USER NAME = jessica.hille | DESIGNED - | REVISED - |
| | DRAWN - | REVISED - |
| PLOT SCALE = 100,0000' / in. | CHECKED - | REVISED - |
| PLOT DATE = 3/21/2024 | DATE - | REVISED - |

**STATE OF ILLINOIS
DEPARTMENT OF TRANSPORTATION**

| TYPICAL SECTIONS | | | |
|------------------|-------|-----------|--------------|
| SCALE: | SHEET | OF SHEETS | STA. TO STA. |

| F.A.P. RTE. | SECTION | COUNTY | TOTAL SHEETS | SHEET NO. |
|---------------------------|-------------------|------------|--------------|-----------|
| 828 | (108,109,110)RS-4 | CUMBERLAND | 27 | 7 |
| CONTRACT NO. 74C42 | | | | |
| ILLINOIS FED. AID PROJECT | | | | |

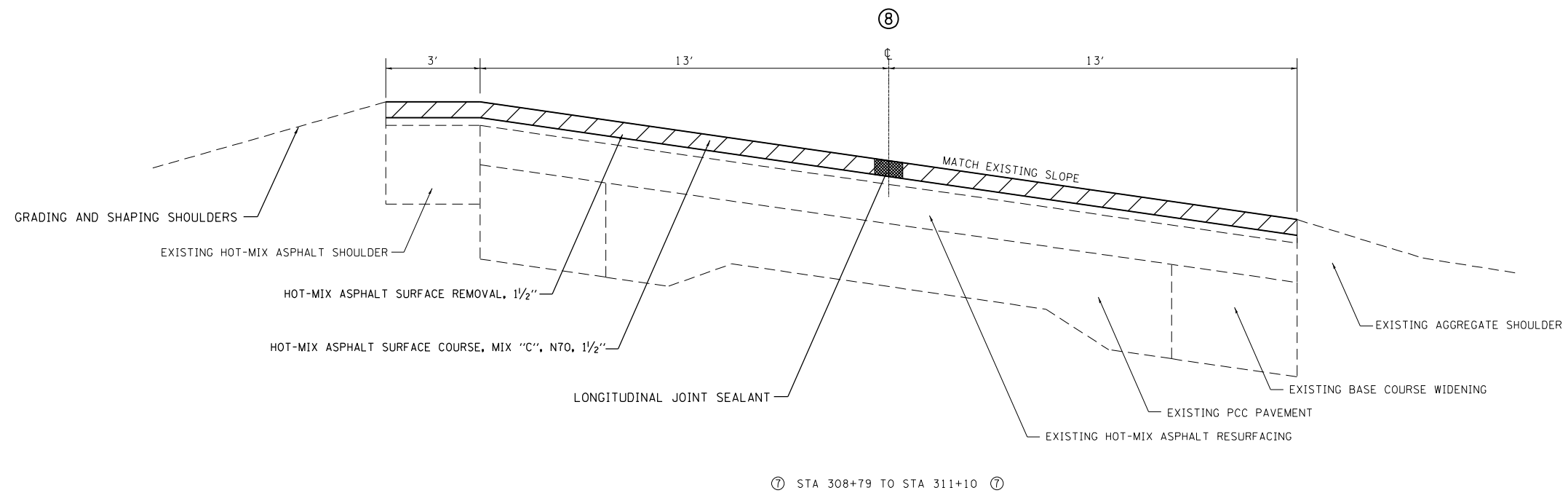
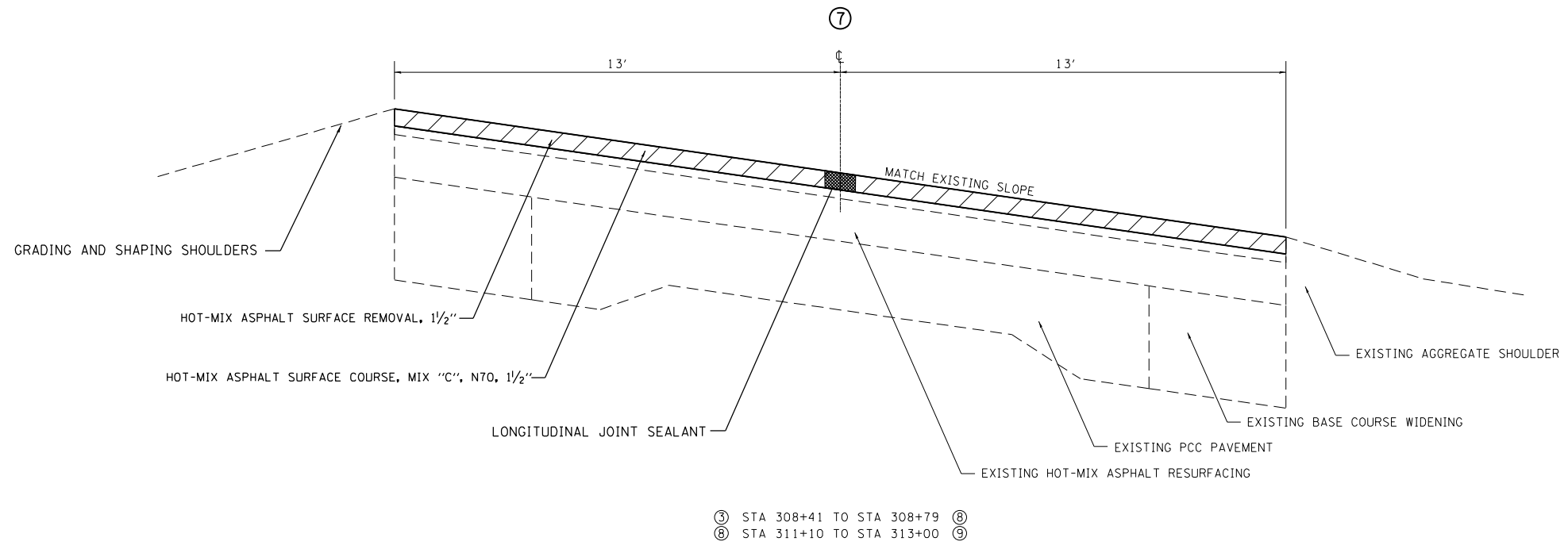

NOTE: NOT TO SCALE

MODEL: Default
FILE: \\MAILSrv\pub\lucast-pw\bea\paw.com\PIV\DOT\Documents\DOT Office\District 7\Projects\74C42\CADDData\CAD\Sheet\74C42-shr-jpl\174c42.dgn

| | | |
|------------------------------|------------|-----------|
| USER NAME = jessica.hille | DESIGNED - | REVISED - |
| | DRAWN - | REVISED - |
| PLOT SCALE = 100,0000' / in. | CHECKED - | REVISED - |
| PLOT DATE = 3/21/2024 | DATE - | REVISED - |

**STATE OF ILLINOIS
DEPARTMENT OF TRANSPORTATION**

TYPICAL SECTIONS

SCALE: SHEET OF SHEETS STA. TO STA.

| F.A.P. RTE. | SECTION | COUNTY | TOTAL SHEETS | SHEET NO. |
|---------------------------|-------------------|------------|--------------|-----------|
| 828 | (108,109,110)RS-4 | CUMBERLAND | 27 | 8 |
| CONTRACT NO. 74C42 | | | | |
| ILLINOIS FED. AID PROJECT | | | | |

| RESURFACING SCHEDULE | | | | | | | | | | | |
|----------------------|----|-----------------------|----------------|---------|--------|----------------------------------|----------------------------|----------------|---|---|-------|
| | | LENGTH | PAVEMENT WIDTH | AREA | AREA | BITUMINOUS MATERIALS (TACK COAT) | LONGITUDINAL JOINT SEALANT | TEMPORARY RAMP | HOT-MIX ASPHALT SURFACE COURSE, IL-9.5,MIX"C",N70 | HOT-MIX ASPHALT SURFACE REMOVAL, 1 1/2" | |
| STATION | TO | STATION | FEET | FEET | SQ FT | SQ YD | POUND | FEET | SQ YD | TON | SQ YD |
| 7+94 | | 6+06 | 188 | 38 | 7144 | 794 | 357 | 188 | 13 | 67 | 794 |
| 6+06 | | 5+31 | 75 | 32 | 2400 | 267 | 120 | 75 | | 22 | 267 |
| 5+31 | | 0+00 | 531 | 26 | 13806 | 1534 | 690 | 531 | | 129 | 1534 |
| 0+00 | = | 6+08 | - | | | | | | | | |
| 6+08 | | 6+20 | 12 | | | | | | | | |
| 6+20 | | 151+83 | 14563 | 26 | 378638 | 42071 | 18932 | 14563 | 13 | 3534 | 42071 |
| 151+83 | | 154+89 | 306 | 32 | 9792 | 1088 | 490 | 306 | 13 | 91 | 1088 |
| 154+89 | | 155+95 | 106 | | | | | | | | |
| 155+95 | | 158+34 | 239 | 32 | 7648 | 850 | 382 | 239 | 13 | 71 | 850 |
| 158+34 | | 211+76 | 5342 | 26 | 138892 | 15432 | 6945 | 5342 | | 1296 | 15432 |
| 211+76 | | 212+12 | 36 | 25 | 900 | 100 | 45 | 36 | | 8 | 100 |
| 212+12 | | 215+46 | 334 | 24 | 8016 | 891 | 401 | 334 | | 75 | 891 |
| 215+46 | | 215+50 | 4 | | | | | | | | |
| 215+50 | | 217+15 | 165 | 24 | 3960 | 440 | 198 | 165 | | 37 | 440 |
| 217+15 | | 218+50 | 135 | 25 | 3375 | 375 | 169 | 135 | | 32 | 375 |
| 218+50 | | 232+26 | 1376 | 26 | 35776 | 3975 | 1843 | 1406 | 13 | 345 | 3975 |
| 232+26 | | 233+14 | 88 | | | | | | | | |
| 233+14 | | 243+50 | 1036 | 26 | 26936 | 2993 | 1347 | 1036 | 13 | 251 | 2993 |
| 243+50 | | 249+14 | 564 | 24 | 13536 | 1504 | 677 | 564 | | 126 | 1504 |
| 249+14 | | 250+10 | 96 | 25 | 2400 | 267 | 120 | 96 | | 22 | 267 |
| 250+10 | | 254+55 | 445 | 26 | 11570 | 1286 | 579 | 445 | | 108 | 1286 |
| 254+55 | | 257+25 | 270 | 25 | 6750 | 750 | 338 | 270 | | 63 | 750 |
| 257+25 | | 262+33 | 508 | 24 | 12192 | 1355 | 610 | 508 | | 114 | 1355 |
| 262+33 | | 297+81 | 3548 | 26 | 92248 | 10250 | 4612 | 3548 | | 861 | 10250 |
| 297+81 | | 305+10 | 729 | 24 | 17496 | 1944 | 875 | 729 | | 163 | 1944 |
| 305+10 | | 308+41 | 331 | 26 | 8606 | 956 | 430 | 331 | | 80 | 956 |
| 308+41 | | 121/MONTROSE BLKTOP Y | | VAR. | 19474 | 2164 | 974 | 1061 | 13 | 182 | 2164 |
| | | | | TOTAL = | 821555 | 91284 | 41132 | 31908 | 93 | 7679 | 91284 |

LJS FOR CENTERLINE AND ALL JOINTS

MODEL: Default
 FILE: \\malfp-pw-bentley.com\PW\DOT\Documents\DOT Office\Dir\dir_7\Project\7AC13\CADDData\CAD\Sheet\7AC13-2-Sub-schedule.dgn

| | | |
|-------------------------------|------------|-----------|
| USER NAME = jessica.hille | DESIGNED - | REVISED - |
| | DRAWN - | REVISED - |
| PLOT SCALE = 100,0000 ' / in. | CHECKED - | REVISED - |
| PLOT DATE = 3/21/2024 | DATE - | REVISED - |

**STATE OF ILLINOIS
DEPARTMENT OF TRANSPORTATION**

| | | | |
|-------------------------------|-------|----|--------|
| SCHEDULE OF QUANTITIES | | | |
| SCALE: | SHEET | OF | SHEETS |
| | STA. | TO | STA. |

| | | | | |
|---------------------------|-------------------|------------|--------------|-----------|
| F.A.P. RTE. | SECTION | COUNTY | TOTAL SHEETS | SHEET NO. |
| 828 | (108,109,110)RS-4 | CUMBERLAND | 27 | 9 |
| CONTRACT NO. 74C42 | | | | |
| ILLINOIS FED. AID PROJECT | | | | |

| PAVEMENT MARKINGS | | | | | | | | | | | | | | | | | |
|-------------------|----|-------------------|------------------|----------------------------------|--|--|---|---|---|---|--|--|-----------------------------|-------------------------------------|-----------------------------------|---|------|
| | | LENGTH | NO PASSING ZONE | PAINT PAVEMENT MARKING - LINE 4" | THERMOPLASTIC PAVEMENT MARKING - LETTERS AND SYMBOLS | THERMOPLASTIC PAVEMENT MARKING - LINE 8" | THERMOPLASTIC PAVEMENT MARKING - LINE 12" | THERMOPLASTIC PAVEMENT MARKING - LINE 24" | GROOVING FOR RECESSED PAVEMENT MARKING, LETTERS AND SYMBOLS | GROOVING FOR RECESSED PAVEMENT MARKING 9" | GROOVING FOR RECESSED PAVEMENT MARKING 13" | GROOVING FOR RECESSED PAVEMENT MARKING 25" | SHORT TERM PAVEMENT MARKING | SHORT TERM PAVEMENT MARKING REMOVAL | RAISED REFLECTIVE PAVEMENT MARKER | RAISED REFLECTIVE PAVEMENT MARKER REMOVAL | |
| STATION | TO | STATION | FEET | | FFFT | SQ FT | FEET | FFFT | FFFT | SQ FT | FEET | FFFT | FFFT | FEET | SQ FT | EACH | EACH |
| 7+94.00 | | 0+17.00 | 777.0 | DBL NPZ | 3108.00 | 61.2 | - | - | 36 | 61.2 | - | - | 36 | 155 | 51.3 | 9.7 | 9.7 |
| 0+17.00 | | 0+00.00 | 17.0 | NB NPZ | 55.25 | - | - | - | 12 | - | - | - | 12 | 3 | 1.1 | 0.2 | 0.2 |
| 0+00.00 | = | 6+08.00 | STATION EQUATION | | | | | | | | | | | | | | |
| 6+08.00 | | 9+81.00 | 373.0 | NB NPZ | 1212.25 | 61.2 | - | - | 36 | 61.2 | - | - | 36 | 75 | 24.6 | 4.5 | 4.5 |
| 9+81.00 | | 201+28.00 | 19147.0 | SKIP DASH | 42609.75 | - | - | - | - | - | - | - | 3829 | 1263.7 | 238.0 | 238.0 | |
| 201+28.00 | | 213+70.00 | 1242.0 | SB NPZ | 4036.50 | - | - | - | - | - | - | - | 248 | 82.0 | 15.5 | 15.5 | |
| 213+70.00 | | 215+45.68 | 175.7 | NB NPZ | 570.96 | - | - | - | - | - | - | - | 35 | 11.6 | 2.2 | 2.2 | |
| 215+45.68 | = | 215+50.00 | STATION EQUATION | | | | | | | | | | | | | | |
| 215+50.00 | | 223+80.00 | 830.0 | NB NPZ | 2697.50 | - | - | - | - | - | - | - | 166 | 54.8 | 10.4 | 10.4 | |
| 223+80.00 | | 235+81.00 | 1201.0 | SKIP DASH | 2642.25 | - | - | - | - | - | - | - | 240 | 79.3 | 13.9 | 13.9 | |
| 235+81.00 | | 246+65.00 | 1084.0 | SB NPZ | 3523.00 | - | - | - | - | - | - | - | 217 | 71.5 | 13.6 | 13.6 | |
| 246+65.00 | | 262+35.00 | 1570.0 | DBL NPZ | 6280.00 | - | - | - | - | - | - | - | 314 | 103.6 | 19.6 | 19.6 | |
| 262+35.00 | | 272+90.00 | 1055.0 | NB NPZ | 3428.75 | - | - | - | - | - | - | - | 211 | 69.6 | 13.2 | 13.2 | |
| 272+90.00 | | 288+56.00 | 1566.0 | SKIP DASH | 3461.50 | - | - | - | - | - | - | - | 313 | 103.4 | 19.6 | 19.6 | |
| 288+56.00 | | 299+88.00 | 1132.0 | SB NPZ | 3679.00 | - | - | - | - | - | - | - | 226 | 74.7 | 14.2 | 14.2 | |
| 299+88.00 | | 313+00.00 | 1312.0 | DB NPZ | 5116.75 | - | 255 | 87 | - | - | 255 | 87 | 262 | 86.6 | 16.4 | 16.4 | |
| 1+21.00 | | Montrose Blacktop | 392.0 | SKIP DASH | 487 | - | - | - | 14 | - | - | 14 | 78 | 25.9 | 4.9 | 4.9 | |
| TOTAL = | | | | | 82909 | 122 | 255 | 87 | 98 | 122 | 255 | 87 | 98 | 6375 | 2104 | 396 | 396 |

| PATCHING/RUMBLE STRIPS | | | | | | | | |
|---------------------------|------------|-------|--------|------------|--------------------|-------|-----------------------------------|--------------|
| LOCATION | STATIONING | | LENGTH | LANE WIDTH | RUMBLE/PATCH WIDTH | AREA | CLASS C PATCHES, TYPE IV, 10 INCH | RUMBLE STRIP |
| | FROM | TO | FEET | FEET | FEET | SQ YD | SQ YD | SQ FT |
| LL 121 South of RR tracts | 9+20 | 8+95 | 25.0 | 13.0 | 13.0 | 36.1 | 36.1 | 325.0 |
| LL 121 South of RR tracts | 11+20 | 10+95 | 25.0 | 13.0 | 13.0 | 36.1 | 36.1 | 325.0 |
| LL 121 South of RR tracts | 16+28 | 16+03 | 25.0 | 13.0 | 13.0 | 36.1 | 36.1 | 325.0 |
| TOTAL | | | | | | 108 | 108 | 975 |

| PORTLAND CEMENT CONCRETE SURFACE REMOVAL - BUTT JOINT | | | | |
|---|--------|-------|-------|-------|
| LOCATION | LENGTH | WIDTH | AREA | |
| | FEET | FEET | SQ YD | SQ YD |
| Southbound Approach | 30 | 18 | 60 | 60.0 |
| Northbound Approach | Var. | 18 | 24 | 39.0 |
| | | | | 99 |

MODEL: Default
 FILE: Mainfile.pxl
 PROJECT: \\server\projects\DOT\Projects\74C42\74C42-Sub-Structure.dgn

| | | |
|------------------------------|------------|-----------|
| USER NAME = jessica.hille | DESIGNED - | REVISED - |
| | DRAWN - | REVISED - |
| PLOT SCALE = 100,0000' / in. | CHECKED - | REVISED - |
| PLOT DATE = 3/21/2024 | DATE - | REVISED - |

STATE OF ILLINOIS
DEPARTMENT OF TRANSPORTATION

| SCHEDULE OF QUANTITIES | | | | |
|------------------------|-------|----|--------|--------------|
| SCALE: | SHEET | OF | SHEETS | STA. TO STA. |
| | | | | |

| F.A.P. RTE. | SECTION | COUNTY | TOTAL SHEETS | SHEET NO. |
|---------------------------|-------------------|------------|--------------|-----------|
| 828 | (108,109,110)RS-4 | CUMBERLAND | 27 | 10 |
| CONTRACT NO. 74C42 | | | | |
| ILLINOIS FED. AID PROJECT | | | | |

| | | | LENGTH | CURB AND GUTTER | GRADING AND SHAPING SHOULDERS |
|-----------|----|-----------------------|--------------|-----------------|-------------------------------|
| STA. | IO | SIA. | FEET | LT/RT/BT | UNITS |
| 7+94.00 | | 6+06.00 | 188.0 | - | 3.76 |
| 6+06.00 | | 5+31.00 | 75.0 | - | 1.50 |
| 5+31.00 | | 0+00.00 | 531.0 | - | 10.62 |
| 0+00.00 | = | 6+08.00 | - | | STATION EQUATION |
| 6+08.00 | | 6+20.00 | 12.0 | | RAILROAD OMISSION |
| 6+20.00 | | 151+83.00 | 14563.0 | - | 261.52 |
| 151+83.00 | | 154+89.00 | 306.0 | - | 5.87 |
| 154+89.00 | | 155+95.00 | 106.0 | | BRIDGE OMISSION |
| 155+95.00 | | 158+34.00 | 239.0 | - | 4.78 |
| 158+34.00 | | 211+76.00 | 5342.0 | - | 33.57 |
| 211+76.00 | | 212+12.00 | 36.0 | LT | 0.12 |
| 212+12.00 | | 215+45.68 | 333.7 | BT | |
| 215+45.68 | | 215+50.00 | - | | STATION EQUATION |
| 215+50.00 | | 217+15.00 | 165.0 | BT | |
| 217+15.00 | | 218+50.00 | 135.0 | LT | 1.35 |
| 218+50.00 | | 232+26.00 | 1376.0 | - | 24.45 |
| 232+26.00 | | 233+14.00 | 88.0 | | BRIDGE OMISSION |
| 233+14.00 | | 243+50.00 | 1036.0 | - | 19.91 |
| 243+50.00 | | 249+14.00 | 564.0 | BT | |
| 249+14.00 | | 250+10.00 | 96.0 | RT | 0.96 |
| 250+10.00 | | 254+55.00 | 445.0 | - | 8.90 |
| 254+55.00 | | 257+25.00 | 270.0 | LT | 2.70 |
| 257+25.00 | | 262+33.00 | 508.0 | BT | |
| 262+33.00 | | 297+81.00 | 3548.0 | - | 57.86 |
| 297+81.00 | | 305+10.00 | 729.0 | BT | |
| 305+10.00 | | 308+41.00 | 331.0 | - | 6.47 |
| 308+41.00 | | 308+79.00 | 38.0 | - | 0.76 |
| 308+79.00 | | 311+10.00 | 231.0 | BT | 4.20 |
| 311+10.00 | | 313+00.00 | 190.0 | | 1.90 |
| 308+41 | | 121/MONTROSE BLKTOP Y | 392.0 | | 4.92 |
| | | | TOTAL | Total | 456 |

MODEL: Default
 FILE: \\mfls-pw-bentley.com\P\INDOT\Documents\DOT Offices\District 7\Project\74C42\CADDData\CAD\Sheet\74C42-eh-schedule.dgn

| | | |
|------------------------------|------------|-----------|
| USER NAME = jessica.hille | DESIGNED - | REVISED - |
| | DRAWN - | REVISED - |
| PLOT SCALE = 100,0000' / in. | CHECKED - | REVISED - |
| PLOT DATE = 3/21/2024 | DATE - | REVISED - |

STATE OF ILLINOIS
DEPARTMENT OF TRANSPORTATION

SCHEDULE OF QUANTITIES

SCALE: SHEET OF SHEETS STA. TO STA.

| F.A.P. RTE. | SECTION | COUNTY | TOTAL SHEETS | SHEET NO. |
|---------------------------|-------------------|------------|--------------|-----------|
| 828 | (108,109,110)RS-4 | CUMBERLAND | 27 | 11 |
| CONTRACT NO. 74C42 | | | | |
| ILLINOIS FED. AID PROJECT | | | | |

| PATCHING SCHEDULE | | | | | | | |
|-------------------|----------|---------|---------------|--------------|------------------------------------|-------------------------------------|------------------------------------|
| PATCH NUMBER | LOCATION | STATION | LENGTH (FOOT) | WIDTH (FOOT) | CLASS D PATCHES, TYPE II, 13" (SQ) | CLASS D PATCHES, TYPE III, 13" (SQ) | CLASS D PATCHES, TYPE IV, 13" (SQ) |
| 1 | NB | 4+45 | 200 | 6 | | | 133.3 |
| 2 | SB | 5+85 | 185 | 6 | | | 123.3 |
| 3 | NB | 6+70 | 4 | 12 | 5.3 | | |
| 4 | SB | 6+70 | 4 | 12 | 5.3 | | |
| 5 | NB | 8+28 | 4 | 12 | 5.3 | | |
| 6 | SB | 8+28 | 4 | 12 | 5.3 | | |
| 7 | NB | 8+20 | 4 | 12 | 5.3 | | |
| 8 | SB | 8+20 | 4 | 12 | 5.3 | | |
| 9 | NB | 8+38 | 4 | 12 | 5.3 | | |
| 10 | SB | 8+38 | 4 | 12 | 5.3 | | |
| 11 | NB | 8+60 | 4 | 12 | 5.3 | | |
| 12 | SB | 8+60 | 4 | 12 | 5.3 | | |
| 13 | NB | 9+58 | 4 | 12 | 5.3 | | |
| 14 | SB | 9+58 | 6 | 12 | 8 | | |
| 15 | NB | 10+09 | 4 | 12 | 5.3 | | |
| 16 | SB | 10+09 | 6 | 12 | 8 | | |
| 17 | NB | 10+90 | 4 | 12 | 5.3 | | |
| 18 | SB | 10+90 | 4 | 12 | 5.3 | | |
| 19 | NB | 12+49 | 4 | 12 | 5.3 | | |
| 20 | SB | 12+49 | 4 | 12 | 5.3 | | |
| 21 | SB | 13+13 | 4 | 12 | 5.3 | | |
| 22 | NB | 13+17 | 6 | 12 | 8 | | |
| 23 | SB | 13+26 | 4 | 12 | 5.3 | | |
| 24 | SB | 14+20 | 6 | 12 | 8 | | |
| 25 | SB | 14+38 | 8 | 12 | 10.7 | | |
| 26 | NB | 14+70 | 4 | 12 | 5.3 | | |
| 27 | SB | 14+70 | 4 | 12 | 5.3 | | |
| 28 | NB | 16+68 | 4 | 12 | 5.3 | | |
| 29 | SB | 16+68 | 4 | 12 | 5.3 | | |
| 30 | NB | 18+12 | 4 | 12 | 5.3 | | |
| 31 | SB | 18+12 | 4 | 12 | 5.3 | | |
| 32 | SB | 18+62 | 4 | 12 | 5.3 | | |
| 33 | SB | 18+73 | 4 | 12 | 5.3 | | |
| 34 | SB | 19+50 | 4 | 12 | 5.3 | | |
| 35 | NB | 19+63 | 6 | 12 | 8 | | |
| 36 | SB | 19+63 | 10 | 12 | 13.3 | | |
| 37 | SB | 20+54 | 4 | 12 | 5.3 | | |
| 38 | NB | 21+97 | 4 | 12 | 5.3 | | |
| 39 | SB | 21+97 | 4 | 12 | 5.3 | | |
| 40 | NB | 25+00 | 6 | 12 | 8 | | |

| PATCHING SCHEDULE | | | | | | | |
|-------------------|----------|---------|---------------|--------------|------------------------------------|-------------------------------------|------------------------------------|
| PATCH NUMBER | LOCATION | STATION | LENGTH (FOOT) | WIDTH (FOOT) | CLASS D PATCHES, TYPE II, 13" (SQ) | CLASS D PATCHES, TYPE III, 13" (SQ) | CLASS D PATCHES, TYPE IV, 13" (SQ) |
| 41 | SB | 25+00 | 4 | 12 | 5.3 | | |
| 42 | SB | 25+92 | 4 | 12 | 5.3 | | |
| 43 | NB | 27+00 | 4 | 12 | 5.3 | | |
| 44 | SB | 27+00 | 4 | 12 | 5.3 | | |
| 45 | SB | 27+61 | 12 | 12 | | 16 | |
| 46 | SB | 28+66 | 6 | 12 | 8 | | |
| 47 | NB | 29+11 | 4 | 12 | 5.3 | | |
| 48 | SB | 29+11 | 30 | 12 | | | 40 |
| 49 | NB | 29+61 | 10 | 12 | 13.3 | | |
| 50 | SB | 29+61 | 10 | 12 | 13.3 | | |
| 51 | NB | 30+37 | 8 | 12 | 10.7 | | |
| 52 | SB | 30+37 | 15 | 12 | | 20 | |
| 53 | SB | 33+03 | 6 | 12 | 8 | | |
| 54 | SB | 33+41 | 6 | 12 | 8 | | |
| 55 | NB | 33+41 | 6 | 12 | 8 | | |
| 56 | NB | 34+29 | 4 | 12 | 5.3 | | |
| 57 | NB | 35+58 | 4 | 12 | 5.3 | | |
| 58 | SB | 36+29 | 15 | 12 | | 20 | |
| 59 | SB | 36+69 | 8 | 12 | 10.7 | | |
| 60 | SB | 36+96 | 6 | 12 | 8 | | |
| 61 | SB | 37+15 | 18 | 12 | | 24 | |
| 62 | NB | 39+41 | 4 | 12 | 5.3 | | |
| 63 | SB | 39+41 | 4 | 12 | 5.3 | | |
| 64 | SB | 40+26 | 10 | 12 | 13.3 | | |
| 65 | NB | 40+26 | 4 | 12 | 5.3 | | |
| 66 | NB | 41+53 | 4 | 12 | 5.3 | | |
| 67 | SB | 41+53 | 4 | 12 | 5.3 | | |
| 68 | NB | 42+16 | 4 | 12 | 5.3 | | |
| 69 | SB | 42+61 | 6 | 12 | 8 | | |
| 70 | SB | 42+61 | 4 | 12 | 5.3 | | |
| 71 | NB | 42+93 | 4 | 12 | 5.3 | | |
| 72 | SB | 42+93 | 4 | 12 | 5.3 | | |
| 73 | SB | 43+82 | 10 | 12 | 13.3 | | |
| 74 | SB | 45+47 | 8 | 12 | 10.7 | | |
| 75 | NB | 45+65 | 4 | 12 | 5.3 | | |
| 76 | SB | 45+75 | 8 | 12 | 10.7 | | |
| 77 | NB | 46+30 | 4 | 12 | 5.3 | | |
| 78 | SB | 47+63 | 6 | 12 | 8 | | |
| 79 | NB | 48+04 | 6 | 12 | 8 | | |
| 80 | SB | 48+04 | 6 | 12 | 8 | | |

MODEL: Default
 FILE: \\blm\c:\p\blm\caw\benefit\com\p\blm\dot\Documents\DOT\Office\Director_7\Project\74C42\CADDData\CADDData\DOT\Sheet\DOT\74C42-sbr-schedule.dgn

| | | |
|------------------------------|------------|-----------|
| USER NAME = jessica.hille | DESIGNED - | REVISED - |
| | DRAWN - | REVISED - |
| PLOT SCALE = 100,0000' / in. | CHECKED - | REVISED - |
| PLOT DATE = 3/21/2024 | DATE - | REVISED - |

STATE OF ILLINOIS
DEPARTMENT OF TRANSPORTATION

| SCHEDULE OF QUANTITIES | | | |
|------------------------|-------|------|---------|
| SCALE: | SHEET | OF | SHEETS |
| | | | |
| | | STA. | TO STA. |

| | | | | |
|---------------------------|-------------------|------------|--------------|-----------|
| F.A.P. RTE. | SECTION | COUNTY | TOTAL SHEETS | SHEET NO. |
| 828 | (108,109,110)RS-4 | CUMBERLAND | 27 | 12 |
| CONTRACT NO. 74C42 | | | | |
| ILLINOIS FED. AID PROJECT | | | | |

| PATCHING SCHEDULE | | | | | | | |
|-------------------|----------|---------|---------------|--------------|------------------------------------|-------------------------------------|------------------------------------|
| PATCH NUMBER | LOCATION | STATION | LENGTH (FOOT) | WIDTH (FOOT) | CLASS D PATCHES, TYPE II, 13" (SQ) | CLASS D PATCHES, TYPE III, 13" (SQ) | CLASS D PATCHES, TYPE IV, 13" (SQ) |
| 81 | SB | 49+35 | 4 | 12 | 5.3 | | |
| 82 | SB | 49+80 | 4 | 12 | 5.3 | | |
| 83 | SB | 50+13 | 10 | 12 | 13.3 | | |
| 84 | NB | 51+15 | 4 | 12 | 5.3 | | |
| 85 | SB | 51+15 | 4 | 12 | 5.3 | | |
| 86 | SB | 52+40 | 8 | 12 | 10.7 | | |
| 87 | SB | 53+25 | 6 | 12 | 8 | | |
| 88 | NB | 55+02 | 4 | 12 | 5.3 | | |
| 89 | SB | 55+02 | 4 | 12 | 5.3 | | |
| 90 | NB | 55+58 | 4 | 12 | 5.3 | | |
| 91 | NB | 57+57 | 4 | 12 | 5.3 | | |
| 92 | SB | 57+57 | 4 | 12 | 5.3 | | |
| 93 | NB | 58+28 | 4 | 12 | 5.3 | | |
| 94 | SB | 58+28 | 4 | 12 | 5.3 | | |
| 95 | SB | 59+07 | 6 | 12 | 8 | | |
| 96 | SB | 60+69 | 4 | 12 | 5.3 | | |
| 97 | SB | 60+79 | 4 | 12 | 5.3 | | |
| 98 | NB | 61+61 | 6 | 12 | 8 | | |
| 99 | SB | 61+61 | 6 | 12 | 8 | | |
| 100 | SB | 62+40 | 8 | 12 | 10.7 | | |
| 101 | NB | 62+66 | 4 | 12 | 5.3 | | |
| 102 | SB | 62+66 | 4 | 12 | 5.3 | | |
| 103 | NB | 64+59 | 6 | 12 | 8 | | |
| 104 | SB | 64+59 | 6 | 12 | 8 | | |
| 105 | SB | 65+36 | 6 | 12 | 8 | | |
| 106 | NB | 67+45 | 6 | 12 | 8 | | |
| 107 | SB | 67+45 | 6 | 12 | 8 | | |
| 108 | NB | 69+04 | 4 | 12 | 5.3 | | |
| 109 | SB | 69+04 | 4 | 12 | 5.3 | | |
| 110 | NB | 70+73 | 4 | 12 | 5.3 | | |
| 111 | SB | 70+73 | 4 | 12 | 5.3 | | |
| 112 | SB | 72+76 | 6 | 12 | 8 | | |
| 113 | NB | 73+02 | 4 | 12 | 5.3 | | |
| 114 | SB | 73+02 | 4 | 12 | 5.3 | | |
| 115 | NB | 74+04 | 4 | 12 | 5.3 | | |
| 116 | SB | 74+04 | 4 | 12 | 5.3 | | |
| 117 | SB | 74+28 | 6 | 12 | 8 | | |
| 118 | SB | 75+79 | 4 | 12 | 5.3 | | |
| 119 | NB | 75+92 | 4 | 12 | 5.3 | | |
| 120 | SB | 75+92 | 4 | 12 | 5.3 | | |

| PATCHING SCHEDULE | | | | | | | |
|-------------------|----------|---------|---------------|--------------|------------------------------------|-------------------------------------|------------------------------------|
| PATCH NUMBER | LOCATION | STATION | LENGTH (FOOT) | WIDTH (FOOT) | CLASS D PATCHES, TYPE II, 13" (SQ) | CLASS D PATCHES, TYPE III, 13" (SQ) | CLASS D PATCHES, TYPE IV, 13" (SQ) |
| 121 | NB | 77+50 | 6 | 12 | 8 | | |
| 122 | SB | 77+50 | 6 | 12 | 8 | | |
| 123 | NB | 79+11 | 6 | 12 | 8 | | |
| 124 | SB | 79+11 | 6 | 12 | 8 | | |
| 125 | SB | 80+12 | 4 | 12 | 5.3 | | |
| 126 | NB | 80+36 | 6 | 12 | 8 | | |
| 127 | SB | 80+36 | 6 | 12 | 8 | | |
| 128 | SB | 81+20 | 4 | 12 | 5.3 | | |
| 129 | SB | 81+68 | 6 | 12 | 8 | | |
| 130 | SB | 82+85 | 4 | 12 | 5.3 | | |
| 131 | NB | 83+88 | 6 | 12 | 8 | | |
| 132 | SB | 83+88 | 6 | 12 | 8 | | |
| 133 | NB | 84+40 | 4 | 12 | 5.3 | | |
| 134 | SB | 84+40 | 4 | 12 | 5.3 | | |
| 135 | NB | 84+70 | 6 | 12 | 8 | | |
| 136 | SB | 84+70 | 6 | 12 | 8 | | |
| 137 | SB | 85+55 | 4 | 12 | 5.3 | | |
| 138 | NB | 86+25 | 6 | 12 | 8 | | |
| 139 | SB | 87+33 | 6 | 12 | 8 | | |
| 140 | SB | 88+70 | 6 | 12 | 8 | | |
| 141 | NB | 88+87 | 6 | 12 | 8 | | |
| 142 | SB | 89+60 | 12 | 12 | | 16 | |
| 143 | NB | 90+10 | 6 | 12 | 8 | | |
| 144 | SB | 90+10 | 6 | 12 | 8 | | |
| 145 | SB | 90+45 | 6 | 12 | 8 | | |
| 146 | NB | 91+08 | 4 | 12 | 5.3 | | |
| 147 | SB | 91+08 | 4 | 12 | 5.3 | | |
| 148 | NB | 91+43 | 4 | 12 | 5.3 | | |
| 149 | SB | 91+43 | 4 | 12 | 5.3 | | |
| 150 | NB | 91+75 | 6 | 12 | 8 | | |
| 151 | SB | 91+75 | 6 | 12 | 8 | | |
| 152 | NB | 92+20 | 6 | 12 | 8 | | |
| 153 | SB | 92+20 | 8 | 12 | 10.7 | | |
| 154 | NB | 92+80 | 6 | 12 | 8 | | |
| 155 | SB | 92+80 | 6 | 12 | 8 | | |
| 156 | SB | 93+20 | 6 | 12 | 8 | | |
| 157 | SB | 93+50 | 6 | 12 | 8 | | |
| 158 | SB | 93+90 | 4 | 12 | 5.3 | | |
| 159 | NB | 94+35 | 6 | 12 | 8 | | |
| 160 | SB | 94+90 | 6 | 12 | 8 | | |

MODEL: Default
 FILE: \\MAILSrv\public\aw_bentley.com\PIV\DOT\Documents\DOT_Offices\Dir\dir_7\Project\74C42\CADDData\CADDData\DOT\74C42-Sub-schedule.dgn

| | | |
|------------------------------|------------|-----------|
| USER NAME = jessica.hille | DESIGNED - | REVISED - |
| | DRAWN - | REVISED - |
| PLOT SCALE = 100,0000' / in. | CHECKED - | REVISED - |
| PLOT DATE = 3/21/2024 | DATE - | REVISED - |

STATE OF ILLINOIS
DEPARTMENT OF TRANSPORTATION

| | | | |
|-------------------------------|-------|----|--------|
| SCHEDULE OF QUANTITIES | | | |
| SCALE: | SHEET | OF | SHEETS |
| | STA. | TO | STA. |

| | | | | |
|---------------------------|-------------------|------------|--------------|-----------|
| F.A.P. RTE. | SECTION | COUNTY | TOTAL SHEETS | SHEET NO. |
| 828 | (108,109,110)RS-4 | CUMBERLAND | 27 | 13 |
| CONTRACT NO. 74C42 | | | | |
| ILLINOIS FED. AID PROJECT | | | | |

| PATCHING SCHEDULE | | | | | | | |
|-------------------|----------|---------|---------------|--------------|------------------------------------|-------------------------------------|------------------------------------|
| PATCH NUMBER | LOCATION | STATION | LENGTH (FOOT) | WIDTH (FOOT) | CLASS D PATCHES, TYPE II, 13" (SQ) | CLASS D PATCHES, TYPE III, 13" (SQ) | CLASS D PATCHES, TYPE IV, 13" (SQ) |
| 161 | SB | 95+10 | 4 | 12 | 5.3 | | |
| 162 | SB | 95+75 | 6 | 12 | 8 | | |
| 163 | SB | 96+27 | 6 | 12 | 8 | | |
| 164 | SB | 96+83 | 4 | 12 | 5.3 | | |
| 165 | NB | 97+46 | 4 | 12 | 5.3 | | |
| 166 | NB | 98+15 | 4 | 12 | 5.3 | | |
| 167 | SB | 98+15 | 4 | 12 | 5.3 | | |
| 168 | NB | 98+60 | 6 | 12 | 8 | | |
| 169 | SB | 98+60 | 6 | 12 | 8 | | |
| 170 | NB | 100+28 | 6 | 12 | 8 | | |
| 171 | SB | 100+28 | 6 | 12 | 8 | | |
| 172 | SB | 100+98 | 6 | 12 | 8 | | |
| 173 | SB | 101+57 | 6 | 12 | 8 | | |
| 174 | NB | 102+21 | 4 | 12 | 5.3 | | |
| 175 | SB | 102+75 | 4 | 12 | 5.3 | | |
| 176 | NB | 103+40 | 4 | 12 | 5.3 | | |
| 177 | SB | 103+40 | 4 | 12 | 5.3 | | |
| 178 | SB | 103+75 | 6 | 12 | 8 | | |
| 179 | SB | 104+25 | 8 | 12 | 10.7 | | |
| 180 | NB | 104+25 | 4 | 12 | 5.3 | | |
| 181 | SB | 104+77 | 4 | 12 | 5.3 | | |
| 182 | SB | 105+56 | 4 | 12 | 5.3 | | |
| 183 | NB | 106+30 | 6 | 12 | 8 | | |
| 184 | NB | 106+65 | 6 | 12 | 8 | | |
| 185 | SB | 106+65 | 6 | 12 | 8 | | |
| 186 | NB | 107+00 | 6 | 12 | 8 | | |
| 187 | SB | 107+00 | 6 | 12 | 8 | | |
| 188 | NB | 108+75 | 4 | 12 | 5.3 | | |
| 189 | SB | 108+75 | 4 | 12 | 5.3 | | |
| 190 | NB | 109+10 | 6 | 12 | 8 | | |
| 191 | SB | 109+40 | 6 | 12 | 8 | | |
| 192 | NB | 109+70 | 4 | 12 | 5.3 | | |
| 193 | SB | 109+70 | 4 | 12 | 5.3 | | |
| 194 | NB | 110+05 | 4 | 12 | 5.3 | | |
| 195 | SB | 110+05 | 4 | 12 | 5.3 | | |
| 196 | SB | 110+72 | 6 | 12 | 8 | | |
| 197 | NB | 111+20 | 4 | 12 | 5.3 | | |
| 198 | SB | 111+20 | 4 | 12 | 5.3 | | |
| 199 | NB | 111+47 | 4 | 12 | 5.3 | | |
| 200 | SB | 111+47 | 4 | 12 | 5.3 | | |

| PATCHING SCHEDULE | | | | | | | |
|-------------------|----------|---------|---------------|--------------|------------------------------------|-------------------------------------|------------------------------------|
| PATCH NUMBER | LOCATION | STATION | LENGTH (FOOT) | WIDTH (FOOT) | CLASS D PATCHES, TYPE II, 13" (SQ) | CLASS D PATCHES, TYPE III, 13" (SQ) | CLASS D PATCHES, TYPE IV, 13" (SQ) |
| 201 | NB | 112+44 | 4 | 12 | 5.3 | | |
| 202 | SB | 112+44 | 4 | 12 | 5.3 | | |
| 203 | SB | 112+80 | 4 | 12 | 5.3 | | |
| 204 | NB | 113+75 | 4 | 12 | 5.3 | | |
| 205 | SB | 113+90 | 4 | 12 | 5.3 | | |
| 206 | NB | 114+40 | 4 | 12 | 5.3 | | |
| 207 | SB | 114+40 | 4 | 12 | 5.3 | | |
| 208 | NB | 115+00 | 4 | 12 | 5.3 | | |
| 209 | SB | 115+00 | 4 | 12 | 5.3 | | |
| 210 | NB | 115+30 | 6 | 12 | 8 | | |
| 211 | NB | 116+67 | 4 | 12 | 5.3 | | |
| 212 | SB | 116+67 | 4 | 12 | 5.3 | | |
| 213 | NB | 116+85 | 4 | 12 | 5.3 | | |
| 214 | SB | 116+85 | 6 | 12 | 8 | | |
| 215 | NB | 117+35 | 4 | 12 | 5.3 | | |
| 216 | NB | 118+55 | 6 | 12 | 8 | | |
| 217 | SB | 118+55 | 6 | 12 | 8 | | |
| 218 | NB | 119+02 | 4 | 12 | 5.3 | | |
| 219 | NB | 120+08 | 4 | 12 | 5.3 | | |
| 220 | SB | 121+00 | 4 | 12 | 5.3 | | |
| 221 | NB | 121+50 | 6 | 12 | 8 | | |
| 222 | SB | 121+50 | 6 | 12 | 8 | | |
| 223 | NB | 122+10 | 6 | 12 | 8 | | |
| 224 | SB | 122+10 | 6 | 12 | 8 | | |
| 225 | NB | 122+70 | 4 | 12 | 5.3 | | |
| 226 | SB | 122+70 | 4 | 12 | 5.3 | | |
| 227 | NB | 128+13 | 4 | 12 | 5.3 | | |
| 228 | SB | 128+13 | 4 | 12 | 5.3 | | |
| 229 | SB | 128+97 | 4 | 12 | 5.3 | | |
| 230 | NB | 129+83 | 4 | 12 | 5.3 | | |
| 231 | NB | 130+50 | 4 | 12 | 5.3 | | |
| 232 | SB | 130+50 | 4 | 12 | 5.3 | | |
| 233 | NB | 130+75 | 4 | 12 | 5.3 | | |
| 234 | NB | 133+00 | 6 | 12 | 8 | | |
| 235 | SB | 133+00 | 6 | 12 | 8 | | |
| 236 | NB | 133+62 | 6 | 12 | 8 | | |
| 237 | SB | 133+62 | 6 | 12 | 8 | | |
| 238 | NB | 134+65 | 4 | 12 | 5.3 | | |
| 239 | SB | 134+65 | 4 | 12 | 5.3 | | |
| 240 | SB | 135+55 | 4 | 12 | 5.3 | | |

MODEL: Default
 FILE: \\MAILSrv\pub\ldict-pw-bead\paw.com\FW\DOT\Documents\DOT\Office\Director_7\Project\74C42\CADDData\CADD\Sheet\74C42-sbr-schedule.dgn

| | | |
|------------------------------|------------|-----------|
| USER NAME = jessica.hille | DESIGNED - | REVISED - |
| | DRAWN - | REVISED - |
| PLOT SCALE = 100,0000' / in. | CHECKED - | REVISED - |
| PLOT DATE = 3/21/2024 | DATE - | REVISED - |

STATE OF ILLINOIS
DEPARTMENT OF TRANSPORTATION

| SCHEDULE OF QUANTITIES | | | |
|------------------------|-------|-----------|--------------|
| SCALE: | SHEET | OF SHEETS | STA. TO STA. |
| | | | |

| | | | | |
|---------------------------|-------------------|------------|--------------|-----------|
| F.A.P. RTE. | SECTION | COUNTY | TOTAL SHEETS | SHEET NO. |
| 828 | (108,109,110)RS-4 | CUMBERLAND | 27 | 14 |
| CONTRACT NO. 74C42 | | | | |
| ILLINOIS FED. AID PROJECT | | | | |

| PATCHING SCHEDULE | | | | | | | |
|-------------------|----------|---------|---------------|--------------|------------------------------------|-------------------------------------|------------------------------------|
| PATCH NUMBER | LOCATION | STATION | LENGTH (FOOT) | WIDTH (FOOT) | CLASS D PATCHES, TYPE II, 13" (SQ) | CLASS D PATCHES, TYPE III, 13" (SQ) | CLASS D PATCHES, TYPE IV, 13" (SQ) |
| 241 | SB | 138+63 | 4 | 12 | 5.3 | | |
| 242 | NB | 140+00 | 6 | 12 | 8 | | |
| 243 | SB | 140+00 | 6 | 12 | 8 | | |
| 244 | NB | 142+55 | 6 | 12 | 8 | | |
| 245 | SB | 142+80 | 4 | 12 | 5.3 | | |
| 246 | NB | 143+10 | 4 | 12 | 5.3 | | |
| 247 | SB | 143+10 | 4 | 12 | 5.3 | | |
| 248 | SB | 144+20 | 4 | 12 | 5.3 | | |
| 249 | SB | 145+23 | 4 | 12 | 5.3 | | |
| 250 | NB | 146+05 | 4 | 12 | 5.3 | | |
| 251 | SB | 146+05 | 4 | 12 | 5.3 | | |
| 252 | NB | 146+87 | 4 | 12 | 5.3 | | |
| 253 | SB | 146+87 | 4 | 12 | 5.3 | | |
| 254 | NB | 147+40 | 4 | 12 | 5.3 | | |
| 255 | SB | 147+40 | 4 | 12 | 5.3 | | |
| 256 | NB | 148+68 | 6 | 12 | 8 | | |
| 257 | SB | 148+68 | 6 | 12 | 8 | | |
| 258 | NB | 149+90 | 4 | 12 | 5.3 | | |
| 259 | SB | 149+90 | 4 | 12 | 5.3 | | |
| 260 | SB | 151+60 | 4 | 12 | 5.3 | | |
| 261 | NB | 151+75 | 6 | 12 | 8 | | |
| 262 | SB | 151+75 | 4 | 12 | 5.3 | | |
| 263 | SB | 160+50 | 4 | 12 | 5.3 | | |
| 264 | NB | 161+02 | 4 | 12 | 5.3 | | |
| 265 | SB | 161+02 | 4 | 12 | 5.3 | | |
| 266 | SB | 162+12 | 6 | 12 | 8 | | |
| 267 | NB | 162+85 | 4 | 12 | 5.3 | | |
| 268 | SB | 162+85 | 4 | 12 | 5.3 | | |
| 269 | NB | 164+70 | 4 | 12 | 5.3 | | |
| 270 | SB | 164+70 | 4 | 12 | 5.3 | | |
| 271 | SB | 165+01 | 4 | 12 | 5.3 | | |
| 272 | NB | 165+42 | 4 | 12 | 5.3 | | |
| 273 | SB | 165+42 | 4 | 12 | 5.3 | | |
| 274 | NB | 165+72 | 4 | 12 | 5.3 | | |
| 275 | SB | 165+72 | 4 | 12 | 5.3 | | |
| 276 | NB | 165+95 | 4 | 12 | 5.3 | | |
| 277 | SB | 165+95 | 4 | 12 | 5.3 | | |
| 278 | SB | 167+23 | 4 | 12 | 5.3 | | |
| 279 | SB | 167+96 | 4 | 12 | 5.3 | | |
| 280 | SB | 168+33 | 4 | 12 | 5.3 | | |

| PATCHING SCHEDULE | | | | | | | |
|-------------------|----------|---------|---------------|--------------|------------------------------------|-------------------------------------|------------------------------------|
| PATCH NUMBER | LOCATION | STATION | LENGTH (FOOT) | WIDTH (FOOT) | CLASS D PATCHES, TYPE II, 13" (SQ) | CLASS D PATCHES, TYPE III, 13" (SQ) | CLASS D PATCHES, TYPE IV, 13" (SQ) |
| 281 | NB | 169+35 | 4 | 12 | 5.3 | | |
| 282 | SB | 169+35 | 4 | 12 | 5.3 | | |
| 283 | NB | 170+60 | 4 | 12 | 5.3 | | |
| 284 | SB | 170+60 | 4 | 12 | 5.3 | | |
| 285 | SB | 171+13 | 10 | 12 | 13.3 | | |
| 286 | NB | 171+16 | 4 | 12 | 5.3 | | |
| 287 | SB | 172+20 | 4 | 12 | 5.3 | | |
| 288 | SB | 172+91 | 4 | 12 | 5.3 | | |
| 289 | SB | 173+16 | 4 | 12 | 5.3 | | |
| 290 | NB | 173+97 | 4 | 12 | 5.3 | | |
| 291 | SB | 173+97 | 4 | 12 | 5.3 | | |
| 292 | SB | 177+02 | 4 | 12 | 5.3 | | |
| 293 | SB | 177+55 | 4 | 12 | 5.3 | | |
| 294 | SB | 178+07 | 4 | 12 | 5.3 | | |
| 295 | NB | 178+07 | 4 | 12 | 5.3 | | |
| 296 | SB | 179+45 | 4 | 12 | 5.3 | | |
| 297 | SB | 181+25 | 4 | 12 | 5.3 | | |
| 298 | NB | 185+37 | 4 | 12 | 5.3 | | |
| 299 | SB | 185+37 | 4 | 12 | 5.3 | | |
| 300 | SB | 188+22 | 4 | 12 | 5.3 | | |
| 301 | NB | 189+05 | 4 | 12 | 5.3 | | |
| 302 | SB | 189+05 | 4 | 12 | 5.3 | | |
| 303 | SB | 189+82 | 6 | 12 | 8 | | |
| 304 | NB | 190+58 | 4 | 12 | 5.3 | | |
| 305 | SB | 193+53 | 4 | 12 | 5.3 | | |
| 306 | SB | 194+36 | 10 | 12 | 13.3 | | |
| 307 | SB | 198+82 | 4 | 12 | 5.3 | | |
| 308 | NB | 199+07 | 4 | 12 | 5.3 | | |
| 309 | SB | 199+07 | 4 | 12 | 5.3 | | |
| 310 | NB | 199+35 | 4 | 12 | 5.3 | | |
| 311 | SB | 199+35 | 4 | 12 | 5.3 | | |
| 312 | NB | 201+40 | 4 | 12 | 5.3 | | |
| 313 | SB | 201+40 | 4 | 12 | 5.3 | | |
| 314 | SB | 202+97 | 4 | 12 | 5.3 | | |
| 315 | SB | 203+50 | 4 | 12 | 5.3 | | |
| 316 | NB | 205+50 | 4 | 12 | 5.3 | | |
| 317 | SB | 205+50 | 4 | 12 | 5.3 | | |
| 318 | SB | 207+60 | 4 | 12 | 5.3 | | |
| 319 | NB | 210+40 | 6 | 12 | 8 | | |
| 320 | NB | 210+95 | 4 | 12 | 5.3 | | |

MODEL: Default
 FILE: \\MAILSrv\pub\ludat-pw\ben\paw.com\PIV\DOT\Documents\DOT\Office\Dir\dir_7\Project\74C42\CADDData\CADD\Sheet\74C42-Sub-schedule.dgn

| | | |
|------------------------------|------------|-----------|
| USER NAME = jessica.wille | DESIGNED - | REVISED - |
| | DRAWN - | REVISED - |
| PLOT SCALE = 100,0000' / in. | CHECKED - | REVISED - |
| PLOT DATE = 3/21/2024 | DATE - | REVISED - |

STATE OF ILLINOIS
DEPARTMENT OF TRANSPORTATION

| | | | |
|-------------------------------|-------|----|--------|
| SCHEDULE OF QUANTITIES | | | |
| SCALE: | SHEET | OF | SHEETS |
| | STA. | TO | STA. |

| | | | | |
|---------------------------|-------------------|------------|--------------|-----------|
| F.A.P. RTE. | SECTION | COUNTY | TOTAL SHEETS | SHEET NO. |
| 828 | (108,109,110)RS-4 | CUMBERLAND | 27 | 15 |
| CONTRACT NO. 74C42 | | | | |
| ILLINOIS FED. AID PROJECT | | | | |

| PATCHING SCHEDULE | | | | | | | |
|-------------------|----------|---------|---------------|--------------|------------------------------------|-------------------------------------|------------------------------------|
| PATCH NUMBER | LOCATION | STATION | LENGTH (FOOT) | WIDTH (FOOT) | CLASS D PATCHES, TYPE II, 13" (SQ) | CLASS D PATCHES, TYPE III, 13" (SQ) | CLASS D PATCHES, TYPE IV, 13" (SQ) |
| 321 | SB | 210+95 | 4 | 12 | 5.3 | | |
| 322 | NB | 212+20 | 12 | 12 | | 16 | |
| 323 | SB | 212+35 | 8 | 12 | 10.7 | | |
| 324 | NB | 212+52 | 6 | 12 | 8 | | |
| 325 | NB | 213+05 | 8 | 12 | 10.7 | | |
| 326 | NB | 213+60 | 6 | 12 | 8 | | |
| 327 | SB | 215+45 | 4 | 12 | 5.3 | | |
| 328 | NB | 215+45 | 4 | 12 | 5.3 | | |
| 329 | NB | 216+18 | 10 | 12 | 13.3 | | |
| 330 | SB | 216+18 | 10 | 12 | 13.3 | | |
| 331 | NB | 216+78 | 6 | 12 | 8 | | |
| 332 | SB | 216+78 | 6 | 12 | 8 | | |
| 333 | NB | 217+50 | 4 | 12 | 5.3 | | |
| 334 | SB | 217+50 | 4 | 12 | 5.3 | | |
| 335 | NB | 217+75 | 10 | 12 | 13.3 | | |
| 336 | SB | 217+75 | 10 | 12 | 13.3 | | |
| 337 | NB | 219+65 | 8 | 12 | 10.7 | | |
| 338 | SB | 219+65 | 8 | 12 | 10.7 | | |
| 339 | SB | 221+75 | 4 | 12 | 5.3 | | |
| 340 | SB | 222+30 | 4 | 12 | 5.3 | | |
| 341 | NB | 224+20 | 6 | 12 | 8 | | |
| 342 | SB | 224+20 | 6 | 12 | 8 | | |
| 343 | NB | 225+65 | 4 | 12 | 5.3 | | |
| 344 | SB | 225+65 | 4 | 12 | 5.3 | | |
| 345 | SB | 226+35 | 6 | 12 | 8 | | |
| 346 | SB | 226+70 | 4 | 12 | 5.3 | | |
| 347 | NB | 239+71 | 6 | 12 | 8 | | |
| 348 | SB | 239+71 | 6 | 12 | 8 | | |
| 349 | NB | 241+70 | 6 | 12 | 8 | | |
| 350 | SB | 241+70 | 6 | 12 | 8 | | |
| 351 | NB | 250+15 | 4 | 12 | 5.3 | | |
| 352 | SB | 250+15 | 4 | 12 | 5.3 | | |
| 353 | NB | 252+75 | 6 | 12 | 8 | | |
| 354 | SB | 252+75 | 6 | 12 | 8 | | |
| 355 | NB | 254+87 | 4 | 12 | 5.3 | | |
| 356 | SB | 254+87 | 4 | 12 | 5.3 | | |
| 357 | NB | 257+40 | 6 | 12 | 8 | | |
| 358 | SB | 257+40 | 6 | 12 | 8 | | |
| 359 | NB | 259+75 | 12 | 12 | | 16 | |
| 360 | SB | 259+75 | 12 | 12 | | 16 | |
| 361 | SB | 260+00 | 30 | 12 | | | 40 |

| PATCHING SCHEDULE | | | | | | | |
|-------------------|----------|---------|---------------|--------------|------------------------------------|-------------------------------------|------------------------------------|
| PATCH NUMBER | LOCATION | STATION | LENGTH (FOOT) | WIDTH (FOOT) | CLASS D PATCHES, TYPE II, 13" (SQ) | CLASS D PATCHES, TYPE III, 13" (SQ) | CLASS D PATCHES, TYPE IV, 13" (SQ) |
| 362 | NB | 260+00 | 20 | 12 | | | 26.7 |
| 363 | NB | 260+81 | 8 | 12 | 10.7 | | |
| 364 | SB | 260+95 | 8 | 12 | 10.7 | | |
| 365 | NB | 260+95 | 4 | 12 | 5.3 | | |
| 366 | SB | 261+65 | 12 | 12 | | 16 | |
| 367 | NB | 262+35 | 4 | 12 | 5.3 | | |
| 368 | SB | 262+35 | 4 | 12 | 5.3 | | |
| 369 | NB | 263+76 | 4 | 12 | 5.3 | | |
| 370 | SB | 264+80 | 6 | 12 | 8 | | |
| 371 | SB | 266+75 | 4 | 12 | 5.3 | | |
| 372 | SB | 268+05 | 6 | 12 | 8 | | |
| 373 | NB | 269+60 | 4 | 12 | 5.3 | | |
| 374 | SB | 270+26 | 4 | 12 | 5.3 | | |
| 375 | NB | 270+90 | 4 | 12 | 5.3 | | |
| 376 | SB | 270+90 | 4 | 12 | 5.3 | | |
| 377 | SB | 271+97 | 6 | 12 | 8 | | |
| 378 | NB | 271+97 | 4 | 12 | 5.3 | | |
| 379 | SB | 274+95 | 6 | 12 | 8 | | |
| 380 | SB | 275+37 | 4 | 12 | 5.3 | | |
| 381 | NB | 275+82 | 4 | 12 | 5.3 | | |
| 382 | SB | 275+82 | 4 | 12 | 5.3 | | |
| 383 | NB | 280+87 | 4 | 12 | 5.3 | | |
| 384 | SB | 280+87 | 4 | 12 | 5.3 | | |
| 385 | SB | 281+17 | 4 | 12 | 5.3 | | |
| 386 | SB | 282+22 | 4 | 12 | 5.3 | | |
| 387 | SB | 282+55 | 4 | 12 | 5.3 | | |
| 388 | SB | 283+38 | 4 | 12 | 5.3 | | |
| 389 | SB | 288+95 | 4 | 12 | 5.3 | | |
| 390 | SB | 291+45 | 6 | 12 | 8 | | |
| 391 | SB | 293+05 | 4 | 12 | 5.3 | | |
| 392 | SB | 297+70 | 4 | 12 | 5.3 | | |
| 393 | NB | 299+95 | 4 | 12 | 5.3 | | |
| 394 | NB | 303+45 | 4 | 12 | 5.3 | | |
| 395 | SB | 303+45 | 4 | 12 | 5.3 | | |
| 396 | NB | 305+85 | 4 | 12 | 5.3 | | |
| 397 | SB | 305+85 | 4 | 12 | 5.3 | | |
| 398 | NB | 306+70 | 4 | 12 | 5.3 | | |
| 399 | SB | 306+70 | 4 | 12 | 5.3 | | |
| 400 | NB | 307+55 | 4 | 12 | 5.3 | | |
| 401 | SB | 307+55 | 4 | 12 | 5.3 | | |
| TOTAL | | | | | 2528 | 160 | 364 |

MODEL: Default
 FILE: \\blmfc-pw-bentley.com\FW\DOT\Documents\DOT_Offices\Dir\Dir_7\Project\74C42\CADDData\CADD\Sheet\74C42-sbr-schedule.dgn

| | | |
|------------------------------|------------|-----------|
| USER NAME = jessica.hille | DESIGNED - | REVISED - |
| | DRAWN - | REVISED - |
| PLOT SCALE = 100,0000' / in. | CHECKED - | REVISED - |
| PLOT DATE = 3/21/2024 | DATE - | REVISED - |

**STATE OF ILLINOIS
DEPARTMENT OF TRANSPORTATION**

| SCHEDULE OF QUANTITIES | | | |
|------------------------|-------|------|---------|
| SCALE: | SHEET | OF | SHEETS |
| | | | |
| | | STA. | TO STA. |

| F.A.P. RTE. | SECTION | COUNTY | TOTAL SHEETS | SHEET NO. |
|---------------------------|-------------------|------------|--------------|-----------|
| 828 | (108,109,110)RS-4 | CUMBERLAND | 27 | 16 |
| CONTRACT NO. 74C42 | | | | |
| ILLINOIS FED. AID PROJECT | | | | |

| PERMANENT SURVEY MARKERS | | | | | | PROPOSED |
|--------------------------|-----------|-----------|--|---------|-----------------------------|--|
| Point No. | Northing | Easting | STATION | OFFSET | DESC | RESET |
| 1000 | 981204.35 | 971552.48 | PT 7+29.07 | 0.0' | ALUM. VAULT COULN'T OPEN | Remove vault and install Type I - IDOT Disk at the surface |
| 1001 | 981086.19 | 971610.13 | PC 5+92.68 | 0.0' | ALUM. VAULT COULN'T OPEN | Remove vault and install Type I - IDOT Disk at the surface |
| 1002 | 980739.17 | 971520.51 | PT 2+34.17 | 0.0' | ALUM. DISK IN VAULT | Remove vault and install Type I - IDOT Disk at the surface |
| 1003 | 980643.64 | 971495.80 | PI 1+36.50 (not the section corner) | 6.5'LT | ALUM. DISK IN VAULT | Remove vault and install Type I - IDOT Disk at the surface |
| 1004 | 980545.01 | 971495.05 | PC 0+37.84 | 0.0' | ALUM. DISK IN VAULT | Remove vault and install Type I - IDOT Disk at the surface |
| 1005 | 977424.11 | 971472.64 | PC 37+00 | 0.0' | MAG NAIL FOUND | Type I - IDOT Disk at the surface |
| 1006 | 976424.11 | 971455.38 | PI 47+00 | 2.0' RT | MAG NAIL FOUND | Type I - IDOT Disk at the surface |
| 1007 | 975424.09 | 971457.56 | PT 56+99.98 | 0.0' | MAG NAIL FOUND | Type I - IDOT Disk at the surface |
| 1008 | 972424.10 | 971474.12 | POT 87+00 | 0.0' | MAG NAIL FOUND | Type I - IDOT Disk at the surface |
| 1009 | 969424.16 | 971480.71 | POT 117+00 | 0.0' | MAG NAIL FOUND | Type I - IDOT Disk at the surface |
| 1010 | 965808.16 | 971488.63 | PC 153+15.99 | 0.0' | MAG NAIL FOUND | Type I - IDOT Disk at the surface |
| 1011 | 964808.10 | 971490.92 | PI 163+15.99 | 0.0' | MAG NAIL FOUND | Type I - IDOT Disk at the surface |
| 1012 | 963808.17 | 971494.65 | PT 173+15.99 | 0.0' | MAG NAIL FOUND | Type I - IDOT Disk at the surface |

| PERMANENT SURVEY MARKERS | | | | | | PROPOSED |
|--------------------------|-----------|-----------|--------------------------------------|----------|-----------------------------|--|
| Point No. | Northing | Easting | STATION | OFFSET | DESC | RESET |
| 1013 | 962124.24 | 971500.96 | PI 190+00 | 0.0' | MAG NAIL FOUND | Type I - IDOT Disk at the surface |
| 1014 | 959578.27 | 971510.88 | STA EQ 215+45.68 BK= 215+50 AH | 0.0' | ALUM. DISK IN VAULT | Remove vault and install Type I - IDOT Disk at the surface |
| 1015 | 956760.35 | 971521.24 | POT 243+68.08 | 0.0' | ALUM. DISK IN VAULT | Remove vault and install Type I - IDOT Disk at the surface |
| 1016 | 950298.98 | 971537.38 | PC 308+40.9 | 0.0' | ALUM. VAULT COULN'T OPEN | Remove vault and install Type I - IDOT Disk at the surface |
| 1020 | 972759.62 | 971469.75 | Sec Corn 83+64.5 | 4.5' Rt | NAIL FOUND | Mag nail |
| 1021 | 970100.66 | 971478.83 | Sec Corn? 110+23.5 | 0.6' RT. | MAG NAIL FOUND | Mag nail |
| 1022 | 964822.10 | 971490.86 | SEC COR 163+02 | 0.0' | MAG NAIL FOUND | Mag nail |
| 1023 | 962181.15 | 971503.91 | Sec Corn 189+43 | 3.1' LT | PK NAIL FOUND | Mag nail |
| 1024 | 959540.26 | 971507.38 | Sec Corn 215+88 | 3.0' RT | I.P. IN ALUM. VAULT | Remove vault and install Type I - IDOT Disk at the surface |
| 1025 | 956914.34 | 971512.14 | Sec Corn 242+14 | 8.5' RT. | I.P. W/ ALUM. CAP | Type I - IDOT Disk at the surface |
| 1026 | 951623.77 | 971530.79 | Sec Corn? 295+16.5 | 2.7' RT. | ALUM. DISK IN VAULT | Remove vault and install Type I - IDOT Disk at the surface |
| 1029 | 952945.63 | 971523.63 | Sec Corn 281+83 | 6.4' RT | MAG NAIL FOUND | Mag nail |
| TOTAL= | | | | | | 25 |

MODEL: Default
 FILE: \\malfp-pw-bentley.com\P\INDOT\Documents\IDOT_Offices\Dir\rdt_7\Project\74C42\CADDData\CAD\Sheet\74C42-ah-schedule.dgn

| | | |
|-------------------------------|------------|-----------|
| USER NAME = jessica.hille | DESIGNED - | REVISED - |
| | DRAWN - | REVISED - |
| PLOT SCALE = 100,0000 ' / in. | CHECKED - | REVISED - |
| PLOT DATE = 3/21/2024 | DATE - | REVISED - |

**STATE OF ILLINOIS
DEPARTMENT OF TRANSPORTATION**

SCHEDULE OF QUANTITIES

SCALE: SHEET OF SHEETS STA. TO STA.

| | | | | |
|---------------------------|-------------------|------------|-----------------|--------------|
| F.A.P. RTE. | SECTION | COUNTY | TOTAL SHEETS | SHEET NO. |
| 828 | (108,109,110)RS-4 | CUMBERLAND | 27 | 17 |
| CONTRACT NO. 74C42 | | | | |
| ILLINOIS FED. AID PROJECT | | | | |

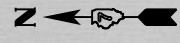

| SHOULDER PATCHING/WIDENING | | | | | | | | | |
|----------------------------|-------|------|------|--------|-------|--------------------|------------------------|-------------------------------|-----------------------------|
| LOCATION | | | | LENGTH | WIDTH | HMA SHOULDER WIDTH | PAVED SHOULDER REMOVAL | HOT-MIX ASPHALT SHOULDER, 10' | EARTH EXCAVATION (WIDENING) |
| | LT/RT | STA. | TO | | | | | | |
| LT | 7+94 | | 6+04 | 190 | 3 | 6 | 63.3 | 126.7 | 17.6 |
| LT | 6+04 | | 5+84 | 20 | 0 | VAR | 0 | 17.8 | 4.9 |
| LT | 5+84 | | 3+54 | 230 | 0 | 10 | 0 | 255.6 | 71.0 |
| LT | 3+54 | | 2+54 | 100 | 0 | VAR | 0 | 83.3 | 23.1 |
| RT | 7+94 | | 5+31 | 263 | 3 | 10 | 87.7 | 292.2 | 56.8 |
| RT | 5+31 | | 4+79 | 52 | 0 | 10 | 0 | 57.8 | 16.0 |
| RT | 4+79 | | 3+79 | 100 | 0 | VAR | 0 | 83.3 | 23.1 |
| TOTAL | | | | | | | 151 | 419 | 213 |

MODEL: Default
 FILE: \\blmfe-pw-bentley.com\FW\DOT\Documents\DOT Office\Dir\dir 7\Project\74C42\CADD\Drawings\74C42-ehb-418n.dwg

| | | |
|------------------------------|------------|-----------|
| USER NAME = jessica.hille | DESIGNED - | REVISED - |
| | DRAWN - | REVISED - |
| PLOT SCALE = 100,0000' / in. | CHECKED - | REVISED - |
| PLOT DATE = 3/21/2024 | DATE - | REVISED - |

STATE OF ILLINOIS
DEPARTMENT OF TRANSPORTATION

| | | | |
|------------------------------|-------|----|--------|
| RT 45 /ILL 121 DETAIL | | | |
| SCALE: | SHEET | OF | SHEETS |
| | STA. | TO | STA. |

| | | | | |
|---------------------------|-------------------|-----------|--------------------|-----------|
| F.A.P. RTE. | SECTION | COUNTY | TOTAL SHEETS | SHEET NO. |
| 828 | (108,109,110)RS-4 | EFFINGHAM | 27 | 18 |
| | | | CONTRACT NO. 74C42 | |
| ILLINOIS FED. AID PROJECT | | | | |

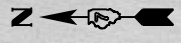

— STA 11+70
 X STA 11+95
 — STA 12+20

▨ STA 16+28

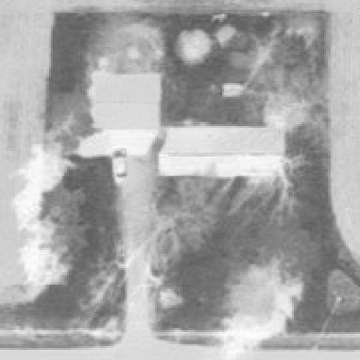

MODEL: Default
 FILE: \\mifs-pw-backend.com\PW\DOT\Documents\DOT Office\Dir\rdt_7\Projects\74C42\CADD\DATA\CAD\Sheets\74C42-eh-rls.dgn

| | | |
|------------------------------|------------|-----------|
| USER NAME = jessica.ville | DESIGNED - | REVISED - |
| PLOT SCALE = 100,0000' / in. | DRAWN - | REVISED - |
| PLOT DATE = 3/21/2024 | CHECKED - | REVISED - |
| | DATE - | REVISED - |

**STATE OF ILLINOIS
 DEPARTMENT OF TRANSPORTATION**

RT 45 / ILL 121 DETAIL

SCALE: SHEET OF SHEETS STA. TO STA.

| F.A.P. RTE. | SECTION | COUNTY | TOTAL SHEETS | SHEET NO. |
|---------------------------|-------------------|-----------|--------------|-----------|
| 828 | (108,109,110)RS-4 | EFFINGHAM | 27 | 19 |
| CONTRACT NO. 74C42 | | | | |
| ILLINOIS FED. AID PROJECT | | | | |



STA 308+40.9
POINT NO. 1016
ALUM. DISK

LANE LINE
EXTENSIONS

END STA 105+00
MONTROSE BLACKTOP

END STA 313+00
ILL 121

PAVEMENT MARKING LEGEND

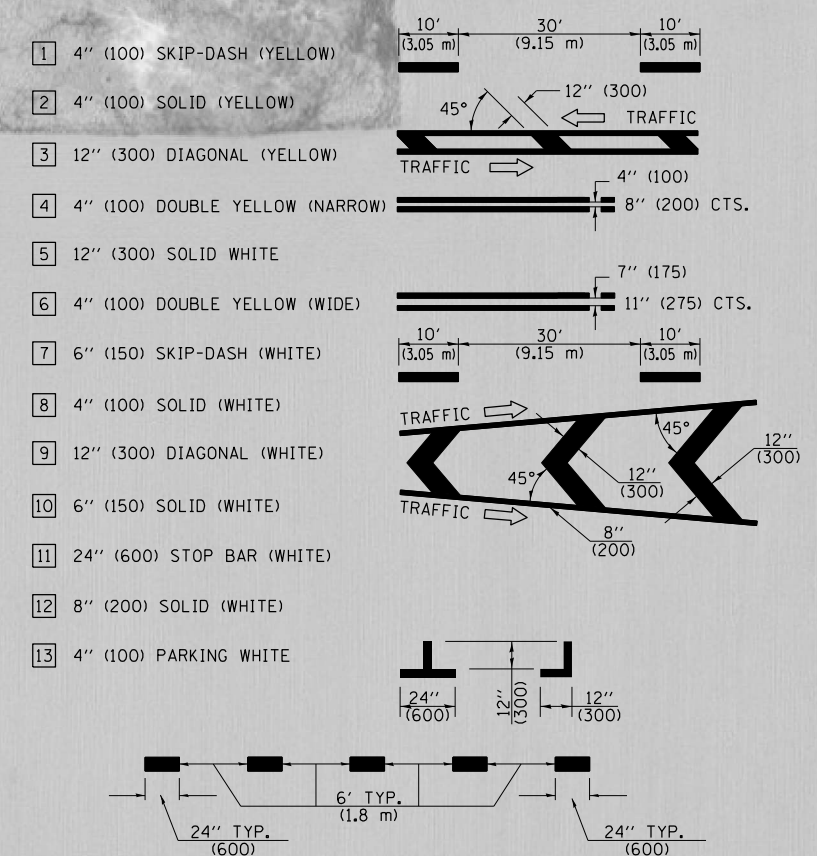

LANE LINE EXTENSIONS

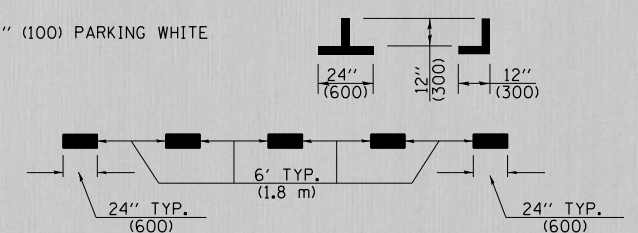

MODEL: Default
FILE: \\na11e01.pw.bentley.com\PIV\DOT\Documents\DOT Office\District 7\Projects\74C42\CADDData\CAD\Sheets\74C42-rlr-pln.dwg

| | | |
|-------------------------------|------------|-----------|
| USER NAME = jessica.ville | DESIGNED - | REVISED - |
| | DRAWN - | REVISED - |
| PLOT SCALE = 100,0000 ' / in. | CHECKED - | REVISED - |
| PLOT DATE = 3/21/2024 | DATE - | REVISED - |

STATE OF ILLINOIS
DEPARTMENT OF TRANSPORTATION

ILL 121 /MONTROSE BLACKTOP DETAIL

SCALE: SHEET OF SHEETS STA. TO STA.

| | | | | |
|---------------------------|-------------------|-----------|--------------|-----------|
| F.A.P. RTE. | SECTION | COUNTY | TOTAL SHEETS | SHEET NO. |
| 828 | (108,109,110)RS-4 | EFFINGHAM | 27 | 20 |
| CONTRACT NO. 74C42 | | | | |
| ILLINOIS FED. AID PROJECT | | | | |

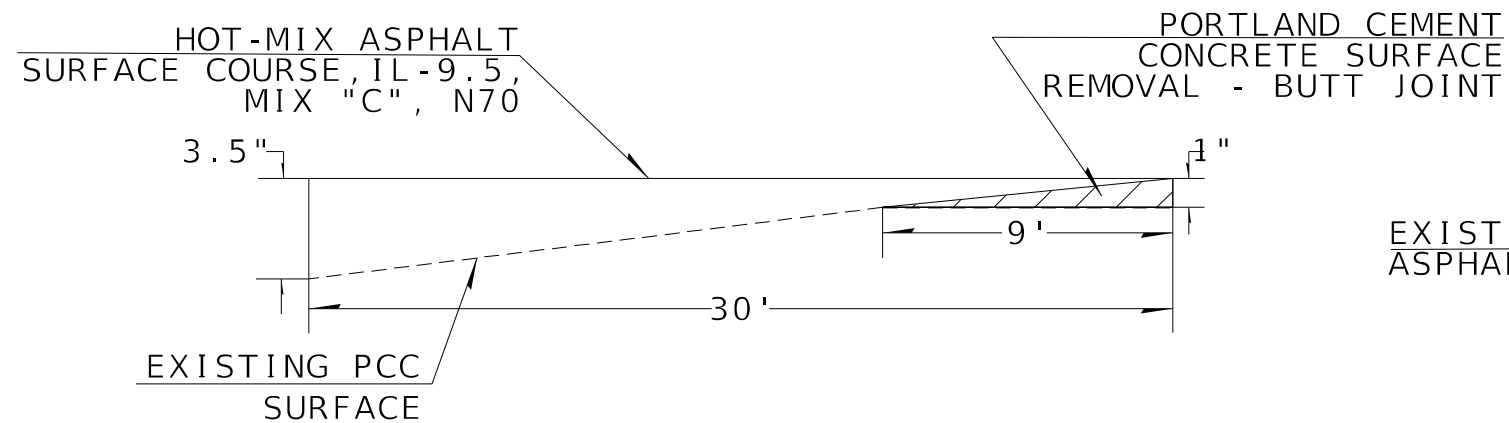

PROFILE C

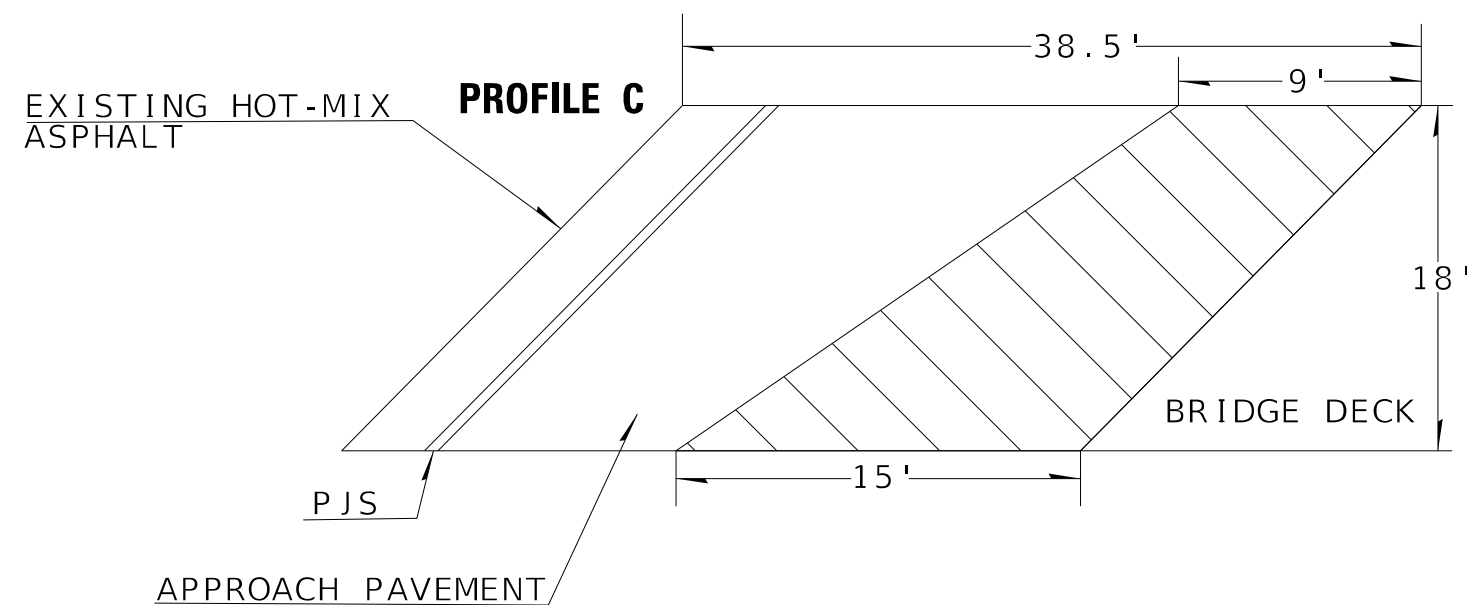

NORTHBOUND APPROACH

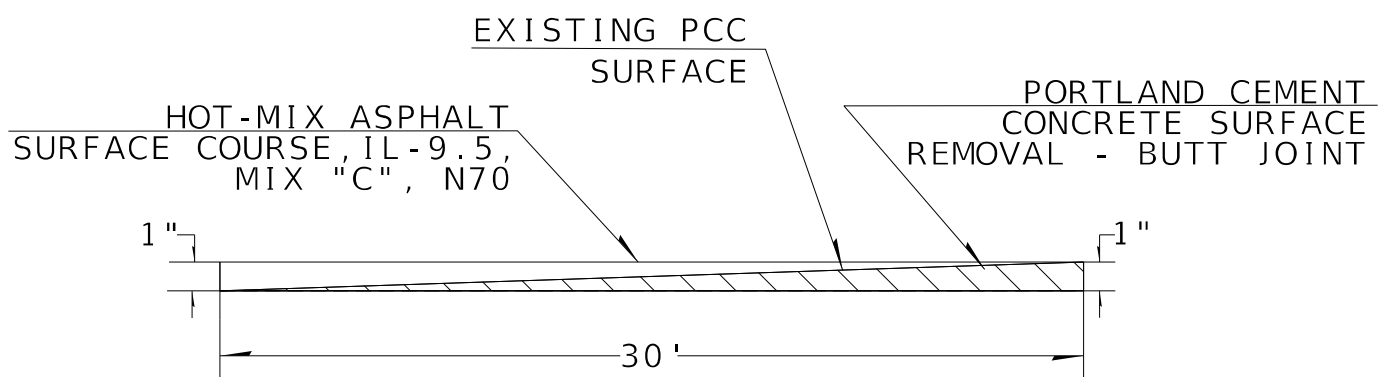

PROFILES A & B

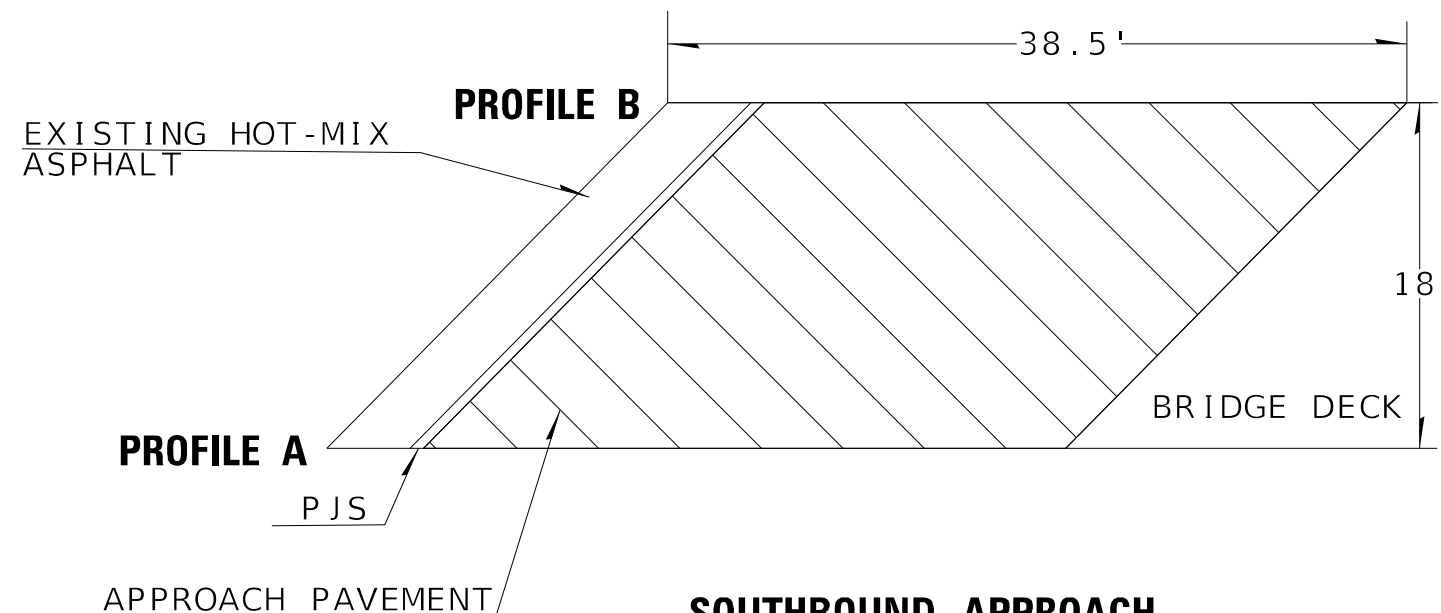

SOUTHBOUND APPROACH

NOTE: SEE SPECIAL PROVISION HOT-MIX ASPHALT SURFACE COURSE

MODEL: Default
 FILE: Mainfile.pia
 SUBJECT: pav.bentley.com/PIV/DOT/Document/1/DOT Office/Dir/Dir: 7/Project/17AC13/CADDData/CADD/Sheet/17AC13-Sub-1.dwg

| | | |
|------------------------------|------------|-----------|
| USER NAME = jessica.wille | DESIGNED - | REVISED - |
| | DRAWN - | REVISED - |
| PLOT SCALE = 100,0000' / in. | CHECKED - | REVISED - |
| PLOT DATE = 3/21/2024 | DATE - | REVISED - |

**STATE OF ILLINOIS
DEPARTMENT OF TRANSPORTATION**

**APPROACH PAVMENT DETAIL
STRUCTURE NO.018-0066**

SCALE: SHEET OF SHEETS STA. TO STA.

| F.A.P. RTE. | SECTION | COUNTY | TOTAL SHEETS | SHEET NO. |
|---------------------------|-------------------|-----------|--------------|-----------|
| 828 | (108,109,110)RS-4 | EFFINGHAM | 27 | 21 |
| CONTRACT NO. 74C42 | | | | |
| ILLINOIS FED. AID PROJECT | | | | |

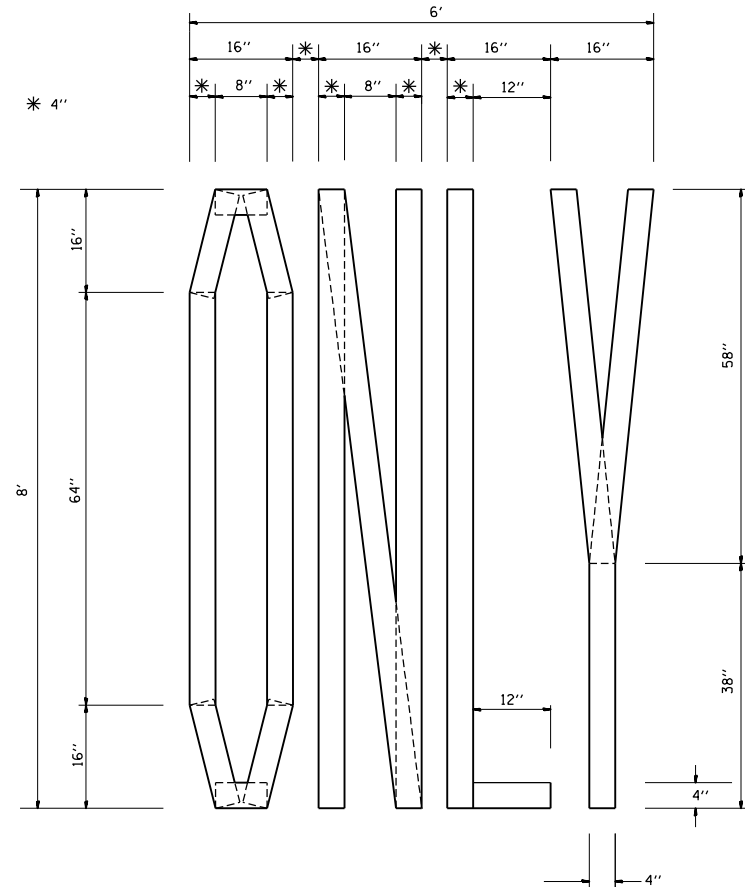

QUANTITY
 4" LINE = 63.2 FT.
 21.0 SQ. FT.

SHORT TERM STOP BAR

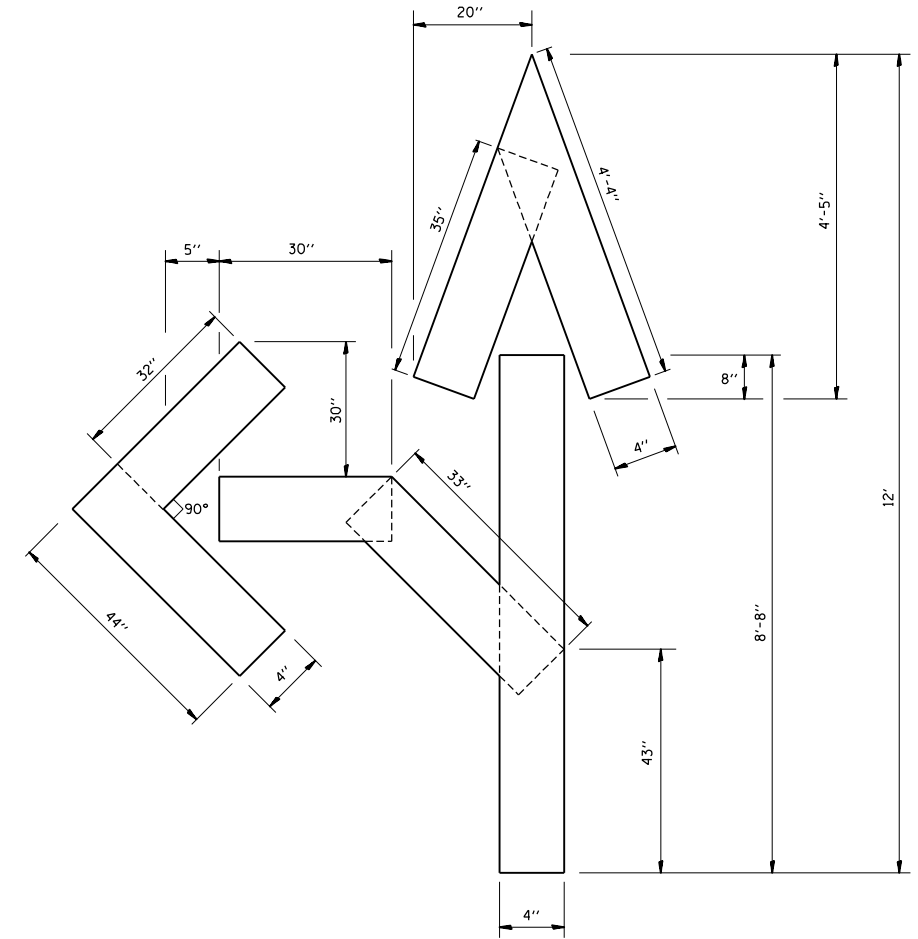

QUANTITY
 4" LINE = 27.5 FT.
 9.2 SQ. FT.

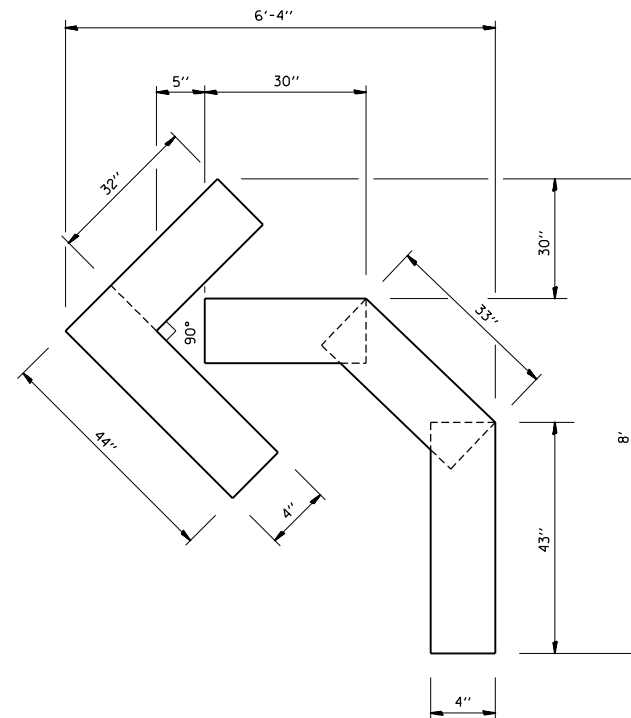

QUANTITY
 4" LINE = 15.2 FT.
 5.0 SQ. FT.

MODEL: Default
 FILE: M:\MFC_Plan\Subect-pw-bead-fay.com\FW\DOT\Documents\DOT_Offices\Dir\drf_7\Project\74C42\CADDData\CAD\Sheet\74C42-sht-details.dgn

| | | |
|-------------------------------|------------|-----------|
| USER NAME = jessica.wille | DESIGNED - | REVISED - |
| PLOT SCALE = 100,0000 ' / in. | DRAWN - | REVISED - |
| PLOT DATE = 3/21/2024 | CHECKED - | REVISED - |
| | DATE - | REVISED - |

STATE OF ILLINOIS
 DEPARTMENT OF TRANSPORTATION

PAVEMENT MARKING LETTERS AND SYMBOLS
 FOR TRAFFIC STAGING

SCALE: SHEET OF SHEETS STA. TO STA.

| F.A.P. RTE. | SECTION | COUNTY | TOTAL SHEETS | SHEET NO. |
|---------------------------|-------------------|------------|--------------|-----------|
| 828 | (108,109,110)RS-4 | CUMBERLAND | 27 | 22 |
| CONTRACT NO. 74C42 | | | | |
| ILLINOIS FED. AID PROJECT | | | | |

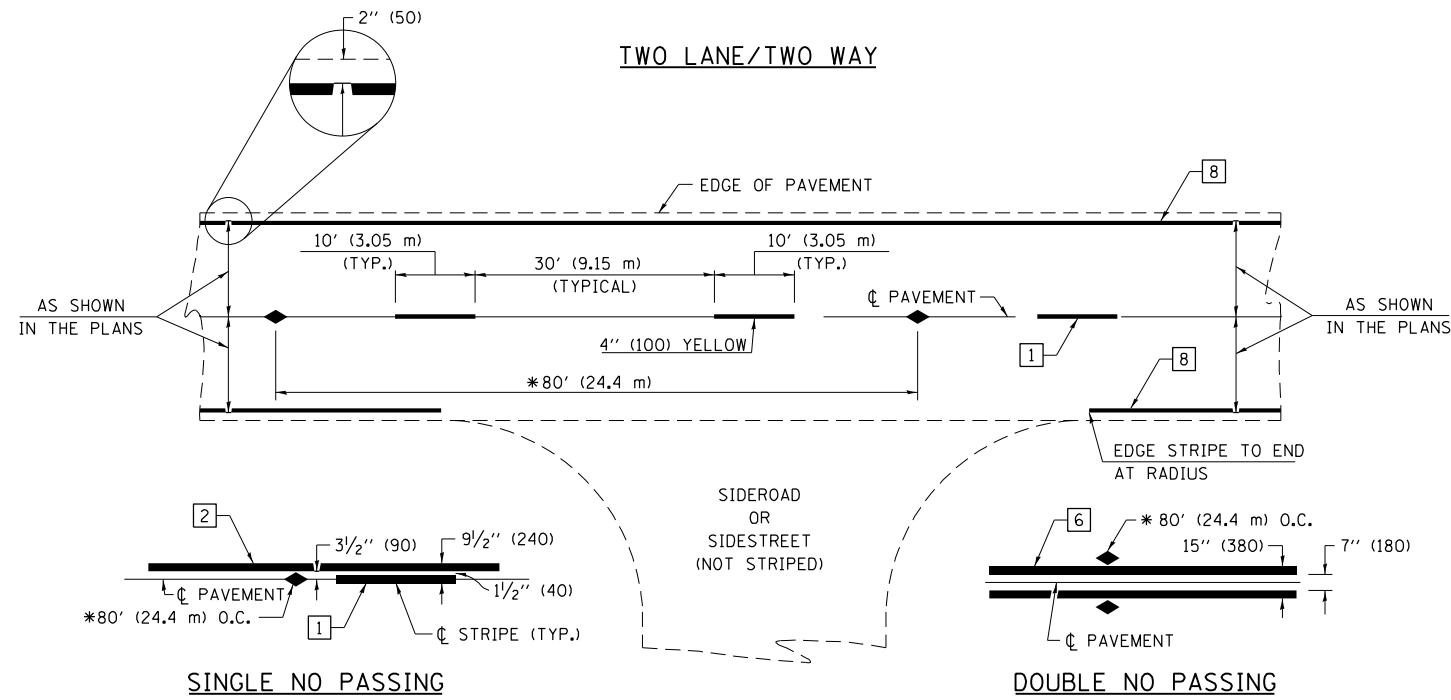

* REDUCE TO 40' (12.2 m) O.C. ON CURVES WITH POSTED OR ADVISORY SPEEDS OF 45 mph (70 km/h) OR LESS.

PAVEMENT MARKING LEGEND

- 1 4" (100) SKIP-DASH (YELLOW)
- 2 4" (100) SOLID (YELLOW)
- 3 12" (300) DIAGONAL (YELLOW)
- 4 4" (100) DOUBLE YELLOW (NARROW)
- 5 12" (300) SOLID WHITE
- 6 4" (100) DOUBLE YELLOW (WIDE)
- 7 6" (150) SKIP-DASH (WHITE)
- 8 4" (100) SOLID (WHITE)
- 9 12" (300) DIAGONAL (WHITE)
- 10 6" (150) SOLID (WHITE)
- 11 24" (600) STOP BAR (WHITE)
- 12 8" (200) SOLID (WHITE)
- 13 4" (100) PARKING WHITE

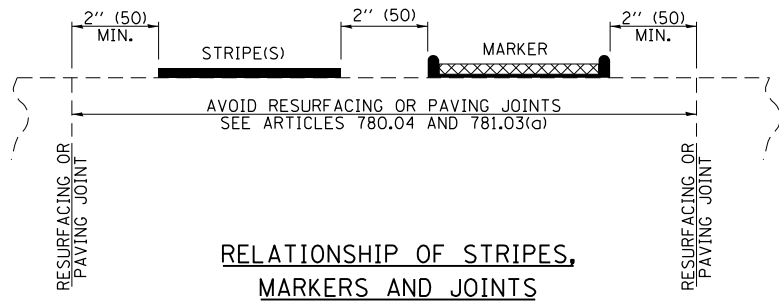

TYPICAL PAVEMENT MARKERS LEGEND

- ◆ TWO-WAY AMBER MARKER
- ▶ ONE-WAY AMBER MARKER
- ▷ ONE-WAY CRYSTAL MARKER

RAISED REFLECTIVE PAVEMENT MARKERS

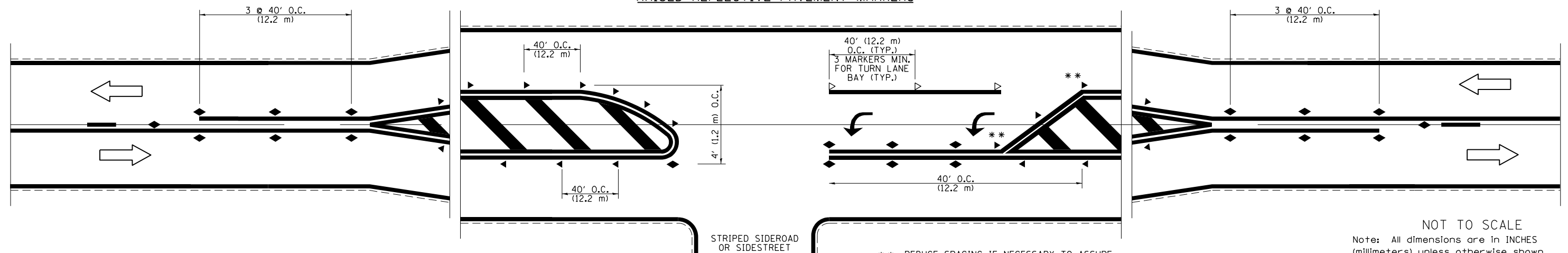

** REDUCE SPACING IF NECESSARY TO ASSURE MARKERS AT CORNER POINTS.

NOT TO SCALE
Note: All dimensions are in INCHES (millimeters) unless otherwise shown.

DISTRICT 7 DETAIL NO. 78000001

| | | | |
|---|---------------------------|------------|---------------------|
| FILE NAME = | USER NAME = jessica.hille | DESIGNED - | REVISED - NAS 06/22 |
| pw:\idot-pw\bentley.com\PIWIDOT\Documents\IDOT Offices\District 7\Projects\74C42\CADD\Drawings\Drawings\74C42-8ht-details.dgn | | CHECKED - | REVISED - |
| PLOT SCALE = 100.0000' / in. | | DATE - | REVISED - |
| PLOT DATE = 3/21/2024 | | | |

**STATE OF ILLINOIS
DEPARTMENT OF TRANSPORTATION**

**PAVEMENT MARKING AND RAISED REFLECTIVE PAVEMENT MARKERS
(RURAL & URBAN APPLICATIONS)**

SCALE: SHEET NO. 1 OF 4 SHEETS STA. TO STA.

| F.A.P. RTE. | SECTION | COUNTY | TOTAL SHEETS | SHEET NO. |
|---------------------------|-------------------|------------|--------------|-----------|
| 828 | (108,109,110)RS-4 | CUMBERLAND | 27 | 23 |
| CONTRACT NO. 74C42 | | | | |
| ILLINOIS FED. AID PROJECT | | | | |

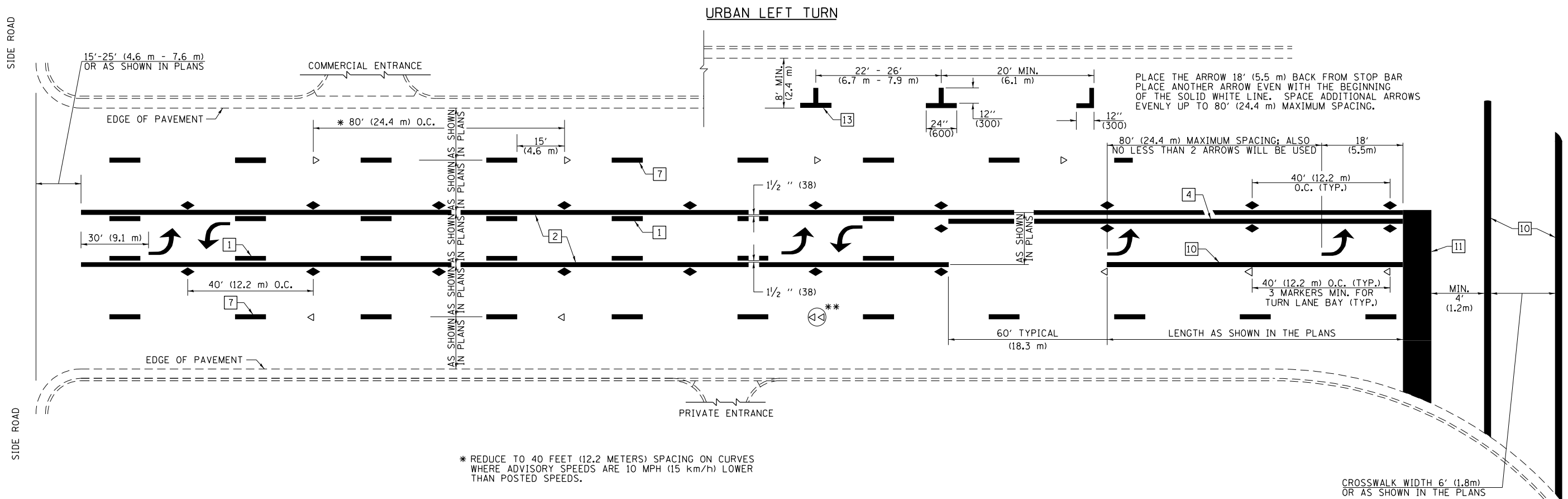

* REDUCE TO 40 FEET (12.2 METERS) SPACING ON CURVES WHERE ADVISORY SPEEDS ARE 10 MPH (15 km/h) LOWER THAN POSTED SPEEDS.

** DOUBLE LANE LINE MARKERS SHALL BE SPECIFIED AND SPACED AS SHOWN IN HIGHWAY STANDARD 781001 FOR MULTI-LANE DIVIDED AND UNDIVIDED HIGHWAYS.

PAVEMENT MARKING LEGEND

- 1 4" (100) SKIP-DASH (YELLOW)
- 2 4" (100) SOLID (YELLOW)
- 3 12" (300) DIAGONAL (YELLOW)
- 4 4" (100) DOUBLE YELLOW (NARROW)
- 5 12" (300) SOLID WHITE
- 6 4" (100) DOUBLE YELLOW (WIDE)
- 7 6" (150) SKIP-DASH (WHITE)
- 8 4" (100) SOLID (WHITE)
- 9 12" (300) DIAGONAL (WHITE)
- 10 6" (150) SOLID (WHITE)
- 11 24" (600) STOP BAR (WHITE)
- 12 8" (200) SOLID (WHITE)
- 13 4" (100) PARKING WHITE

GENERAL NOTES

1. TURN ARROW PAIRS SHALL BE PLACED AT 250' (75 m) INTERVALS AND SHALL BE EVENLY SPACED BETWEEN BOTH ENDS OF THE BIDIRECTIONAL LEFT TURN LANE. USE A MINIMUM OF TWO PAIRS PER BLOCK.
2. THE SOLID YELLOW PAVEMENT MARKINGS [2] SHOULD GENERALLY START OR END NEAR THE RADIUS POINT OF EACH STREET RETURN EXCEPT WHERE ONE OR BOTH ENDS WOULD INCLUDE STOP BARS.
3. THE SKIP-DASH PAVEMENT MARKINGS [1] OR [7] SHOULD BE CENTERED BETWEEN BOTH ENDS OF EACH CITY BLOCK AND SHALL BE PLACED SO THEY LINE UP ACROSS FROM EACH OTHER.
4. USE LARGE ARROW SIZE FOR BOTH RURAL AND URBAN LOCATIONS. (SEE SECTION 780 FOR SYMBOLS TABLE)
5. LANE LINE EXTENSIONS SHALL BE THE SAME COLOR AND WIDTH AS THE LANE LINE BEING EXTENDED.
6. ALL WHITE SKIP-DASH LINES SHALL BE 6" IN WIDTH.

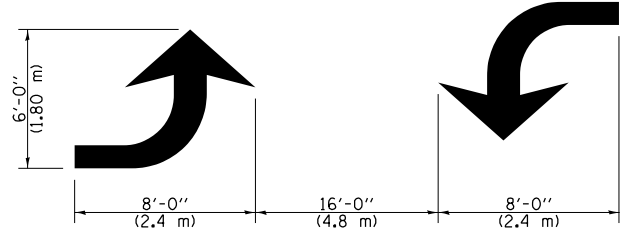
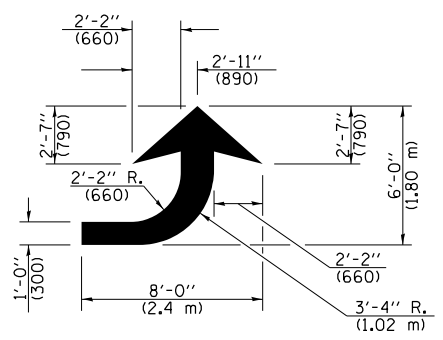
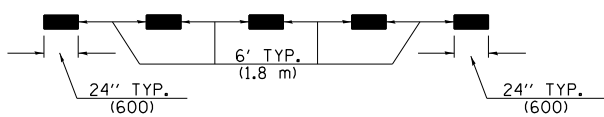
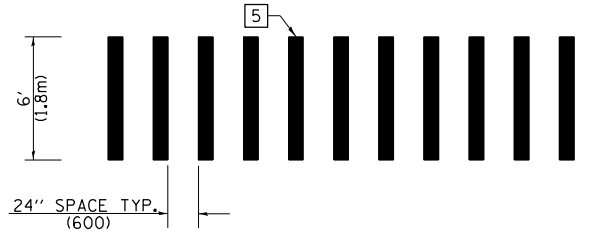

LEFT ARROW

REVERSE FOR RIGHT ARROW
AREA = 15.6 SQ. FT. (1.47 m²)
(WHITE)

TYPICAL DOUBLE TURN ARROWS (WHITE)

NOT TO SCALE

Note: All dimensions are in INCHES (millimeters) unless otherwise shown.

DISTRICT 7 DETAIL NO. 7800001

| | | | | | | | | | | |
|--|---------------------------|------------|---------------------|---|---|---------------------------|-------------------|------------|--------------|-----------|
| FILE NAME = | USER NAME = jessica.hille | DESIGNED - | REVISED - NAS 06/22 | STATE OF ILLINOIS DEPARTMENT OF TRANSPORTATION | PAVEMENT MARKING AND RAISED REFLECTIVE PAVEMENT MARKERS (RURAL & URBAN APPLICATIONS) | F.A.P. RTE. | SECTION | COUNTY | TOTAL SHEETS | SHEET NO. |
| pw:\idot-pw\Bentley.com\PWIDOT\Documents\IDOT Offices\District 7\Projects\74C42\CADD\Drawings\Drawings\74C42-sht-details.dgn | DRAWN | CHECKED - | REVISED - | | | 828 | (108,109,110)RS-4 | CUMBERLAND | 27 | 24 |
| PLOT SCALE = 100.0000' / 1" | CHECKED - | REVISED - | REVISED - | | | CONTRACT NO. 74C42 | | | | |
| PLOT DATE = 3/21/2024 | DATE - | REVISED - | REVISED - | | | ILLINOIS FED. AID PROJECT | | | | |

ISLANDS

OPTION 1

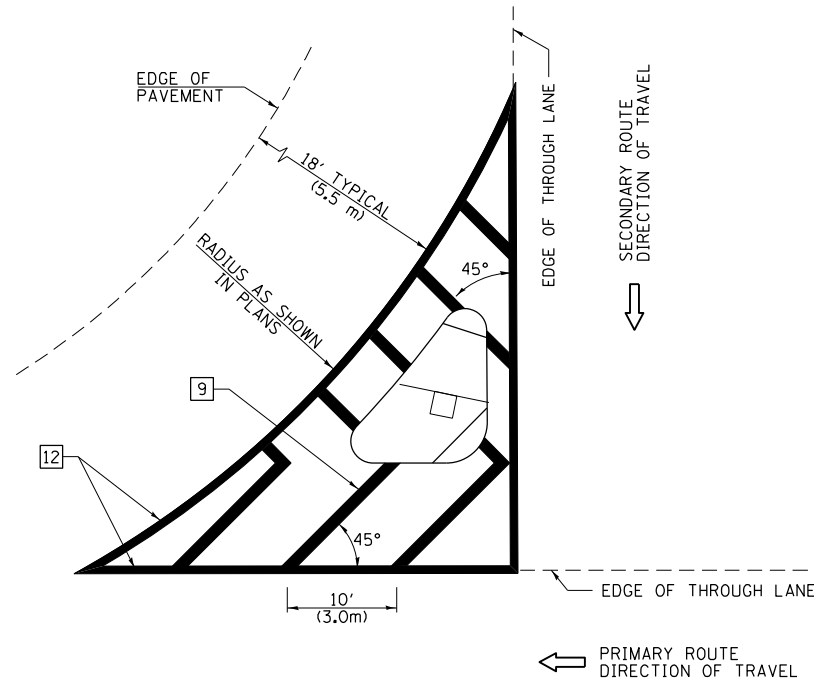

GENERAL NOTES

1. RAISED AND CORRUGATED MEDIANS SHALL BE OUTLINED WITH [2].
2. SOME OF THE INFORMATION INCLUDED WITH THIS DETAIL MAY NOT BE APPLICABLE TO THIS IMPROVEMENT.
3. PAVEMENT MARKINGS ARE TO BE EXTENDED THROUGH OMISSIONS WHEN APPLICABLE.
4. FINAL PAVEMENT MARKINGS SHALL BE IN PLACE PRIOR TO PLACING ANY RAISED REFLECTIVE PAVEMENT MARKERS.
5. THE FOLLOWING CRITERIA SHALL BE USED FOR SELECTING THE DIAGONAL PAVEMENT MARKING SPACING:

| | |
|------------------------|-------------|
| < 30 MPH (< 50 km/h) | 15' (4.5 m) |
| 30-45 MPH (50-75 km/h) | 20' (6.0 m) |
| > 45 MPH (> 75 km/h) | 30' (9.0 m) |
6. THE USE OF ISLAND STRIPING OPTION 1 OR OPTION 2 SHALL BE AS SHOWN ON THE PLANS.

PAVEMENT MARKING LEGEND

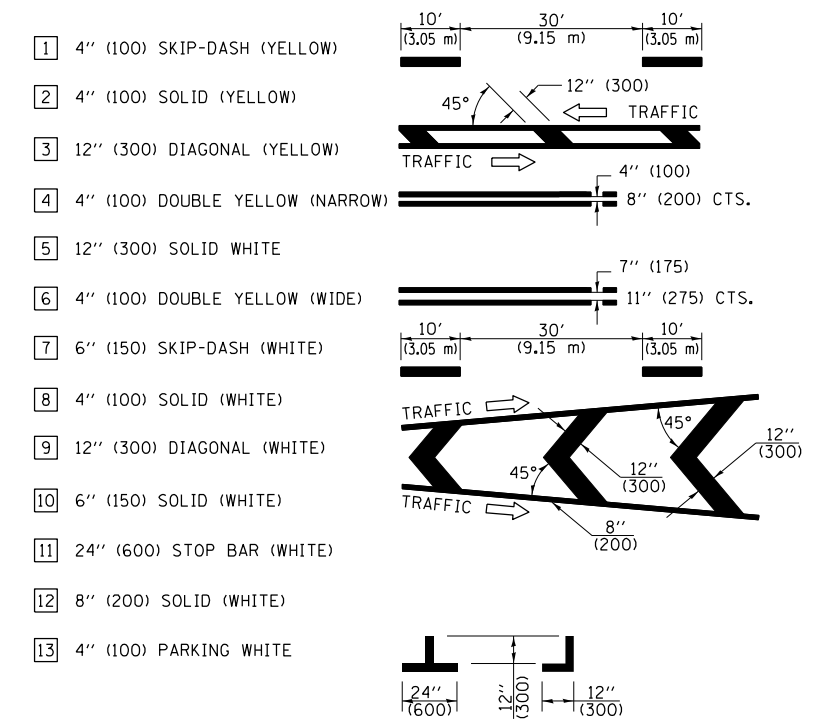

OPTION 2

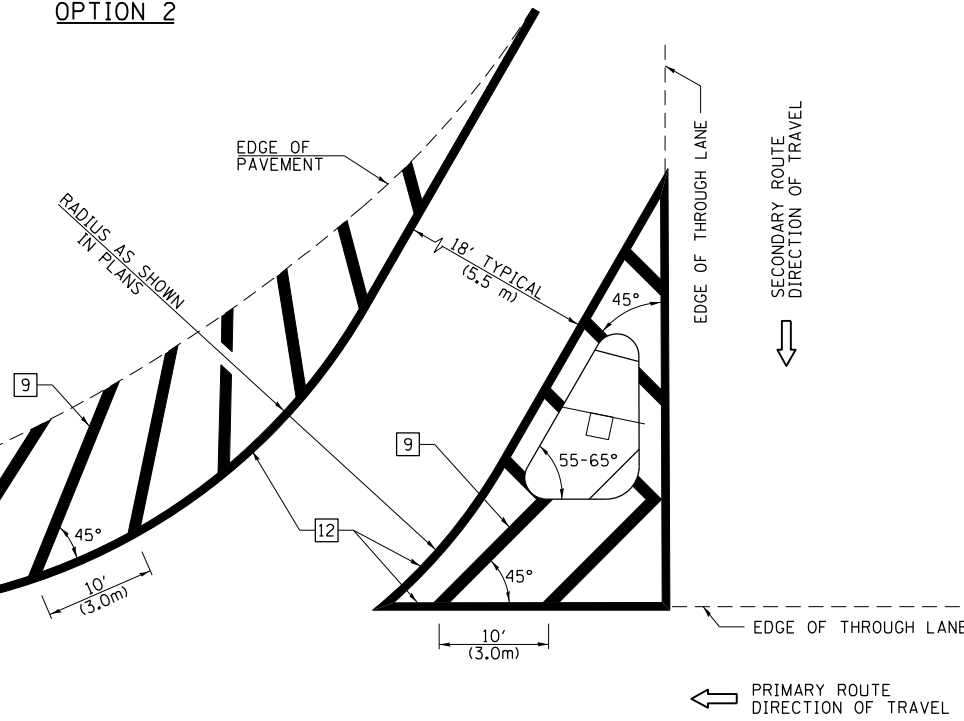

RURAL LEFT TURN STRIPING

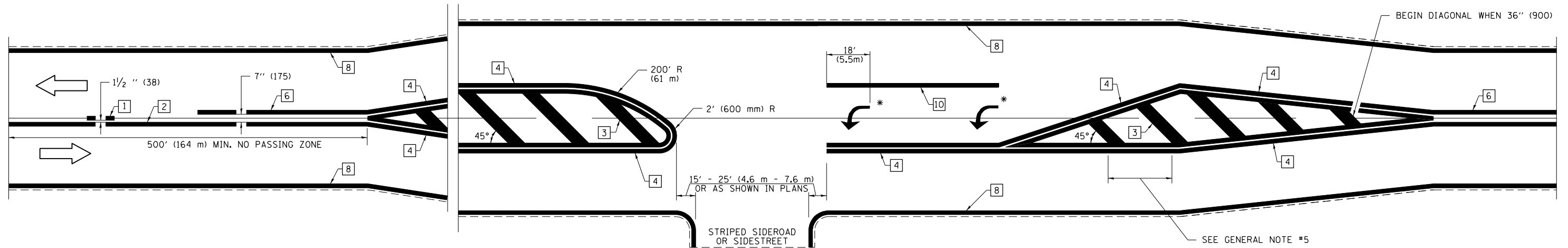

* PLACE AN ARROW 18' (5.5 m) BACK FROM END OF THE SOLID WHITE LINE. PLACE ANOTHER ARROW EVEN WITH THE BEGINNING OF THE SOLID WHITE LINE. SPACE ADDITIONAL ARROWS EVENLY UP TO 80' (24.4 m) MAXIMUM SPACING. USE MINIMUM OF 2 ARROWS.

NOT TO SCALE

Note: All dimensions are in INCHES (millimeters) unless otherwise shown.

DISTRICT 7 DETAIL NO. 7800001

| | | | |
|---|---------------------------|------------|---------------------|
| FILE NAME = | USER NAME = jessica.hille | DESIGNED - | REVISED - NAS 06/22 |
| p:\dot-pw-bentley.com\PWIDOT\Documents\DOT Offices\District 7\Projects\74C42\CADD\Drawings\Drawings\74C42-sht-details.dgn | | CHECKED - | REVISED - |
| | | DATE - | REVISED - |

**STATE OF ILLINOIS
DEPARTMENT OF TRANSPORTATION**

**PAVEMENT MARKING AND RAISED REFLECTIVE PAVEMENT MARKERS
(RURAL & URBAN APPLICATIONS)**

SCALE: SHEET NO. 3 OF 4 SHEETS STA. TO STA.

| F.A.P. RTE. | SECTION | COUNTY | TOTAL SHEETS | SHEET NO. |
|---------------------------|-------------------|------------|--------------|-----------|
| 828 | (108,109,110)RS-4 | CUMBERLAND | 27 | 25 |
| CONTRACT NO. 74C42 | | | | |
| ILLINOIS FED. AID PROJECT | | | | |

SUPPLEMENTAL PAVEMENT MARKING TREATMENT FOR RAILROAD-HIGHWAY GRADE CROSSING

PAVEMENT MARKING LEGEND

PAVEMENT MARKINGS AT RAILROAD-HIGHWAY GRADE CROSSING

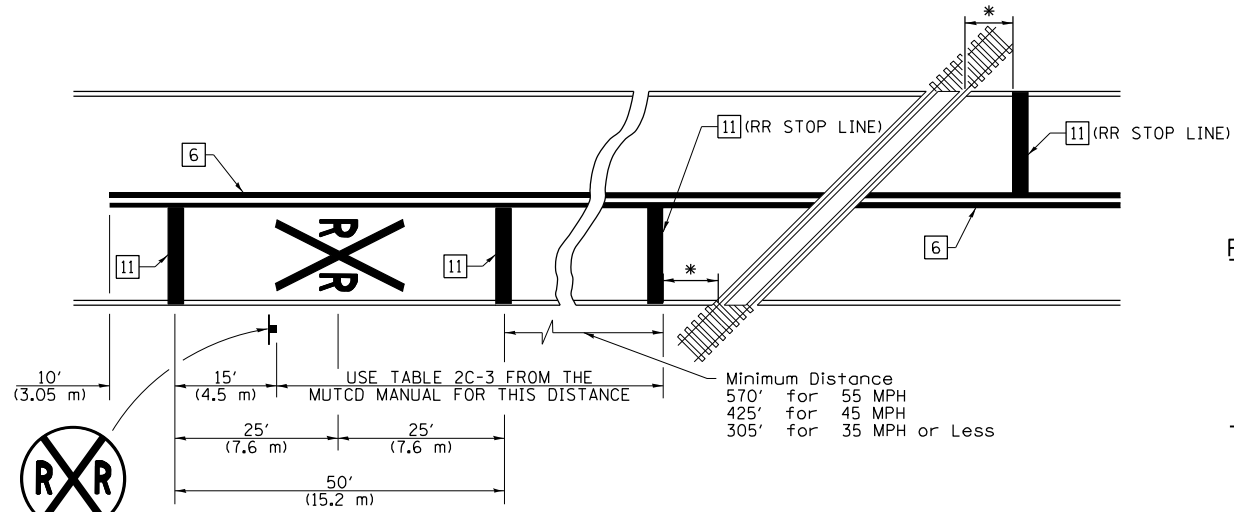

NOTES

THE TRAVERSE SPREAD OF THE "X" MAY VARY ACCORDING TO LANE WIDTH.

ON MULTI-LANE ROADS, THE STOP LINES SHALL EXTEND ACROSS ALL APPROACH LANES AND SEPARATE RRR SYMBOLS SHALL BE PLACED ADJACENT TO EACH OTHER IN EACH LANE.

WHEN THE PAVEMENT MARKING SYMBOL IS USED, A PORTION OF THE SYMBOL SHOULD BE LOCATED DIRECTLY ADJACENT TO THE ADVANCE WARNING SIGN (W10-1) AS PLACED BY TABLE II-1, CONDITION B OF THE MUTCD.

RAILROAD CROSSING WITH NON-SIGNALIZED INTERSECTION

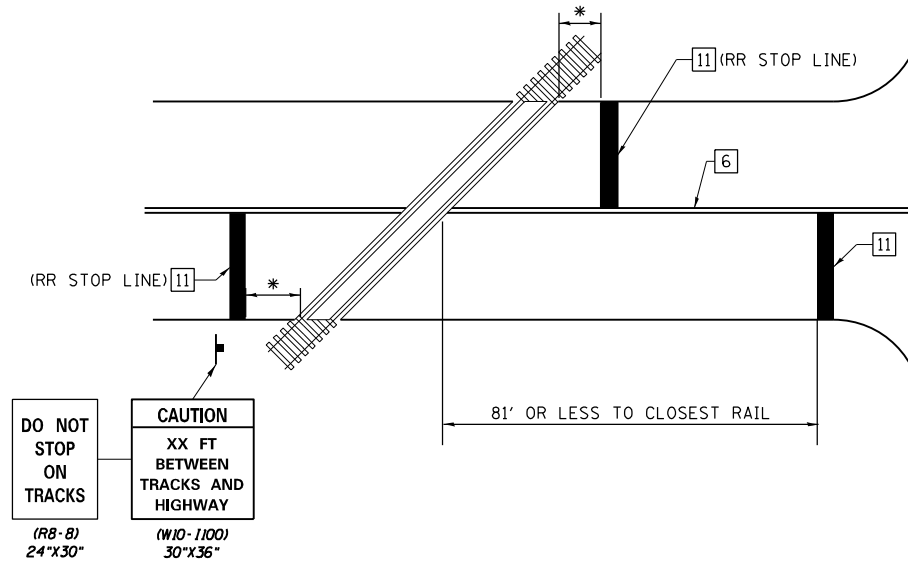

RAILROAD CROSSING WITH INTERCONNECT AND PRE-SIGNALS

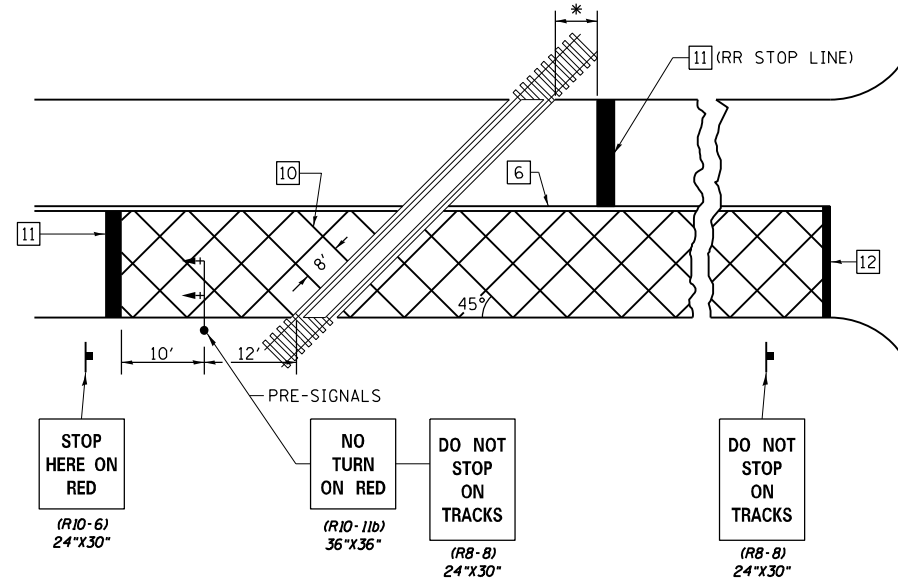
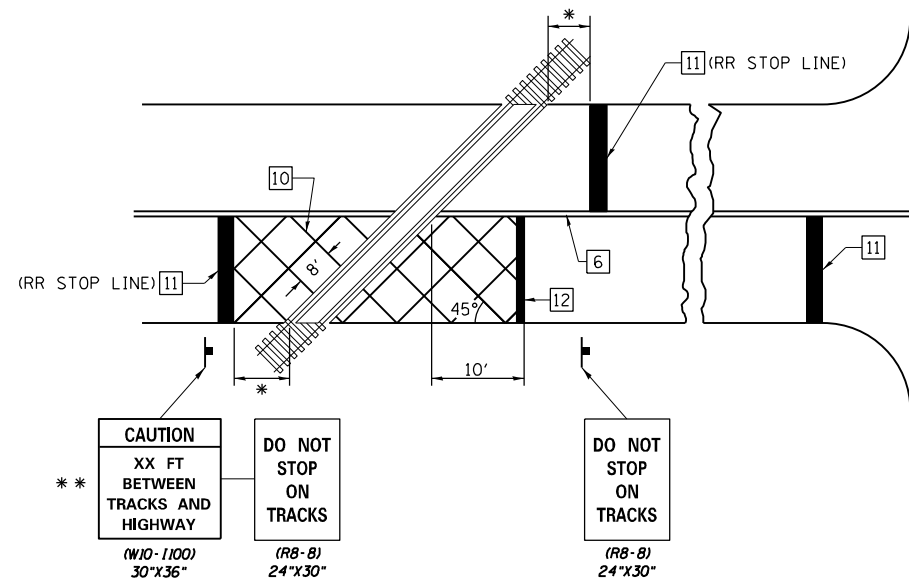

- 1 4" (100) SKIP-DASH (YELLOW)
- 2 4" (100) SOLID (YELLOW)
- 3 12" (300) DIAGONAL (YELLOW)
- 4 4" (100) DOUBLE YELLOW (NARROW)
- 5 12" (300) SOLID WHITE
- 6 4" (100) DOUBLE YELLOW (WIDE)
- 7 6" (150) SKIP-DASH (WHITE)
- 8 4" (100) SOLID (WHITE)
- 9 12" (300) DIAGONAL (WHITE)
- 10 6" (150) SOLID (WHITE)
- 11 24" (600) STOP BAR (WHITE)
- 12 8" (200) SOLID (WHITE)
- 13 4" (100) PARKING WHITE

GENERAL NOTES

- SUPPLEMENTAL PAVEMENT MARKINGS TO BE INSTALLED ONLY ON APPROACHES TO INTERSECTIONS CONTROLLED BY TRAFFIC SIGNALS WHICH ARE INTERCONNECTED WITH THE RAILROAD WARNING SIGNALS.
- EXTEND PAVEMENT MARKINGS TO THE INTERSECTION ONLY WHERE PRE-SIGNALS ARE USED.
- WHEN PEDESTRIAN SIGNALS ARE PRESENT WITH INTERCONNECTED SIGNALS, WARNING SIGN W10-1101 (18"X24") SHALL BE PLACED NEAR EACH PEDESTRIAN SIGNAL HEAD. COUNTDOWN PEDESTRIAN SIGNAL HEADS SHALL NOT BE UTILIZED ALONG WITH INTERCONNECTED SIGNALS.
- PLEASE REFER TO THE IDOT BUREAU OF OPERATION MEMO OPS T-06 DATED DECEMBER 1, 2020 FOR ADDITIONAL INFORMATION

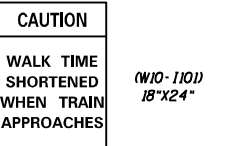

* 15' FROM NEAR RAIL OR 8' FROM AND PARALLEL TO GATE IF PRESENT

** WARNING SIGN W10-1100 SHALL BE USED AS AN INTERIM MEASURE AT INTERCONNECTED SIGNAL LOCATIONS WHERE PRE-SIGNALS ARE TO BE INSTALLED IN THE FUTURE. THIS SIGN SHALL BE REMOVED WHEN THE PRE-SIGNALS ARE INSTALLED AND THE PAVEMENT MARKINGS ARE EXTENDED TO THE INTERSECTION.

NOT TO SCALE

Note: All dimensions are in INCHES (millimeters) unless otherwise shown.

DISTRICT 7 DETAIL NO. 78000001

| | | | |
|---|---------------------------|------------|---------------------|
| FILE NAME = | USER NAME = jessica.hille | DESIGNED - | REVISED - NAS 06/22 |
| pw:\idot-pw\bentley.com\PIDOT\Documents\IDOT Offices\District 7\Projects\74C42\CADD\Drawings\Drawings\74C42-sht-details.dgn | | CHECKED - | REVISED - |
| PLOT SCALE = 100.0000' / in. | | DATE - | REVISED - |
| PLOT DATE = 3/21/2024 | | | |

STATE OF ILLINOIS
DEPARTMENT OF TRANSPORTATION

PAVEMENT MARKING AND RAISED REFLECTIVE PAVEMENT MARKERS
(RURAL & URBAN APPLICATIONS)

SCALE: SHEET NO. 4 OF 4 SHEETS STA. TO STA.

| F.A.P. RTE. | SECTION | COUNTY | TOTAL SHEETS | SHEET NO. |
|---------------------------|-------------------|------------|--------------|-----------|
| 828 | (108,109,110)RS-4 | CUMBERLAND | 27 | 26 |
| CONTRACT NO. 74C42 | | | | |
| ILLINOIS FED. AID PROJECT | | | | |

TYPICAL RUMBLE STRIP APPLICATION IN ADVANCE OF AN INTERSECTION

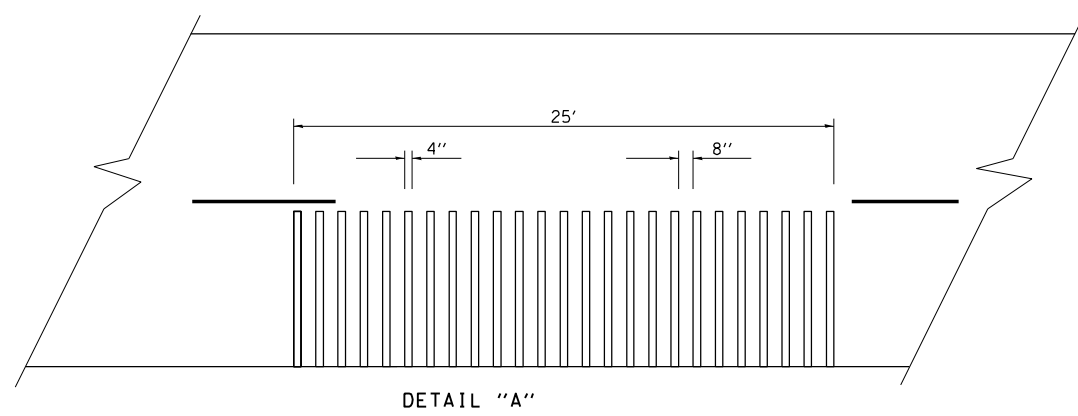
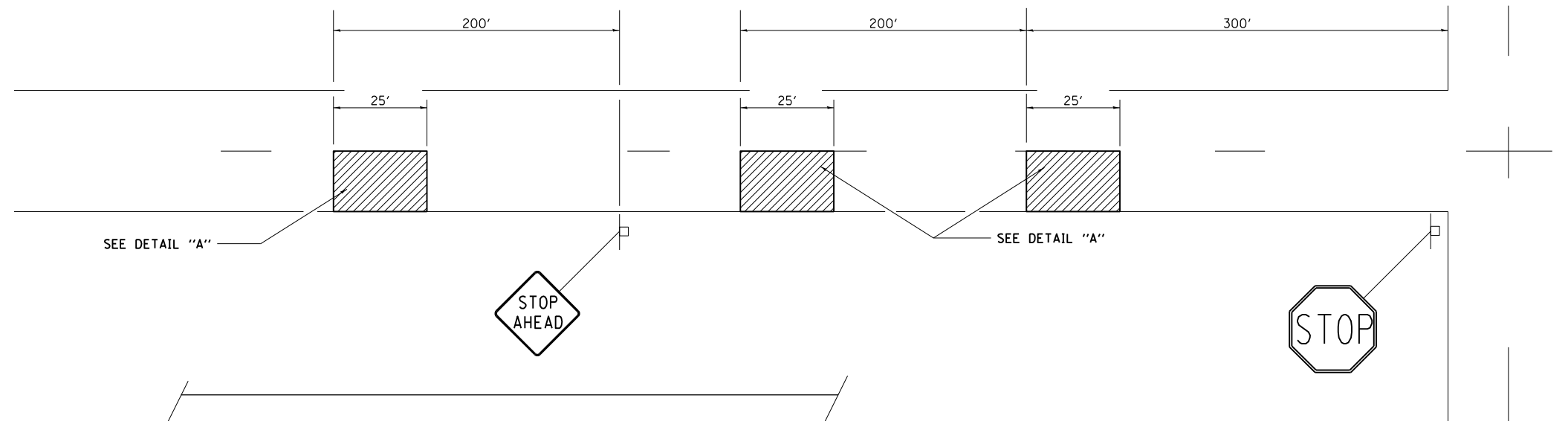

NOTE: THE 25 FEET RUMBLE AREA HAS 4" WIDE GROOVES SAWED INTO THE PAVEMENT, SEPARATED BY 8" OF EXISTING PAVEMENT. THE SAW CUTS SHALL EXTEND 12" INTO THE SHOULDER TO ALLOW FOR DRAINAGE.

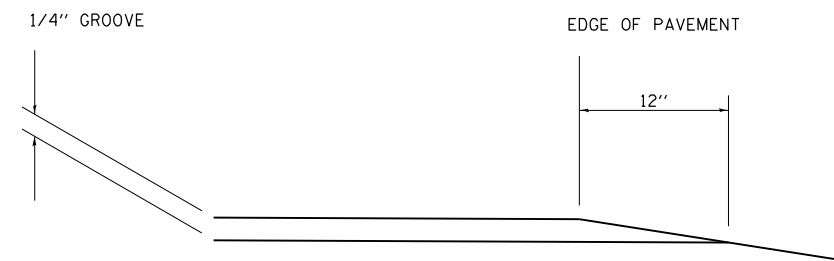
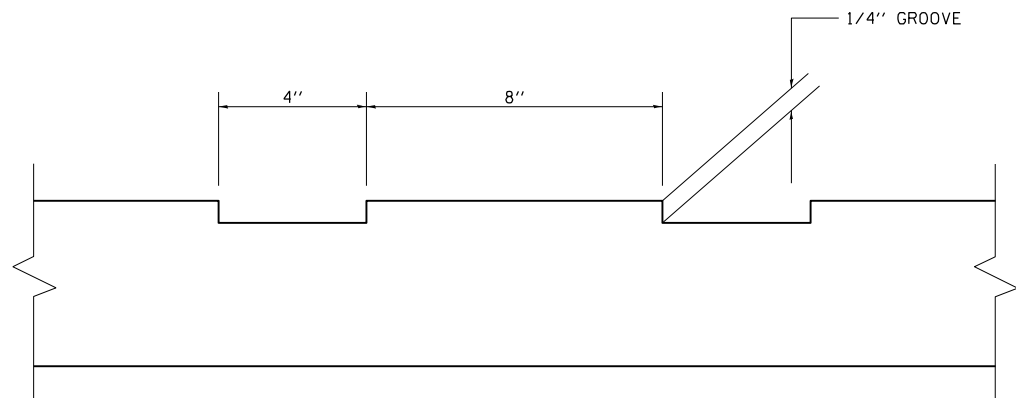

NOT TO SCALE

DISTRICT 7 DETAIL NO. Z0055300

| | | | |
|---|---------------------------|------------------------------|---------------------|
| FILE NAME = | USER NAME = jessica.hille | DESIGNED - | REVISED - MMO 12-99 |
| pw:\idot-pw.bentley.com\PIDOT\Documents\IDOT Offices\District 7\Projects\74C42\CADD\Drawings\Drawings\74C42-sht-details.dgn | | CHECKED - | REVISED - MKS 04-08 |
| | | PLOT SCALE = 100.0000' / in. | REVISOR - |
| | | PLOT DATE = 3/21/2024 | DATE - |

**STATE OF ILLINOIS
DEPARTMENT OF TRANSPORTATION**

TYPICAL RUMBLE STRIP APPLICATION

SCALE: SHEET NO. OF SHEETS STA. TO STA.

| F.A. RTE. | SECTION | COUNTY | TOTAL SHEETS | SHEET NO. |
|---|-------------------|------------|--------------------|-----------|
| 828 | (108,109,110)RS-4 | CUMBERLAND | 27 | 27 |
| FED. ROAD DIST. NO. ILLINOIS FED. AID PROJECT | | | CONTRACT NO. 74C42 | |