

STATE OF ILLINOIS
DEPARTMENT OF TRANSPORTATION

| F.A.U. RTE | SECTION | COUNTY | TOTAL SHEETS | SHEET NO |
|------------|------------------------------|----------|--------------------|----------|
| 7424 | D7 PARKING LOT IMPROV 2024-1 | MACON | 7 | 1 |
| | | ILLINOIS | CONTRACT NO. 74C78 | |

FOR INDEX OF SHEETS, SEE SHEET NO. 2

PROPOSED
HIGHWAY PLANS

F.A.U. ROUTE 7424 (WESTLAWN AVE.)
D7 PARKING LOT IMPROV 2024-1

PARKING LOT IMPROVEMENT
MACON COUNTY
C-97-011-24

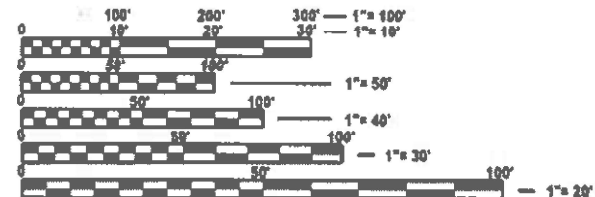
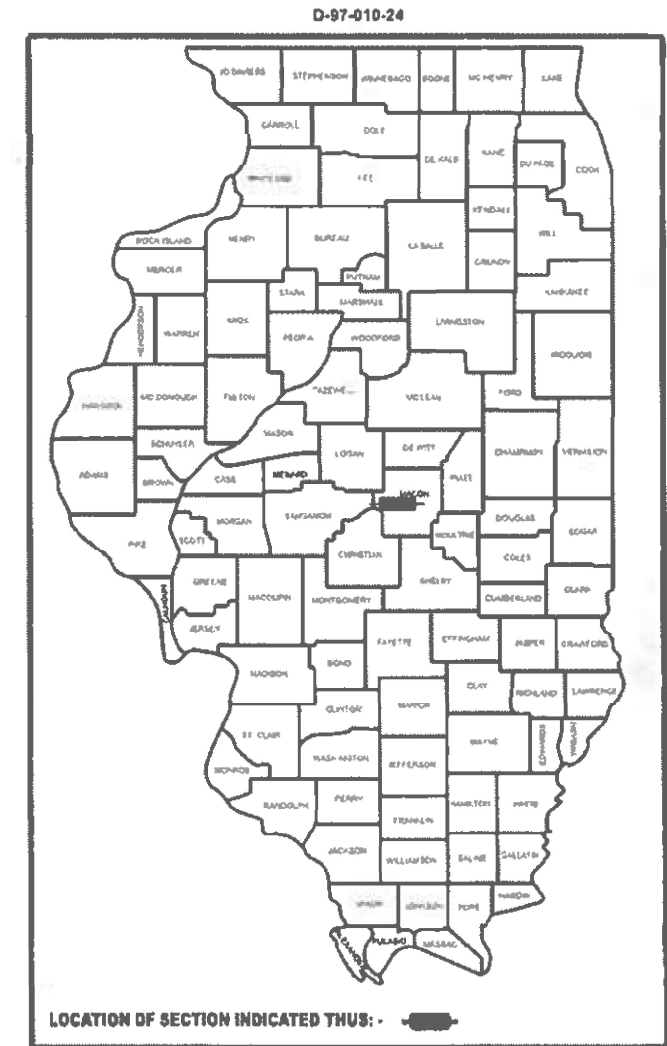

FULL SIZE PLANS HAVE BEEN PREPARED USING STANDARD ENGINEERING SCALES. REDUCED SIZED PLANS WILL NOT CONFORM TO STANDARD SCALES. IN MAKING MEASUREMENTS ON REDUCED PLANS, THE ABOVE SCALES MAY BE USED.

J.U.L.I.E.
JOINT UTILITY LOCATION INFORMATION FOR EXCAVATION
1-800-892-0123
OR 811

DECATUR MAINTENANCE YARD
4142 NORTH WESTLAWN AVENUE

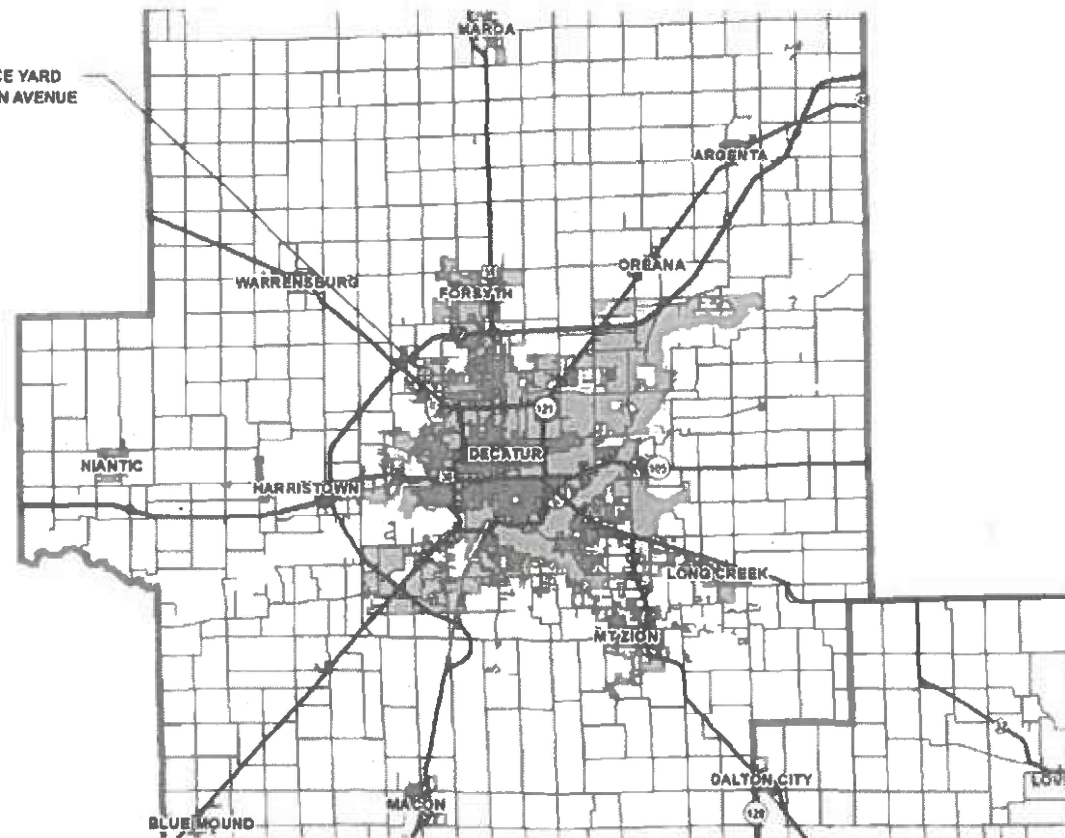

GROSS LENGTH = 1500.00 FT. = 0.30 MILE
NET LENGTH = 1500.00 FT. = 0.30 MILE

PROJECT ENGINEER DOUG RUDOLPHI
PROJECT MANAGER ROBERT GREUEL

CONTRACT NO. 74C78

STATE OF ILLINOIS
DEPARTMENT OF TRANSPORTATION

SUBMITTED March 22 2024
Jeffrey P Myrsky
REGIONAL ENGINEER

May 10, 2024 [Signature]
ENGINEER OF DESIGN AND ENVIRONMENT

May 10, 2024 [Signature]
DIRECTOR OF HIGHWAYS PROJECT IMPLEMENTATION

PRINTED BY THE AUTHORITY
OF THE STATE OF ILLINOIS

INDEX OF SHEETS

| | |
|-----------|-----------------------------------|
| SHEET NO. | DESCRIPTION |
| 1 | COVER SHEET |
| 2 | INDEX OF SHEETS AND GENERAL NOTES |
| 3 | SUMMARY OF QUANTITIES |
| 4 | PLAN SHEET |
| 5 | CONCRETE REMOVAL |
| 6 | CONCRETE DETAILS |
| 7 | HOT MIX ASPHALT DETAILS |

THE FOLLOWING STANDARDS ARE A PART OF THESE PLANS AND ARE INCLUDED FOLLOWING THE LAST NUMBERED SHEET OF THE PLANS.

| | |
|-----------|--|
| 000001-08 | STANDARD SYMBOLS, ABBREVIATIONS AND PATTERNS |
| 001006 | DECIMAL OF AN INCH AND OF A FOOT |
| 701001-02 | OFF-ROAD OPERATIONS, 2L, 2W, MORE THAN 15' AWAY |
| 701006-05 | OFF-ROAD OPERATIONS, 2L, 2W, 15' TO 24" FROM PAVEMENT EDGE |
| 701201-05 | LANE CLOSURE, 2L, 2W, DAY ONLY, FOR SPEEDS ≥ 45 MPH |
| 701301-04 | LANE CLOSURE, 2L, 2W, SHORT TIME OPERATIONS |
| 701901-09 | TRAFFIC CONTROL DEVICES |
| 001001-02 | AREAS OF REINFORCEMENT BARS |

GENERAL NOTES

THIS PROJECT IS LOCATED AT THE DECATUR MAINTENANCE YARD 4142 NORTH WESTLAWN AVE., DECATUR, ILLINOIS.

THE WORK FOR THIS PARKING LOT REHABILITATION CONSISTS OF FIRST REMOVING THE CONCRETE APRON AND REPLACING IT WITH FIBER REINFORCED CONCRETE. THEN MILL THE EXISTING OIL AND CHIP PARKING LOT AND RESURFACING WITH HOT MIX ASPHALT. WHILE MILLING THE CONTRACTOR SHALL HOLD A ONE PERCENT SLOPE AND DAY LIGHTING OUT AS SHOWN ON THE PLANS. THE GOAL IS TO HAVE AS MUCH OIL AND CHIP TO REMAIN IN PLACE TO SERVE AS A BASE FOR THE HOT MIX ASPHALT TO BE PLACED ON. ALL MATERIAL PRODUCED FROM THE REMOVAL OPERATIONS SUCH AS MILLINGS AND BROKEN CONCRETE SHALL BE CONSIDERED ILLINOIS STATE PROPERTY AND REMAIN AT THE DECATUR MAINTENANCE YARD.

THE MAINTENANCE YARD WILL REMAIN OPEN FOR BUSINESS AS USUAL AND THE CONTRACTOR SHALL COORDINATE WITH THE YARD TO KEEP INTERRUPTIONS WITH THE YARDS DAILY BUSINESS DOWN TO A MINIMUM.

THE FOLLOWING MIXTURE REQUIREMENTS ARE APPLICABLE TO THIS PROJECT:

| LOCATION(S) | MIXTURE USE(S) | PG | DESIGN AIR VOIDS | MIXTURE COMPOSITION | FRICTION AGGREGATE | MIXTURE WEIGHT | QUALITY MANAGEMENT PROGRAM | SUBLOT SIZE | MATERIAL TRANSFER DEVICE (REQUIRED?) |
|-------------|--|----------|------------------|---------------------|--------------------|----------------|----------------------------|-------------|--------------------------------------|
| MAINLINE | POLYMERIZED HMA SURFACE COURSE, IL-9.5, MIX "D", N90 | PG 70-22 | 4.0% @ N=90 | IL - 9.5 | MIXTURE D | N90 | QCQA | 3000 | N/A |

REV. - MS

MODEL: GENERAL NOTES (Sheet)
FILE NAME: c:\p\work\pav\sig\renew\0911703\074C78_Index of Sheets.dgn

| | | | | | | | | | | |
|---------------------------|------------|-----------|---|--|-----------------------------|------------------------------|--------|--------------|-----------|--|
| USER NAME = Robert.Greuel | DESIGNED - | REVISED - | STATE OF ILLINOIS DEPARTMENT OF TRANSPORTATION | INDEX OF SHEETS, HIGHWAY STANDARDS, AND GENERAL NOTES | F.A.U. RTE. | SECTION | COUNTY | TOTAL SHEETS | SHEET NO. | |
| | DRAWN - | REVISED - | | | 7424 | D7 PARKING LOT IMPROV 2024-1 | MACON | 7 | 2 | |
| | CHECKED - | REVISED - | | | CONTRACT NO. 74C78 | | | | | |
| PLOT DATE = 3/21/2024 | DATE - | REVISED - | | | ILLINOIS FED. AID PROJECT | | | | | |
| | | | | SCALE: | SHEET | OF 1 SHEETS | STA. | TO STA. | | |

| SUMMARY OF QUANTITIES | | | | CONSTR. CODE |
|-----------------------|--|-------|----------------|--------------|
| CODE NO. | ITEM | UNIT | TOTAL QUANTITY | ROADWAY |
| | | | | 0044 |
| 31101000 | SUBBASE GRANULAR MATERIAL, TYPE B | TON | 88 | 88 |
| 40600290 | BITUMINOUS MATERIALS (TACK COAT) | POUND | 2182 | 2182 |
| 40604164 | POLYMERIZED HOT-MIX ASPHALT SURFACE COURSE, IL-9.5, MIX "D", N90 | TON | 543 | 543 |
| 50800205 | REINFORCEMENT BARS, EPOXY COATED | POUND | 60.1 | 60.1 |
| 58700300 | CONCRETE SEALER | SQ FT | 3597 | 3597 |
| 67100100 | MOBILIZATION | L SUM | 1 | 1 |
| 70100450 | TRAFFIC CONTROL AND PROTECTION, STANDARD 701201 | L SUM | 1 | 1 |
| X0321309 | CONCRETE PAD | SQ YD | 400 | 400 |
| X1700114 | CONCRETE PAD REMOVAL | SQ FT | 3597 | 3597 |
| X4400102 | SURFACE REMOVAL, VARIABLE DEPTH (SPECIAL) | SQ YD | 4849 | 4849 |
| Z0018905 | DRILL AND GROUT BARS | EACH | 90 | 90 |
| Z0062002 | SAW CUTTING, (FULL DEPTH) | FOOT | 217 | 217 |

MODEL: summary of quantities (Sheet)
FILE NAME: c:\p\work\pav\sig\resurf\0811703\074C78_Summary of Quantities.dgn

REV. - MS

| | | | | | | | | | | |
|---------------------------|------------|-----------|---|------------------------------|--------------------|------------------------------|-------------|--------------|-----------|----------|
| USER NAME = jessica.hille | DESIGNED - | REVISED - | STATE OF ILLINOIS DEPARTMENT OF TRANSPORTATION | SUMMARY OF QUANTITIES | F.A.U. RTE. | SECTION | COUNTY | TOTAL SHEETS | SHEET NO. | |
| | DRAWN - | REVISED - | | | 7424 | D7 PARKING LOT IMPROV 2024-1 | MACON | 7 | 3 | |
| | CHECKED - | REVISED - | | | CONTRACT NO. 74C78 | | | | | |
| PLOT DATE = 3/21/2024 | DATE - | REVISED - | | | SCALE: | SHEET | OF 1 SHEETS | STA. | TO STA. | ILLINOIS |

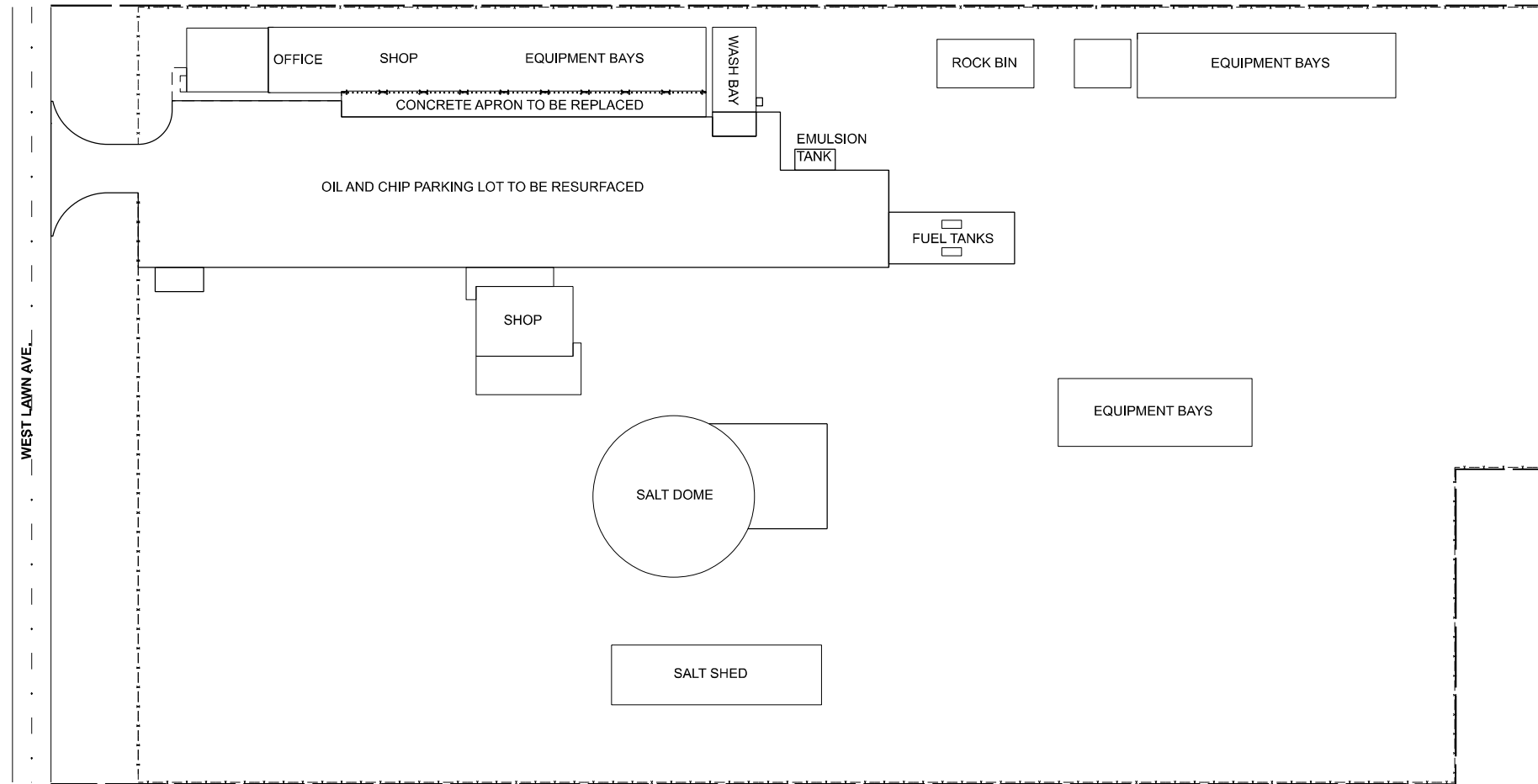

MODEL: detail of Decatur yard (Sheet)
 FILE NAME: c:\p\work\wis\rd\greuel\0911703\074C78_Plan_Sheet.dgn

| | | |
|---------------------------|------------|-----------|
| USER NAME = Robert.Greuel | DESIGNED - | REVISED - |
| | DRAWN - | REVISED - |
| | CHECKED - | REVISED - |
| PLOT DATE = 3/22/2024 | DATE - | REVISED - |

STATE OF ILLINOIS
DEPARTMENT OF TRANSPORTATION

PLAN SHEET

SCALE: SHEET OF 4 SHEETS STA. TO STA.

| F.A.U. RTE. | SECTION | COUNTY | TOTAL SHEETS | SHEET NO. |
|---------------------------|-----------------------|--------|--------------|-----------|
| 7424 | D7 PARKING LOT 2024-1 | MACON | 7 | 4 |
| CONTRACT NO. 74C78 | | | | |
| ILLINOIS FED. AID PROJECT | | | | |

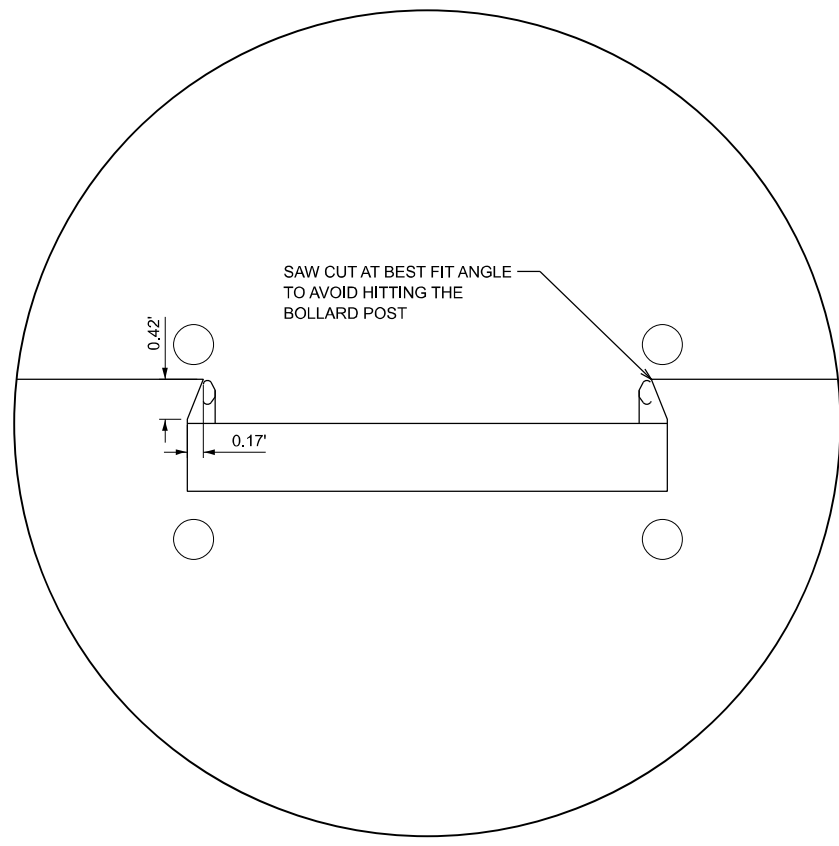
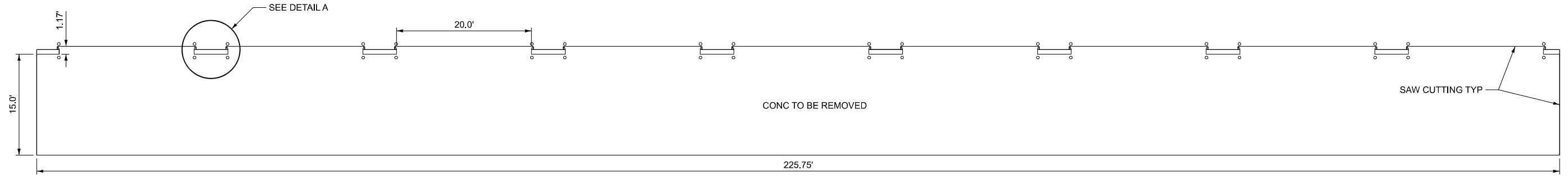

DETAIL A

MODEL: CONCRETE REMOVAL 50 SCALE (Sheet)
 FILE NAME: c:\p\work\evict\hille\03117031D74C78_Plan Sheet.dgn

| | | |
|---------------------------|------------|-----------|
| USER NAME = jessica.hille | DESIGNED - | REVISED - |
| | DRAWN - | REVISED - |
| | CHECKED - | REVISED - |
| PLOT DATE = 3/22/2024 | DATE - | REVISED - |

**STATE OF ILLINOIS
 DEPARTMENT OF TRANSPORTATION**

CONCRETE REMOVAL

SCALE: SHEET OF SHEETS STA. TO STA.

| F.A.U. RTE. | SECTION | COUNTY | TOTAL SHEETS | SHEET NO. |
|---------------------------|------------------------------|--------|--------------|-----------|
| 7424 | D7 PARKING LOT IMPROV 2024-1 | MACON | 7 | 5 |
| CONTRACT NO. 74C78 | | | | |
| ILLINOIS FED. AID PROJECT | | | | |

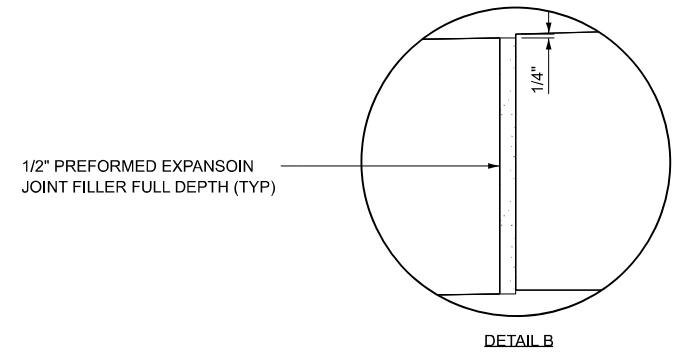
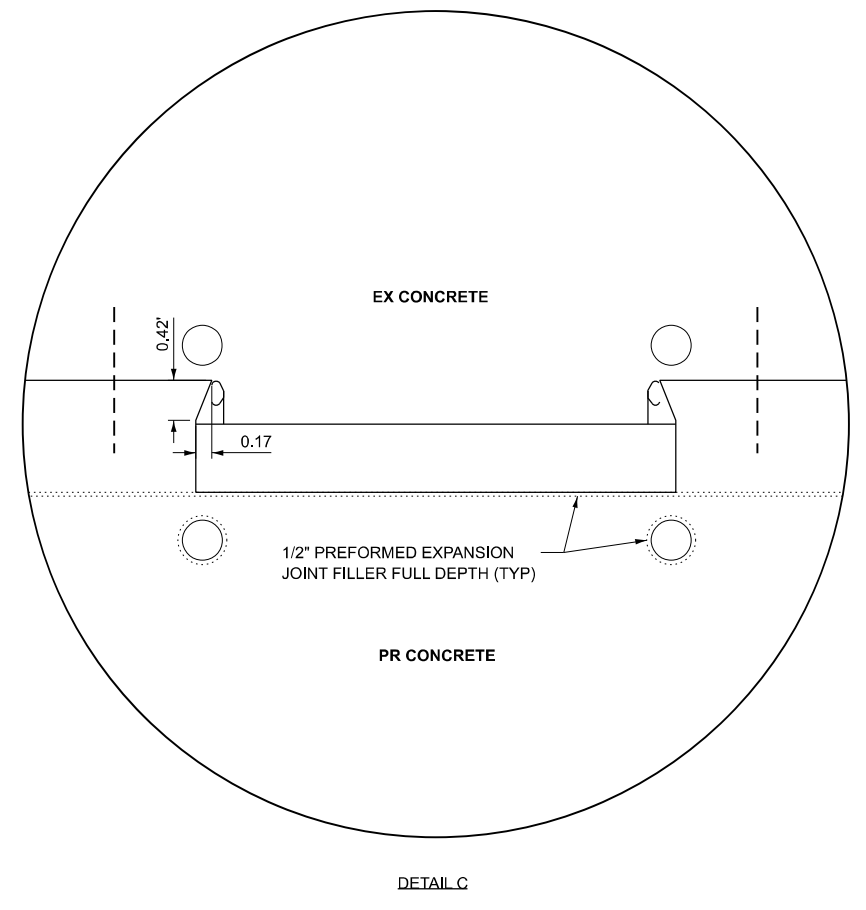
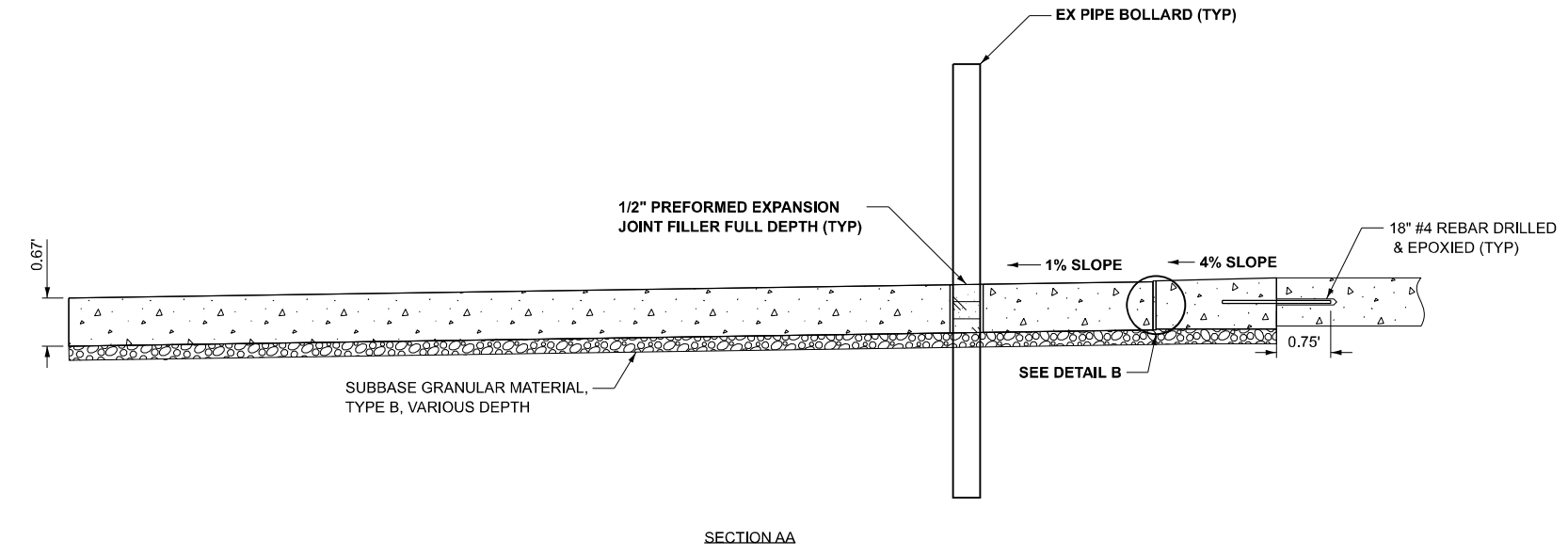
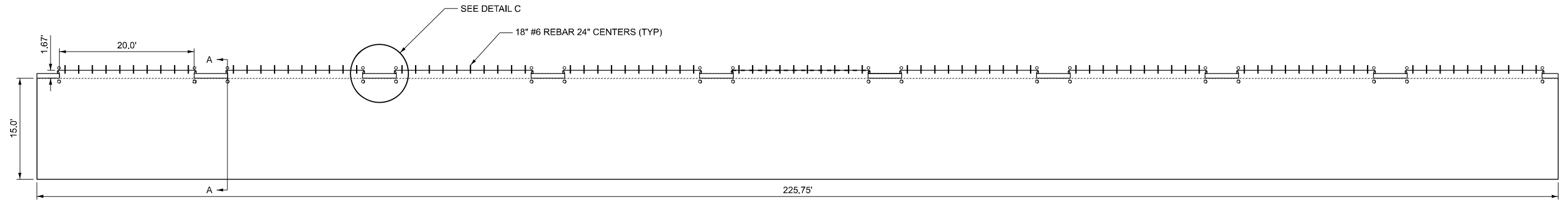

MODEL: CONCRETE REPLACE 50 SCALE=1 (Sheet)
 FILE NAME: c:\p\work\wv\wv\grev\df\0911703\07\4C78_Plan_Sheet.dgn

| | | |
|---------------------------|------------|-----------|
| USER NAME = jessica.hille | DESIGNED - | REVISED - |
| | DRAWN - | REVISED - |
| | CHECKED - | REVISED - |
| PLOT DATE = 3/22/2024 | DATE - | REVISED - |

STATE OF ILLINOIS
 DEPARTMENT OF TRANSPORTATION

| | | | | | | |
|--------|--|-------|----|--------|------|---------|
| SCALE: | | SHEET | OF | SHEETS | STA. | TO STA. |
| | | | | | | |

| | | | | |
|---------------------------|------------------------------|--------|--------------|-----------|
| F.A.U. RTE. | SECTION | COUNTY | TOTAL SHEETS | SHEET NO. |
| 7424 | D7 PARKING LOT IMPROV 2024-1 | MACON | 7 | 6 |
| CONTRACT NO. 74C78 | | | | |
| ILLINOIS FED. AID PROJECT | | | | |

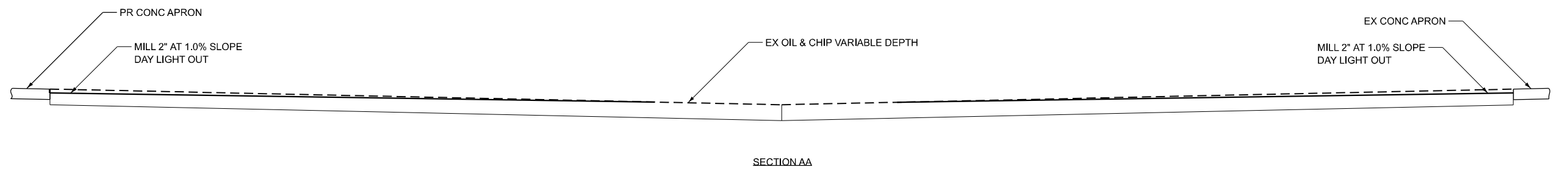
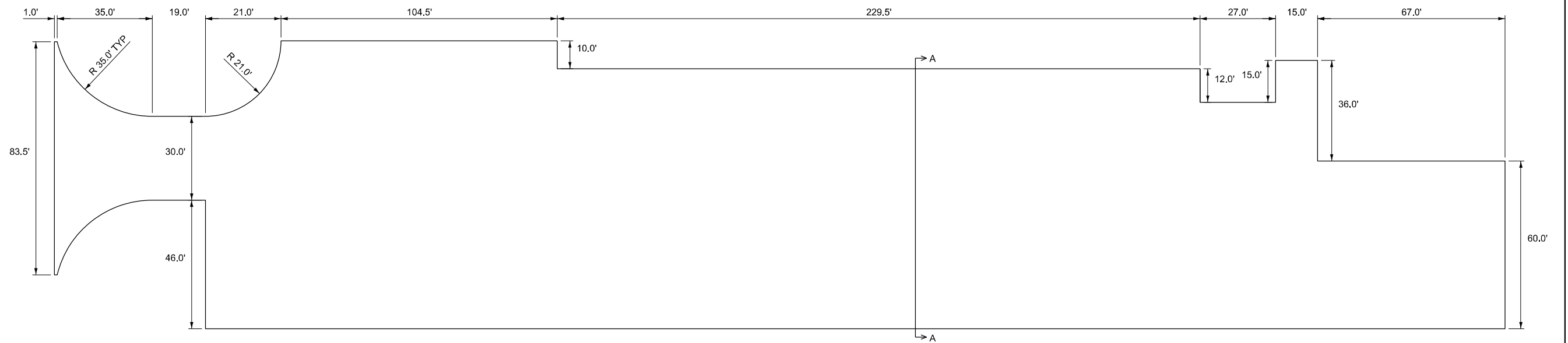

MODEL: detail of Decatur yard-1 [Sheet]
 FILE NAME: c:\p\work\wisid\greuel\0911703\0774C78_Plan_Sheet.dgn

| | | |
|---------------------------|------------|-----------|
| USER NAME = Robert.Greuel | DESIGNED - | REVISED - |
| | DRAWN - | REVISED - |
| | CHECKED - | REVISED - |
| PLOT DATE = 3/22/2024 | DATE - | REVISED - |

STATE OF ILLINOIS
DEPARTMENT OF TRANSPORTATION

HOT MIX ASPHALT DETAILS

SCALE: SHEET OF 4 SHEETS STA. TO STA.

| F.A.U. RTE. | SECTION | COUNTY | TOTAL SHEETS | SHEET NO. |
|---------------------------|------------------------------|--------|--------------|-----------|
| 7424 | D7 PARKING LOT IMPROV 2024-1 | MACON | 7 | 7 |
| CONTRACT NO. 74C78 | | | | |
| ILLINOIS FED. AID PROJECT | | | | |