

INDEX OF SHEETS

1. COVER SHEET, LOCATION MAP, SCHEDULE OF QUANTITIES
2. SUMMARY OF QUANTITIES, GENERAL NOTES
3. TYPICAL AND PROPOSED CROSS-SECTION
4. SIDE ROAD, PRIVATE ENTRANCE, MAILBOX DETAILS, MIX SCHEDULE
5. STRIPING SCHEDULE

ROUTE	SECTION	COUNTY	CONTRACT	TOT. SHTS.	SHEET
FAU 8715 / FAS 1830	21-00224-00-RS	JEFFERSON	99733	5	1

STATE OF ILLINOIS
 DEPARTMENT OF TRANSPORTATION
 DIVISION OF HIGHWAYS
 PLANS FOR PROPOSED
 SURFACE TRANSPORTATION PROJECT
 FAU 8715 / FAS 1830 - OLD FAIRFIELD ROAD



HIGHWAY STANDARDS

000001-08	BLR 21-9
701006-05	BLR 22-7
701011-04	
701201-05	
701306-04	
701311-03	
701901-09	

SECTION 21-00224-00-RS
 JEFFERSON COUNTY
 793A(266)
 C-99-014-25
 CONTRACT # 99733

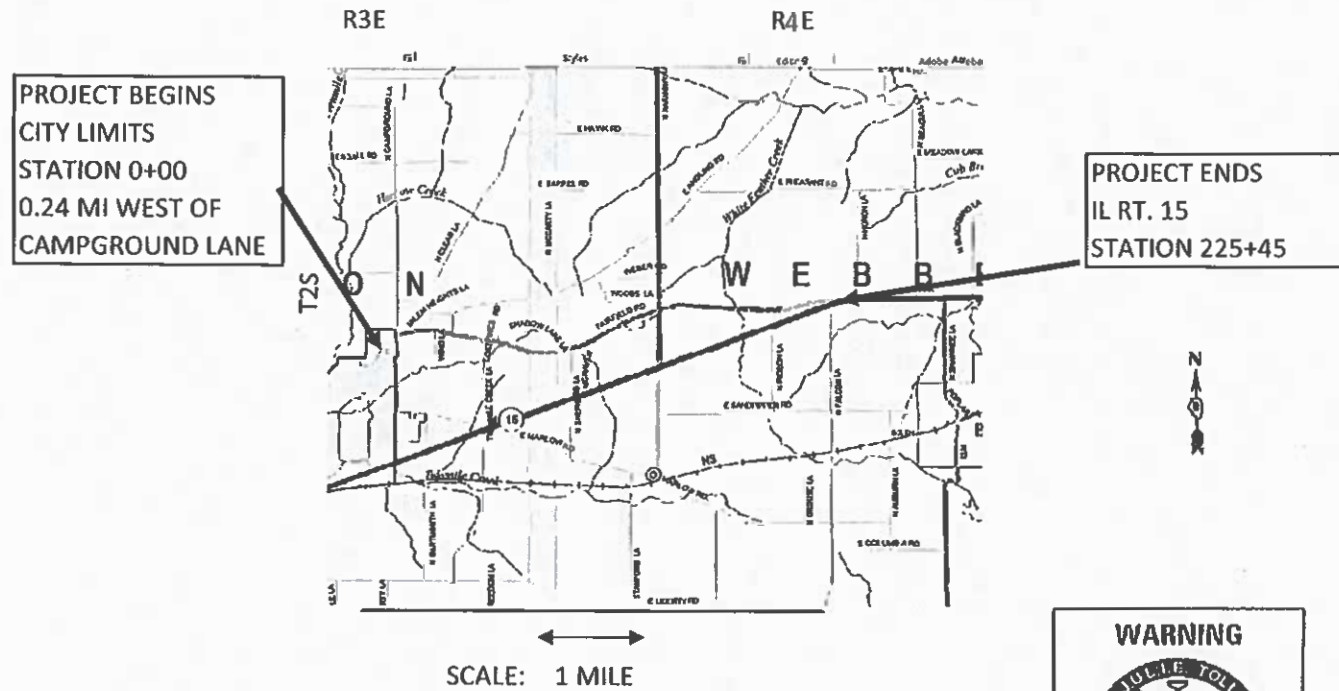

CONTRACT NO. 99733

ROADWAY CLASSIFICATION: MAJOR COLLECTOR
 DESIGN SPEED: 50 MPH

ADT:
 (2024) = 1950
 (2044) = 2650
 PC = 1762
 SU = 161
 MU = 57

TOTAL GROSS SECTION LENGTH = 22,545' = 4.270 MILES
 TOTAL NET SECTION LENGTH = 22,545' = 4.270 MILES



APPROVED
[Signature], 2024
 COUNTY ENGINEER
 JEFFERSON COUNTY HIGHWAY DEPARTMENT
 750 OLD FAIRFIELD ROAD
 MT. VERNON, IL 62864
 PH: (618) 244-8031
 LICENCE EXP. 11-30-2025

APPROVED
[Signature], 2024
 DISTRICT ENGINEER OF LOCAL ROADS AND STREETS

RELEASING FOR BID BASED OF LIMITED REVIEW
[Signature], 2024
 KIRK BROWN, P.E.
 DEPUTY DIRECTOR OF HIGHWAYS
 REGION 5 ENGINEER
 STATE OF ILLINOIS
 DEPARTMENT OF TRANSPORTATION

PRINTED BY THE AUTHORITY OF
 THE STATE OF ILLINOIS

ROUTE	SECTION	COUNTY	CONTRACT	TOT. SHTS.	SHEET
FAU 8715 / FAS 1830	21-00224-00-RS	JEFFERSON	99733	5	2

SUMMARY OF QUANTITIES			
	PAY ITEM	UNIT OF MEASURE	QUANTITY
	40200800 AGGREGATE SURFACE COURSE, TYPE B	TON	125
	40600290 BITUMINOUS MATERIALS (TACK COAT)	POUND	26000
	40600990 TEMPORARY RAMP	SQYD	60
	40600982 HOT-MIX ASPHALT SURFACE REMOVAL - BUTT JOINT	SQYD	65
	40600985 PORTLAND CEMENT CONCRETE SURFACE REMOVAL - BUTT JOINT	SQYD	65
	40604052 HOT-MIX ASPHALT SURFACE COURSE, IL-9.5, MIX "C", N70	TON	7050
	48101200 AGGREGATE SHOULDERS, TYPE B	TON	600
	67100100 MOBILIZATION	LSUM	1
	70300100 SHORT-TERM PAVEMENT MARKING	FOOT	5650
	70300150 SHORT-TERM PAVEMENT MARKING REMOVAL	SQFT	5650
*	78000200 THERMOPLASTIC PAVEMENT MARKING - LINE 4"	FOOT	83616
*	LR400740 COLD-IN-PLACE RECYCLING, 4"	SQYD	57615
*	LR400055 CIR-FDR EMULSIFIED ASPHALT	TON	400
*	LR403300 SURFACE PROFILE MILLING	SQYD	57615
	X7010216 TRAFFIC CONTROL AND PROTECTION, (SPECIAL)	LSUM	1
	XX009289 TRAFFIC CONTROL AND PROTECTION, STANDARD BLR 21	LSUM	1
	XX009291 TRAFFIC CONTROL AND PROTECTION, STANDARD BLR 22	LSUM	1

GENERAL NOTES

ALL CONSTRUCTION SHALL BE DONE IN ACCORDANCE WITH THE STATE OF ILLINOIS "STANDARD SPECIFICATIONS FOR ROAD AND BRIDGE CONSTRUCTION ADOPTED JANUARY 1, 2022", "SUPPLEMENTAL SPECIFICATIONS AND RECURRING SPECIAL PROVISIONS ADOPTED APRIL 1, 2024", THESE PLANS AND THE SPECIAL PROVISIONS INCLUDED IN THE CONTRACT DOCUMENTS

THE LOCATION OF ALL UTILITIES SHALL BE DETERMINED BY THE CONTRACTOR

THE CONTRACTOR SHALL PROVIDE ACCESS TO ABUTTING PROPERTY AT ALL TIMES DURING THE CONSTRUCTION OF THE PROJECT

THE FOLLOWING RATES HAVE BEEN USED IN CALCULATING PLAN QUANTITIES

AGGREGATE SURFACE COURSE, TYPE B	2.00 TON/CU YD
STONE DUMPED RIPRAP, CLASS A4	2.00 TON/CU YD
HOT-MIX ASPHALT	115 LB/SY/IN
TACK COAT	0.05 LB/ SF
CIR EMULSION RATE	1.5 GAL/ SY

* SPECIALTY ITEMS

ROUTE	SECTION	COUNTY	CONTRACT	TOT. SHTS.	SHEET
FAU 8715 / FAS 1830	21-00224-00-RS	JEFFERSON	99733	5	3

TYPICAL #1 EXISTING CROSS-SECTION
0+00 TO 225+45

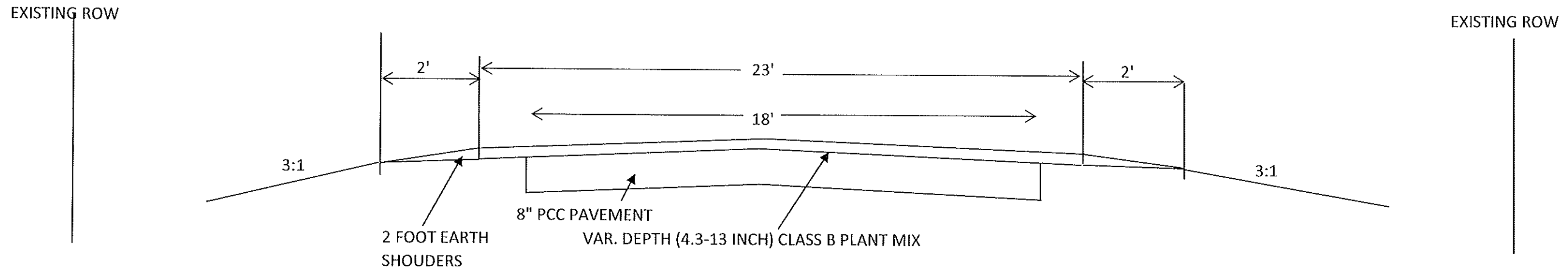

TYPICAL #2 PROPOSED CROSS-SECTION
0+00 TO 225+45

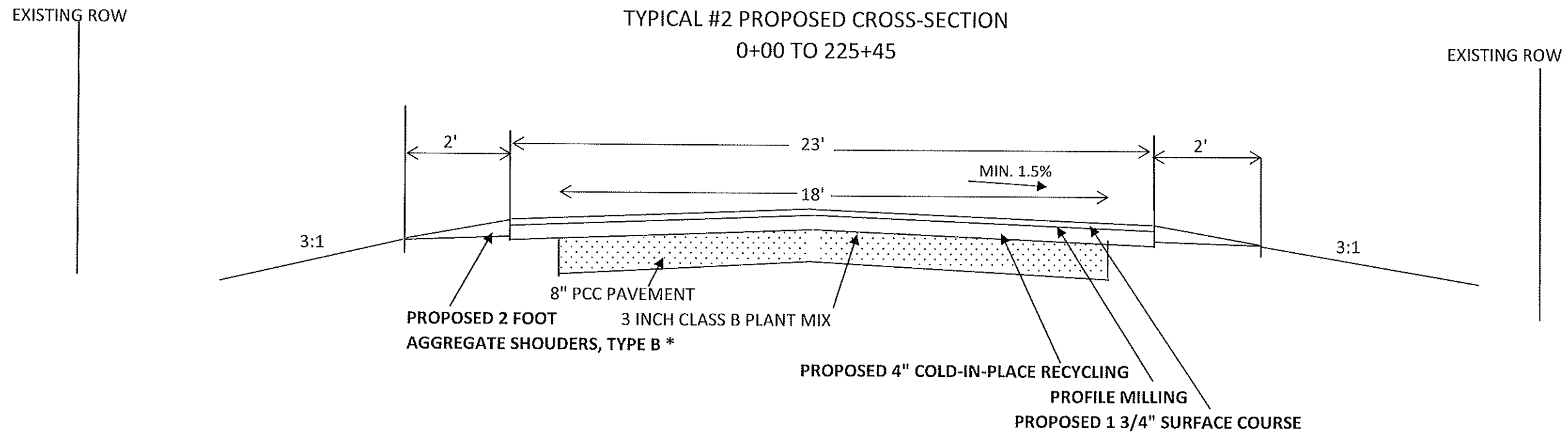

* Additional quantity included for existing drop-off

ROUTE	SECTION	COUNTY	CONTRACT	TOT. SHTS.	SHEET
FAU 8715 / FAS 1830	21-00224-00-RS	JEFFERSON	99733	5	4

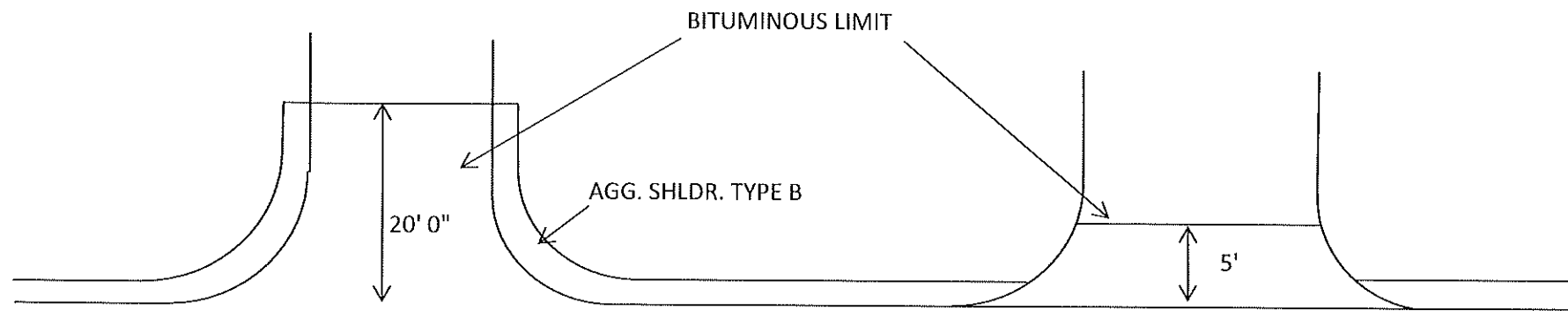

DETAIL OF SIDE ROAD INTERSECTION (14 EACH)
20 TONS BITUMINOUS EACH ALLOWED IN PROPOSAL

DETAIL OF PRIVATE ENTRANCE (117 EACH)
5 TONS BITUMINOUS EACH ALLOWED IN THE PROPOSAL

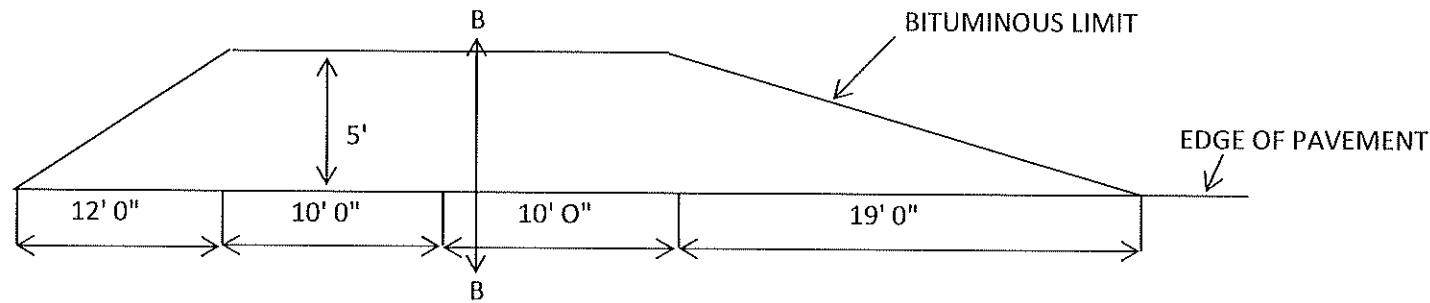

DETAIL OF MAILBOX TURNOUT (68 EACH)
5 TONS BITUMINOUS EACH ALLOWED IN THE PROPOSAL

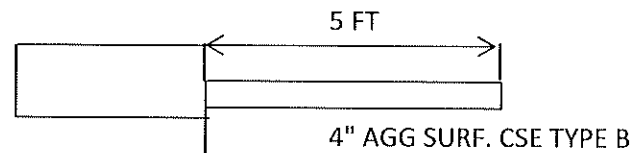

5 TONS EACH IN THE PROPOSAL

STRUCTURAL DESIGN TRAFFIC		YEAR 2023
PV = 1762	SU = 171	MU = 57
CLASSIFICATION: MAJOR COLLECTOR		
PERCENT OF STRUCTURAL DESIGN TRAFFIC IN DESIGN LANE		
P = 88	S = 9	M = 3
TRAFFIC FACTOR		TF = 0.57
PG GRADE	SURFACE = 64-22	
IBR = 3		

HOT MIX ASPHALT MIXTURE REQUIREMENTS	
Location(s):	Hot-Mix Asphalt Surface Course
Mixture Use(s):	Hot-Mix Asphalt Surface Course, IL 9.5, Mix "C", N70
AC/PG:	PG64-22
RAP % (Max):	10
Design Air Voids:	4.0%, 70 Gyration Design
Mixture Composition: (Gradation Mixture)	IL-9.5 mm or IL 12.5 mm
Friction Aggregate:	C Surface

ROUTE	SECTION	COUNTY	CONTRACT	TOT. SHTS.	SHEET
FAU 8715 / FAS 1830	21-00224-00-RS	JEFFERSON	99733	5	5

STRIPING SCHEDULE								
	FROM	TO	TOTAL LENGTH (FT)	SKIPS (FT)	EB (FT)	WB (FT)	EDGELINE (FT)	TOTAL
SKIPS	0+00	0+74	74	19			148	167
NPZ EB	0+74	7+57	683	171	683		1366	2220
NPZ	7+57	35+86	2829		2829	2829	5658	11316
NPZ WB	35+86	44+20	834	209		834	1668	2711
NPZ	44+20	45+02	82		82	82	164	328
NPZ EB	45+02	54+34	932	233	932		1864	3029
NPZ WB	54+34	64+13	979	245		979	1958	3182
NPZ EB	64+13	74+05	992	248	992		1984	3224
NPZ	74+05	124+65	5060		5060	5060	10120	20240
NPZ WB	124+65	135+38	1073	269		1073	2146	3488
SKIPS	135+38	137+65	227	57			454	511
NPZ EB	137+65	144+10	645	162	645		1290	2097
NPZ	144+10	152+62	852		852	852	1704	3408
NPZ WB	152+62	162+43	981	246		981	1962	3189
NPZ	162+43	163+63	120		120	120	240	480
NPZ EB	163+63	173+00	937	235	937		1874	3046
NPZ	173+00	225+45	5245		5245	5245	10490	20980
			22545	2094	18377	18055	45090	83616

GENERAL NOTES

ALL CONSTRUCTION SHALL BE DONE IN ACCORDANCE WITH THE STATE OF ILLINOIS "STANDARD SPECIFICATIONS FOR ROAD AND BRIDGE CONSTRUCTION ADOPTED JANUARY 1, 2022", "SUPPLEMENTAL SPECIFICATIONS AND RECURRING SPECIAL PROVISIONS ADOPTED APRIL 1, 2024", THESE PLANS AND THE SPECIAL PROVISIONS INCLUDED IN THE CONTRACT DOCUMENTS

THE LOCATION OF ALL UTILITIES SHALL BE DETERMINED BY THE CONTRACTOR

THE CONTRACTOR SHALL PROVIDE ACCESS TO ABUTTING PROPERTY AT ALL TIMES DURING THE CONSTRUCTION OF THE PROJECT

THE FOLLOWING RATES HAVE BEEN USED IN CALCULATING PLAN QUANTITIES

AGGREGATE SURFACE COURSE, TYPE B	2.00 TON/CU YD
STONE DUMPED RIPRAP, CLASS A4	2.00 TON/CU YD
HOT-MIX ASPHALT	115 LB/SY/IN
TACK COAT	0.05 LB / SF
CIR EMULSION RATE	1.5 GAL / SY