

F.A.U. RTE.	SECTION	COUNTY	TOTAL SHEETS	SHEET NO.
* 531 RS-1		COOK	COOK	11
STA. 55+00	TO STA. 72+06			
FED. ROAD DIST. NO. 1		ILLINOIS	HIGHWAY PROJECT	

\* FAU 2592 & FAP 305

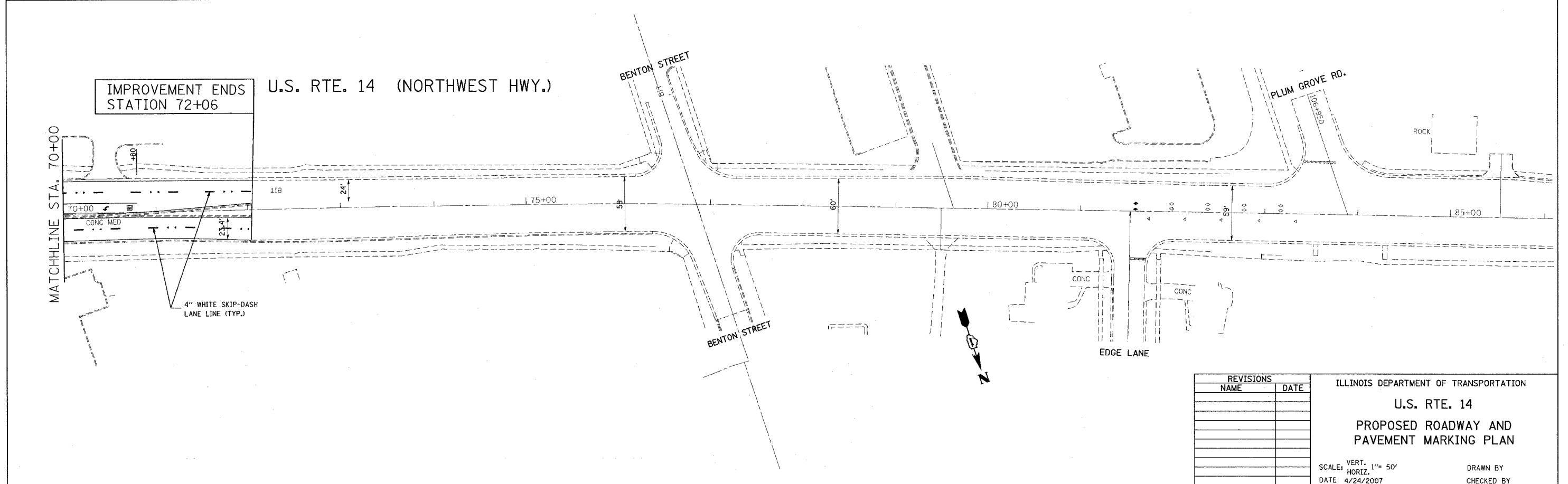
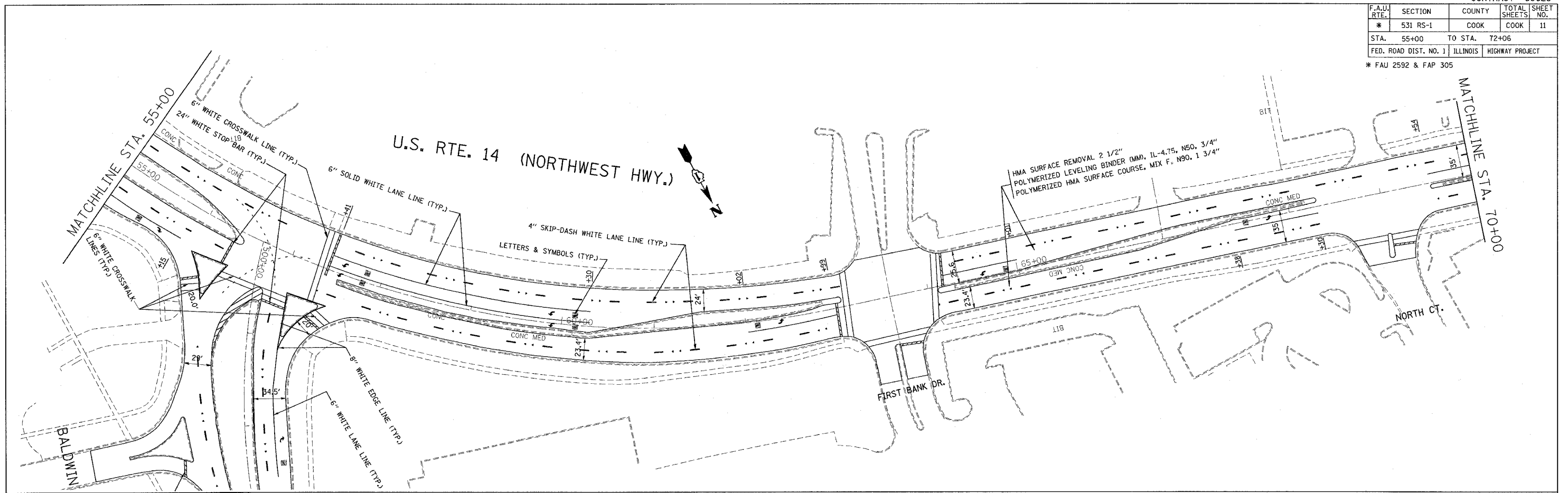

REVISIONS	
NAME	DATE

ILLINOIS DEPARTMENT OF TRANSPORTATION  
**U.S. RTE. 14**  
**PROPOSED ROADWAY AND PAVEMENT MARKING PLAN**

SCALE: VERT. 1" = 50'  
 HORIZ. 1" = 50'  
 DATE 4/24/2007

DRAWN BY \_\_\_\_\_  
 CHECKED BY \_\_\_\_\_