

SECTION	COUNTY	TOTAL SHEETS	SHEET NO.
531R3-1	COOK	34	14
STA.	TO STA.		
PBL. ROAD DIST. NO. 1			

- ☐ DOUBLE HANDHOLE
 - DETECTOR LOOP
 - ⊙ SERVICE INSTALLATION
 - TRAFFIC SIGNAL CONTROLLER CABINET
-
- R.O.W. RIGHT OF WAY
 - N.T.S. NOT TO SCALE
 - SIGN PANEL LOCATION
 - ⊙ SIGNAL HEAD AND POST
 - ⊙ OPTICALLY PROGRAMMED SIGNAL HEAD
 - ⊙ OPTICALLY PROGRAMMED SIGNAL HEAD WITH BACKPLATE
 - ⊙ OPTICAL DETECTOR
 - EXISTING WOOD POLE
 - STEEL MAST ARM ASSEMBLY AND POLE
 - GALVANIZED STEEL CONDUIT
UPPER NUMERAL INDICATES LENGTH
"T" INDICATES CONDUIT IN TRENCH
"P" INDICATES CONDUIT PUSHED
LOWER NUMERAL INDICATES SIZE

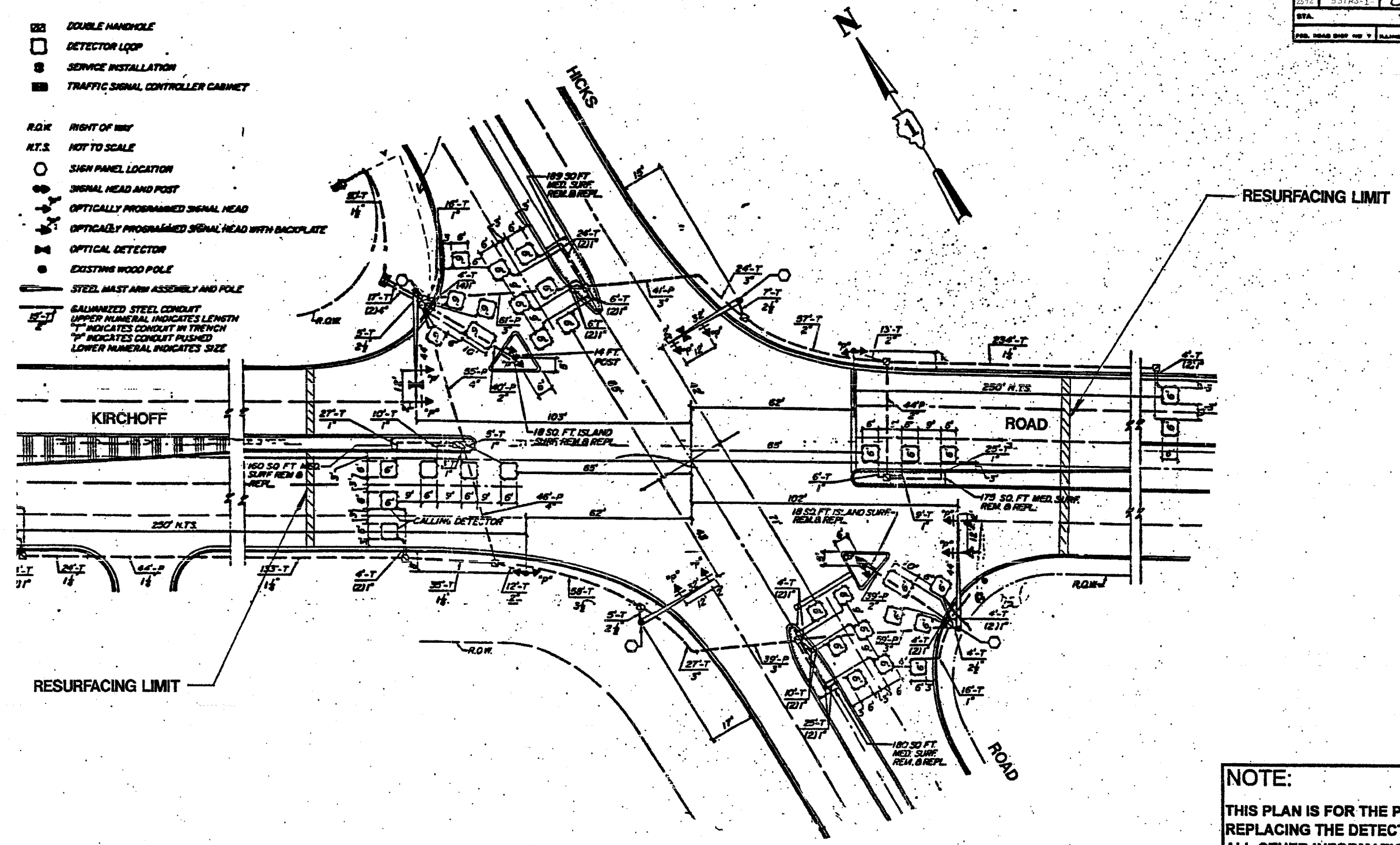

REPLACE ALL DETECTOR LOOPS AS SHOWN
(WITHIN THE RESURFACING LIMITS)

CODE NO.	QUANTITY	UNIT	ITEM
88600600	375	Foot	Detector Loop Replacement

REVISIONS	
NAME	DATE

NOTE:
THIS PLAN IS FOR THE PURPOSE OF REPLACING THE DETECTOR LOOPS ONLY. ALL OTHER INFORMATION SHOWN IS NOT RELATED AND WILL BE DISREGARDED.

ILLINOIS DEPARTMENT OF TRANSPORTATION
DETECTOR LOOP REPLACEMENT
HICKS ROAD AT KIRCHOFF ROAD

SCALE: 1" = 20'
DATE: OCT. 2005

DRAWN BY: JHE
DESIGNED BY: JHE
CHECKED BY: DAD