

F.A.P. RTE.	SECTION	COUNTY	TOTAL SHEETS	SHEET NO.
577	3114 N-1	COOK	72	13
STA. 18+00		TO STA. 30+00		
FED. ROAD DIST. NO.		ILLINOIS FED. AID PROJECT		

EXIST. CURVE CURVE2  
 PI STA. = 29+27.94  
 $\Delta = 4^\circ 11' 25''$  (LT)  
 $D = 2^\circ 21' 110''$   
 $R = 2,435.00'$   
 $T = 89.08'$   
 $L = 178.08'$   
 $E = 1.63'$   
 $e = \text{---}$   
 $T.R. = \text{---}$   
 $S.E. RUN = \text{---}$   
 $P.C. STA. = 28+38.85$   
 $P.T. STA. = 30+16.94$

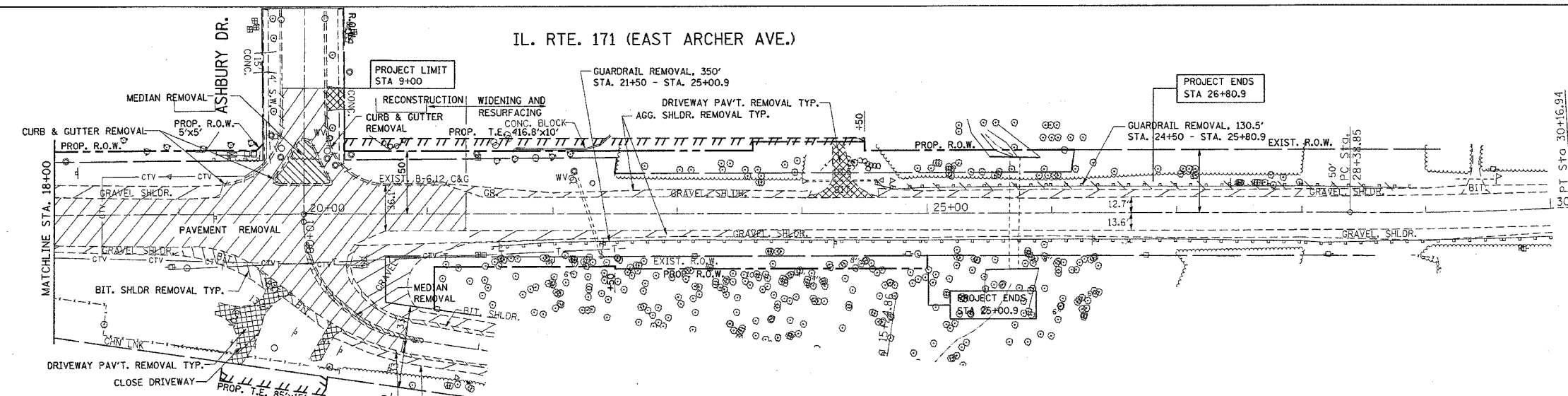

IL. RTE. 171 (EAST ARCHER AVE.)



IL. RTE. 171 (EAST ARCHER AVE.)

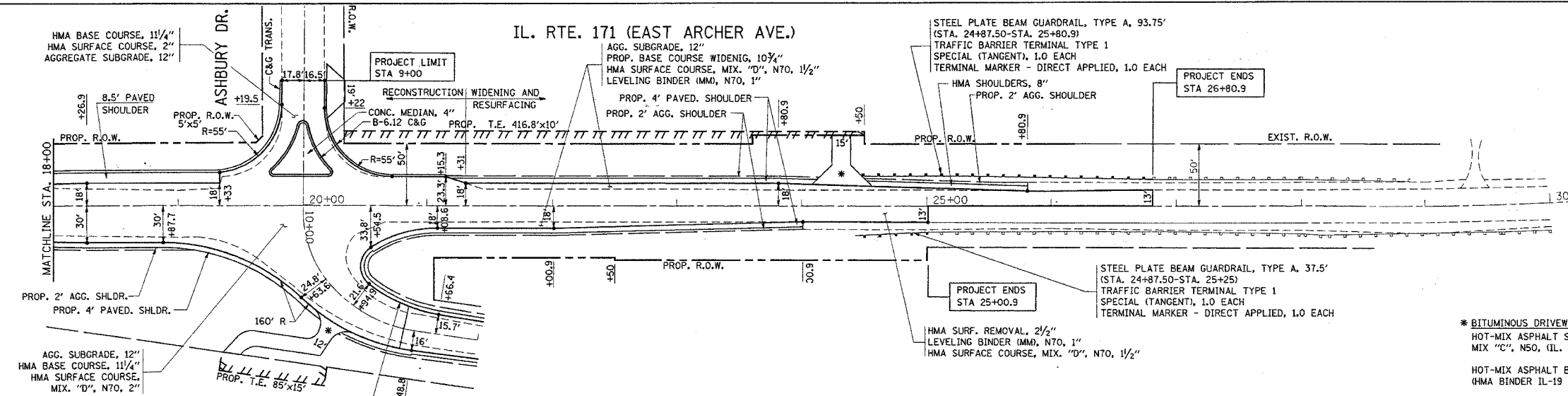

\* BITUMINOUS DRIVEWAY (PE)  
 HOT-MIX ASPHALT SURFACE COURSE,  
 MIX "C", NSO, (1L 9.5 mm), 2"  
 HOT-MIX ASPHALT BASE COURSE,  
 (HMA BINDER 1L-19 mm), 6"

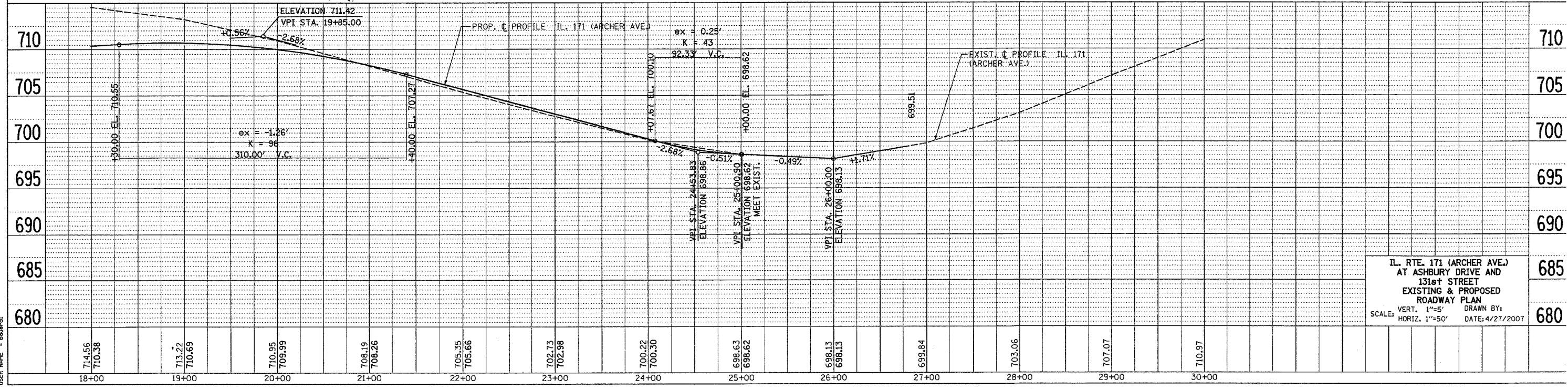

IL. RTE. 171 (ARCHER AVE.)  
 AT ASHBURY DRIVE AND  
 131st STREET  
 EXISTING & PROPOSED  
 ROADWAY PLAN  
 SCALE: VERT. 1"=5' HORIZ. 1"=50'  
 DRAWN BY: DATE: 4/27/2007

DATE	BY	REVISION

DATE	BY	REVISION

PLOT DATE = 4/27/2007  
 PLOT SCALE = 1"=50' / 1"=50'  
 USER NAME = bauerl