

F.A.P. RTE.	SECTION	COUNTY	TOTAL SHEETS	SHEET NO.
577	3114 N-1	COOK	72	14
STA. 9+00		TO STA. 18+00		
FED. ROAD DIST. NO. ILLINOIS FED. AID PROJECT				

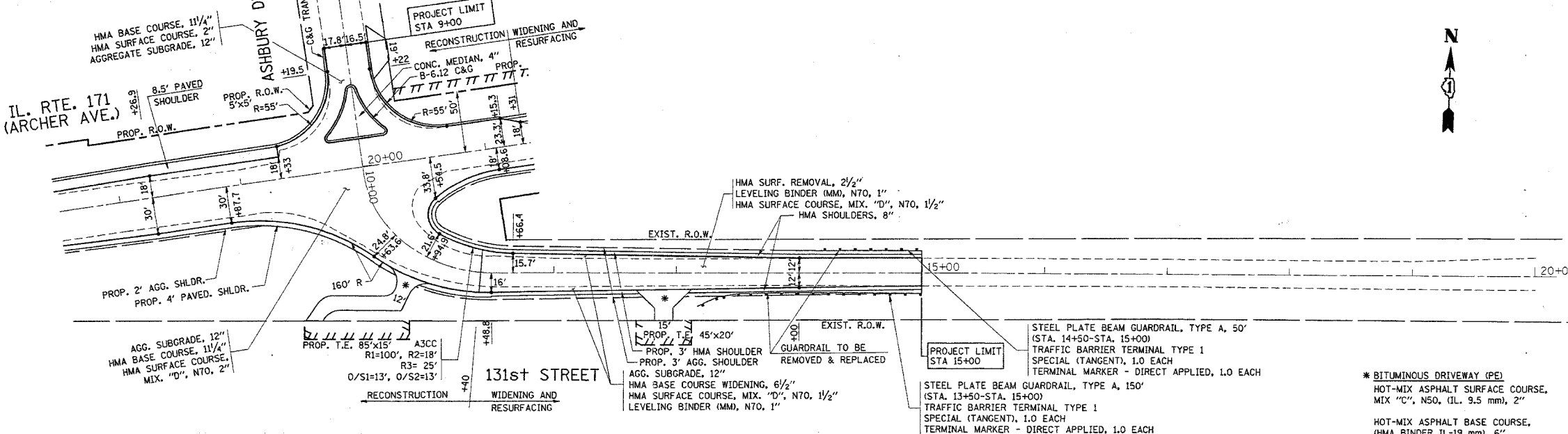
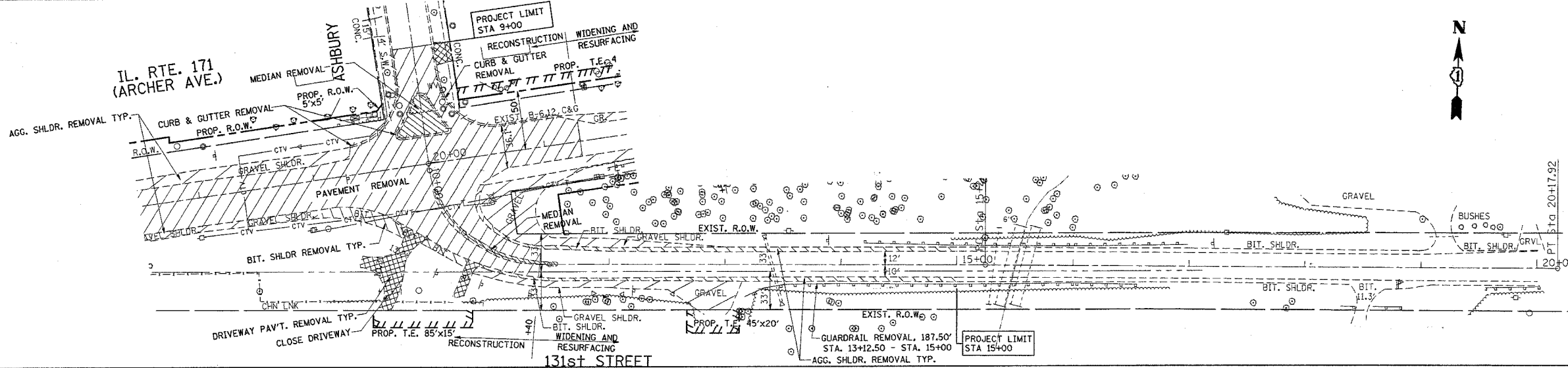

\* BITUMINOUS DRIVEWAY (PE)  
HOT-MIX ASPHALT SURFACE COURSE,  
MIX "C", NSO, (IL. 9.5 mm), 2"  
HOT-MIX ASPHALT BASE COURSE,  
(HMA BINDER IL-19 mm), 6"

PLAN

DATE	BY

REVISIONS:  
PLOTTED  
CHECKED  
DATE  
BY  
NO. FILE NAME

PROFILE

DATE	BY

REVISIONS:  
PLOTTED  
CHECKED  
DATE  
BY  
NO. FILE NAME

PLOT DATE = 4/27/2007  
PLOT SCALE = 50.0000' / IN.  
USER NAME = bward1

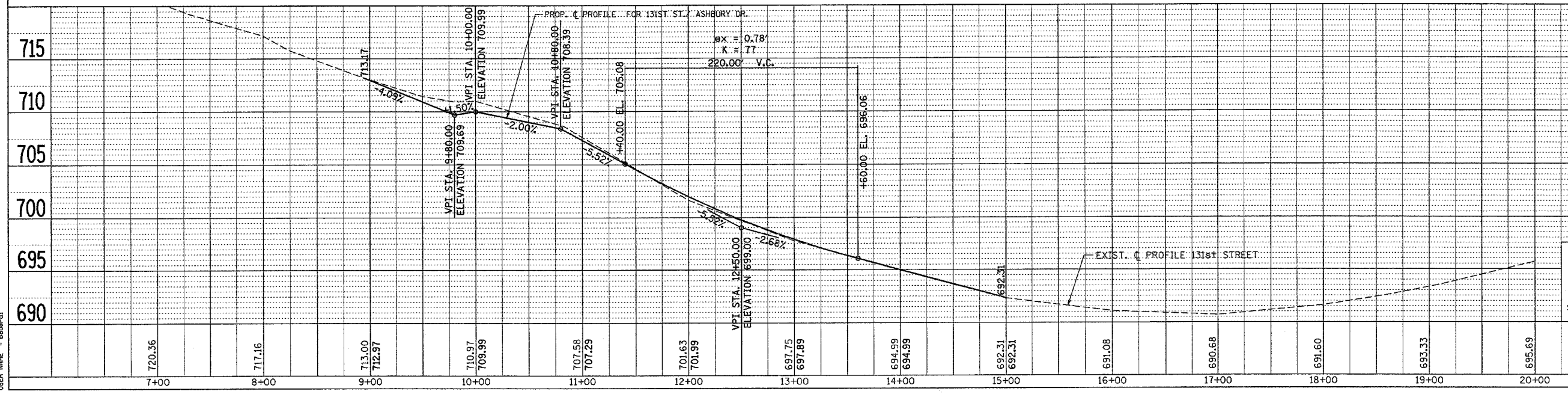

IL. RTE. 171 (ARCHER AVE.)  
AT ASHBURY DRIVE AND  
131st STREET  
EXISTING & PROPOSED  
ROADWAY PLAN  
SCALE: VERT. 1"=5'  
HORIZ. 1"=50'  
DRAWN BY:  
DATE: 4/27/2007