

F.A.P. RTE.	SECTION	COUNTY	TOTAL SHEETS	SHEET NO.
577	3114 N-1	COOK		26
STA. 18+00		TO STA. 30+00		
FED. ROAD DIST. NO.		ILLINOIS FED. AID PROJECT		

IL. RTE. 171 (EAST ARCHER AVE.)

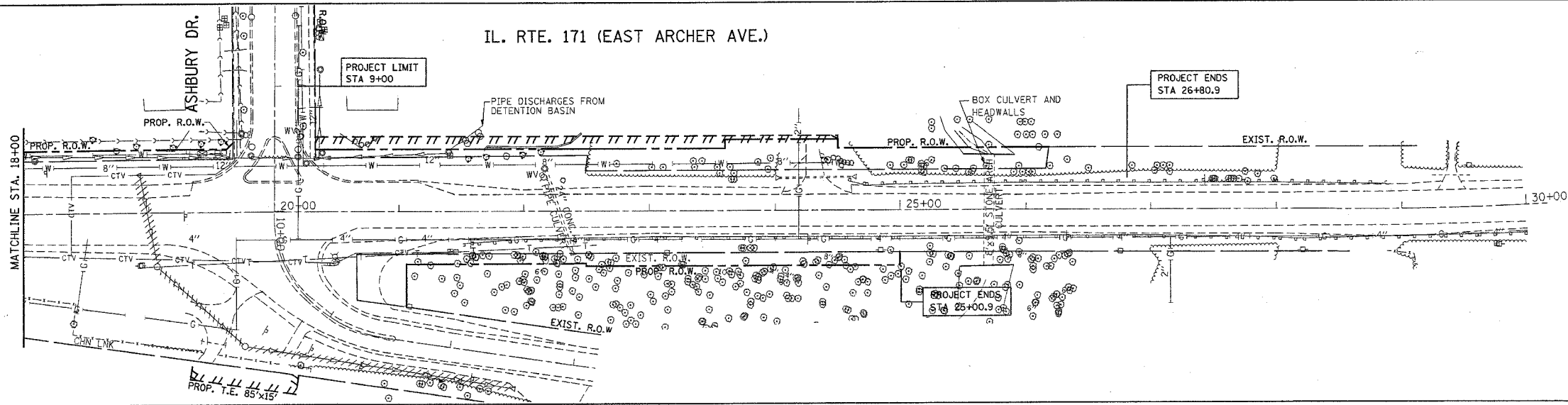

IL. RTE. 171 (EAST ARCHER AVE.)

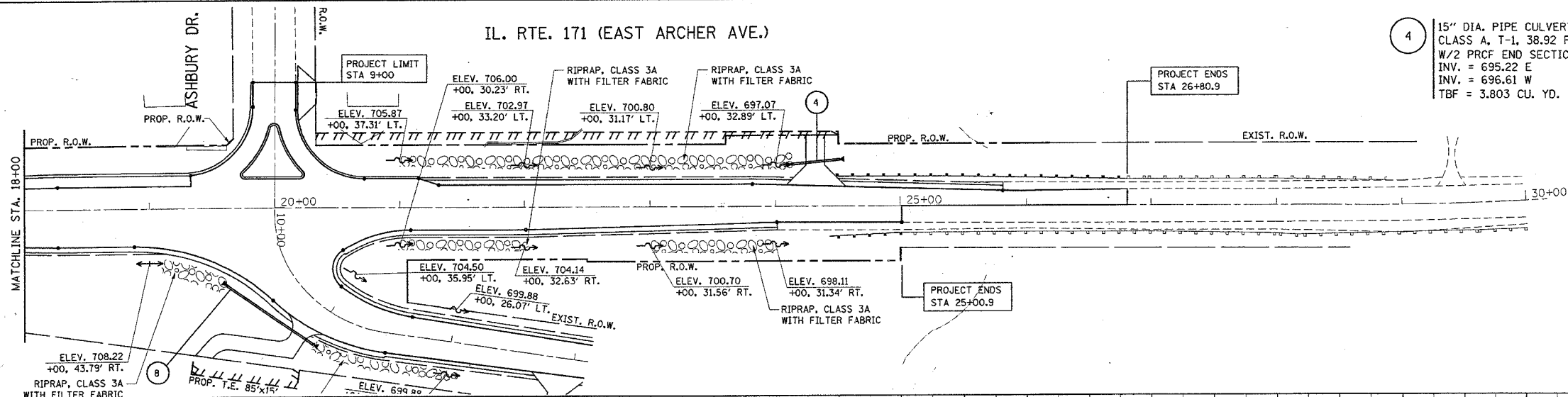

4 15" DIA. PIPE CULVERT  
 CLASS A, T-1, 38.92 FT., 37.42' LT.  
 W/2 PRCF END SECTIONS, 15'  
 INV. = 695.22 E  
 INV. = 696.61 W  
 TBF = 3.803 CU. YD.

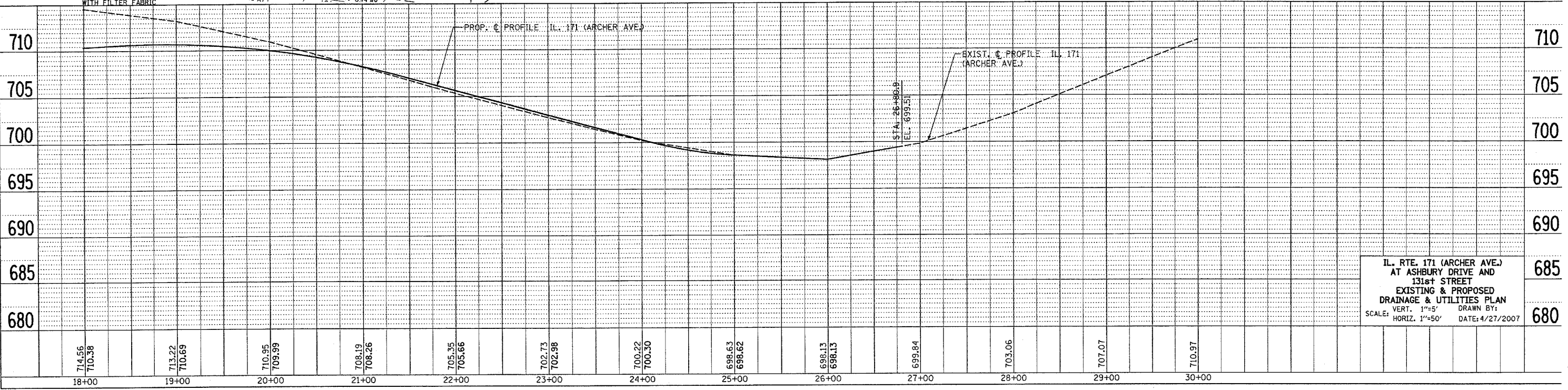

IL. RTE. 171 (ARCHER AVE.)  
 AT ASHBURY DRIVE AND  
 131st STREET  
 EXISTING & PROPOSED  
 DRAINAGE & UTILITIES PLAN  
 SCALE: VERT. 1"=5' HORIZ. 1"=50' DATE: 4/27/2007

PLAN

REVISION	DATE
BY	
CHECKED	
DATE	
NOTE BOOK NO.	
FILE NAME	
USER NAME	

PROFILE

REVISION	DATE
BY	
CHECKED	
DATE	
NOTE BOOK NO.	
FILE NAME	
USER NAME	

PLOT DATE = 4/27/2007  
 FILE NAME = C:\Projects\60A25\131st\131st.dwg  
 USER NAME = [Name]