

F.A.P. RTE.	SECTION	COUNTY	TOTAL SHEETS	SHEET NO.
577	3114 N-1	COOK	72	35
STA. 10+00		TO STA. 28+00		
FED. ROAD DIST. NO.		ILLINOIS FED. AID PROJECT		

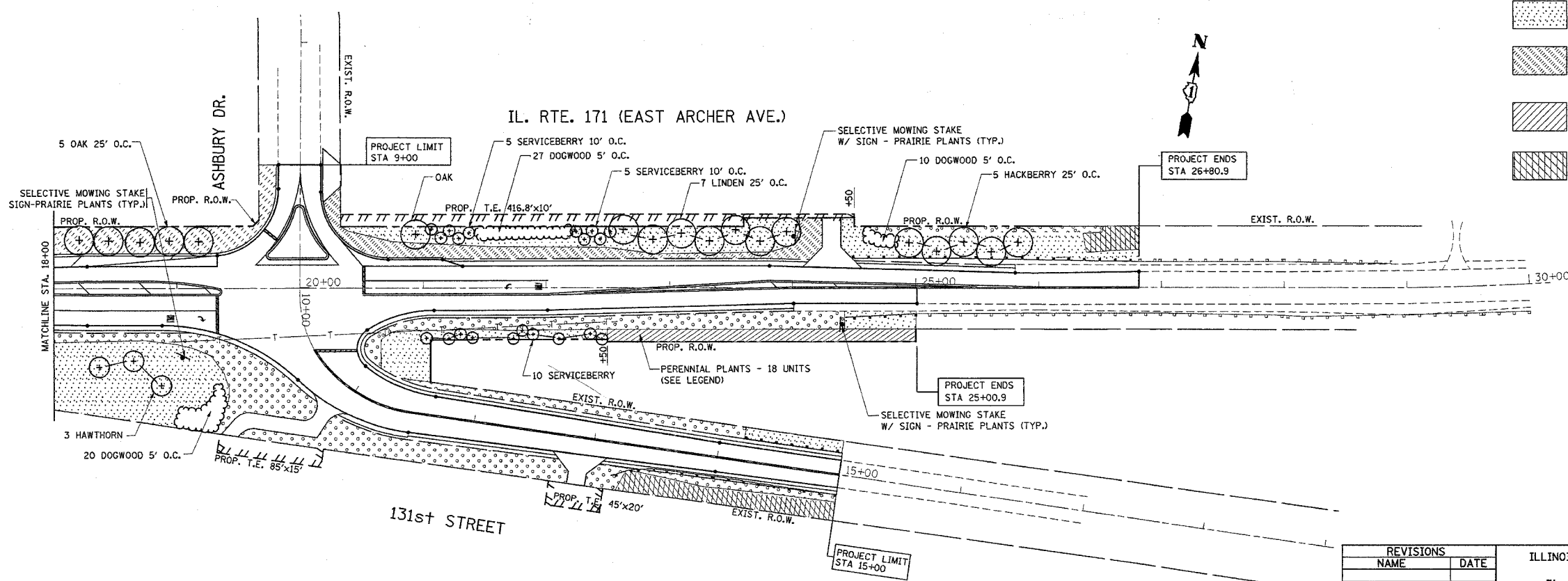
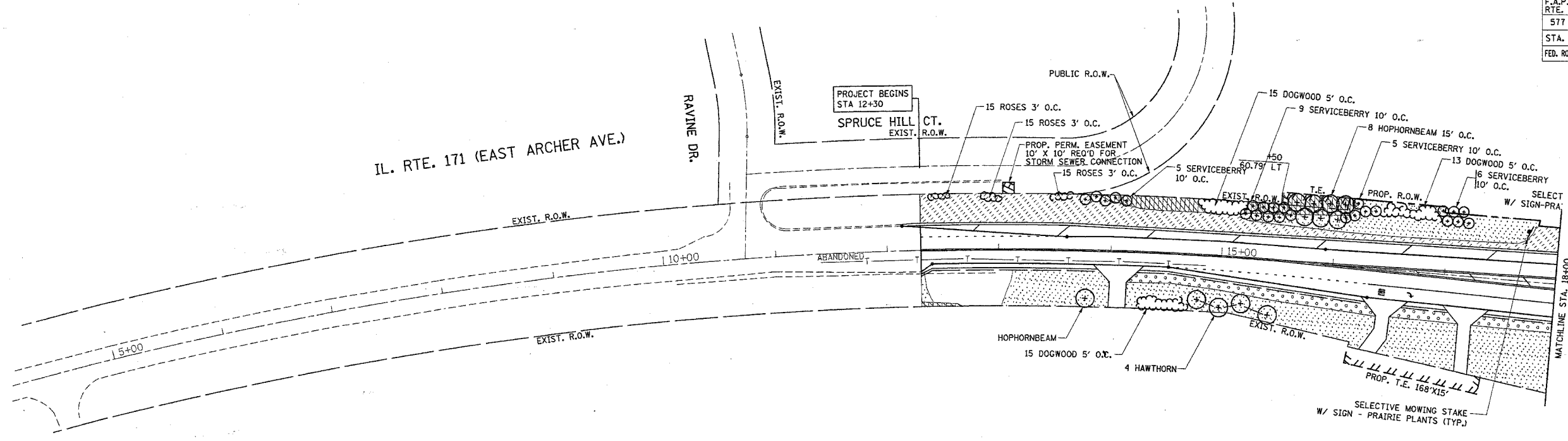

LEGEND

- SEEDING CLASS 2A
TOPSOIL
EROSION CONTROL BLANKET
- SEEDING CLASS 4A
COMPOST FURNISH & PLACE, 4"
EROSION CONTROL BLANKET
- SODDING, SALT TOLERANT
TOPSOIL
- PERENNIAL PLANTS, WOODLAND TYPE
PERENNIAL PLANTS, SEDGES
COARSE SAND PLACEMENT, 2"
COMPOST FURNISH & PLACE, 2"
- SELECTIVE CLEARING (1000 SQ. FT./UNIT)
MULCH PLACEMENT, 4"

REVISIONS	
NAME	DATE

ILLINOIS DEPARTMENT OF TRANSPORTATION
**IL. RTE. 171 (ARCHER AVE.)
 AT ASHBURY DRIVE AND
 131st STREET**
 PROPOSED LANDSCAPING PLAN

SCALE: VERT. 1"=50'
 HORIZ. 1"=50'
 DATE 4/25/2007

DRAWN BY _____
 CHECKED BY _____

PLOT DATE = 4/25/2007
 FILE NAME = c:\projects\60a25\60a25.dgn
 PLOT SCALE = 1/8"=1'-0"
 USER NAME = jprichard