

60A88

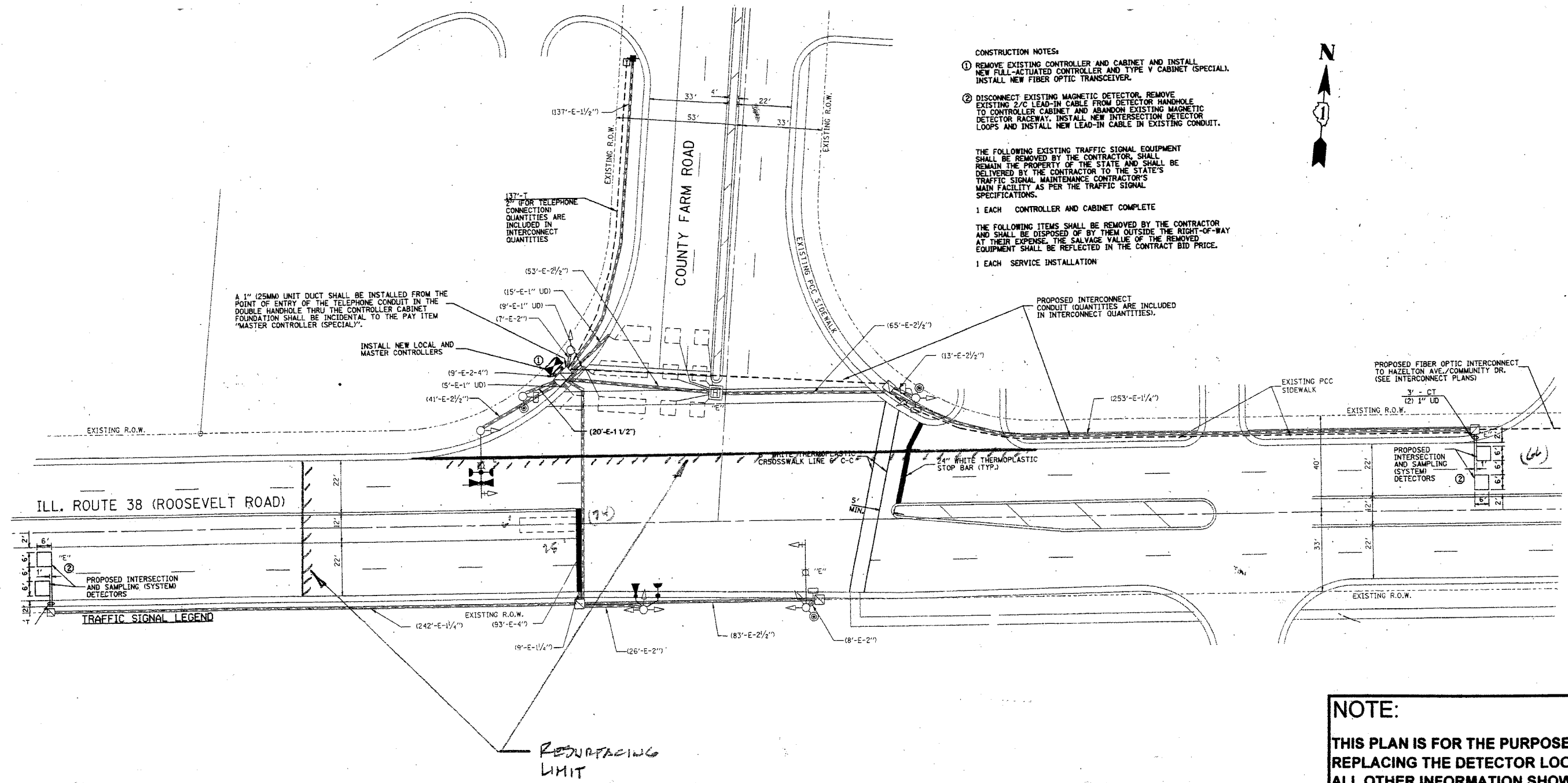

CONSTRUCTION NOTES:

- REMOVE EXISTING CONTROLLER AND CABINET AND INSTALL NEW FULL-ACTUATED CONTROLLER AND TYPE V CABINET (SPECIAL). INSTALL NEW FIBER OPTIC TRANSCEIVER.
- DISCONNECT EXISTING MAGNETIC DETECTOR. REMOVE EXISTING 2/C LEAD-IN CABLE FROM DETECTOR HANDHOLE TO CONTROLLER CABINET AND ABANDON EXISTING MAGNETIC DETECTOR RACEWAY. INSTALL NEW INTERSECTION DETECTOR LOOPS AND INSTALL NEW LEAD-IN CABLE IN EXISTING CONDUIT.

THE FOLLOWING EXISTING TRAFFIC SIGNAL EQUIPMENT SHALL BE REMOVED BY THE CONTRACTOR, SHALL REMAIN THE PROPERTY OF THE STATE AND SHALL BE DELIVERED BY THE CONTRACTOR TO THE STATE'S TRAFFIC SIGNAL MAINTENANCE CONTRACTOR'S MAIN FACILITY AS PER THE TRAFFIC SIGNAL SPECIFICATIONS.

1 EACH CONTROLLER AND CABINET COMPLETE

THE FOLLOWING ITEMS SHALL BE REMOVED BY THE CONTRACTOR AND SHALL BE DISPOSED OF BY THEM OUTSIDE THE RIGHT-OF-WAY AT THEIR EXPENSE. THE SALVAGE VALUE OF THE REMOVED EQUIPMENT SHALL BE REFLECTED IN THE CONTRACT BID PRICE.

1 EACH SERVICE INSTALLATION



NOTE:

THIS PLAN IS FOR THE PURPOSE OF REPLACING THE DETECTOR LOOPS ONLY. ALL OTHER INFORMATION SHOWN IS NOT RELATED AND WILL BE DISREGARDED.

REPLACE ALL DETECTOR LOOPS AS SHOWN

(WITHIN THE RESURFACING LIMITS)

CODE NO.	QUANTITY	UNIT	ITEM
86600600	140	Foot	Detector Loop Replacement

REVISIONS	
NAME	DATE

ILLINOIS DEPARTMENT OF TRANSPORTATION

DETECTOR LOOP REPLACEMENT

ILL. ROUTE 38 @ COUNTY FARM RD.

SCALE: *AS SHOWN*

DATE: *MAR. 2007*

DRAWN BY: JHE
 DESIGNED BY: JHE
 CHECKED BY: DAD