

F.A.P. RTE.	SECTION	COUNTY	TOTAL SHEETS	SHEET NO.
344	2005-079 TS	DuPAGE	19	13
STA.	TO STA.			
FED. ROAD DIST. NO.	ILLINOIS	FED. AID PROJECT		
CONTRACT NO. 60A92				

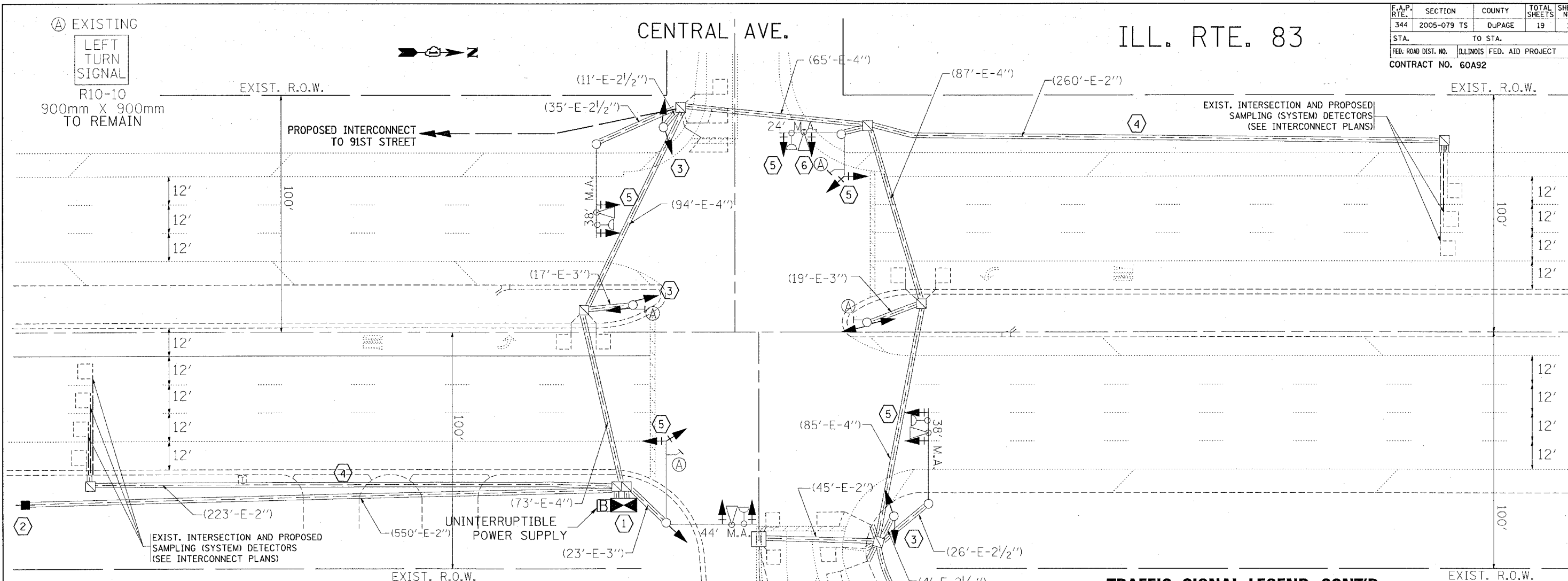

TRAFFIC SIGNAL LEGEND

	PROPOSED	EXISTING
CONTROLLER CABINET		
RAILROAD CONTROL CABINET		
SERVICE INSTALLATION, (P) POLE OR (G) GROUND MOUNT		
TELEPHONE CONNECTION		
SIGNAL HEAD		
SIGNAL HEAD WITH BACKPLATE		
SIGNAL HEAD OPTICALLY PROGRAMMED		
SIGNAL HEAD PEDESTRIAN		
SIGNAL POST		
WOOD POLE		
STEEL MAST ARM ASSEMBLY AND POLE		
ALUMINUM MAST ARM ASSEMBLY AND POLE		
STEEL COMBINATION MAST ARM ASSEMBLY AND POLE WITH LUMINAIRE		
UNINTERRUPTIBLE POWER SYSTEM		

- CONSTRUCTION NOTES:**
- REMOVE EXISTING CONTROLLER AND CABINET. INSTALL NEW CONTROLLER AND TYPE V CABINET. RE-USE EXISTING FOUNDATION. RELOCATE EXISTING EMERGENCY VEHICLE PRIORITY SYSTEM PHASING UNIT TO NEW CONTROLLER CABINET INCLUDED IN COST OF THE NEW CONTROLLER AND CABINET.
 - REMOVE EXISTING SERVICE CABLE AND SERVICE. INSTALL NEW SERVICE, SERVICE CABLE AND GROUND CABLE.
 - REMOVE EXISTING TRAFFIC SIGNAL HEADS AND REPLACE THEM WITH NEW L.E.D. SIGNAL.
 - INSTALL NEW ELECTRIC CABLE IN CONDUIT, LEAD-IN NO. 14 1 PAIR.
 - REMOVE EXISTING TRAFFIC SIGNAL HEADS AND REPLACE THEM WITH NEW L.E.D. 1-FACE, 3-SECTION MAST ARM MOUNTED SIGNAL AND BACKPLATE.
 - REMOVE EXISTING TRAFFIC SIGNAL HEADS AND REPLACE THEM WITH NEW L.E.D. 1-FACE, 5-SECTION MAST ARM MOUNTED SIGNAL AND BACKPLATE.

TRAFFIC SIGNAL LEGEND CONT'D.

	PROPOSED	EXISTING
EMERGENCY VEHICLE SYSTEM DETECTOR		
CONFIRMATION BEACON		
JUNCTION BOX		
HANDHOLE		
HEAVY DUTY HANDHOLE		
DOUBLE HANDHOLE		
G.S. CONDUIT IN TRENCH OR PUSHED		
COMMON TRENCH	CT	
UNIT DUCT	UD	
PEDESTRIAN PUSHBUTTON DETECTOR		
DETECTOR LOOP, TYPE I		
PERFORMED DETECTOR LOOP		

RESTORATION OF WORK AREA, RESTORATION OF THE TRAFFIC SIGNAL WORK AREA SHALL BE INCLUDED IN THE RELATED PAY ITEMS SUCH AS FOUNDATION, CONDUIT, HANDHOLE, TRENCH AND BACKFILL, ETC. ALL ROADWAY SURFACES SUCH AS SHOULDERS, MEDIANS, SIDEWALKS, PAVEMENT, ETC. SHALL BE REPLACED IN KIND. ALL DAMAGE TO MOWED LAWNS SHALL BE REPLACED WITH AN APPROVED SOD AND ALL DAMAGE TO UNMOWED FIELDS SHALL BE SEEDED. RESTORATION OF THE WORK AREA SHALL BE INCIDENTAL TO THE CONTRACT WITHOUT ANY EXTRA COMPENSATION ALLOWED TO THE CONTRACTOR.

REVISIONS	
NAME	DATE

ILLINOIS DEPARTMENT OF TRANSPORTATION

TRAFFIC SIGNAL MODERNIZATION PLAN

ILL. RTE. 83 AT CENTRAL AVE.

SCALE: VERT. 1"=20'
HORIZ. DATE 3/16/2007

DRAWN BY: BCK
DESIGNED BY: BCK
CHECKED BY: DAD

PLOT DATE = 3/16/2007
PLOT SCALE = 20/8000 / IN.
USER NAME = kamrapph\vejb