

ROUTE	SECTION	COUNTY	TOTAL SHEETS	SHEET NUMBER
FAP 362	N-6-7-1-1	COOK	14+2=16	1

FOR INDEX OF SHEETS SEE SHEET 2

STATE OF ILLINOIS
DEPARTMENT OF TRANSPORTATION
DIVISION OF HIGHWAYS
DISTRICT ONE
PROPOSED HIGHWAY PLANS

CONTRACT NO. 60B28

D-91-318-06

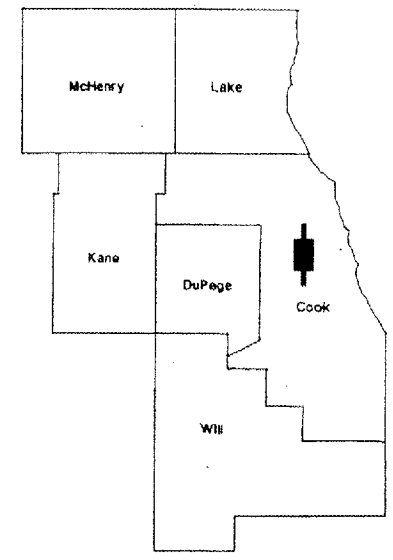

LOCATION OF IMPROVEMENT INDICATED THUS:

IMPROVEMENT IS LOCATED IN THE VILLAGE OF HOFFMAN ESTATES

FAP ROUTE 362 : BARRINGTON ROAD
 OVER I-90 (NORTHWEST TOLLWAY)
 SECTION : N-6-7-1-1
 BRIDGE REPAIR &
 OVERLAY APPROACHES
 COOK COUNTY
 C-91-318-06
 SN 016-0522

LOCATION OF IMPROVEMENT SN 016-0522

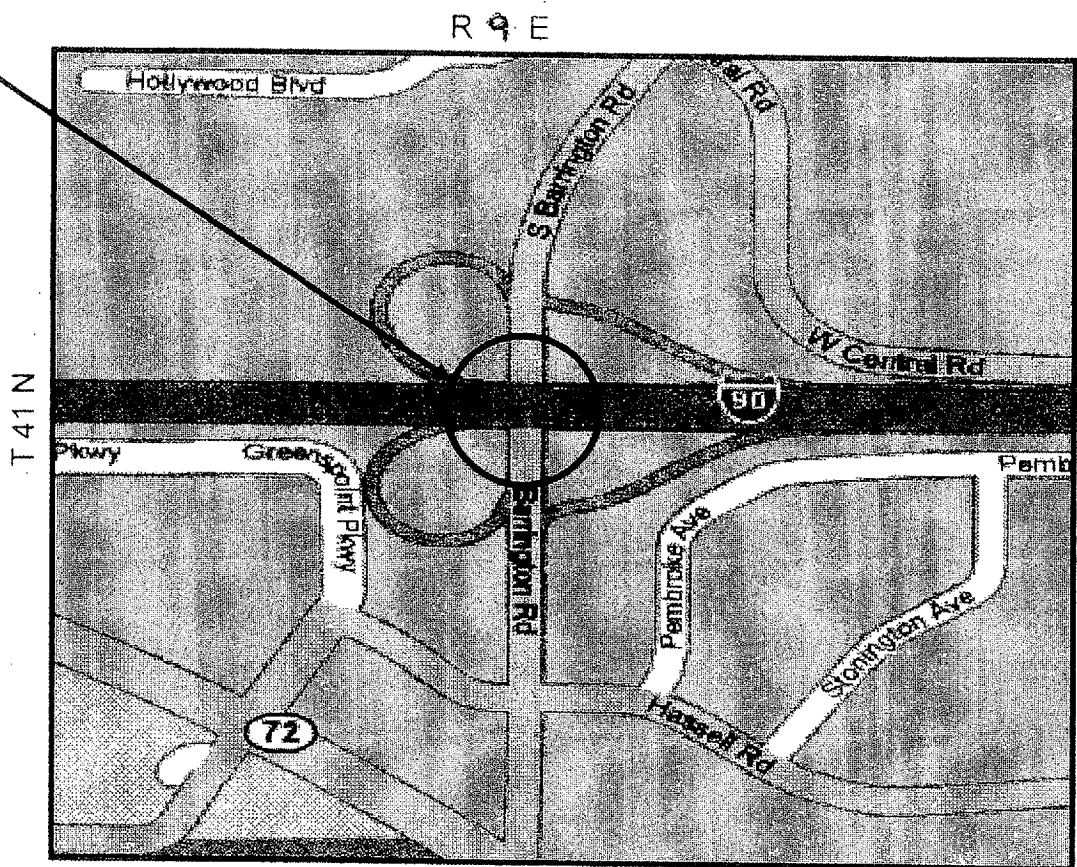

TRAFFIC DATA:
 BARRINGTON RD: SPEED LIMIT = 40 MPH
 2006 ADT = 42,600
 I-90 (NW TOLLWAY): SPEED LIMIT = 55 MPH
 2006 ADT = 146900

CONTRACT NO. 60B28

SCHAUMBURG TOWNSHIP

STATE OF ILLINOIS
 DEPARTMENT OF TRANSPORTATION
 DIVISION OF HIGHWAYS
 SUBMITTED: March 27 2007
Diane O'Keefe
 DEPUTY DIRECTOR OF HIGHWAYS, REGION ENGINEER
May 11, 2007
Eric E. Harnik
 INTERIM ENGINEER OF DESIGN AND ENVIRONMENT
May 11, 2007
Milton R. Sees, P.E.
 DIRECTOR, DIVISION OF HIGHWAYS

PRINTED BY THE AUTHORITY OF THE STATE OF ILLINOIS

J.U.L.I.E.: JOINT UTILITY LOCATION INFORMATION FOR EXCAVATION
 (800) 892-0123

DISTRICT ONE - DESIGN - PLAN PREPARATION ENGINEER:
 KEN ENG / ROBERT BORO (847) 705-4178

ROUTE	SECTION	COUNTY	TOTAL SHEETS	SHEET NUMBER
FAP 362	N-6-7-I-1	COOK	14	2

INDEX OF SHEETS

SHEET NO.	DESCRIPTION
1	COVER SHEET
2	INDEX OF SHEETS, STANDARDS, AND GENERAL NOTES
3	SUMMARY OF QUANTITIES
4	TYPICAL SECTION
5-8	BRIDGE PLANS
9-10	TRAFFIC STAGING
11 11A	ALTERNATE ROUTE PLAN PERMANENT PROTECTIVE SHIELD
12A	BUTT JOINT AND HMA TAPER DETAIL
13	TYPICAL APPLICATIONS RAISED REFLECTIVE PAVEMENT MARKERS (SNOW-PLOW RESISTANCE)
14	DISTRICT ONE TYPICAL PAVEMENT MARKINGS

LIST OF STATE STANDARDS

STANDARD NO.	DESCRIPTION
701301-02	LANE CLOSURE 2L,2W SHORT TIME OPERATIONS
701411-03	MULTI-LANE, TRAFFIC CONTROL AT ENTERANCE OR EXIT RAMPS
701400-02	APPROCH TO LANE CLOSURE FREEWAY/EXPRESSWAY
701401-03	LANE CLOSURE FREEWAY/EXPRESSWAY
701601-04	URBAN LANE CLOSURE, MULTILANE, 1W OR 2W WITH NONTRAVERSABLE MEDIAN
702001-06	TRAFFIC CONTROL DEVICES

GENERAL NOTES

BEFORE STARTING ANY EXCAVATION, THE CONTRACTOR SHALL CALL "JULIE" AT 800-892-0123 FOR FIELD LOCATIONS OF BURIED ELECTRIC, TELEPHONE AND GAS FACILITIES. (48 HOUR NOTIFICATION IS REQUIRED)

THE CONTRACTOR SHALL COORDINATE CONSTRUCTION ACTIVITIES WITH UTILITY COMPANIES.

THE CONTRACTOR WILL NOT BE ALLOWED TO SET UP A YARD OR FIELD OFFICE ON STATE PROPERTY WITHOUT WRITTEN PERMISSION FROM THE DEPARTMENT.

The Contractor shall coordinate construction activities with utility companies.

ALL DAMAGE TO EXISTING PAVEMENT MARKING OR RAISED REFLECTIVE PAVEMENT MARKINGS OUTSIDE THE REMOVAL LINE SHOWN ON THE PLANS SHALL BE REPLACED AT THE CONTRACTOR'S EXPENSE.

WHEN MILLED PAVEMENT IS OPEN TO TRAFFIC THE MAXIMUM GRADE DIFFERENTIAL BETWEEN PASSES OF THE MILLING MACHINE SHALL NOT EXCEED 40 MM (1 1/2 INCHES) WHERE THE SPEED LIMIT IS 80 KM/H (45 MPH) OR LESS AND 25 MM (1 INCH) WHERE THE SPEED LIMIT IS GREATER THAN 80 KM/H (45 MPH). WITH WRITTEN APPROVAL FROM THE ENGINEER, A MAXIMUM GRADE DIFFERENTIAL OF 75 MM (3 INCHES) MAY BE ALLOWED IF THE EDGE OF THE MILLING IS SLOPED A MINIMUM 1:3 (V:H).

BUTT JOINTS WILL BE INSTALLED AT THE ENDS OF ALL RESURFACING (WHERE RESURFACING MEETS EXISTING PAVEMENT). IN ACCORDANCE WITH "BUTT JOINT AND HOT-MIX ASPHALT TAPER DETAILS" SHEET INCLUDE IN THE PLANS, UNLESS OTHERWISE SPECIFIED.

THE CONTRACTOR SHALL CONTACT THE DISTRICT ONE TRAFFIC CONTROL SUPERVISOR AT (847) 705-4470 FOR ARTERIALS & ISTHA DAILY TRAFFIC CONTROL AUTHORIZATION AT (630) 241-6800 EXT. 3822 FOR TOLLWAYS.

WHEN ARTIFICIAL LIGHTING IS UTILIZED IN NIGHT OPERATIONS, THE CONTRACTOR SHALL EXERCISE THE UTMOST PRECAUTIONS IN PREVENTING ADVERSE VISIBILITY TO THE MOTORING PUBLIC AND ADJOINING RESIDENTIAL AREA.

BEFORE BEGINNING ANY WORK, THE CONTRACTOR SHALL RETAIN AND RECORD FOR FUTURE REFERENCE, ALL EXISTING PAVEMENT MARKING LINES (AND RAISED REFLECTIVE PAVEMENT MARKERS) IN ORDER THAT THESE LOCATIONS CAN BE RE-ESTABLISHED FOR STRIPING. EXACT LOCATIONS OF ALL PAVEMENT MARKINGS SHALL BE AS DIRECTED BY THE ENGINEER.

THE ENGINEER SHALL CONTACT WALLY CZARNY TRAFFIC FIELD ENGINEER (OR TECHNICIAN), AT (773) 685-4342. A MINIMUM OF (2) WEEKS PRIOR TO PLACEMENT OF PERMANENT PAVEMENT MARKINGS.

THE "ADVANCE WARNING SIGN DETAIL FOR ARTERIAL TRAFFIC" LOCATED IN THE SPECIAL PROVISIONS FOR "TEMPORARY INFORMATION SIGNING FOR LANE CLOSURES" IS APPLICABLE ONLY TO ARTERIAL ROADS AND SHALL NOT BE APPLIED TO TOLLWAYS.

DO NOT SCALE PLANS FOR CONSTRUCTION DIMENSIONS

THESE PLANS HAVE BEEN PREPARED FROM NOTES RECEIVED FROM BRIDGE INSPECTORS.

PAVEMENT MARKING TAPE, TYPE III SHALL BE USE FOR SHORT TERM PAVEMENT MARKINGS ON ALL FINAL SURFACES. THE COST OF THE PAVEMENT MARKING TAPE, TYPE III AND ITS REMOVAL SHALL BE INCLUDED IN THE COST OF SHORT TERM PAVEMENT MARKING.

CONTRACT: 60B28

ILLINOIS DEPARTMENT OF
TRANSPORTATION

**INDEX OF SHEETS
LIST OF STATE STANDARDS
PLAN NOTES**

Rev.

SUMMARY OF QUANTITIES			URBAN TOTAL QUANTITIES		CONSTRUCTION TYPE CODE				
CODE NO	ITEM	UNIT		BRIDGE SN 016-0522 STATE 100% SFTY-2A					
40600200	BITUMINOUS MATERIALS (PRIME COAT)	TON	0.6	0.6					
40600300	AGGREGATE (PRIME COAT)	TON	3	3					
40600400	MIXTURE FOR CRACKS, JOINTS, AND FLANGEWAYS	TON	0.4	0.4					
40600635	LEVELING BINDER (MACHINE METHOD), N70	TON	27	27					
40600982	HOT-MIX ASPHALT SURFACE REMOVAL - BUTT JOINT	SO YD	61	61					
40600985	PORTLAND CEMENT CONCRETE SURFACE REMOVAL - BUTT JOINT	SO YD	203	203					
40603240	POLYMERIZED HOT-MIX ASPHALT BINDER COURSE, IL-19.0, N90	TON	385	385					
40603595	POLYMERIZED HOT-MIX ASPHALT SURFACE COURSE, MIX "F", N90	TON	156	156					
44000157	HOT-MIX ASPHALT SURFACE REMOVAL, 2"	SO YD	949	949					
44000705	BARRIER MEDIAN REMOVAL	SO FT	120	120					
45000130	RELIEF JOINT 4"	FOOT	120	120					
50157300	PROTECTIVE SHIELD	SO YD	1552	1552					
50300300	PROTECTIVE COAT	SO YD	230	230					
60623800	CONCRETE BARRIER MEDIAN	SO FT	120	120					
67100100	MOBILIZATION	L SUM	1	1					
70102670	TRAFFIC CONTROL AND PROTECTION, STANDARD 701601 (SPECIAL)	L SUM	1	1					
70103815	TRAFFIC CONTROL SURVEILLANCE	CAL DA	10	10					
70300100	SHORT-TERM PAVEMENT MARKING	FOOT	660	660					
70301000	WORK ZONE PAVEMENT MARKING REMOVAL	SO FT	2112	2112					
* 78000200	THERMOPLASTIC PAVEMENT MARKING - LINE 4"	FOOT	1045	1045					
* 78008210	POLYUREA PAVEMENT MARKING TYPE I - LINE 4"	FOOT	592	592					
* 78100100	RAISED REFLECTIVE PAVEMENT MARKER	EACH	23	23					
78300200	RAISED REFLECTIVE PAVEMENT MARKER REMOVAL	EACH	23	23					
X0322467	TEMPORARY INFORMATION SIGNING FOR LANE CLOSURE	SO FT	48	48					

SUMMARY OF QUANTITIES			URBAN TOTAL QUANTITIES		CONSTRUCTION TYPE CODE				
CODE NO	ITEM	UNIT		BRIDGE SN 016-0522 STATE 100% SFTY-2A					
X0323077	SILICONE JOINT SEALER, 2 3/4"	FOOT	160	160					
X7011015	TRAFFIC CONTROL AND PROTECTION (EXPRESSWAYS)	L SUM	1	1					
X7030100	WET TEMPORARY PAVEMENT MARKING TAPE, TYPE III	FOOT	6400	6400					
Z0016002	DECK SLAB REPAIR (FULL DEPTH, TYPE II)	SO YD	74	74					
Z0016200	DECK SLAB REPAIR (PARTIAL)	SO YD	167	167					
X0325775	WET REFLECTIVE TEMPORARY TAPE TYPE III, 4 INCH	FOOT	6400	6400					
X0322066	PROTECTIVE SHIELD (PERMANENT)	SQ YD	1458	1458					
Z0001700	APPROACH SLAB REPAIR (FULL DEPTH)	SQ YD	17	17					
60300310	FRAMES AND LIDS TO BE ADJUSTED (SPECIAL)	EACH	1	1					
X4400100	PORTLAND CEMENT CONCRETE SURFACE REMOVAL (VARIABLE DEPTH)	SQ YD	18	18					

*SPECIALTY ITEMS

REVISIONS	
NAME	DATE

ILLINOIS DEPARTMENT OF TRANSPORTATION
SUMMARY OF QUANTITIES

Rev.

4/3/2007

ROUTE	SECTION	COUNTY	TOTAL SHEETS	SHEET NUMBER
FAP 362	N-6-7-I-1	COOK	14	4

CONTRACT: 60B28

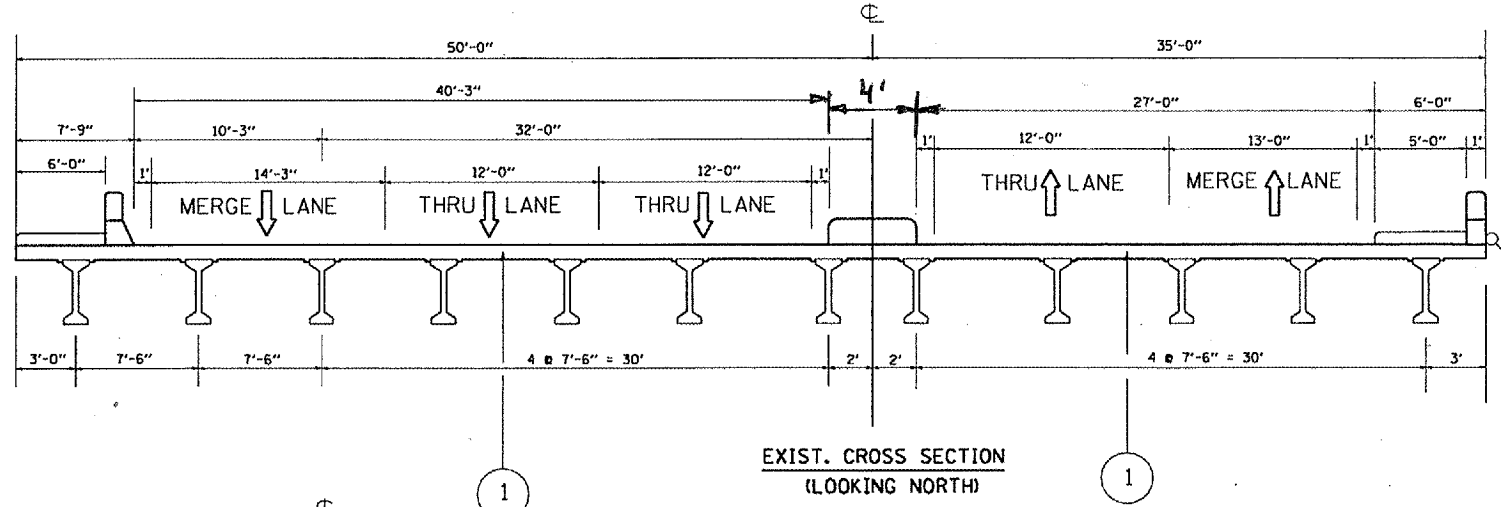

LEGEND
 ① EXIST. DECK THICKNESS, 9 1/2" (INCLUDING EXISTING OVERLAY)

NOTE:
 CONTRACTOR SHALL TAKE PRECAUTION NOT TO DAMAGE EXISTING TRAFFIC CONDUIT. ANY DAMAGE SHALL BE REPAIRED AT THE CONTRACTOR'S EXPENSE.

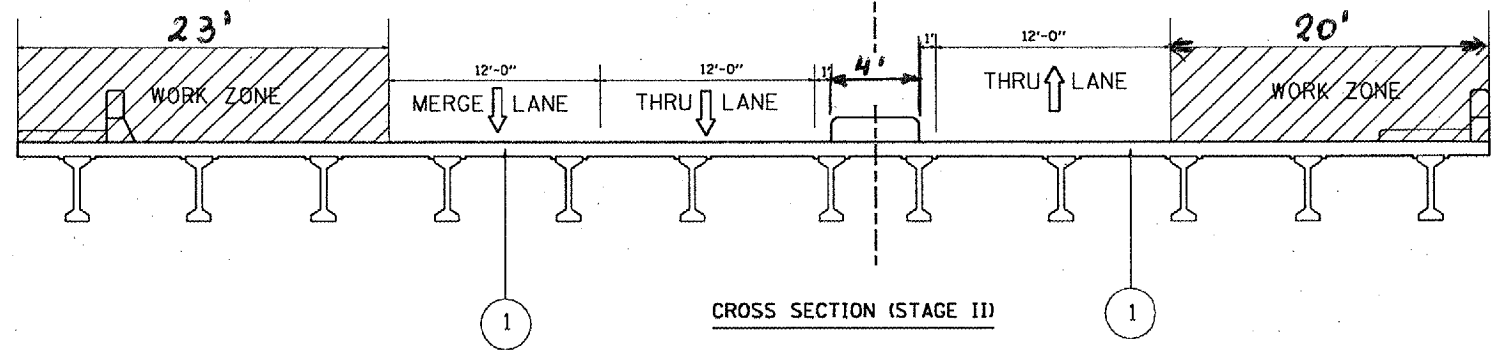
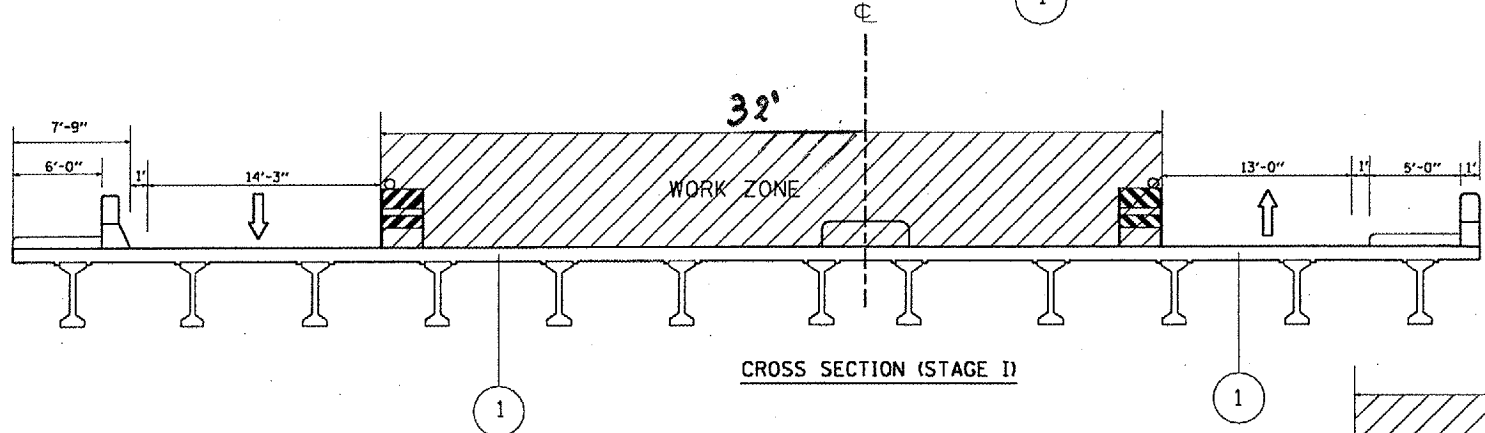

MIXTURE REQUIREMENTS		
MIXTURE USES	AC TYPE	VOIDS
POLY. HOT-MIX ASPHALT SURFACE COURSE, MIX "F", N90, IL 9.5 mm	SBS/SBR PG 70-22	4% AT 90 GYR.
POLY. HOT-MIX ASPHALT BINDER COURSE, IL-19.0, N90	SBS/SBR PG 70-22	4% AT 90 GYR.
LEVELING BINDER (MACHINE METHOD), N70, IL 9.5 mm	PG 64-22 *	4% AT 70 GYR.

NOTE 1: THE UNIT WEIGHT USED TO CALCULATE ALL HOT-MIX ASPHALT SURFACE MIXTURE IS 112 LBS/SQYD/IN
 * NOTE 2: WHEN RAP EXCEEDS 20% THE NEW ASPHALT BINDER IN THE MIX SHALL BE PG 58-22.

ILLINOIS DEPARTMENT OF
 TRANSPORTATION
 BARRINGTON RD
 OVER I-90 (NORTHWEST TOLLWAY)
 TYPICAL SECTION

ROUTE	SECTION	COUNTY	TOTAL SHEETS	SHEET NUMBER
FAP 362	N-6-7-I-1	COOK	14	5

CONTRACT: 60B28

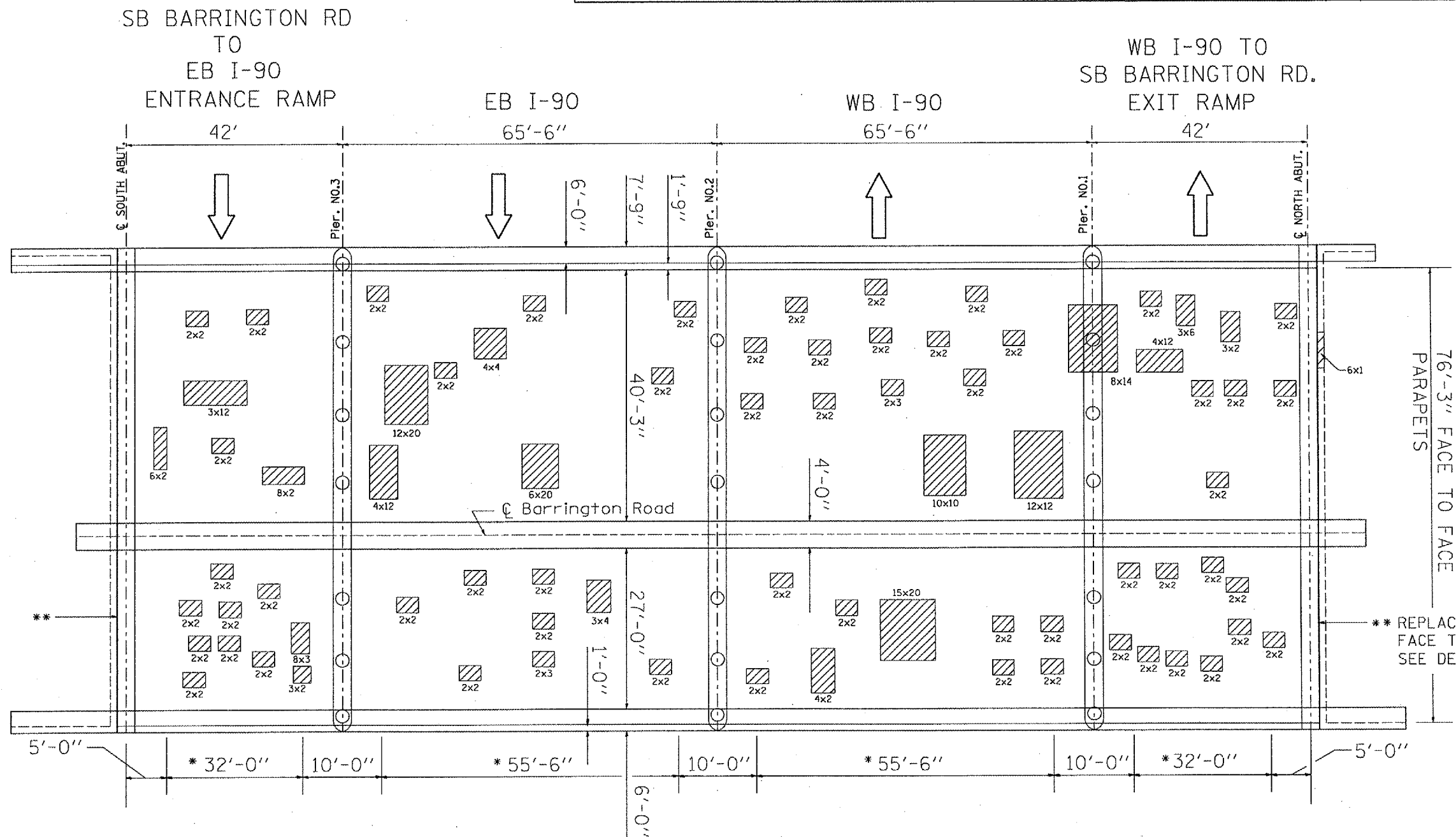

LEGEND

DECK SLAB REPAIR (PARTIAL DEPTH)

DATE OF SURVEY: 1-8-2007
 SURVEY BY: DD

ILLINOIS DEPARTMENT OF
 TRANSPORTATION
 BARRINGTON RD
 OVER I-90 (NORTHWEST TOLLWAY)
 DECK SLAB REPAIR (PARTIAL DEPTH)
 SN 016-0522

ROUTE	SECTION	COUNTY	TOTAL SHEETS	SHEET NUMBER
FAP 362	N-6-7-I-1	COOK	14	6

CONTRACT: 60B28

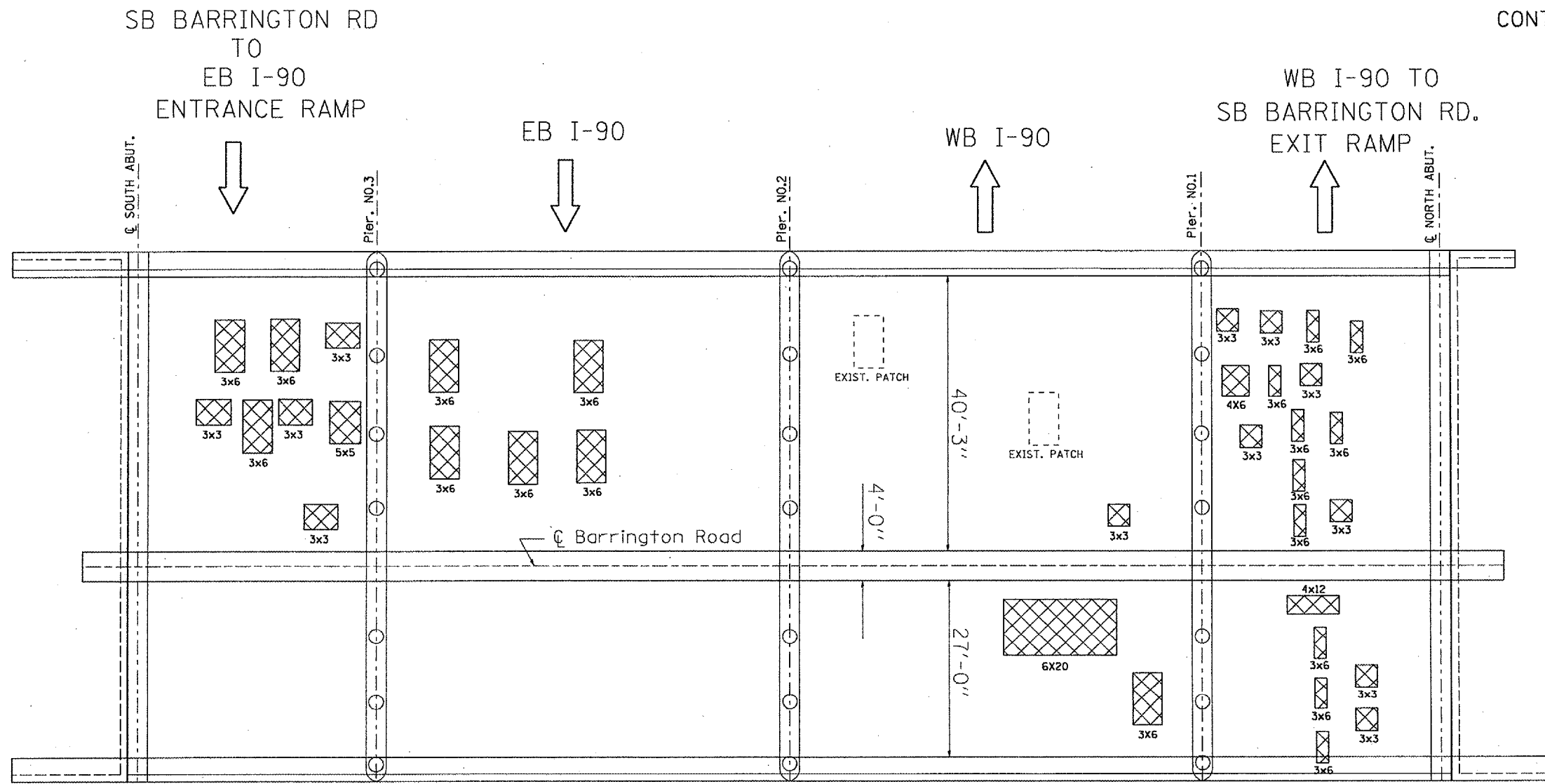

LEGEND

☒ DECK SLAB REPAIR (FULL DEPTH)

DATE OF SURVEY: 1-8-2007
 SURVEY BY: DD

ILLINOIS DEPARTMENT OF
 TRANSPORTATION
 BARRINGTON RD
 OVER I-90 (NORTHWEST TOLLWAY)
 BOTTOM DECK SURVEY
 SN 016-0522

ROUTE	SECTION	COUNTY	TOTAL SHEETS	SHEET NUMBER
362	N-6-7-I-1	COOK	14	7

CONTRACT: 60B28

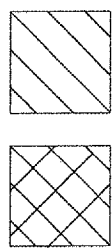
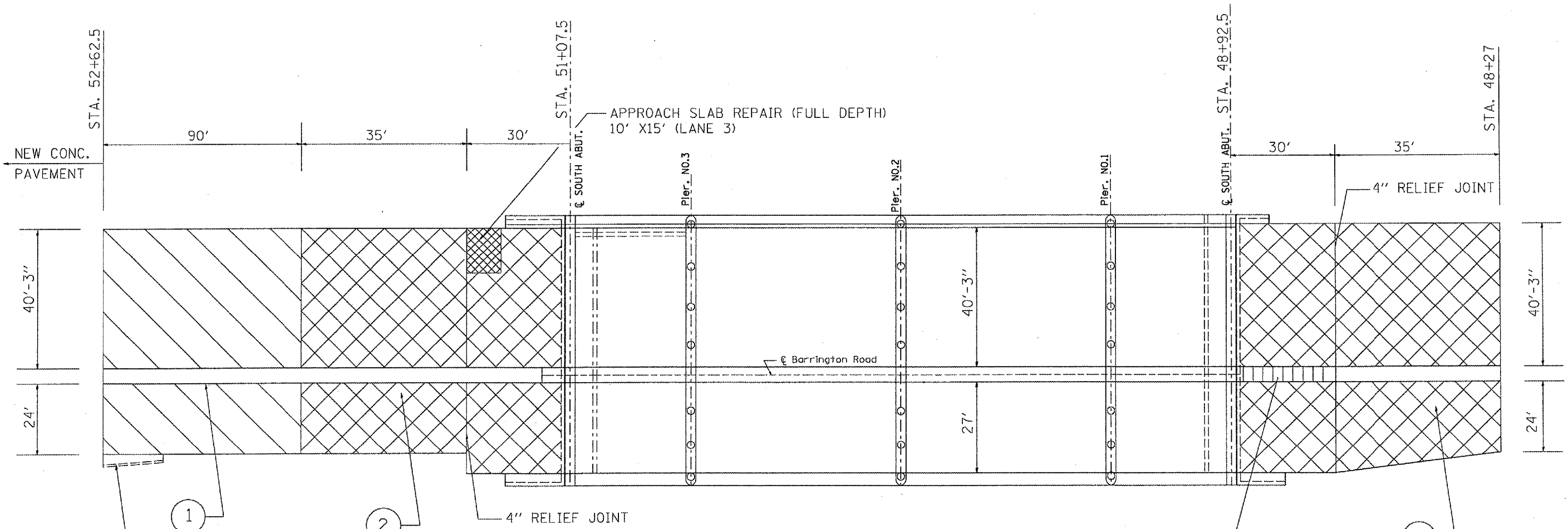

EXIST. COMB. CURB AND GUTTER
EXISTING CONCRETE PAVEMENT
EXISTING BIT. SURFACE

- ① PROP. POLYMERIZED HOT-MIX ASPHALT SURFACE COURSE, MIX "F", N90, 1 3/4"
PROP. LEVELING BINDER (MACHINE METHOD), N70, 3/4"
- ② PROP. HOT-MIX ASPHALT SURFACE REMOVAL, 2"
PROP. POLYMERIZED HOT-MIX ASPHALT SURFACE COURSE, MIX "F", N90, 1 3/4"
PROP. POLYMERIZED HOT-MIX ASPHALT BINDER COURSE, IL-19.0, N90
(VARIES 2 1/4" TO 12 1/4") SEE ROAD PROFILE SHEET

PROP. CONCRETE BARRIER MEDIAN
PROP. BARRIER MEDIAN REMOVAL

ILLINOIS DEPARTMENT OF
TRANSPORTATION
BARRINGTON RD
OVER I-90 (NORTHWEST TOLLWAY)

ROUTE	SECTION	COUNTY	TOTAL SHEETS	SHEET NUMBER
362	N-6-7-I-1	COOK	14	8

CONTRACT: 60B28

EXIST. ROAD PROFILE
NORTH OF BRIDGE

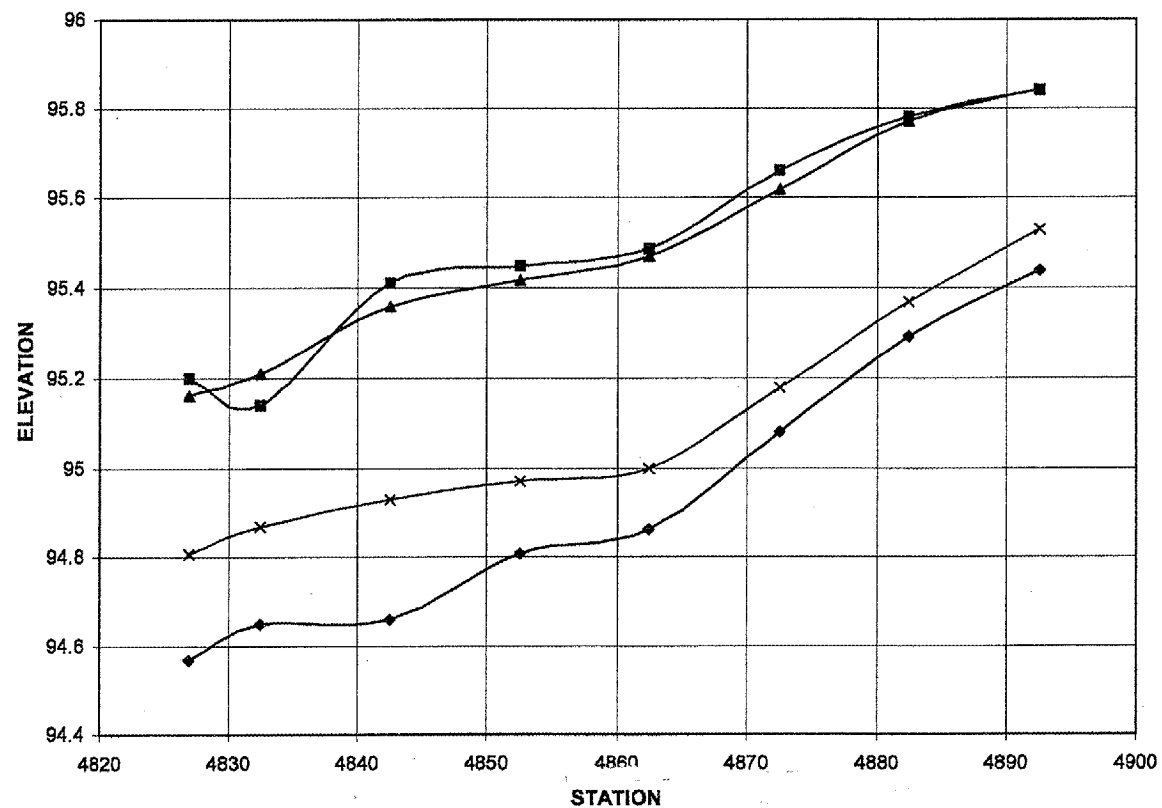

EXIST. ROAD PROFILE
SOUTH OF BRIDGE

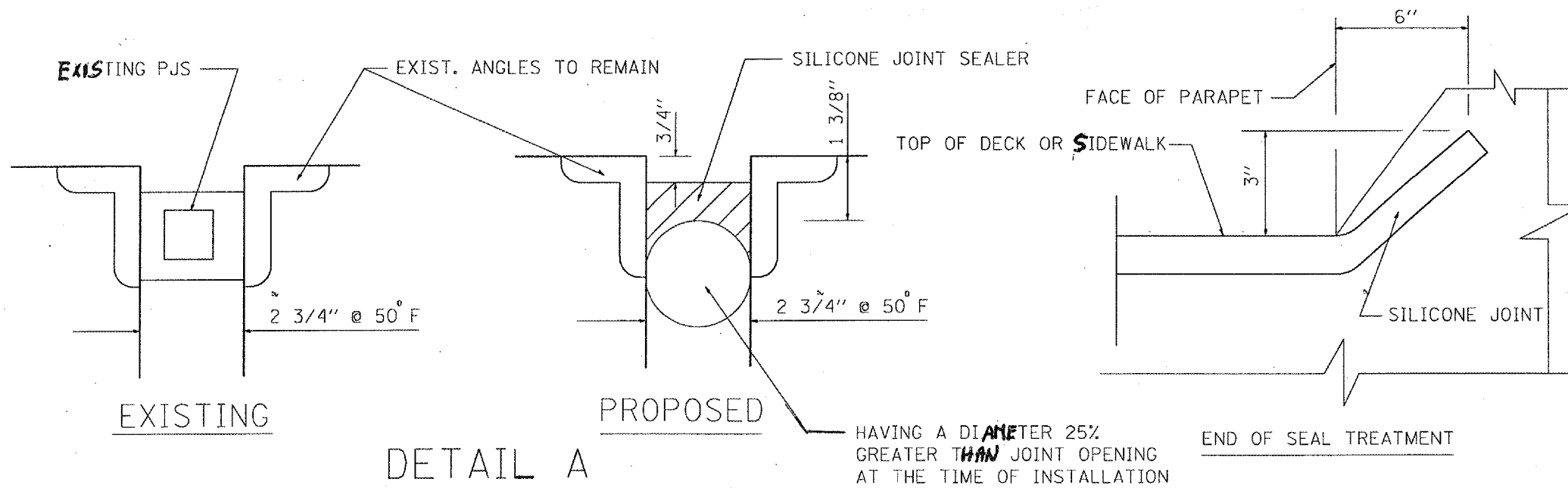
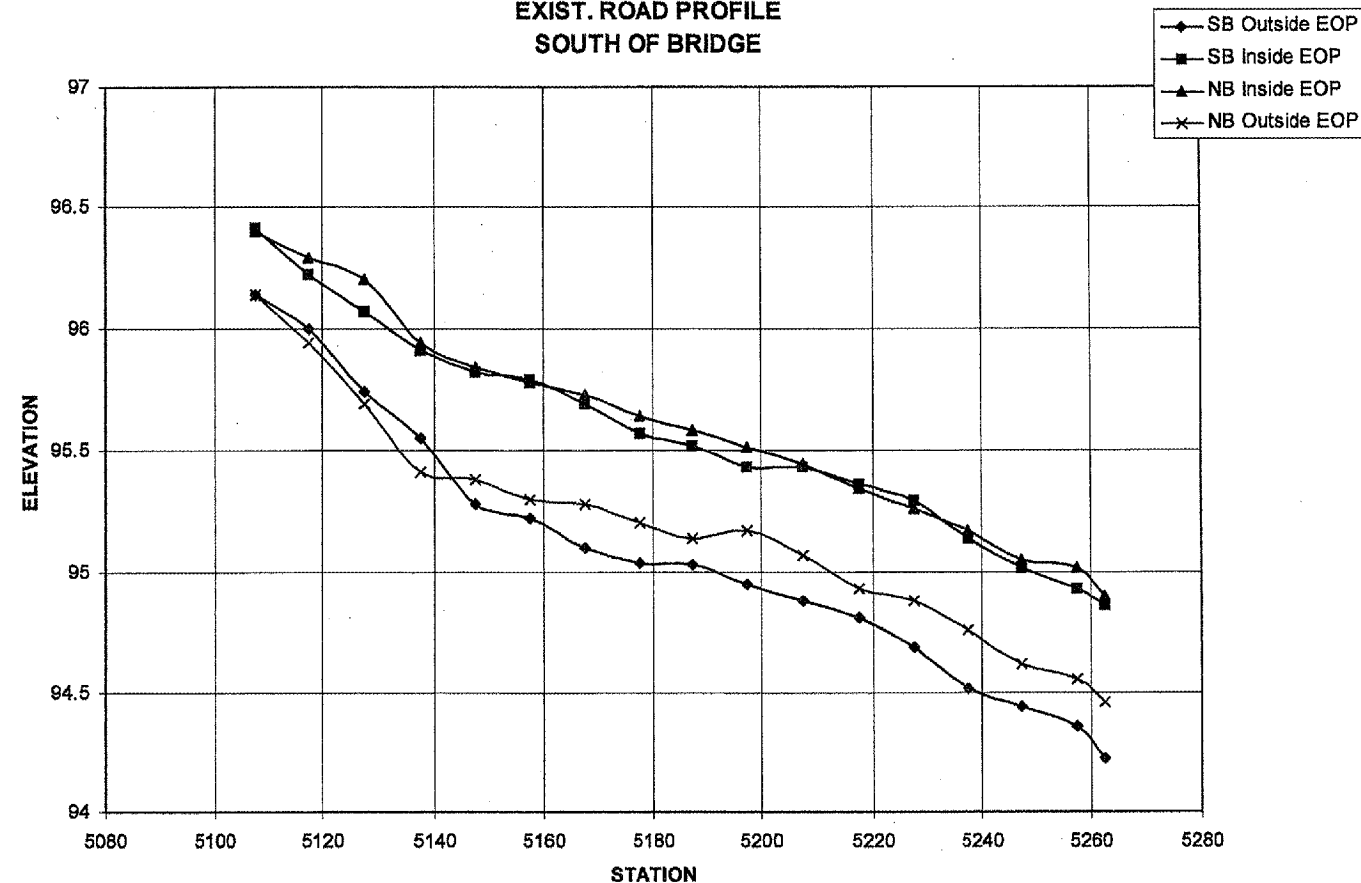

NOTE: PROPOSED PROFILE
PER ART. 406.06 A STRINGLINE SHALL BE USED AS A GUIDE. THE STRINGLINE SHALL BE SET BY THE ENGINEER USING THE BEGINNING AND ENDING ELEVATION GIVEN IN THE EXISTING PROFILE.

ILLINOIS DEPARTMENT OF
TRANSPORTATION
BARRINGTON RD
OVER I-90 (NORTHWEST TOLLWAY)
ROAD PROFILE & DETAIL

ROUTE	SECTION	COUNTY	TOTAL SHEETS	SHEET NUMBER
FAP 362	N-6-7-I-1	COOK	14	9

CONTRACT: 60B28

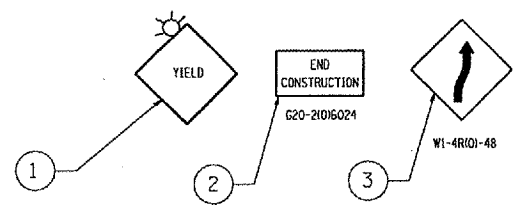
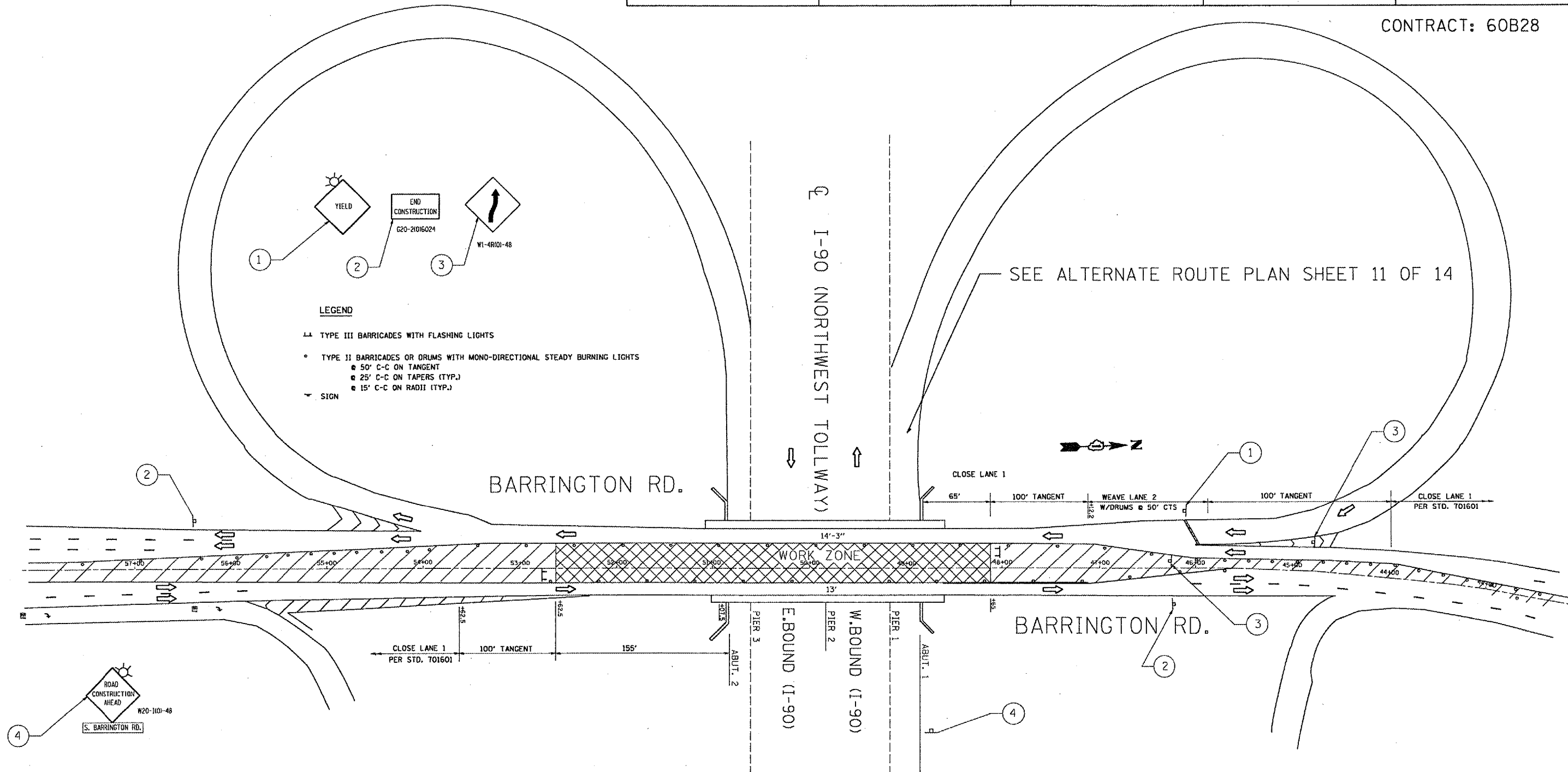

- LEGEND**
- ▬ TYPE III BARRICADES WITH FLASHING LIGHTS
 - TYPE II BARRICADES OR DRUMS WITH MONO-DIRECTIONAL STEADY BURNING LIGHTS
 - 50' C-C ON TANGENT
 - 25' C-C ON TAPERS (TYP.)
 - 15' C-C ON RADII (TYP.)
 - ▾ SIGN

COVER CONFLICTING PAVEMENT MARKING WITH BLACK TYPE III TAPE. COST OF BLACK TYPE III TAPE AND ITS REMOVAL IS INCLUDED IN THE COST OF 701601 (SPECIAL). HIGHWAY STANDARD 701601, DISTRICT STD'S AND ADDITIONAL TRAFFIC CONTROL ITEMS SHOWN ON THIS SHEET SHALL BE INCLUDED IN THE COST OF "TRAFFIC CONTROL AND PROTECTION 701601 (SPECIAL).

ILLINOIS DEPARTMENT OF
TRANSPORTATION
BARRINGTON RD
OVER I-90 (NORTHWEST TOLLWAY)
STAGE I

ROUTE	SECTION	COUNTY	TOTAL SHEETS	SHEET NUMBER
FAP 362	N-6-7-I-1	COOK	14	10

CONTRACT: 60B28

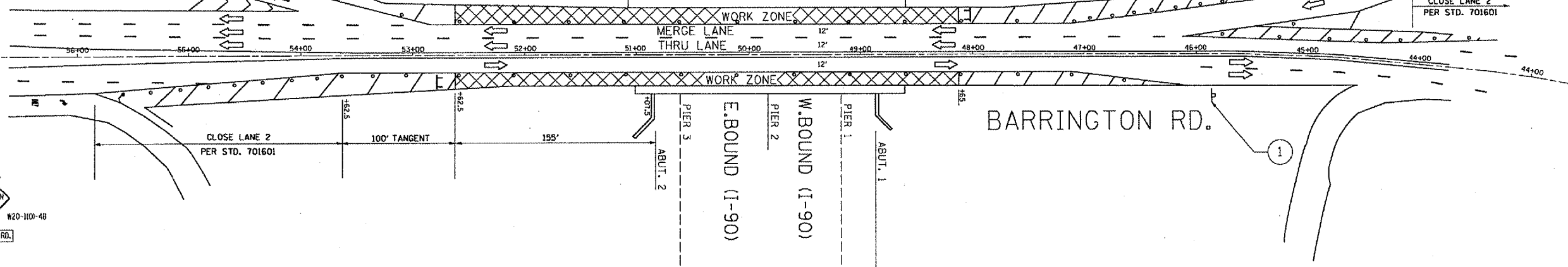
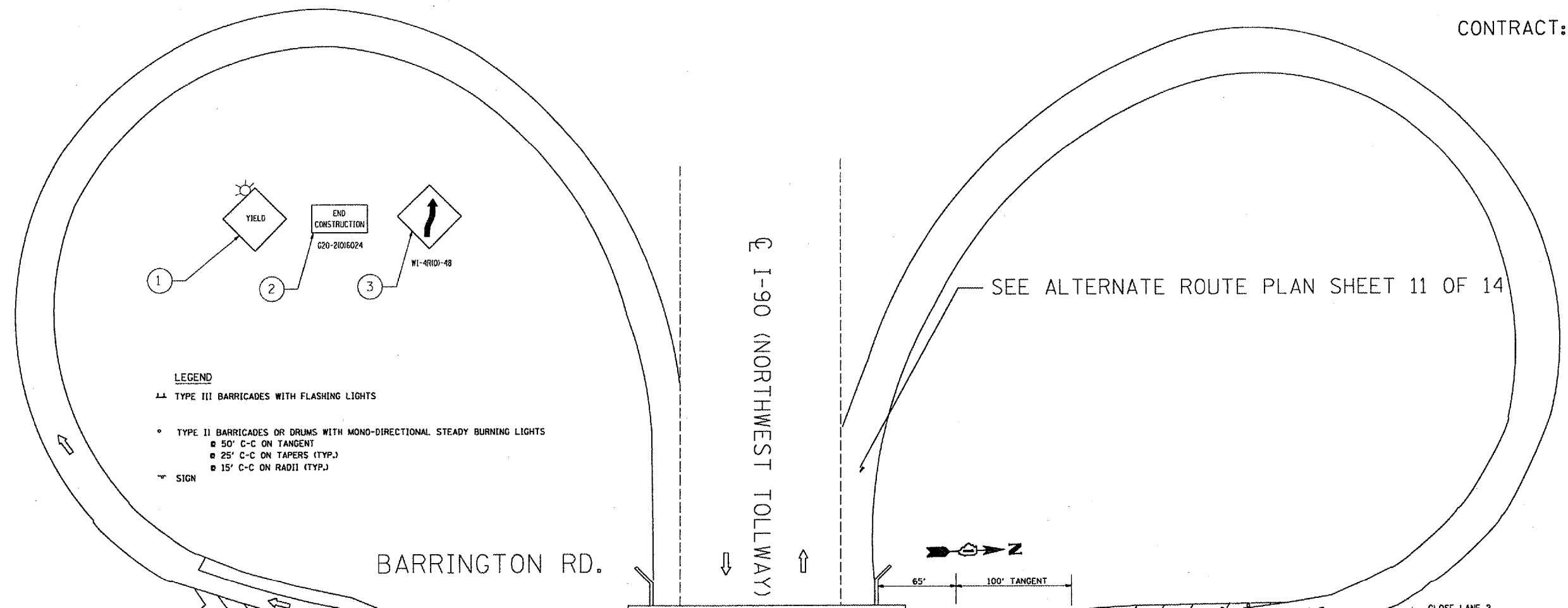

COVER CONFLICTING PAVEMENT MARKING WITH BLACK TYPE III TAPE. COST OF BLACK TYPE III TAPE AND ITS REMOVAL IS INCLUDED IN THE COST OF 701601 (SPECIAL). HIGHWAY STANDARD 701601, DISTRICT STD'S AND ADDITIONAL TRAFFIC CONTROL ITEMS SHOWN ON THIS SHEET SHALL BE INCLUDED IN THE COST OF "TRAFFIC CONTROL AND PROTECTION 701601 (SPECIAL).

ILLINOIS DEPARTMENT OF TRANSPORTATION
 BARRINGTON RD
 OVER I-90 (NORTHWEST TOLLWAY)
 STAGE II

ROUTE	SECTION	COUNTY	TOTAL SHEETS	SHEET NUMBER
FAP 362	N-6-7-I-1	COOK	14	11

CONTRACT: 60B28

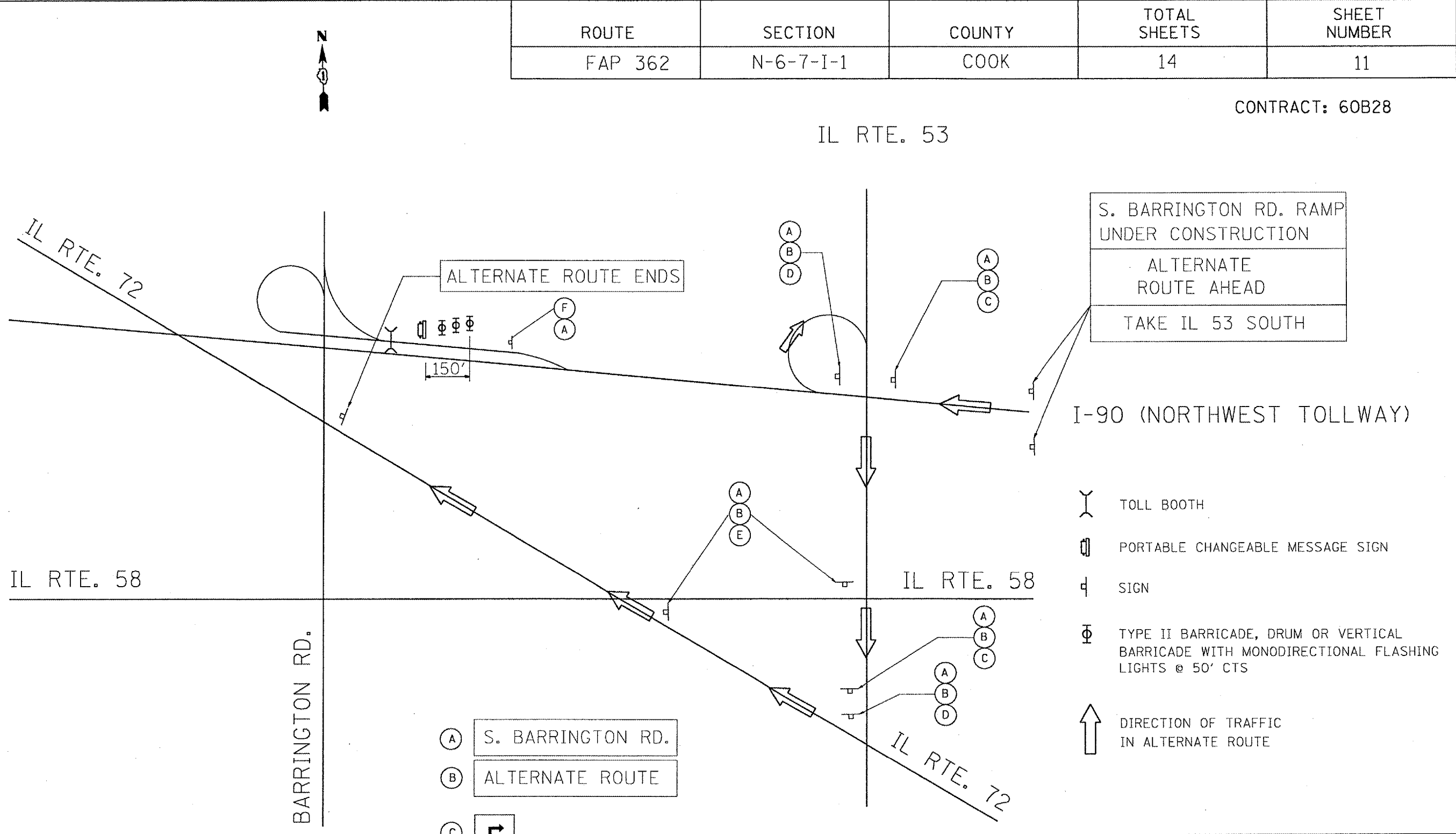

S. BARRINGTON RD. RAMP
UNDER CONSTRUCTION

ALTERNATE
ROUTE AHEAD

TAKE IL 53 SOUTH

I-90 (NORTHWEST TOLLWAY)

- TOLL BOOTH
- PORTABLE CHANGEABLE MESSAGE SIGN
- SIGN
- TYPE II BARRICADE, DRUM OR VERTICAL BARRICADE WITH MONODIRECTIONAL FLASHING LIGHTS @ 50' CTS
- DIRECTION OF TRAFFIC IN ALTERNATE ROUTE

- (A) S. BARRINGTON RD.
- (B) ALTERNATE ROUTE
- (C)
- (D)
- (E)

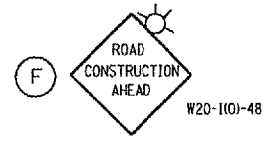

NOTE:
THE COST OF ALL TRAFFIC CONTROL ITEMS AND ALTERNATE ROUTE SIGNS SHOWN ON THIS SHEET SHALL BE INCLUDED IN THE COST OF TRAFFIC CONTROL & PROTECTION STD. 701601 (SPECIAL).

ILLINOIS DEPARTMENT OF
TRANSPORTATION

ALTERNATE ROUTE PLAN

STATE OF ILLINOIS
DEPARTMENT OF TRANSPORTATION

ROUTE NO.	SECTION	COUNTY	TOTAL SHEETS	SHEET NO.
FAP 362	N-6-7 I-1	COOK	14	11A
FED. ROAD DIST. NO. 7	ILLINOIS	FED. AID PROJECT		

Contract # 60B28

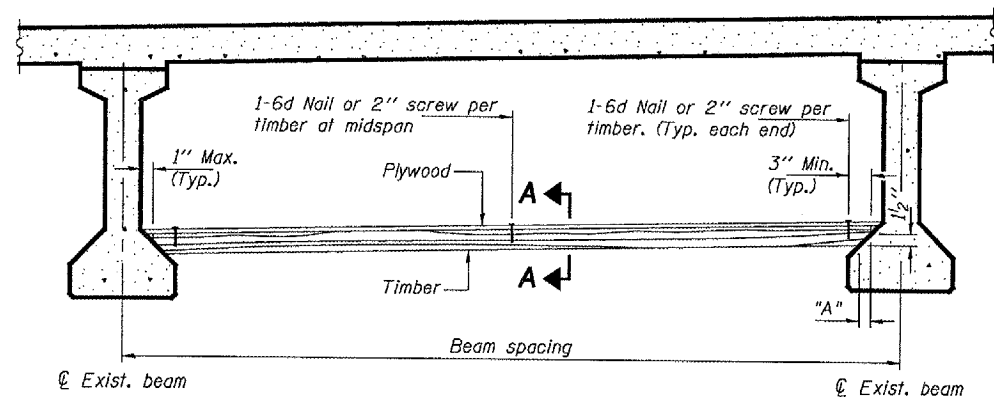

PPC I-BEAMS AND BULB-T'S

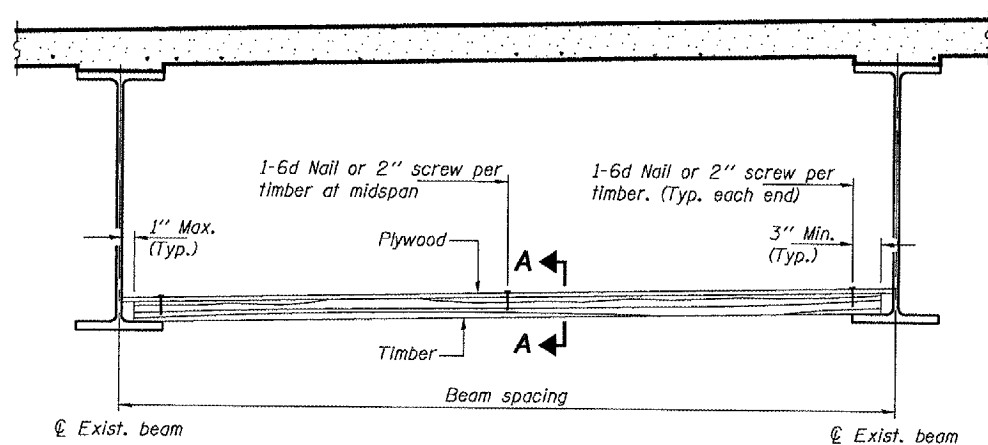

STEEL BEAMS

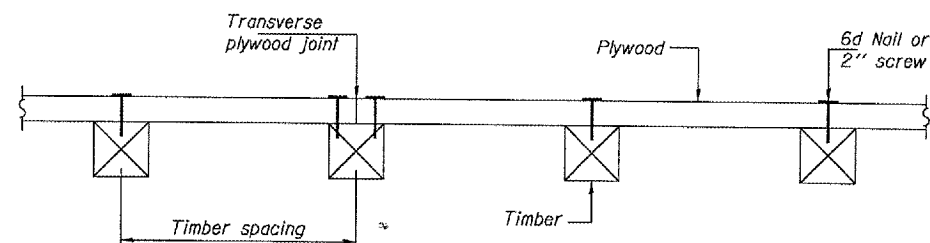

SECTION A-A

TIMBER SPACING

Beam Spacing (ft.)	Timber Sizes (in.)		
	4" x 4" with min. Fb=775 psi Fv=135 psi	4" x 6" with min. Fb=775 psi Fv=135 psi	6" x 6" with min. Fb=575 psi Fv=125 psi
	Maximum Timber Spacing (in.)		
4.5	16	16	16
4.75	16	16	16
5.0	16	16	16
5.25	16	16	16
5.5	16	16	16
5.75	16	16	16
6.0	16	16	16
6.25	12	16	16
6.5	12	16	16
6.75	12	16	16
7.0	8	16	16
7.25	8	16	16
7.5	8	16	16
7.75	8	16	16
8.0	8	12	16
8.25	8	12	16
8.5	6	12	12
8.75	6	12	12
9.0	6	8	12

PPC I-BEAMS AND BULB-T'S

BEAM	"A"
36" I-Beam	1 1/2"
42" I-Beam	1 1/2"
48" I-Beam	1 1/2"
54" I-Beam	1 5/8"
63" Bulb-T	3 3/8"
72" Bulb-T	3 3/8"

Notes: See special provision for Permanent Protective Shield System. Timber sizes shown are nominal sizes. Rough sawn timber of the dimensions shown will also be considered acceptable. The minimum Fb and Fv values shown are the tabulated design values given in the National Design Specification for Wood Construction for No. 2 Spruce-Pine-Fir without adjustment factors applied. Better grades or other species with equal or higher allowable stresses will also be considered acceptable. The timber spacings shown have been determined using allowable stresses with all adjustment factors necessary for the anticipated service conditions. All timber shall be treated. Plywood shall be 5/8" Exterior type plywood. Plywood shall be placed such that the face grain is perpendicular to the timber supports. When less than a full sheet (4' width) of plywood is used, the width of the strip used shall not be less than 2'. Transverse plywood joints shall be supported by timbers. When 4" x 6" timbers are used, they shall be placed such that the wide face is horizontal and the narrow face is vertical. Design load = 200 psf.

BILL OF MATERIAL

Item	Unit	Total
Protective Shield (Permanent)	Sq. Yd.	1458

ILLINOIS DEPARTMENT OF TRANSPORTATION
PERMANENT PROTECTIVE SHIELD
BARRINGTON RD
OVER I-90 (NORTHWEST TOLLWAY)
016-0522

F.A.P. RTE.	SECTION	COUNTY	TOTAL SHEETS	SHEET NO.
362	N-6-7-1-1	COOK	14	12
STA.		TO STA.		
FED. ROAD DIST. NO. 1		ILLINOIS FED. AID PROJECT		

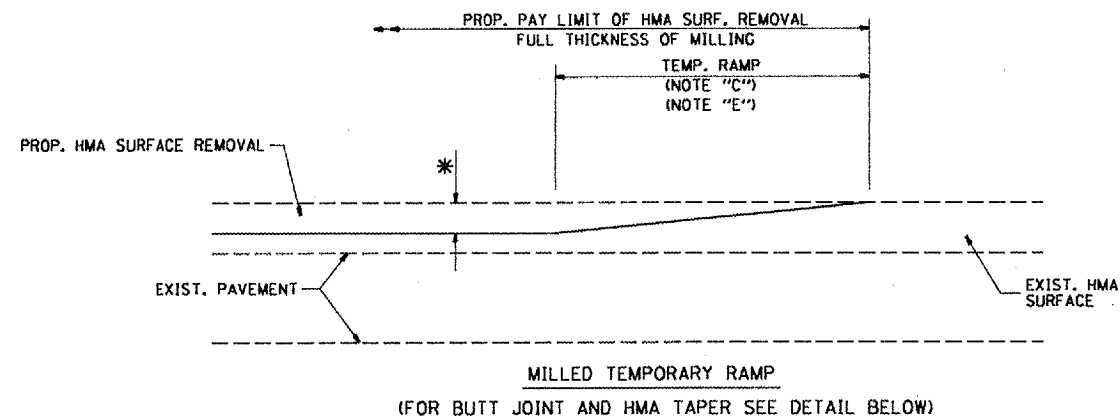

OPTION 1

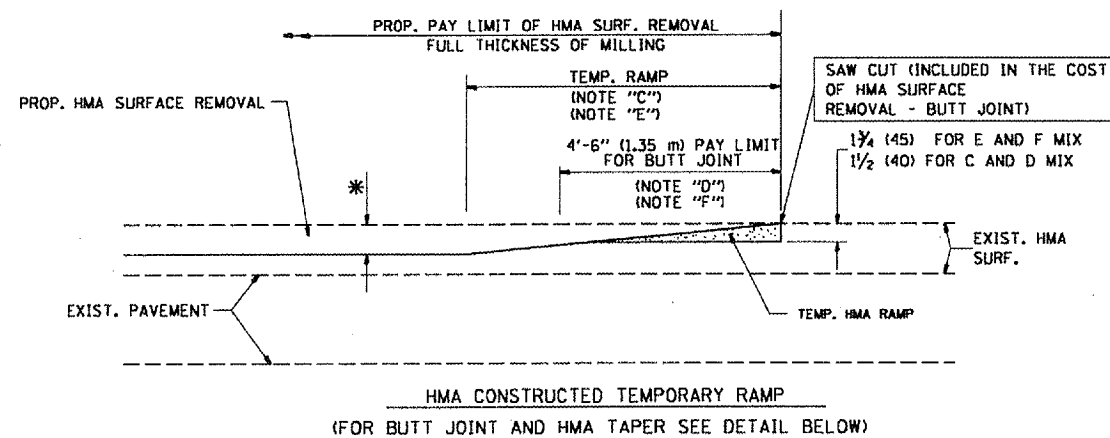

OPTION 2
TYPICAL TEMPORARY RAMP

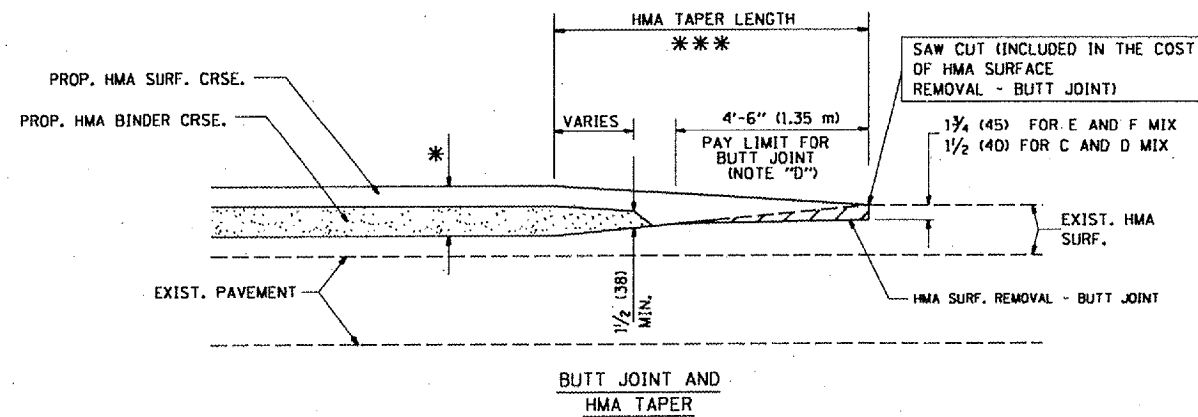

TYPICAL BUTT JOINT AND HMA TAPER
FOR MILLING AND RESURFACING

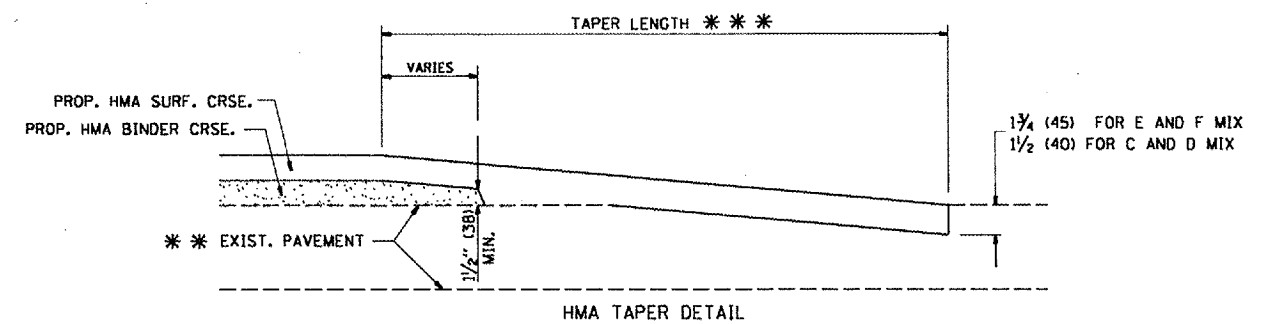
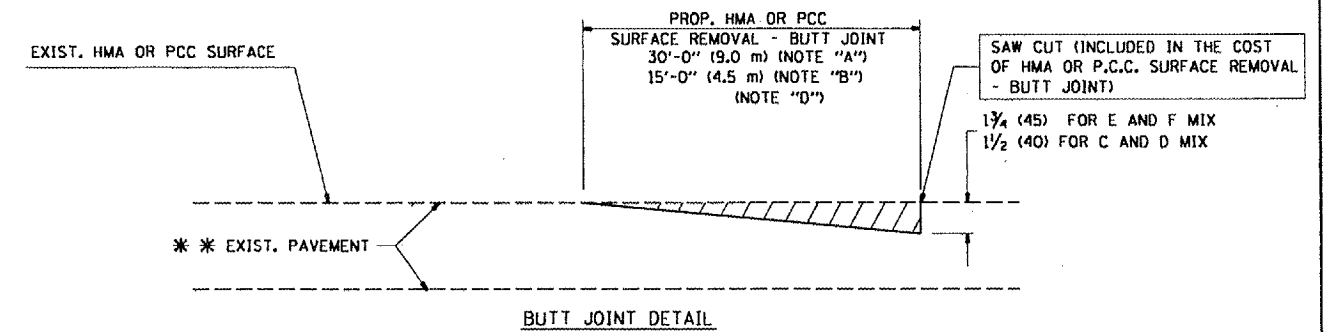

TYPICAL BUTT JOINT AND HMA TAPER
FOR RESURFACING ONLY

*** PC CONCRETE, HMA OR HMA RESURFACED PAVEMENT.

NOTES

- A: MAINLINE ROADWAYS AND MAJOR SIDE ROADS.
 - B: MINOR SIDE ROADS.
 - C: THE TEMP. RAMP SHALL BE CONSTRUCTED IMMEDIATELY UPON REMOVAL OF THE EXISTING HMA SURFACE.
 - D: THE BUTT JOINT SHALL BE CONSTRUCTED IMMEDIATELY PRIOR TO PLACING THE PROPOSED HMA COURSES.
 - E: TAPER THE TEMP. RAMP AT A RATE OF 3'-0" (900 mm) PER 1 INCH (25 mm) OF MILLING THICKNESS.
 - F: INSTALLATION AND REMOVAL OF THE 4'-6" (1.35 m) TEMP. RAMP IS INCLUDED IN COST OF HMA SURFACE REMOVAL - BUTT JOINT
 - G: SEE ARTICLE 406.08 AND 406.14 OF THE STANDARD SPECIFICATIONS FOR "HMA AND/OR PCC SURFACE REMOVAL, BUTT JOINT".
- * SEE TYPICAL SECTIONS FOR MILLING THICKNESS.
- *** 20'-0" (6.1 m) PER 1 (25) RESURFACING (NOTE "A")
10'-0" (3.0 m) PER 1 (25) RESURFACING (NOTE "B")

ALL DIMENSIONS ARE IN INCHES (MILLIMETERS) UNLESS OTHERWISE SHOWN.

BASIS OF PAYMENT:

THE BUTT JOINT WILL BE PAID FOR AT THE CONTRACT UNIT PRICE PER SQUARE YARD (SQUARE METER) FOR "HOT-MIX ASPHALT SURFACE REMOVAL - BUTT JOINT" OR FOR "PORTLAND CEMENT CONCRETE SURFACE REMOVAL - BUTT JOINT".

REVISIONS	
NAME	DATE
M. DE YONG	6-13-90
M. DE YONG	7-3-90
M. DE YONG	3-27-92
R. SHAH	09/09/94
R. SHAH	10/25/94
A. ABBAS	03/21/97
M. GOMEZ	04/06/01
R. BORD	01/01/07

ILLINOIS DEPARTMENT OF TRANSPORTATION

BUTT JOINT AND HMA TAPER DETAILS

SCALE: VERT. NONE
HORIZ.

DRAWN BY
CHECKED BY

CONTRACT NO.				
F.A. RTE.	SECTION	COUNTY	TOTAL SHEETS	SHEET NO.
362	N-6-7-I-1	COOK	14	13A
STA.		TO STA.		
FED. ROAD DIST. NO. 1		ILLINOIS		FED. AID PROJECT

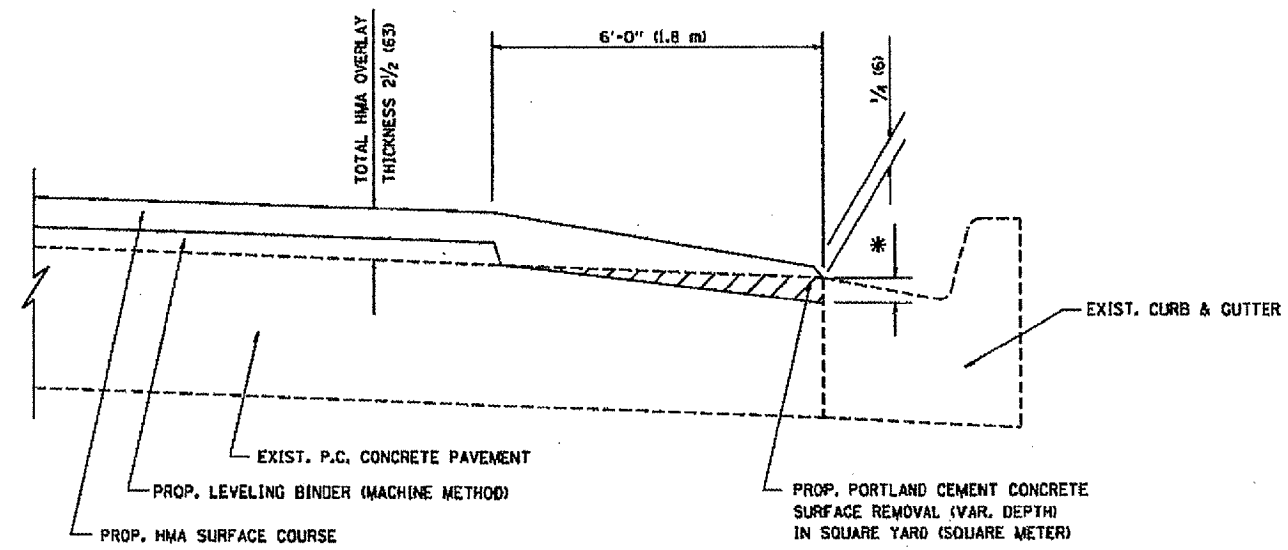

HMA TAPER AT
EDGE OF P.C.C. PAVEMENT

HMA SURFACE		LEVELING BINDER		* MILLING AT GUTTER FLAG
MIX	THICKNESS	THICKNESS		
C OR D	1/2 (38)	1 (25)	1/4 (19)	1/4 (19)
F	1/4 (19)	3/4 (19)	1/2 (38)	1/2 (38)

ALL DIMENSIONS ARE IN INCHES (MILLIMETERS) UNLESS OTHERWISE SHOWN.

REVISIONS	
NAME	DATE
R. SHAH	09/10/94
R. SHAH	10/25/94
A. ABBAS	05/05/99
E. GOMEZ	12/21/00
R. BORO	01/01/07

ILLINOIS DEPARTMENT OF TRANSPORTATION

HMA TAPER AT
EDGE OF P.C.C. PAVEMENT

SCALE: VERT. NONE
HORIZ. NONE

DRAWN BY jls
CHECKED BY A. ABBAS

PLT DATE: 03/08/07
PLT SCALE: 1/8" = 1'-0"
USER NAME: jls

F.A.P. RTE.	SECTION	COUNTY	TOTAL SHEETS	SHEET NO.
362	N-6-T-1-1	COOK	14	13
STA.		TO STA.		
FED. ROAD DIST. NO.		ILLINOIS FED. AID PROJECT		

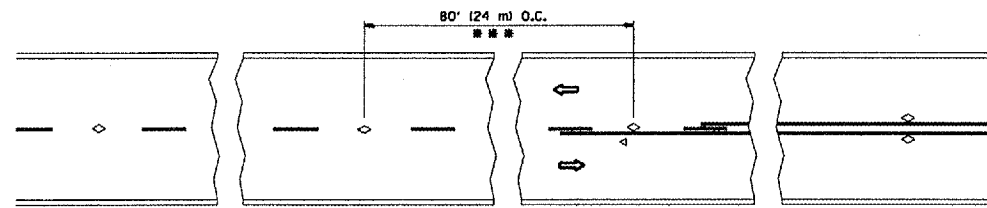

*** REDUCE TO 40' (12 m) O.C. ON CURVES WITH POSTED OR ADVISORY SPEED 45 M.P.H. (70 km/h) OR LESS.

TWO-LANE/TWO-WAY

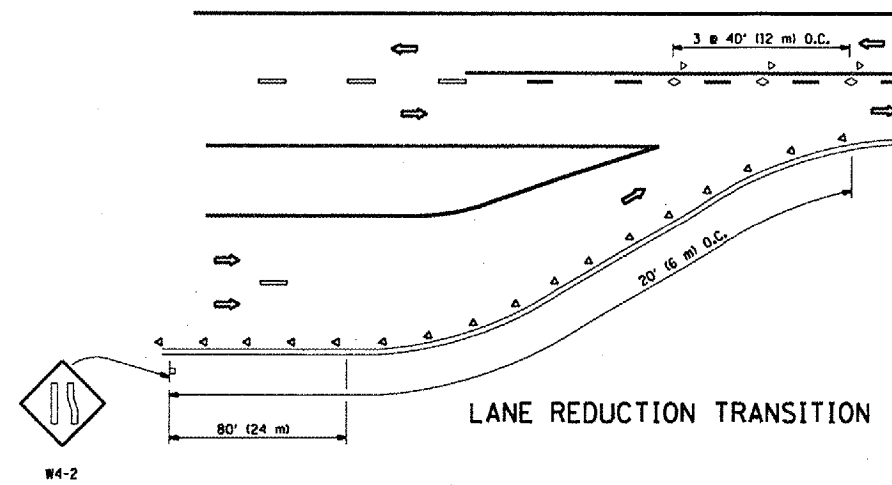

LANE REDUCTION TRANSITION

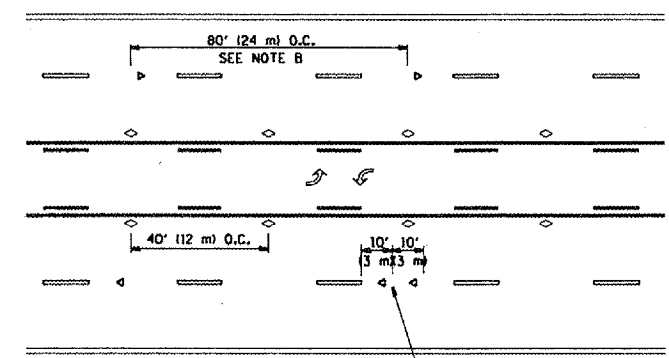

TWO-WAY LEFT TURN

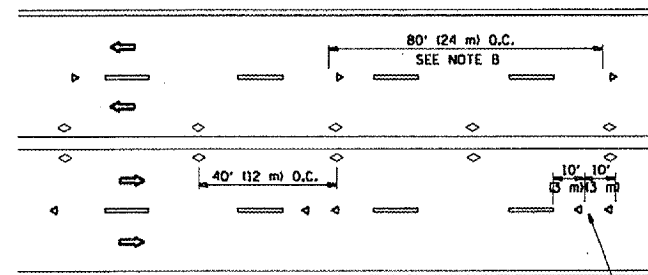

MULTI-LANE/UNDIVIDED

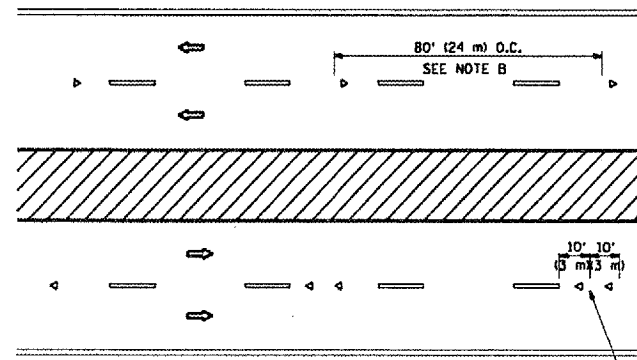

MULTI-LANE/DIVIDED

GENERAL NOTES

1. MARKERS USED WITH DASHED LINES SHALL BE CENTERED IN THE GAP BETWEEN SEGMENTS.
2. MARKERS USED ADJACENT TO SOLID LINES SHALL BE OFFSET 2 TO 3 (50 TO 75) TOWARD TRAFFIC AS SHOWN.
3. MARKERS THROUGH TANGENTS LESS THAN 500' (150 m) IN LENGTH BETWEEN CURVES SHALL BE INSTALLED AT THE LESSER OF THE TWO CURVE SPACINGS.

SYMBOLS

- YELLOW STRIPE
- WHITE STRIPE
- ◁ ONE-WAY AMBER MARKER
- ◁ ONE-WAY CRYSTAL MARKER (W/O)
- ◊ TWO-WAY AMBER MARKER

LANE MARKER NOTES

- B. REDUCE TO 40' (12 m) O.C. ON CURVES WHERE ADVISORY SPEEDS ARE 10 M.P.H (16 km/h) LOWER THAN POSTED SPEEDS.
- A. USE DOUBLE LANE LINE MARKERS SPACED AS SHOWN.

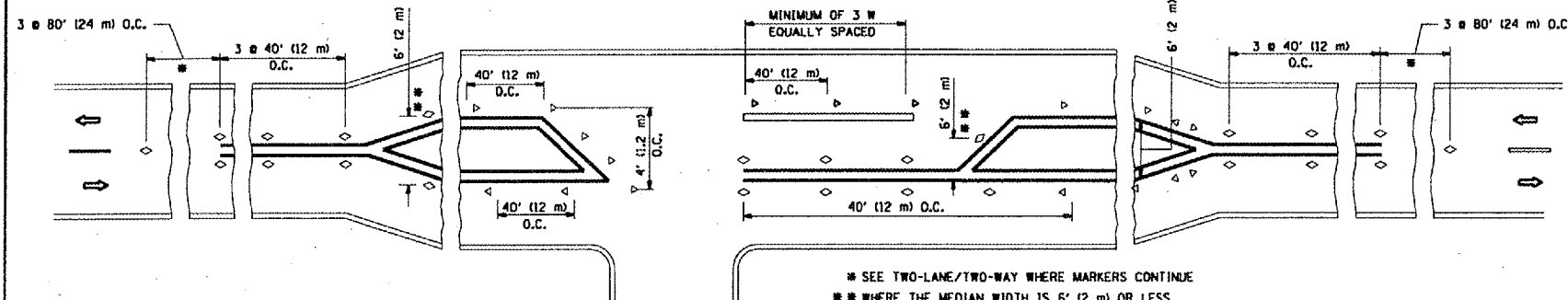

LEFT TURN

* SEE TWO-LANE/TWO-WAY WHERE MARKERS CONTINUE
 ** WHERE THE MEDIAN WIDTH IS 6' (2 m) OR LESS USE TWO-WAY MARKERS.

All dimensions are in inches (millimeters) unless otherwise shown.

REVISIONS	
NAME	DATE
T. RAMMACHER	09-19-94
T. RAMMACHER	03-12-98
T. RAMMACHER	01-06-00

ILLINOIS DEPARTMENT OF TRANSPORTATION
 TYPICAL APPLICATIONS
 RAISED REFLECTIVE PAVEMENT
 MARKERS (SNOW-PLOW RESISTANT)

SCALE: NONE

DRAWN BY CADD
 CHECKED BY
 TC-11

F.A. RTE.	SECTION	COUNTY	TOTAL SHEETS	SHEET NO.
362	N-6-7-1-1	COOK	14	14
STA.	TO STA.			
FED. ROAD DIST. NO.	ILLINOIS FED. AID PROJECT			

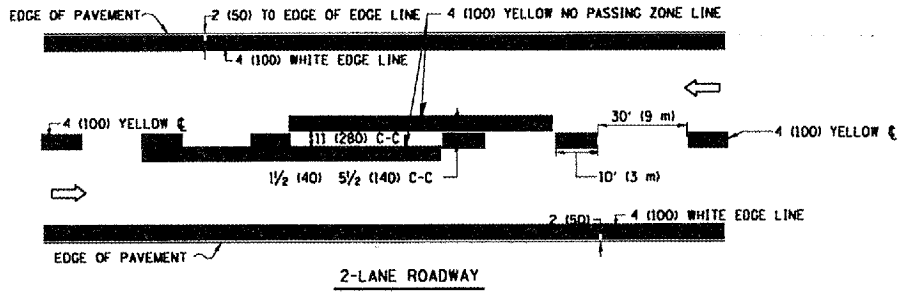

2-LANE ROADWAY

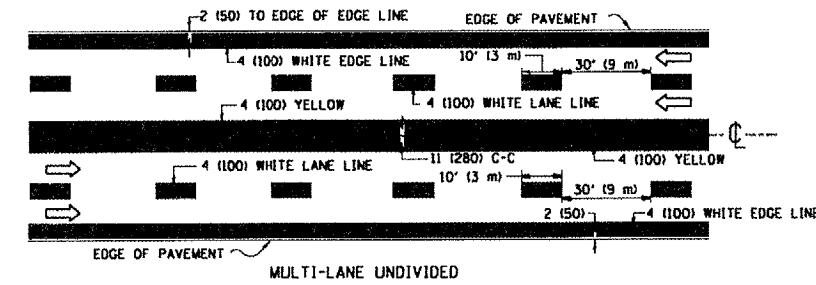

MULTI-LANE UNDIVIDED

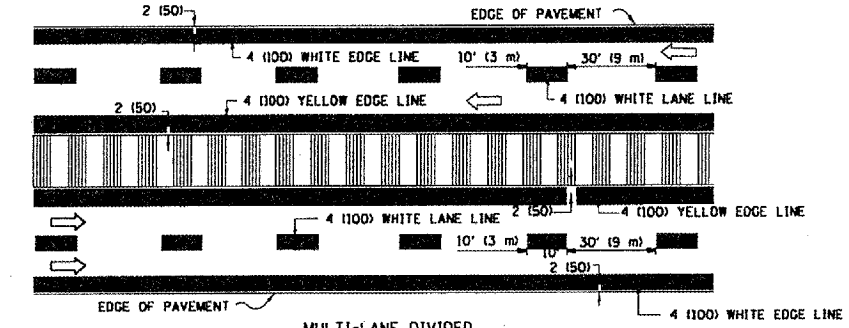

MULTI-LANE DIVIDED WITH MOUNTABLE MEDIAN

NOTE: MEDIANS WITH BARRIER CURB DO NOT REQUIRE AN EDGE LINE

TYPICAL LANE AND EDGE LINE MARKING

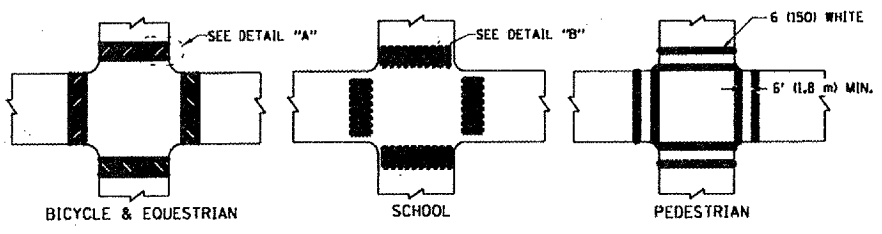

TYPICAL CROSSWALK MARKING

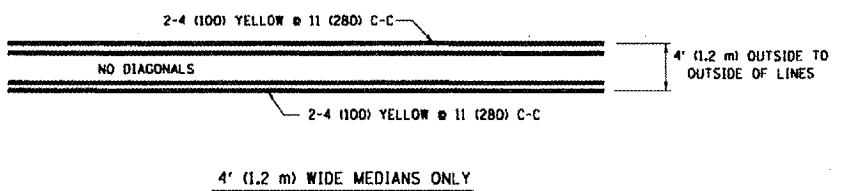

4' (1.2 m) WIDE MEDIANS ONLY

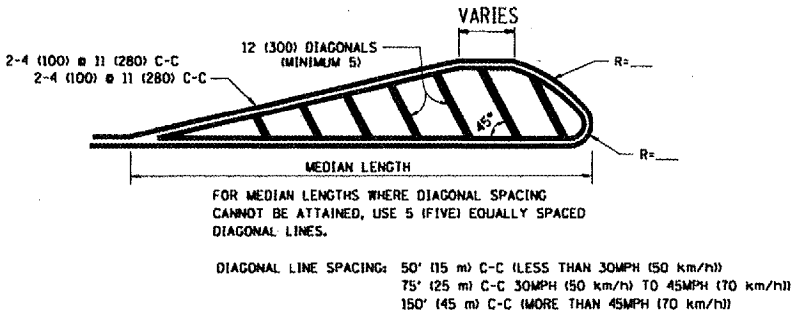

MEDIANS OVER 4' (1.2 m) WIDE

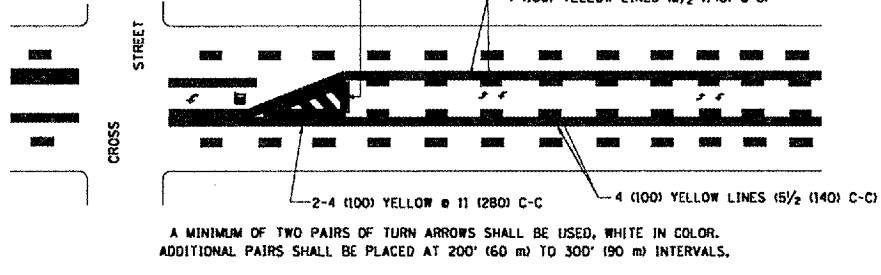

TYPICAL PAINTED MEDIAN MARKING

MEDIAN WITH TWO-WAY LEFT TURN LANE

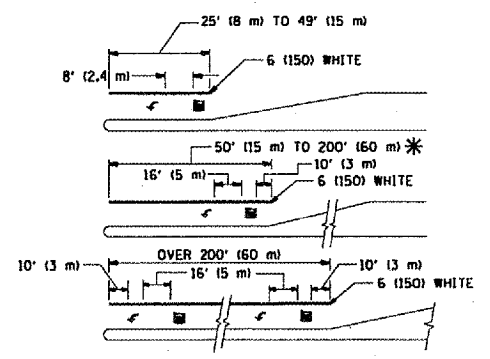

TYPICAL LEFT (OR RIGHT) TURN LANE

TYPICAL TURN LANE MARKING

FULL SIZE LETTERS 8" (2.4 m) AND ARROWS SHALL BE USED. AREA = 15.6 SQ. FT. (1.5 m²) ONLY AREA = 20.8 SQ. FT. (1.9 m²)
 * TURN LANES IN EXCESS OF 400' (120 m) IN LENGTH MAY HAVE AN ADDITIONAL SET OF ARROW - "ONLY" INSTALLED MIDWAY BETWEEN THE OTHER TWO SETS OF ARROW - "ONLY".

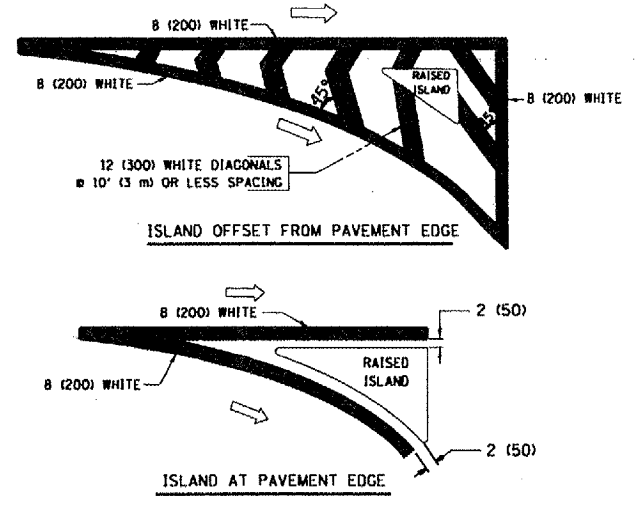

TYPICAL ISLAND MARKING

TYPE OF MARKING	WIDTH OF LINE	PATTERN	COLOR	SPACING / REMARKS
CENTERLINE ON 2 LANE PAVEMENT	4 (100)	SKIP-DASH	YELLOW	10' (3 m) LINE WITH 30' (9 m) SPACE
CENTERLINE ON MULTI-LANE UNDIVIDED PAVEMENT	2 @ 4 (100)	SOLID	YELLOW	11 (280) C-C
NO PASSING ZONE LINES FOR ONE DIRECTION FOR BOTH DIRECTIONS	4 (100) 2 @ 4 (100)	SOLID SOLID	YELLOW YELLOW	5/2 (140) C-C FROM SKIP-DASH CENTERLINE 11 (280) C-C OMIT SKIP-DASH CENTERLINE BETWEEN
LANE LINES	4 (100) 5 (125) ON FREEWAYS	SKIP-DASH SKIP-DASH	WHITE WHITE	10' (3 m) LINE WITH 30' (9 m) SPACE
DOTTED LINES (EXTENSIONS OF CENTER, LANE OR TURN LANE MARKINGS)	SAME AS LINE BEING EXTENDED	SKIP-DASH	SAME AS LINE BEING EXTENDED	2' (600) LINE WITH 6' (1.8 m) SPACE
EDGE LINES	4 (100)	SOLID	YELLOW-LEFT WHITE-RIGHT	OUTLINE MOUNTABLE MEDIANS IN YELLOW; EDGE LINES ARE NOT USED NEXT TO BARRIER CURB
TURN LANE MARKINGS	6 (150) LINE; FULL SIZE LETTERS & SYMBOLS 18" (2.4m)	SOLID	WHITE	SEE TYPICAL TURN LANE MARKING DETAIL
TWO WAY LEFT TURN MARKING	2 @ 4 (100) EACH DIRECTION 8' (2.4m) LEFT ARROW	SKIP-DASH AND SOLID IN PAIRS	YELLOW WHITE	10' (3 m) LINE WITH 30' (9 m) SPACE FOR SKIP-DASH 5/2 (140) C-C BETWEEN SOLID LINE AND SKIP-DASH LINE SEE TYPICAL TWO-WAY LEFT TURN MARKING DETAIL
CROSSWALK LINES (PEDESTRIAN A. DIAGONALS (BIKE & EQUESTRIAN) B. LONGITUDINAL BARS (SCHOOL))	2 @ 6 (150) 12 (300) @ 45° 12 (300) @ 90°	SOLID SOLID SOLID	WHITE WHITE WHITE	NOT LESS THAN 6' (1.8 m) APART 2' (600) APART SEE TYPICAL CROSSWALK MARKING DETAILS.
STOP LINES	24 (600)	SOLID	WHITE	PLACE 4' (1.2 m) IN ADVANCE OF AND PARALLEL TO CROSSWALK, IF PRESENT. OTHERWISE, PLACE AT DESIRED STOPPING POINT, PARALLEL TO CROSSROAD CENTERLINE, WHERE POSSIBLE
PAINTED MEDIANS	2 @ 4 (100) WITH 12 (300) DIAGONALS @ 45° NO DIAGONALS USED FOR 4' (1.2 m) WIDE MEDIANS	SOLID	YELLOW; TWO WAY TRAFFIC WHITE; ONE WAY TRAFFIC	11 (280) C-C FOR THE DOUBLE LINE SEE TYPICAL PAINTED MEDIAN MARKING.
GORE MARKING AND CHANNELIZING LINES	8 (200) WITH 12 (300) DIAGONALS @ 45°	SOLID	WHITE	DIAGONALS: 15' (4.5 m) C-C (LESS THAN 30MPH (50 km/h)) 20' (6 m) C-C 30MPH (50 km/h) TO 45MPH (70 km/h) 30' (9 m) C-C (OVER 45MPH (70 km/h))
RAILROAD CROSSING	24 (600) TRANSVERSE LINES; "RR" 15 6' (1.8 m) LETTERS; 16 (400) LINE FOR "X"	SOLID	WHITE	SEE STATE STANDARD 780001 AREA OF: "R"=3.6 SQ. FT. (0.33 m ²) EACH "X"=54.0 SQ. FT. (5.0 m ²)
SHOULDER DIAGONALS	12 (300) @ 45°	SOLID	WHITE - RIGHT YELLOW - LEFT	50' (15 m) C-C (LESS THAN 30MPH (50 km/h)) 75' (25 m) C-C (30 MPH (50 km/h) TO 45MPH (70 km/h)) 150' (45 m) C-C (OVER 45MPH (70 km/h))

FOR FURTHER DETAILS ON PAVEMENT MARKING REFER TO STANDARD SPECIFICATIONS FOR ROAD AND BRIDGE CONSTRUCTION AND STATE STANDARD 780001.

All dimensions are in inches (millimeters) unless otherwise shown.

REVISIONS	
NAME	DATE
EVERS	03-19-90
T. RAMMACHER	10-27-94
ALEX HOUSEH	10-09-96
ALEX HOUSEH	10-17-96
T. RAMMACHER	01-06-00

ILLINOIS DEPARTMENT OF TRANSPORTATION
 DISTRICT ONE
 TYPICAL PAVEMENT MARKINGS

SCALE: NONE
 DRAWN BY CAD
 CHECKED BY
 TC-13

PLT DATE: 4/27/98
 FILE NAME: P:\AV\AV131.dgn
 PLOT SCALE: 1/8"=1'-0"
 USER NAME: jshelton