

F.A.I. RTE.	SECTION	COUNTY	TOTAL SHEETS	SHEET NO.
55	99 (I&2) WRS-2	WILL	228	45
STA. TO STA.		ILLINOIS FED. AID PROJECT		

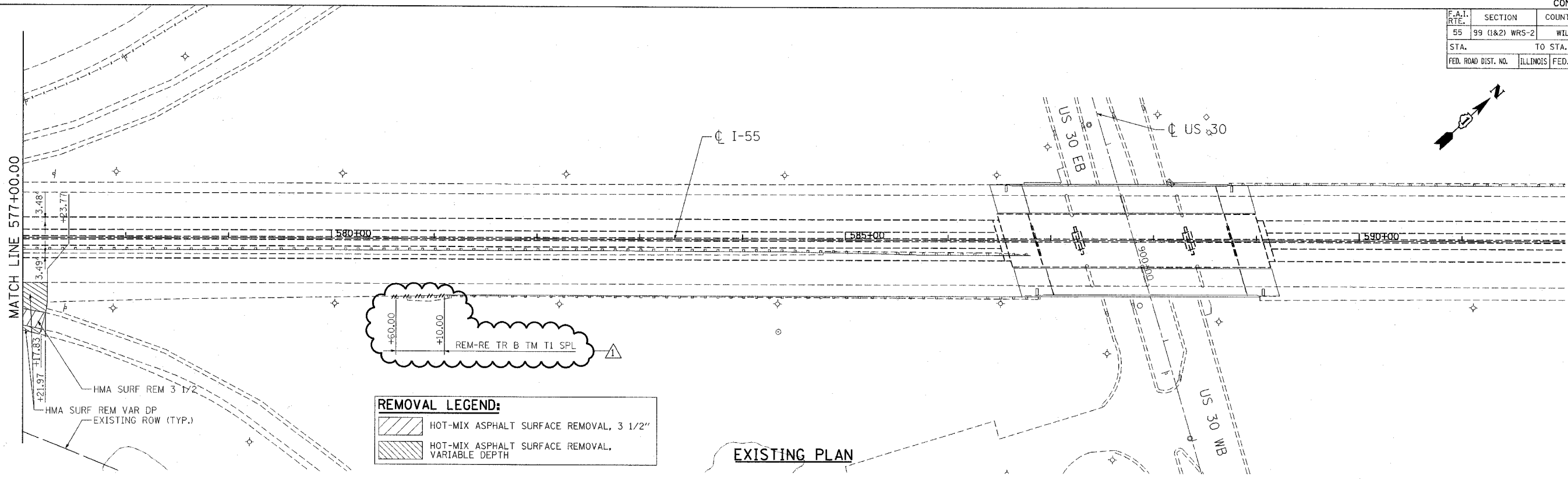

**REMOVAL LEGEND:**

- HOT-MIX ASPHALT SURFACE REMOVAL, 3 1/2"
- HOT-MIX ASPHALT SURFACE REMOVAL, VARIABLE DEPTH

**EXISTING PLAN**

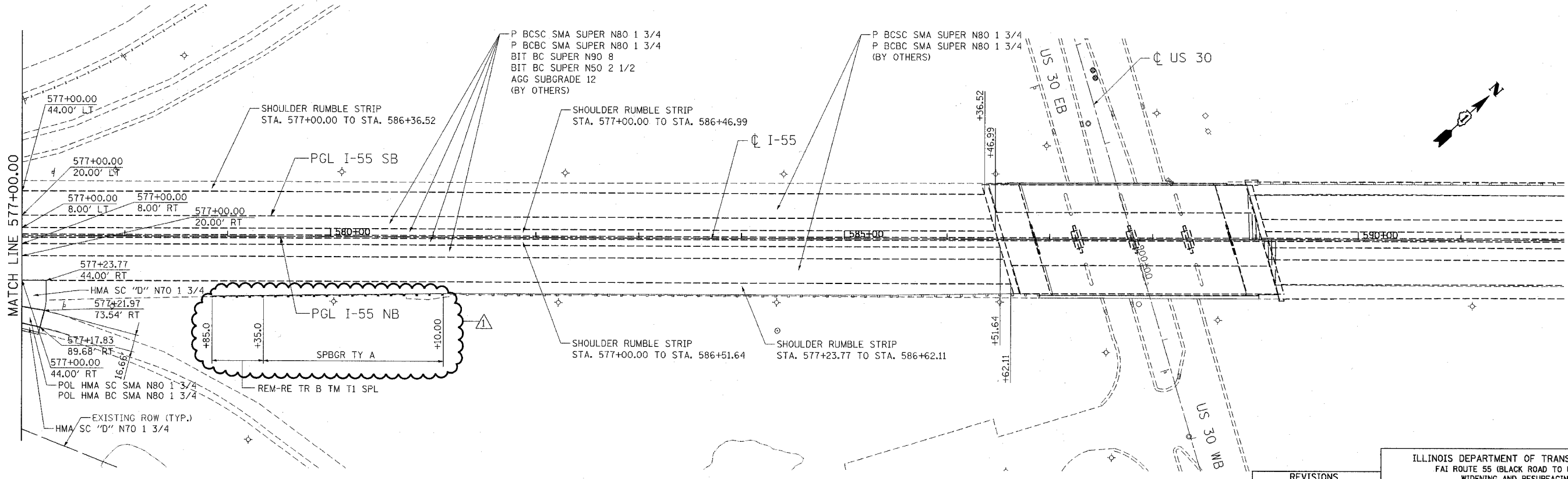

**PROPOSED PLAN**

REVISIONS	
NAME	DATE
DDH	5/22/07

ILLINOIS DEPARTMENT OF TRANSPORTATION  
 FAI ROUTE 55 (BLACK ROAD TO U.S. 30)  
 WIDENING AND RESURFACING

**ROADWAY PLAN**  
**FAI 55**  
**STA. 577+00.00 TO STA. 592+00.00**

SCALE: 1"=50'  
 DATE: 05/22/07

DRAWN BY: AG  
 CHECKED BY: DDH

**TENG**  
 TENG & ASSOCIATES, INC.  
 ENGINEERS/ARCHITECTS/PLANNERS  
 CHICAGO, ILLINOIS

PLOT DATE = #DATE#  
 FILE NAME = #FILE#  
 USER NAME = #USER#

\\s:\proj\1001\1001.dwg  
 5-24-2007 12:26:55