

F.A.I. RTE.	SECTION	COUNTY	TOTAL SHEETS	SHEET NO.
55	99 (1&2) WRS-2	WILL	228	44
STA.	TO STA.			
FED. ROAD DIST. NO.	ILLINOIS	FED. AID PROJECT		

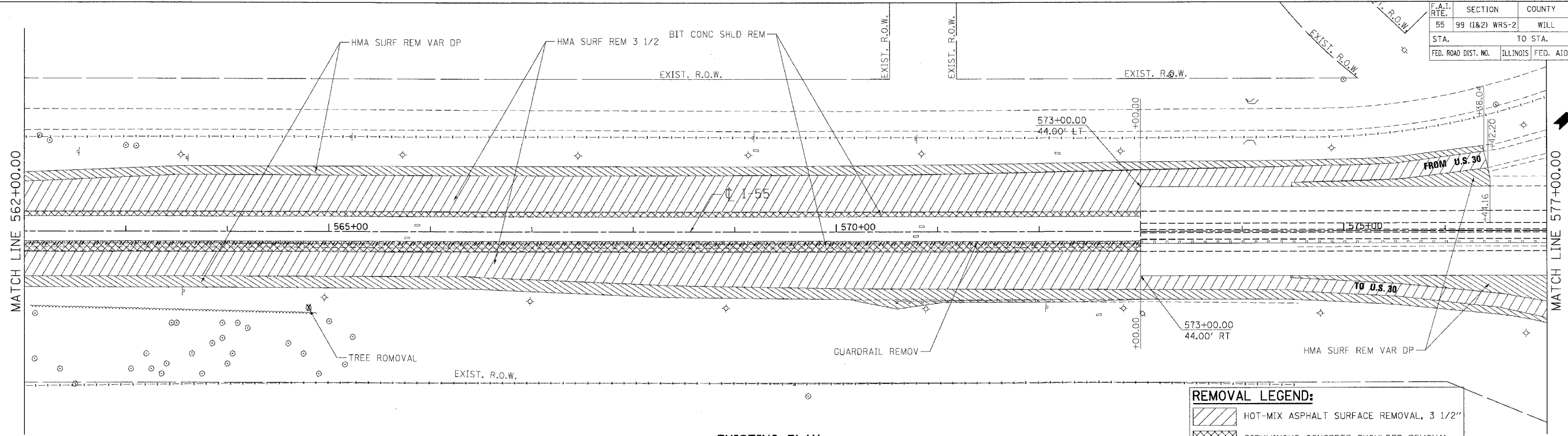

EXISTING PLAN

REMOVAL LEGEND:

	HOT-MIX ASPHALT SURFACE REMOVAL, 3 1/2"
	BITUMINOUS CONCRETE SHOULDER REMOVAL
	HOT-MIX ASPHALT SURFACE REMOVAL, VARIABLE DEPTH

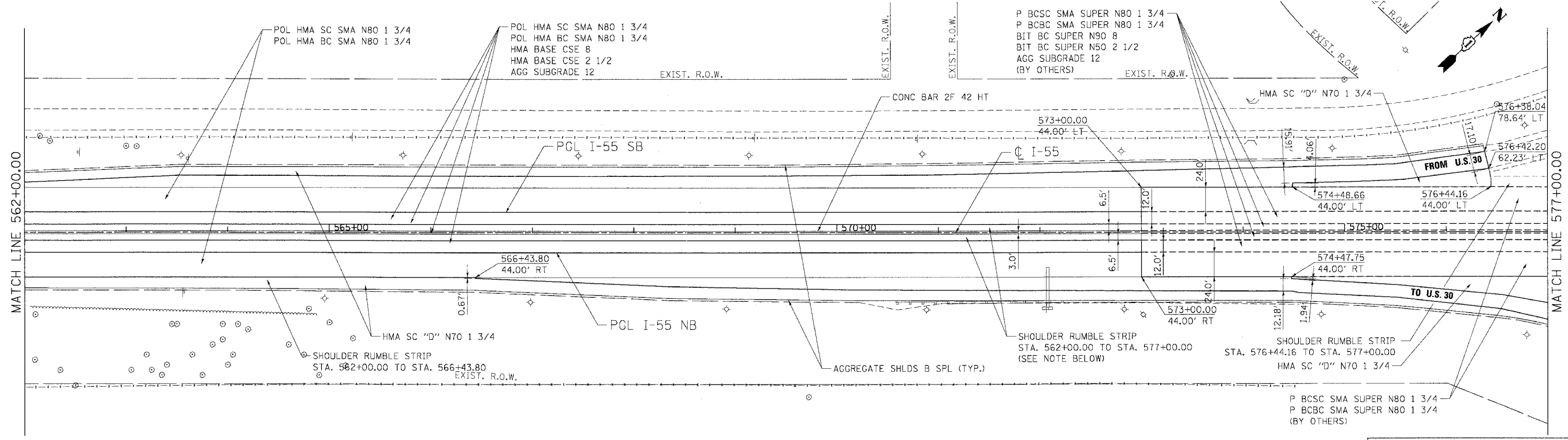

PROPOSED PLAN

NOTE:
SHOULDER RUMBLE STRIPS TO BE EXTENDED TO THE BRIDGE APPROACH PAVEMENT AT US30.

REVISIONS	
NAME	DATE

ILLINOIS DEPARTMENT OF TRANSPORTATION
FAI ROUTE 55 (BLACK ROAD TO U.S. 30)
WIDENING AND RESURFACING

ROADWAY PLAN
FAI 55
STA. 562+00.00 TO STA. 577+00.00

SCALE: 1"=50'
DATE: 02/23/07

DRAWN BY AG
CHECKED BY DDH

TENG
TENG & ASSOCIATES, INC.
ENGINEERS/ARCHITECTS/PLANNERS
CHICAGO, ILLINOIS

PLOT DATE = 02/23/07
FILE NAME = 022307.DWG
USER NAME = DDH