

F.A.I. RTE.	SECTION	COUNTY	TOTAL SHEETS	SHEET NO.
55	99 (I&2) WRS-2	WILL	228	122
STA.	TO STA.			
FED. ROAD DIST. NO.	ILLINOIS	FED. AID PROJECT		

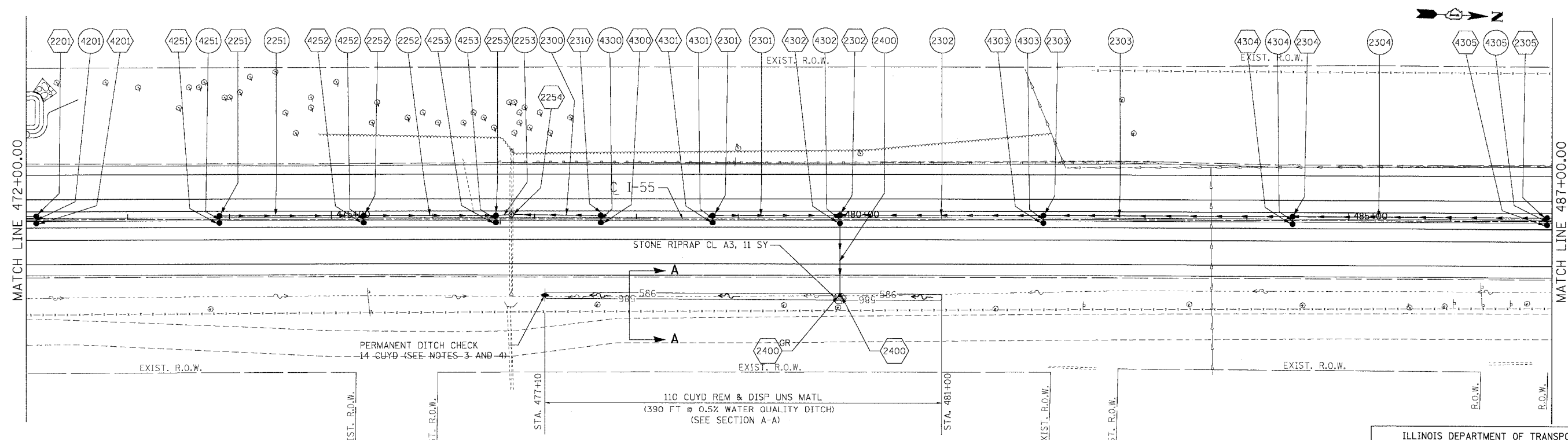

EXISTING PLAN

PROPOSED PLAN

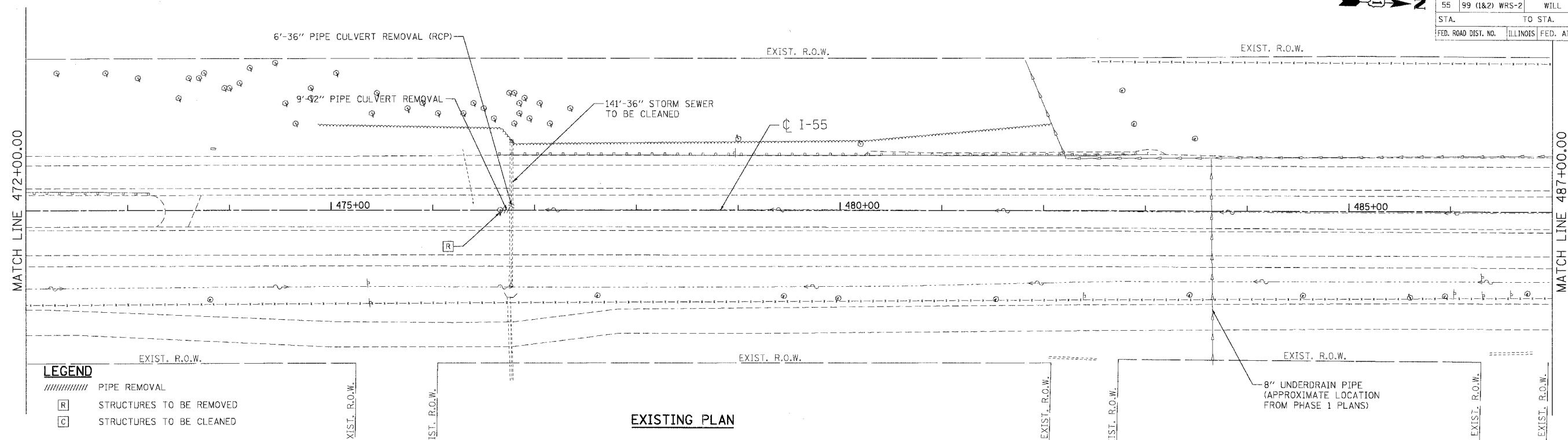
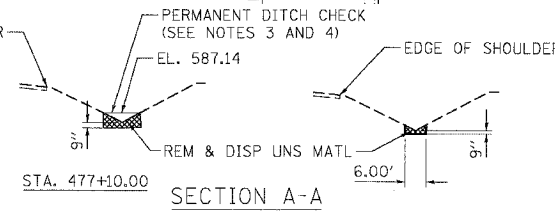

SECTION A-A

NOTES

1. FOR STRUCTURE AND PIPE INFORMATION SEE DRAINAGE SCHEDULES, SHEETS 129, 130, 131, 132, AND 133.
2. PROPOSED SEWER AND CULVERT CROSSING BENEATH THE EXISTING PAVEMENT SHALL BE CONSTRUCTED DURING PRE-STAGE PER THE STAGING AND TRAFFIC CONTROL PLANS. SEE ROADWAY PLANS FOR PATCHING DETAILS.
3. THE COST OF PERMANENT DITCH CHECK WILL NOT BE PAID FOR SEPARATELY, BUT SHALL BE INCLUDED IN THE CONTRACT UNIT PRICE PER CU YD FOR EARTH EXCAVATION.
4. THE CONSTRUCTION WILL FOLLOW THE "EMBANKMENT" REQUIREMENTS, AS SPECIFIED IN SECTION 205 OF THE STANDARD SPECIFICATIONS.

REVISIONS	
NAME	DATE

ILLINOIS DEPARTMENT OF TRANSPORTATION  
 FAI ROUTE 55 (BLACK ROAD TO U.S. 30)  
 WIDENING AND RESURFACING

**DRAINAGE AND UTILITY PLAN**  
**FAI 55**  
**STA. 472+00.00 TO STA. 487+00.00**

SCALE: 1"=50'  
 DATE 03/15/07  
 DRAWN BY MRK  
 CHECKED BY TKL

**TENG**  
 TENG & ASSOCIATES, INC.  
 ENGINEERS/ARCHITECTS/PLANNERS  
 CHICAGO, ILLINOIS

PLT DATE = 03/15/07  
 FILE NAME = 031507.DWG  
 PLOT SCALE = #SCALE#  
 USER NAME = #USER#