

F.A.I. RTE.	SECTION	COUNTY	TOTAL SHEETS	SHEET NO.
55	99 (1&2) WRS-3	WILL	305	41
STA. 787+00		TO STA. 802+00		
FED. ROAD DIST. NO. 1 ILLINOIS FED. AID PROJECT				
PLN-01 OF 15				

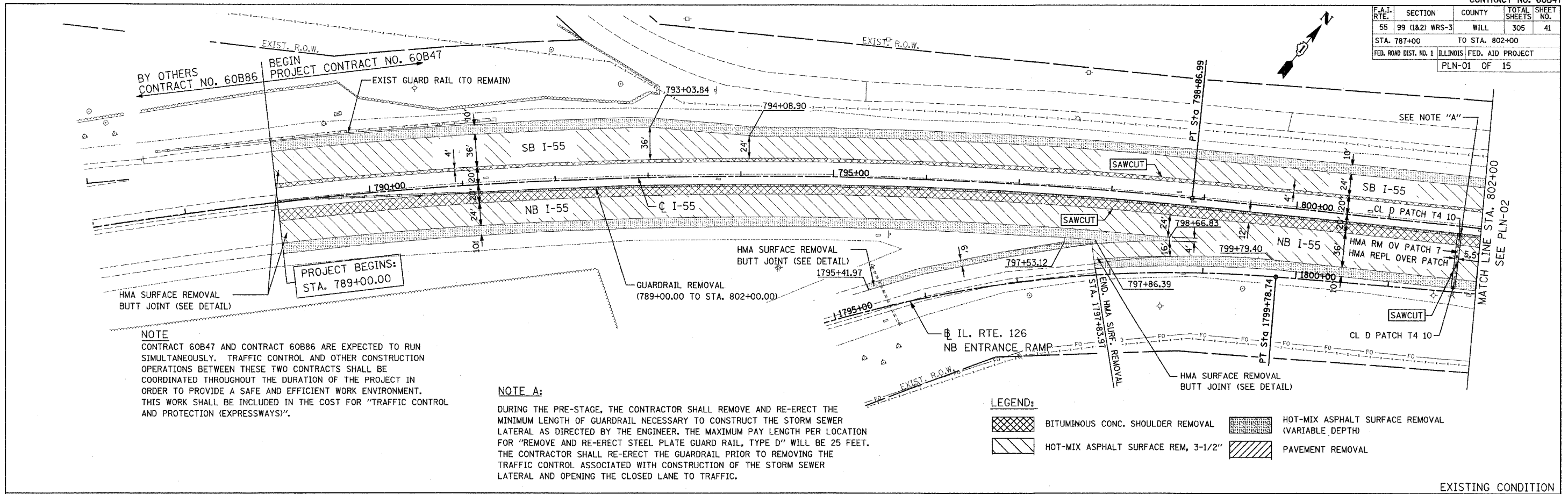

NOTE
 CONTRACT 60B47 AND CONTRACT 60B86 ARE EXPECTED TO RUN SIMULTANEOUSLY. TRAFFIC CONTROL AND OTHER CONSTRUCTION OPERATIONS BETWEEN THESE TWO CONTRACTS SHALL BE COORDINATED THROUGHOUT THE DURATION OF THE PROJECT IN ORDER TO PROVIDE A SAFE AND EFFICIENT WORK ENVIRONMENT. THIS WORK SHALL BE INCLUDED IN THE COST FOR "TRAFFIC CONTROL AND PROTECTION (EXPRESSWAYS)".

NOTE A:
 DURING THE PRE-STAGE, THE CONTRACTOR SHALL REMOVE AND RE-ERECT THE MINIMUM LENGTH OF GUARDRAIL NECESSARY TO CONSTRUCT THE STORM SEWER LATERAL AS DIRECTED BY THE ENGINEER. THE MAXIMUM PAY LENGTH FOR LOCATION FOR "REMOVE AND RE-ERECT STEEL PLATE GUARD RAIL, TYPE D" WILL BE 25 FEET. THE CONTRACTOR SHALL RE-ERECT THE GUARDRAIL PRIOR TO REMOVING THE TRAFFIC CONTROL ASSOCIATED WITH CONSTRUCTION OF THE STORM SEWER LATERAL AND OPENING THE CLOSED LANE TO TRAFFIC.

LEGEND:

	BITUMINOUS CONC. SHOULDER REMOVAL		HOT-MIX ASPHALT SURFACE REMOVAL (VARIABLE DEPTH)
	HOT-MIX ASPHALT SURFACE REM, 3-1/2"		PAVEMENT REMOVAL

EXISTING CONDITION

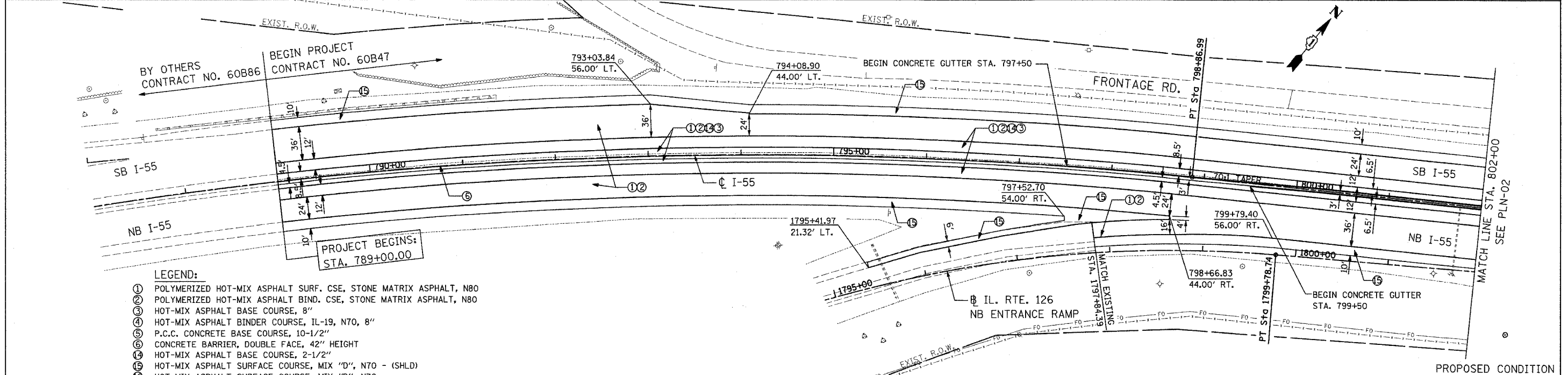

LEGEND:

- ① POLYMERIZED HOT-MIX ASPHALT SURF. CSE, STONE MATRIX ASPHALT, N80
- ② POLYMERIZED HOT-MIX ASPHALT BIND. CSE, STONE MATRIX ASPHALT, N80
- ③ HOT-MIX ASPHALT BASE COURSE, 8"
- ④ HOT-MIX ASPHALT BINDER COURSE, IL-19, N70, 8"
- ⑤ P.C.C. CONCRETE BASE COURSE, 10-1/2"
- ⑥ CONCRETE BARRIER, DOUBLE FACE, 42" HEIGHT
- ⑦ HOT-MIX ASPHALT BASE COURSE, 2-1/2"
- ⑧ HOT-MIX ASPHALT SURFACE COURSE, MIX "D", N70 - (SHLD)
- ⑨ HOT-MIX ASPHALT SURFACE COURSE, MIX "D", N70

PROPOSED CONDITION

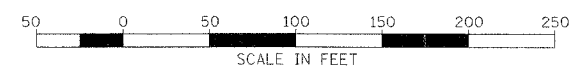

REVISIONS	
NAME	DATE

ILLINOIS DEPARTMENT OF TRANSPORTATION
 FAI ROUTE 55
 143RD STREET TO WEBER ROAD
 EXISTING AND PROPOSED
 ROADWAY PLAN

SCALE: 1" = 50'
 DATE: 02-23-07

DRAWN BY: ALR
 CHECKED BY: RH

FINAL