

F.A.I. RTE.	SECTION	COUNTY	TOTAL SHEETS	SHEET NO.
55	99 (1&2) WRS-3	WILL	305	53
STA. 4900+00		TO STA. 4913+00		
FED. ROAD DIST. NO. 1		ILLINOIS FED. AID PROJECT		
PLN-13 OF 15				

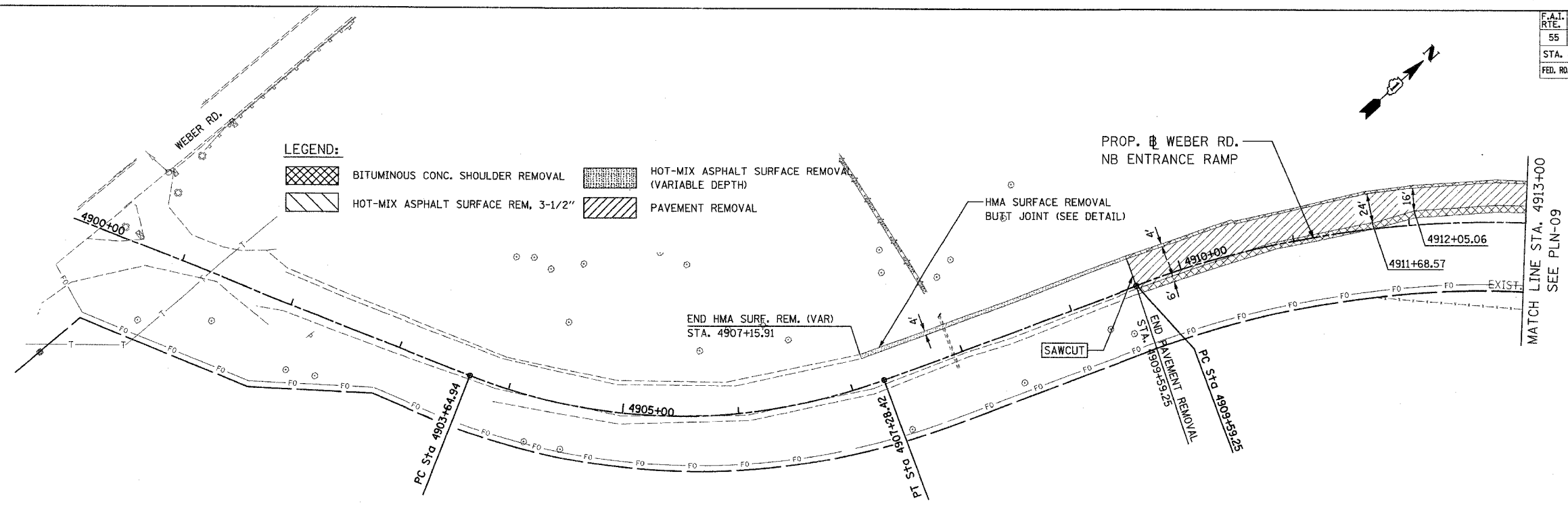

EXISTING CONDITION

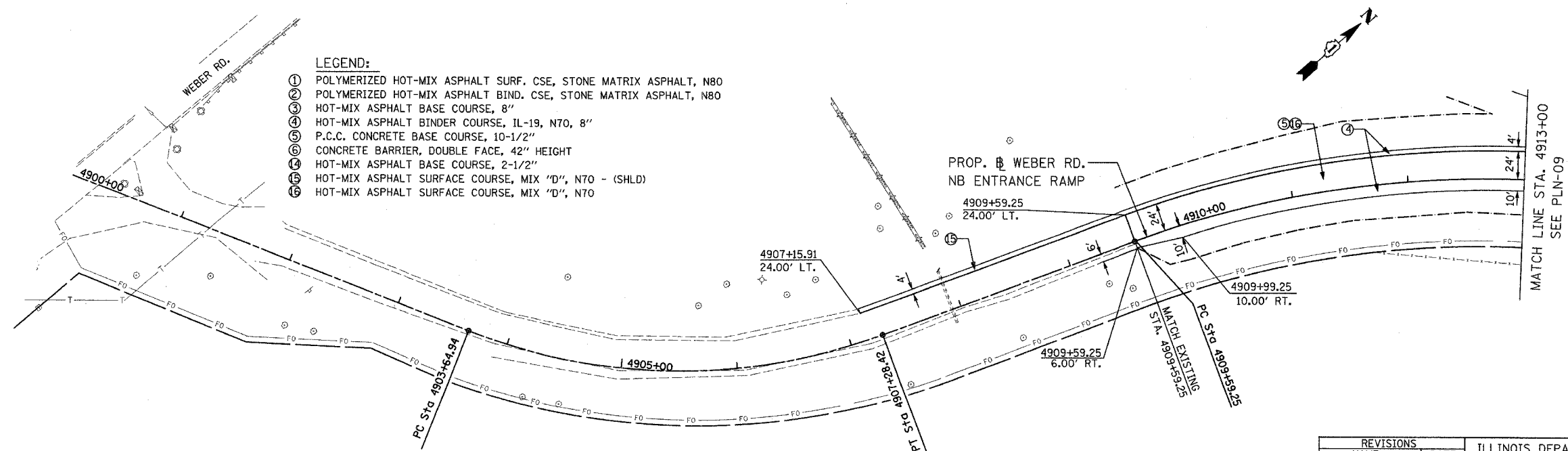

PROPOSED CONDITION

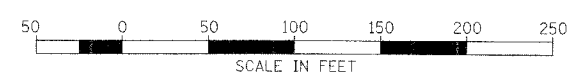

REVISIONS	
NAME	DATE

ILLINOIS DEPARTMENT OF TRANSPORTATION
 FAI ROUTE 55
 143RD STREET TO WEBER ROAD
 EXISTING AND PROPOSED
 ROADWAY PLAN
 SCALE: 1" = 50'
 DATE: 02-23-07
 DRAWN BY: ALR
 CHECKED BY: RH

FINAL