

F.A.I. RTE.	SECTION	COUNTY	TOTAL SHEETS	SHEET NO.
55	99 (1&2) WRS-3	WILL	305	59
STA.		TO STA.		
FED. ROAD DIST. NO.		ILLINOIS FED. AID PROJECT		
P-XX-XXX-XX		DET-04 OF 05		

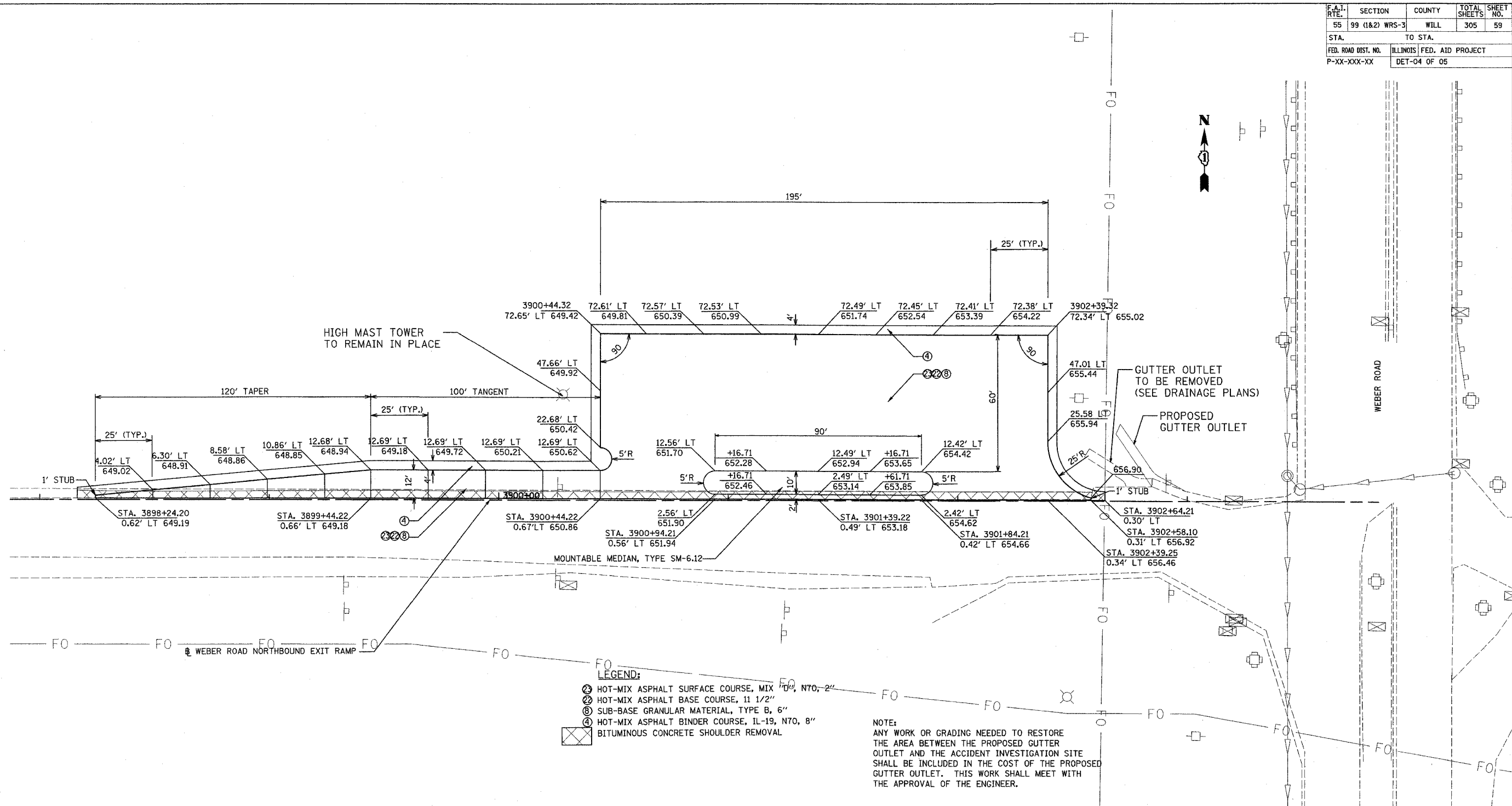

- LEGEND:**
- ② HOT-MIX ASPHALT SURFACE COURSE, MIX 100, N70, 2"
 - ③ HOT-MIX ASPHALT BASE COURSE, 1 1/2"
 - ⑥ SUB-BASE GRANULAR MATERIAL, TYPE B, 6"
 - ④ HOT-MIX ASPHALT BINDER COURSE, IL-19, N70, 8"
 - ⊗ BITUMINOUS CONCRETE SHOULDER REMOVAL

NOTE:
 ANY WORK OR GRADING NEEDED TO RESTORE THE AREA BETWEEN THE PROPOSED GUTTER OUTLET AND THE ACCIDENT INVESTIGATION SITE SHALL BE INCLUDED IN THE COST OF THE PROPOSED GUTTER OUTLET. THIS WORK SHALL MEET WITH THE APPROVAL OF THE ENGINEER.

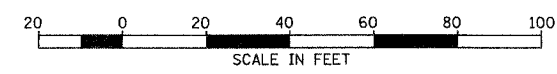

REVISIONS	
NAME	DATE

ILLINOIS DEPARTMENT OF TRANSPORTATION
 FAI ROUTE 55
 143RD STREET TO WEBER ROAD
 ACCIDENT INVESTIGATION SITE
 NORTHBOUND EXIT RAMP AT WEBER ROAD

SCALE: 1" = 20'
 DATE: 02-23-07

DRAWN BY MGH
 CHECKED BY DM

FINAL