

F.A.I. RTE.	SECTION	COUNTY	TOTAL SHEETS	SHEET NO.
55	99 (1&2) WRS-3	WILL	305	70
STA.		TO STA.		
FED. ROAD DIST. NO.	ILLINOIS	FED. AID PROJECT		
		MOT-TYP-03		OF 06

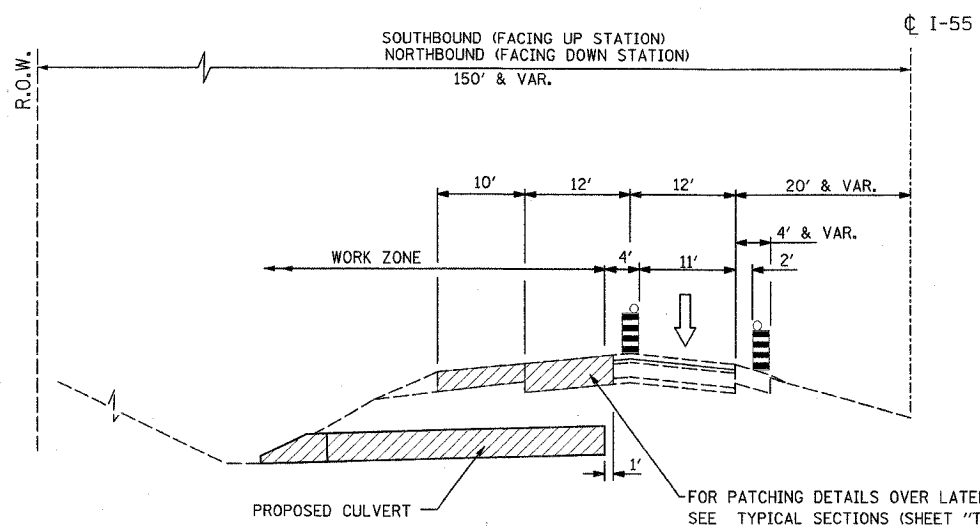

PRE-STAGE, PHASE I
STORM SEWER LATERALS CONSTRUCTION

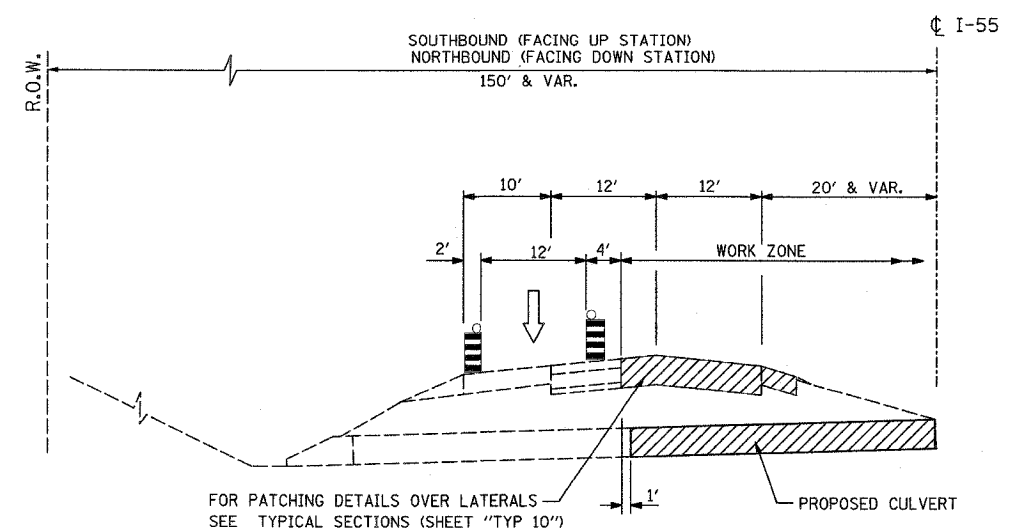

PRE-STAGE, PHASE II
STORM SEWER LATERALS CONSTRUCTION

LEGEND

- ① PVMT MARKING TAPE, TYPE III 4" (WHITE)
- ② PVMT MARKING TAPE, TYPE III 5" SKIP-DASH (30FT/10FT)
- ③ PVMT MARKING TAPE, TYPE III 4" (YELLOW)
- ④ HOT-MIX ASPHALT SURFACE COURSE, MIX "D", N70, 1-3/4"
- ⑤ HOT-MIX ASPHALT BASE COURSE, 10-1/4"
- ⑥ EXISTING AGGREGATE SHOULDER
- ⑦ AGGREGATE SHOULDER, TYPE B
- VERTICAL PANELS AT 100' IN CURVES AND 200' IN TANGENTS
- DRUMS W/ STEADY BURN LIGHTS AT 50' C-C IN TAPERS AND 100' C-C IN TANGENTS
- WORK ZONE
- ↑ TRAFFIC FLOW ARROW
- TEMPORARY CONCRETE BARRIER

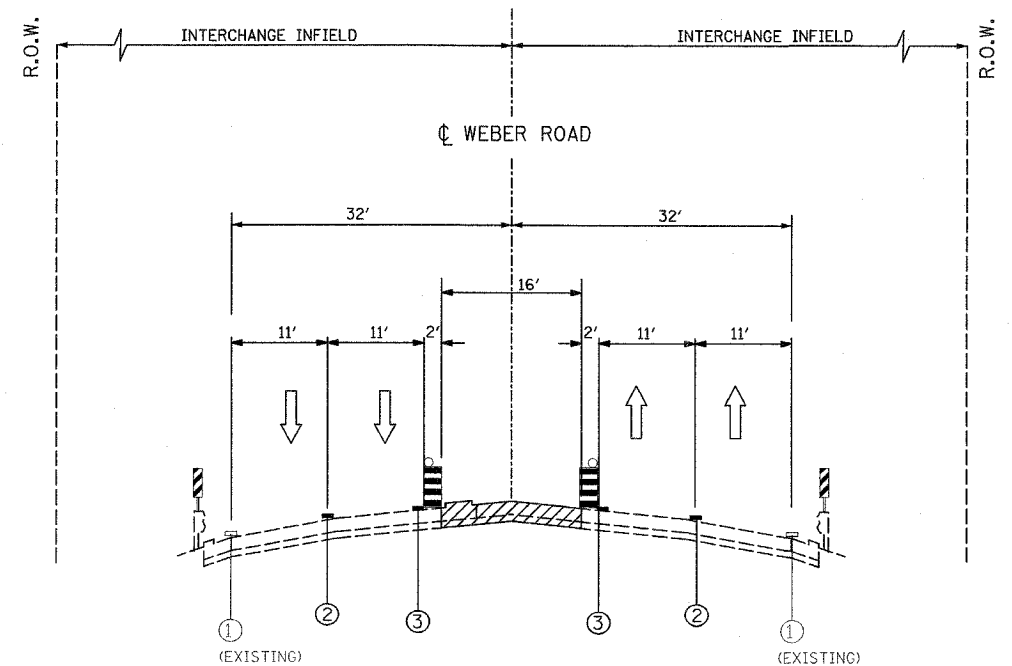

CONSTRUCTION TYPICAL SECTION
STAGE I - WEBER ROAD

PRE-STAGE & STAGE I

REVISIONS	
NAME	DATE

ILLINOIS DEPARTMENT OF TRANSPORTATION
FAI ROUTE 55
143RD STREET TO WEBER ROAD
SUGGESTED STAGES OF
CONSTRUCTION AND TRAFFIC CONTROL
GENERAL NOTES AND DETAILS

SCALE: NONE
DATE: 02-23-07

DRAWN BY: DM
CHECKED BY: DVS

