

F.A.I. RTE.	SECTION	COUNTY	TOTAL SHEETS	SHEET NO.
55	99 (I&2) WRS-3	WILL	305	85
STA.	TO STA.			
907+00	937+00			
FED. ROAD DIST. NO.	ILLINOIS FED. AID PROJECT			
	MOTII-05 OF 07			

LEGEND

- WORK ZONE
- DIRECTION OF TRAVEL
- TEMP CONCRETE BARRIER
- DRUMS W/ STEADY BURN LIGHTS
*See Drawing For Spacing
- BARRICADE, TYPE III WITH TWO FLASHING LIGHTS
- ① PVMT MARKING TAPE, TYPE III 4" (WHITE)
- ② PVMT MARKING TAPE, TYPE III 5" SKIP-DASH (WHITE-30 FT/10 FT)
- ③ PVMT MARKING TAPE, TYPE III 4" (YELLOW)
- ④ PVMT MARKING TAPE, TYPE III 4" SKIP-DASH (WHITE-6 FT/2 FT)
- ⑤ PVMT MARKING TAPE, TYPE III 8" (WHITE)
- ⑥ PVMT MARKING TAPE, TYPE III 12" (WHITE)
- ⑦ PVMT MARKING TAPE, TYPE III 8" SKIP-DASH (WHITE-9 FT/3 FT)

*STATIONS AND OFFSETS FOR RAMP WORK ARE DESCRIBED FROM RAMP
 Ⓢ TO WHICH CALL OUTS ORIGINATE UNLESS NOTED OTHERWISE.

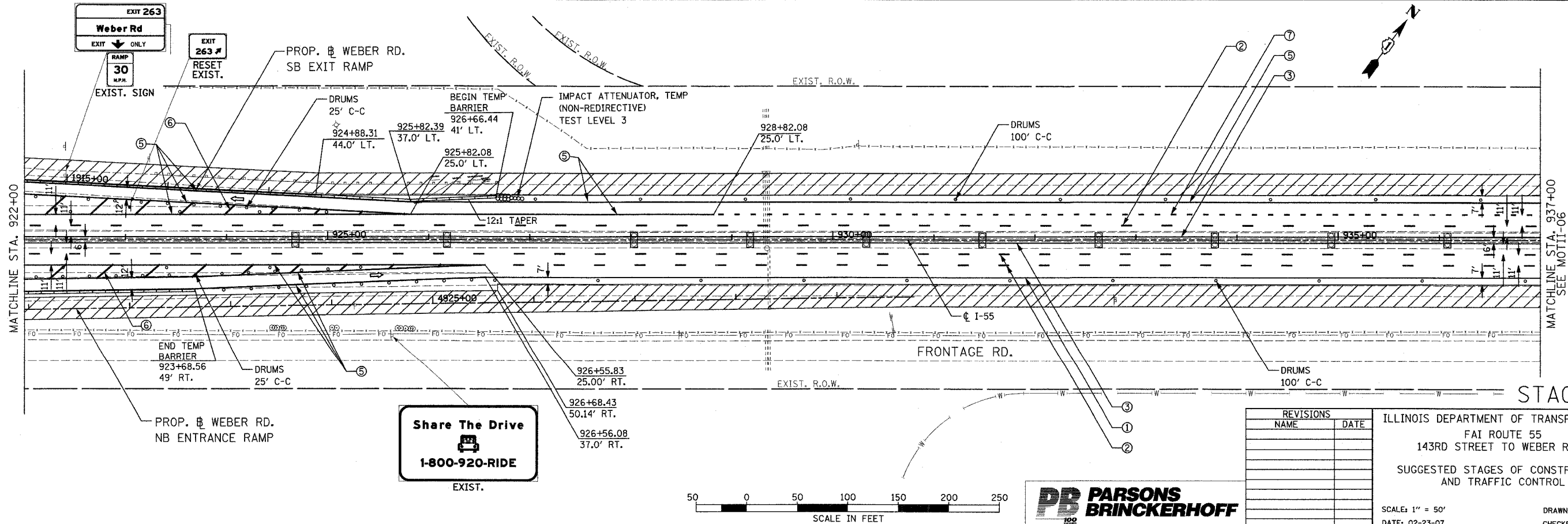
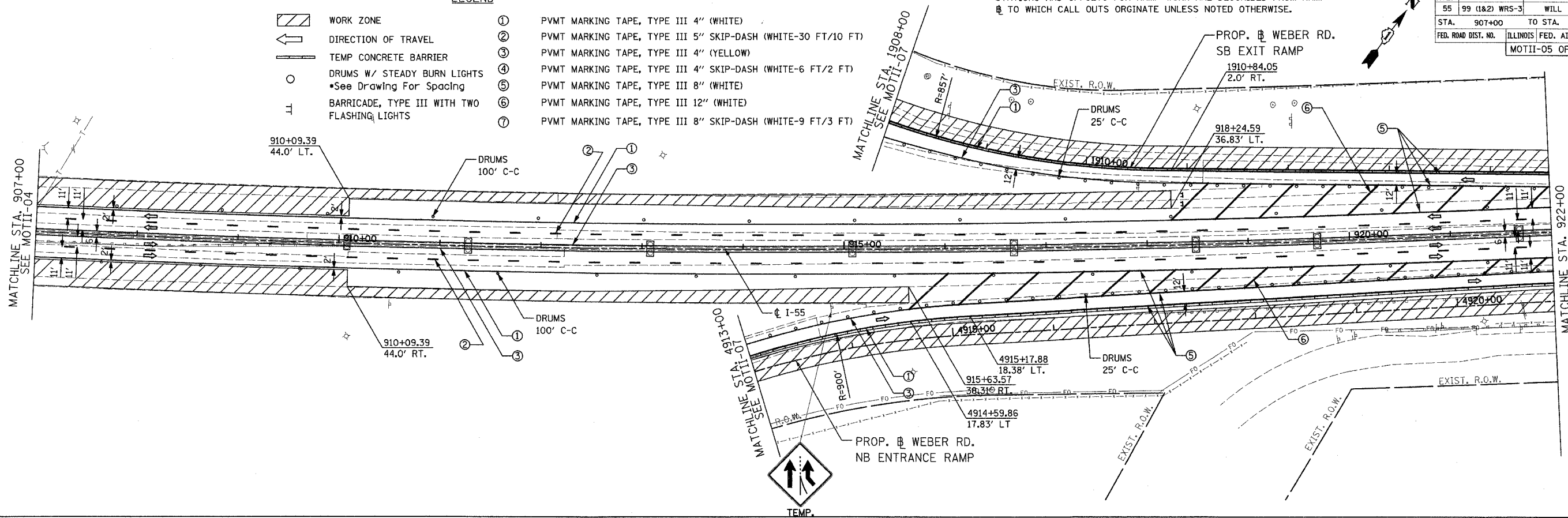

Share The Drive

1-800-920-RIDE
 EXIST.

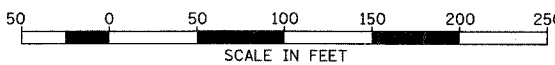

PARSONS BRINCKERHOFF

REVISIONS	
NAME	DATE

ILLINOIS DEPARTMENT OF TRANSPORTATION
 FAI ROUTE 55
 143RD STREET TO WEBER ROAD
 SUGGESTED STAGES OF CONSTRUCTION
 AND TRAFFIC CONTROL
 SCALE: 1" = 50'
 DATE: 02-23-07
 DRAWN BY: TJR
 CHECKED BY: DM

FINAL