

CONTRACT NO. 60B47			
F.A. RTE.	SECTION	COUNTY	TOTAL SHEETS
55	99 (1&2) WRS-3	WILL	305
STA. 787+00 TO STA. 802+00		FED. ROAD DIST. NO.	ILLINOIS FED. AID PROJECT
		DRU-01 OF 14	

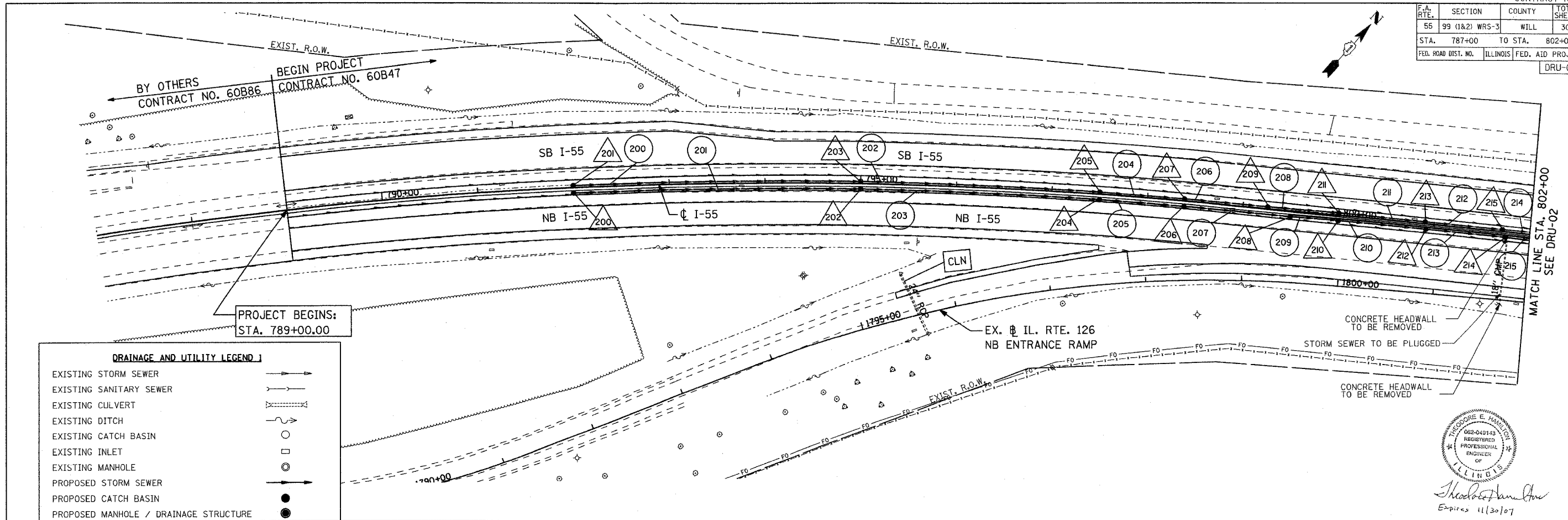

PROJECT BEGINS:  
STA. 789+00.00

**DRAINAGE AND UTILITY LEGEND 1**

EXISTING STORM SEWER	
EXISTING SANITARY SEWER	
EXISTING CULVERT	
EXISTING DITCH	
EXISTING CATCH BASIN	
EXISTING INLET	
EXISTING MANHOLE	
PROPOSED STORM SEWER	
PROPOSED CATCH BASIN	
PROPOSED MANHOLE / DRAINAGE STRUCTURE	

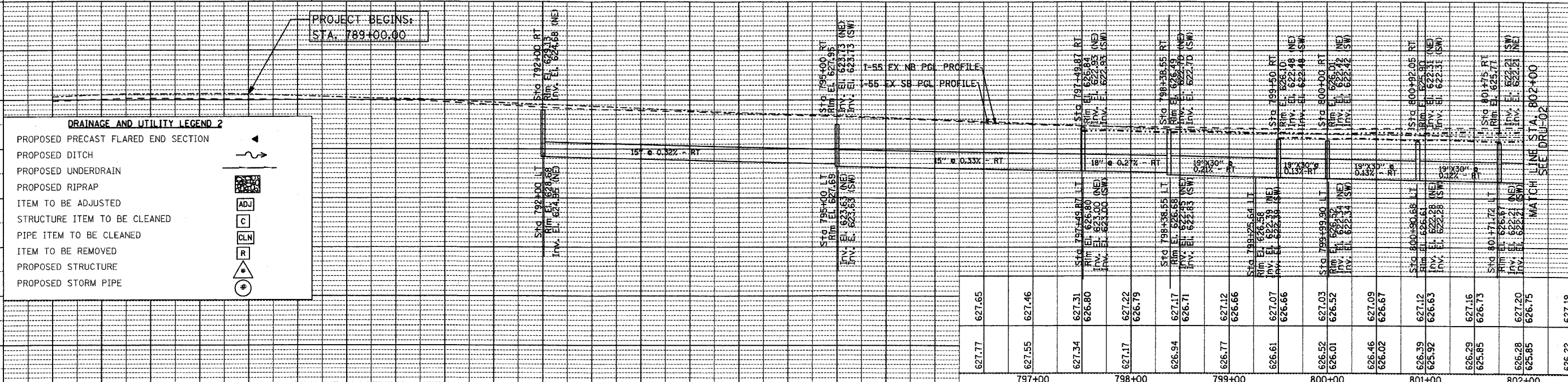

**DRAINAGE AND UTILITY LEGEND 2**

PROPOSED PRECAST FLARED END SECTION	
PROPOSED DITCH	
PROPOSED UNDERDRAIN	
PROPOSED RIPRAP	
ITEM TO BE ADJUSTED	
STRUCTURE ITEM TO BE CLEANED	
PIPE ITEM TO BE CLEANED	
ITEM TO BE REMOVED	
PROPOSED STRUCTURE	
PROPOSED STORM PIPE	

SB PGL ELEV	629.87	630.05	630.14	630.10	630.07	630.03	629.99	629.95	629.80	629.52	629.26	629.05	628.89	628.79	628.58	628.42	628.27	628.09	627.91
NB PGL ELEV	630.30	630.52	630.59	630.61	630.56	630.41	630.25	630.11	629.96	629.76	629.55	629.36	629.15	628.91	628.69	628.53	628.37	628.18	627.97
	787+00	788+00	789+00	790+00	791+00	792+00	793+00	794+00	795+00	796+00	797+00	798+00	799+00	800+00	801+00	802+00	802+00	802+00	802+00

100FT (HORIZ.)  
10FT (VERT.)

GRAPHIC SCALE IN FEET

PARSONS BRINCKERHOFF  
SMITH ENGINEERING CONSULTANTS, INC.

**REVISIONS**

NAME	DATE

ILLINOIS DEPARTMENT OF TRANSPORTATION  
FAI ROUTE 55  
143RD STREET TO WEBER ROAD  
DRAINAGE AND UTILITY  
PLAN AND PROFILE

SCALE: VERT. 1"=50'  
HORIZ. 1"=10'  
DATE: 02/23/2007

DRAWN BY: JPA  
CHECKED BY: TEH

PROFESSOR E. HANNON  
062-049143  
REGISTERED  
PROFESSIONAL  
ENGINEER  
OF  
ILLINOIS

*Shelton*  
Expires 11/30/07

FINAL