

F.A. RTE.	SECTION	COUNTY	TOTAL SHEETS	SHEET NO.
55			305	164
STA.		TO STA.		
FED. ROAD DIST. NO.		ILLINOIS FED. AID PROJECT		

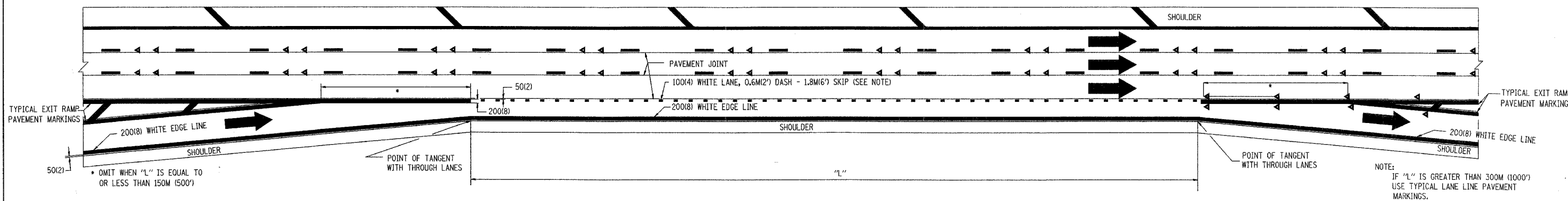

TYPICAL ENTRANCE/EXIT RAMP COMBINATION PAVEMENT MARKINGS

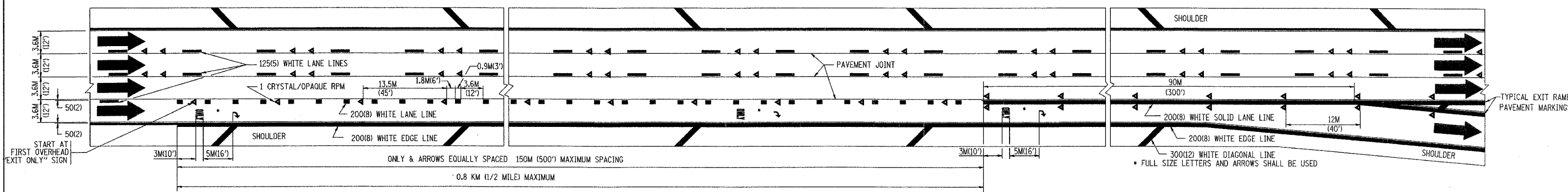

TYPICAL EXIT ONLY LANE PAVEMENT MARKINGS

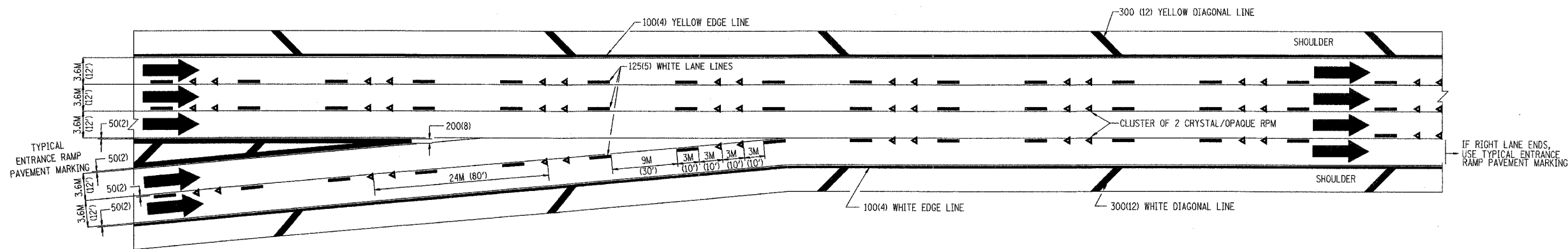

TYPICAL TWO LANE ENTRANCE RAMP PAVEMENT MARKINGS

REVISIONS	
NAME	DATE
DWS	1/90
DWS	5/91

ILLINOIS DEPARTMENT OF TRANSPORTATION
 MULTI-LANE FREEWAY
 PAVEMENT MARKING
 DETAILS
 SCALE: NONE
 DATE: 3/1/2006
 DRAWN BY C.A.D.D.
 CHECKED BY
 TC12 SHEET 2 OF 2
 REVISION DATE: 02/28/06

PLOT DATE = 3/1/06
 FILE NAME = K:\data\1022.dgn
 PLOT SCALE = 0.8000 / 1 IN.
 USER NAME = jagan