

STATE OF ILLINOIS
DEPARTMENT OF TRANSPORTATION

ROUTE NO.	SECTION	COUNTY	DIS.	SHEET	SHEET NO. 1 1 SHEETS
FA1 55	**	WILL	305	181	
FED. ROAD DIST. NO. 7	ILLINOIS	FED. AID PROJECT-			

** SECTION 99 (1&2) WRS-3
CONTRACT NO. 60B47

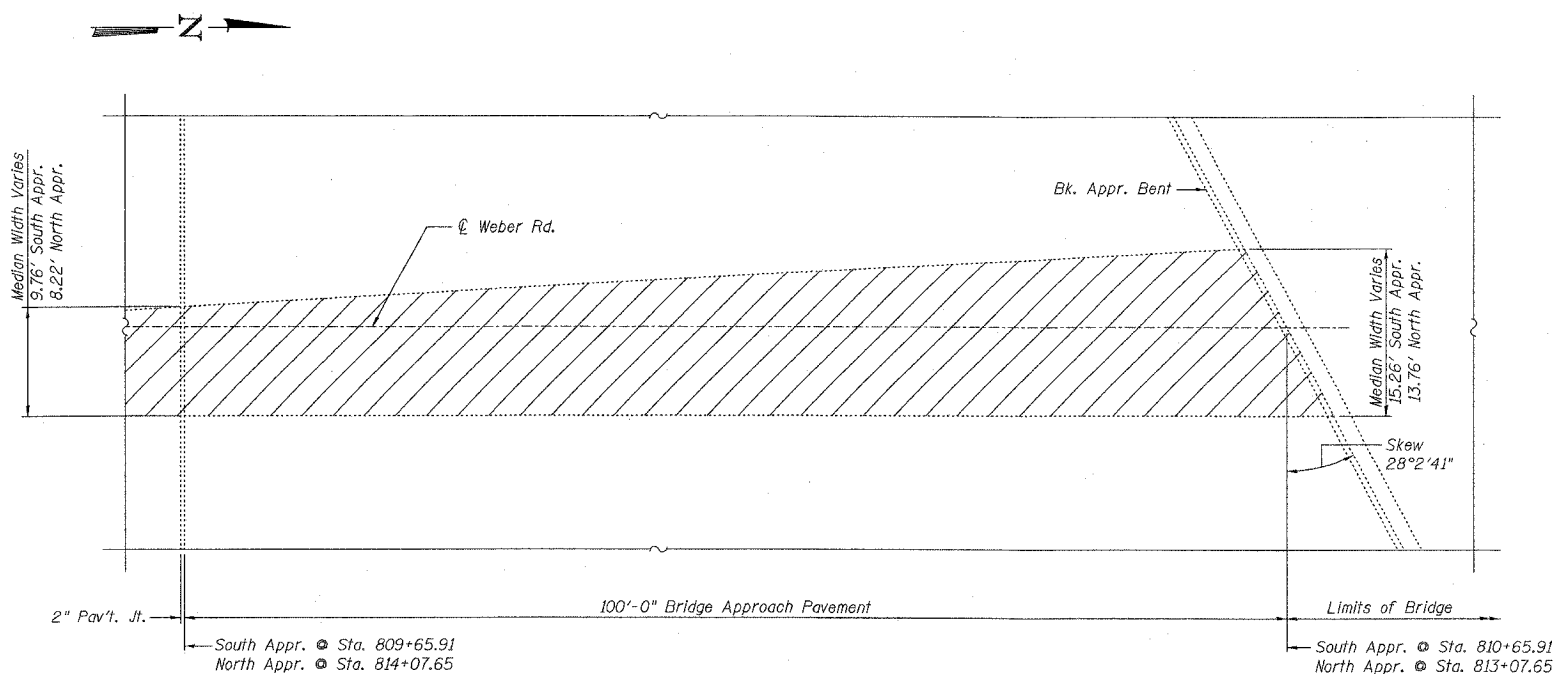

**APPROACH PAVEMENT
MEDIAN REMOVAL PLAN**
(South Approach Median Shown, North Approach Median Similar)

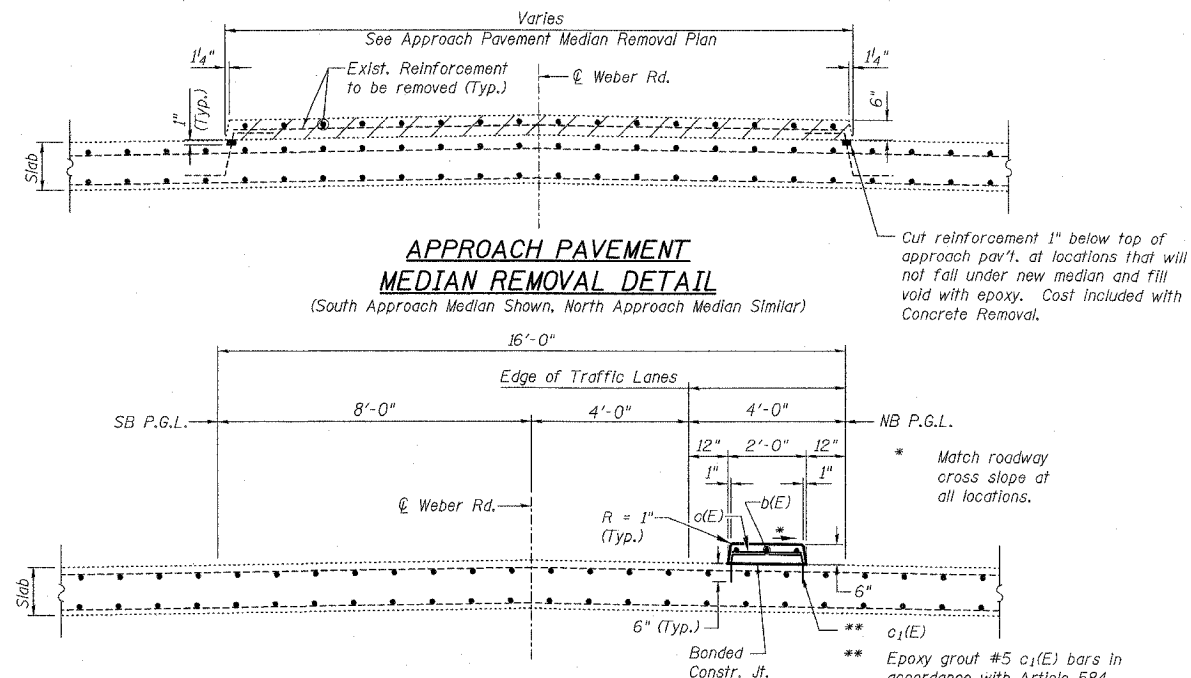

**APPROACH PAVEMENT
MEDIAN REMOVAL DETAIL**
(South Approach Median Shown, North Approach Median Similar)

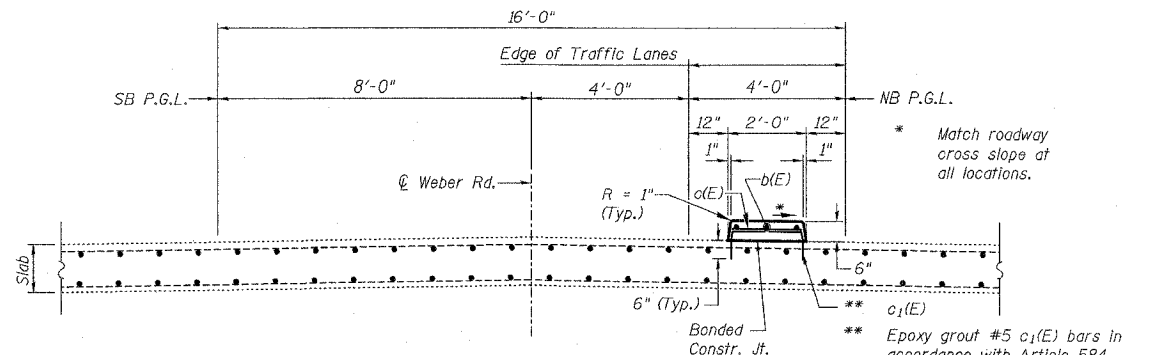

**APPROACH PAVEMENT
PROPOSED MEDIAN DETAIL**
(South Approach Median Shown, North Approach Median Similar)

**PROPOSED MEDIAN
BILL OF MATERIAL**

Bar	No.	Size	Length	Shape
b(E)	24	#5	27'-8"	
c(E)	202	#5	1'-9"	
c1(E)	404	#5	1'-10"	
Concrete Removal			Cu. Yd.	43.6
Concrete Structures			Cu. Yd.	7.4
Bridge Deck Grooving			Sq. Yd.	217
Protective Coat			Sq. Yd.	328
* Reinforcement Bars, Epoxy Coated			Pound	1,840
** Joint or Crack Routing (PC Concrete Pavement and Shoulder)			Foot	400

* See Special Provisions
** See General Note No. 8

DESIGN STRESSES

$f_y = 60,000$ PSI
 $f'_c = 3,500$ PSI
 $n = 8.5$

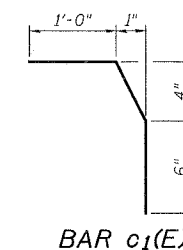

BAR c1(E)

GENERAL NOTES:

- Min. Lap shall be 2'-2" for #5 bars.
- Reinforcement bars designated (E) shall be epoxy coated.
- Bars indicated thus 3 x 4-#5 etc. indicates 3 line of bars with 4 lengths per line.
- The final surface after median removal shall be smoothed by grinding, subject to the approval of the Engineer, prior to completing the Bridge Deck Grooving. Cost included with Concrete Removal.
- Saw Cut Grooving shall be performed in the areas of each bridge approach pavement that are within the footprint plus 1'-0" on each side of the existing median but not covered by the proposed median. This work shall be completed in accordance with Section 503.15 (a)(3)b of the Standard Specifications. This work will be included in the cost for Bridge Deck Grooving.
- Protective Coat shall be applied to the surface of each bridge approach pavement that is within the footprint plus 1'-0" on each side of the existing median, top surface of the proposed raised median, and each vertical face of the proposed median curb. This work shall be completed in accordance with Section 420.18 of the Standard Specifications. This work will be included in the cost of Protective Coat.
- A 2" Pavement Joint is required in the areas of the approach pavement that are within the footprint of the existing median at both approach ends. All work required to install the proposed pavement joint shall be considered incidental. All materials and labor shall be included in the cost of Concrete Structures and no additional compensation will be allowed. See Standard 420001 for joint details.
- Approach pavement longitudinal construction joints with gaps larger than 3 inches shall be sealed in accordance with Section 452 of the Standard Specifications or as directed by the Engineer. This work will be paid for at the contract unit cost per foot for Joint or Crack Routing (PC Concrete Pavement and Shoulder).

LEGEND

Concrete Removal

**BRIDGE APPROACH PAVEMENT
WEBER ROAD OVER I-55
SECTION 99 (1&2) WRS-3
WILL COUNTY
STA. 811+86.78
STRUCTURE NO. 099-0281**



2/16/2007 9:42:17 AM C:\116617\AS\StructCadd\Pre-Final\WEBER\Final Submittal to IDOT\BO_022307\092206-09B47-000-000-000_Appr Pavt Design

DESIGNED	S.CHELBIAN
CHECKED	J.GRAINAWI
DRAWN	S.CHELBIAN
CHECKED	J.GRAINAWI

Date: 2/23/2007