

F.A. RTE.	SECTION	COUNTY	TOTAL SHEETS	SHEET NO.
290	2006-030 I	COOK	82	4
STA.		TO STA.		
FED. ROAD DIST. NO.		ILLINOIS FED. AID PROJECT		

NOTE: FOR STAGING TYPICAL SECTIONS SEE SHEETS 40, 52 AND 64

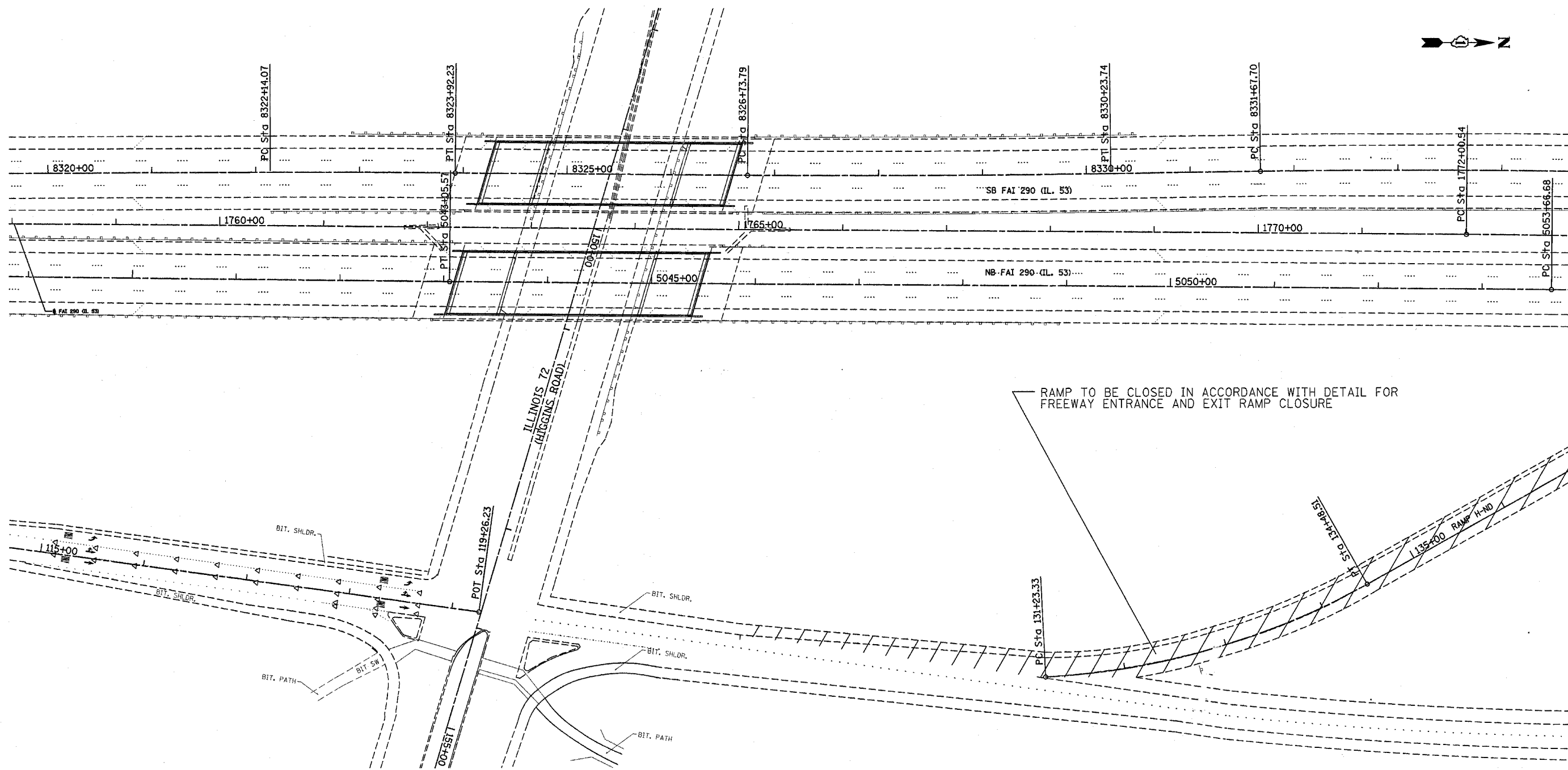

RAMP TO BE CLOSED IN ACCORDANCE WITH DETAIL FOR FREEWAY ENTRANCE AND EXIT RAMP CLOSURE

NOTE:

TRAFFIC CONTROL STAGING SHALL REQUIRE ADDITIONAL SIGNING. THESE ADDITIONAL SIGNING PLAN SHEETS SHALL BE PROVIDED AT THE PRECONSTRUCTION MEETING.

REVISIONS	
NAME	DATE
Δ - Revised Sheet	5/2/07

ILLINOIS DEPARTMENT OF TRANSPORTATION
TRAFFIC CONTROL STAGING
Stage 1

SCALE: VERT.
HORIZ.
DATE

DRAWN BY
CHECKED BY

Δ Rev. 6-7-07

PLOT DATE = 5/20/2007
FILE NAME = c:\projects\142886\design\stage1.dgn
PLOT SCALE = 5/8" = 1' / IN.
USER NAME = r1chiera