

F.A. RTE.	SECTION	COUNTY	TOTAL SHEETS	SHEET NO.
290	2006-030 I	COOK	82	5
STA.		TO STA.		
FED. ROAD DIST. NO.		ILLINOIS FED. AID PROJECT		

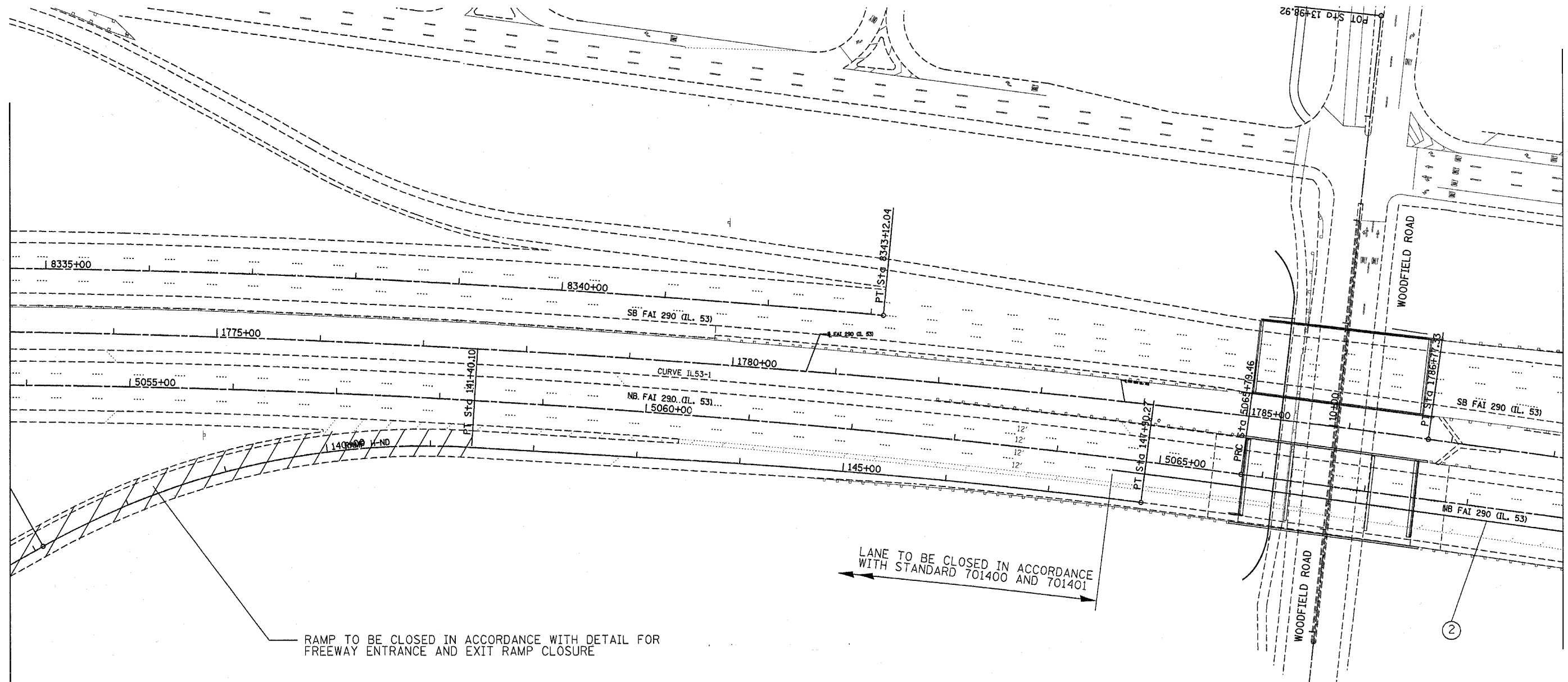
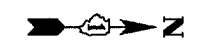

LANE TO BE CLOSED IN ACCORDANCE WITH STANDARD 701400 AND 701401

RAMP TO BE CLOSED IN ACCORDANCE WITH DETAIL FOR FREEWAY ENTRANCE AND EXIT RAMP CLOSURE

STAGING PAVEMENT MARKING LEGEND

- ① LINE 4" (YELLOW EDGE)
- ② LINE 4" (WHITE EDGE)
- ③ LINE 4" (WHITE 6' SKIP, 2' DASH)
- ④ LINE 5" (WHITE 30' SKIP, 10' DASH)
- ⑤ LINE 8" (WHITE GORE)
- ⑥ LINE 12" (WHITE DIAGONAL)

REVISIONS	
NAME	DATE
Δ- Revised sheet	5/30/07

ILLINOIS DEPARTMENT OF TRANSPORTATION
TRAFFIC CONTROL STAGING
 Stage 1

SCALE: VERT. _____
 HORIZ. _____

DATE _____

DRAWN BY _____
 CHECKED BY _____

PLOT DATE = 5/30/2007
 PLOT SCALE = 5/16000" = 1" = 160'
 USER NAME = ritchie