

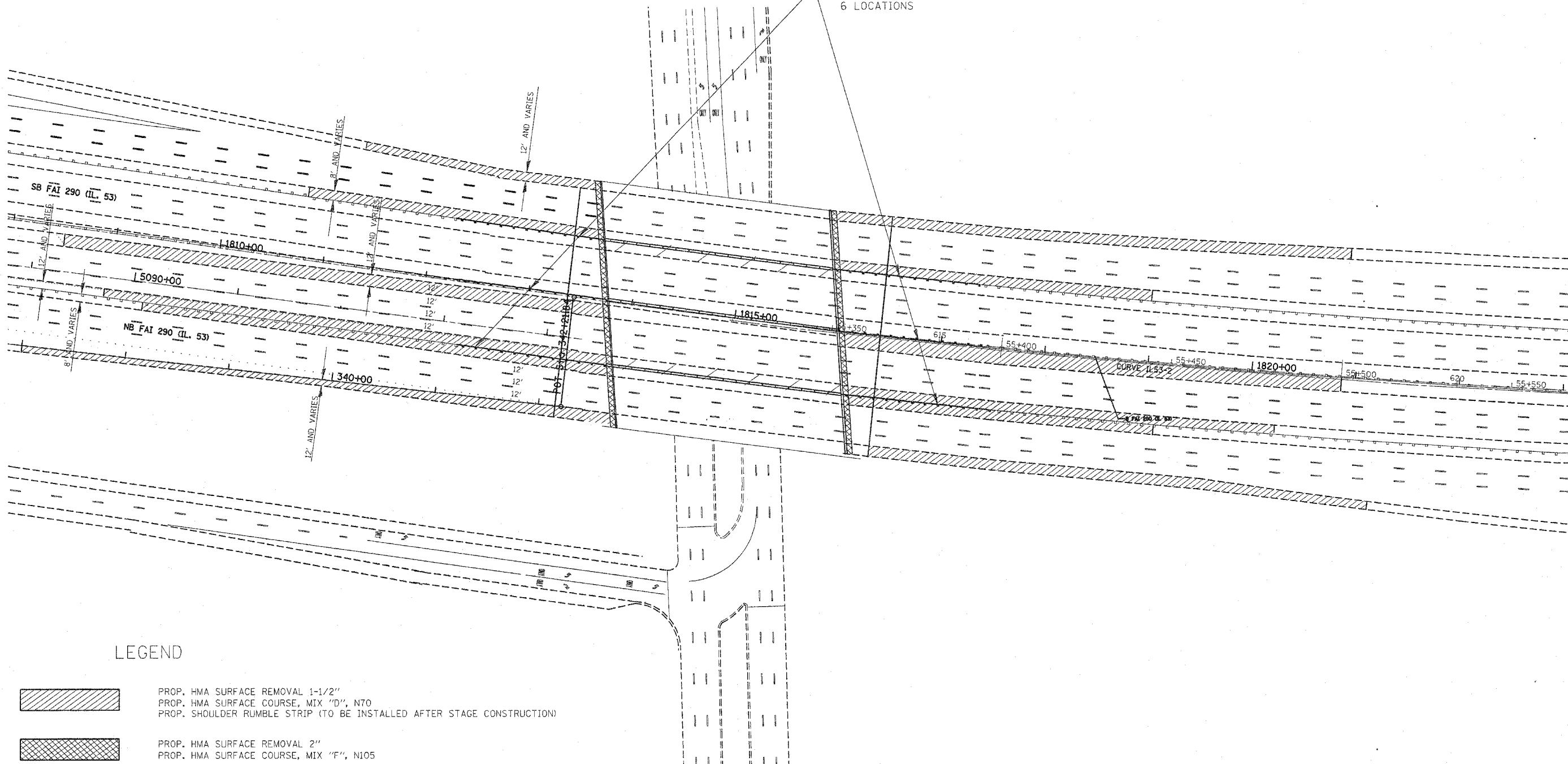

F.A. RTE.	SECTION	COUNTY	TOTAL SHEETS	SHEET NO.
290	2006-030 1	COOK	78	72
STA.		TO STA.		
FED. ROAD DIST. NO.		ILLINOIS FED. AID PROJECT		

PROP. TRAFFIC BARRIER TERMINAL TYPE 6 - 1 EACH
 PROP. STEEL PLATE BEAM GUARDRAIL, TYPE D - 100 L.F.
 6 LOCATIONS

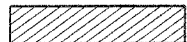

LEGEND

-  PROP. HMA SURFACE REMOVAL 1-1/2"
 PROP. HMA SURFACE COURSE, MIX "D", N70
 PROP. SHOULDER RUMBLE STRIP (TO BE INSTALLED AFTER STAGE CONSTRUCTION)
-  PROP. HMA SURFACE REMOVAL 2"
 PROP. HMA SURFACE COURSE, MIX "F", N105

NOTE

HMA RESURFACING OF THE EXISTING ROADWAY SHOULDERS SHALL BE LIMITED TO AREAS WHERE TRAFFIC HAS TO BE WEAVED INTO THE SHOULDER FOR STAGING. SHOULDER RESURFACING SHALL BE COMPLETED PRIOR TO STAGE CONSTRUCTION.

REVISIONS	
NAME	DATE
Revised sheets	9/30/07

ILLINOIS DEPARTMENT OF TRANSPORTATION
 ROADWAY PLANS
 I-290/IL. 53 AT
 ILL. 58 (GOLF RD.)
 SCALE: VERT. _____
 HORIZ. _____
 DATE _____ DRAWN BY _____
 CHECKED BY _____

PLOT DATE = 5/29/2007
 FILE NAME = c:\projects\i290\design\i290\design.dgn
 USER NAME = S1060007 / JN
 USER NAME = P1060000