

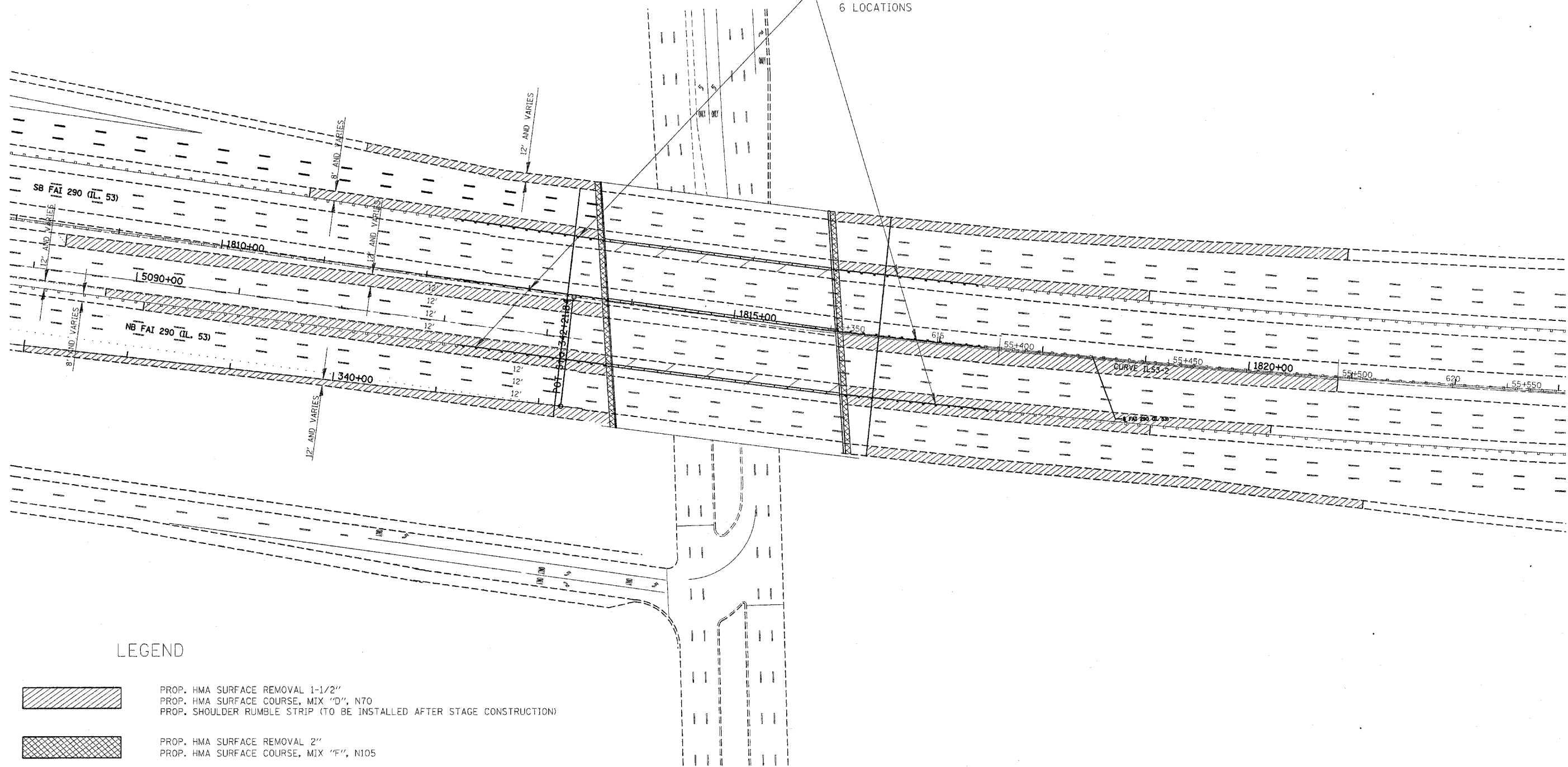

F.A. RTE.	SECTION	COUNTY	TOTAL SHEETS	SHEET NO.
290	2006-030 I	COOK	78	61
STA.		TO STA.		
FED. ROAD DIST. NO.		ILLINOIS FED. AID PROJECT		

PROP. TRAFFIC BARRIER TERMINAL TYPE 6 - 1 EACH  
 PROP. STEEL PLATE BEAM GUARDRAIL, TYPE D - 100 L.F.  
 6 LOCATIONS



LEGEND

-  PROP. HMA SURFACE REMOVAL 1-1/2"  
 PROP. HMA SURFACE COURSE, MIX "D", N70  
 PROP. SHOULDER RUMBLE STRIP (TO BE INSTALLED AFTER STAGE CONSTRUCTION)
-  PROP. HMA SURFACE REMOVAL 2"  
 PROP. HMA SURFACE COURSE, MIX "F", N105

NOTE

HMA RESURFACING OF THE EXISTING ROADWAY SHOULDERS SHALL BE LIMITED TO AREAS WHERE TRAFFIC HAS TO BE WEAIVED INTO THE SHOULDER FOR STAGING. SHOULDER RESURFACING SHALL BE COMPLETED PRIOR TO STAGE CONSTRUCTION.

REVISIONS	
NAME	DATE

ILLINOIS DEPARTMENT OF TRANSPORTATION

ROADWAY PLANS  
 I-290/IL. 53 AT  
 ILL. 58 (GOLF RD.)

SCALE: VERT.  
 HORIZ.  
 DATE

DRAWN BY  
 CHECKED BY